

Antennas

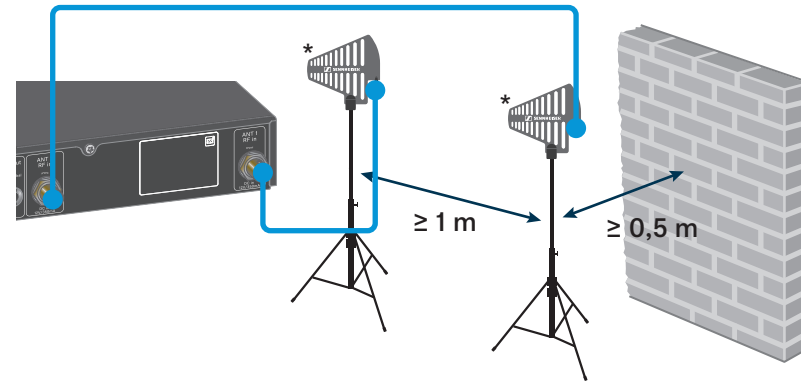

*optional accessories:
ADP UHF (470 - 1075 MHz)
AD 1800 (1400 - 2400 MHz)

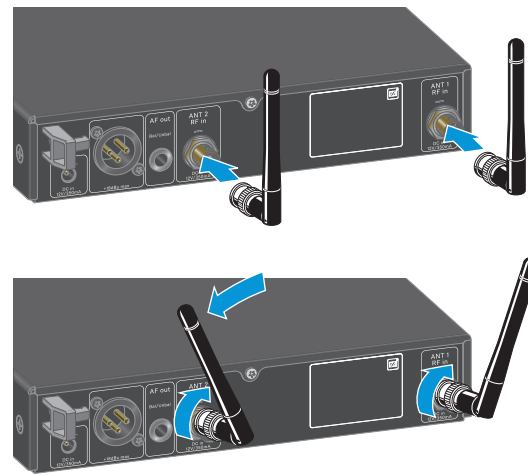

EW-D Smart Assist



Sennheiser Documentation App



or online at
www.sennheiser.com/download
EW-D_

Sennheiser electronic GmbH & Co. KG

Am Labor 1, 30900 Wedemark, Germany
www.sennheiser.com

Printed in Germany
Publ. 04./20, 583962/A01



Evolution Wireless Digital

- Quick Guide
- Kort vejledning
- Kurzanleitung
- Pikaohje
- Guide rapide
- Γρήγορος οδηγός
- Guida rapida
- Kısa Kılavuz
- Guía de inicio rápido
- Краткая инструкция
- Guia rápido
- 快速指南
- Beknopte handleiding
- クイックガイド
- Krótka instrukcja obsługi
- 퀵 가이드
- Snabbguide

SENNHEISER

Audio Out

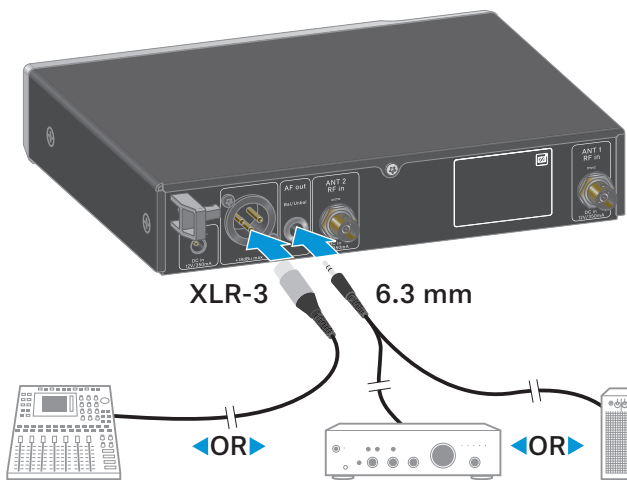

Power supply

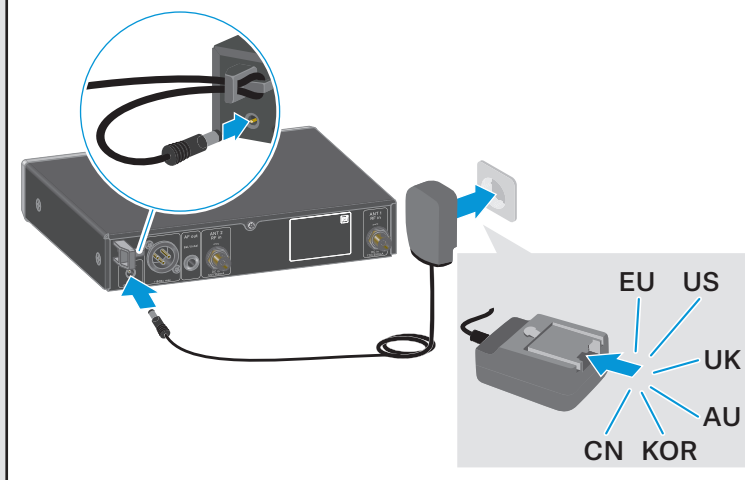

EW-D Smart Assist

The EW-D Smart Assist app simplifies your workflow

- EW-D Smart Assist app provides automated setup, operation and monitoring using any iOS or Android device
- Intelligent setup automatically creates reliable wireless connections, no wireless expertise required
- Mobile access to all system settings centralizes control and eliminates the need for complicated menu navigation on each device
- Easy frequency allocation and wireless channel naming help to keep systems organized



In the box

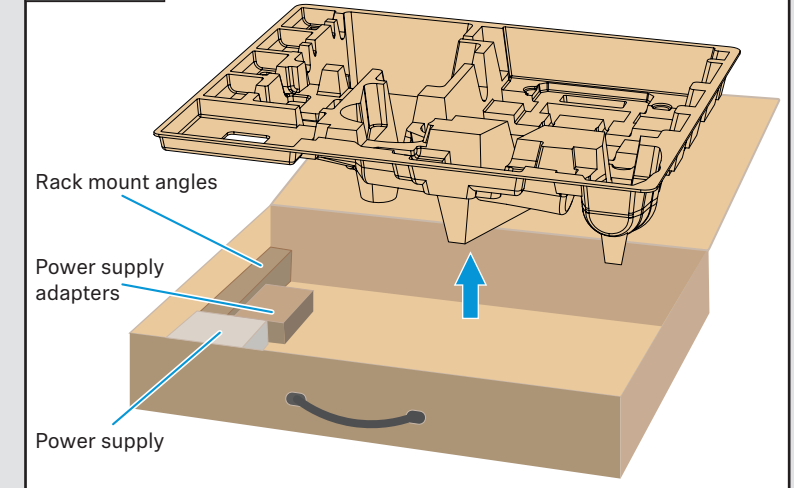

Battery

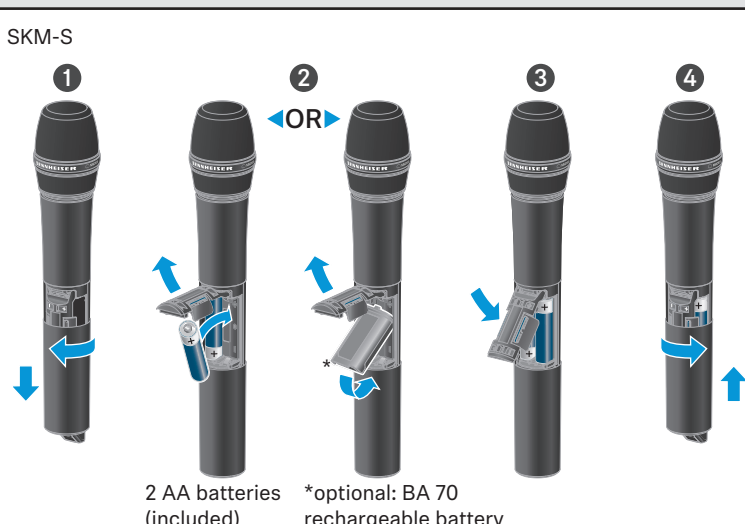
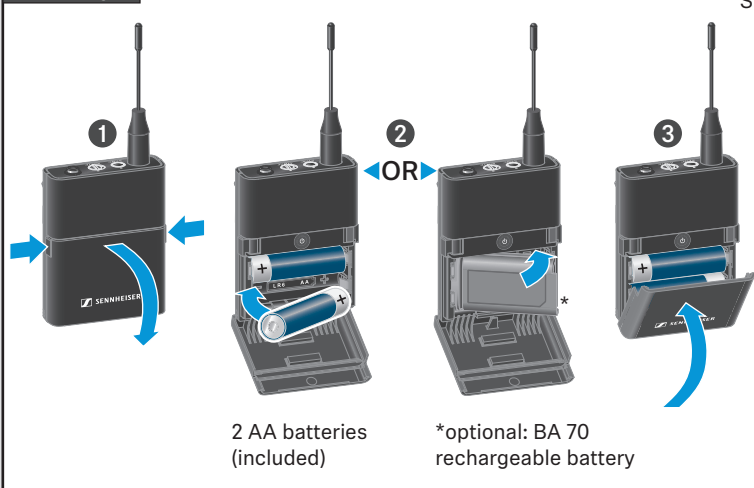

EW-D EM

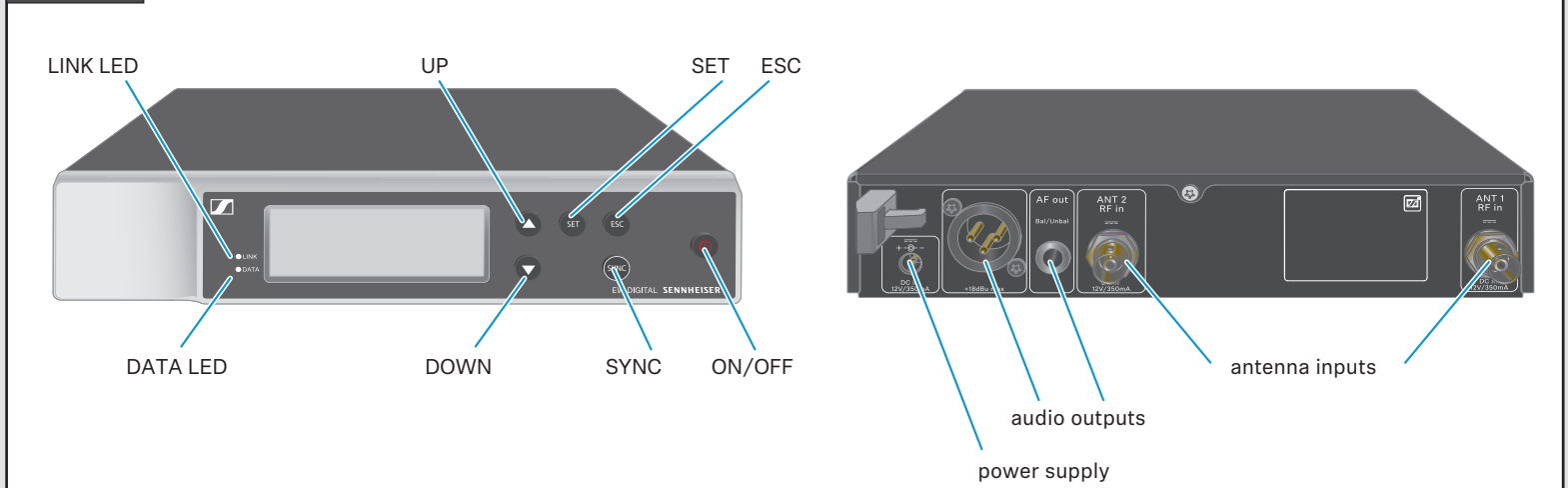

On/Off

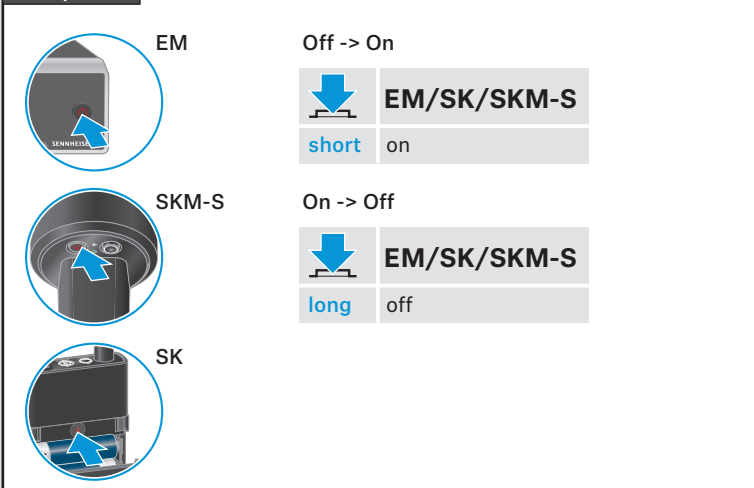

Identify/Battery check

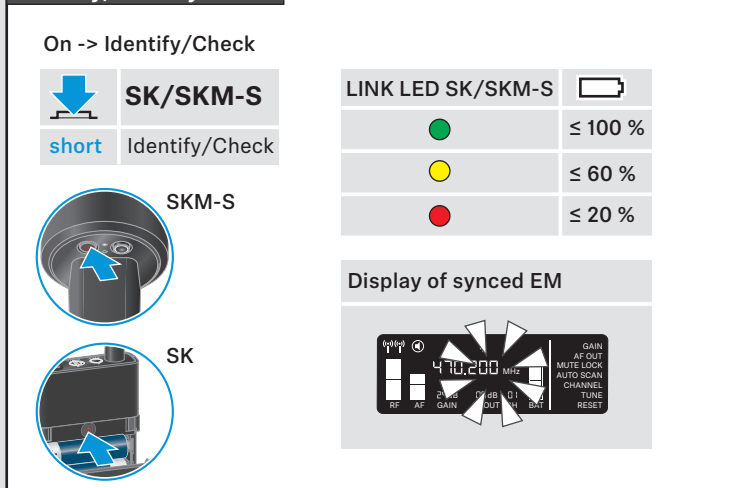

EW-D SKM-S

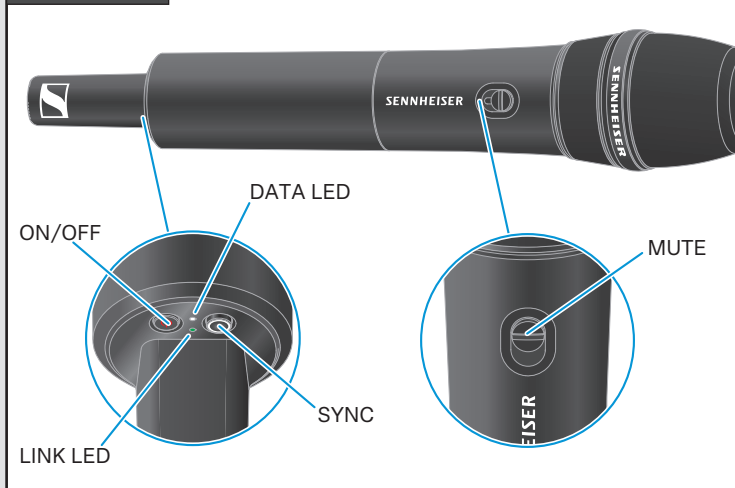

EW-D SK

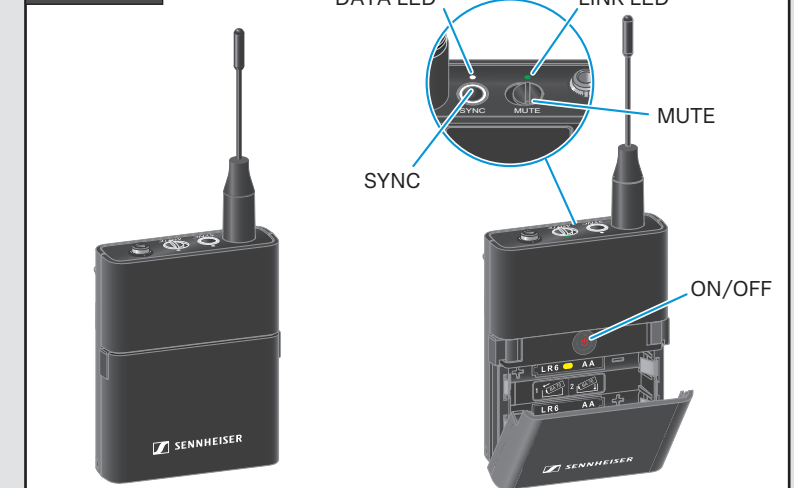

Display

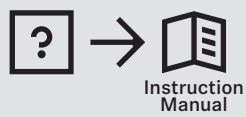
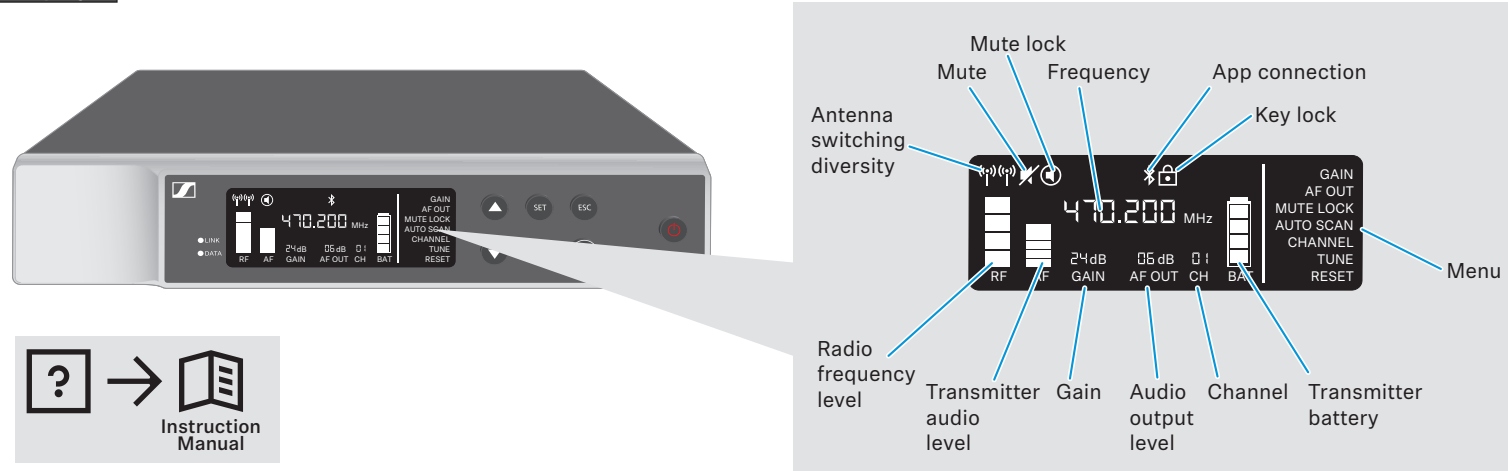

Menu

Gain

AF Out

Mute Lock

Auto Scan

Channel

Tune

Reset

EW-D Smart Assist

Available on the App Store | ANDROID APP ON Google play

Sennheiser Documentation App

Available on the App Store | ANDROID APP ON Google play

LEDs

LINK LED	
	- Link ok - audio active
	- Link ok - audio muted or no capsule on SKM
	- Link ok - audio clip
	- No link
	- Link ok - Low transmitter battery
	- No link - Device switched off

EM

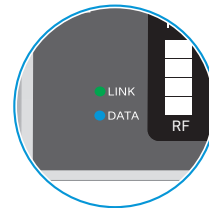

SKM-S

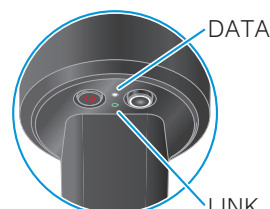

SK

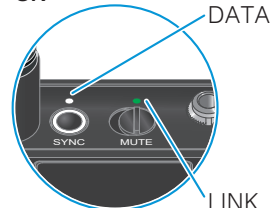

DATA LED	
	Bluetooth active to - sync with transmitter - connect with app
	Firmware update in progress

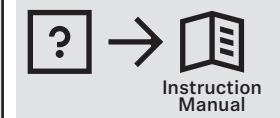

Mute

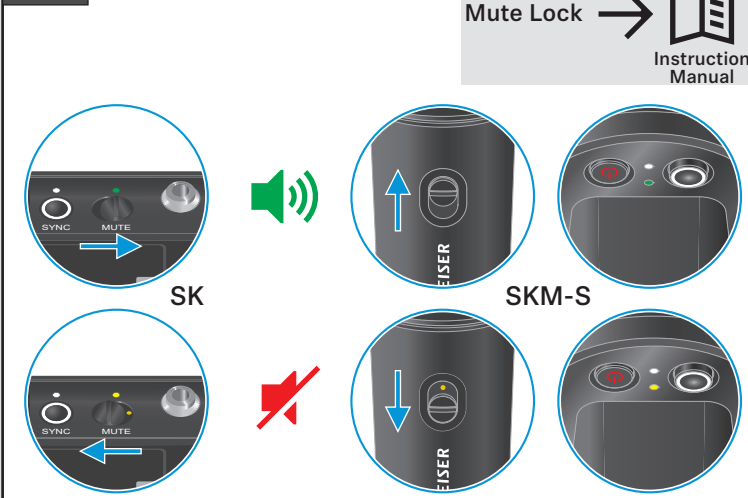

Sync

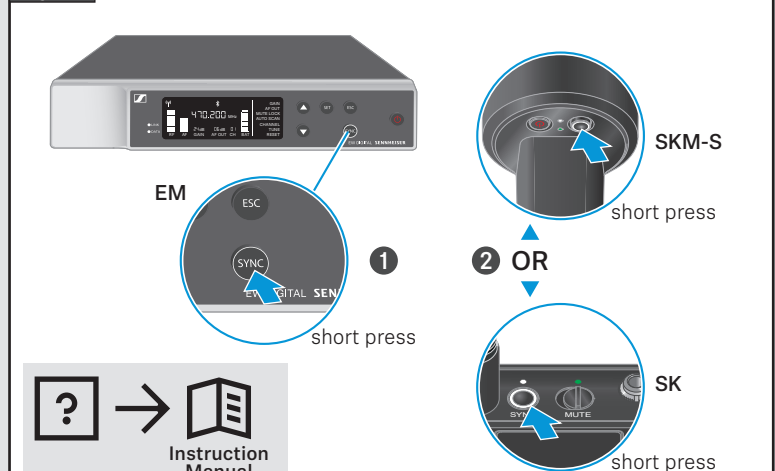

Key lock

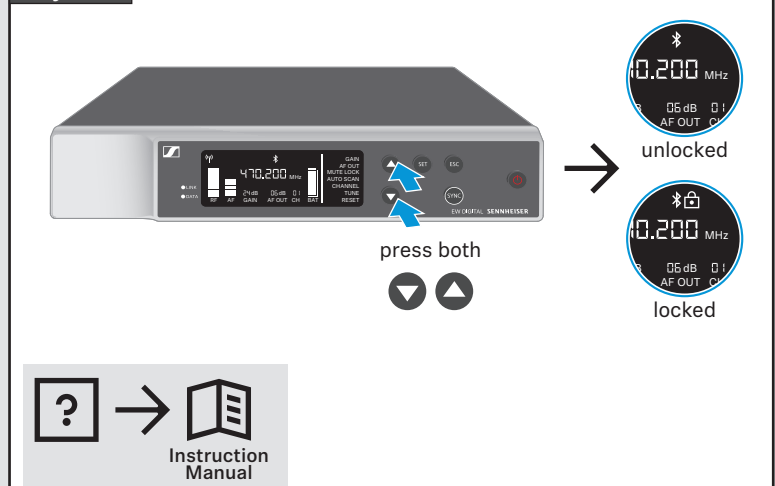

Color coding sets

