

# Contents

Important safety instructions .....	2
The SK 2000 bodypack transmitter .....	3
Areas of application .....	3
The frequency bank system .....	4
Delivery includes .....	5
Product overview .....	6
Overview of the SK 2000 bodypack transmitter .....	6
Overview of the displays .....	7
Putting the bodypack transmitter into operation .....	8
Inserting the batteries/accupack .....	8
Charging the accupack .....	8
Connecting the microphone cable/instrument cable .....	8
Attaching the bodypack transmitter to clothing .....	9
Using the bodypack transmitter .....	11
Switching the bodypack transmitter on/off .....	11
Deactivating the lock mode temporarily .....	12
Muting the audio signal or deactivating the RF signal .....	13
Selecting a standard display .....	15
Using the operating menu .....	16
The buttons .....	16
Overview of the operating menu .....	16
Working with the operating men .....	18
Synchronizing the bodypack transmitter with a receiver .....	20
Cleaning the bodypack transmitter .....	21
If a problem occurs ... ..	21
Specifications .....	23
Manufacturer Declarations .....	25



For more detailed information on the individual sections of this instruction manual, visit the corresponding product page on our website at [www.sennheiser.com](http://www.sennheiser.com).

## Important safety instructions

- Read this instruction manual.
- Keep this instruction manual. Always include this instruction manual when passing the device on to third parties.
- Heed all warnings and follow all instructions.
- Clean the device only with a slightly damp cloth.
- Do not place the device near any heat sources such as radiators, stoves, or other devices (including amplifiers) that produce heat.
- Only use attachments/accessories specified by Sennheiser.
- When replacement parts are required, only use replacement parts specified by Sennheiser or those having the same characteristics as the original part. Unauthorized substitutions may result in fire, electric shock, or other hazards.
- Refer all servicing to qualified service personnel.  
Servicing is required if the device has been damaged in any way, liquid has been spilled, objects have fallen inside, the device has been exposed to rain or moisture, does not operate properly or has been dropped.
- **WARNING:** To reduce the risk of short circuits, do not use the device near water and do not expose it to rain or moisture.

### Intended use

Intended use of the SK 2000 bodypack transmitter includes:

- having read these instructions especially the chapter “Important safety instructions”,
- using the device within the operating conditions and limitations described in this instruction manual.

“Improper use” means using the device other than as described in these instructions, or under operating conditions which differ from those described herein.

## The SK 2000 bodypack transmitter

This bodypack transmitter is part of the 2000 series. With this series, Sennheiser offers high-quality state-of-the-art RF transmission systems with a high level of operational reliability and ease of use. Transmitters and receivers permit wireless transmission with studio-quality sound.



Features of the 2000 series:

- Optimized PLL synthesizer and microprocessor technology
- HDX noise reduction system
- Pilot tone squelch control
- True diversity technology
- Switching bandwidth of up to 75 MHz
- Increased immunity to intermodulation and interferences in multi-channel operation

### Areas of application

The bodypack transmitter can be combined with the EM 2000 or EM 2050 rack-mount receiver. The receivers are available in the same UHF frequency ranges and are equipped with the same frequency bank system with factory-preset frequencies. An advantage of the factory-preset frequencies is that

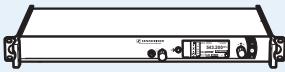





- a transmission system is ready for immediate use after switch-on,
- several transmission systems can be operated simultaneously on the preset frequencies without causing intermodulation interference.

Transmitter	Combinable with	Receivers
SK 2000 	<ul style="list-style-type: none"> <li>• Clip-on microphones: MKE 1, ME 102, ME 104, ME 105*</li> </ul>	EM 2000 receiver 
	<ul style="list-style-type: none"> <li>• Headmics: HSP 2, HSP 4*</li> </ul>	EM 2050 twin receiver 
	<ul style="list-style-type: none"> <li>• Instrument cable: CI 1-4*</li> </ul>	

\* each equipped with a 3-pin special audio connector

## The SK 2000 bodypack transmitter

Overview of the microphones and instrument cables:

Microphone/instrument cable	Type	Pick-up pattern
MKE 1 clip-on microphone	condenser	 omni-directional
ME 102 clip-on microphone		 cardioid
ME 104 clip-on microphone		 cardioid
ME 105 clip-on microphone		 super-cardioid
HSP 2 headmic		 omni-directional
HSP 4 headmic		 cardioid
CI 1-4 instrument cable	–	–

## The frequency bank system

The bodypack transmitter is available in 6 UHF frequency ranges with up to 3,000 transmission frequencies per frequency range:

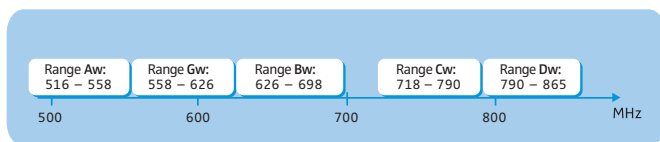

Each frequency range (Aw–Ew, Gw) offers 26 frequency banks with up to 64 channels each:

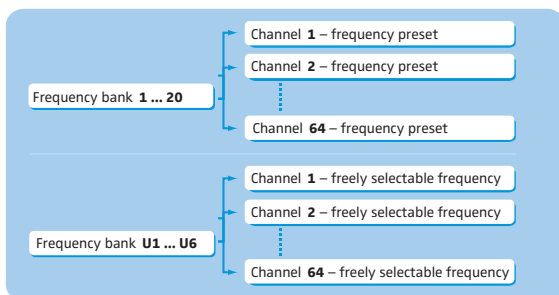

Each of the channels in the frequency banks "1" to "20" has been factory-preset to a fixed transmission frequency (frequency preset). The factory-preset frequencies within one frequency bank are intermodulation-free. These frequencies cannot be changed.

For an overview of the frequency presets, please refer to the supplied frequency information sheet. Updated versions of the frequency information sheet can be downloaded from the corresponding product page on our website at [www.sennheiser.com](http://www.sennheiser.com).

The frequency banks "U1" to "U6" allow you to freely select and store transmission frequencies. It might be that these transmission frequencies are **not** intermodulation-free.

## Delivery includes

The packaging contains the following items:

- 1 SK 2000 bodypack transmitter
- 2 AA size batteries, 1.5 V
- 1 BPP 1 bodypack pouch
- 1 instruction manual
- 1 frequency information sheet
- 1 RF power information sheet

# Product overview

## Overview of the SK 2000 bodypack transmitter

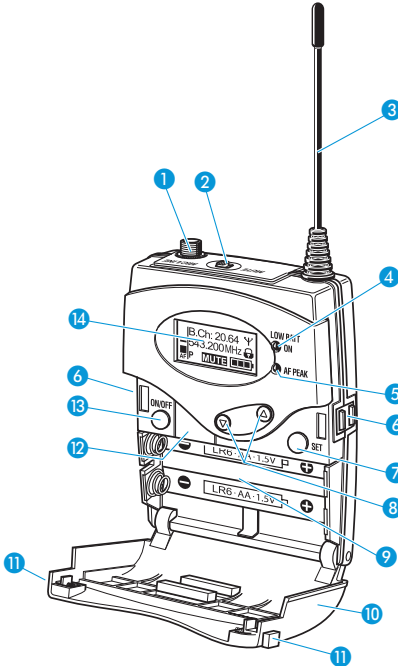



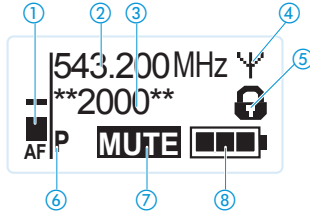

- 1 Microphone/instrument input (MIC/LINE), 3-pole special audio socket, lockable
- 2 MUTE switch
- 3 Antenna
- 4 Operation and battery status indicator, red LED:  
lit = ON  
flashing = LOW BATT
- 5 Audio overmodulation indicator, yellow LED:  
lit = AF PEAK
- 6 Charging contacts
- 7 SET button
- 8 ▲/▼ rocker button (UP/DOWN)
- 9 Battery compartment
- 10 Battery compartment cover (metal)
- 11 Battery compartment catches
- 12 Infra-red interface
- 13 ON/OFF button (serves as the ESC (cancel) key in the operating menu)
- 14 Display panel, backlit in orange

## Overview of the displays

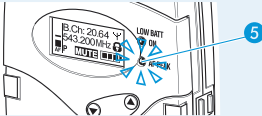
After switch-on, the bodypack transmitter displays the standard display “Frequency/Name”. For further illustrations and examples of the different standard displays, refer to page 15. The display backlighting is automatically reduced after approx. 20 seconds.

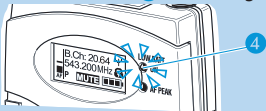

Display	Meaning
① Audio level “AF”	<p>Modulation of the bodypack transmitter</p> <p>When the audio input level is excessively high, the “AF” display shows full deflection and, in addition, the yellow <b>AF PEAK</b> LED ⑤ lights up:</p> 
② Frequency	Current transmission frequency
③ Name	User selectable name
④ Transmission icon	RF signal is being transmitted
⑤ Lock mode icon	Lock mode is activated
⑥ “P” (Pilot)	Pilot tone transmission is activated
⑦ “MUTE”	Microphone or line input is muted
⑧ Battery status	<p>Charge status:</p> <ul style="list-style-type: none"> <li> approx. 100%</li> <li> approx. 70%</li> <li> approx. 30%</li> <li> charge status is critical, the red <b>LOW BATT</b> LED ④ is flashing:</li> </ul> 

## Putting the bodypack transmitter into operation

### Inserting the batteries/accupack

For powering the bodypack transmitter, you can either use two 1.5 V AA size batteries or the rechargeable Sennheiser BA 2015 accupack.

- ▶ Open the battery compartment by pushing the two catches **11** in the direction of the arrows and open the cover **10**.

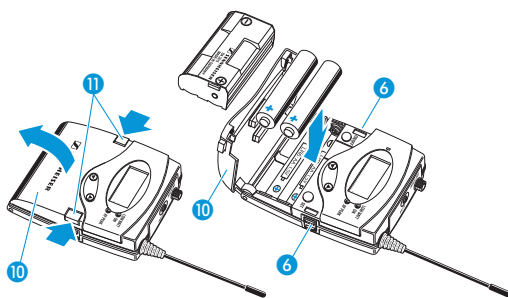

- ▶ Insert the two batteries or the accupack as shown above. Please observe correct polarity when inserting the batteries/accupack.
- ▶ Close the battery compartment. The battery compartment cover **10** locks into place with an audible click.

### Charging the accupack

To charge the bodypack transmitter with the BA 2015 accupack (optional accessory) installed:

- ▶ Insert the bodypack transmitter into the L 2015 charger (optional accessory).



The L 2015 charger can only charge the combination BA 2015 accupack/bodypack transmitter. Standard batteries (primary cells) or individual rechargeable battery cells cannot be charged.

### Connecting the microphone cable/instrument cable

The audio input is designed for the connection of both condenser microphones and instruments (e.g. guitars). DC powering of the condenser microphones is via the audio input **MIC/LINE 1**.



- ▶ Use one of the recommended Sennheiser microphones or the CI 1-4 instrument cable (see page 3).
- ▶ Connect the 3-pin special audio connector **15** from the Sennheiser microphone or instrument cable to the socket **MIC/LINE 1**.

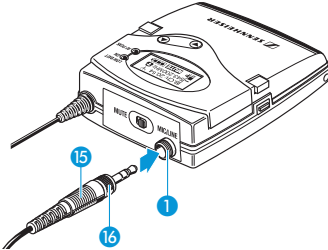

- ▶ Lock the 3-pin special audio connector by screwing down the coupling ring **16** of the cable.
- ▶ Via the operating menu, adjust the sensitivity of the microphone/line input.

## Attaching the bodypack transmitter to clothing

You can use supplied bodypack pouch or the belt clip **18** to attach the bodypack transmitter to clothing (e.g. belt, waistband).

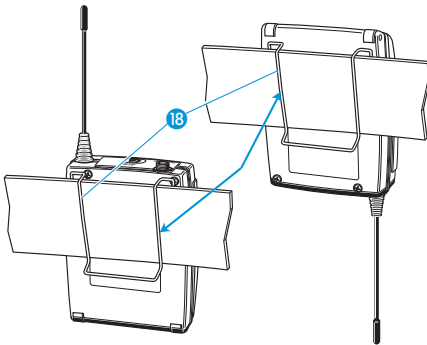

The belt clip is detachable so that you can also attach the transmitter with the antenna pointing downwards. To do so, withdraw the belt clip **18** from its fixing points and attach it the other way round.

The belt clip **18** is secured so that it cannot slide out of its fixing points accidentally.

## Putting the bodypack transmitter into operation

To detach the belt clip:

- ▶ Lift one side of the belt clip as shown.

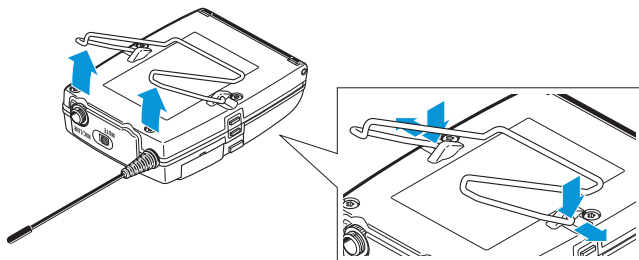

- ▶ Press down the belt clip at one fixing point and pull it out of the transmitter housing.
- ▶ Repeat for the other side.

## Using the bodypack transmitter

To establish a transmission link, proceed as follows:

1. Switch the receiver on (see the instruction manual of the receiver).
2. Switch the bodypack transmitter on (see below).  
The transmission link is established and the display backlighting of the receiver changes from red to orange.

### Switching the bodypack transmitter on/off

- ▶ Push the two battery compartment catches **11** and open the battery compartment cover **10**.

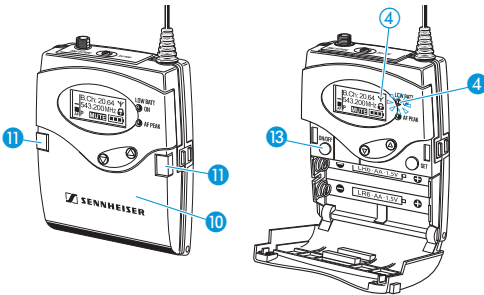

To switch the bodypack transmitter **on** (online operation):

- ON/OFF** ▶ Briefly press the **ON/OFF** button **13**.  
The bodypack transmitter transmits an RF signal. The standard display "**Frequency/Name**" appears on the display panel. The red **ON LED** **4** lights up and the transmission icon **4** is displayed.

To switch the bodypack transmitter **off**:

- ▶ If necessary, deactivate the lock mode (see page 12).
- ON/OFF** ▶ Keep the **ON/OFF** button **13** pressed until "**OFF**" appears on the display panel.  
The red **ON LED** **4** goes off and the display panel turns off.



When in the operating menu, pressing the **ON/OFF** button **13** cancel your entry (ESC function) and return you to the current standard display.

To switch the bodypack transmitter **on** and to **deactivate the RF signal on switch-on** (offline operation):

## Using the bodypack transmitter

**ON/OFF** ▶ Keep the **ON/OFF** button **13** pressed until “RF Mute On?” appears on the display panel.



**SET** ▶ Press the **SET** button.  
The transmission frequency is displayed but the bodypack transmitter does not transmit an RF signal. The transmission icon **4** is not displayed.

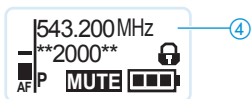

Use this function to save battery power or to prepare a bodypack transmitter for use during live operation without causing interference to existing transmission links.

To **activate** the RF signal:

**ON/OFF** ▶ Press the **ON/OFF** button.  
“RF Mute Off” appears on the display panel.



**SET** ▶ Press the **SET** button.  
The transmission icon **4** is displayed again.



## Deactivating the lock mode temporarily

You can activate or deactivate the automatic lock mode via the “Auto Lock” menu item. If the lock mode is activated, you have to temporarily deactivate it in order to be able to operate the bodypack transmitter:

**SET / ON/OFF** ▶ Press the **SET** button or the **ON/OFF** button.  
“Locked” appears on the display panel.



▼▲ ▶ Press the rocker button.  
“Unlock?” appears on the display panel.

**SET** ▶ Press the **SET** button.

- When you are in the operating menu, the lock mode remains deactivated until you exit the operating menu.
- When one of the standard displays is shown, the lock mode is automatically activated after 10 seconds.



The lock mode icon **5** flashes prior to the lock mode being activated again.



**5**