

MOMENTUM Wireless M2 OEBT



Instruction Manual

Contents

Important safety instructions	2
The MOMENTUM Wireless (M2 OEBT)	4
Package includes	6
Product overview	7
Overview of the headphones	7
Overview of pictograms	7
Overview of LED indicators	9
Overview of buttons	10
Getting started	11
Charging basics	11
Pairing the headphones	13
Adjusting the headband	16
Using the headphones	17
Switching the headphones on	17
Switching the headphones off.....	17
Adjusting the volume	18
Checking the remaining battery life.....	19
Music functions.....	20
Call functions	21
Voice control functions.....	23
Using the audio cable	24
Caring and maintenance	25
Replacing the earpads	25
Storing and handling	26
Updating the software using the Sennheiser Updater	26
Replacing/removing the rechargeable battery	27
Troubleshooting	28
Clearing the paired settings	29
Specifications	30
Manufacturer declarations	31



Important safety instructions

- ▶ Read the instruction manual, safety guide, quick guide (as supplied) carefully and completely before using the product.
- ▶ Always include this safety guide when passing the product on to third parties.
- ▶ Do not use an obviously defective product.

Preventing damage to health and accidents

- ▶ Protect your hearing from high volume levels. Permanent hearing damage may occur when headphones are used at high volume levels for long periods of time. Sennheiser headphones sound exceptionally good at low and medium volume levels.
- ▶ Keep the headphones at least 10 cm/3.94" from cardiac pacemaker or implanted defibrillator. The headphones contain magnets that generate a magnetic field which could cause interference with cardiac pacemaker and implanted defibrillator.
- ▶ Keep the product and its accessories away from small children and pets. The product contains small parts which may cause choking hazards to small children and pets.
- ▶ Do not use the product in situations which require special attention (for example, in traffic or when performing skilled jobs).

Preventing damage to the product and malfunctions

- ▶ Always keep the product dry and do not expose it to extreme temperatures to avoid corrosion or deformation. The normal operating temperature is from 0 to 40°C/32 to 104°F.
- ▶ Use only attachments/accessories/spare parts supplied or recommended by Sennheiser.
- ▶ Clean the product only with a soft, dry cloth.
- ▶ Use only the product in environments where **Bluetooth**® wireless transmission is permitted.
- ▶ Do not wear the headphones during charging because the built-in rechargeable battery can get warm.
- ▶ Use the product with care and store it in a clean, dust-free environment.
- ▶ Do not operate the product near heat sources.

Intended use/Liability



These wireless headphones are designed for use with mobile devices (e. g. mobile music players, smartphones, tablets, laptop computers) that support wireless communication via **Bluetooth**. Compatible **Bluetooth** devices include those that support the following profiles: Hands Free Profile (HFP), Headset Profile (HSP), Advanced Audio Distribution Profile (A2DP), Audio/Video Remote Control Profile (AVRCP), and Device ID profile (DIP).

It is considered improper use when this product is used for any application not named in the associated instruction manuals and product guides.

Sennheiser does not accept liability for damage arising from abuse or misuse of this product and its attachments/accessories.

Safety instructions for the Lithium-Polymer battery pack

WARNING

In extreme cases, abuse or misuse of Lithium-Polymer battery pack can lead to:



- explosion,
- fire development,
- heat generation or
- smoke or gas development.

	Dispose of products with built-in rechargeable batteries at special collection points or return them to your specialist dealer.
	Use only rechargeable batteries and chargers recommended by Sennheiser.
	Charge products with built-in rechargeable batteries at ambient temperatures between 10 and 40°C (+/-5°C) / 50 and 104°F (+/-41°F).
	Switch battery-powered products off after use.
	When not using the product for an extended period of time, charge them regularly (about every 3 months).
	Do not expose to heat above 70°C/158°F, e.g. do not expose to sunlight or throw into fire.
	Do not charge products with built-in rechargeable batteries if the product is obviously defective.

The MOMENTUM Wireless (M2 OEBT)

Proudly leading the way into the next generation of Sennheiser's highly regarded MOMENTUM line, the M2 OEBT brings you freedom of movement and total purity of sound. **Bluetooth®** wireless technology makes a cable unnecessary, and thanks to Sennheiser's innovative **NoiseGard™** Hybrid active noise cancellation technology, you'll be able to enjoy your favorite music on the go with minimal ambient noise.

A technological masterpiece in a stunning package, the M2 OEBT sports an elegant stainless steel construction and luxurious Alcantara® padding, fully in keeping with the exacting aesthetic principles of the MOMENTUM line while the foldable headband adds a new level of comfort and convenience to your listening experience. Sennheiser's M2 OEBT – liberation for sound and body.

Features

- Closed supra-aural design featuring **Bluetooth®** wireless technology
- Soft, durable Alcantara® for a sensuous and functional wearing experience
- Amazing stereo sound across the audible range thanks to Sennheiser's 18 Ω high-end transducers
- Robust, foldable headband for easy storage on the go
- **NoiseGard™** Hybrid active noise cancellation for optimum isolation from background noise and outstanding audio performance
- Immediate pairing to smart devices using NFC connectivity
- VoiceMax™ technology utilizing two built-in microphones for voice communication to emphasize speech quality and remove external noise
- 22 hours of battery life span with both **Bluetooth®** and **NoiseGard™** activated
- Comes with an attachable audio cable for use in environments where **Bluetooth®** connectivity is not permitted

Bluetooth



The MOMENTUM Wireless (M2 OEBT) headphones comply with the **Bluetooth** technology 4.0 standard and are compatible with all **Bluetooth** 1.1, 1.2, 2.0, 2.1, and 4.0 devices with the following profiles:

- **Headset Profile (HSP) 1.2** - The profile that provides the basic functionalities used by the headphones to interact with a **Bluetooth** smartphone.
- **Hands-Free Profile (HFP) 1.6** - A profile used by the headphones to interact with a **Bluetooth** smartphone. This profile provides extra functionalities as compared to the HSP. If a function, such as voice control, is not supported by the HSP profile, the HFP takes place.
- **Audio/Video Remote Control Profile (AVRCP) 1.5** - The profile used to control music on the **Bluetooth** device from the headphones (Play, pause, skip music track, etc.).
- **Advanced Audio Distribution Profile (A2DP) 1.3, supporting aptX®** - The profile used by a **Bluetooth** device to stream high-quality stereo music to the headphones.
- **Device ID Profile (DIP) 1.3** - The profile used by the headphones to be identified, such as by its manufacturer, product ID, product version, etc.

NFC



Near Field Communication (NFC) is a short-range wireless technology that enables connection and communication between NFC-capable electronic devices by placing them near one another or with a single touch.

VoiceMax



VoiceMax™ dual microphone technology filters away the background noise. 2 microphones work in synergy; one to emphasize your voice, and the other to remove the ambient noise.

NoiseGard



The NoiseGard™ hybrid Active Noise Cancellation system is a combination of 2 noise-cancellation systems composed of a total of 4 microphones. Two microphones with openings to the outside of the headphones work as a Feed-Forward active noise cancellation system that reduces noise at the high frequency band, while the other two microphones inside the headphones work as a Feed-Back active noise cancellation system that reduces noise at the low frequencies. The combination of these 2 microphone systems results in a broad reduction in noise covering a wider band of frequencies.

aptX®



With aptX® audio coding, you can be assured of crisp, pure and full stereo sound. It allows you to not only hear, but experience and feel the audio as it was intended. Utilizing aptX®, **Bluetooth** technology can now offer wireless audio quality that is indistinguishable from the highest quality wired connection.

Package includes



Headphones



Carry case



Soft carry case



Audio cable with 2.5-mm and 3.5-mm jack



USB cable with micro USB connector



In-flight adapter



Quick start guide



Safety guide

i A list of accessories can be found at www.sennheiser.com. For information, contact your local Sennheiser partner: www.sennheiser.com> "Sales Partner".

Product overview

Overview of the headphones



- ① Headband
- ② Earpads
- ③ Earcups
- ④ Microphone
- ⑤ NFC Antenna
- ⑥ LED indicator
- ⑦ Power button
- ⑧ 3-way multifunction button
- ⑨ Audio input
- ⑩ Micro USB input

Overview of pictograms

Pictograms for using buttons

Pictogram	Meaning
	Press and immediately release the button
	Press the button twice
	Press the button and hold for 5 seconds

Pictograms for LED indicators

Pictogram	Meaning
	LED shines
	Time interval or interruption. Causes LED to flash
	Continuous shine/flash
	Time interval of flashing

Examples of pictographs used in this manual:

Pictogram	Meaning
	The LED continuously flashes on and off
	The LED continuously flashes once every 3 seconds
	The LED continuously shines
	The LED flashes thrice per second

The icon with „i”

Notes marked with the pictogram “i” provide useful information on the use of the headphones.

Overview of LED indicators



LED indicators when operating

Indicator	Meaning
	Headphones are switching on Pairing with a device is successful
	Headphones are switching off
	Headphones are in pairing mode
	Headphones are disconnected from the device
	Headphones, with an almost empty battery, are disconnected from the device
	Pair settings on the headphones are cleared

LED indicators when making a call

Indicator	Meaning
	Incoming call
	Incoming call with an almost empty battery

Overview of buttons

Power button

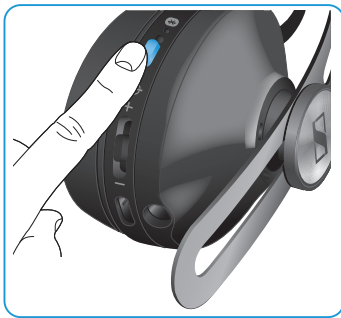

Press	Function	Page
	Switches the headphones on and off	17

3-way multifunction button

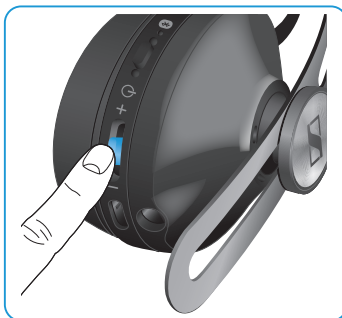

Press	Function	Page
	Accepts/ends a call	21
	Accepts an incoming call and ends the active call	21
	Plays/pauses a song	20
	Rejects a call	21
	Activates the voice control	23
	Transfers a call	22
	Plays the next song	20
	Accepts an incoming call and puts the active call on hold/Toggles between 2 calls	21
	Checks the battery life	19
	Plays the previous song	20
	Rewinds a song	20
	Fast-forwards a song	20

Getting started

Charging basics



A complete charging cycle takes about 3 hours. Before using the headphones for the first time, charge the headphones for a complete charging cycle without interruption.

When the battery is almost empty or when you are charging the headphones, the LED emits a signal and a voice message prompts you of the charge condition of the battery. When the battery life drops to a low level, a voice message prompts you to recharge the headphones to avoid call and music disruptions.

It is recommended to charge the headphones using only the supplied USB cable and a USB power adaptor with a rated output of 500 mA or higher.

LED	Meaning	Voice prompt
	Battery is almost empty (less than 2%)	„Recharge headset“ „Power off“
	Battery is less than 15% charged	„Below 3 hours play time“
	Battery is less than 25% charged	„Between 3 and 5 hours play time“
	Battery is less than 50% charged	„Between 5 and 11 hours play time“
	Battery is less than 80% charged	„Between 11 and 18 hours play time“
	Battery is more than 80% charged	„Between 18 and 22 hours play time“
	Battery is fully charged	„Between 18 and 22 hours play time“

Charging the headphones

1. Connect the micro USB plug of the charging cable to the micro USB input of your headphones.
2. Connect the USB plug to a power adaptor (not included) or to the USB car charger adaptor (not included), and connect to the power source. If you are using a computer, connect the USB plug to the USB port.
The LED flashes/shines depending on the battery condition of the headphones, as provided in the table above.



i When you connect the headphones to a computer using the USB cable, it will automatically switch off. Switch the headphones on, see page 17, to continue to listen to music or make calls from your smartphone via **Bluetooth** wireless connection.

You can also use the cable to listen to a media player on your computer. If you are connecting to a computer for the first time, you may need to set your M2 OEBT headphones as the default speaker from the Sound control panel of your computer.

Pairing the headphones

AUTION

Danger of malfunction!



The transmitted radio waves of mobile phones can impair the operation of sensitive and unprotected devices.

- ▶ Make calls on the headphones only in locations where **Bluetooth** wireless transmission is permitted.

To pair your headphones with a **Bluetooth** device you can either use the Near Field Communication (NFC) or the **Bluetooth** search function. To connect the headphones, **Bluetooth** needs to be activated in both cases of pairing.

The M2 OEBT headphones comply with the **Bluetooth** 4.0 standard. In order for the data to be transmitted wirelessly using **Bluetooth** technology, you need to pair your headphones to compatible **Bluetooth** devices that support the following profiles:

- ▶ Hands Free Profile (HFP)
- ▶ Headset Profile (HSP)
- ▶ Audio/Video Remote Control Profile (AVRCP)
- ▶ Advanced Audio Distribution Profile (A2DP)
- ▶ Device ID Profile (DIP)

When you switch the headphones on, it automatically tries to connect to the last two connected **Bluetooth** devices. The headphones can save the connection profiles of up to eight **Bluetooth** devices with which it had been paired.

If you pair the headphones to a ninth **Bluetooth** device, the saved connection profile of the least used **Bluetooth** device will be overwritten. If you want to re-establish a connection with the overwritten **Bluetooth** device, you have to pair it back to the headphones again.

You can easily pair and connect your wireless headphones to your smartphone if the device supports the Near Field Communication (NFC) technology.



The following sections describe, using a smartphone as an example, how to pair your M2 OEBT headphones to an NFC or **Bluetooth** device. If the instructions provided do not work on your smartphone, please proceed as described in the instruction manual of your device.

Pairing the headphones to an NFC device

1. Switch the NFC function on from your smartphone.
2. Place your smartphone close, about less than 3 cm, to the NFC antenna on the left earcup of the headphones.
You hear the voice prompts „power on“ and „pairing“ and the LED flashes blue and red.
3. Depending on your smartphone, click „Yes“ if a verification to pair to the headphones appears on the screen.
If the pairing is successful, you hear the voice prompt „connected“ and the LED switches off.

