



URBANITE XL Wireless

Bluetooth headset

Instruction manual

 **SENNHEISER**

Contents

- Important safety instructions 2**
- Introduction..... 3**
- Package contents..... 4**
- Product overview..... 5**
 - Overview of the headset 5
 - Overview of the remote control..... 5
 - Overview of pictograms 6
 - Overview of the LED indications 6
 - Overview of buttons 7
- Getting started 8**
 - Charging the headset battery..... 8
 - Pairing the headset..... 9
- Using the headset..... 12**
 - Individually adjusting the headset 12
 - Switching the headset on and connecting it 12
 - Switching the headset off 12
 - Changing the volume..... 13
 - Listening to music using the headset 13
 - Making calls using the headset 14
 - Managing two calls 15
 - Using the audio cable 16
 - Storing and transporting the headset 17
 - If you are out of the Bluetooth transmission range 17
- Cleaning and maintaining the headset 18**
 - Replacing the ear pads 18
- If a problem occurs ... 19**
- Specifications 20**
- Valuable information – aptX audio coding 21**
- Manufacturer Declarations 22**



Important safety instructions

- ▶ Please read this instruction manual carefully and completely before using the product.
- ▶ Always include this instruction manual when passing the product on to third parties.
- ▶ Do not use an obviously defective product.

Preventing damage to health and accidents

- ▶ Do not listen at high volume levels for long periods of time to prevent hearing damage.
- ▶ Always maintain a distance of at least 3.94" (10 cm) between the ear cups and the cardiac pacemaker or implanted defibrillator since the product generates permanent magnetic fields.
- ▶ Keep the product, accessories and packaging parts out of reach of children and pets to prevent accidents and choking hazards.
- ▶ Do not use the product in situations which require special attention.

Preventing damage to the product and malfunctions

- ▶ Always keep the product dry and do not expose it to extreme temperatures (hairdryer, heater, extended exposure to sunlight, etc.) to avoid corrosion or deformation.
- ▶ Only use attachments/accessories supplied or recommended by Sennheiser.
- ▶ Only clean the product with a soft, dry cloth.
- ▶ Only use the product in environments where wireless **Bluetooth**® transmission is permitted.

Intended use/Liability

The URBANITE XL WIRELESS is designed for use with mobile phones, tablets pcs and computers and other **Bluetooth** devices. The **Bluetooth** technologies "hands free profile" (HFP), "headset profile" (HSP) and "advanced audio distribution profile" (A2DP) support the wireless communication.

It is considered improper use when this product is used for any application not named in this instruction manual.

Sennheiser does not accept liability for damage arising from abuse or misuse of this product and its attachments/accessories. The risk is to be borne by the user.

Sennheiser is not liable for damages to USB devices that are not consistent with the USB specifications.

Sennheiser is not liable for damages resulting from the loss of connection due to flat or overaged rechargeable batteries or exceeding the **Bluetooth** transmission range.

Safety instructions for rechargeable batteries

WARNING

In extreme cases, abuse or misuse of rechargeable batteries can lead to:

- explosion,
- fire development,
- heat generation or
- smoke or gas development.

	Switch rechargeable battery-powered products off after use.
	Only charge rechargeable batteries at ambient temperatures between 10°C/50°F and 40°C/104°F.
	When not using rechargeable batteries for extended periods of time, charge them regularly (about every 3 months).
	Do not heat above 70°C/158°F, e.g. do not expose to sunlight or throw into a fire.
	Dispose of defective products with built-in rechargeable batteries at special collection points or return them to your specialist dealer.
	Only use rechargeable batteries recommended by Sennheiser and the appropriate chargers.

Introduction

This comfortable **Bluetooth** headset is the perfect wireless solution for music listening and phone calls with superb sound quality. The noise cancelling microphone integrated into the headset filters away background noise, thus providing ultimate speech intelligibility.

Additional features of the Bluetooth headset

- Great for travel: comfortable, rugged and foldable headset construction
- Optional connection via audio cable for music enjoyment without **Bluetooth** technology
- Outstanding sound quality due to Duofol diaphragms
- Ultra noise-canceling microphone – for perfect speech transmission
- Large leatherette ear pads – for exceptional wearing comfort and powerful sound
- Sound-enhancement profile – for multimedia and music listening purpose
- Long talk time – talk to business partners and friends for up to 15 hours, with up to 19 days of standby time
- Voice prompts for status – the user is always updated
- Headset battery level indicator displayed on Apple iPhone® screen

Bluetooth

The headset complies with the **Bluetooth** 4.0 standard and is compatible with all **Bluetooth** 1.1, 1.2, 2.0, 2.1, 3.0 and 4.0 devices with a “hands free profile” (HFP), a “headset profile” (HSP) or an “advanced audio distribution profile” (A2DP). The headset provides wireless freedom to give hands-free convenience with your mobile phone or while listening to music.



NFC

Near Field Communication (NFC) is a short-range wireless technology that enables the communication between devices over a distance of less than 10 cm.



aptX

With aptX audio coding, you can be assured of crisp, pure and full stereo sound. It allows you to not only hear, but experience and feel the audio as it was intended. Utilizing aptX, **Bluetooth** technology can now offer wireless audio quality that is indistinguishable from the highest quality wired connection.



From major public broadcasters to film production studios, aptX is used throughout the world to transmit high quality digital audio from A to Z in real-time. It was developed to meet the exacting standards of musicians and audio engineers who love the exceptional dynamic range and high fidelity it provides.

Now available on selected consumer devices, the aptX technology ensures that music lovers everywhere can stream the rich listening experience that only aptX can deliver.

Package contents



Headset



USB charging cable



Universal audio cable with remote control,
2.5-mm and 3.5-mm jack plug



Carry bag



Quick Guide



Safety Guide



A list of accessories can be found at www.sennheiser.com. For information, contact your local Sennheiser partner: www.sennheiser.com> "Sales Partner".

Product overview

Overview of the headset

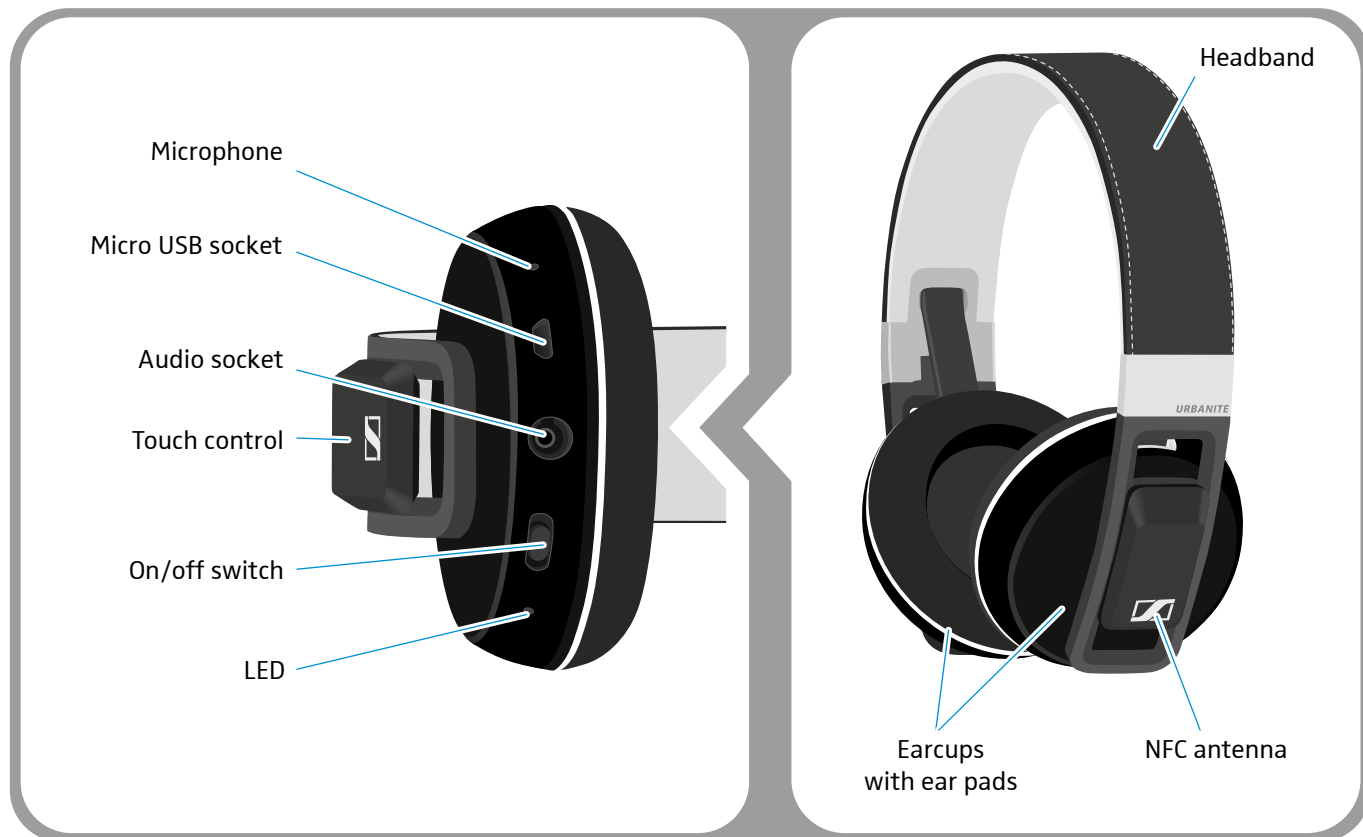



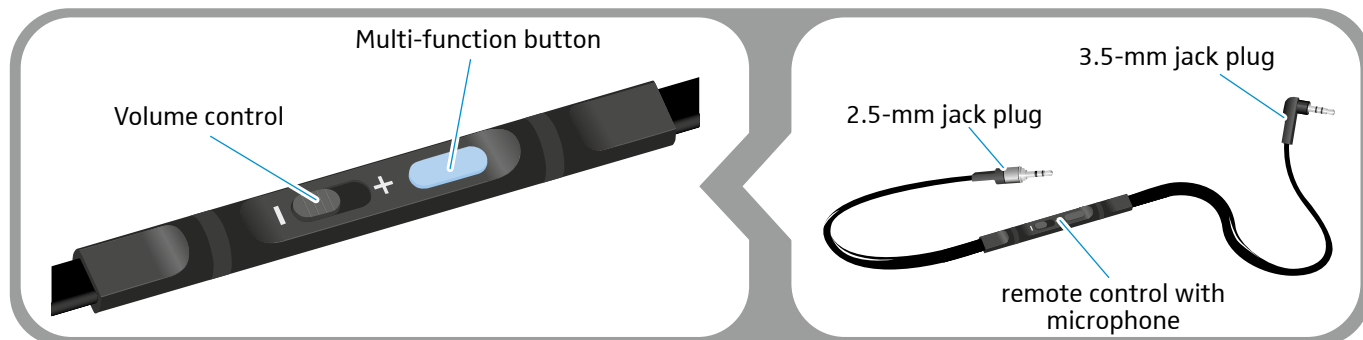

Overview of the remote control







Overview of pictograms

Meaning of the pictograms for pressing a button

Pictogram	Meaning	Pictogram	Meaning
	Briefly press this button.		Keep this button pressed for 5 seconds.
	Double-press this button.		Touch the touch control.

Meaning of the pictograms for the flashing of the LED





Pictogram	Meaning	Pictogram	Meaning
	The LED flashes.		The LED flashes 3 times.
	The LED lights up.		The LED alternately flashes blue/red.

The pictogram “i”



 Notes marked with the pictogram “i” provide important information on the use of the product.

Overview of the LED indications

Meaning during operation

LED	Meaning
	Headset switches on
	Headset is connected to a Bluetooth device
	Headset switches off
	Headset is in pairing mode





Meaning during calls

LED	Meaning
	Incoming call
	Incoming call + rechargeable battery is weak

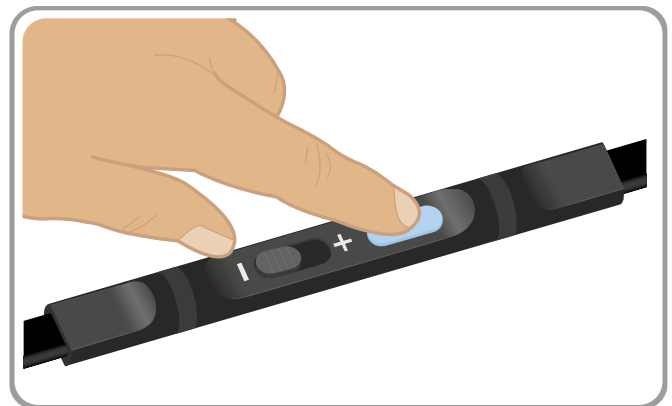
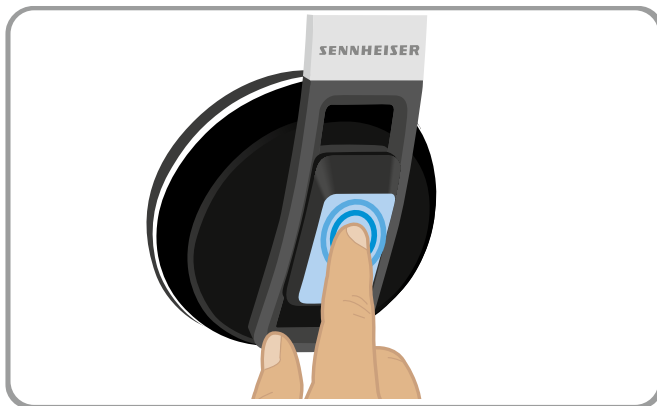
Overview of buttons

Touch control/Multi-function button



Touch/press the button	Function	Page
	Accepts/ends a call	14
	Plays/pauses the track	13
	Accepts the incoming call and ends the active call	15
	Rejects a call	14
	Transfers a call: <ul style="list-style-type: none"> - from the headset to the Bluetooth device - from the Bluetooth device to the headset 	15
	Puts an active call on hold (pause)	14
	2 calls: Accepts the incoming call and puts an active call on hold	15
	2 calls on one mobile phone: Establishes a conference call	15
	Redials the last number/ Cancels redialing	16
	Skips to the next track	13
	press 2x + hold: Fast-forwards the track*	13
	Skips to the previous track	13
	press 3x + hold: Rewinds the track*	13

* These functions are not supported by all connected Bluetooth devices.

On/off switch

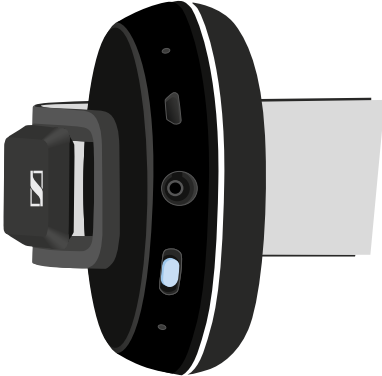



Switches the headset off (see page 12)



Switches the headset on (see page 12)



Pairs the headset with a **Bluetooth** device (see page 9)

Getting started

Charging the headset battery

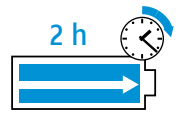

A complete charging cycle takes about 2 hours.

- ▶ Before using the headset for the first time, charge the rechargeable battery for a complete charging cycle without interruption.

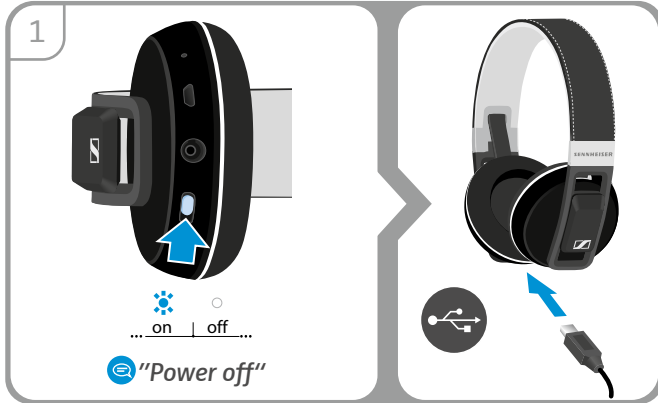

- ▶ Take off the headset and switch it off.
- ▶ Connect the micro USB plug of the charging cable to the USB socket of your headset.

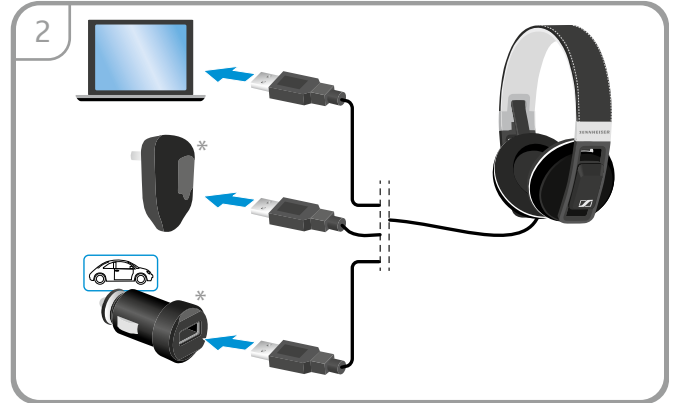

- ▶ Connect the USB plug to the USB socket of your computer or to the corresponding charging accessory (*) and the power source.

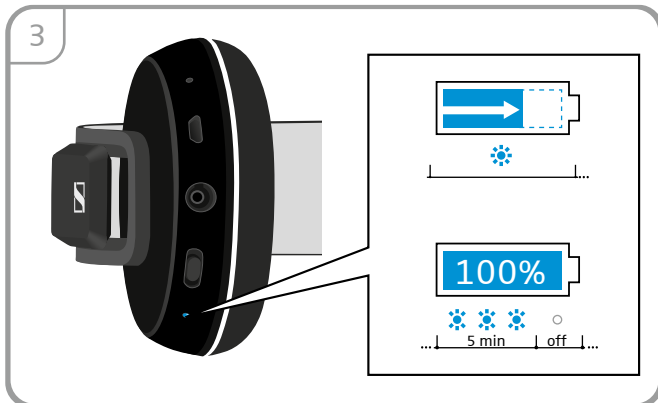

The battery is being charged. The LED lights up. If the battery is fully charged the LED flashes for 5 minutes and then turns off.

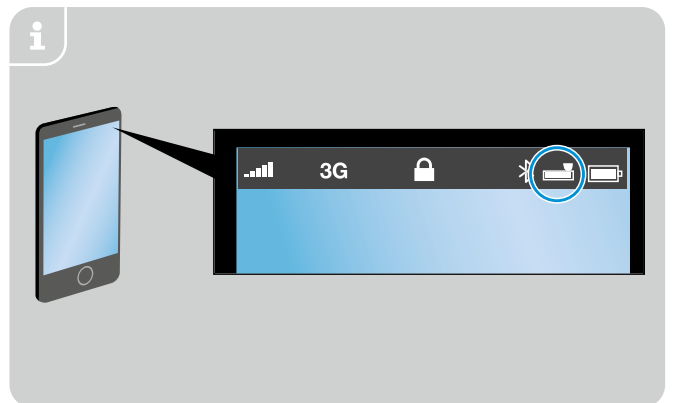

When the headset is paired with an iPhone, the iPhone screen shows an additional battery level indicator for the headset.

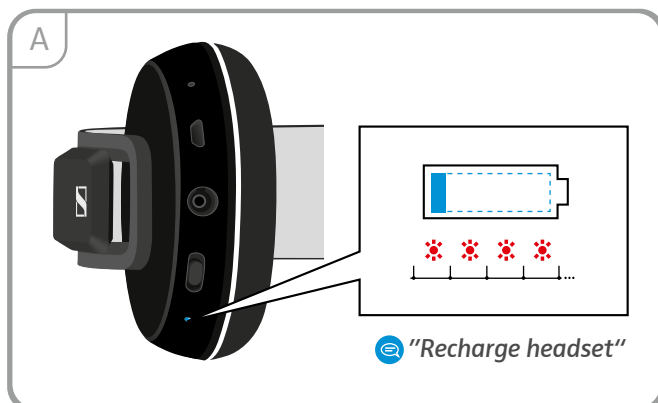

When the battery is almost empty the LED flashes red and the voice prompt "recharge headset" is announced. When the battery is flat, the headset switches off automatically.

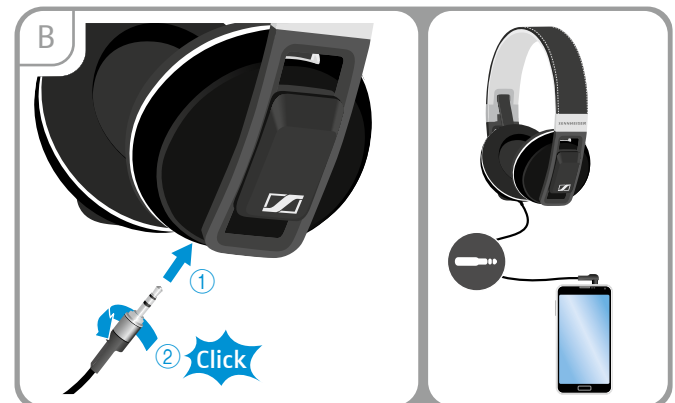

- ▶ Use the audio cable to listen to music or making calls in this case.

Pairing the headset

CAUTION

Danger of malfunction!

The transmitted radio waves of mobile phones can impair the operation of sensitive and unprotected devices.

- ▶ Only make calls with the headset in locations where wireless **Bluetooth** transmission is permitted.



To pair your headset with a **Bluetooth** device you can either use the near field communication (NFC) or the **Bluetooth** search function. To connect the headset **Bluetooth** needs to be activated in both cases.

The headset complies with the **Bluetooth** 4.0 standard. In order that data can be transmitted wirelessly, you have to pair your headset with **Bluetooth** devices that support the "hands free profile" (HFP), the "headset profile" (HSP) or the "advanced audio distribution profile" (A2DP).

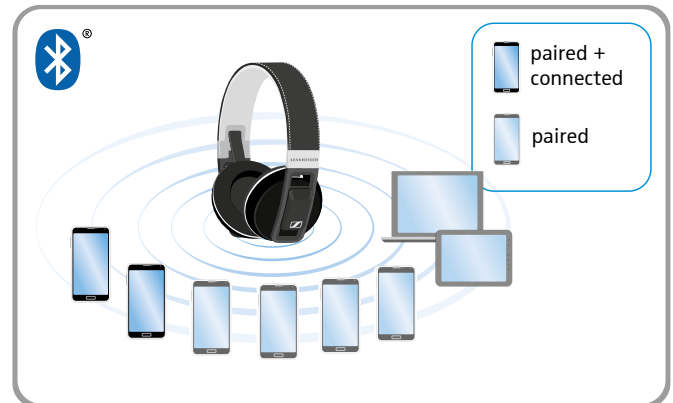

The headset can save up to eight **Bluetooth** devices with which it has been paired. After switch-on, the headset automatically tries to connect to the two last connected **Bluetooth** devices. You can only connect a third **Bluetooth** device after having switched off the first or the second **Bluetooth** device.

If you pair the headset with a ninth **Bluetooth** device, the saved connection profile of the least used **Bluetooth** device will be overwritten. If you want to re-establish a connection with this **Bluetooth** device, you have to pair the headset again.

Pairing the headset via Near field communication (NFC)

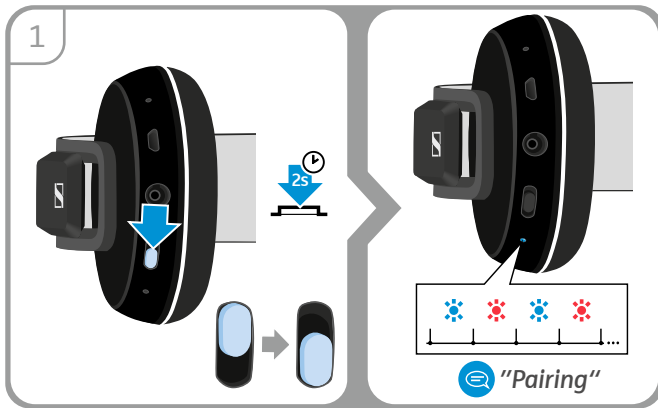

- ▶ Keep the multi-function button pressed until the LED alternately flashes blue and red. The multi-function button automatically returns to the position ON. The headset is in pairing mode. The voice prompt "Pairing" is announced.

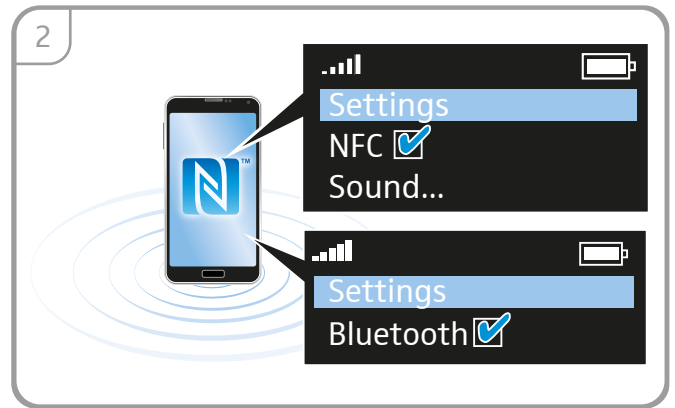

- ▶ Activate the near field communication and Bluetooth on your Bluetooth device.

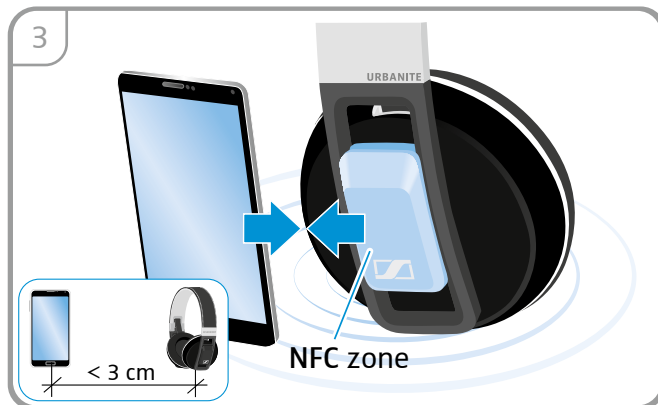

- ▶ Hold the Bluetooth device closely to the left ear cup.



- Once the headset is paired with the Bluetooth device, the LED lights up blue. The voice prompt "Connected" is announced.

Pairing the headset with a Bluetooth device

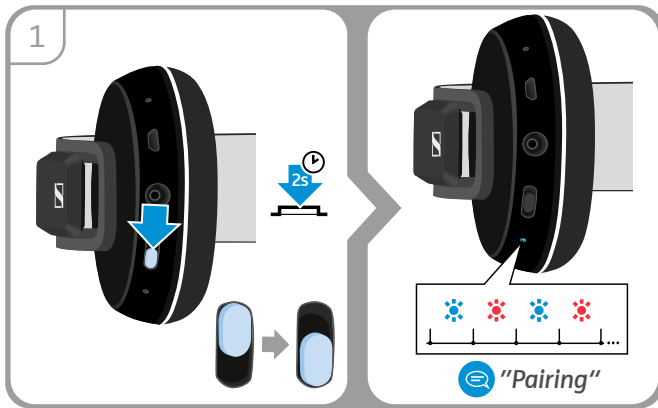

- ▶ Keep the multi-function button pressed until the LED alternately flashes blue and red. The multi-function button automatically returns to the position ON. The headset is in pairing mode. The voice prompt "Pairing" is announced.

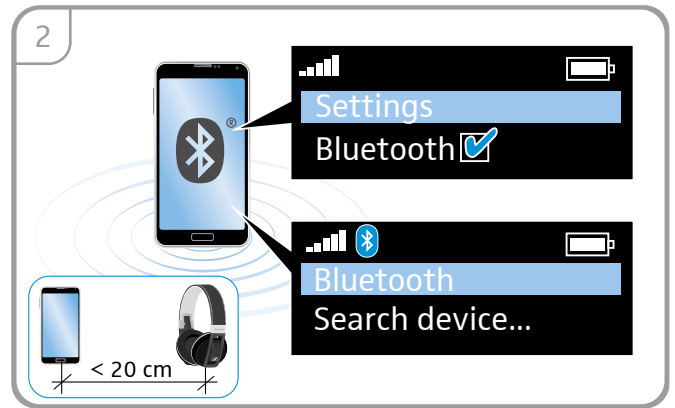

- ▶ Activate **Bluetooth** on your **Bluetooth** device.
- ▶ Start the search for new **Bluetooth** devices. All available devices in the proximity of the **Bluetooth** device are displayed.

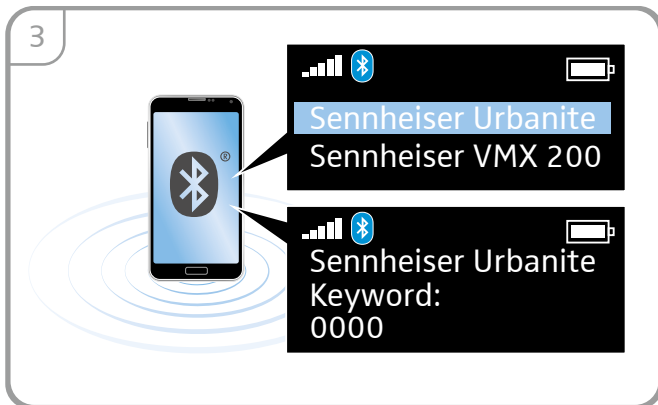

- ▶ Select "Sennheiser Urbanite" to pair the headset with the **Bluetooth** device. If necessary, enter the default PIN code "0000".



- Once the headset is paired with the **Bluetooth** device, the LED lights up blue. The voice prompt "Connected" is announced.

If pairing is not successful within 5 minutes, the headset automatically returns to connectable mode. Repeat the pairing procedure.

Using the headset

Individually adjusting the headset

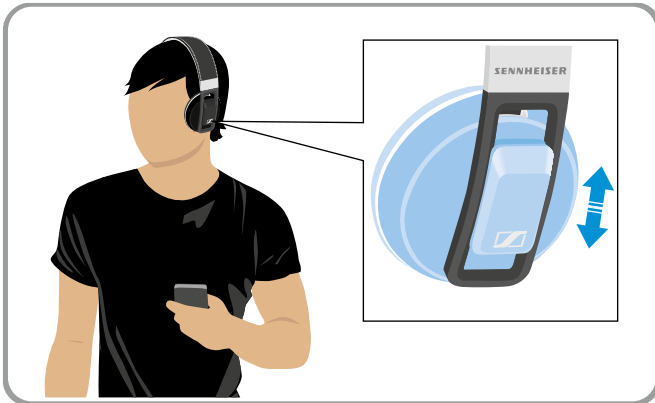

For good sound quality and the best possible comfort, you can adjust the headset to properly fit your head.

- ▶ Wear the headset so that the headband runs over the top of your head.
- ▶ Adjust the headset so that
 - the ear pads rest comfortably against the ears,
 - you feel even, gentle pressure around your ears,
 - a snug fit of the headband on the head is ensured.

Switching the headset on and connecting it

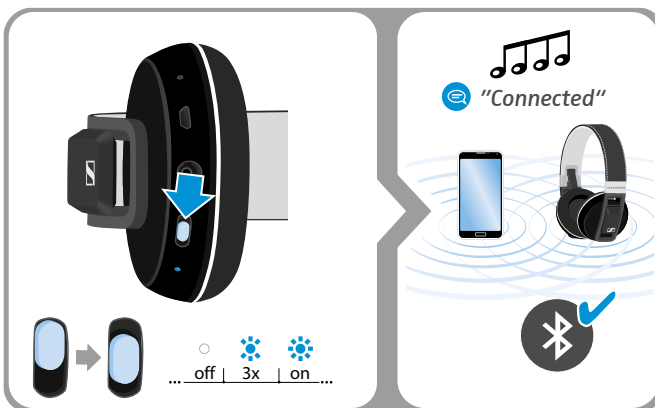

- ▶ Activate **Bluetooth** on your mobile device.
- ▶ Move the on/off switch to the position **ON**.
The headset switches on. You hear an ascending sequence of beeps.

The LED flashes blue until the headset finds a paired **Bluetooth** device to connect to.

Once the connection is successfully established, the voice prompt "Connected" is announced in the headset.

Switching the headset off

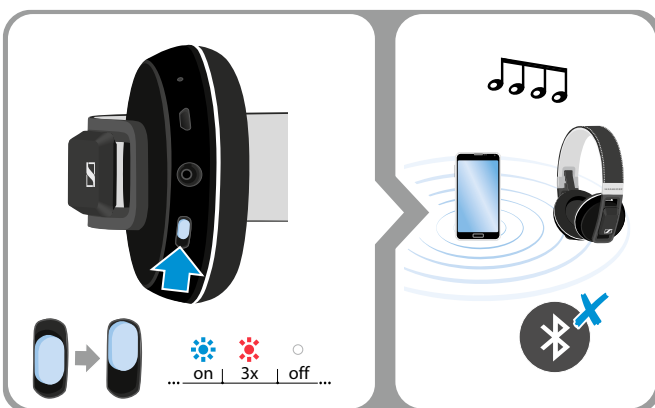

- ▶ Move the on/off switch to the position **OFF**.
The LED flashes 3 times red. You hear a descending sequence of beeps. The headset switches off.

If the headset has not been used for more than 30 minutes and no devices are connected, the headset automatically switches off to conserve battery power.

Changing the volume

CAUTION  **Hearing damage due to high volumes!**

Listening at high volume levels for long periods can lead to permanent hearing defects.

- ▶ Set the volume to a low level before putting on the headset.
- ▶ Do not continuously expose yourself to high volumes.

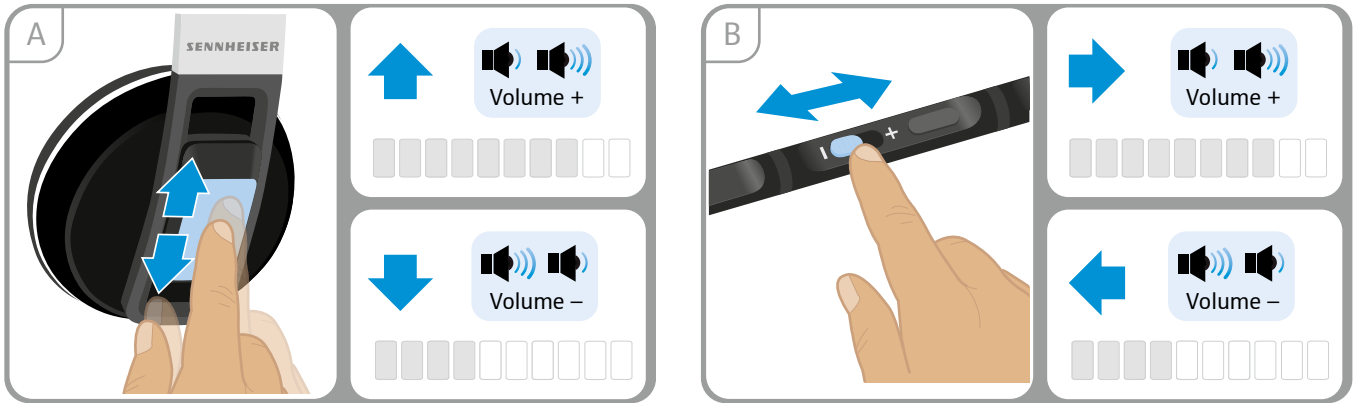







- ▶ Touch the headset's touch control. Slide your finger:
 - upwards, to increase the volume or
 - downwards, to decrease the volume.
- ▶ Move the remote's volume control in the direction:
 - +, to increase the volume or
 - -, to decrease the volume.

When the minimum or maximum volume is reached, you hear a beep in the headset.

Listening to music using the headset

You can listen to music either wireless via **Bluetooth** or via the audio cable.

- ▶ Touch the headset's touch control or press the remote's multi-function button:

		Plays the track
		Pauses the track (acknowledgement tone)
		Skips to the next track
		Skips to the previous track
	 +  HOLD	Fast-forwards the track*
	 +  HOLD	Rewinds the track*

Making calls using the headset

You can making calls either wireless via **Bluetooth** or via the audio cable.

Making a call

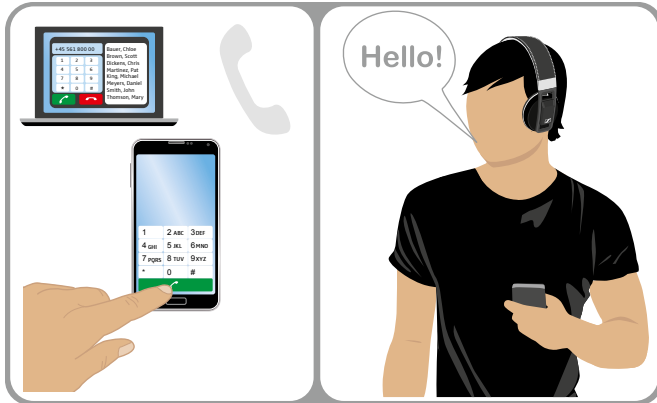

- ▶ Dial the desired number on your mobile phone, smartphone or softphone.
You hear a beep in the headset.

If your mobile phone does not automatically transfer the call to the headset:

- ▶ Touch the touch control on the headset or press a corresponding button on your mobile phone (see the instruction manual of your mobile phone).

Accepting/rejecting/ending a call

When you receive a call, you hear a ring tone in the headset and the LED flashes blue. If the headset battery is low, the LED flashes red.

- ▶ Touch the headset's touch control or press the remote's multi-function button:

 A diagram showing the headset's touch control and a legend for call actions. The top part shows a hand touching the headset's touch control. The bottom part shows a hand touching a button on a remote control. The legend on the right lists four actions:

- Accepts a call (represented by a blue phone icon and a downward arrow)
- Rejects a call (represented by a blue phone icon with a red 'X', a 2s timer, and a speech bubble saying "Call rejected")
- Ends a call (represented by a blue phone icon and a downward arrow with a speech bubble saying "Call ended")
- Puts an active call on hold (pause) (represented by a blue phone icon with a pause symbol and a 2x timer)

To accept a call when the **headset is switched off**:

- ▶ Simply switch your headset on.

i When you listen to music, the music is paused until you end the call. This function is not supported by all mobile phones.

Transferring the call to/from the headset

Once a connection is established, you can transfer the call to/from the headset.

▶ Touch the touch control:

		Transfers a call from the headset to the mobile phone	
		Transfers a call from the mobile phone to the headset	

Managing two calls

You can manage two calls:

- from either two different **Bluetooth** devices or
- from one **Bluetooth** device.

If you receive a call during an active call:

▶ Touch the touch control:

Active call	2nd incoming call				Accepts the incoming call and ends the active call
					Accepts the incoming call and puts an active call on hold (toggling – phone dependent)

If you put an active call on hold (toggling):

▶ Touch the touch control again:

Active call	2nd incoming call				Ends the active call and makes the call on hold active (phone dependent)
					Establishes a conference call (for 2 calls on one mobile phone only)

Redialing

The redialing function is only supported by Bluetooth devices with a "hands free profile" (HFP).

▶ Touch the touch control:

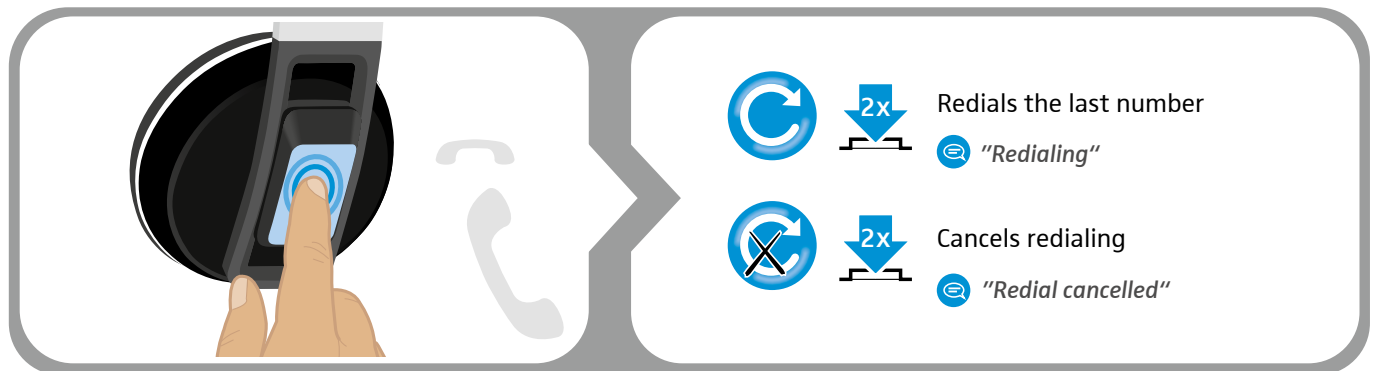

Using the audio cable

Connect the audio cable if:

- the battery pack is flat or
- wireless transmission is not allowed e. g. in airplanes.

The Bluetooth connection is automatically disconnected when you connect the audio cable.



- ▶ Insert the smaller jack plug of the audio cable into the audio socket. You hear a click sound.
- ▶ Turn the jack plug clockwise to secure the audio cable.
- ▶ Connect the other jack plug to your audio source.

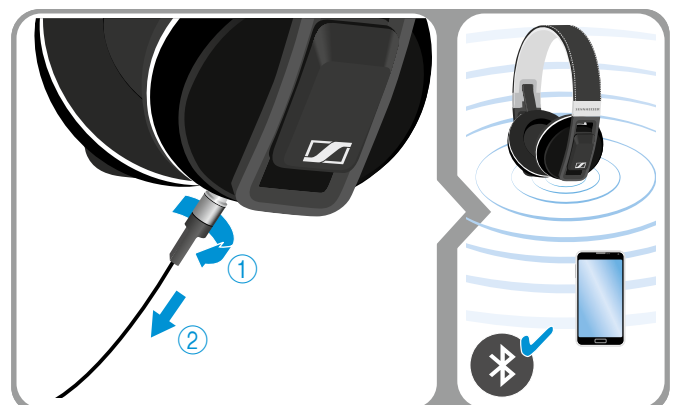

- ▶ Disconnect the audio cable from your audio source.
- ▶ Turn the jack plug counterclockwise to untighten the audio cable.
- ▶ Disconnect the jack plug of the audio cable. You can use the Bluetooth again.

Storing and transporting the headset



For space-saving transportation, the headset can be folded up.

- ▶ Detach the cable if necessary.
- ▶ Fold the ear cups one by one in the direction of the headband.
- ▶ Store the headset in the supplied carry bag to avoid scratches.

If you are out of the Bluetooth transmission range

Listening to music or calling is only possible in the **Bluetooth** transmission range of the mobile phone/**Bluetooth** device. The transmission range largely depends on environmental conditions such as wall thickness, wall composition etc. With a free line of sight, the transmission range of most mobile phones and **Bluetooth** devices is up to 10 meters.



If the headset leaves the transmission range of the connected **Bluetooth** device, the voice prompt "Lost connection" is announced in the headset.

If you re-enter the **Bluetooth** transmission range within 5 minutes, the connection is re-established automatically and the voice prompt "Connected" is announced in the headset.



If you spend more than 5 minutes outside the **Bluetooth** transmission range, the connection breaks down completely and you have to manually re-establish the connection. To re-establish a connection to the **Bluetooth** device:

- ▶ Touch the touch control.
Once the connection is successfully re-established, the voice prompt "Connected" is announced in the headset.

Cleaning and maintaining the headset

CAUTION

Liquids can damage the electronics of the product!

Liquids entering the housing of the device can cause a short circuit and damage the electronics.

- ▶ Keep all liquids far away from the product.
 - ▶ Do not use any cleansing agents or solvents.
-
- ▶ Before cleaning, unplug the USB plug of the charging cable.
 - ▶ Only use a dry and soft cloth to clean the product.

Replacing the ear pads

For reasons of hygiene, you should replace the ear pads from time to time. Spare ear pads are available from your Sennheiser partner.

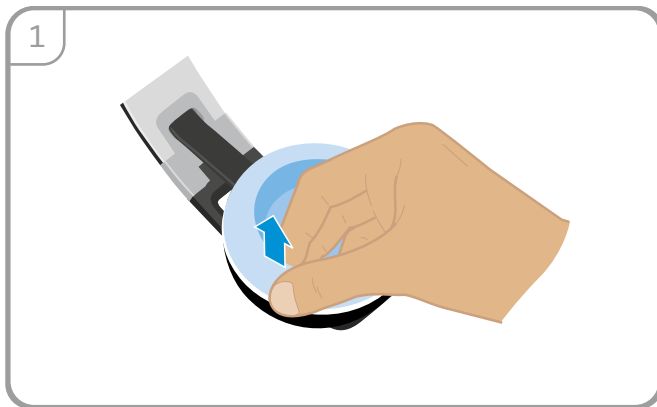

- ▶ Carefully remove the old ear pad from the ear cup.

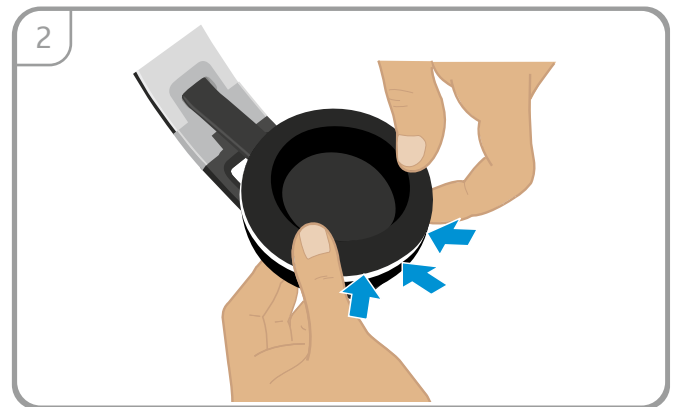

- ▶ Attach the new ear pad to the ear cup by pressing firmly around the ear pad.

If a problem occurs ...

Problem	Possible cause	Solution	Page
Headset cannot be switched on	The rechargeable battery is flat	Recharge the rechargeable battery.	8
No audio signal	The headset is not paired with the Bluetooth device	Check if the headset is paired. If necessary, pair the headset again.	9
	The volume is adjusted too low	Increase the volume.	13
	The headset is switched off	Switch the headset on.	12
Headset cannot be paired	The pairing does not work	Check if your Bluetooth device supports the HF or HS profile.	–
	The mobile phone is switched off	Switch your mobile phone on.	–
	Bluetooth is deactivated on the Bluetooth device	Activate Bluetooth on your Bluetooth device.	–

If a problem occurs that is not listed in the above table or if the problem cannot be solved with the proposed solutions, please contact your local Sennheiser partner for assistance.

To find a Sennheiser partner in your country, search at www.sennheiser.com.

Specifications

Standby time	up to 14 days
Talk time	up to 25 hours
Charging time of rechargeable battery	approx. 2 hours
Rechargeable battery (built-in)	Lithium Polymer; 3.7 V; 205 mA
Speaker type	dynamic, neodymium magnet
Speaker frequency response	150 – 6,800 Hz (wideband) 200 – 3,400 Hz (narrowband) 150 – 15,000 Hz (A2DP/music)
Sound pressure level	max. 118 dB SPL (ERP)
Microphone type	Noise cancelling electret condenser microphone
Microphone frequency response	150 – 6,800 Hz
Dimensions (W x H x D)	approx. 180 x 200 x 90 mm
Weight	approx. 300 g
Temperature range	Operating: +10°C (+50°F) to +40°C (+104°F) Storage: -20°C (-4°F) to +60°C (140°F)
Relative humidity	Operating: +10°C (+50°F) to +40°C (+104°F) Storage: 20 to 85 %, non-condensing



Bluetooth	version 4.0/class 1
Range	up to 25 m (device-dependent)
Transmission frequency	2,402 MHz to 2,480 MHz
Profiles	HSP (v1.2), HFP (v1.6), A2DP (v1.2)
Output power	9 dBm/7.90 mW
Typical sensitivity	-89 dBm

Valuable information – aptX audio coding

Outstanding audio quality

aptX technology is what wireless audio has been waiting for. With aptX audio coding, you can be assured of crisp, pure and full stereo sound. It allows you to not only hear, but experience and feel the audio as it was intended. Utilizing aptX, **Bluetooth** can now offer wireless audio quality that is indistinguishable from the highest quality wired connection.

Professional grade sound

Until now, aptX has been the best-kept secret of the professional audio industry. From major public broadcasters to film production studios, aptX is used throughout the world to transmit high quality digital audio from A to Z in real-time. It was developed to meet the exacting standards of musicians and audio engineers who love the exceptional dynamic range and high fidelity it provides.

Now available on selected consumer devices, the technology ensures that music lovers everywhere can stream the rich listening experience that only aptX can deliver.

Revolutionizing Bluetooth listening

Bluetooth technology has revolutionized our communications and lifestyle by eliminating troublesome wires and letting us get on with life “on the move”. Listening to a mobile phone conversation on a **Bluetooth** earpiece sounds just fine but when it comes to delivering full stereo sound, a little extra help is required. aptX works within **Bluetooth** to deliver CD quality audio, ensuring you are getting the most from your wireless listening experience.

In order to deliver two-channel digital sound within the **Bluetooth** A2DP profile, audio compression is necessary. While traditional audio compression technologies struggle to provide full-bandwidth, high-fidelity audio over **Bluetooth**, aptX works to ensure you enjoy the fullest, richest sound your music collection has to offer.

aptX legacy

If you have ever been to the movies or listened to the radio then chances are you’ll already have heard aptX in action. Over 20,000 radio stations across the world and thousands of cutting-edge film studios rely on aptX for high quality audio delivery.

The digital compression technology now known as aptX was originally developed in Queen’s University, Belfast, Northern Ireland. The technology was first brought to market for radio automation applications to store CD quality audio on computer hard drives for direct playout during radio shows, hence automating the process of the disc jockey.

The acclaim the technology received led to further research and development and throughout the 1990s the technology was used by Broadcast and Post-production studios worldwide to deliver high-fidelity, low latency audio in situations where bandwidth was limited. The same core principles that have earned aptX worldwide acclaim in the Broadcast and Post-Production markets make it the perfect solution for delivering high quality audio on wireless devices. aptX is leading the way in bringing pro-audio quality to the discerning consumer.

aptX key features:

Blind listening tests with industry reference audiences have shown that aptX over **Bluetooth** is indistinguishable from audio delivered over wired technology. Unlike psycho-acoustic-based technologies such as MP3 or AAC, aptX can be used to transport audio without degrading the audio quality. With MPEG/AAC compression, the encoding process is destructive and content perceived as “irrelevant” is discarded.

aptX’s transparent, non-destructive approach ensures that every frequency present in the original signal is preserved in the encoded and decoded signal.

Dynamic range of >92 dB for 16 bit audio and >120 dB for 24 bit audio.

The overall framework of aptX ensures a high degree of resilience to random bit errors, with the bit error response well matched to the auditory response of the human ear. aptX employs connection and synchronization techniques to ensure a robust connection and enable delivery of audio even under stressful conditions.

Shortest processing delay of any professional audio compression technology. Many current wireless devices suffer from unwanted delays which cause lip-sync issues, aptX can enable real-time delivery of wireless audio ensuring seamless integration when used with video devices.

aptX encoded audio fits neatly within the available bandwidth of wireless transmission standards to offer an efficient solution for bandwidth-restricted connections.

Manufacturer Declarations

Warranty

Sennheiser Communications A/S gives a warranty of 24 months on this product. For the current warranty conditions, please visit our website at www.sennheiser.com or contact your Sennheiser partner.

Sennheiser product warranty FOR AUSTRALIA ONLY

In Sennheiser's goods come with guarantees that cannot be excluded under the Australian Consumer Law. You are entitled to a replacement or refund for a major failure and compensation for any other reasonably foreseeable loss or damage. You are also entitled to have the goods repaired or replaced if the goods fail to be of acceptable quality and the failure does not amount to a major failure.

This warranty is in addition to other rights or remedies under law. Nothing in this warranty excludes, limits or modifies any liability of Sennheiser which is imposed by law, or limits or modifies any remedy available to the consumer which is granted by law.

To make a claim under this warranty, contact
Sennheiser Australia Pty Ltd,
Unit 3, 31 Gibbes Street Chatswood NSW 2067, AUSTRALIA
Phone: (02) 9910 6700, email: service@sennheiser.com.au.

All expenses of claiming the warranty will be borne by the person making the claim. The Sennheiser International Warranty is provided by Sennheiser Australia Pty Ltd (ABN 68 165 388 312), Unit 3, 31 Gibbes Street Chatswood NSW 2067 Australia.

In compliance with the following requirements

- WEEE Directive (2012/19/EU)

Please dispose of this product by taking it to your local collection point or recycling center for such equipment. This will help to protect the environment in which we all live.



- Battery Directive (2013/56/EU)

The product's built-in rechargeable batteries can be recycled. In order to protect the environment, please dispose of defective products with built-in rechargeable batteries as special waste or return them to your specialist dealer.



CE Conformity

- R&TTE Directive (1999/5/EC)
- EMC Directive (2014/30/EU)
- Low Voltage Directive (2006/95/EC)
- ErP Directive (2009/125/EC)
- RoHS Directive (2011/65/EU)

The declaration is available on our website at www.sennheiser.com.

Before putting the product into operation, please observe the respective country specific regulations!

Trademarks

The **Bluetooth**® word mark and logos are registered trademarks owned by **Bluetooth SIG, Inc.** and any use of such marks by Sennheiser electronics GmbH & Co. KG is under license.

iPhone® and iPod® are registered trademarks of Apple Inc, registered in the U.S. and other countries.

The aptX® mark and the aptX logo are trade marks of CSR plc or one of its group companies and may be registered in one or more jurisdictions.

Federal Communication Commission Interference Statement

(NOTE : The text below is for all Wireless products / radio products)

FCC Declaration of Conformity

FCC Declaration of Conformity	
	Sennheiser Model No: Urbanite & Urbaqnite XL Wireless
We,	Sennheiser Electronic Corporation One Enterprise Drive · Old Lyme · CT 06371 · USA Tel : +1(860)4349190 ext144 Fax :+1(860)434 1759 ext144
declare the above device complies with the requirements of Federal Communication Commission.	
This device complies with Part 15 of the FCC rules.operation is subjected to the following two conditions:	
1)This device may not cause harmful interference,and	
2) This device must accept any interference received, including interference that may cause undesired operation.	
Responsible party : Greg Beebe	

This equipment has been tested and found to comply with the limits for a Class B digital device, pursuant to Part 15 of the FCC Rules.

These limits are designed to provide reasonable protection against harmful interference in a residential installation. This equipment generates, uses and can radiate radio frequency energy and, if not installed and used in accordance with the instructions, may cause harmful interference to radio communications. However, there is no guarantee that interference will not occur in a particular installation. If this equipment does cause harmful interference to radio or television reception, which can be determined by turning the equipment off and on, the user is encouraged to try to correct the interference by one of the following measures:

- Reorient or relocate the receiving antenna.
- Increase the separation between the equipment and receiver.
- Connect the equipment into an outlet on a circuit different from that to which the receiver is connected.
- Consult the dealer or an experienced radio/TV technician for help.

FCC Caution: Any changes or modifications not expressly approved by the party responsible for compliance could void the user's authority to operate this equipment.

This device complies with Part 15 of the FCC Rules. Operation is subject to the following two

conditions: (1) This device may not cause harmful interference, and (2) this device must accept any interference received, including interference that may cause undesired operation.

This transmitter must not be co-located or operating in conjunction with any other antenna or transmitter

Radiation Exposure Statement:

Since the radiated output power of this device is far below the FCC radio frequency exposure limits, it is not subjected to routine RF exposure evaluation as per Section 2.1093 of the FCC rules.

Industry Canada statement:

This device complies with Industry Canada licence-exempt RSS standard(s). Operation is subject to the following two conditions:

- (1) this device may not cause interference, and
- (2) this device must accept any interference, including interference that may cause undesired operation of the device.

.....

CAN ICES-3 (B) /NMB-3(B)

Le présent appareil est conforme aux CNR d'Industrie Canada applicables aux appareils radio exempts de licence. L'exploitation est autorisée aux deux conditions suivantes :

- (1) l'appareil ne doit pas produire de brouillage, et*
- (2) l'utilisateur de l'appareil doit accepter tout brouillage radioélectrique subi, même si le brouillage est susceptible d'en compromettre le fonctionnement.*

Radiation Exposure Statement:

Since the radiated output power of this device is far below the Canada radio frequency exposure limits, it is not subjected to routine RF exposure evaluation as per RSS -102 Industry Canada

Déclaration d'exposition aux radiations:

The text below to be translated in French

Depuis la puissance de sortie rayonné de cet appareil est bien inférieure aux limites d'exposition aux fréquences radio au Canada , il n'est pas soumis à une évaluation de routine de l'exposition aux RF selon la RSS -102 Industrie Canada

CAN ICES-3 (B) /NMB-3(B)



 **SENNHEISER**

Sennheiser Communications A/S
Industriparken 27, DK-2750, Denmark
www.sennheiser.com

Publ. 08/14, A01