

Bluetooth headset for phone calls
VMX 200

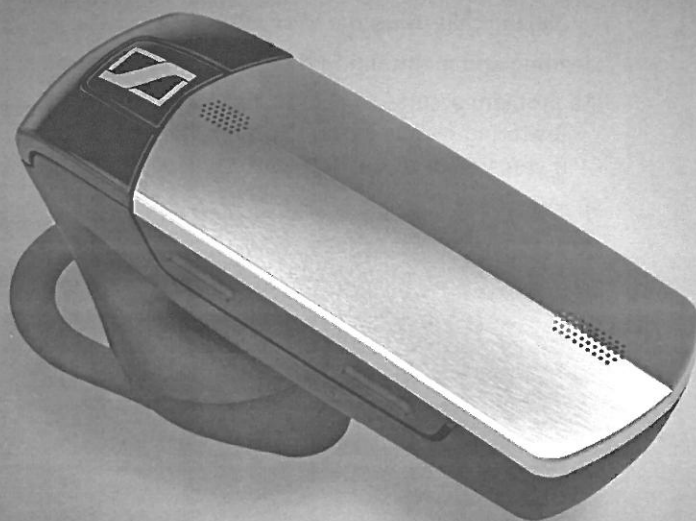

Instruction manual

 **SENNHEISER**
COMMUNICATIONS

Contents

Important safety information	2
The VMX 200 Bluetooth headset	4
Delivery includes	5
Product overview	6
Putting the VMX 200 into operation	9
Charging the headset battery	9
Connecting the VMX 200 to a Bluetooth device	10
Using the VMX 200 with two Bluetooth devices	11
Using the VMX 200	12
Individually adjusting the VMX 200 and wearing it	12
Switching the VMX 200 on/off	14
Changing the speaker volume	15
Making calls using the VMX 200	16
Cleaning and maintaining the VMX 200	19
If a problem occurs	20
Restoring factory default settings (Reset)	20
If you are out of the Bluetooth transmission range	21
Specifications	22
Manufacturer Declarations	23

Important safety information

- ▶ Please read this instruction manual carefully and completely before using the product.
- ▶ Make this instruction manual easily accessible to all users at all times. Always include this instruction manual when passing the product on to third parties.

Preventing health problems

- ▶ Before using the product, set the volume to a low level. To protect your hearing, avoid listening at high volume levels for long periods of time.
- ▶ Do not use the product in situations which require special attention (e.g. in traffic or when performing skilled jobs).
- ▶ Keep the product and accessories out of reach of children who could swallow smaller pieces.

The product generates stronger permanent magnetic fields that could cause interference with cardiac pacemakers and implanted defibrillators (ICDs).

- ▶ Always maintain a distance of at least 3.94" (10 cm) between the ear cup housing and the cardiac pacemaker or implanted defibrillator.

Preventing damage to the product

- ▶ Always keep the product dry and do not expose it to extreme temperatures (normal operating temperatures: 10°C/50°F to 40°C/104°F).
- ▶ Use the product with care and store it in a clean, dust-free environment.
- ▶ Only use the product in aircraft where wireless **Bluetooth**® transmission is permitted.

Intended use

The VMX 200 is an accessory for mobile phones or any **Bluetooth**® compliant device with a "hands free profile" (HFP) or a "headset profile" (HSP). It is intended for wireless communication via **Bluetooth** connection in dry environments.

It is considered improper use when the VMX 200 is used

- for any application not named in this instruction manual,
- under operating conditions that deviate from those described in this instruction manual.

Safety instructions for rechargeable batteries

If abused or misused, rechargeable batteries may leak. In extreme cases, a rechargeable battery may even present



WARNING

- a heat hazard,
- a fire hazard,
- an explosion hazard,
- a smoke and gas hazard.

Please understand that Sennheiser Communications does not accept liability for damage arising from abuse or misuse.



Only charge the rechargeable batteries with the appropriate Sennheiser charger.



Switch rechargeable battery-powered products off after use.



Only charge the rechargeable batteries at ambient temperatures between 10°C/50°F and 40°C/104°F.



When not using rechargeable batteries for extended periods of time, charge them regularly.



Do not charge the rechargeable batteries if the product is obviously defective.

The VMX 200 Bluetooth headset

The stylish new VMX 200 **Bluetooth** headset is the wireless solution for phone calls with superb sound quality. It features VoiceMax Dual Microphone technology that filters away background noise and enhances your voice, thus providing crystal clear speech.

Bluetooth



The VMX 200 complies with the new **Bluetooth** 3.0 standard and is compatible with all **Bluetooth** 1.1, 1.2, 2.0 and 2.1 devices with a "hands free profile" (HFP) or a "headset profile" (HSP). The VMX 200 provides wireless freedom to give hands-free convenience with your mobile phone.

Additional features of the VMX 200 Bluetooth headset

- VoiceMax Dual Microphone technology – two microphones work in synergy; one to emphasize your voice, the other to remove noise
- Easy call control – control calls and adjust the volume to suit you best with just one hand
- Lightweight comfort – weighs only 10 grams
- Flexible wearing style – wear left or right, use with or without ear hook
- Long talk time – talk to business partners and friends for up to 6 hours, with up to 10 days of standby time

Delivery includes



VMX 200 mono **Bluetooth** headset
with built-in rechargeable Lithium-Polymer battery



Ear hook



Ear adapter without loop



Ear adapters with loop (S, M, L)

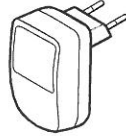

VMX 200 power supply unit (EU/UK/US/AUS version)



Charging cable



Quick Guide



Safety Guide



A list of accessories can be found on the VMX 200 product page at www.senncom.com. For information on suppliers, contact your local Sennheiser partner: www.senncom.com > "Sales Partner"

Product overview

VMX 200 headset

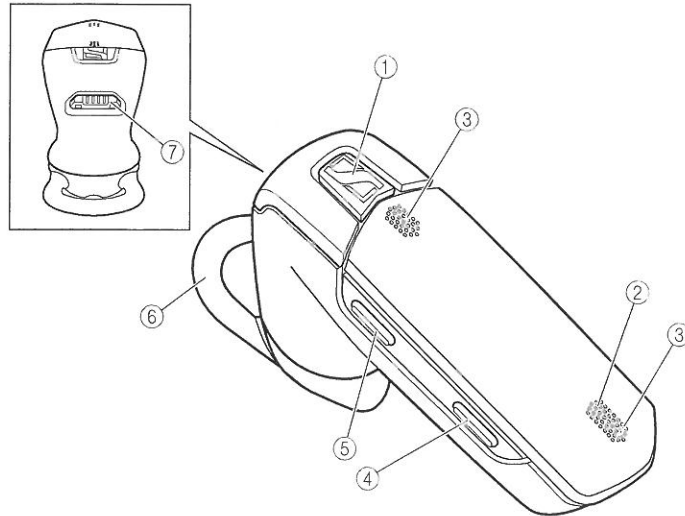

- ① Multi-function button
- ② LED
- ③ Microphone
- ④ Volume down button
- ⑤ Volume up button
- ⑥ Ear adapter with loop
- ⑦ USB socket

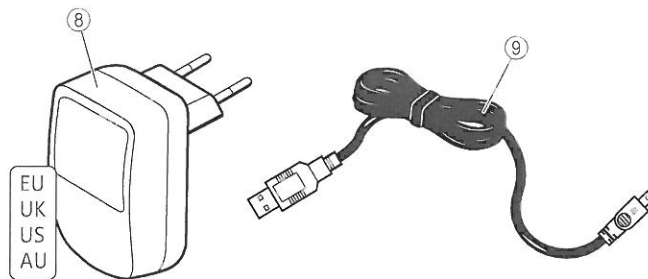

VMX 200 power supply unit









- ⑧ VMX 200 power supply unit (EU/UK/US/AUS version)
- ⑨ Charging cable

Overview of pictograms

Meaning of the pictograms for pressing a button

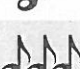
Pictogram	Meaning
	Briefly press this button.
	Double-press this button.
	Keep this button pressed for 5 seconds.

Meaning of the pictograms for the beeps

Pictogram	Meaning
	Ascending sequence of beeps
	Descending sequence of beeps
	One beep
	Several beeps
	Two descending beeps
	Two ascending beeps

Meaning of the pictograms for the flashing of the LED

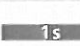
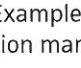
Pictogram	Meaning
	This pictogram symbolizes a flashing.
	This pictogram symbolizes an interruption.
	This pictogram symbolizes a time interval.

Examples of some of the pictograms that are used throughout this instruction manual:

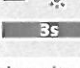
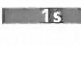
Pictogram	Meaning
	The LED flashes rapidly.
	The LED flashes once every 3 seconds.
	The LED flashes 3 times per second.

The pictogram “i”

 Notes marked with the pictogram “i” provide important information on the use of the headset.

Overview of buttons

Multi-function button

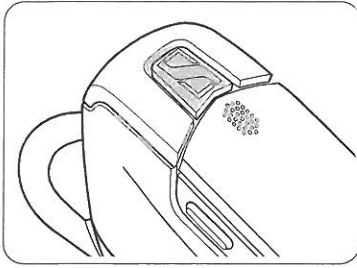

Press the button	Function	Page	
	Accepts a call	16	
	Ends a call	16	
	Transfers a call from the mobile phone to the headset	16	
	Accepts an incoming call and ends the active call (managing two calls)	17	
	Ends the active call and makes the call on hold active (managing two calls)	17	
	Stops redialing	17	
	Voice dialing	18	
	Stops voice dialing	18	
		Rejects a call	16
		Rejects the incoming call and continues the active call (managing two calls)	17
Redials the last number		17	
Establishes a conference call (managing two calls)		17	
	Accepts an incoming call and puts the active call on hold (managing two calls)	17	
	Toggles between two calls (managing two calls)	17	
	Switches the headset on	14	
	Switches the headset off	14	
	Changes to pairing mode	10	

Volume buttons

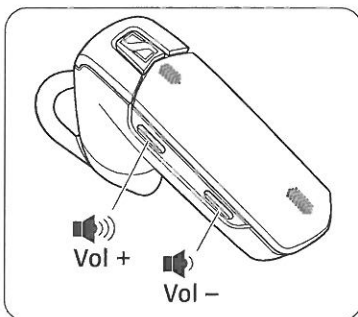

Button	Duration	Function	Page
		Mutes the headset microphone	18
		Resets the headset to the factory default settings	20

Putting the VMX 200 into operation

Charging the headset battery



WARNING

Danger of injury!

Wearing the headset when charging can cause burns and injuries.

- ▶ Do not wear the headset when charging.

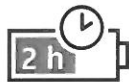

Before using the headset for the first time, charge the rechargeable battery for at least 2.5 hours. Later, 2 hours will suffice to fully charge the battery. A fully charged battery provides a talk time of approx 6 hours.

- 1 Take off the headset and switch it off (see page 14).
- 2 Connect the smaller plug of the charging cable to the USB socket of the VMX 200.
- 3 Connect the USB plug of the charging cable to the USB socket of the power supply unit or your computer.
- 4 The battery is being charged and all active connections are interrupted. The LED lights up red. When charging is complete, the LED flashes blue once every 5 seconds.

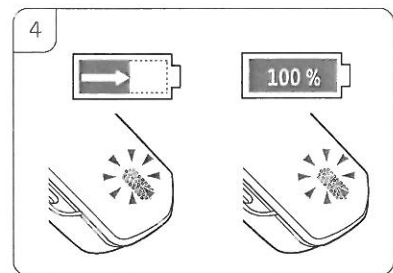
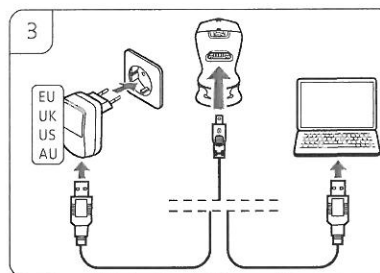
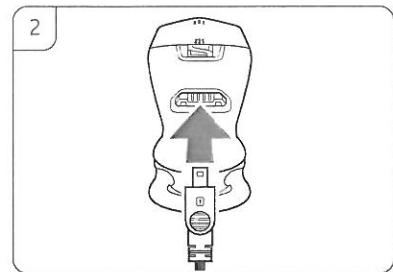
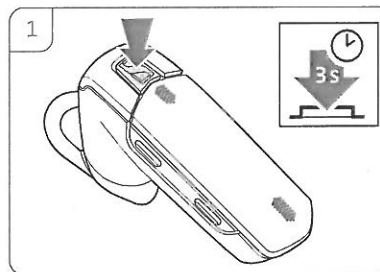

When the battery level drops below 10 minutes of talk time, the LED flashes red and you hear a low battery warning every 20 seconds. The headset automatically switches off after the battery has dropped below the minimum level.

Connecting the VMX 200 to a Bluetooth device

CAUTION

Danger of malfunction!

The transmitted radio waves of mobile phones can impair the operation of sensitive and unprotected devices.

- ▶ Only make calls with the headset in locations and aircraft where wireless **Bluetooth** transmission is permitted.

The headset complies with the **Bluetooth** 3.0 standard. In order that data can be transmitted wirelessly using **Bluetooth** technology, you have to pair your headset with **Bluetooth** devices that support the "hands free profile" (HFP) or "headset profile" (HSP).

The headset can save the connection profiles of up to eight **Bluetooth** devices with which it has been paired. After switch-on, the headset automatically tries to connect to the two last connected devices.

If you pair the headset with a ninth **Bluetooth** device, the saved connection profile of the first **Bluetooth** device will be overwritten. If you want to re-establish a connection with the first **Bluetooth** device, you have to pair the headset again.

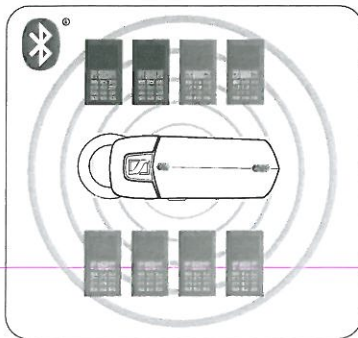

Pairing the VMX 200 with a Bluetooth device

The following chapter describes, by way of example of a mobile phone, how to pair the VMX 200 with a **Bluetooth** device.

- 1 Make sure that
 - the headset's battery is fully charged (see page 9),
 - the mobile phone's **Bluetooth** visibility is enabled (see the instruction manual of the corresponding **Bluetooth** device),
 - the headset is placed close to the mobile phone (approx. 20 cm or 7").
- 2 Switch the headset off (see page 14).
- 3 Press and hold the multi-function button for 5 seconds. You hear an ascending beep in the headset and the LED flashes alternately blue and red, indicating that the headset is in pairing mode.
- 4 Once the VMX 200 has found the mobile phone, the devices exchange device identification information. Select "Sennheiser VMX 200" on your mobile phone. If necessary, enter the default PIN code "0000".
- 5 The devices have identified each other and the headset is paired with the mobile phone. "Sennheiser VMX 200" appears on the display of the mobile phone, the LED flashes slowly blue.

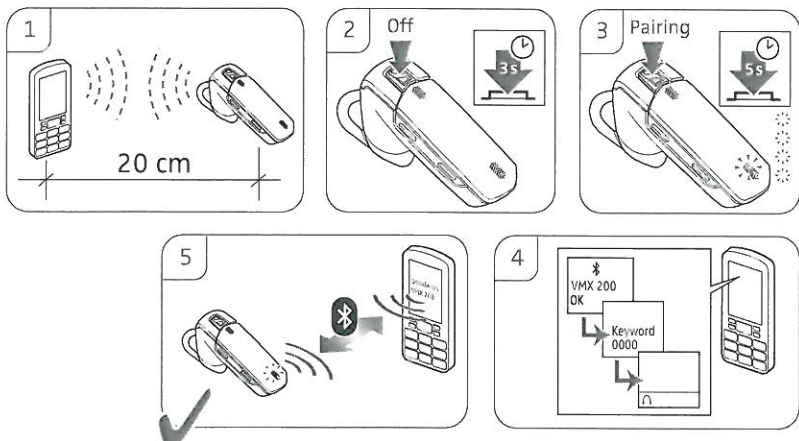

If pairing is not successful within 5 minutes, the headset automatically returns to searching mode. If the headset has been paired before, it will try to connect to the last connected device after 5 minutes.

- ▶ On the mobile phone, start a search for **Bluetooth** devices (see the instruction manual of your mobile phone) and follow the instructions on the mobile phone's display.

Using the VMX 200 with two Bluetooth devices

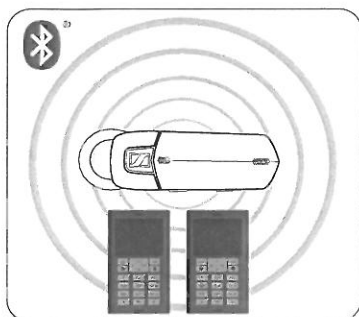

You can use the VMX 200 simultaneously with two connected **Bluetooth** devices (Multi Connection).

In order for this to function, at least two **Bluetooth** devices must already be paired with the headset. To do so, follow the instructions in the preceding chapter "Pairing the VMX 200 with a Bluetooth device".

- ▶ Switch the headset on. The headset automatically tries to establish a **Bluetooth** connection to the two last connected **Bluetooth** devices.

Using the VMX 200

Individually adjusting the VMX 200 and wearing it

For an optimized and individual wearing comfort, the VMX 200 can be worn on your left or right ear in two different ways, i.e. with or without the ear hook.

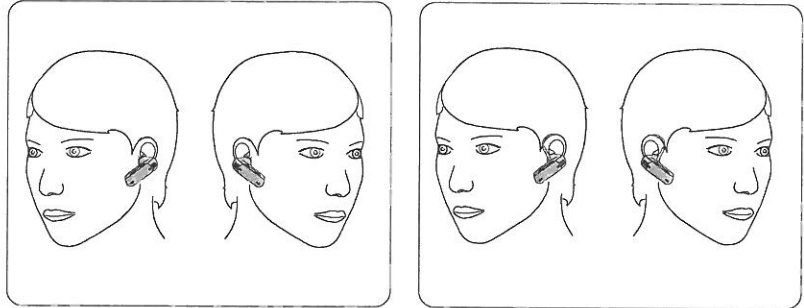

Wearing the VMX 200 with ear adapter

The ear adapter with loop is supplied in 3 different sizes: S, M, L. Size M is pre-installed. Select the size that fits your ear.

- 1 If the pre-installed ear adapter with loop is not the right size, remove it from the headset.
- 2 Attach the selected ear adapter with loop to the headset.
- 3 Move the headset to your ear and insert the loop of the ear adapter.
- 4 Adjust the angle of the loop so that the headset fits comfortably and securely in your ear.

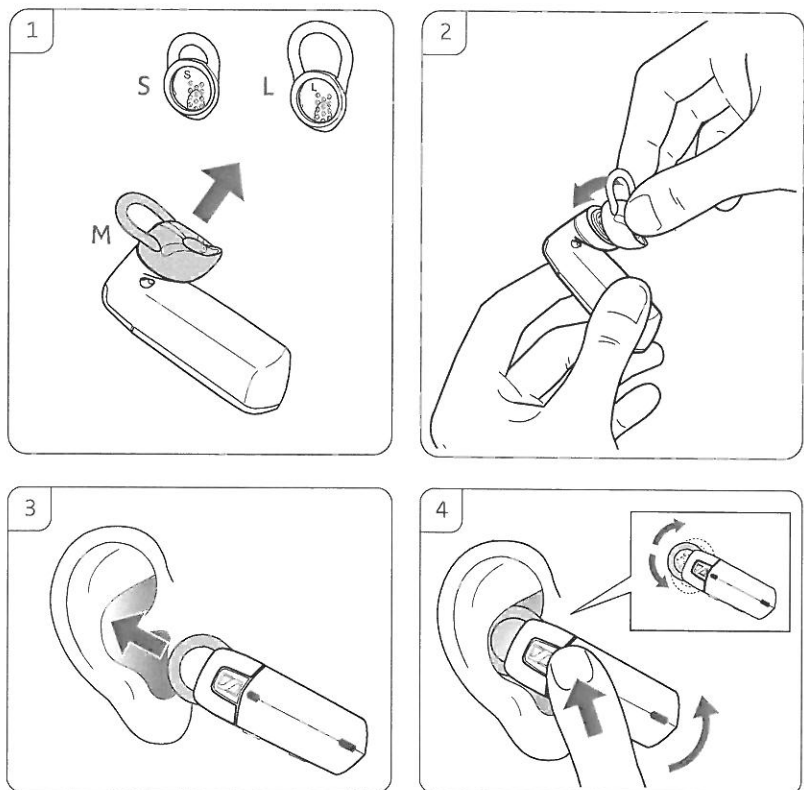

Wearing the VMX 200 using the ear hook

If you prefer using the ear hook, always wear it in combination with the ear adapter without loop to ensure optimum wearing comfort.

- 1 Remove the pre-installed ear adapter with loop.
- 2 Attach the ear adapter without loop to the headset.
- 3 Attach the ear hook to the VMX 200. If you want to change the wearing ear of the headset, attach the ear hook the other way round.
- 4 Move the headset to your ear and guide the ear hook behind your ear.
- 5 Position the headset so that it fits comfortably.

