

REVISIONS

| ECO | ITEM MASTER | REV | DESCRIPTION | DATE | BY |
|--------|-------------|-----|-----------------------|----------|----|
| C24918 | 166425 | 01 | RELEASE @ DEVELOPMENT | 10/14/08 | JW |

KEYLINES FOR REFERENCE ONLY
DO NOT PRINT

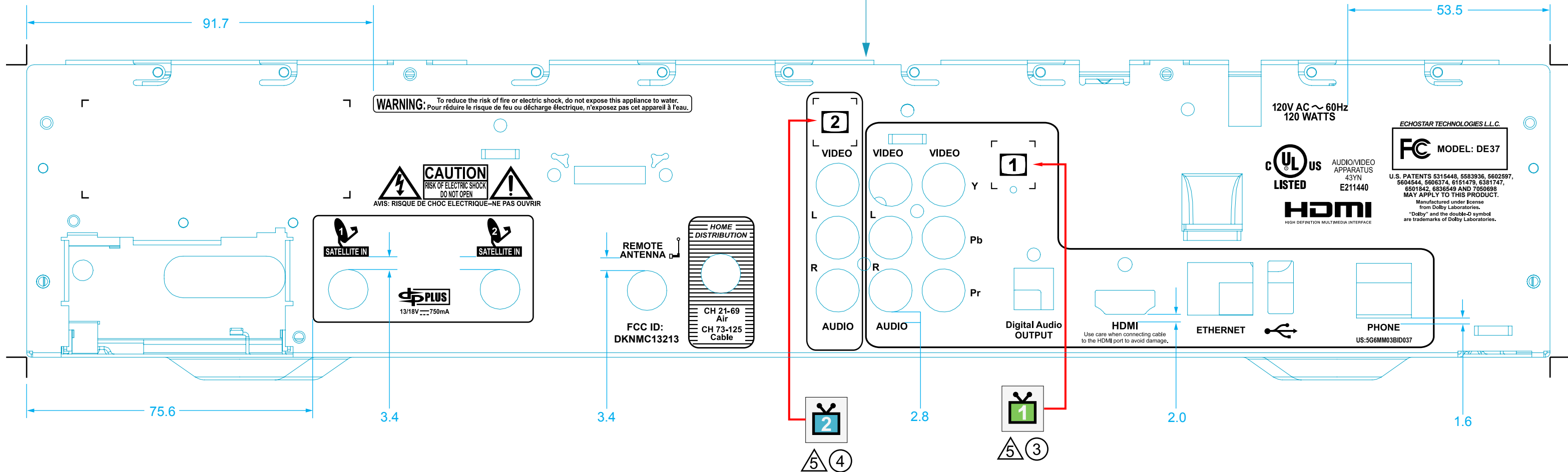

- NOTES:
1. ALL DIMENSIONS ARE IN MILLIMETERS.
 2. SEE BOM FOR ITEM NUMBERS.
 3. PLACE ALL GRAPHICS ON CHASSIS AS SHOWN.
 4. PRINT COLOR: PANTONE STANDARD BLACK OR ECHOSTAR APPROVED EQUIVALENT.
 5. PLACE "TV1" AND "TV2" LABELS ON CHASSIS AS SHOWN COVERING THE BLACK SILKSCREENED "1" AND "2".
 6. QUALITY ASSURANCE PROVISIONS: IN ADDITION TO MEETING ALL REQUIREMENTS OUTLINED IN THIS SPECIFICATION, ALL REQUIREMENTS IN THE FOLLOWING ECHOSTAR QUALITY ASSURANCE DOCUMENTS AND THEIR REFERENCES MUST BE MET OR EXCEEDED.
 - A) 124214 SUPPLIER AQL REQUIREMENTS
 - B) 105450 SUPPLIER QA REQUIREMENTS
 - C) 123473765-AA COSMETIC PROVISIONS

| | | | | |
|---|----------|-------|--------------|---|
| UNLESS OTHERWISE SPECIFIED DIMENSIONS ARE IN MM. TOLERANCES: HOLE DIA: 0.000 +/- .125 +/- .075 0.00 +/- .25 0.0 +/- .4 ANGLES: 0 +/- .7 +/- .5° | | | | |
| THIS DRAWING CONTAINS CONFIDENTIAL INFORMATION AND IS THE SOLE PROPERTY OF ECHOSTAR TECHNOLOGIES CORPORATION. UNAUTHORIZED REPRODUCTION OR DISTRIBUTION IS EXPRESSLY PROHIBITED WITHOUT PRIOR WRITTEN CONSENT OF ECHOSTAR TECHNOLOGIES CORPORATION. | | | | TITLE ASSY DWG, ART/CHASSIS, VIP922 DVR |
| APPROVALS | DATE | SIZE | DWG. NO | REV |
| JASON WALKER | 10/14/08 | B | 166425 | 01 |
| CHECKED | | SCALE | SHEET 1 of 1 | |