

**Important Safety Instructions**

**CAUTION: Risk of Fire and Burns. Do Not Open, Crush, Heat Above 60°C or Incinerate. Follow All Instructions.**

Read and understand all operating instructions prior to use. Keep this document for future reference.

Do not immerse the product in water or expose it to rain, moisture, dripping or splashing.

Do not leave the product where it could reach very high temperatures, for example inside a vehicle in direct sunlight.

Avoid dropping the product or subjecting it to excessive force, pressure or impacts.

Package and secure the product well during transport to avoid excessive shock, vibration and damage.

Do not use or charge the product if it appears damaged or abnormal.

Keep the product, plastic packaging and small parts away from babies and children.

Dispose of or recycle the product properly according to local codes. Do not shred.

Do not charge the product at high ambient temperatures.

Handle the product carefully to avoid static electricity discharge into the product. Static may damage sensitive protection components and cause failures.

Do not charge the product when ambient temperatures are below 0°C or above 35°C (32°F or above 95°F).

If the product emits odor, generates heat, becomes discolored or deformed, or in any way appears abnormal during use, recharging or storage, immediately remove it from the charger and stop using it.

The product should be stored at room temperature. Product should be charged once every 3 months while storing.

© 2017 SlingStudio™ is a trademark of Sling Media, Inc. Other products and companies mentioned are the trademarks of their respective owners and not of Sling Media, Inc.

Warranty, safety, regulatory and legal information can be found at [MySlingStudio.com/legal](http://MySlingStudio.com/legal)  
213753



## Quick Start Guide

[MySlingStudio.com](http://MySlingStudio.com)

## Getting Started

**Important:** If you have multiple CameraLinks, each one must be paired one-at-a-time to SlingStudio.

**1** Charge your SlingStudio™ CameraLink by connecting the included USB cable from the device to any USB wall charger (not included). The CameraLink is fully charged when all four battery LEDs are green.

**2** Connect the CameraLink to your camera's HDMI output using the included HDMI cable.\* To power on the CameraLink, press and hold the Power button for 3 seconds.

*For initial setup, the CameraLink automatically powers on in WPS mode, indicated by a blinking red LED.*

**3** To pair the CameraLink to SlingStudio, ensure that the CameraLink, SlingStudio and iPad with the SlingStudio Console app are in close proximity. Then open the Console app on your iPad, go to Settings and turn on WPS mode to connect to the CameraLink automatically.

*The Power LED will turn white when the CameraLink is successfully paired to SlingStudio. These two devices will automatically connect with each other on subsequent power-ups.*

### Please note:

- To power off the CameraLink, press and hold the Power button for 3 seconds.
- To pair the CameraLink to another SlingStudio, be sure that both devices are powered on. Unpair the CameraLink from the first SlingStudio by pressing and holding the CameraLink's Power button for 10 seconds, until the Power LED blinks red. Then repeat Step 3 with the other SlingStudio.
- If pairing more than one CameraLink to SlingStudio, repeat these three steps for each CameraLink.

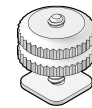

**Optional:** Use the included hot shoe mount to mount your CameraLink to your camera or tripod.



\*The HDMI cable included with the CameraLink is a micro-to-mini-HDMI cable that allows connection with cameras that have a mini-HDMI port.

If your camera has a standard HDMI or micro-HDMI port, please see the cable accessory options at [MySlingStudio.com/CameraLink](http://MySlingStudio.com/CameraLink).

**For more details, go to:**  
[MySlingStudio.com/CameraLink](http://MySlingStudio.com/CameraLink)