

Filtrete[™]
Ultra Slim
Air Purifier

Air Purifier Model Series
FAP-04

Replacement Filter Model Series
FAPF-04

For more information go to
www.filtrete.com





Table of Contents:

- 1** Safety Information
- 2** FCC Information for the Remote Control
- 3** Warnings & Cautions
- 4** Installation Requirements
 - Location Requirements
- 5** Electrical Requirements
 - Battery Installation
- 6** Wall Mount Bracket
- 7** Features and Functions
- 9** Air Purifier Use
 - Turning the Air Purifier On/Off
 - Adjusting the Fan Speed
 - Running in Automatic Mode
- 11** Using the Lighting Features
 - Turning the Ionizer On/Off
 - Setting the Timer
 - Resetting the Filter Timer
- 12** Cleaning
- 13** Filter Removal
- 14** Filter Replacement
- 15** Troubleshooting
- 16** Assistance or Service & Warranty

Safety Information

Please read, understand, and follow all of the safety information contained in these instructions prior to using the Filtrere™ Ultra Slim Air Purifier. **READ AND SAVE THESE INSTRUCTIONS** for future reference.

Intended Use:

The Filtrere™ Air Purifier is intended for indoor household use, with Filtrere™ brand filters and standard 120V AC power. This Air Purifier has not been tested with non-Filtrere brand filters, operated at different voltages, or used outdoors. Each of these misuses could damage the Air Purifier and/or create unsafe operating conditions.

Explanation of Signal Words

Warning

Indicates a potentially hazardous situation, which if not avoided, could result in death or serious injury.

Caution

Indicates a potentially hazardous situation, which if not avoided, may result in minor or moderate injury.

This device complies with Part 15 of the FCC Rules. Operation is subject to the following two conditions: (1) this device may not cause harmful interference, and (2) this device must accept any interference received, including interference that may cause undesired operation.

Note: This equipment has been tested and found to comply with the limits for a Class B digital device, pursuant to part 15 of the FCC Rules. These limits are designed to provide reasonable protection against harmful interference in a residential installation. This equipment generates, uses and can radiate radio frequency energy and, if not installed and used in accordance with the instructions, may cause harmful interference to radio communications. However, there is no guarantee that interference will not occur in a particular installation. If this equipment does cause harmful interference to radio or television reception, which can be determined by turning the equipment off and on, the user is encouraged to try to correct the interference by one or more of the following measures:

- Reorient or relocate the receiving antenna.
- Increase the separation between the equipment and receiver.
- Connect the equipment into an outlet on a circuit different from that to which the receiver is connected.
- Consult the dealer or an experienced radio/TV technician for help.

FCC ID: DGFCHIMFAP-04

Modifications to this device shall not be made without the written consent of 3M Company. Unauthorized modifications may void the authority granted under Federal Communication Rules permitting the operation of this device.

Warning

To reduce the risk associated with hazardous voltage:

- Plug the power cord correctly and tightly into a properly rated electrical outlet.
- Do not use the Air Purifier if the power cord is frayed or otherwise damaged.
- Do not touch the power cord with wet hands.
- Disconnect electrical power before servicing the filter.
- Use indoors and in dry locations only.
- Do not submerge the Air Purifier in water.
- Do not modify or attempt to modify this product.
- Do not disassemble the Air Purifier.
- Except for filter replacement, the Air Purifier is not intended to be serviced and does not contain any serviceable replacement parts or adjustments.
- Do not use if the interlock switch is damaged.
- Do not attempt to override the interlock switch.

To reduce the risk associated with hazardous voltage, and/or fire:

- Plug the Air Purifier into a properly rated electrical outlet.
- This equipment should be inspected frequently and collected dirt removed from it regularly to prevent excessive accumulation that may result in flashover or a risk of fire.

To reduce the risk associated with hazardous voltage and/or moving blades:

- Do not place fingers and/or any objects into air and/or motor housing vents.

To reduce the risk associated with fire:

- Do not block any air vents during use.
- Do not place the Air Purifier near a heat source.

To reduce the risk associated with hazardous voltage, and/or fire, and/or explosion:

- Do not use any combustible or flammable items on or near the Air Purifier.
- Do not spill or spray any liquids or aerosols into the Air Purifier or on the filter.

To reduce the risk associated with various hazards:

- Read and understand the operating manual before using the Air Purifier.
- Do not allow children or pets to have unsupervised access to this product.

Caution

To reduce the risk associated with environmental contamination:

- Dispose of the Air Purifier, batteries, and filters in accordance with local, state, and federal regulations.

To reduce the risk associated with various hazards:

- Replace the filter when the filter change timer begins flashing red.
- **The filter should be changed after no more than 90 days of continuous use, or sooner depending on the conditions in your home.**
- Periodically inspect the filter for damage or blockage.

To reduce the risk associated with falling, and/or impact:

- Do not sit on or place any object on this product.
- Do not install the wall bracket in a location or manner that cannot support the weight of the Air Purifier.

Location Requirements:

- Select a location where the air intake and filtered air outlet are not obstructed.
- Place the Air Purifier on a flat, level surface at least two feet from any heat source, such as ranges or heaters.
- Do not block the air openings or place the Air Purifier on a soft surface such as a bed, chair, or sofa.
- Operate indoors only.

Warning

- For indoor dry location use only. Do not use outdoors or in a wet environment.
- Do not submerge the Air Purifier in water.
- Do not place fingers and/or any objects into air and/or motor housing vents.
- Do not allow children or pets to have unsupervised access to this product.
- Do not block any air vents during use.
- Do not use any combustible or flammable items on or near the Air Purifier.
- Do not spill or spray any liquids or aerosols into the Air Purifier or on the filter.
- Do not place the Air Purifier near a heat source.

Caution

- Do not sit on or place any object on this product.

Installation Requirements

Electrical Connection:

- Plug the Air Purifier into a 120V AC electrical outlet.
- This product is equipped with a polarized AC plug (a plug having one blade wider than the other). This plug will fit into the electrical outlet only one way. If the plug does not fit fully into the outlet, reverse the plug. If it still does not fit, contact qualified personnel to install the proper outlet. DO NOT DEFEAT the safety purpose of this polarized plug in any way.

Warning

- Plug the Air Purifier into a 120V AC electrical outlet.
- Plug the power cord correctly and tightly into a properly rated electrical outlet.
- Do not use the Air Purifier if the power cord is frayed or otherwise damaged.
- Do not touch the power cord with wet hands.

Battery Installation in the Remote Control:

- Slide the battery compartment door open on the back of the remote control.
- Install one 12V alkaline battery in the remote control by aligning the +/- of the battery with the marks inside the battery compartment.
- Replace the battery compartment door.
- Always use 12V alkaline batteries.
- 12V Alkaline batteries can be disposed of with normal household waste.
- 12V Alkaline batteries can be found in most major retail outlets.

Wall Mount Bracket (optional)

Installing the Wall Mount Bracket:

- The mounting location for the wall bracket is at the top of the back side of the Air Purifier.
- The components should be lined up in the following order: Air Purifier, metal bracket, screws (included).
- Use a screw driver to install the wall mount bracket firmly, but not too tightly.

Installing the Wall Bracket:

- Select a wall location that will be able to handle the weight of the Air Purifier, such as a wall stud.
- Select wall fastening hardware (screws, etc.- not included) that is appropriate for the specific wall surface.
- Fasten the wall bracket to the wall, making certain the bracket tab is accessible to the wall mount bracket on the Air Purifier.
- Contact a qualified professional if difficulties are encountered in the installation.

Mounting the Air Purifier on the Wall:

- Carefully lift the Air Purifier into position so that the wall mount bracket on the Air Purifier fully engages the wall bracket.
- Visually and physically examine the wall mount connection before operating the Air Purifier.



Caution

- Do not install the wall bracket in a location or manner that cannot support the weight of the Air Purifier.

Features and Functions

This Filtrete™ Air Purifier from 3M comes complete with the latest advances in air filtration technology and includes the following product features:

- A Filtrete™ air cleaning filter - model FAPF-04
- An ionizer that can help produce fresher indoor air
- Backlit controls
- A stylish night-light
- A stylish radio frequency (RF) remote control
- An air quality sensor
- A filter change indicator

The Air Purifier is also designed to be quiet and not disruptive to your everyday activities.

Filtration:

The Filtrete™ filter contains electrostatically charged fibers that initially increase the filter's ability to remove particles from indoor air and also provide low airflow resistance. Particles can be introduced into the air of a room from many sources, including open doors and windows or by simply disturbing dust resting on a surface. To maximize the air cleaning in the room that contains the Air Purifier, it is recommended that you clean and seal, as much as possible, the room in which the Air Purifier operates; continue to dust surfaces and vacuum on a normal schedule; and close all windows and doors during operation. Also, remember that any Air Purifier can only help clean the air that passes through the filter.

Ionizer:

The ionizer in this product produces negative ions, which help improve small particle filtration. This unit emits a very small amount of ozone but has been certified to produce less than allowable limits by strict Underwriter's Laboratory (UL) standards. Running this machine with the ionizer on can produce fresher indoor air. If you are sensitive to ozone, use this product with the ionizer off.

Backlit Controls:

This Air Purifier is equipped with backlit controls to easily read and control the settings in low lighting conditions. The backlit controls can be turned off to maintain a dark environment. Please see the Air Purifier Use section for more details.

Features and Functions

Night-Light:

This Air Purifier also has a stylish night-light on the front air inlet. The night-light can be turned on/off as described in the Air Purifier Use section.

Remote Control:

This Air Purifier comes with a remote control, which allows you to turn the unit on/off and control the settings from across the room. The remote control uses a radio signal, so it will operate through many objects like doors and walls. As with any remote control, the working distance is usually within a moderate distance from the device. The Air Purifier will beep when receiving a signal from the remote control.

Air Quality Sensor:

This Air Purifier includes an air quality sensor. The air quality sensor reacts to odors and gases in the air and causes the Air Purifier to change speed. This Air Purifier is primarily designed to remove particles from the air. However, odors and particles are often formed together, such as cooking smoke, tobacco smoke, etc., so in many cases the air quality sensor will react to changes in particle concentration. The Air Purifier will run on higher speeds when more gases or odors are detected and on lower speeds when less gases or odors are detected. The air quality sensor will respond to many different gases, but it may be more sensitive to some and less sensitive to others. The air quality sensor can only respond to gases that contact the sensor, so an odor noticed by the user may not be detected by the sensor. The air quality sensor will only operate while the Air Purifier is in the Automatic Mode.

Filter Change Indicator:

This Air Purifier includes a filter change indicator. The change indicator monitors how long the Air Purifier has operated, not just how many days since the filter was installed. The filter should be changed after not more than 90 days of continuous use, and the timer is set for this timing. Depending upon the conditions in your home, the filter may need to be changed more frequently. The filter change indicator has been set to indicate filter change for typical household conditions; using the Air Purifier in environments with tobacco smoke, candle burning, construction work, sanding projects, wood-burning stove or fireplace smoke, or pets in the home may decrease the filter's life. The filter should be periodically checked for damage or blockage. A yellow caution light will come on when the filter is about 80% used. A flashing red warning light will come on when the filter needs to be changed.

Warning

- Read and understand the operating manual before using the Air Purifier.



Turning the Air Purifier On/Off:

- Ensure that the Air Purifier is plugged into a 120V AC outlet properly.
- Press the ON/OFF button on either the Air Purifier or the remote control to turn the Air Purifier on.
- The previous operation of the Air Purifier is automatically stored and will automatically be repeated when the purifier is restarted.
- Once the Air Purifier is on, pressing the ON/OFF button on the Air Purifier or remote control will turn the Air Purifier off.



Adjusting the Fan Speed:

- Once the Air Purifier is turned on, the fan speed can be adjusted to one of three settings.
- The fan speed is displayed on the controls display.
- Pressing the SPEED button on either the Air Purifier or the remote control will step between the three fan speeds of Low/Medium/High.
- If the fan speed is set at either Low or Medium, pressing the SPEED button will increase the speed to the next highest setting.
- If the fan speed is set at High, pressing the SPEED button will decrease the fan speed to Low.



Running in Automatic Mode:

- Running in Automatic Mode allows the air quality sensor to control the speed of the fan. The Air Purifier will run on higher speeds when more gases or odors are detected and on lower speeds when fewer gases or odors are detected.
- To run in Automatic Mode, press the AUTOMATIC MODE button on either the Air Purifier or the remote control. The light beside the Automatic Mode icon on the Air Purifier will illuminate when the Air Purifier is running in Automatic Mode.
- The Air Purifier will also display the current fan speed while running in Automatic Mode.
- To turn Automatic Mode off, press the FAN SPEED button to select a new speed.
- **Please note:** The air quality sensor takes several minutes to warm up when the Air Purifier is first plugged in. During this time, the Automatic Mode light on the Air Purifier will slowly flash. The light will stop flashing when the air quality sensor is warmed up and ready for use.

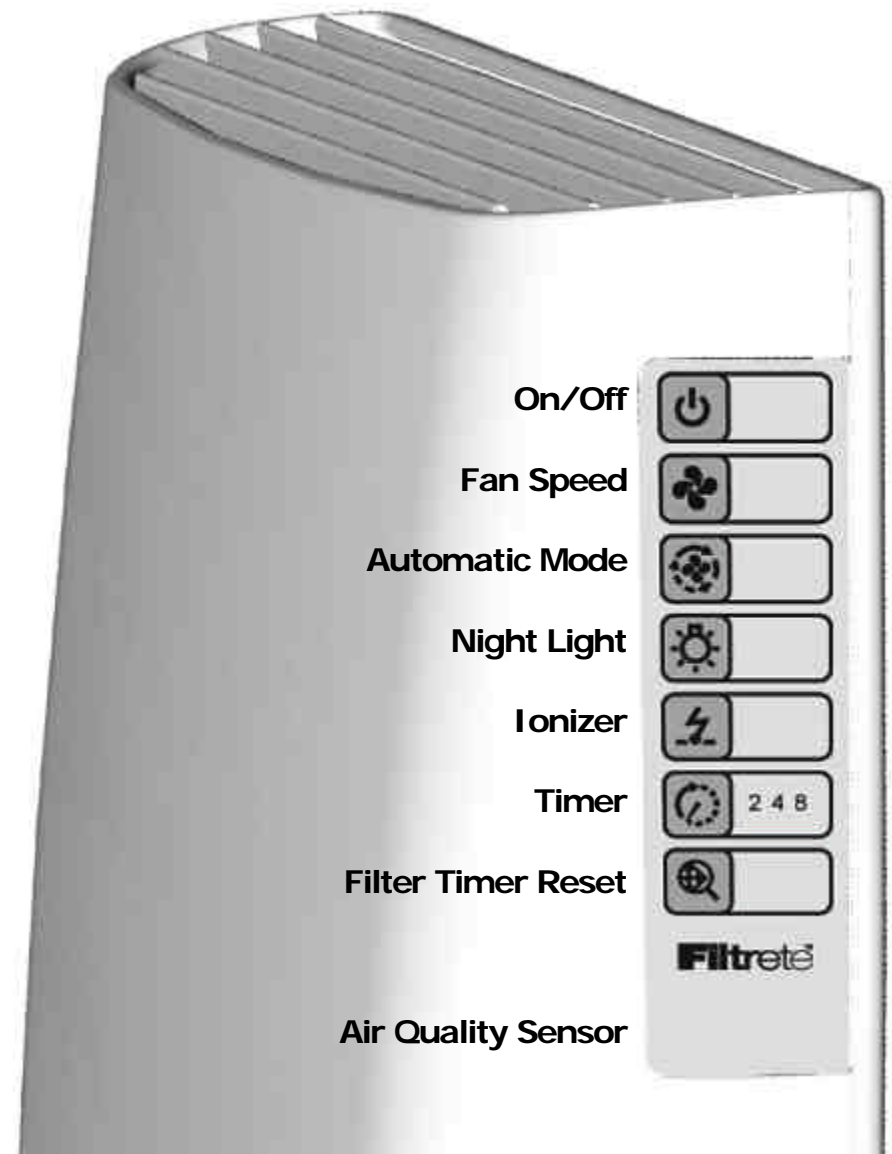



Using the Lighting Features:

- The lighting features include both the night-light and the backlit controls display. The Air Purifier has three different settings for the lighting features:
 1. Night-light and controls backlight on.
 2. Night-light off, controls backlight on.
 3. Night-light off, controls backlight off.
- To switch between modes, press the LIGHT button on either the Air Purifier or the remote control.
- For setting #3 (night-light off and controls backlight off), the LIGHT button will stay lit for easy identification. All other buttons will continue to work correctly, but will not be lighted.



Turning the Ionizer On/Off:

- The Air Purifier can be run with the ionizer on or off.
- The air will be cleaned more effectively with the ionizer turned on.
- The Air Purifier must be turned on for the ionizer to operate.
- Once the Air Purifier is turned on, the ionizer can be turned on or off by pressing the IONIZER button on either the Air Purifier or the remote control.
- The controls display on the Air Purifier indicates when the ionizer is turned on by illuminating a light next to the IONIZER button.



Setting the Timer:

- The Air Purifier has a built-in countdown timer that can be set for two, four, or eight hours.
- Press the TIMER button on either the Air Purifier or the remote control once to activate the timer.
- The timer will increase by one step each time the TIMER button is pressed.
- The timer can be turned off by pressing the TIMER button once while the eight hour setting is displayed.



Resetting the Filter Timer:

- When the filter is about 80% used, a yellow light will illuminate as a reminder to purchase a replacement filter.
- When the filter needs to be changed, the yellow light will turn red and start slowly flashing. Replace the filter immediately by following the instructions in the Filter Replacement section.
- To reset the filter timer, hold down the FILTER RESET button for three seconds. The red light will start flashing quickly while the button is depressed, and the Air Purifier will beep once after three seconds to indicate that the timer has been reset. Release the button.

Cleaning:

- Turn the room Air Purifier off and unplug it before cleaning.
- The outside of the room Air Purifier can be cleaned with a soft, clean, dampened cloth.
- The air inlet and outlet grills can be cleaned with a small, soft brush. To clean the air inlet grill, remove the inlet disc on the front of the Air Purifier. The disc is held in place with a magnet and is designed to be removed. The inlet disc only fits one way, so be sure to check the direction of the tabs on the inside of the disc before installation.
- If you wish to clean the inside of the Air Purifier, please only use a clean, dry, soft cloth to wipe it down. Please do not attempt to clean the ionizer needle because it may be damaged and cause the ionizer in the Air Purifier to malfunction.

Warning

- This equipment should be inspected frequently and collected dirt removed from it regularly to prevent excessive accumulation that may result in flashover or a risk of fire.

Filter Removal

- Turn off and unplug the Air Purifier before replacing the Air Purifier filter.
- Remove the filter cover on the back of the Air Purifier by grasping the filter door tabs on both sides of the filter door and pulling the cover outward.
- Lift the cover from the bottom cover slots to remove the cover from the Air Purifier.
- Set the cover aside.
- To remove the used filter: Grasp the top of the filter on both sides. Gently pull outward to clear the filter holding tabs. For easier removal, remove the filter one side at a time. Lift the filter out of the bottom filter slot.
- Dispose of the used filter properly.

Note: The ionizer needle may be touched when the filter is removed. Please do not touch the ionizer needle because it may be damaged and cause the ionizer in the Air Purifier to malfunction.

Warning

- Disconnect electrical power before servicing the filter.

Caution

- Dispose of the Air Purifier, batteries, and filters in accordance with local, state, and federal regulations.
- Replace the filter when the filter change timer begins flashing red.
- **The filter should be changed after no more than 90 days of continuous use, or sooner depending on the conditions in your home.**
- Periodically inspect the filter for damage or blockage.

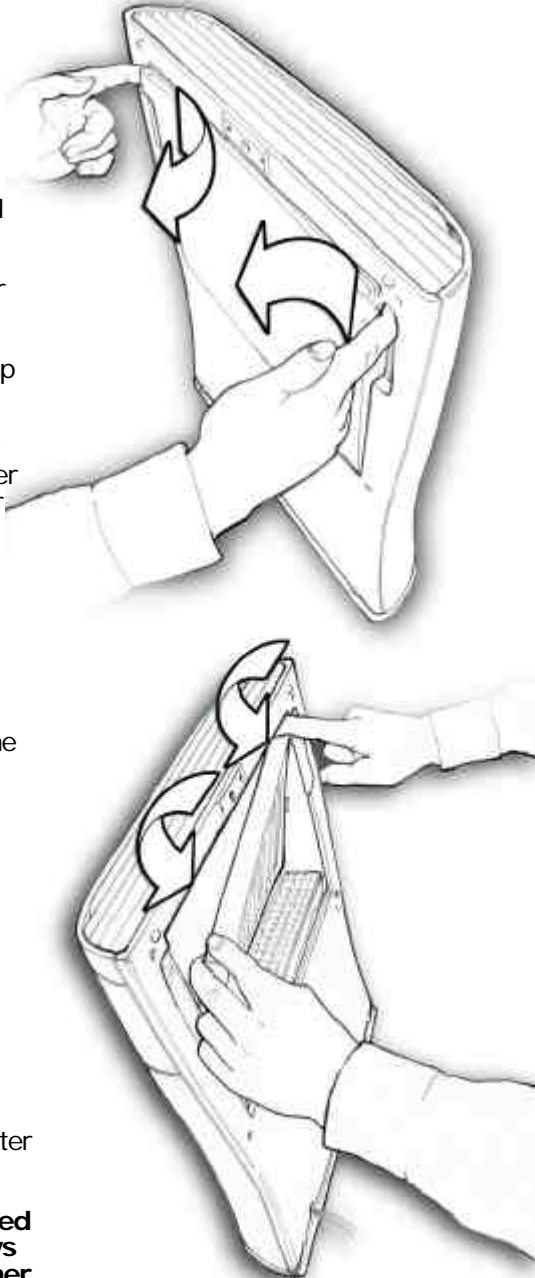

Filter Replacement

Use only Filtrete™ brand replacement filters in this Air Purifier

- Remove the plastic wrapper and paper insert on the replacement filter.
- Be sure that the filter is aligned properly. The arrow on the side of the filter should point toward the Air Purifier when you install the filter.
- To install the filter: Securely position the bottom of the filter in the bottom filter slot. Gently push the top of the filter toward the Air Purifier until it snaps past the filter holding tabs and into position.
- The final air seal of the filter occurs when air flows through the filter and presses it against the filter sealing track.
- Replace the filter cover by placing the bottom tabs on the cover into the slots in the Air Purifier. Push the top of the cover toward the Air Purifier until the cover locks into place.
- Plug the Air Purifier into a 120V AC outlet and turn it back on.
- To reset the filter timer, hold down the  FILTER RESET button for three seconds. The red light will start flashing quickly while the button is depressed, and the Air Purifier will beep once after three seconds to indicate that the timer has been reset. Release the button.

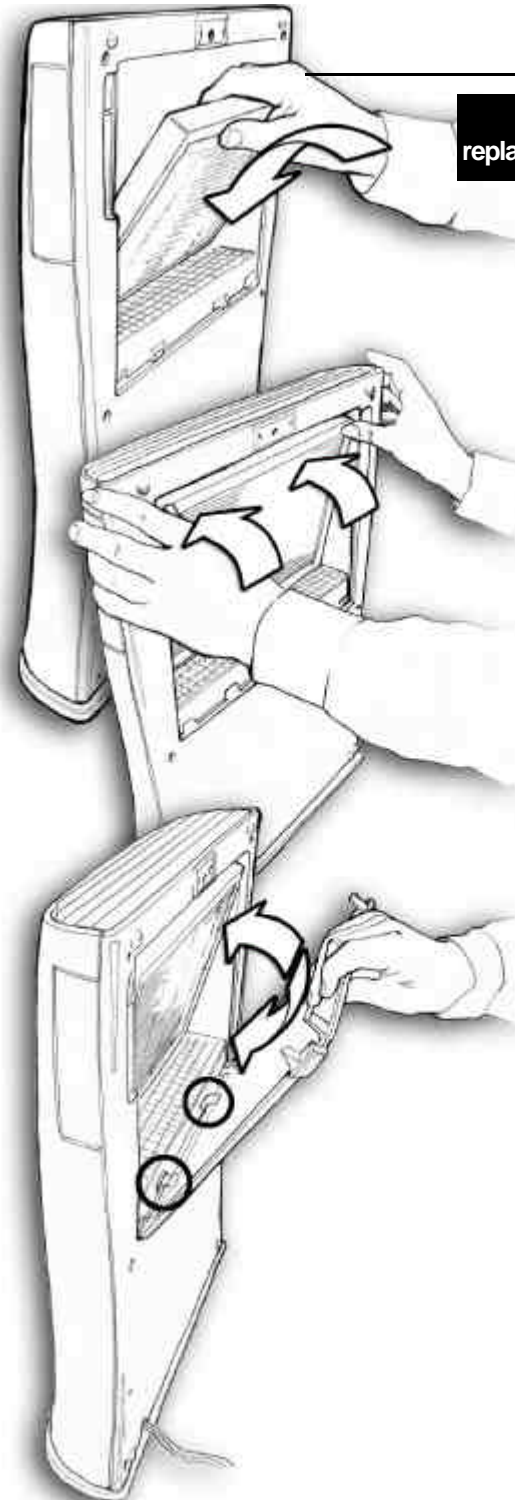

Warning

- Do not modify or attempt to modify this product.
- Do not disassemble the Air Purifier.
- Except for filter replacement, the Air Purifier is not intended to be serviced and does not contain any serviceable replacement parts or adjustments.
- Do not use if the interlock switch is damaged.
- Do not attempt to override the interlock switch.

Replacement filter doesn't fit:

- Check the model number on the filter. It should be FAPF-04.
- Make sure that the bottom of the filter is properly placed in the bottom filter slot.
- Make sure that no foreign objects are blocking the filter opening.
- A small force is required to push the filter past the filter holding ribs: try installing with greater force.

Air Purifier will not turn on:

- Be sure the Air Purifier is properly plugged into a 120V AC outlet.
- Be sure the Air Purifier is turned on.
- Check if a fuse is blown or if a circuit breaker has been tripped.

Remote control does not operate:

- Try using the remote control closer to the Air Purifier.
- Be sure that the 12V alkaline battery is fresh and installed properly.

Decreased airflow:

- Check the Air Purifier to make sure that nothing is blocking the air inlet and filtered air outlet.
- Check the condition of the filter and if dirty, replace with a new Filtrete™ FAPF-04 filter.

Noisy operation:

- Check the condition of the filter and if dirty, replace with a new **Filtrete™ FAPF-04** filter.
- Be sure that nothing is blocking the air inlet or filtered air outlet.

Assistance or Questions

For more information about using this Air Purifier, visit our web site at www.filtrete.com or call 1-800-388-3458 from the United States or Canada.

Warranty

Limited Warranty. This product will be free from defects in material and manufacture for a period of one year from the date of purchase. The user is responsible for determining whether the product is fit for a particular purpose and suitable for the user's application. If this 3M product is defective within the warranty period stated above, your exclusive remedy and 3M's sole obligation shall be, at 3M's option, to replace the 3M product or refund the purchase price of the 3M product. This warranty does not cover normal wear and tear or damage resulting from accident, misuse, use of alternate filters, alteration, or lack of reasonable care.

This warranty gives you specific legal rights, and you may have other rights which may vary from state to state or country to country. To obtain warranty service contact 3M at 1-800-388-3458.

Limitation of Liability

3M will not be liable for any loss or damage arising from this 3M product, whether direct, indirect, special, incidental or consequential, regardless of the legal theory asserted, including warranty, contract, negligence or strict liability. Some states and countries do not allow the exclusion or limitation of incidental or consequential damages, so the above limitation or exclusion may not apply to you.

Filtrete is a trademark of 3M Company. © 3M 2006