

DLT-100 User Guide

DIGI·WAVE



DLT 100

digital listening transceiver

portable conference / 2-way tour guide / portable interpretation system

WILLIAMS SOUND®

What's included with DLT-100

- ① DLT-100
- ② USB Cable
- ③ Adaptor
- ④ Plug 1 (Europe)
- ⑤ Plug 2 (England)
- ⑥ Plug 3 (Australia)

①



②



③



④



⑤



⑥



Location of Controls

⑤ External Mic. Jack(3.5mm)

⑥ External Headphone Jack(3.5mm)

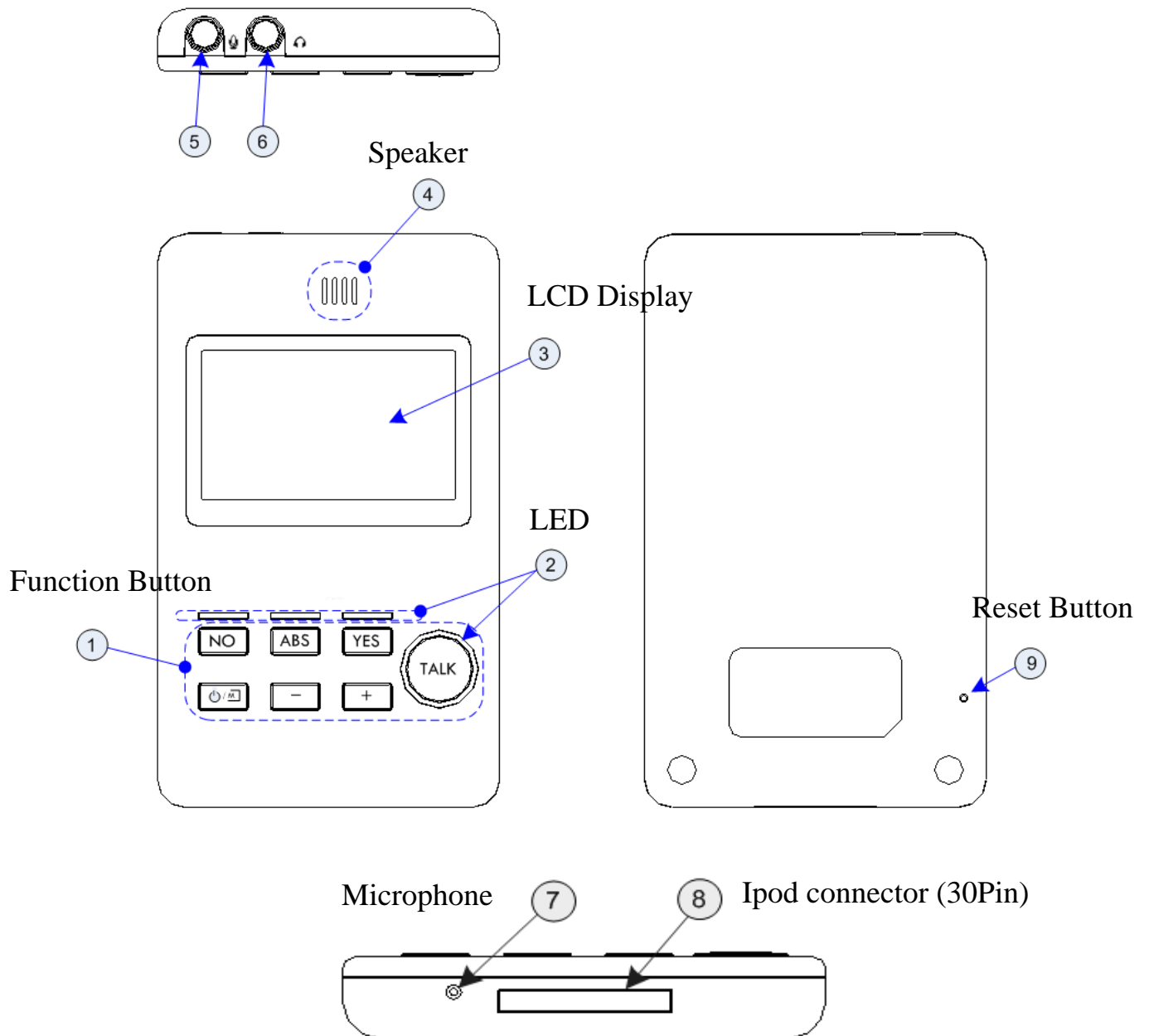

Simultaneous Interpretation Mode



Simultaneous Interpretation Mode

1. Setting procedure for Interpretation Mode

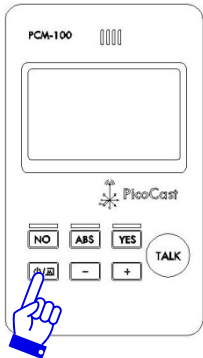

Press and hold power button for 2 seconds to turn DLT-100 on

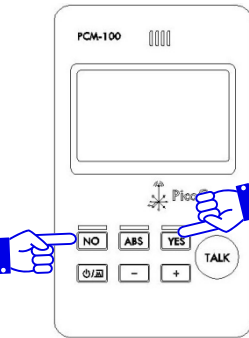
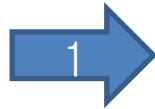

Press No and Yes button together for 2 second

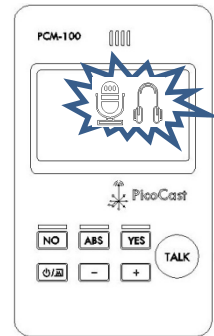
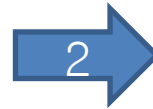

Mode icon will blink on LCD

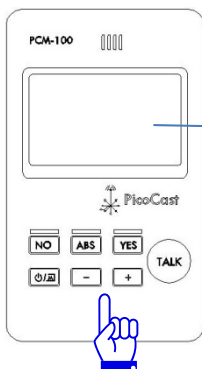

Press (+) or (-) button to select mode

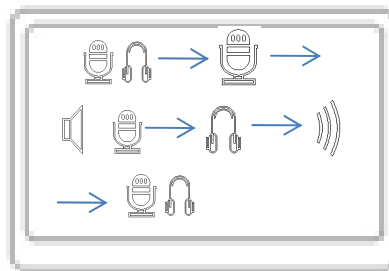

Press (-) button, the mode will be changed in above sequence.
Press (+) button, reverse sequence.

Note

In Interpretation Mode 3 different mode can be used as shown in left side. Each has different role but they all can be used in Interpretation system

 Main Speaker

 Interpreter

 AP(relay)

 Receiver only

Simultaneous Interpretation Mode

1. Setting procedure for Interpretation Mode

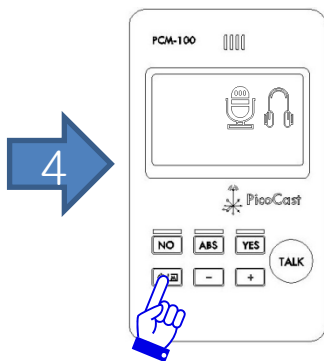

Press mode button to select interpretation mode



When mode selection is made then SLV icon will blink

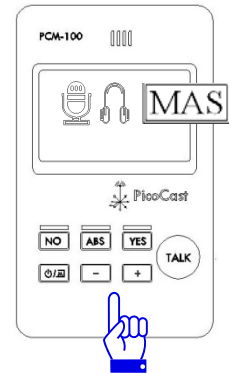

Press (+) or (-) button to select SLV or MAS
SLV- Slave
MAS-Master

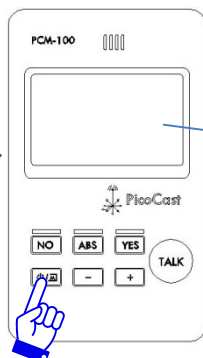

Press mode button to select SLV or MAS



Note

When channel number is at No.1, (-) button will not work

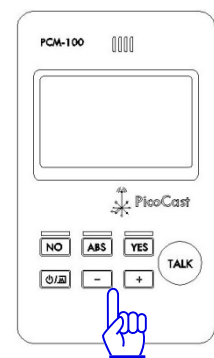
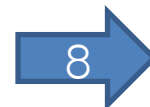

Press (+) or (-) button to select transmitting channel number

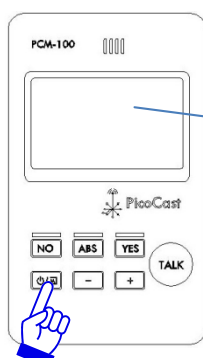

Press mode button to select channel number

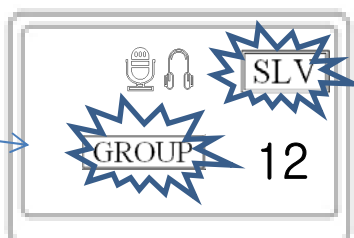

When channel number selection is made then Group icon will blink and number will be shown

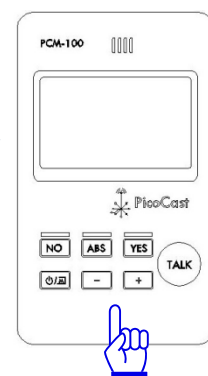
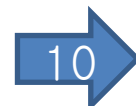

Press (+) or (-) button to select group number

Simultaneous Interpretation System

1.Setting procedure for Interpretation System

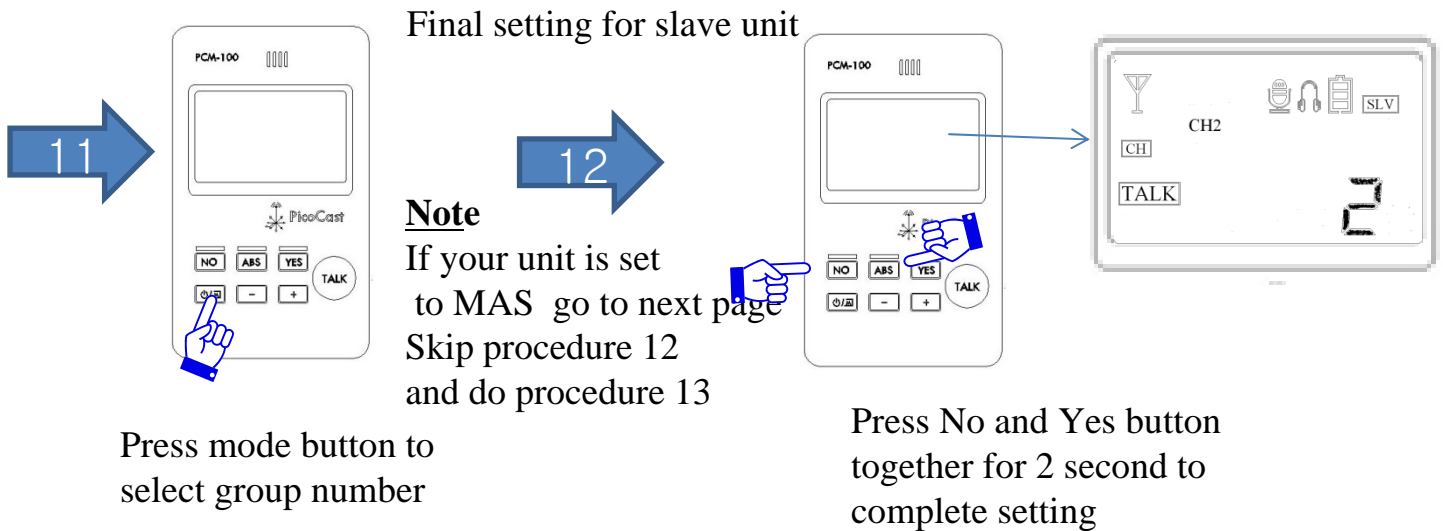

Simultaneous Interpretation System

1.Setting procedure for Interpretation System

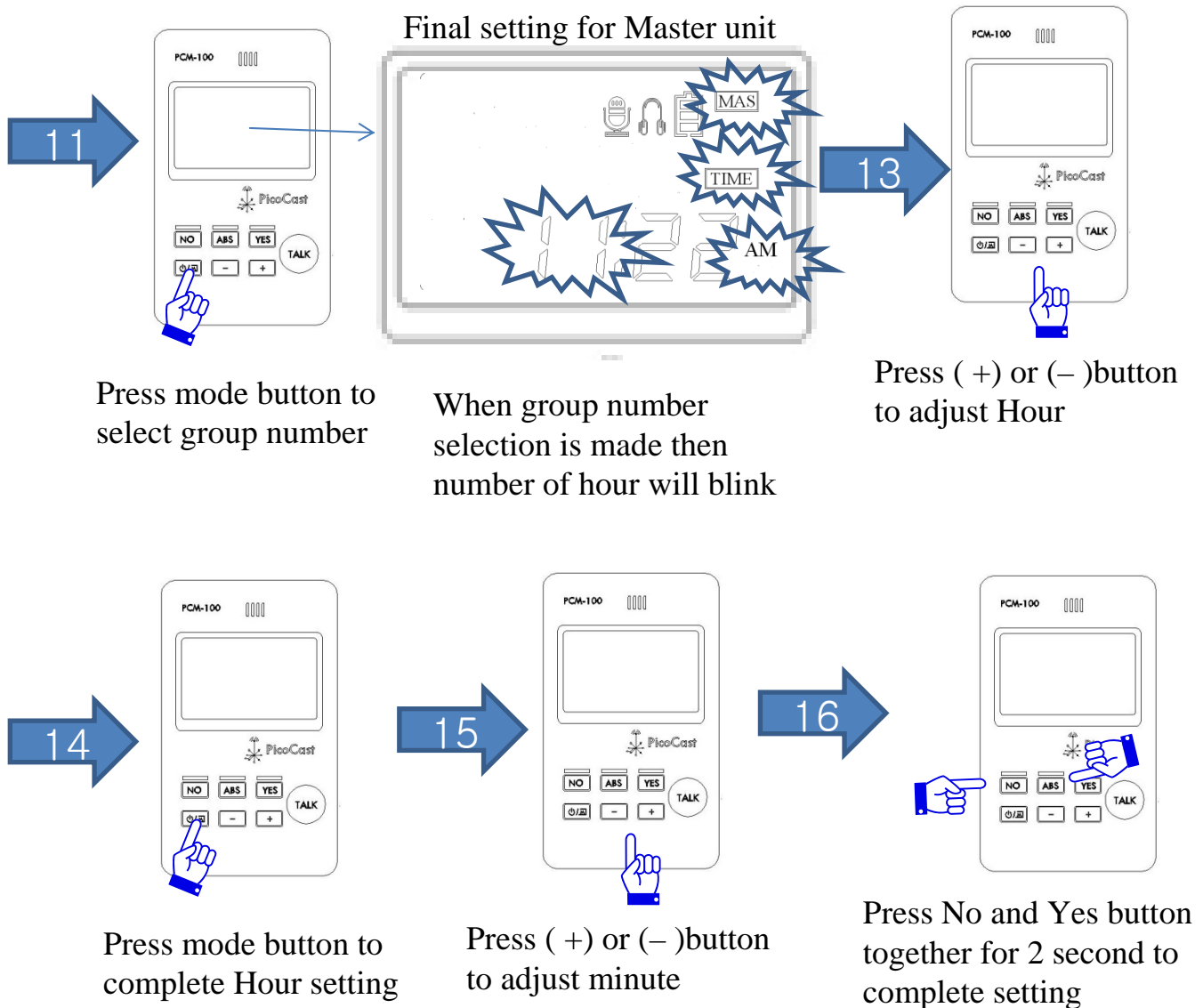

Note:

- 1.Master and Slave unit must have same group number
- 2.Transmitting Channel must be set different
- 3.Must have one master in a group

Simultaneous Interpretation Mode

CASE1)



Interpreter -3 units
Receiver – 20 units



English
Ch1

Chinese
Ch2

Korean
Ch3

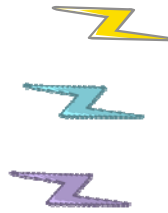

Select Channel and Listen



CASE2)



Main Speaker
is set to
“0” Channel



Interpreter -A
Ch1



Interpreter -B
Ch2



Main Speaker -1 units
Interpreter – 2 units
Receiver – 20 units

Select Channel and Listen



CASE3)



Interpreter -A
Ch1



AP (=Repeater)
Extend the
distance



Two-way tour guide mode (conference mode)

2. Setting procedure for Two-way tour guide mode(conference mode)

→ Mode change from interpretation to Two-way tour guide mode

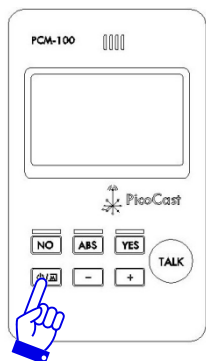

Press and hold power button for 2 seconds to turn DLT-100 on

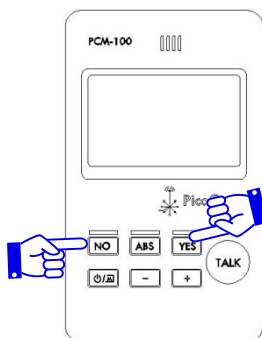
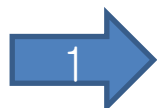

Press No and Yes button together for 2 second

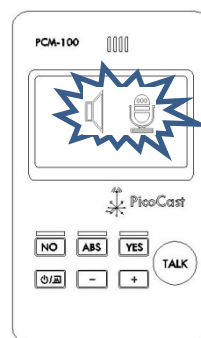
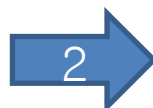

Mode icon will blink on LCD

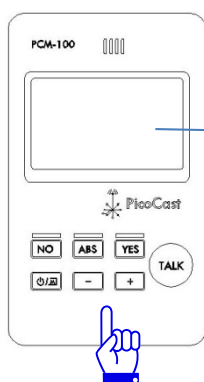

Press (+) or (-)button to select mode

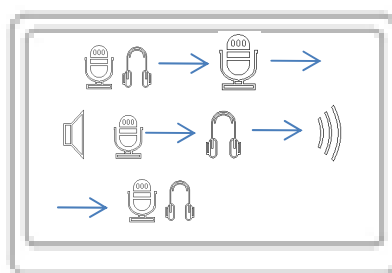

Press (-) button, the mode will be changed in above sequence.
Press (+) button, reverse sequence.



Select tour guide system

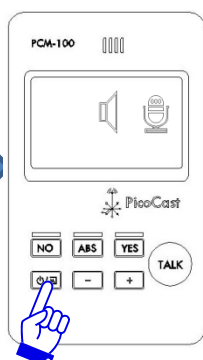

Press mode button to select tour guide system



When mode selection is made then CHAIRMAN SLV will blink

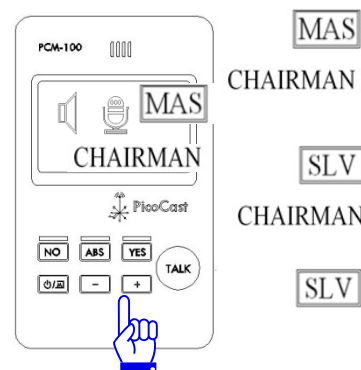

Press (+) or (-)button to select CHAIRMAN /SLV, CHAIRMAN₀ /MAS, SLV

Two-way tour guide mode (conference mode)

2. Setting procedure for Two-way tour guide mode(conference mode)

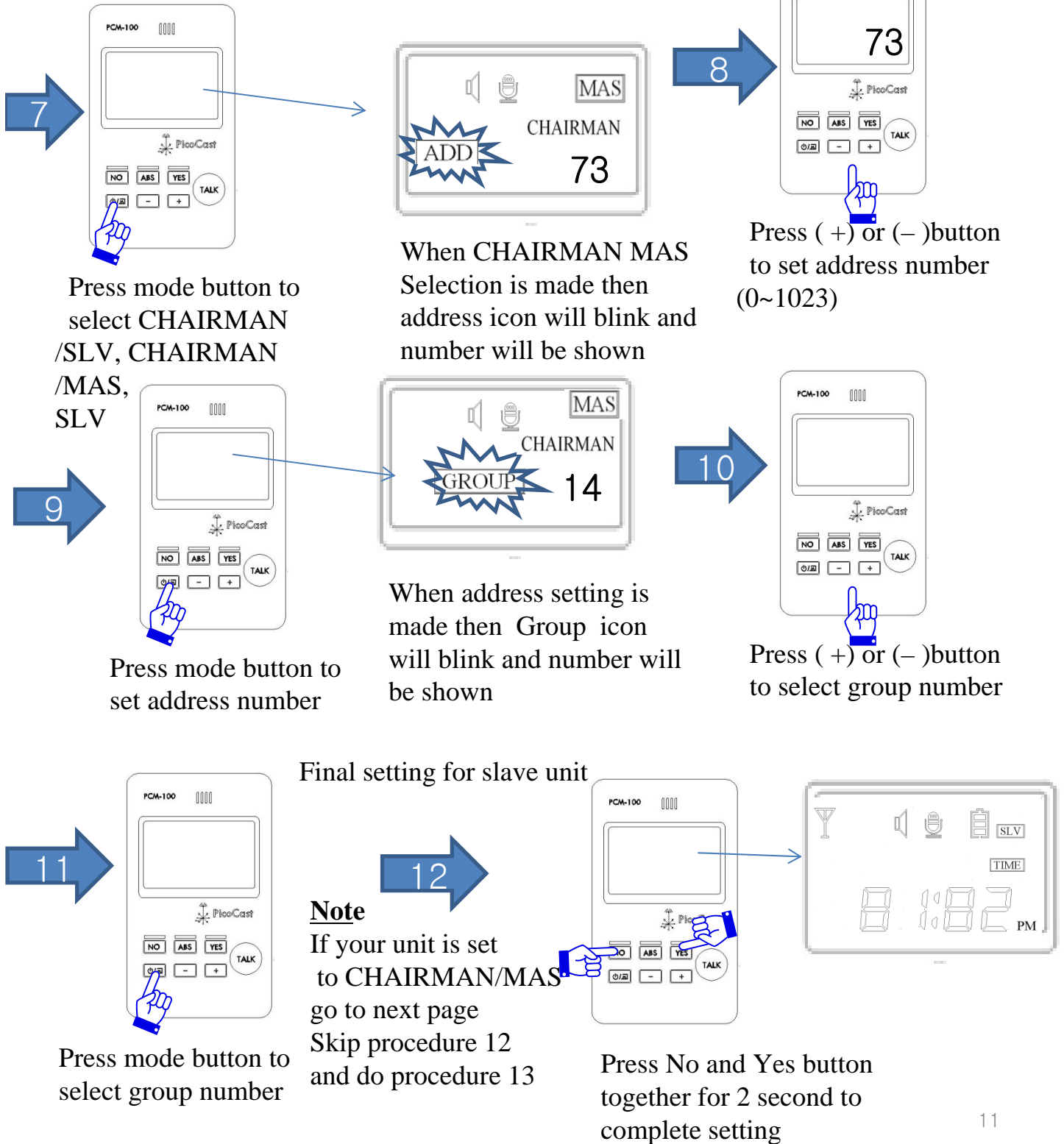

Two-way tour guide mode (conference mode)

2. Setting procedure for Two-way tour guide mode(conference mode)

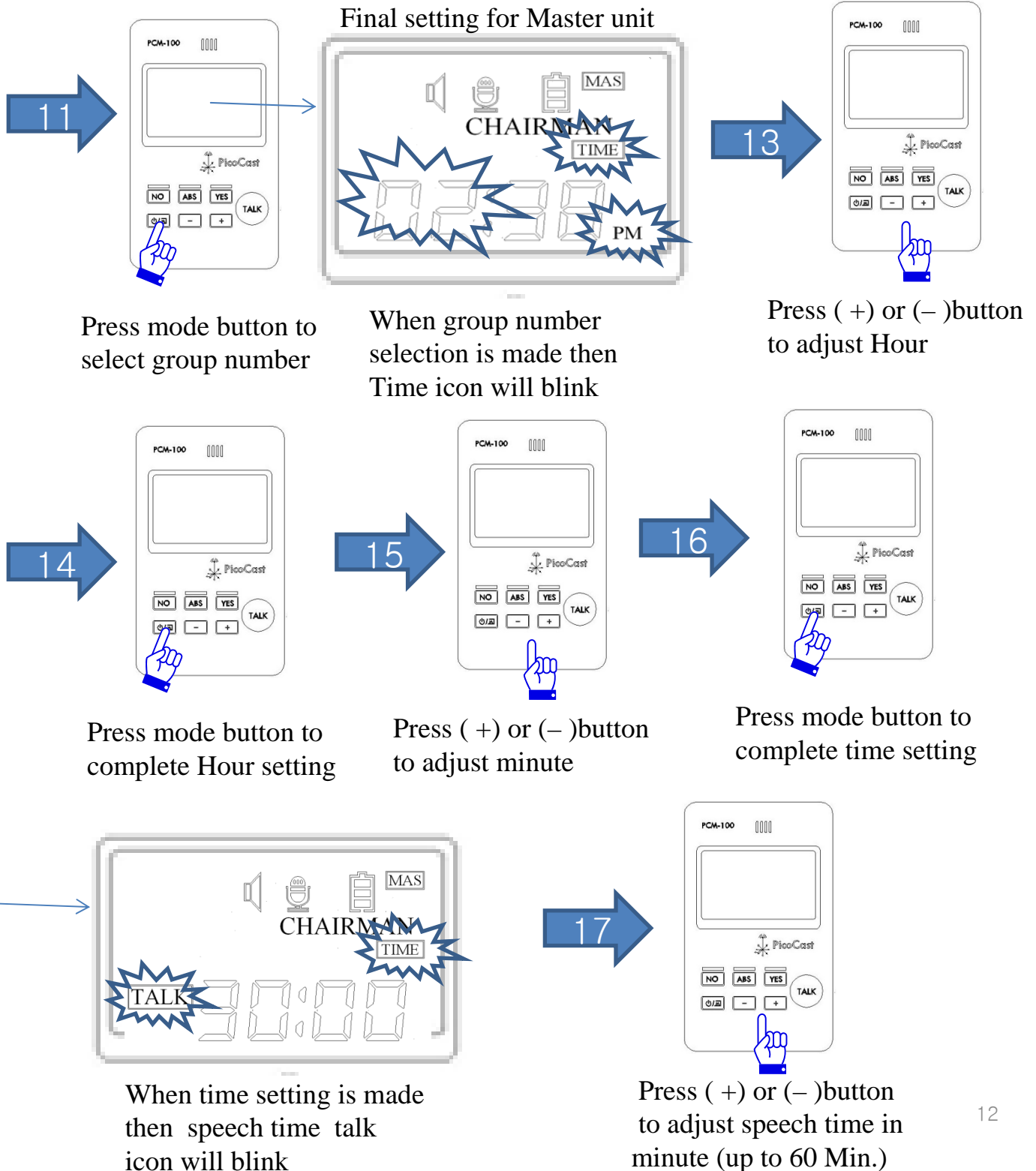

Two-way tour guide mode (conference mode)

2. Setting procedure for Two-way tour guide mode (conference mode)

Note

If you don't want to set speech time, please set speech time to "0"

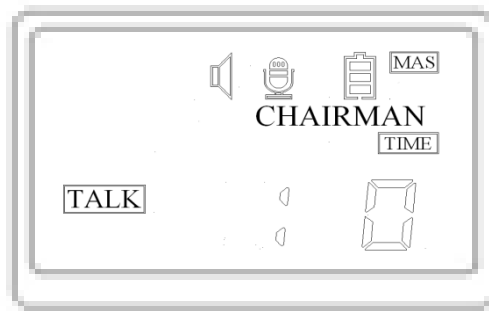

18

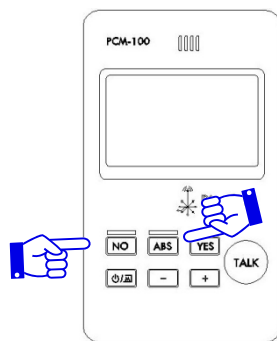

Press No and Yes button together for 2 second to complete setting



Note:

- 1.Master and Slave unit must have same group number
- 2.Must have one master in a group

Two-way tour guide mode (conference mode)

CASE1)

Tour guide phone-2 units
Receiver – 20 units



English

Chinese

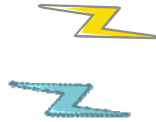

Just Listen



CASE2)

Tour guide phone-3 units
Receiver – 20 units

Two way
communication



Two people can talk at the same time

Just Listen



Troubleshooting

Problems	Cause	What to do
Power does not turn-on	Discharge of battery	Charge the battery
Power turned off automatically	Master device can't be found	Set Master device
Power doesn't turn off	Program Error	Press reset button on the backside of device
Have difficult of hearing sound (noise, disconnection)	Disconnection of earphone	Check Earphone Connection
	Master doesn't exist	Set Master
	Different Group Number settings	Setting every unit in same group number
	Out of range	Enter the range of 30~50m from the master unit
	More than 1 master exist in a group	Set one master per group
	Obstacle Exist	Move to another places or move the obstacles
	More than 2 units with Same address exist in a group	Set address different
Error in attendees checking	More than 2 units with Same address exist in a group	Set address different
Error in electronic voting results	More than 2 units with Same address exist in a group	Set address different
	Master unit can count ballots up to 99 only	Vote up to 99 people only
	Not recognizable address exist	Set Address number between 0 ~ 99
Unable to select receiving channel	Transmitting channel is overlapping	Set different transmitting channel
Unable to transmitting Interpretation	Please check the mode for simultaneous interpretation mode	set simultaneous interpretation mode
	More than 2 master units exist	Set one master only

- A/S phone Number: 952-943-2252
- Williams Sound Corp. A/S Team
- 10321 West 70th Street Eden Prairie, MN55344 U.S.A

FCC Part 15.19

This device complies with part 15 of the FCC Rules. Operation is subject to

The following two conditions:

- (1) This device may not cause harmful interference, and
- (2) this device must accept any interference received, including interference that may cause undesired operation.

FCC Part 15.21

Any changes or modifications (including the antennas) made to this device that are not expressly approved by the manufacturer may void the user's authority to operate the equipment.

FCC Part 15.105

Note : This equipment has been tested and found to comply with the limits for a Class B digital device, pursuant to part 15 of the FCC Rules. These limits are designed to provide reasonable protection against harmful interference in a residential installation. This equipment generates, uses and can radiate radio frequency energy and, if not installed and used in accordance with the instructions, may cause harmful interference to radio communications. However, there is no guarantee that interference will not occur in a particular installation. If this equipment does cause harmful interference to radio or television reception, which can be determined by turning the equipment off and on, the user is encouraged to try to correct the interference by one or more of the following measures:

- Reorient or relocate the receiving antenna.
- Increase the separation between the equipment and receiver.
- Connect the equipment into an outlet on a circuit different from that to which the receiver is connected.
- Consult the dealer or an experienced radio/TV technician for help.

RF Exposure Statement

FCC RF Radiation Exposure Statement: This equipment complies with FCC RF Radiation exposure limits set forth for an uncontrolled environment. This device and its antenna must not be co-located or operating in conjunction with any other antenna or transmitter.

IC Number: 1360A-DLT100**RSS-GEN 7.1.5**

Operation is subject to the following two conditions:

- (1) this device may not cause interference, and
- (2) this device must accept any interference, including interference that may cause undesired operation of the device.

Caution:

Any changes or modifications to the equipment not expressly approved by the party responsible for compliance could void user's authority to operate the equipment.

This equipment complies with IC radiation exposure limits set forth for an uncontrolled environment.

To maintain compliance with IC RC exposure compliance requirement, please avoid direct contact to the transmitting antenna during transmitting.

This device and its antenna must not be co-located or operating in conjunction with any other antenna or transmitter. End users must follow this specific operating instructions for satisfying RF exposure compliance