

Antenna Details:

Type	Manufacturer	Part Number	Gain
Patch	Centurion	CAF94131	1.5 dBi
Dipole	Radiall	R380.500.117	2 dBi
Dipole	Radiall/Larsen	R380.500.116	2 dBi

All the antennas meet the requirements of 15.203. The dipoles use a reverse polarity SMA. The patch is installed at the factory, integral to the host device, and is not user accessible.

MicroBlue

Internal Wireless Antenna

Part Number (P/N):
CAF94131

Features:

- Versatile and easy to use antenna for 2.4 to 2.5 GHz Bluetooth and IEEE 802.11 devices
- Designed for easy connection to radio cards
- Utilizes Centurion's patented PCB Microsphere technology
- Has a ground plane incorporated into the resonator structure, therefore no additional ground plane is required to radiate efficiently

Specifications:

Frequency Range	2.4 – 2.5 GHz
Polarization	Linear
Peak Gain	1.5 dBi
Average Gain	>0 dBi
Nominal Impedance	50 ohms
VSWR (Min. Performance)	< 1.8:1 from 2.4 GHz to 2.5 GHz 2:1 VSWR Bandwidth > 600 MHz
Temperature Range	-40° to +85°C
Vibration	6G RMS (9.04g ² /Hz) for 15 minutes each in vertical and horizontal. No appearance or functional axis.
Thermal Shock	Change after 4 repeated cycles of 1 hr. at +85°C and 1 hr. at -40°C. Transfer time is 5 min.
Size (inches)	.89" x 1.88" x .032" (w x l x t)
Standard Cable	RG-178 (MIL-C17) Coaxial Cable x 8" Long
Standard Connector	Right-Angle MMCX Plug



MicroBlue 2.4 shown here with standard 8 inches of RG-178 coax and right angle MMCX connector

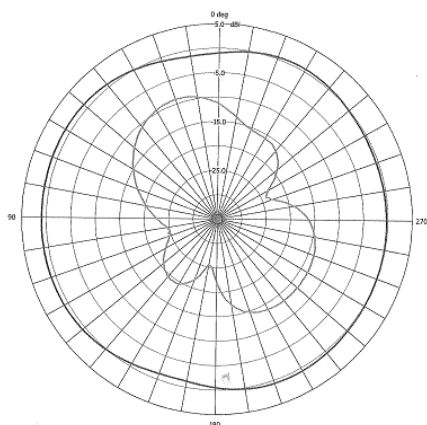

**Azimuth Plane
2450 MHz**

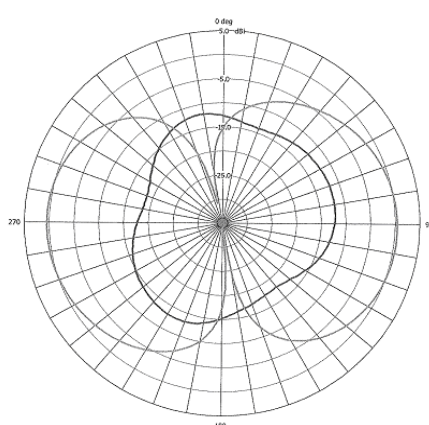

**Elevation Plane, Phi = 0
2450 MHz**

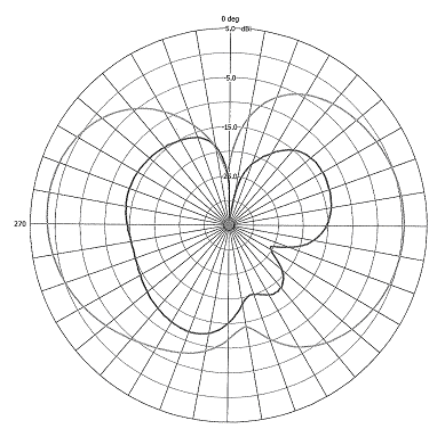

**Elevation Plane, Phi = 90
2450 MHz**

Specifications subject to change without notice

MicroBlue – 10/28/02

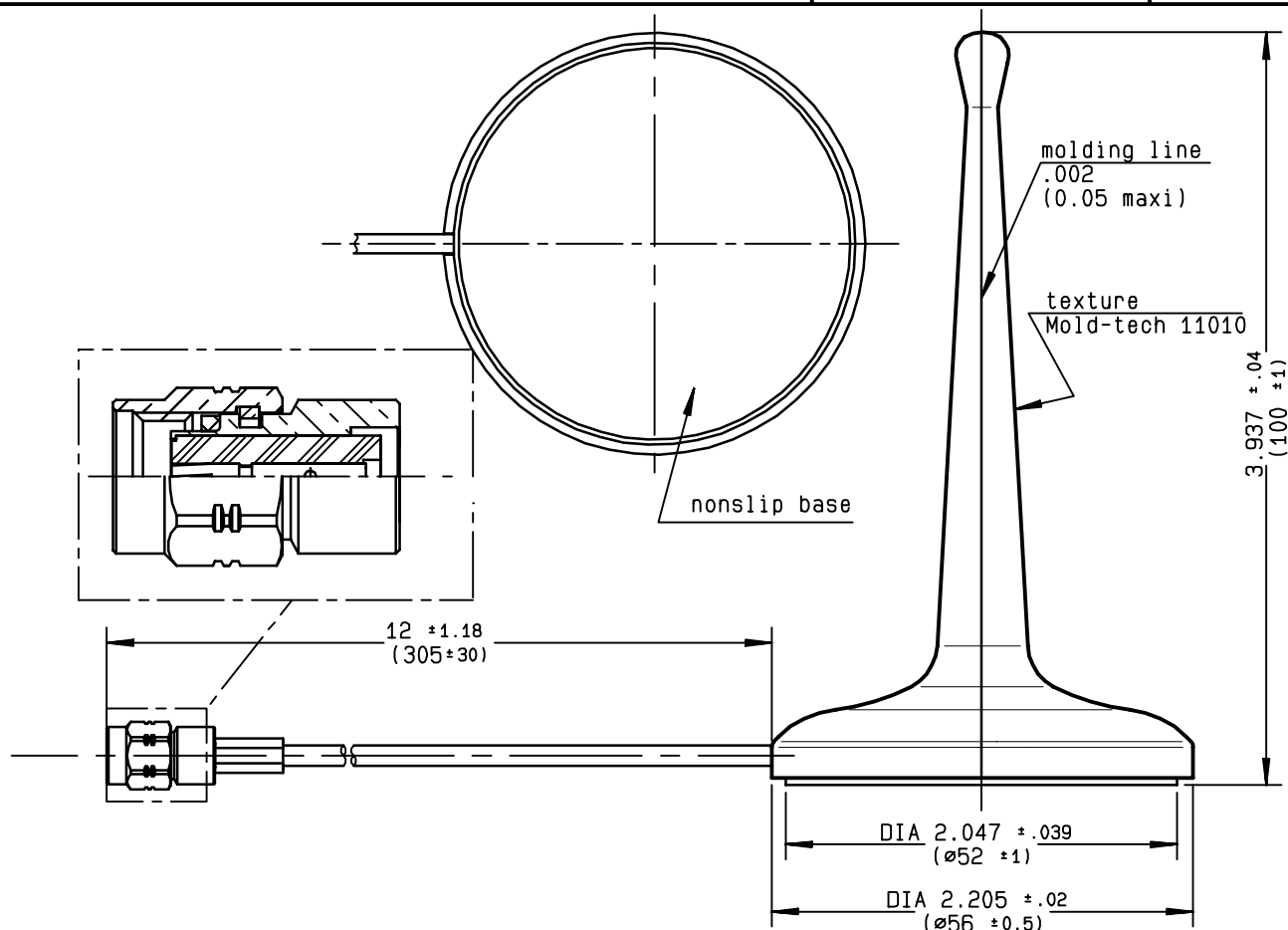

ELECTRICAL SPECIFICATIONS

Operating frequency range	:2400-2500 MHz
VSWR	:2:1
Impedance	:50 Ω
Polarization	:Vertical (antenna axis)
Vertical 3 dB beamwidth	:80
Gain	:2 dBi
Gain including cable	:1 dBi
Radiation pattern	:Omni directionnal in the Horizontal plane
Power input	:2 Watt

MECHANICAL SPECIFICATIONS

Weight	:50,2g
Connector	:polarized SMA PLUG
Color	:Black(RAL 9004)
radome material	:TPE(thermo.poly.elast.)

ENVIRONMENTAL SPECIFICATIONS

Operating Temperature	:-30 °C to +85 °C
Humidity	:Up to 100% @38 °C

COSMETIC PARAMETERS

- No scratches
- No mold release
- No sink marks
- No bright spots

Initiated on 25/04/00

Approval by RIGOLAND

The information given here is subject to change without notice. Design changes may be in order to improve the product.

STRAIGHT DIPOLE SMA 2.4GHZ
OMNIDIRECTIONAL ANTENNA

R380.500.116

Series : ANTENNE

Scale 1:1

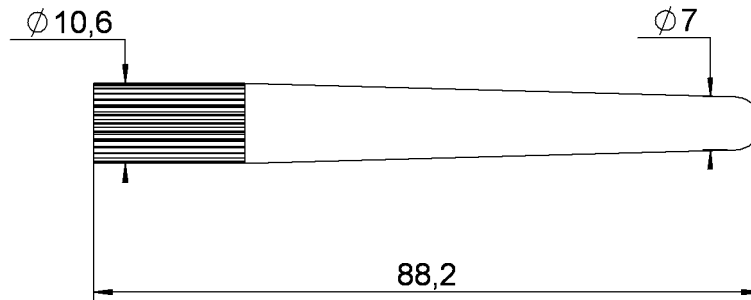

PVC Black

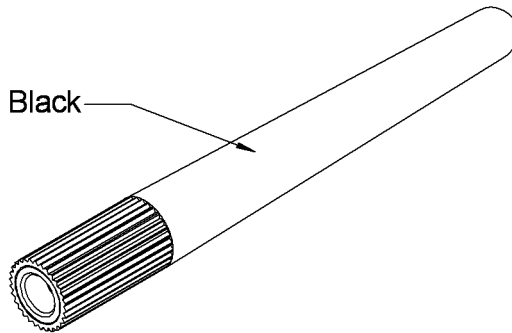

Scale 4:1

Reverse SMA Plug

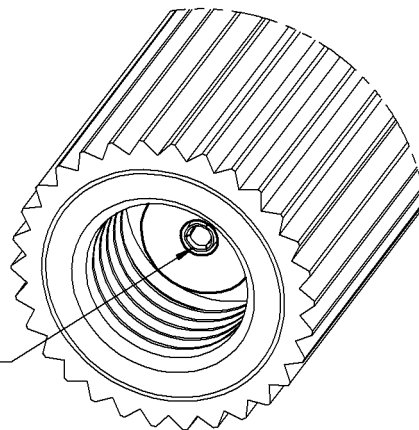

All dimensions are in mm



Issue : 0241 A

In the effort to improve our products, we reserve the right to make changes judged to be necessary.

RADIAL / LARSEN
antenna technologies

**STRAIGHT DIPOLE SMA 2.4GHZ
OMNIDIRECTIONAL ANTENNA****R380.500.116**

Series : ANTENNE

ELECTRICAL CHARACTERISTICS

Frequency :	2.4-2.5 GHz
Nominal Impedance :	50 Ω
VSWR :	2 Max
Gain (Overall gain) :	2 dBi
Radiation Pattern -3 dB beamwidth	Omni-directional in the horizontal plane
Vertical Plane :	80 °
Polarization :	VERTICAL
Connector type :	Reverse SMA Plug

MECHANICAL CHARACTERISTICS

Plastic radome :	PVC
Color :	BLACK RAL 9004
Weight :	9 g
Overall length :	88 mm

ENVIRONMENTAL CHARACTERISTICS

Operating temperature :	-40/+70 ° C
Humidity :	Up to 100% @ 38° C

Issue : 0241 A

In the effort to improve our products, we reserve the right to make changes judged to be necessary.

RADIALL / LARSEN
antenna technologies