

EN.book Page 1 Wednesday, July 11, 2012 2:31 PM

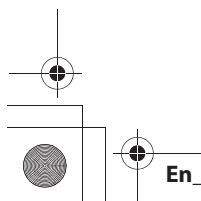

En_Fr_Es_Pb_01

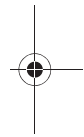
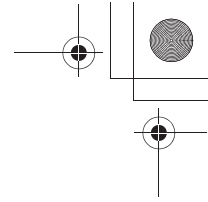
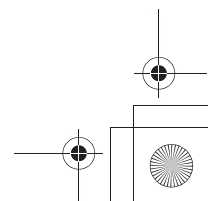

Nikon

Quick Start Guide

Confirming the Package Contents	3
First Steps	5
Shooting and Playback	14
Using ViewNX 2	20
Other Functions	26
For Your Safety	32

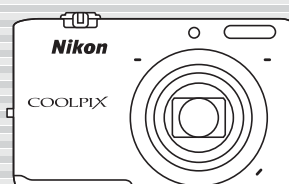

En

COOLPIX S6500

Thank you for purchasing the Nikon COOLPIX S6500 digital camera. This guide introduces the procedures necessary for first time use of this camera. To ensure proper use, please read and thoroughly understand the information in "For Your Safety" (pages 32–35) before using the camera. For more detailed information, please refer to the digital *Reference Manual*, which is located on the included CD-ROM. For information on viewing the camera's digital *Reference Manual*, see "Viewing the "Reference Manual CD"" described below. Should you need technical support, we offer a number of options.

Internet

Please visit the Nikon support home page, where you can:

- Search Nikon's continuously updated Knowledge Database for the latest technical support information.
- Use "Ask Nikon a Question" to receive a prompt reply from a Nikon professional advisor to your e-mail.
- Download the latest versions of Nikon software or firmware updates for your product, or register to receive e-mail notification for software or firmware updates.

For customers in the United States: www.nikontechusa.com

For customers in Canada: help.nikon.ca (English), nikoncanada-fr.custhelp.com (Français)

For customers in Mexico: nikon.com.mx/soporte

For customers in Brazil: <http://nikon.com.br>

Telephone

Please call for technical support and other product assistance. Our professional advisers are standing by to help with your digital camera needs.

For customers in the United States: **1-800-NIKON-UX (1-800-645-6689)**

For customers in Canada: **1-877-534-9910**

For customers in Mexico: **001-888-565-5452**

For customers in Brazil: **0800-886-4566 (0800-88 NIKON)**



Viewing the "Reference Manual CD"

The *Reference Manual* can be viewed using Adobe Reader, available for free download from the Adobe website.

1 Start the computer and insert the "Reference Manual CD".

2 Double-click the CD (COOLPIX S6500) icon in **Computer** or **My Computer** (Windows) or on the desktop (Mac OS).

3 Double-click the **INDEX.pdf** icon to display the language selection screen.

Click a language and follow the links to view the *Reference Manual*.

An Important Notice about Accessories

Nikon COOLPIX digital camera is designed to the highest standards and includes complex electronic circuitry. Only Nikon accessories, such as battery chargers, batteries, Charging AC Adapters, and AC adapters are certified by Nikon specifically for your Nikon COOLPIX camera and are engineered and tested to operate within the requirements of the electronic circuitry of our cameras.

THE USE OF NON-NIKON ACCESSORIES MAY DAMAGE YOUR CAMERA AND WILL VOID YOUR NIKON WARRANTY.

Genuine Nikon accessories are available through your Nikon-authorized dealer.

Confirming the Package Contents

In the event that any items are missing, please contact the store where you purchased the camera.



COOLPIX S6500
Digital Camera



Camera Strap



Rechargeable Li-ion
Battery EN-EL19
(with battery case)



Charging AC Adapter
EH-70P*



USB Cable UC-E6



Audio Video Cable
EG-CP16



ViewNX 2 CD



Reference Manual CD

- Quick Start Guide (this guide)
- Warranty

* A plug adapter is included if the camera was purchased in a country or region that requires a plug adapter. The shape of the plug adapter varies with the country or region of purchase (📖8). The included charging AC adapter is EH-70P in countries other than Brazil, and EH-69C in Brazil.

NOTE: A Secure Digital (SD) memory card, hereafter referred to as a "memory card," is not provided.

📖: This icon indicates that more information is available elsewhere in this guide.

Parts of the Camera

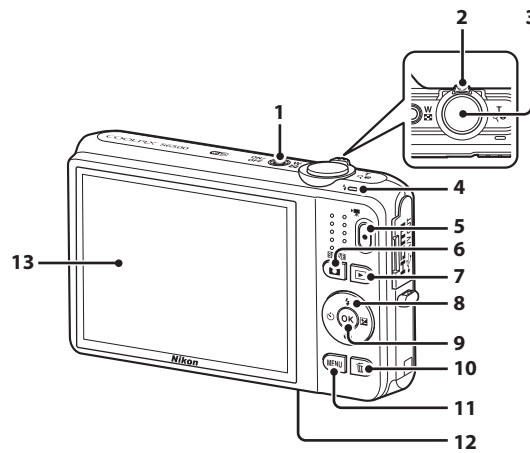

- 1** Power switch/power-on lamp
- 2** Zoom control
- 3** Shutter-release button
- 4** Charge lamp/flash lamp
- 5** ● (movie-record) button
- 6** 📷 (shooting mode) button
- 7** ▶ (playback) button

- 8** Multi selector
- 9** ⓧ (apply selection) button
- 10** 🗑️ (delete) button
- 11** MENU button
- 12** Battery-chamber/memory card slot cover
- 13** Monitor

4

Confirming the Package Contents

First Steps

Step 1 Attach the Camera Strap

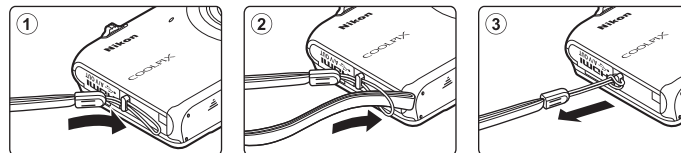

Step 2 Insert the Battery and Memory Card

If a memory card is inserted, images will be saved on the memory card when you take images. If a memory card is not inserted, images will be saved in the camera's internal memory (approximately 25 MB).

2.1 Open the battery-chamber/memory card slot cover.

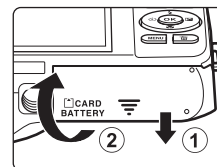

2.2 Insert the included EN-EL19 battery (rechargeable Li-ion battery).

- Use the battery to push the orange battery latch up in the direction indicated by the arrow (①), and fully insert the battery (②).
- When the battery is inserted correctly, the battery latch will lock the battery in place.

⚠ Inserting the Battery Correctly
Inserting the battery upside down or backwards could damage the camera.
Be sure to check that the battery is in the correct orientation.

Battery latch

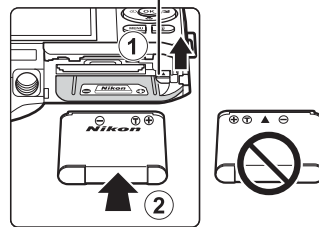

2.3 Insert the memory card.

- Slide the memory card in until it clicks into place.

⚠ Inserting the Memory Card Correctly
Inserting the memory card upside down or backwards could damage the camera or the memory card. Be sure to check that the memory card is in the correct orientation.

Memory card slot

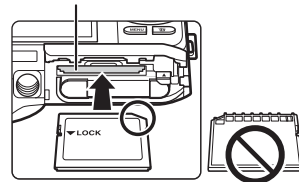

2.4 Close the battery-chamber/memory card slot cover.

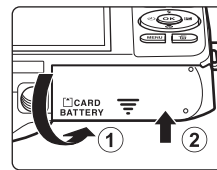

Removing the Battery and Memory Card

Turn the camera off and be sure that the power-on lamp and the monitor have turned off before opening the battery-chamber/memory card slot cover.

- The camera, battery, and memory card may be hot immediately after using the camera. Observe caution when removing the battery or memory card.

Removing the Battery

- To eject the battery, open the battery-chamber/ memory card slot cover and slide the orange battery latch up in the direction indicated by the arrow (1). The battery can then be removed by hand (2). Do not pull it at an angle.

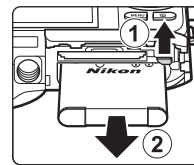

Removing the Memory Card

- Gently push the memory card into the camera (1) to partially eject the card, and then remove the card. Do not pull it at an angle.

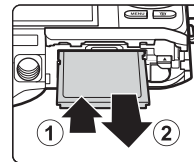

Step 3 Charge the Battery

Use the included Charging AC Adapter EH-70P and USB cable to charge the included Rechargeable Li-ion Battery EN-EL19 while it is in the camera.

3.1 Prepare the included Charging AC Adapter EH-70P.

If a plug adapter* is included with your camera, attach the plug adapter to the plug on the Charging AC Adapter. Push the plug adapter firmly until it is securely held in place. Once the two are connected, attempting to forcibly remove the plug adapter could damage the product.

* The shape of the plug adapter varies according to the country or region in which the camera was purchased.

The Charging AC Adapter comes with the plug adapter attached in Argentina and Korea.

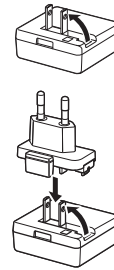

3.2 Make sure the battery is installed in the camera, and then connect the camera to the Charging AC Adapter in order of ① to ③.

- Keep the camera turned off.
- Be sure that plugs are properly oriented. Do not attempt to insert plugs at an angle, and do not use force when connecting or disconnecting the plugs.

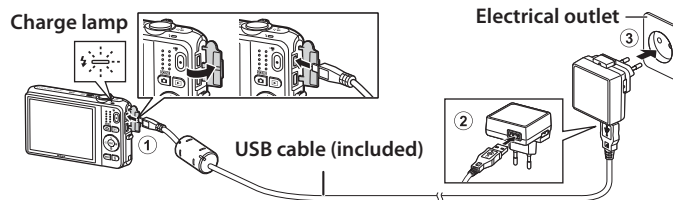

- The charge lamp slowly flashes green to indicate that the battery is charging.
- About 3 hours are required to charge a fully exhausted battery.
- When the battery has been completely charged, the charge lamp turns off.

3.3 Disconnect the Charging AC Adapter from the electrical outlet and then disconnect the USB cable.

Step 4 Turn On the Camera

Press the power switch to turn on the camera.

- The power-on lamp (green) will light and then the monitor will turn on (the power-on lamp turns off when the monitor turns on).

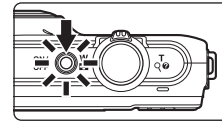

Power Saving Function (Auto Off)

If no operations are performed for a while, the monitor will turn off, the camera will enter standby mode, and the power-on lamp will flash. If no operations are performed for approximately another three minutes, the camera will turn off automatically.

While the camera is in standby mode, the monitor turns back on if you perform any of the following operations:

- Press the power switch, shutter-release button,  (shooting mode) button,  (playback) button, or  (movie-record) button

Step 5 Select a Language and Set the Camera Clock

When the camera is turned on for the first time, the language-selection screen and the date and time setting screen for the camera clock are displayed. Use the multi selector to make the settings.

The Multi Selector

Press the multi selector up (▲), down (▼), left (◀), or right (▶), or press the **OK** button.

- Selects the item above.
- Selects the item to the left, returns to the previous screen.
- Selects the item below.
- Selects the item to the right, continues to the next screen.
- Applies the current selection.

5.1

Press ▲ or ▼ to select the desired language and press the **OK** button.

5.2

Press ▲ or ▼ to select **Yes** and press the **OK** button.

5.3



Press ◀ or ▶ to select your home time zone and press the OK button.

Daylight Saving Time

If daylight saving time is in effect, press ▲ to enable the daylight saving time function.

- When the daylight saving time function is enabled, ☀ is displayed above the map.
- Press ▼ to disable the daylight saving time function.

5.4

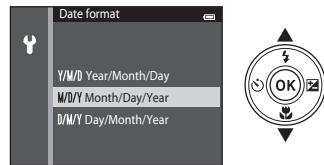

Press ▲ or ▼ to select the date format and press the OK button.

5.5

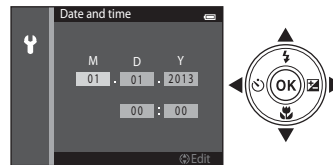

Edit the date and time.

- Select a field: Press ▶ or ◀ (changes between **M**, **D**, **Y**, hour, and minute).
- Edit the date and time: Press ▲ or ▼.
- Confirm the setting: Select the minute field and press the OK button.

5.6

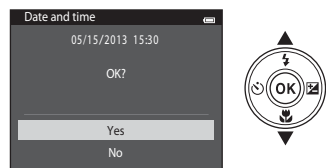

Press **▲** or **▼** to select **Yes** and press the **OK** button.

- When settings are finished, the lens extends and the camera switches to shooting mode.

Imprinting the Date and Time on Images While Taking Images

After setting the date and time, enable the **Print date** option in the **Y** (setup) menu (📖29). Display the **Y** (setup) menu using the following procedure and change the settings. Press the **MENU** button → press the multi selector **◀→** → press **▲** or **▼** to select the **Y** (setup) menu icon and press the **OK** button → press **▲** or **▼** to select an item and press the **OK** button.

Changing the Language Setting and the Date and Time Setting



Just as described under "Imprinting the Date and Time on Images While Taking Images" above, display the **Y** (setup) menu (📖29) and set **Language** or **Time zone and date**.

The next step explains basic shooting operations using  (auto) mode.

Shooting and Playback

Step 1 Check the Battery Level and the Number of Exposures Remaining

Battery level indicator

Display	Description
	The battery level is high.
	The battery level is low. Prepare to charge or replace the battery.
 Battery exhausted.	Cannot take images. Charge or replace the battery.

Battery level indicator

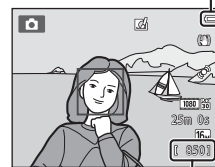

Number of exposures remaining

Number of Exposures Remaining

 is displayed when no memory card is inserted in the camera, and images will be saved in the internal memory (approximately 25 MB).

Step 2 Hold the Camera and Frame a Picture

2.1 Hold the camera steady in both hands.

- Keep fingers and other objects away from the lens, flash, etc.

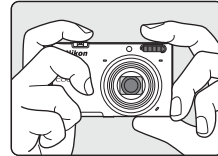

2.2 Frame the picture.

- Aim the camera at the desired subject.
- When the camera detects the main subject, the focus area is displayed (default setting).

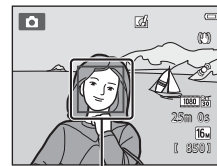

Focus area

Using the Zoom

Rotate the zoom control.

- To zoom in closer to the subject, rotate the zoom control to **T** (telephoto).
- To zoom out and view a larger area, rotate the zoom control to **W** (wide-angle).

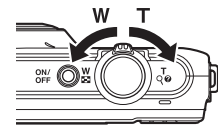

When you turn the camera on, the zoom moves to the maximum wide-angle position.

Step 3 Focus and Shoot

3.1 Press the shutter-release button halfway, i.e., press the button lightly until you feel a slight resistance.

- When the subject is in focus, the focus area that is in focus lights in green.

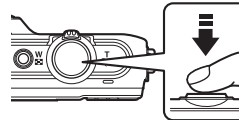

When human faces are detected:

- The camera focuses on one of them.

When no human faces are detected:

- If the main subject is detected, the camera focuses on it (up to three subjects).
- If no main subject is detected, the camera automatically selects one or more of the nine focus areas containing the subject closest to the camera.
- When the camera is unable to focus, the focus area will flash red. Modify the composition and press the shutter-release button halfway again.

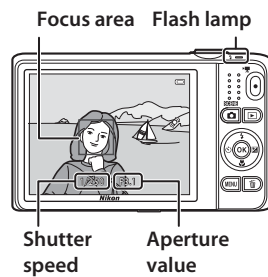

Flash lamp

The flash lamp indicates flash status when the shutter-release button is pressed halfway.

	On	Flash will fire when an image is taken.
	Flashing	Flash charging.*
	Off	Flash will not fire when an image is taken.

* If the battery is low, the monitor will turn off in order to save power while the flash is charging.







3.2 Press the shutter-release button the rest of the way down to take the image.



- The shutter is released and the image will be saved.
- If you press the shutter-release button with too much force, the camera may shake, causing images to be blurred. Press the button gently.



Step 4 **Play Back Images**

Press the  (playback) button. The camera enters playback mode.

- The last image captured is displayed in full-frame playback mode.
- To display previous or next images, press the multi selector , , , or .
- To return to shooting mode, press the  button, the shutter-release button, or the  (movie-record) button.

 (movie-record) button
 button

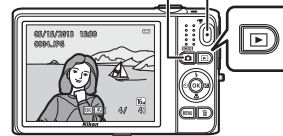



Display the previous image





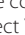

Display the next image

Deleting Unwanted Images

To delete the image currently displayed in the monitor, press the  (delete) button.

When the deletion screen is displayed, press the multi-selector  or  to select **Current image** and press the  button.

When the confirmation dialog is displayed, press  or  to select **Yes** and press the  button to delete the image that is displayed.

- After pressing the  button, press  or  to select **Erase selected images** and select multiple images to be deleted. Select **All images** to delete all images.
- **Deleted images cannot be restored.** To cancel without deleting, select **No** in the confirmation dialog and press the  button.

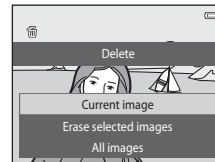
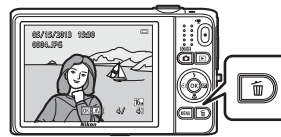

Step 5 Turn Off the Camera

Press the power switch to turn the camera off.

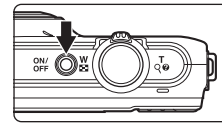

Using ViewNX 2

ViewNX 2 is an all-in-one software package which enables you to transfer, view, edit and share images. Install ViewNX 2 using the included ViewNX 2 CD-ROM.



Step 1 Installing ViewNX 2

- An Internet connection is required.

Compatible Operating Systems

Windows

Windows 8, Windows 7, Windows Vista, Windows XP

Macintosh

Mac OS X 10.6, 10.7, 10.8

Refer to the Nikon website for details on system requirements, including the latest information on operating system compatibility.

1.1 Start the computer and insert the ViewNX 2 CD-ROM into the CD-ROM drive.

- Windows: If instructions for operating the CD-ROM are displayed in the window, follow the instructions to proceed to the installation window.
- Mac OS: When the **ViewNX 2** window is displayed, double-click the **Welcome** icon.

1.2 Select a language in the language selection dialog to open the installation window.

- If the desired language is not available, click **Region Selection** to choose a different region and then choose the desired language (the **Region Selection** button is not available in the European release).
- Click **Next** to display the installation window.

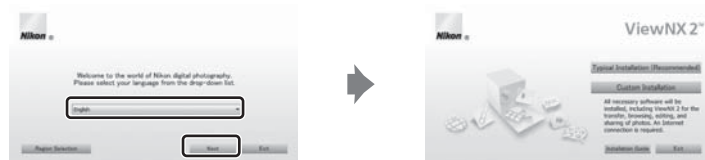

1.3 Start the installer.

- We recommend clicking **Installation Guide** in the installation window to check the installation help information and system requirements before installing ViewNX 2.
- Click **Typical Installation (Recommended)** in the installation window.

1.4 Download the software.

- When the **Software Download** screen is displayed, click **I agree - Begin download**.
- Follow the on-screen instructions to install the software.

1.5 Exit the installer when the installation completion screen is displayed.

- Windows: Click **Yes**.
- Mac OS: Click **OK**.

The following software is installed:

- ViewNX 2 (consisting of the three modules below)
 - Nikon Transfer 2: For transferring images to the computer
 - ViewNX 2: For viewing, editing, and printing transferred images
 - Nikon Movie Editor: For basic editing of transferred movies
- Panorama Maker (for creating a single panorama image of a landscape, etc. from a series of images that each capture a separate portion of the subject)

1.6 Remove the ViewNX 2 CD-ROM from the CD-ROM drive.



Step 2 **Transferring Images to the Computer**

2.1 Choose how images will be copied to the computer.

Choose one of the following methods:

- **Direct USB connection:** Turn the camera off and ensure that the memory card is inserted in the camera. Connect the camera to the computer using the included USB cable. The camera automatically turns on. To transfer images that are saved in the camera's internal memory, remove the memory card from the camera before connecting it to the computer.

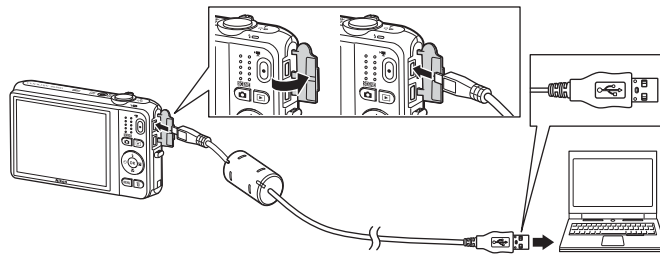

- **SD card slot:** If your computer is equipped with an SD card slot, the card can be inserted directly in the slot.
- **SD card reader:** Connect a card reader (available separately from third-party suppliers) to the computer and insert the memory card.

If a message is displayed prompting you to choose a program, select Nikon Transfer 2.

• **When using Windows 7**

If the dialog shown at right is displayed, follow the steps below to select Nikon Transfer 2.

- 1 Under **Import pictures and videos**, click **Change program**. A program selection dialog will be displayed; select **Import File using Nikon Transfer 2** and click **OK**.
- 2 Double-click **Import File**.



If the memory card contains a large number of images, it may take a while for Nikon Transfer 2 to start. Wait until Nikon Transfer 2 starts.

✓ Connecting the USB Cable

The connection may not be recognized if the camera is connected to the computer via a USB hub.

2.2 Transfer images to the computer.

- Confirm that the name of the connected camera or removable disk is displayed as the "Source" on the "Options" title bar of Nikon Transfer 2 (①).
- Click **Start Transfer** (②).



- At default settings, all the images on the memory card will be copied to the computer.

2.3 Terminate the connection.

- If the camera is connected to the computer, turn the camera off and disconnect the USB cable. If you are using a card reader or card slot, choose the appropriate option in the computer operating system to eject the removable disk corresponding to the memory card and then remove the card from the card reader or card slot.

Step 3 Viewing Images

Start ViewNX 2.

- Images are displayed in ViewNX 2 when transfer is complete.
- Consult online help for more information on using ViewNX 2.



Starting ViewNX 2 Manually

- **Windows:** Double-click the **ViewNX 2** shortcut on the desktop.
- **Mac OS:** Click the **ViewNX 2** icon in the Dock.

Other Functions

Flash Mode, Self-Timer, Macro Mode, and Exposure Compensation

Use the multi selector in shooting mode to apply the following settings.

Flash Mode

The flash modes available are **AUTO** (auto), **REDEYE** (auto with red-eye reduction), **OFF**, **FILL** (fill flash), and **SLOW** (slow sync) modes.



Exposure Compensation

Overall image brightness or darkness can be adjusted by setting exposure compensation before taking images.



Macro Mode

Use for close-ups. The camera can focus at a closer distance when the zoom is at a position where **MACRO** and the zoom indicator glow green.

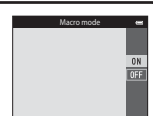



Self-Timer



The camera is equipped with two- and ten-second timers.



Selecting a Shooting Mode

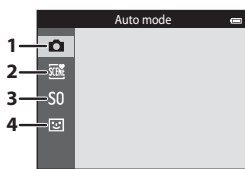
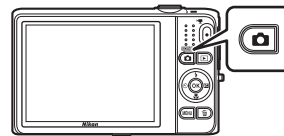

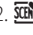
Press the  button in shooting mode to display the shooting mode selection menu. Select a shooting mode with the multi selector, and press the  button to switch to that mode.







1.  Auto mode (📖 15)
2.  Scene mode*
3. **SO** Special effects mode*
4.  Smart portrait mode

* The icon displayed differs depending on which scene or effect was selected last.

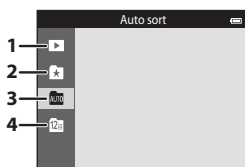
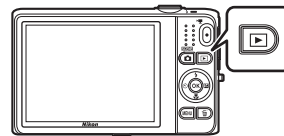

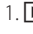
Selecting a Playback Mode

Press the  button in playback mode to display the playback mode selection menu. Select a playback mode with the multi selector, and press the  button to change to that mode.



1.  Playback mode (all images) (📖 17)
2.  Favorite pictures mode
3.  Auto sort mode
4.  List by date mode

Recording Movies

You can record movies by simply pressing the  button. Press the  button to start movie recording. Press the  button again to stop movie recording.

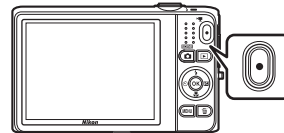

Using Camera Menus

A variety of shooting and playback settings can be adjusted from the camera menus.

Press the **MENU** button to display the menu for the current mode and use the multi selector to select an item (11).

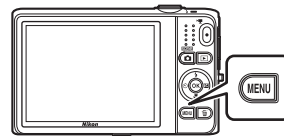

Select a menu icon on the left to switch to the menu of the selected icon.

Press the **MENU** button again to exit the menu.

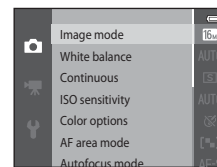

Switching Between Menu Icons

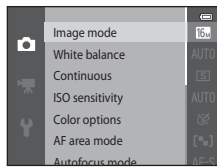

Press the multi selector **◀** to highlight a menu icon.

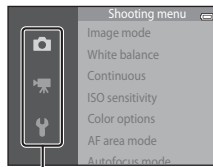

Press the multi selector **▲** or **▼** to choose another menu icon, and press either the **OK** button or **▶**.

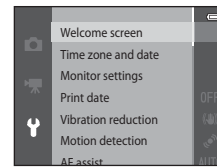





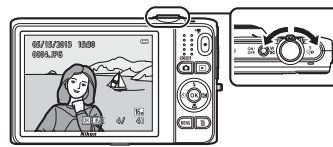

The selected menu is displayed.

Playback Mode

The following options are available in full-frame playback mode.



To	Use	Description
Select images		Press the multi selector ▲, ▼, ◀, or ▶ to display previous or next images.
View thumbnails/ enable calendar display	W	Displays 4, 9, or 16 image thumbnails. Rotate the zoom control to W in the 16-image thumbnail display to apply the calendar display (except in list by date mode).
Zoom during playback	T	Magnifies the image displayed in the monitor, up to about 10x. Press the button to return to full-frame playback mode.
Play back movies		Plays back the movie currently displayed.
Apply effects to images		Press the button when is displayed on a still image to select one of the displayed effects.
Delete image		Allows you to delete images. When using favorite pictures mode, auto sort mode, or list by date mode, images with the same album, category, or shooting date can be deleted.
Display menus	MENU	Displays the menu for the selected mode.

To	Use	Description
Switch to another playback mode		Displays the playback mode selection menu, allowing you to switch to favorite pictures mode, auto sort mode, or list by date mode.
Switch to shooting mode		Press the  button, shutter-release button, or  (movie-record) button to switch to shooting mode.
		
		

For Your Safety

To prevent damage to your Nikon product or injury to yourself or to others, read the following safety precautions in their entirety before using this equipment. Keep these safety instructions where all those who use the product will read them. The consequences that could result from failure to observe the precautions listed in this section are indicated by the following symbol:



This icon marks warnings, information that should be read before using this Nikon product, to prevent possible injury.

WARNINGS

Turn off in the event of malfunction

Should you notice smoke or an unusual smell coming from the camera or Charging AC Adapter, unplug the Charging AC Adapter and remove the battery immediately, taking care to avoid burns. Continued operation could result in injury. After removing or disconnecting the power source, take the equipment to a Nikon-authorized service representative for inspection.

Do not disassemble

Touching the internal parts of the camera or Charging AC Adapter could result in injury.

Repairs should be performed only by qualified technicians. Should the camera or Charging AC Adapter break open as the result of a fall or other accident, take the product to a Nikon-authorized service representative for inspection, after unplugging the product and/or removing the battery.

Do not use the camera or Charging AC Adapter in the presence of flammable gas

Do not use electronic equipment in the presence of flammable gas, as this could result in explosion or fire.

⚠ Handle the camera strap with care
Never place the strap around the neck of an infant or child.

⚠ Keep out of reach of children
Particular care should be taken to prevent infants from putting the battery or other small parts into their mouths.

⚠ Do not remain in contact with the camera, battery charger, or AC adapter for extended periods while the devices are on or in use

Parts of the devices become hot. Leaving the devices in direct contact with the skin for extended periods may result in low-temperature burns.

⚠ Observe caution when handling the battery

The battery may leak, overheat, or explode if improperly handled. Observe the following precautions when handling the battery for use in this product:

- Before replacing the battery, turn the product off. If you are using the Charging AC Adapter/AC adapter, be sure it is unplugged.

- Use only a Rechargeable Li-ion Battery EN-EL19 (included). Charge the battery by using a camera that supports battery charging or by using a Battery Charger MH-66 (available separately). To charge the battery with the camera, use either Charging AC Adapter EH-70P (included) or the **Charge by computer** function.
- When inserting the battery, do not attempt to insert it upside down or backwards.
- Do not short or disassemble the battery or attempt to remove or break the battery insulation or casing.
- Do not expose the battery to flame or to excessive heat.
- Do not immerse in or expose to water.
- Put the battery in the battery case before transporting it. Do not transport or store with metal objects such as necklaces or hairpins.
- The battery is prone to leakage when fully discharged. To avoid damage to the product, be sure to remove the battery when no charge remains.

- Discontinue use immediately should you notice any change in the battery, such as discoloration or deformation.
- If liquid from the damaged battery comes in contact with clothing or skin, rinse immediately with plenty of water.

⚠ Observe the following precautions when handling the Charging AC Adapter

- Keep dry. Failure to observe this precaution could result in fire or electric shock.
- Dust on or near the metal parts of the plug should be removed with a dry cloth. Continued use could result in fire.
- Do not handle the plug or go near the Charging AC Adapter during lightning storms. Failure to observe this precaution could result in electric shock.
- Do not damage, modify, forcibly tug or bend the USB cable, place it under heavy objects, or expose it to heat or flames. Should the insulation be damaged and the wires become exposed, take it to a Nikon-authorized service representative for inspection. Failure to observe these

precautions could result in fire or electric shock.

- Do not handle the plug or Charging AC Adapter with wet hands. Failure to observe this precaution could result in electric shock.
- Do not use with travel converters or adapters designed to convert from one voltage to another or with DC-to-AC inverters. Failure to observe this precaution could damage the product or cause overheating or fire.

⚠ Use appropriate cables

When connecting cables to the input and output jacks, use only the cables provided or sold by Nikon for the purpose, to maintain compliance with product regulations.

⚠ Handle moving parts with care

Be careful that your fingers or other objects are not pinched by the lens cover or other moving parts.

⚠ CD-ROMs

The CD-ROMs included with this device should not be played back on audio CD equipment. Playing CD-ROMs on an audio CD player could cause hearing loss or damage the equipment.

⚠ Observe caution when using the flash

Using the flash close to your subject's eyes could cause temporary visual impairment. Particular care should be observed if photographing infants, when the flash should be no less than 1 m (3 ft 4 in.) from the subject.

⚠ Do not operate the flash with the flash window touching a person or object

Failure to observe this precaution could result in burns or fire.

⚠ Avoid contact with liquid crystal

Should the monitor break, care should be taken to avoid injury caused by broken glass and to prevent liquid crystal from the monitor touching the skin or entering the eyes or mouth.

⚠ Turn the power off when using inside an airplane or the hospital

Turn the power off while inside the airplane during take off or landing. Follow the instructions of the hospital when using while in a hospital. The electromagnetic waves given out by this camera may disrupt the electronic systems of the airplane or the instruments of the hospital. Remove the Eye-Fi card, which can be the cause of the disruption, beforehand if inserted in the camera.

⚠ 3D Images

Do not continuously view 3D images recorded with this device for extended periods, whether on a television, monitor, or other display.

In the case of children whose visual systems are still maturing, consult a pediatrician or ophthalmologist prior to use and follow their instructions. Prolonged viewing of 3D images may cause eye strain, nausea, or discomfort. Cease use should any of these symptoms occur and consult a physician if necessary.

Notices

Notices for Customers in the U.S.A.

IMPORTANT SAFETY INSTRUCTIONS - SAVE THESE INSTRUCTIONS.

DANGER - TO REDUCE THE RISK OF FIRE OR ELECTRIC SHOCK, CAREFULLY FOLLOW THESE INSTRUCTIONS

For connection to a supply not in the U.S.A., use an attachment plug adapter of the proper configuration for the power outlet if needed.

The power supply unit is intended to be correctly orientated in a vertical or floor mount position.

Federal Communications Commission (FCC) Radio Frequency Interference Statement

This equipment has been tested and found to comply with the limits for a Class B digital device, pursuant to Part 15 of the FCC rules. These limits are designed to provide reasonable protection against

harmful interference in a residential installation. This equipment generates, uses, and can radiate radio frequency energy and, if not installed and used in accordance with the instructions, may cause harmful interference to radio communications. However, there is no guarantee that interference will not occur in a particular installation. If this equipment does cause harmful interference to radio or television reception, which can be determined by turning the equipment off and on, the user is encouraged to try to correct the interference by one or more of the following measures:

- Reorient or relocate the receiving antenna.
- Increase the separation between the equipment and receiver.
- Connect the equipment into an outlet on a circuit different from that to which the receiver is connected.

- Consult the dealer or an experienced radio/television technician for help.

FC **Nikon**
COOLPIX S6500

CAUTIONS
Modifications

The FCC requires the user to be notified that any changes or modifications made to this device that are not expressly approved by Nikon Corporation may void the user's authority to operate the equipment.

Interface Cables

Use the interface cables sold or provided by Nikon for your equipment. Using other interface cables may exceed the limits of Class B Part 15 of the FCC rules.

Notice for customers in the State of California

WARNING

Handling the cord on this product will expose you to lead, a chemical known to the State of California to cause birth defects or other reproductive harm.

Wash hands after handling.

Nikon Inc.,
1300 Walt Whitman Road
Melville, New York 11747-3064
USA
Tel: 631-547-4200

Notice for customers in Canada

CAUTION

This Class B digital apparatus complies with Canadian ICES-003.

ATTENTION

Cet appareil numérique de la classe B est conforme à la norme NMB-003 du Canada.

Caring for the Camera

To ensure continued enjoyment of this Nikon product, observe the precautions described below in addition to the warnings in "For Your Safety" (☞32-35) when using or storing the device.

✔ Do Not Drop

The product may malfunction if subjected to strong shock or vibration.

✔ Handle the Lens and All Moving Parts with Care

Do not apply force to the lens, lens cover, monitor, memory card slot, or battery chamber. These parts are easily damaged. Applying force to the lens cover could result in camera malfunction or damage to the lens. Should the monitor break, care should be taken to avoid injury caused by broken glass and to prevent the liquid crystal from the display touching the skin or entering the eyes or mouth.

✔ Keep Dry

The device will be damaged if immersed in water or subjected to high humidity.

✔ Avoid Sudden Changes in Temperature

Sudden changes in temperature, such as when entering or leaving a heated building on a cold day, can cause condensation to form inside the device. To prevent condensation, place the device in a carrying case or a plastic bag before exposing it to sudden changes in temperature.

✔ Keep away from Strong Magnetic Fields

Do not use or store this device in the vicinity of equipment that generates strong electromagnetic radiation or magnetic fields. Strong static charge or the magnetic fields produced by equipment such as radio transmitters could interfere with the monitor, damage data saved on the memory card, or affect the product's internal circuitry.

✓ Do Not Point the Lens at Strong Light Sources for Extended Periods

Avoid pointing the lens at the sun or other strong light sources for extended periods when using or storing the camera. Intense light may cause deterioration of the image sensor, producing a white blur effect in photographs.

✓ Turn the Product off Before Removing or Disconnecting the Power Source

Do not remove the battery while the product is on, or while images are being saved or deleted. Forcibly cutting power in these circumstances could result in loss of data or in damage to product memory or internal circuitry.

✓ Notes About the Monitor

- Monitors and electronic viewfinders are constructed with extremely high precision; at least 99.99% of pixels are effective, with no more than 0.01% being missing or defective. Hence while these displays may contain pixels that are always lit (white, red, blue, or green) or always off (black), this is not a malfunction and has no effect on images recorded with the device.
- Images in the monitor may be difficult to see under bright lighting.
- The monitor is lit by an LED backlight. Should the monitor begin to dim or flicker, contact your Nikon-authorized service representative.

Wi-Fi (Wireless LAN Network)

This product is controlled by the United States Export Administration Regulations, and you are required to obtain permission from the United States government if you export or re-export this product to any country to which the United States embargoes goods. The following countries were subject to embargo: Cuba, Iran, North Korea, Sudan, and Syria. Since the target countries are subject to change, please contact the United States Department of Commerce for the latest information.

Restrictions on Wireless Devices

The wireless transceiver included in this product conforms to wireless regulations in the country of sale and is not for use in other countries (products purchased in the EU or EFTA can be used anywhere within the EU and EFTA). Nikon does not accept liability for use in other countries. Users who are unsure as to the original country of sale should consult with their local Nikon service center or Nikon-authorized service

representative. This restriction applies to wireless operation only and not to any other use of the product.

Notice for Customers in the U.S.A. and Canada

Federal Communications Commission (FCC) and Industry of Canada (IC) Declaration of Conformity

This device complies with Part 15 of FCC Rules and Industry Canada licence-exempt RSS standard(s). Operation is subject to the following two conditions: (1) this device may not cause interference, and (2) this device must accept any interference, including interference that may cause undesired operation of this device.

FCC/IC RF Exposure Statement

This transmitter must not be co-located or operated in conjunction with any other antenna or transmitter.

The available scientific evidence does not show that any health problems are associated with using low power wireless devices. There is no proof, however, that these low power wireless devices are absolutely safe. Low power wireless

devices emit low levels of radio frequency energy (RF) in the microwave range while being used. Whereas high levels of RF can produce health effects (by heating tissue), exposure of low-level RF that does not produce heating effects causes no known adverse health effects. Many studies of low-level RF exposures have not found any biological effects. Some studies have suggested that some biological effects might occur, but such findings have not been confirmed by additional research. COOLPIX S6500 (FCC ID:CGJ5149EB/IC ID:4634A-5149EB) has been tested and found to comply with FCC/IC radiation exposure limits set forth for an uncontrolled environment and meets the FCC radio frequency (RF) Exposure Guidelines in Supplement C to OET65 and RSS-102 of the IC radio frequency (RF) Exposure rules. Please refer to the SAR test report that was uploaded to FCC website.

Precautions when Using Radio Transmissions

- Always keep in mind that radio transmission or reception of data is subject to interception by third parties. Note that Nikon is not responsible for data or information leaks that may occur during data transfer.
- The operating frequency band of this equipment is used by industrial, scientific, consumer and medical equipment including microwave ovens, premises radio stations for identifying mobile units used in the manufacturing lines of plants (radio stations requiring no license), and amateur radio stations (hereinafter referred to as "another station").
 1. Before using this equipment, confirm that another station is not being operated nearby.
 2. In the event of this equipment causing harmful radio wave interference with another station, promptly change the operating frequency or stop radio wave emission by turning off the power, etc.
 3. If you have further questions, contact a Nikon

service center or Nikon authorized service representative.

Personal Information Management and Disclaimer

- User information registered and configured on the product, including wireless LAN connection settings and other personal information, is susceptible to alteration and loss resulting from operational error, static electricity, accident, malfunction, repair or other handling. Always keep separate copies of important information. Nikon is not responsible for any direct or indirect damages or lost profits resulting from alteration or loss of content that is not attributable to Nikon.
- Before discarding this product or transferring it to another owner, perform **Reset all** in the setup menu (📖29) to delete all user information registered and configured with the product, including wireless LAN connection settings and other personal information.

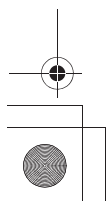
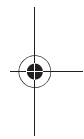
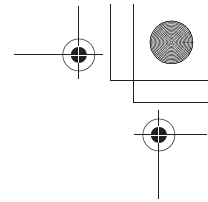
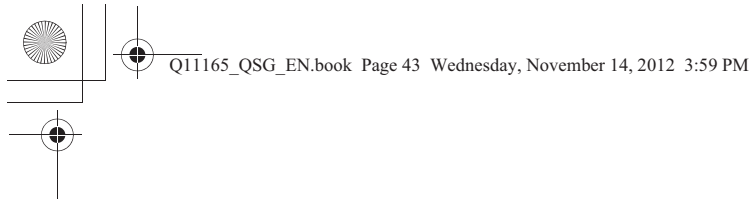

En_Fr_Es_Pb_01

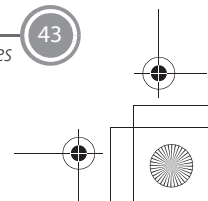



Highlight Features of the COOLPIX S6500

Image editing effects that are fun and easy to apply while shooting

Quick effects

Create images with effects in three easy steps, simply by shooting, selecting, and saving. Thirty effects are available. Just as with a smartphone application, you can preview the results of each effect on the image and choose your favorite one to suit the scene or your mood. You can also apply effects to images later by pressing the  button during playback.

Autofocus function that automatically determines the subject

Target finding AF

The **Target finding AF** function allows the camera to determine the main subject of the image, such as a person, flower, or small object. The camera automatically focuses on the subject, letting you freely compose the image without worrying about the focus. In addition, the camera automatically adjusts the focus area to match the size of the subject, ensuring a sharp focus on the intended subject.

Remotely controlling the camera using a smart device

Wi-Fi (wireless LAN) function

The camera's built-in Wi-Fi (wireless LAN) function* allows you to remotely release the shutter of the camera by operating a smart device that is wirelessly connected to the camera.

The camera's monitor view is displayed on the screen of the wirelessly connected smart device, enabling you to remotely zoom the camera in or out on the subject. You can also transfer saved images from the camera to the smart device.

* To use the Wi-Fi (wireless LAN) function, Wireless Mobile Utility must be installed on the smart device.

NIKON CORPORATION

© 2013 Nikon Corporation

YP2K01(11)
6MN10211-01

En_Fr_Es_Pb_01

Wi-Fi (Wireless LAN Network)

This product is controlled by the United States Export Administration Regulations, and you are required to obtain permission from the United States government if you export or re-export this product to any country to which the United States embargoes goods. The following countries were subject to embargo: Cuba, Iran, North Korea, Sudan, and Syria. Since the target countries are subject to change, please contact the United States Department of Commerce for the latest information.

Restrictions on Wireless Devices

The wireless transceiver included in this product conforms to wireless regulations in the country of sale and is not for use in other countries (products purchased in the EU or EFTA can be used anywhere within the EU and EFTA). Nikon does not accept liability for use in other countries. Users who are unsure as to the original country of sale should consult with their local Nikon service center or Nikon-authorized service representative. This restriction applies to wireless operation only and not to any other use of the product.

Notice for Customers in the U.S.A. and Canada

Federal Communications Commission (FCC) and Industry of Canada (IC)

Declaration of Conformity

This device complies with Part 15 of FCC Rules and Industry Canada licence-exempt RSS standard(s). Operation is subject to the following two conditions: (1) this device may not cause interference, and (2) this device must accept any interference, including interference that may cause undesired operation of this device.

FCC/IC RF Exposure Statement

This transmitter must not be co-located or operated in conjunction with any other antenna or transmitter.

The available scientific evidence does not show that any health problems are associated with using low power wireless devices. There is no proof, however, that these low power wireless devices are absolutely safe. Low power wireless devices emit low levels of radio frequency energy (RF) in the microwave range while being used. Whereas high levels of RF can produce health effects (by heating tissue), exposure of low-level RF that does not produce heating effects causes no known adverse health effects. Many studies of low-level RF exposures have not found any biological effects. Some studies have suggested that some biological effects might occur, but such findings have not been confirmed by additional research.

COOLPIX S6500 (FCC ID:CGJ5149EB/IC ID:4634A-5149EB) has been tested and found to comply with FCC/IC radiation exposure limits set forth for an uncontrolled environment and meets the FCC radio frequency (RF) Exposure Guidelines in Supplement C to OET65 and RSS-102 of the IC radio frequency (RF) Exposure rules. Please refer to the SAR test report that was uploaded to FCC website.

Declaration of Conformity

Hereby, Nikon Corporation, declares that COOLPIX S6500 is in compliance with the essential requirements and other relevant provisions of Directive 1999/5/EC. The declaration of conformity may be consulted at http://imaging.nikon.com/support/pdf/DoC_S6500.pdf.