



**INSTALLATION MANUAL
FLOOR ANTENNA
EQ 45-F**

February 07, 2012

Part#: 9886168

This information is furnished for guidance, and with no guarantee as to its accuracy or completeness; Its publication conveys no license under patent or other right, nor does the publisher assume Liability for any consequence of its use; specifications and availability of goods mentioned in it are Subject to change without notice; it is not to be reproduced in any way, in whole or in part, without the written consent of the publisher.

© N.V. Nederlandsche Apparatenfabriek "Nedap"

INSTALLATION

- 1 Make a hole in the floor 1810mm x 710mm with a depth of 74 mm. Equalize the surface with fluid concrete or another material to equalize the surface.



- 2 Fit the antenna in the hole and mark the drill holes to drill 8 holes with a diameter of 10mm deep 80mm.

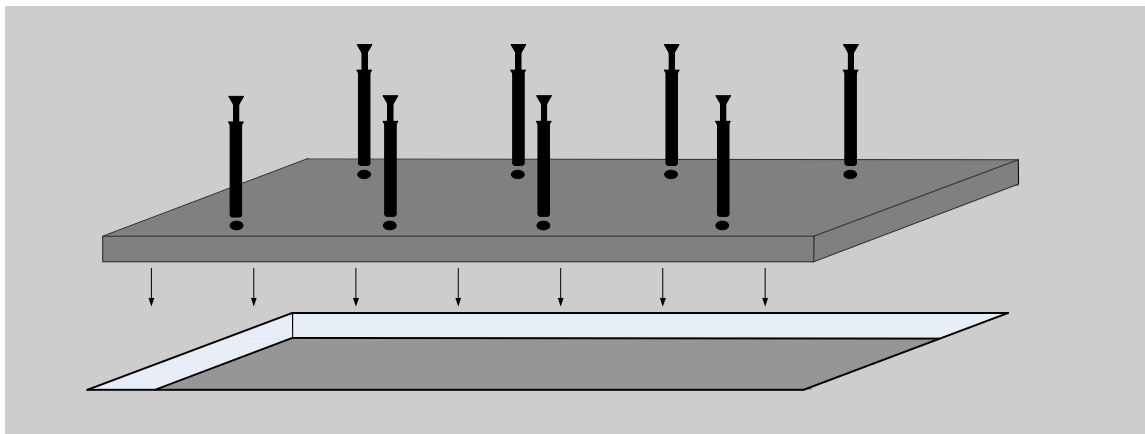

- 3 Place the Antenna assembly 9886168 in the hole and fix the antenna assembly so that the surfaces from the floor and antenna are equal.

- 4 Fix the Antenna construction with the fisher screws article Fisher Hammerfix article 50347

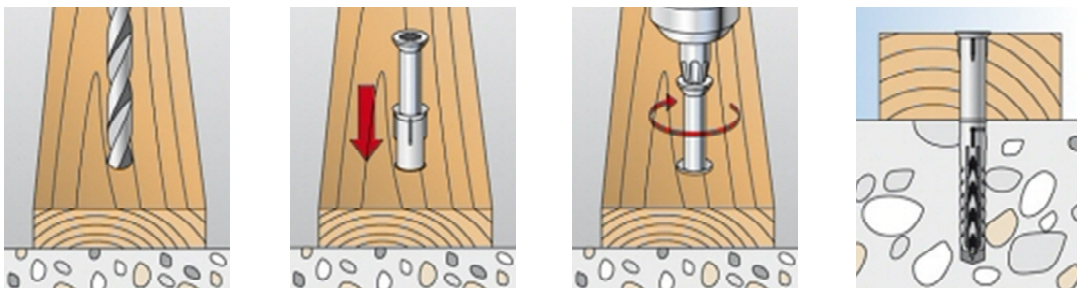
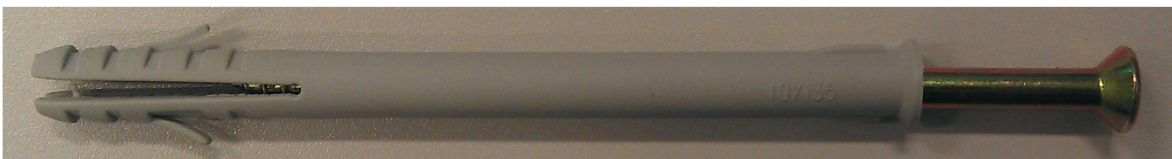

- 5 After mounting the antenna assembly the rest holes can be filled with fluid concrete or another fill material.

