

L5000-Wi-Fi Communications Module

INSTALLATION GUIDE

About the Communications Module

The L5000-Wi-Fi communications module is intended to provide compatible Honeywell LYNX Touch control panels with a Wi-Fi connection.

Compatible Controls

Control	Firmware Level	Field Update Rev	Installation Guide
LYNX Touch	TBD	TBD	800-10614
QuickConnect Touch	TBD		TBD

The module connects directly to the control panel and is powered via the control panel's connection.

1. Install the provided FCC/IC label (P/N 800-10341) on the control's case back (refer to Figure 1).

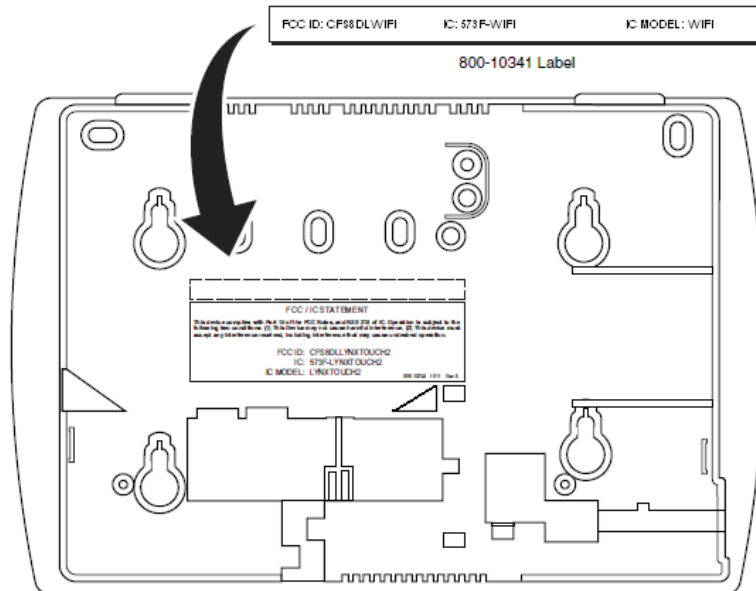

Figure 1. FCC/IC Label Location

Mounting the Module

Mount the module component side up in the control panel as shown in Figure 1. Ensure that module's receptacle is securely seated on the control's edge connector.

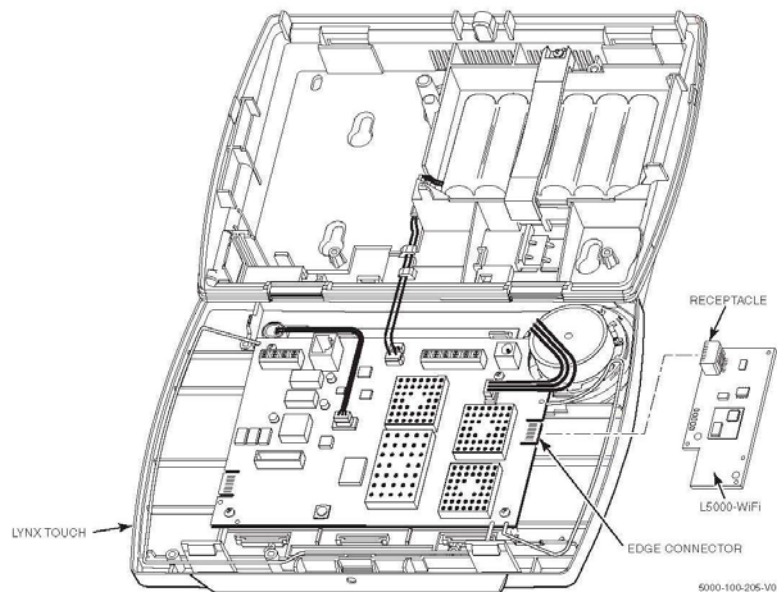

Figure 1. Installing the L5000-Wi-Fi Communications Module

Programming Notes

Programming associated with the L5000-Wi-Fi module is accomplished as part of the Control Panel Programming. Refer to the Control Panel Installation and Setup Guide for additional information.

1. The Remote Access Serial option must be set to "Enabled".
2. The Multi Mode Serial option must be set to "Enhanced Reports".

GSMVLP5-4G/GSMVLP5CN4G GSM and ILP5 Ethernet Communications Modules

Installation and Setup Guide

Installing Communication Modules

Installing the GSMVLP5-4G/GSMVLP5CN4G in the LYNX Touch Series Control



Ensure that SIM card and the connector board are securely installed in the GSMVLP5-4G/GSMVLP5CN4G before installing the module in the LYNX Touch.

1. Install the provided FCC/IC label (P/N 800-10341) on the control's case back (refer to Figure 1).

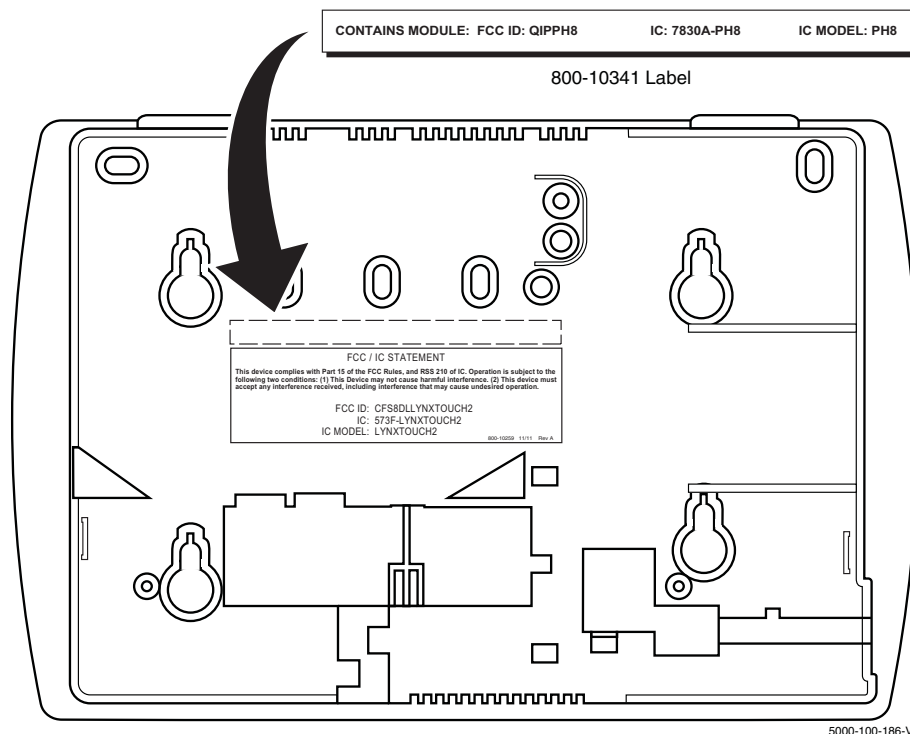

Figure 1. FCC/IC Label Location

2. Release the LYNX Touch front case from the back case by depressing the two locking tabs at the top of the unit with the blade of a medium size screwdriver (Refer to Figure 2).
3. Install the GSMVLP5-4G/GSMVLP5CN-4G into the LYNX Touch control front case. Ensure that the connector board is properly seated into the receptacle on the control (Refer to Figure 2).
4. Secure the GSMVLP5-4G/GSMVLP5CN-4G with the three provided screws (Refer to Figure 2).
5. Enable the GSMVLP5-4G/GSMVLP5CN-4G device, configure alarm reporting and module supervision and register the device. Refer to the "Program the Radio" and "Diagnostics" sections in the LYNX Touch Series Installation and Setup Guide (P/N 800-10614 or higher).

For Documentation and Online Support: <http://www.security.honeywell.com/hsc/resources/MyWebTech>

L5100-ZWAVE Communications Module Installation Guide

For Documentation and Online Support: <http://www.security.honeywell.com/hsc/resources/MyWebTech>

General Information

The L5100-ZWAVE communications module is intended to provide connection between compatible Honeywell LYNX Touch control panels and the ZWAVE devices and allows the panel to conduct integrated ZWAVE control.

Compatible Controls

Control	Firmware Level	Installation Guide
LYNX Touch	5.00	800-10614
QuickConnect Touch	5.00	800-10144V1

Installing the Module

1. Install the provided FCC/IC label (P/N 800-10342) on the control's case back (refer to Figure 1).

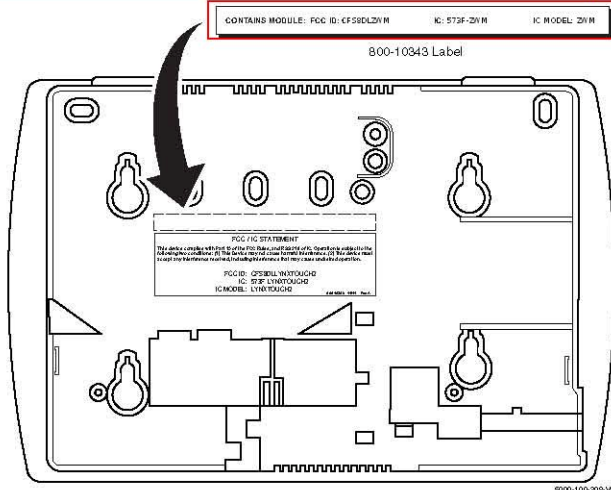

Figure 1. FCC/IC Label Location

2. Release the LYNX Touch front case from the back case by depressing the two locking tabs at the top of the unit with the blade of a medium size screwdriver. Refer to Figure 2.
3. Install the module component side up in the control panel as shown in Figure 2. Ensure that module's receptacle is securely seated on the control's edge connector.

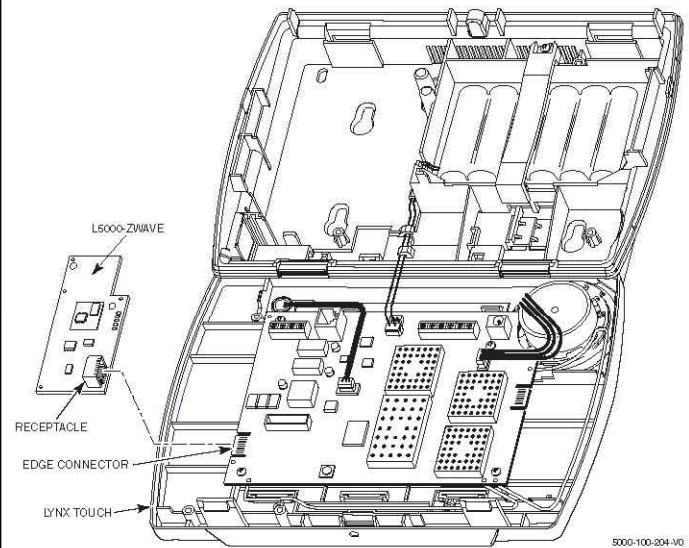

Figure 2. Installing the L5100-ZWAVE Communications Module

Programming Notes

Programming associated with the L5100-ZWAVE module is accomplished as part of the Control Panel Programming. Refer to the Control Panel Installation and Setup Guide for additional information.

1. The Multi Mode Serial option must be set to "Enhanced Reports".

Specifications

Board Dimensions:	1.25" W x 2.875" L x 0.3125" D
Current Drain:	TBD mA nominal; TBDmA max
Input Voltage:	3.3 VDC
Temperature:	32°F (0°C) to 140°F (60°C)

REFER TO THE INSTALLATION AND SETUP GUIDE FOR THE CONTROL WITH WHICH THIS DEVICE IS USED FOR WARRANTY INFORMATION AND LIMITATIONS OF THE ENTIRE SYSTEM.