

THE EXACT LOCATION OF LABEL & LABEL INFORMATION:

1. LYNX TOUCH2 MAIN LABEL - NO MODULES
2. LYNX TOUCH2 MAIN LABEL - AND 3G MODULE AUX LABEL



3. LYNX TOUCH2 MAIN LABEL - AND WIFI MODULE AUX LABEL
4. LYNX TOUCH2 MAIN LABEL - AND 3G & WIFI AUX LABELS



ENGINEERS DRAWING OF THE WIFI MODULES AUXILIARY LABEL:

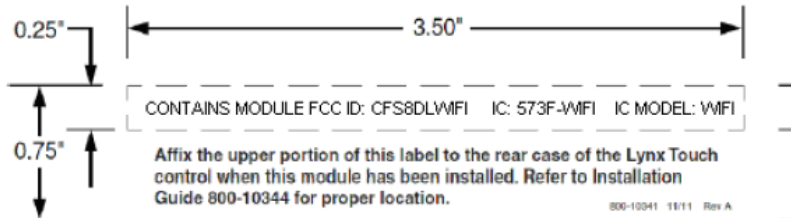

ENGINEERS DRAWING OF AUXILIARY LABEL FOR 3G MODULE

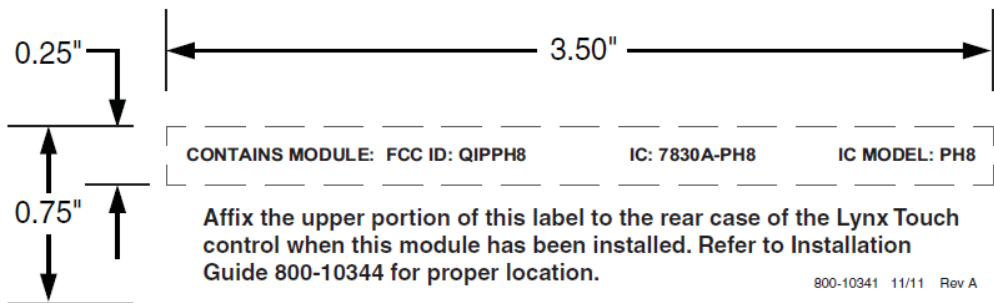

## L5000-Wi-Fi Communications Module

### INSTALLATION GUIDE

#### About the Communications Module

The L5000-Wi-Fi communications module is intended to provide compatible Honeywell LYNX Touch control panels with a Wi-Fi connection.

#### Compatible Controls

Control	Firmware Level	Field Update Rev	Installation Guide
LYNX Touch	TBD	TBD	800-10614
QuickConnect Touch	TBD		TBD

The module connects directly to the control panel and is powered via the control panel's connection.

1. Install the provided FCC/IC label (P/N 800-10341) on the control's case back (refer to Figure 1).

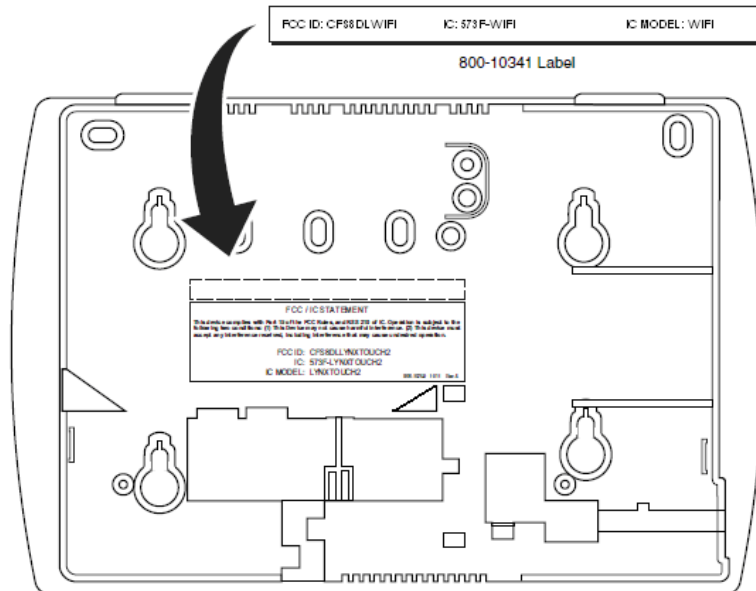

Figure 1. FCC/IC Label Location

#### Mounting the Module

Mount the module component side up in the control panel as shown in Figure 1. Ensure that module's receptacle is securely seated on the control's edge connector.

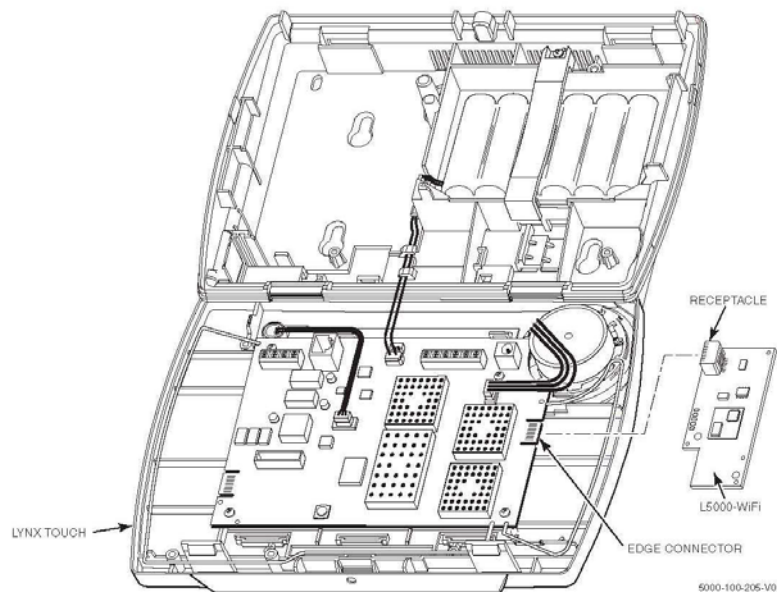

Figure 1. Installing the L5000-Wi-Fi Communications Module

#### Programming Notes

Programming associated with the L5000-Wi-Fi module is accomplished as part of the Control Panel Programming. Refer to the Control Panel Installation and Setup Guide for additional information.

1. The Remote Access Serial option must be set to "Enabled".
2. The Multi Mode Serial option must be set to "Enhanced Reports".

## GSMVLP5-4G/GSMVLP5CN4G GSM and ILP5 Ethernet Communications Modules

### Installation and Setup Guide

#### Installing Communication Modules

##### Installing the GSMVLP5-4G/GSMVLP5CN4G in the LYNX Touch Series Control



Ensure that SIM card and the connector board are securely installed in the GSMVLP5-4G/GSMVLP5CN4G before installing the module in the LYNX Touch.

1. Install the provided FCC/IC label (P/N 800-10341) on the control's case back (refer to Figure 1).

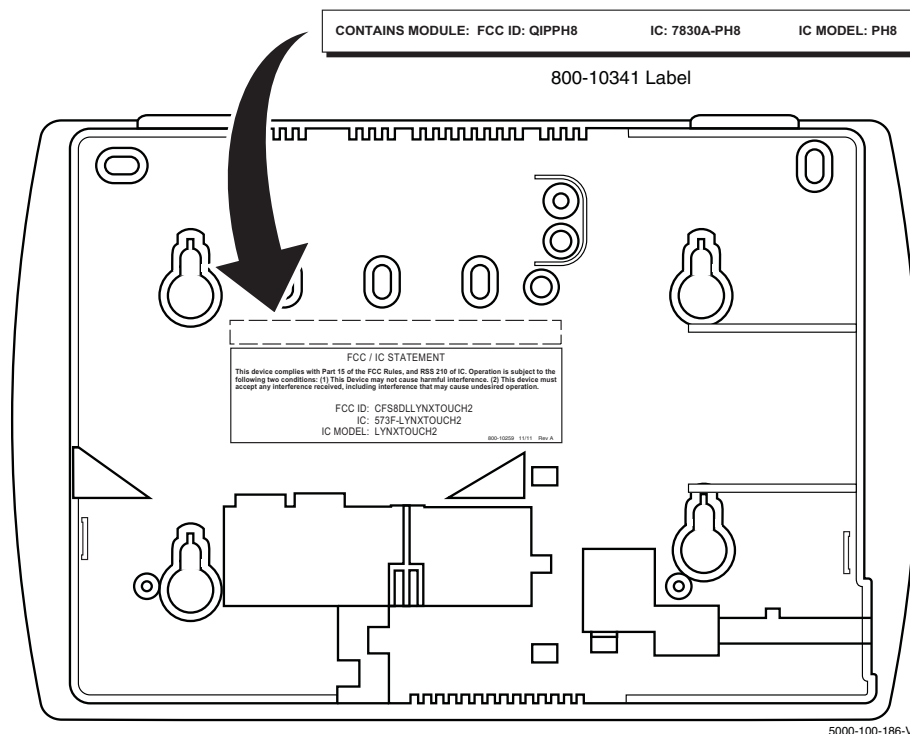

Figure 1. FCC/IC Label Location

2. Release the LYNX Touch front case from the back case by depressing the two locking tabs at the top of the unit with the blade of a medium size screwdriver (Refer to Figure 2).
3. Install the GSMVLP5-4G/GSMVLP5CN-4G into the LYNX Touch control front case. Ensure that the connector board is properly seated into the receptacle on the control (Refer to Figure 2).
4. Secure the GSMVLP5-4G/GSMVLP5CN-4G with the three provided screws (Refer to Figure 2).
5. Enable the GSMVLP5-4G/GSMVLP5CN-4G device, configure alarm reporting and module supervision and register the device. Refer to the "Program the Radio" and "Diagnostics" sections in the LYNX Touch Series Installation and Setup Guide (P/N 800-10614 or higher).

**For Documentation and Online Support:** <http://www.security.honeywell.com/hsc/resources/MyWebTech>