

ISOMETRIC VIEW FOR REFERENCE ONLY

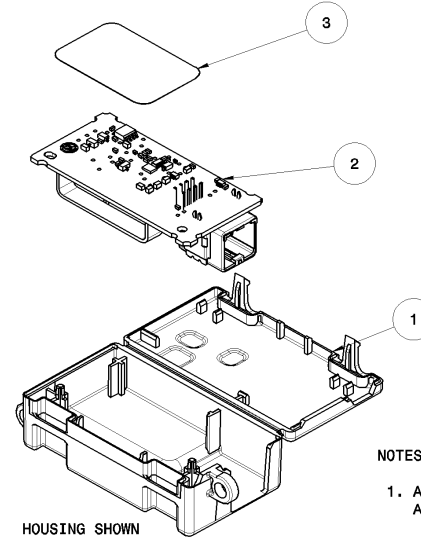

HOUSING SHOWN AS MOLDED

NOTES:

- ASSEMBLER IS TO PRINT LABEL INFORMATION AS SHOWN USING ADHESIVE LABEL.
- REFER TO LATEST REVISION OF DRAWING 1535474 FOR ACTUAL PATENT NUMBERS FOR THE PATENT GROUP IDENTIFIED. LAY OUT PATENT NUMBERS TO FILL SPACE AVAILABLE. BUT NATION / ORGANIZATION OF ORIGIN HEADINGS MUST BE MAINTAINED FOR CORRESPONDING PATENT NUMBERS AS SHOWN ON LATEST REVISION OF DRAWING 1535474.
- FOR THE PRODUCTION DATE USE FORMAT "MONTH/DAY/YEAR"
- THE ASSEMBLY MUST MEET FLAMMABILITY REQUIREMENTS FMVSS302 AND CMVSS302.

BARCODE AREA - SEE FORMAT

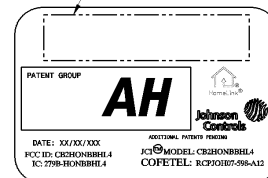

LABEL VIEW SCALE: 2:1

1	3	LBL, STOCK 1.0X1.5	VJ6846	VJ6846
1	2	PCB ASM, TX0A MY12 HL4 BLACK BOX	2170577	2170577
1	1	HSG, TX4 MY12 HL4 BLACK BOX	2170582	2170582

QTY	ITEM	DESCRIPTION	DRAWING NO.	PART NO. (L/F)
5A	5	REV		
	2170576	JCI ASM P/N		
	36610-TX4A-A012-M1	CUSTOMER ASM P/N		

FORMAT FOR BARCODE

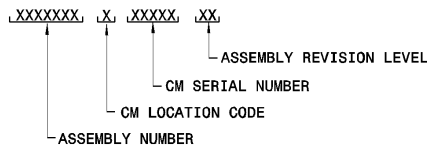

SPECIFICATIONS	
PERFORMANCE: SEE COMPONENT LEVEL DRAWINGS 36612-TX4A-A011-M1	PRODUCT SPECIFICATION
MATERIAL: SEE COMPONENT LEVEL DRAWINGS	
FINISH:	
GENERAL PART STD. UNLESS OTHERWISE SPECIFIED	
THIRD ANGLE PROJECTION	ASME Y14.5M 1994
1. DIMENSIONS ARE IN MILLIMETERS. 2. ELECTRONIC PART IS DATA MASTER. ELECTRONIC DRAWING IS MASTER FOR REQUIREMENTS, SPECIFICATIONS, AND TOLERANCES ONLY. -ALL GRAPHIC MEASURED DATA IS TO BE TAKEN FROM THE NOMINAL PART FILE AT ITS LATEST REVISION LEVEL. -UNDIMENSIONED FEATURES ARE TO MATCH THE CAD PART WITHIN: □ XX.XX ANGULAR ±2° X THE SPI COMMERCIAL HOLDING TOLERANCES (1993 STANDARD) AS MEASURED FROM DATUMS 3. ANY PERMANENT OR TEMPORARY MATERIALS (LUBRICANTS, CUTTING OILS, MOLD RELEASE, RUST INHIBITORS, FASTENER COATINGS, PVC, ETC) USED ON THIS PART MUST BE COMPATIBLE WITH THE MATERIAL IN THIS COMPONENT AND ITS MATING COMPONENTS. 4. SUBSTANCE USE RESTRICTIONS: THE GLOBAL AUTOMOTIVE DECLARABLE SUBSTANCES LIST (SEE http://www.gads1.org) REGARDING PROHIBITED AND DECLARABLE SUBSTANCES APPLIES TO ALL MATERIALS USED IN THIS PART.	
CHARACTERISTIC SYMBOLS	
<input type="checkbox"/> DESIGNATES SIGNIFICANT CHARACTERISTIC TO BE MONITORED PER CONTROL PLAN. <input checked="" type="checkbox"/> DESIGNATES SIGNIFICANT CHARACTERISTIC TO BE MONITORED PER CONTROL PLAN USING ATTRIBUTE GAUGING METHODS. <input checked="" type="checkbox"/> DESIGNATES SIGNIFICANT CHARACTERISTIC TO BE MONITORED PER CONTROL PLAN USING VARIABLE GAUGING METHODS. <input type="checkbox"/> DESIGNATES CHARACTERISTIC TO BE CHECKED AT INITIAL/SUBSEQUENT CUSTOMER PART SUBMISSION (ONE TIME CAPABILITY)	<input checked="" type="checkbox"/> DESIGNATES CRITICAL CHARACTERISTIC TO BE MONITORED PER CONTROL PLAN. <input checked="" type="checkbox"/> DESIGNATES CRITICAL CHARACTERISTIC TO BE MONITORED PER CONTROL PLAN USING ATTRIBUTE GAUGING METHODS. <input checked="" type="checkbox"/> DESIGNATES CRITICAL CHARACTERISTIC TO BE MONITORED PER CONTROL PLAN USING VARIABLE MEASUREMENT OR GAUGING METHOD

5A	BOM CHART	PART 2170576 REVISION UPDATE - PCB FAB CHANGED FOR LASER ETCHED BAR CODE			
REV	ECO #	DRAWN	CHECKED	APPROVED	DATE
5	5179121	ASHAFEB	ABORGET	J. BELTER	19JUN11
4A	BOM CHART	PART 2170576 REVISION UPDATE - PCB ASM ADDED PROGRAMMED MICRO PART # WITH SOFTWARE VER 4.2.1			
REV	ECO #	DRAWN	CHECKED	APPROVED	DATE
4	5048555	ASHAFEB	ABORGET	J. BELTER	18MAY11
3B	NOTES	ADD FLAMMABILITY REQUIREMENT - NOTE #4			
3A	BOM CHART	PART 2170576 REVISION UPDATE - PCB ASSEMBLY ADJUSTED LABEL LOCATION AND ADDED PARTS FROM GLOBAL PARTS LIST			
REV	ECO #	DRAWN	CHECKED	APPROVED	DATE
3	4947318	ASHAFEB	ABORGET	J. BELTER	05APR11
2C	PCB ASSEMBLY	UPDATED CRYSTAL CHARACTERIZATION - FORCED MULTIPLE COMPONENT VALUE CHANGES			
2B	SPECIFICATION	ADDED PRODUCT SPECIFICATION CALLOUT			
2A	BOM CHART	PART 2170576 REVISION UPDATE			
REV	ECO #	DRAWN	CHECKED	APPROVED	DATE
2	4713600	ASHAFEB	ACHENOP	J. BELTER	23NOV10
1					
REV	ECO #	DRAWN	CHECKED	APPROVED	DATE
1	4593097	ACHENOP	ASHAFEB	ASHAFEB	07OCT10

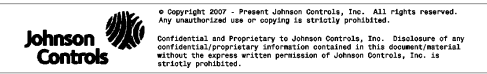

ELEC ASM, TX4 MY12 HL4 BLACK BOX

NAME	ELEC ASM, TX4 MY12 HL4 BLACK BOX			
OPP CODE	MASS	SCALE	PART #	REV
		1:1	SEE CHART	-
SIZE	PROGRAM #	SHEET	DWG #	REV
C	1012370	1 OF 1	2170576	5
CUSTOMER	HONDA			