

REV	ECO NO	DESCRIPTION	DRAWN	DATE
A	C18727	INITIAL RELEASE	KSH	5/9/07

NOTES: UNLESS OTHERWISE SPECIFIED,

1. MATERIAL: PET 75#.
2. WHOLE SURFACE TO BE TEXTURED.
3. FOR COLORS, SEE LABEL PART BOM.
4. FOR LABEL ARTWORK CONTENT AND PRESENTATION, SEE THE ARTWORK IN THE CONTROLLING BOM.
5. LABEL MATERIAL MUST COMPLY WITH UL'S RECOGNIZED COMPONENT PROGRAM FOR MARKING AND LABELING SYSTEMS. UL LABELS MUST BE PURCHASED EXCLUSIVELY FROM LABEL SUPPLIERS WHOSE MANUFACTURING LOCATION IS CERTIFIED BY UL AS A PARTICIPANT IN THE AUTHORIZED LABEL SUPPLIER PROGRAM.

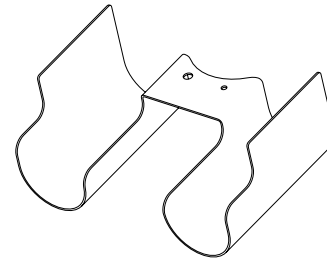

SCALE 1:1

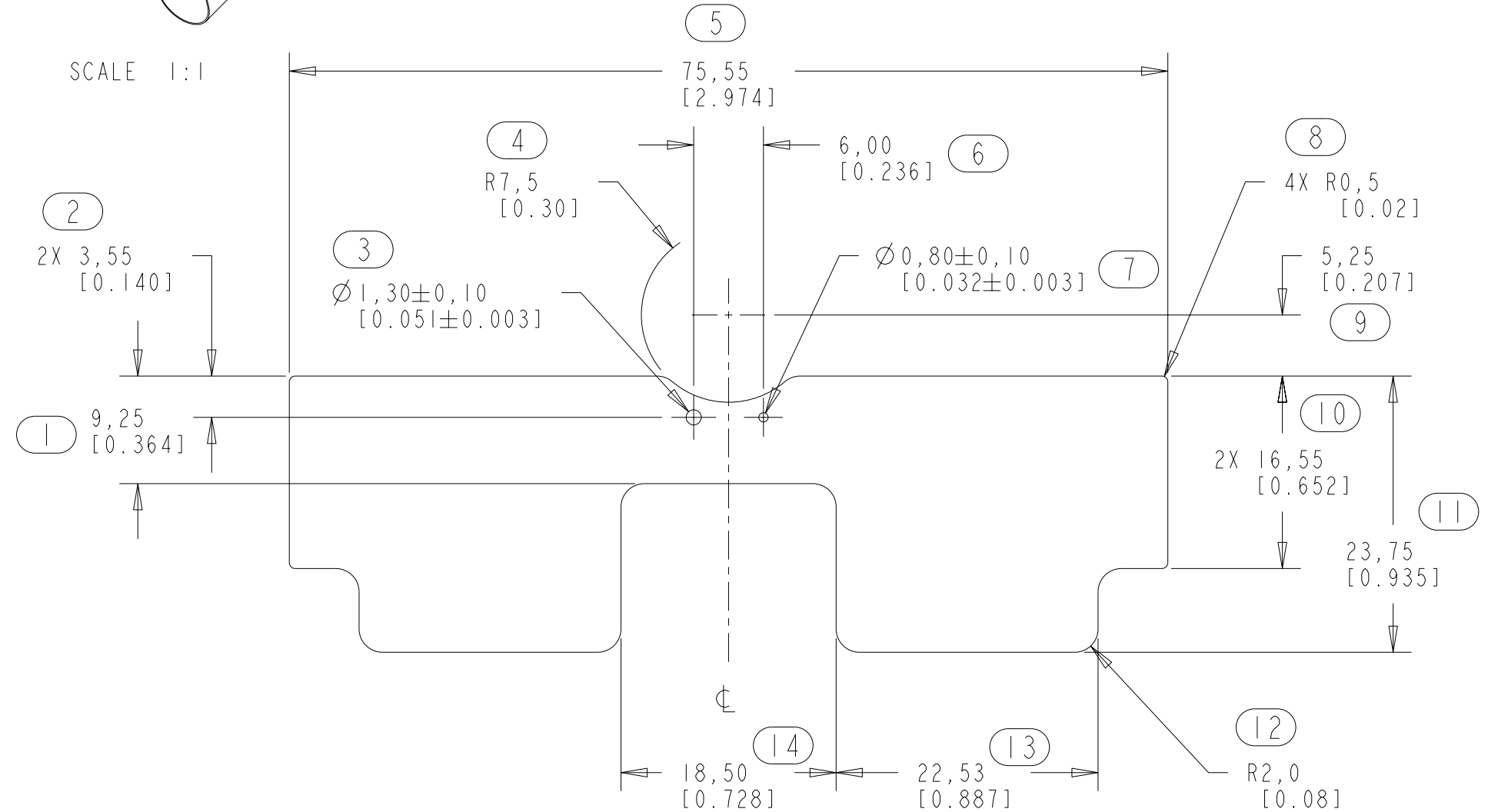

DOCUMENT NO	GENERAL DESCRIPTION
900-300-079	COLOR CORRECTNESS EVAL
00156	FAI GUIDELINES
<b>APPLICABLE SPECIFICATION TABLE</b>	
THIS DOCUMENT AND THE INFORMATION CONTAINED HEREIN ARE PROPRIETARY TO MICROSOFT CORPORATION AND SHALL NOT BE USED BY, OR DISCLOSED IN WHOLE OR IN PART TO ANYONE OUTSIDE OF MICROSOFT CORPORATION WITHOUT THE PRIOR WRITTEN PERMISSION OF MICROSOFT CORPORATION.	

DRAWN	DATE
KSHAYATSU	
CHECKER	DATE
ENGINEER	DATE
MICHAEL SCHWEERS	
ENGR MGR	DATE
PROG MGR	DATE
MFG ENGR	DATE
QUALITY	DATE
TOOLING	DATE
DOC CONTROL	DATE

**Microsoft**

MS PART NO: X813048-001

UNLESS OTHERWISE SPECIFIED  
DIMENSIONS ARE: MM [INCHES]  
TOLERANCES ARE:  
.X =  $\pm .3$  [.01]  
.XX =  $\pm .13$  [.005]  
ANGLES =  $\pm 1^\circ$   
DO NOT SCALE DRAWING

TITLE:  
**MATERIAL SPECIFICATION,  
LABEL, MYLAR BATTERY TAB,  
BLUETOOTH NTBK MOUSE 5000**

LEGEND:  
■ = CRITICAL DIM  
● = TOOLING DIM  
▲ = PROCESS DIM  
XX = DIMENSION ID

SIZE: **B** THIRD ANGLE PROJECTION  
DRAWING NO: **X813048** REV: **A**  
SCALE: 2:1 SHEET: 1 OF 1