

## Specifications

<b>305UPR</b>	<b>Receiver</b>	UHF 188 Selectable Frequencies (566.125-589.875MHz)
	Frequency Range	FM
	Type of Reception	PLL Synthesized
	Oscillator	-95dBm
	RF Squelch Level	50Hz – 15kHz
	Frequency Response	>57dB (±5kHz) "A" Weighted
	S/N Ratio	MIC Level – Balanced – 3.5mm Mini-Jack
	Audio Out	-58 dBm – 600 ? @ ± 5kHz deviation
		-22 ,dBm – 600 ? @ ± 40kHz deviation
	Batteries	2 "AA" Alkaline (2 x 1.5V) - 3-4 hours runtime
		2 "AA" rechargeable Ni-MH (2 x 1.2V)
	Dimensions	2.48"W x 3.86"H x 1.12"D (63 x 98 x 28.5 mm)
	Weight	Approx. 6.7oz (190g) w/batteries
<b>35BT</b>	<b>Body-pack Transmitter</b>	UHF 188 Selectable Frequencies (566.125-589.875MHz)
	Frequency Range	PLL Synthesized
	Oscillator	25mW
	RF Power	50Hz – 15kHz
	Frequency Response	±40kHz @ 1kHz Modulation, MIC Input – 11dBm
	Max. Deviation	2 "AA" Alkaline (2 x 1.5V) – 8-10 hours runtime
	Batteries	2 "AA" rechargeable Ni-MH(2 x 1.2V)
	Dimensions	2.48"W x 3.86"H x 1.12"D (63 x 98 x 28.5 mm)
	Weight	Approx. 6oz (170g) w/batteries
<b>35XT</b>	<b>Plug-In Transmitter</b>	UHF 188 Selectable Frequencies (566.125-589.875MHz)
	Frequency Range	Internal
	Antenna	-16dBm
	Max. Input level	25mW
	RF Power	25k ohms
	Input Impedance	-65dBm to 46dBm
	Audio Adjust. Range	2 "AA" Alkaline (2 x 1.5V) – 6-8 hours runtime
	Battery	2 "AA" rechargeable Ni-MH(2 x 1.2V)
	Dimensions	1.57"W x 1.57"H x 4.49"L (40 x 40 x 114 mm)
	Weight	Approx. 6.35oz (180g) w/battery
<b>35HT</b>	<b>Handheld Microphone/Transmitter</b>	UHF 188 Selectable Frequencies (566.125-589.875MHz)
	Frequency Range	PLL Synthesized
	Oscillator	25mW
	RF Power	50Hz – 15kHz
	Frequency Response	±40kHz @ 1kHz Modulation, MIC Input – 65dBm (dev ±5kHz)
	Max. Deviation	2 "AA" Alkaline (2 x 1.5V) – 8-10 hours runtime
	Batteries	2 "AA" rechargeable Ni-MH (2 x 1.2V)
	Dimensions	Φ1.89" x 9.2"L (48 x 234.5 mm)
	Weight	Approx. 9.5oz (270g) w/batteries

## 305 SYSTEM User's Guide

305UPR • 35BT • 35HT • 35XT  
ON-CAMERA  
UHF WIRELESS MICROPHONE SYSTEM

**PRELIMINARY**



*Due to constant improvements, specifications are subject to change without notice.*  
Azden Corporation, 147 New Hyde Park Road, P.O. Box 10, Franklin Square, NY 11010  
tel - 516.328.7500 • fax - 516.328.7506 • email - azdenus@azdencorp.com



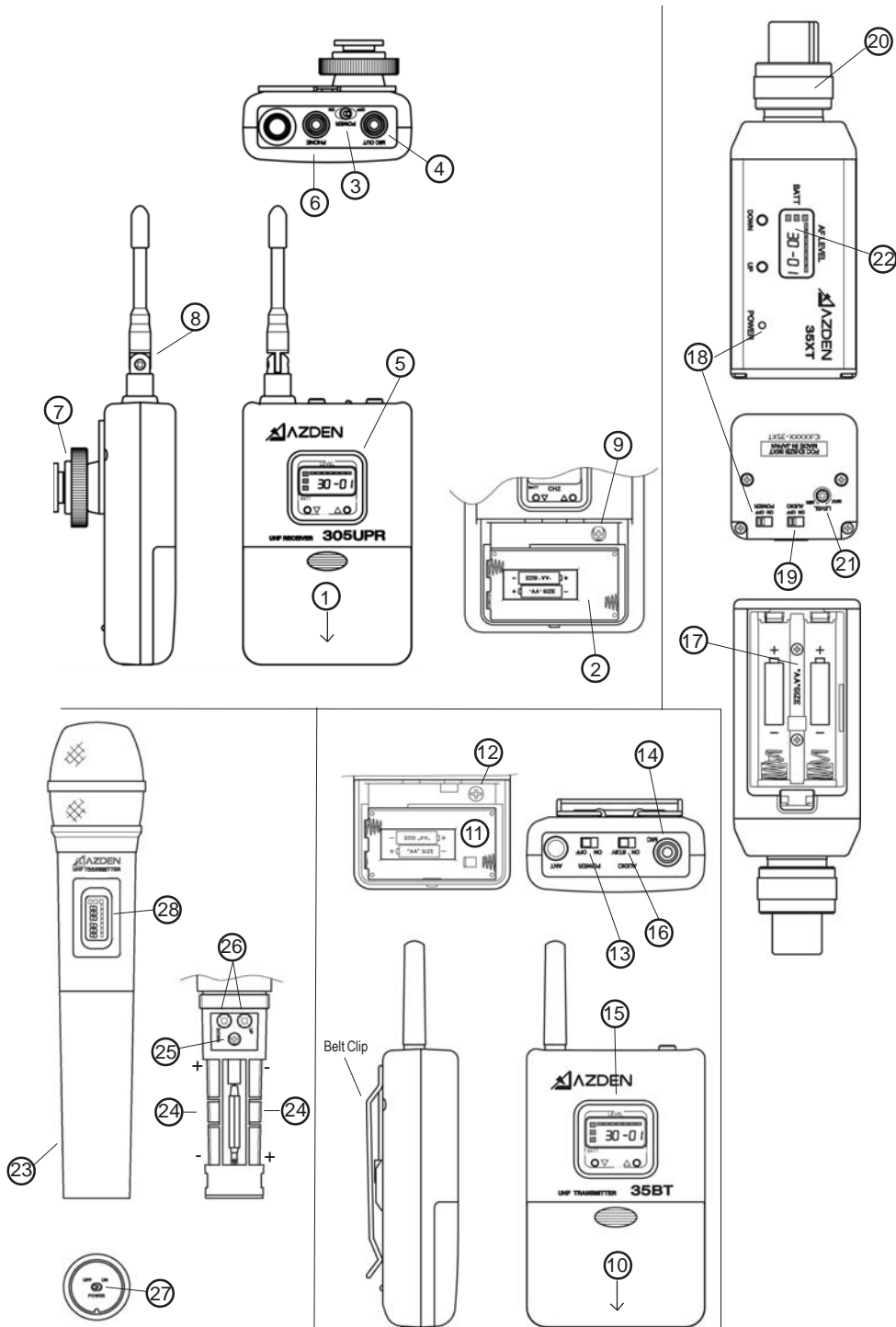

## Operating the system

Because this is a frequency agile system, the receiver and transmitter must be on the same TV:Receive/Transmit channel number. To change the channel number, use the tip of the provided tool and press the UP or DOWN button to the desired channel. Make sure both the receiver and transmitter are on the same channel.

### 305UPR Receiver

After installing new batteries, mount the receiver to your video camera with the supplied shoe mount or hook & loop fastener. Select one of the supplied cables and connect the output cable to the receiver and to the microphone input on the video camera. Switch the 305UPR to "ON" and the battery level indicator should come on. If it doesn't, check the batteries. When the 305UPR receives a signal from the transmitter the reception level indicator will come on. If it does not, make sure both the receiver and transmitter are on matching channels.

### 35BT Transmitter

Plug in the supplied lapel microphone and clip it to your subject. The microphone should be placed 4-12 inches from your subject's mouth. Clip the transmitter to a belt using the supplied belt-clip or place it in a pocket. Switch the 35BT to "ON" and the battery level indicator should come on. If it does not, check the battery. Have someone speak into the microphone as you monitor the sound through the receiver's phone output. If the sound is distorted lower the MIC input level on the transmitter. If there is not enough volume raise the MIC input level on the transmitter.

### 35XT Transmitter

Switch the transmitter to "ON" and the battery level indicator should come on. If it does not, check the battery. Have someone speak into the microphone as you monitor the sound through the camera's monitor output. If the sound is distorted lower the level control on the transmitter. If there is not enough gain raise the level control on the transmitter.

### 35HT Transmitter

Switch the transmitter to "ON" and the battery level indicator should come on. If it does not, check the battery. Have someone speak into the microphone as you monitor the sound through the camera's monitor output. If the sound is distorted lower the level control on the transmitter. If there is not enough gain raise the level control on the transmitter.

#### Important information

Licensing of this, or any Azden wireless equipment is the user's responsibility. The ability to receive a license depends largely on the user's classification, application and frequency. Contact the appropriate agency (FCC in the US) for further information.

These devices comply with Part 15 of the FCC Rules. Operation is subject to the following two conditions: (1) These devices may not cause harmful interference, and (2) These devices must accept any interference received, including interference that may cause undesired operation.

NOTE: The manufacturer is not responsible for any radio or TV interference caused by unauthorized modifications to this equipment. Such modifications could void the user's authority to operate the equipment.

These devices and their antenna(s) must not be co-located or operated in conjunction with any other antenna or transmitter.

## HANDHELD MICROPHONE/TRANSMITTER (35HT)

(23) Remove the battery compartment cover by rotating it counterclockwise and sliding it down.

(24) Insert two fresh Alkaline\* "AA" batteries\* into the compartment. Make sure the battery polarity is correct as marked inside the battery compartment.

\*While Alkaline batteries are preferred, you can use rechargeable Ni-Cd or Ni-MH batteries.

In the battery compartment you will also find #25 and #26:

(25) MIC LEVEL Control:

The MIC LEVEL control enables you to adjust the audio level of the microphone. Using the supplied tool, turn the dial clockwise to increase, or counterclockwise to decrease the microphone's audio level.

(26) UP/DOWN Channel Buttons:

To change the channel number, use the tip of the tool provided and press the UP or DOWN button until the desired channel number appears. Once the desired channel number has been selected on the transmitter, set the receiver to the same channel number.

(27) POWER:

Switches the transmitter "ON" or "OFF".

(28) LCD Display:

This display shows the following information:

TV:Transmit Channel Number: 30:01 – 33:47

Battery Condition: Using a 3 step indicator - 1 (Low) to 3 (High)

To change the TV:Transmit channel number: Use the tip of the tool provided and press the UP or DOWN button to the desired channel, number appears (refer to the included chart). Once the desired TV:Transmit channel number has been selected on the transmitter, set the receiver to the same number.

The TV:Transmit channel display is made of two parts. The first number is the actual TV channel (30-33) and the second is the "transmit channel" number (01-47).

Thank you for purchasing Azden's 305 wireless microphone system. Depending on which system you ordered this package will contain one or more of the following components: the 305UPR receiver, the 35BT body-pack transmitter with EX-503L lavalier microphone, the 35XT XLR plug-in transmitter and/or the 35HT handheld microphone transmitter. This equipment is designed primarily for video cameras but is usable with most electronic components having a microphone level input. The 305UPR allows you to "receive" audio from one transmitter at a time.

---

## RECEIVER (305UPR)

(1) Remove the battery compartment lid by sliding it down.

(2) Insert two fresh Alkaline\* "AA" batteries into the compartment. Make sure the battery polarity is correct as marked inside the battery compartment.

\*Alkaline batteries are preferred, but you can use Azden's 1HR-3U rechargeable Ni-MH batteries.

(3) POWER:

Switches the receiver "ON" or "OFF".

(4) MIC OUT jack:

The 305UPR is supplied with both a mini-to-mini and a mini-to-XLR cable.

For mini jack microphone inputs: Use the supplied mini-to-mini cable. Plug one end of the cable into the receiver and the other end of the cable into the microphone input of the video camera.

For 3-pin XLR microphone inputs: Use the supplied mini-to-XLR cable. Plug the mini-plug end of the cable into the receiver (use the screw-down sleeve to secure it to the receiver) and plug the XLR end of the cable into the microphone input of the video camera.

(5) LCD Display:

The display will light up when the power is turned "ON". The LCD display shows the following information:

TV:Receive Channel Number: 30:01 – 33:47

Battery Condition: Using a 3-step indicator - 1 (Low) to 3 (High)

Reception Level: Using a 4-step indicator - 1 (Low) to 4 (High)

To change the TV:Receive channel number, use the tip of the tool provided and press the UP or DOWN button until the desired channel number appears (refer to included chart). Once the desired TV:Receive channel number has been selected on the receiver, set the transmitter to the same number.

The TV:Receive channel display is made of two parts. The first number is the actual TV channel (30-33) and the second is the "receive channel" number (01-47)

(6) PHONE jack:

Plug a headphone into this 3.5mm jack to monitor sound.

(7) Shoe-Mount:

Attach the 305UPR to the shoe-mount of the video camera by sliding it into place. Turn the thumbwheel clockwise to tighten. Reverse this procedure to remove.

(8) Antenna: For best reception the antenna should be pointed in an upward fashion. Use caution, and do not force it into this position.

(9) Phone Output Adjustment: Using the supplied tool, turn the screw clockwise to increase earphone level and counterclockwise to decrease.

---

BODYPACK TRANSMITTER (35BT)

(10) Remove the battery compartment lid by sliding it down.

(11) Insert two fresh "AA" Alkaline\* batteries into the compartment. Make sure the battery polarity is correct as marked inside the battery compartment.

In addition to the battery, inside the battery compartment you will find:

(12) MIC Input LEVEL Control:

This control enables you to adjust the input level of the microphone. Using the supplied tool, turn the dial clockwise to increase, or counterclockwise to decrease the input level.

(13) POWER:

Switches the transmitter "ON" or "OFF".

(14) MIC Input Jack

Plug the supplied EX-503L microphone into the MIC input jack and tighten the collar until snug (DO NOT OVERTIGHTEN). In addition to the EX-503L, other lapel and/or headset microphones with 3.5mm mini plugs can also be used with the 35BT.

(15) LCD Display:

This display shows the following information:

TV:Transmit Channel Number: 30:01 – 33:47

Battery Condition: Using a 3 step indicator - 1 (Low) to 3 (High)

To change the TV:Transmit channel number: Use the tip of the tool provided and press the UP or DOWN button to the desired channel, number appears (refer to the included chart). Once the desired TV:Transmit channel number has been selected on the transmitter, set the receiver to the same number.

The TV:Transmit channel display is made of two parts. The first number is the actual TV channel (30-33) and the second is the "transmit channel" number (01-47).

2

\*While Alkaline batteries are preferred, you can use rechargeable Ni-Cd or Ni-MH batteries.

(16) AUDIO:

Prior to first turning the 35BT "ON" it is best to set the AUDIO switch to "OFF". When you are ready to begin transmitting, switch to "ON". The "OFF" position acts as a "mute" that maintains the RF signal but turns off the audio.

---

XLR PLUG-IN TRANSMITTER (35XT)

(17) Open the battery compartment lid and insert two fresh "AA" Alkaline\* batteries. Make sure the battery polarity is correct as marked inside the battery compartment

\*While Alkaline batteries are preferred, you can use rechargeable Ni-Cd or Ni-MH batteries.

(18) POWER:

Switches the transmitter "ON" or "OFF".

(19) AUDIO:

Prior to first turning the 35XT "ON" it is best to set the AUDIO switch to "OFF". When you are ready to begin transmitting, switch to "ON". The "OFF" position acts as a "mute" that maintains the RF signal but turns off the audio.

(20) MIC Connector/Locking Ring:

This 3-pin XLR connector is the microphone input. Any low impedance microphone with a corresponding connector can be attached here.

Once the microphone is plugged into the 35XT the locking ring should be rotated clockwise until snug. To remove the microphone, first rotate the locking ring counterclockwise and then, while pressing the XLR release, pull the microphone away from the 35XT.

(21) MIC Input LEVEL Control:

The MIC input LEVEL control enables you to adjust the input level of the connected microphone. Using the supplied tool, turn the dial clockwise to increase, or counterclockwise to decrease the input level.

(22) LCD Display:

This display shows the following information:

TV:Transmit Channel Number: 30:01 – 33:47

Battery Condition: Using a 3 step indicator - 1 (Low) to 3 (High)

To change the TV:Transmit channel number: Use the tip of the tool provided and press the UP or DOWN button to the desired channel, number appears (refer to the included chart). Once the desired TV:Transmit channel number has been selected on the transmitter, set the receiver to the same number.

The TV:Transmit channel display is made of two parts. The first number is the actual TV channel (30-33) and the second is the "transmit channel" number (01-47).

3