

Mommy 2 can HD IP Camera

IP-2100

3 Minutes DIY installation

User's Manual



Wired Network Installation

1 Hardware Installation



- Step1 : Connect IP-2100 and IP router with ethernet cable.
- Step2 : Plug IP-2100 power adaptor in an indoor outlet.
- Step3 : Installation will be completed in 30 seconds meanwhile the Green LED lights up.

2 APP Setting

Setting Method A: Smart phone/Tablet and IP-2100 use the same LAN

- Download and start "HDMommyCan" APP
 - Tap "Add New Camera"
 - Select and tap IP-2100's UID and password: **admin**
- ※ If many UIDs are found, means there are other IP Cams connect to the LAN, please select the UID shown on your IP-2100's bottom label

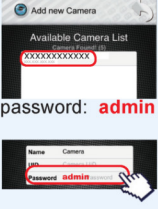

3

- Tap to start "HDMommyCan" and select the SSID you prefer to connect with, after entering the SSID password, the system will reboot, the UID setting will be completed automatically in 1 minute.



※ Please repeat "WiFi Installation" section if you want to change the connected router.

Wall Mounting Installation

※ Please follow below steps to install IP-2100 on concrete or brick wall:

- Use a hammer to fix the screw bolts into the holes you want to fix the screws in.
- Put the screws into the screw holes on the mounting base, fix well with a screw driver.
- Fix the mounting base with IP-2100 main unit.
- Adjust the angle of the mounting base to complete the installation.



※ Warning : An electronic driller or other tools will be used for above installation, if you are not able to using the electronic tools, please request others who are capable of use the tools to operate the installation. A proper protection equipment is strongly suggested before the installation to avoid damage or injure of people.

6

Quick Installation

Wired Network Installation:

※ Please connect the ethernet cable before plug the power adaptor.

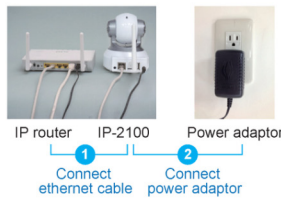

Operate your Smart phone/Tablet

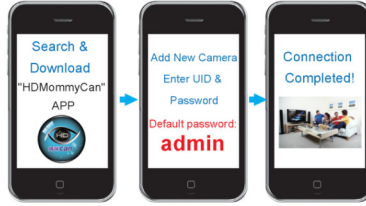

LED Indicator

LED Indicator	Status	Description
Green LED	off	No power supply
	Always lighted	Ready for internet connection
Red LED	Always lighted	No connection to Internet (※1)
	Flashing	AP mode (※2)

- ※1 Please make sure if the IP-2100 is in starting up status or no connection to Internet, if you want to use Smart phone/Tablet to connect with IP-2100 through 3G, please ensure the Internet is connected well and Green LED is always lighted.
- ※2 For more details for AP mode setting, please refer to "WiFi Installation" section.

1

Introduction

Thank you for purchasing IP-2100 HD IP Cam, please check if the enclosed items in the package are complete with nothing missing, if not, please contact the vendor you purchased IP-2100 for assistance. This User's Manual is for iOS smartphone, some instructions are different with Android system.

Package Content



IP-2100 Main Unit



※ Please do not modify the CMOS LENS to avoid damages.

2

WiFi Installation

1 Hardware Installation



- Step1 : Install the WiFi antenna to IP-2100
- Step2 : Plug IP-2100 power adaptor in an indoor outlet.
- Step3 : Press on the RESET button (AP Mode) on the bottom of IP-2100 for 3 seconds, in next 1 minute, you will hear 3 beeps and a long beep, then the Red LED starts to flash that means the installation is completed.

2 APP Setting

- Download and start "HDMommyCan" APP
- Enter Smart phone/Tablet WiFi Setting, tap to connect "PX-ipcsm-00 XX:XX:XX:XX:XX" please ensure the WiFi is well connected.

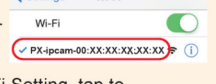

5

APP Operation

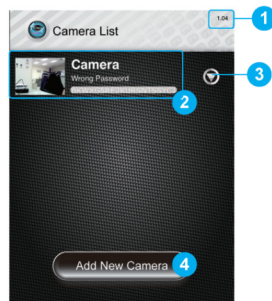

APP Operation Description :

- APP version
- Watch monitor video
- Camera Settings
- Add New Camera

Monitor Video Descriptions :

- System Info: Model name/Firmware version
- Previous Page: Return to previous page
- Refresh: Tap to re-connect to internet
- Status: Connection Information
- Resolution: Resolution Setting
- Snapshot: Save snapshots in Smart phone/Tablet
- Review: Review snapshots
- Auto horizontal patrol recording, tap again to cancel
- Auto vertical patrol recording, tap again to cancel
- Mode: Mute /Sound Monitor /Walkytalky

7

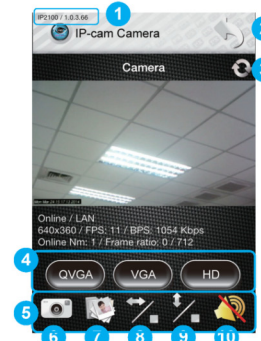

8

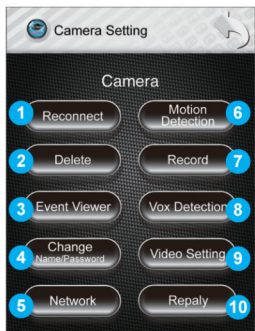

Camera Setting :

- 1 **Reconnect** Refresh the connection
- 2 **Delete** Remove the Camera
- 3 **Event Viewer** Review the event list



- 7 **Record** Record the video and save in the SD Memory Card, please insert the SD Memory Card to enable the recording function

Recording Mode	Resolution
VGA	640 X 360
HD	1280 X 720

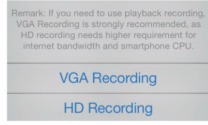

* A "Class 10 High Speed SD Memory Card" is recommended to use.

* Please format your Memory Card periodically to ensure the Memory Card has steady writing and reading. If the Memory Card can not be formatted, it may be broken, please change a new one to replace it.
 * Due to the variety of specification among different brands' SD Memory Cards, there might be compatibility issues when you use one with IP-2100, please refer to below list for compatible SD Memory Cards.

Memory Brand	ADATA	APACER	KINGSTON	SANDISK
Capacity Space	8G	8G	8G	16G
	32G		16G	32G
Memory Brand	SP	TEAM	TRANSEND	
Capacity Space	16G	16G	16G	
	32G	32G	32G	

4 **Change Name/Password** Change the name, password of the Camera

Correct the wrong password

Dismiss OK

* If the camera is connected to multiple smartphones, you will need to use the same password you set in the first smartphone.

5 **Network** WiFi Setting (For wired network installation only)

* Tap WiFi SSID and enter the password, after the Camera and APP reboot and SSID is connected, unplug the ethernet cable.

8 **Vox Detection** Slide the bar to setup the Vox Detection Sensitivity Level, if a sound that volume is over the level is detected, the alarm (or a pre-recorded sound) will be activated.

Vox Detection Sensitivity Level	Volume
0	Disabled
1	80dB
2	75dB
3	70dB
4	65dB
5	55dB

- 1 The email is the same with the one set in 6
 - 2 Tap to start recording the alarm sound; tap again to finish the recording. There will be only one sound alarm file at the same time, the later recorded sound alarm will replace the previous one.
- * This function can be used in LAN and a SD Memory Card is also necessary.
 * Recorded Sound Alarm has a 10 seconds limitation in length.

Q&A

- Q1:When I use the walky-talky, there are echoes heard, why?
 A1:The echoes occur when you use the smartphone and the IP-2100 in the same room, please do not use the walky-talky in such situation.
- Q2:Why the monitor videos shown on Smartphone do not sync with IP-2100?
 A2:The latency is due to variety of internet speed or Smartphone's CPU power.
- Q3:I can't review the events nor record the videos, why?
 A3:Please insert the Micro SD Memory Card in the IP-2100 to enable the functions.
 Q4:I forget my password.
 A4:Press on the RESET button (AP Mode) on the bottom of IP-2100 for 3 seconds, in next 1 minute, you will hear 3 beeps and a long beep, then the Red LED starts to flash that means the installation is completed.
- Q5:Why the events recorded in the "Event" disappeared?
 A5:(1)The memory will be removed when the power is reset, so the recorded events will be removed.
 (2)There are maximum 50 events can be recorded, when the 51st event is record, the 1st event will be replaced and so on.
- Q6:What is "Sound Alarm"?
 A6:A Micro SD Memory Card is needed to enable this function which allows you to record your sound/voice to be a Sound Alarm, when IP-2100 detects a sound that volume value is over the preset value limitation, the Sound Alarm will be played. The preset volume limitation list is as below:
- | | 0 | 1 | 2 | 3 | 4 | 5 |
|--|-----|-------|-------|-------|-------|-------|
| | off | 80 dB | 75 dB | 70 dB | 65 dB | 55 dB |

For your Safety

- Please do not change the RF power and frequency of the product, any intentional, unauthorized change on the specification, design and electrical characteristic of the product are not allowed.
- Please do not use this product near water or use in a humid place.
- Please do not open the main unit.
- Remove or damage of the warranty label will lead the warranty invalid.
- Do not plug the power adaptor overloading, remove the power adaptor from the power outlet during long time idle.
- Do not use this product in high temperature environment.
- If any smoke or smell is produced by the product, please stop using and remove the power plug from the power outlet.
- Clean the product with soft cloth & neutral cleanser.
- Do not use volatilizable liquid to clean the product.

6 **Motion Detection** Motion Detection: Auto snapshot and send a notice info to the smartphone and the preset email.

* Please enable Motion Detection function and drag the detection frame to the preferred detection area. (This setting is recommended to be done in LAN connection)
 * Only Gmail supports email notification function

Email Setting : Gmail is recommended to use for the setting, below setting uses Gmail as an example.

- 1 SMTP name: smtp.gmail.com
- 2 Port Number: 587
- 3 SMTP account: Please enter your Gmail account
- 4 SMTP password: Please enter your password
- 5 Email Address: Please enter your email address
- 6 Security Type: Please select STARTTLS

* If you prefer to use other email domain, please enter corresponding SMTP information.

- 9 **Video Setting** Setting up monitor directions, resolution and power frequency

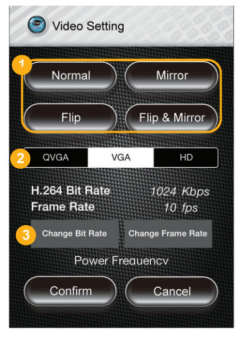

1 **Monitor Directions**

Function	Description
Normal	Default
Flip	Up-Down Reverse
Mirror	Right- Left Reverse
Flip & Mirror	Up-Down & Right-Left Reverse

- 2 **Resolution Setting**

Format	H.264 code	Frame
QVGA 320 x 180	512 kbps · 256 kbps · 192 kbps	30 fps · 25 fps · 20 fps 15 fps · 10 fps · 5 fps
VGA 640 x 360	1 Mbps	15 fps · 12 fps · 10 fps 8 fps · 6 fps · 5 fps 3 fps · 1 fps
HD 1280 x 720	2 Mbps · 1.5 Mbps · 1 Mbps	8 fps · 6 fps · 5 fps 3 fps · 1 fps

* Default is marked in blue

- 3 **Power Frequency :** 50Hz · 60Hz

- 10 **Replay** Recorded videos playback (Only one connected smartphone can use this function at a time)



* If above list is not shown, means:
 1.The "Record" function is not enabled.
 2.The SD Memory Card is not compatible, please refer to the Compatibility List.

47 CFR 15.105 - Information to the user

This equipment has been tested and found to comply with the limits for a Class B digital device, pursuant to part 15 of the FCC Rules. These limits are designed to provide reasonable protection against harmful interference in a residential installation. This equipment generates, uses and can radiate radio frequency energy and, if not installed and used in accordance with the instructions, may cause harmful interference to radio communications. However, there is no guarantee that interference will not occur in a particular installation. If this equipment does cause harmful interference to radio or television reception, which can be determined by turning the equipment off and on, the user is encouraged to try to correct the interference by one or more of the following measures:
 —Reorient or relocate the receiving antenna.
 —Increase the separation between the equipment and receiver.
 —Connect the equipment into an outlet on a circuit different from that to which the receiver is connected.
 —Consult the dealer or an experienced radio/TV technician for help.

FCC Caution:
 1. This device complies with Part 15 of the FCC rules. Operation is subject to the following two conditions:
 (1) This device may not cause harmful interference, and
 (2) This device must accept any interference received, including interference that may cause undesired operation.
 2. This device and its antenna(s) must not be co-located or operating in conjunction with any other antenna or transmitter.
 3. Changes or modifications to this unit not expressly approved by the party responsible for compliance could void the user authority to operate the equipment.

IMPORTANT NOTE :
 FCC Radiation Exposure Statement:
 This equipment complies with FCC radiation exposure limits set forth for an uncontrolled environment. This equipment should be installed and operated with minimum distance 20cm between the radiator & your body.