

EarSet 2

Guide

BANG & OLUFSEN 

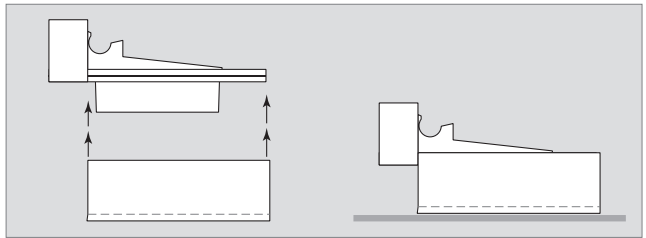
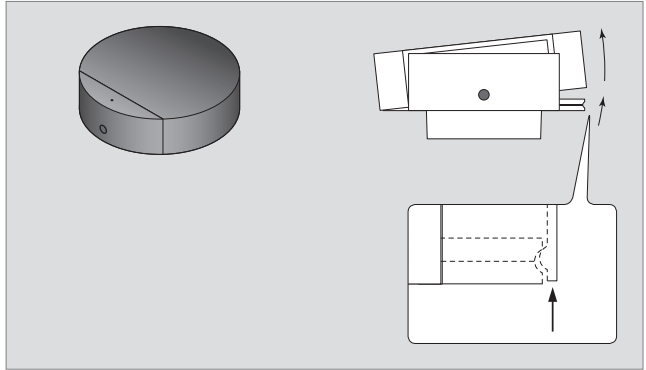

Contents

3

English, 4

Français, 14

Español, 24

日本語, 34

한글, 42

繁體中文, 50

简体中文, 58

English

Introducing EarSet 2

EarSet 2 is a headset equipped with Bluetooth wireless technology for hands-free call handling via a mobile phone, such as Serene, or other products with Bluetooth wireless technology.

Make and receive calls, transfer calls to and from the mobile phone, and charge the headset in the enclosed charger. Place the lid on the charger and it becomes a practical carrying case.

Refer to the guide enclosed with your mobile phone for detailed information about display messages, as these vary from phone to phone.

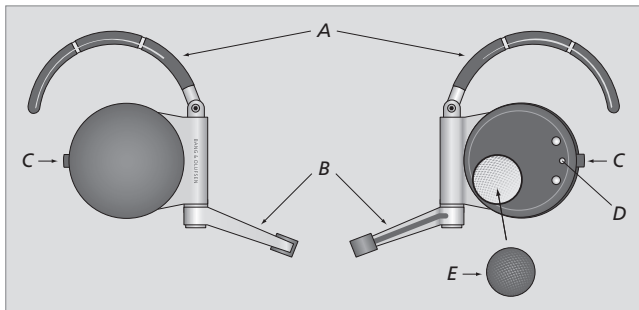

- (A) ... **Ear hook.** Tilt up and down until the speaker fits your ear.
- (B) ... **Microphone arm.** Rotate in to switch the headset off, and out to switch it on.
- (C) ... **Switch.** Push up and down to adjust volume. Press or push to answer an incoming call. Press and hold to redial the last dialed number.
- (D) ... **Indicator light.** Shows the state of the headset.
- (E) ... **Ear pad.** Put the ear pad on the speaker for greater listening comfort.

Indicator light on the headset

The indicator light on the headset (*D*) informs you about the current state of the headset. The signals – which can only appear while the headset is on – are explained below:

Light off ... No power. Charge the battery as described in ‘*Charge the headset battery*’.

Flashing green, slow ... Ready for use.

Flashing green, rapid ... Incoming or active call.

Flashing red, slow ... Ready for use, but the battery requires charging.

Flashing red, rapid ... Indication during an incoming or active call that the battery requires charging.

The indicator light flashes red when there is less than five minutes of talk time left.

Sound feedback

Beep sounds inform you about the state of the phone. The sounds and situations are described below.

One beep

- Limit for speaker volume reached
- Call rejected
- Redial call started

Two beeps

- Call audio on in the headset (rising tone)
- Call audio off in the headset (falling tone)

Repeating beep

- Battery low. Repeats three times at thirty second intervals
- Microphone muted. Repeats continuously at 1.5 second intervals

Wear the headset

- > Fold the microphone arm out as shown. This switches on the headset.
- > Place the speaker in your ear, adjusting the height and angle of the ear hook as necessary. Make sure that the microphone always points towards your mouth. This ensures the best sound quality.

EarSet 2 is intended for use in dry, domestic environments only, within a temperature range of 10–40°C (50–104°F).

Charge the headset battery

If the headset requires charging, this occurs automatically when the headset is placed in the charger.

About charging ...

- The charger must be connected to the power outlet.
- It takes approximately three hours to fully charge the battery.
- The minimum talk-time per charge is approximately four hours.
- Standby time per charge is approximately 100 hours.

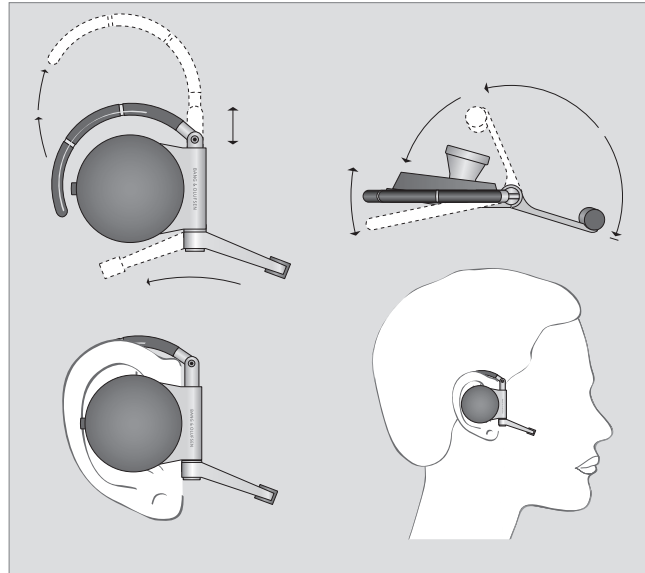
**Indicator light on the charger**

The indicator light on the charger (F) informs you about the current state of the charger.

Light off ... Headset not connected to charger.

Steady red ... Charging in progress.

Steady green ... Charging complete.

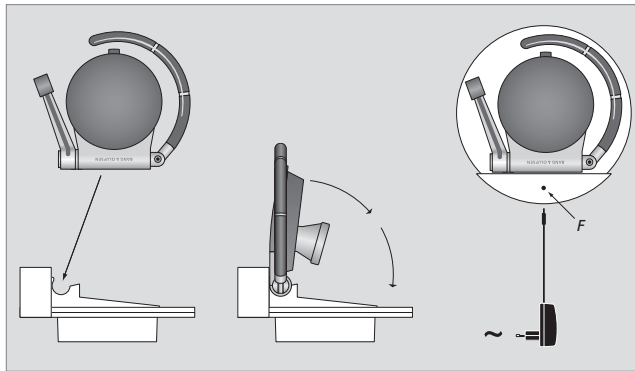

You can always place the headset in the charger after use, even if the battery does not need recharging. Leaving the headset in the charger does not reduce the lifetime of the battery.

TIP: If you do not wish to use the charger as a carrying case, you can use the lid as a table stand. Place the lid on the table with the top side down and place the charger in the lid.

WARNING! For use only with the power supply included with the product!

Manufacturer: Salcomp

ID-nummer: 8040017, 8040018, 8040020, 8040022, 8040023 or 8040024.

Register the headset to your mobile phone

To be able to use the headset, you must first register it to a mobile phone with Bluetooth or to a similar device with a hands-free profile.

You can only register the headset to one mobile phone or device at a time.

To register the headset ...

- > Switch on the mobile phone.
- > If you are registering the headset for the first time, fold the microphone arm out. This switches on the headset. The indicator light flashes red and green.
- > Activate the search function on your mobile phone as described in the guide enclosed with the phone. When the mobile phone finds the headset, the headset is identified as *EarSet 2* in the mobile phone's display.
- > If you are prompted for a pincode by your mobile phone, enter 0000. The headset is now registered to the phone.
- > If registration fails, switch off the headset and repeat the procedure.

Register the headset to a new mobile phone

> Switch on the mobile phone. *Do the next three steps in five seconds or less.*

- > Press and hold the switch.
- > Fold the microphone arm out.
- > When the indicator light flashes red and green, release the switch.
- > Activate the search function on your mobile phone as described in the guide enclosed with the phone. When the mobile phone finds the headset, the headset is identified as *EarSet 2* in the mobile phone's display.
- > If you are prompted for a pincode by your mobile phone, enter 0000. The headset is now registered to the phone.
- > If registration fails, switch off the headset and repeat the procedure.

Make and answer calls

There are several ways to make calls. This depends on which mobile phone you use. Refer to the guide enclosed with your mobile phone for further instruction.

Make sure that the headset is switched on. This is done by folding the microphone arm out.

Ways to make a call ...

- Make the call on your mobile phone. With some models, the call audio is automatically transferred to the headset. With others, you must transfer the call audio manually. A beep sounds from the headset when the audio is transferred.
- If your mobile phone or device supports voice activated calls, press the switch to activate the function.
- If your mobile phone or device supports redial, press and hold the switch for at least 1.5 seconds to redial the last dialled number.

Answer a call ...

When an incoming call is registered, the mobile phone and headset start ringing.

- > To answer the call, push or press the switch. A beep sounds from the headset when the call audio is connected.
- > To reject an incoming call, press and hold the switch until a beep sounds in the headset.

To end a call ...

There are several ways to end a call.

- Press the switch.
- Fold the microphone arm in.
- End the call manually on your mobile phone.

A beep sounds in the headset when the call is ended.

When using the headset, make sure the mobile phone is no further than 10 m (30 ft) from the headset.

To transfer calls between the mobile phone and headset ...

- > To transfer a call from your mobile phone to the headset, press the switch. A beep sounds from the headset when the call audio is connected.
- > To transfer a call from the headset back to the phone, use the mobile phone's transfer function.

It is only possible to use Call Waiting, place calls on hold and switch between calls on mobile phones that support these services and functions.

Volume and the microphone

During calls, you can adjust the volume by pushing the switch up or down. There are eight possible settings. When you reach the upper or lower limit for sound volume, a beep sounds from the headset.

The selected volume level is used for all subsequent calls, but the maximum volume setting that can be stored is 6.

To switch the microphone off during a call, press and hold the switch until you hear a beep from the headset. A repeating beep is heard until the microphone is switched back on.

To switch the microphone back on, press or push the switch.

Adjust the headset ringer level

During standby, you can adjust the headset ringer level by pushing the switch up or down. There are eight possible settings. After each adjustment, the ringer melody is played once.

The selected ringer level is used for all subsequent calls.

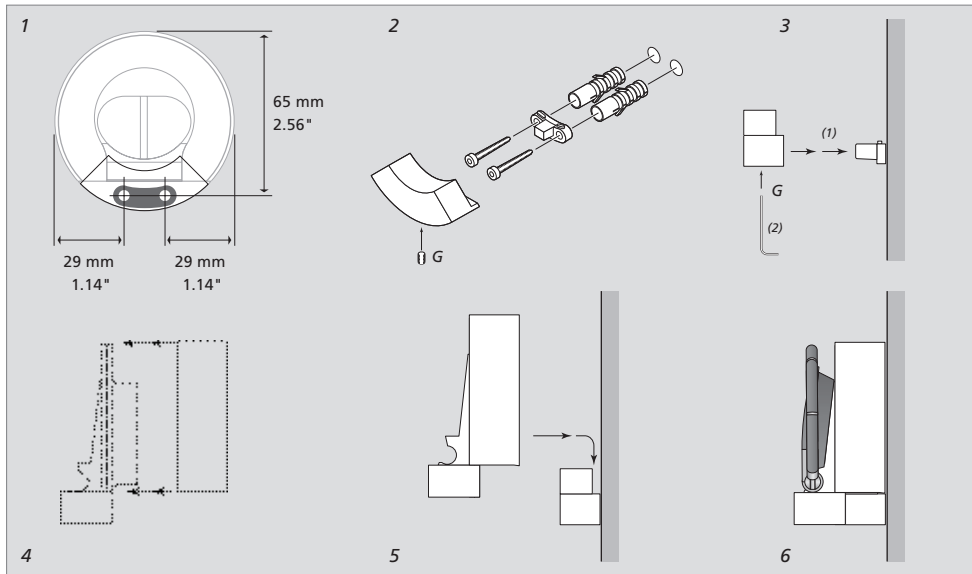

Mount the charger on the wall

If you choose, you can hang the charger on a wall, using the charger lid to mount the charger on the enclosed wall bracket.

For the US and Canadian markets only!

CAUTION: This equipment has been tested and found to comply with the limits for a class B digital device, pursuant to part 15 of the FCC Rules. These limits are designed to provide reasonable protection against harmful interference in a residential installation.

Operation is subject to the following two conditions:

- 1 This device may not cause harmful interference, and
- 2 This device must accept any interference received, including interference that may cause undesired operation

Warning: Changes or modifications made to this equipment not expressly approved by Bang & Olufsen may void the FCC authorization to operate this equipment.

This equipment generates, uses and can radiate radio frequency energy and, if not installed and used in accordance with the

instructions, may cause harmful interference to radio communications. However, there is no guarantee that interference will not occur in a particular installation. If this equipment does cause harmful interference to radio or television reception, which can be determined by turning the equipment off and on, the user is encouraged to try to correct the interference by one or more of the following measures:

- Reorient or relocate the receiving antenna.
- Increase the separation between the equipment and receiver.
- Connect the equipment into an outlet on a circuit different from that to which the receiver is connected.
- Consult the retailer or an experienced radio/TV technician for help.

The radiated output power of Bang & Olufsen Earset 2 is far below the FCC radio frequency exposure limits. Nevertheless, the Bang & Olufsen Earset 2 shall be used in such a manner that the potential for human body contact

during normal operation is minimized.

For the Canadian market only!

This class B digital apparatus meets all requirements of the Canadian Interference-Causing Equipment Regulations and with RSS-210 of Industry Canada.

CAUTION: To prevent electric shock, do not use the polarized plug, attached to this apparatus, with an extension cord, receptacle or other outlet unless the blades can be fully inserted to prevent blade exposure.

NOTICE: The Industry Canada label identifies certified equipment. This certification means that the equipment meets telecommunications network protective, operational and safety requirements as prescribed in the appropriate Terminal Equipment Technical Requirements document(s). The Department does not guarantee the equipment will operate to the user's satisfaction.

Before installing this equipment, users should ensure that it is permissible to be connected to the facilities of the local telecommunications company. The equipment must also be installed using an acceptable method of connection. The customer should be aware that compliance with the above conditions may not prevent degradation of service in some situations. Repairs to certified equipment should be coordinated by a representative designated by the supplier. Any repairs or alterations made by the user to this equipment, or equipment malfunctions, may give the telecommunications company cause to request the user to disconnect the equipment.

Users should ensure for their own protection that the electrical ground connections of the power utility, telephone lines and internal metallic water pipe system, if present, are connected together. This precaution may be particularly important in rural areas.

CAUTION: Users should not attempt to make such connections themselves, but should contact the appropriate electric inspection authority, or electrician, as appropriate.

NOTICE: The Ringer Equivalence Number (REN) assigned to each terminal device provides an indication of the maximum number of terminals allowed to be connected to a telephone interface. The termination on an interface may consist of any combination of devices subject only to the requirement that the sum of the Ringer Equivalence Numbers of all the devices does not exceed 5.

To prevent radio interference to the licensed service, this device is intended to be operated indoors and away from windows to provide shielding. Equipment (or its transmit antenna) that is installed outdoors is subject to licensing.

Waste Electrical and Electronic Equipment (WEEE) – Environmental protection

The European Parliament and the Council of the European Union have issued the Waste Electrical and Electronic Equipment Directive. The purpose of the Directive is the prevention of waste of electrical and electronic equipment, and to promote the reuse and recycling and other forms of recovery of such waste. As such the Directive concerns producers, distributors and consumers.

The WEEE directive requires that both manufacturers and end-consumers dispose of electrical and electronic equipment and parts in an environmentally safe manner, and that equipment and waste are reused or recovered for their materials or energy. Electrical and electronic equipment and parts must not be disposed of with ordinary household refuse; all electrical and electronic equipment and parts must be collected and disposed of separately. Products and equipment which must be collected for reuse, recycling and other forms of recovery are marked with the pictogram shown.

When disposing of electrical and electronic equipment by use of the collection systems available in your country, you protect the environment, human health and contribute to the prudent and rational use of natural resources. Collecting electrical and electronic equipment and waste prevents the potential contamination of nature with the hazardous substances which may be present in electrical and electronic products and equipment. Your Bang & Olufsen retailer will assist with and advise you of the correct way of disposal in your country.



CE *This product fulfils the conditions stated in the EEU directives 89/336 and 73/23.*

This product is CE marked according to provisions of the R&TTE Directive (99/5/EC). Hereby, Bang & Olufsen declares that this product is in compliance with the essential requirements and other relevant provisions of Directive 1995/5/EC.