

HORIZON[®]
H O B B Y

Flyzone[®]
how high will you soar™

Fokker D.VII

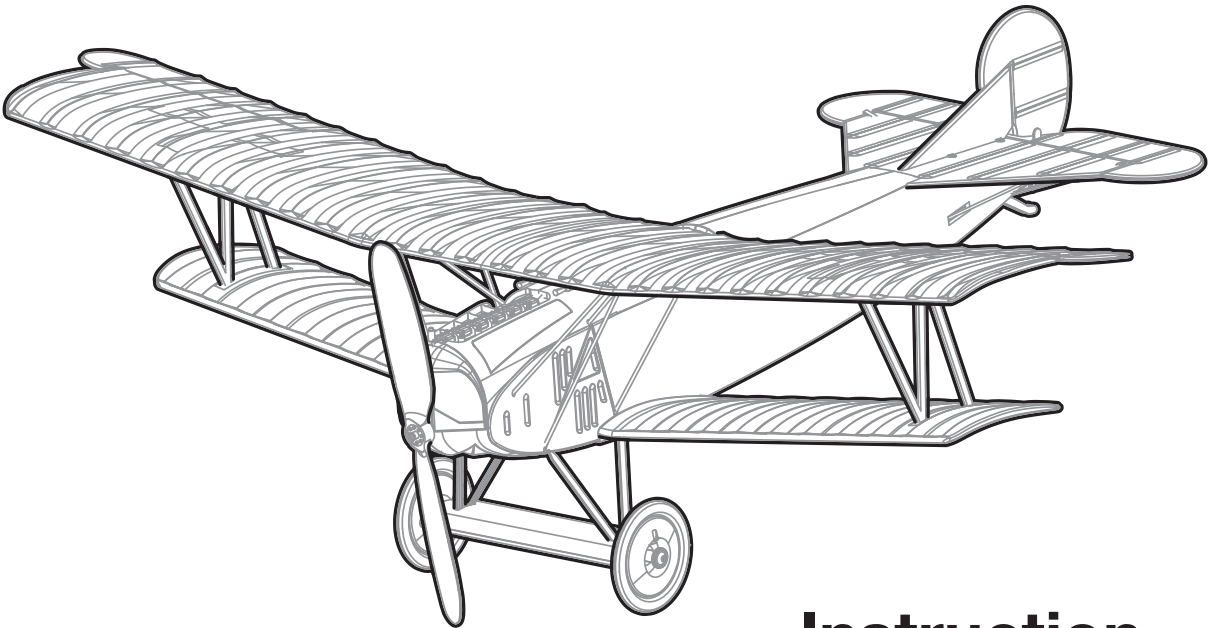

Instruction Manual



WARNING: This product may use a lithium polymer (LiPo) battery. Improper handling may result in FIRE! You are responsible for following all safety precautions as outlined in this instruction manual.

NOTICE

All instructions, warranties and other collateral documents are subject to change at the sole discretion of Horizon Hobby, LLC. For up-to-date product literature, visit www.horizonhobby.com and click on the support tab for this product.

Meaning of Special Language

The following terms are used throughout the product literature to indicate various levels of potential harm when operating this product:

WARNING: Procedures, which if not properly followed, create the probability of property damage, collateral damage, and serious injury OR create a high probability of superficial injury.

CAUTION: Procedures, which if not properly followed, create the probability of physical property damage AND a possibility of serious injury.

NOTICE: Procedures, which if not properly followed, create a possibility of physical property damage AND little or no possibility of injury.

 **WARNING:** Read the ENTIRE instruction manual to become familiar with the features of the product before operating. Failure to operate the product correctly can result in damage to the product, personal property and cause serious injury.

This is a sophisticated hobby product. It must be operated with caution and common sense and requires some basic mechanical ability. Failure to operate this product in a safe and responsible manner could result in injury or damage to the product or other property. This product is not intended for use by children without direct adult supervision. Do not use with incompatible components or alter this product in any way outside of the instructions provided by Horizon Hobby, LLC. This manual contains instructions for safety, operation and maintenance. It is essential to read and follow all the instructions and warnings in the manual, prior to assembly, setup or use, in order to operate correctly and avoid damage or serious injury.

14+ AGE RECOMMENDATION: Not for children under 14 years. This is not a toy.

INCLUDED ITEMS

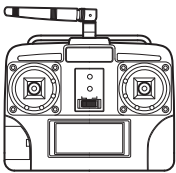

Transmitter



AA Batteries

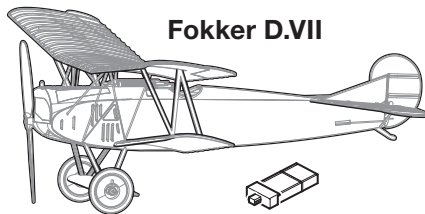

Fokker D.VII



LiPo Battery

FLZU1014 Battery 1S 80 mAh

LiPo: Flyzone Micro

Check the parts against those shown. If any parts are damaged or missing, please call Horizon Product Support at: (877) 504-0233

FCC INFORMATION

FCC ID: BRWFLZU1012

This equipment has been tested and found to comply with the limits for Part 15 of the FCC rules. These limits are designed to provide reasonable protection against harmful interference in a residential installation. This equipment generates uses and can radiate radio frequency energy and, if not installed and used in accordance with the instructions, may cause harmful interference to radio communications.

However, there is no guarantee that interference will not occur in a particular installation. If this equipment does cause harmful interference to radio or television reception, which can be determined by turning the equipment off and on, the user is encouraged to try to correct the interference by one or more of the following measures:

- Reorient or relocate the receiving antenna.
- Increase the separation between the equipment and receiver.
- Connect the equipment to an outlet on a circuit different from that to which the receiver is connected.

This device complies with part 15 of the FCC rules. Operation is subject to the following two conditions: (1) This device may not cause harmful interference, and (2) this device must accept any interference received, including interference that may cause undesired operation.

NOTICE: Modifications to this product will void the user's authority to operate this equipment.

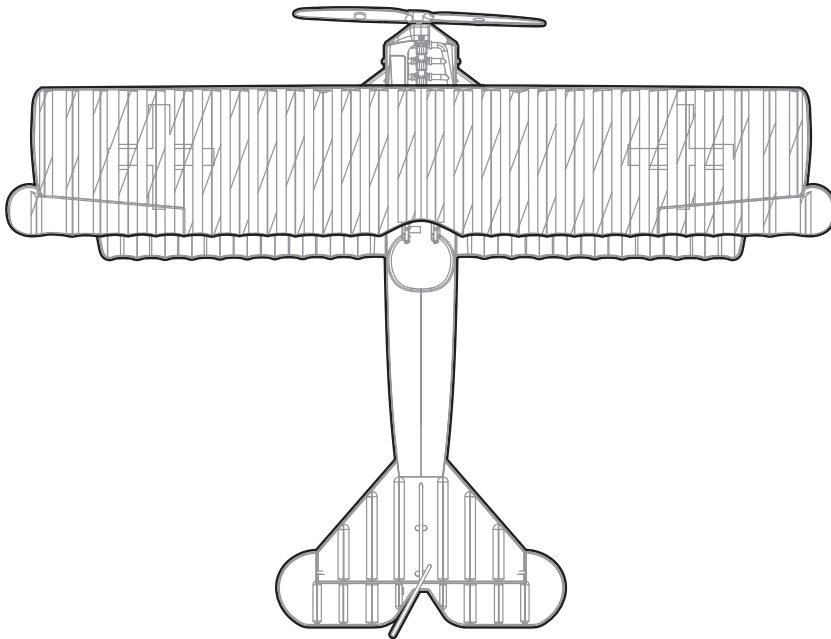

PRECAUTIONS

Your Micro Fokker D.VII model should not be considered a toy, but rather a sophisticated, working model that functions very much like a full-size airplane. Because of its performance capabilities, the model, if not assembled and operated correctly, could possibly cause injury to yourself or spectators and damage to property.

1. Operate the plane according to the instructions. DO NOT alter or modify the model. If you make any modifications, you void your warranty.
2. Test the operation of the model before each flight to ensure that all equipment is operating properly and that the model remains structurally sound.
3. Fly only indoors or outdoors on very calm days (with wind speeds less than 5 mph) and in large open areas free of trees, people, buildings, or any other obstacles.
4. Although the model is designed to be successfully flown by the first time pilot, you may still benefit from the assistance of an experienced pilot for your first flights. If you're not a member of an R/C club, your local hobby shop has information about clubs in your area whose membership includes experienced pilots. You can also contact the National Academy of Aeronautics (AMA) which has over 2,500 chartered clubs across the country. Instructor training programs and insured newcomer training are available through any of these clubs. Contact the AMA at the following address or toll-free phone number:

Academy of Model Aeronautics

5151 East Memorial Drive Ph. (800) 435-9262
Muncie, IN 47302-9252 Fx. (765) 741-0057
www.modelaircraft.org

The R/C model hobby becomes more and more enjoyable as your experience grows. Your chances for success and graduation to higher levels are very good if you take your time and follow the flying instructions carefully and completely. We hope you enjoy flying your Micro Fokker D.VII model.

TRANSMITTER CAUTIONS

- Do not use rechargeable (NiCd) batteries.
- Do not mix old and new batteries.
- Do not mix alkaline, standard (carbon-zinc) or rechargeable (NiCd) batteries.

CHARGING WARNINGS



CAUTION: All instructions and warnings must be followed exactly. Mishandling of Li-Po batteries can result in a fire, personal injury and/or property damage.

- NEVER LEAVE CHARGING BATTERIES UNATTENDED.
- NEVER CHARGE BATTERIES OVERNIGHT.
- By handling, charging or using the included Li-Po battery, you assume all risks associated with lithium batteries.
- If at any time the battery begins to balloon or swell, discontinue use immediately. If charging or discharging, discontinue and disconnect. Continuing to use, charge or discharge a battery that is ballooning or swelling can result in fire.

- Always store the battery at room temperature in a dry area for best results.
- Always transport or store the battery in a temperature range of 40–120° F (5–49° C).
- Do not store battery or model in a car or direct sunlight. If stored in a hot car, the battery can be damaged or even catch fire.
- Always charge batteries away from flammable materials.
- Always inspect the battery before charging.
- Always disconnect the battery after charging, and let the charger cool between charges.
- Always constantly monitor the temperature of the battery pack while charging.
- **ONLY USE A CHARGER SPECIFICALLY DESIGNED TO CHARGE LI-PO BATTERIES.** Failure to charge the battery with a compatible charger may cause a fire resulting in personal injury and/or property damage.
- Never discharge Li-Po cells to below 3V under load.
- Never cover warning labels with hook and loop strips.
- Never charge batteries outside recommended levels.
- Never charge damaged batteries.
- Never attempt to dismantle or alter the charger.
- Never allow minors to charge battery packs.
- Never charge batteries in extremely hot or cold places (recommended between 40–120° F or 5–49° C) or place in direct sunlight.

BATTERY CHARGING PRECAUTIONS

1. Always remove the battery from the model before charging.
2. Do not leave a charging battery unattended! Unplug the battery if it gets warm, even if the charge LED has not gone out.
3. Charge on a fireproof surface away from potentially flammable objects.
4. Use only the charger built into the included transmitter!



WARNING: Misuse or malfunction may overheat the battery and charger, resulting in personal injury or damage to surroundings.

LITHIUM POLYMER BATTERY RECYCLING

ATTENTION: The product you have purchased is powered by a rechargeable battery. At the end of the battery's useful life, under various state and local laws, it may be illegal to dispose of this battery into the municipal waste system. Check with your local solid waste officials for details in your area for recycling options or proper disposal.



WARNING: This product contains a chemical known to the State of California to cause cancer.

GLOSSARY

- **Lithium Polymer (LiPo) Battery:** Rechargeable battery which is used to power the airplane. LiPo batteries are lighter and smaller than most other types of rechargeable batteries.
- **Transmitter (TX):** This is the hand-held unit that sends the signal to the 3-in-1 control unit.
- **Rudder:** The flight control on the airplane that controls turning direction. This will yaw the plane so that the nose points in the direction of the turn and will cause the wings to roll into the turn.
- **Elevator:** The flight control that controls pitch attitude. By adding power and pitching up, you can make the model climb or loop.
- **Servo:** The device on the model that moves the flight controls.
- **Glide Slope:** The proper path for an airplane approaching a landing strip.

PREPARE THE TRANSMITTER

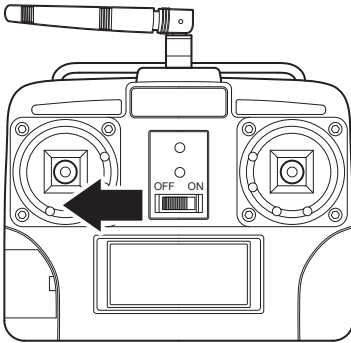

Leave the transmitter unpowered.

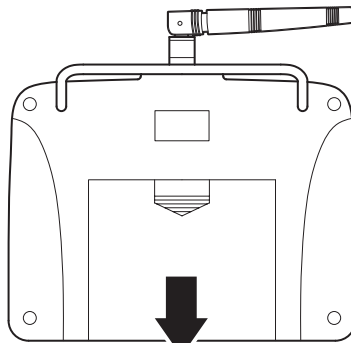

Push and slide to remove the battery door.

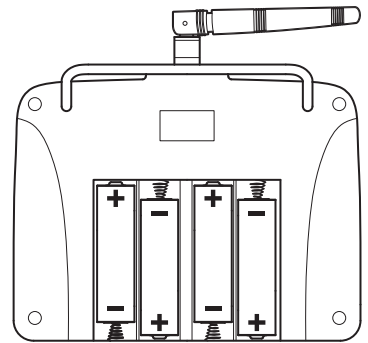

Install 4 "AA" batteries and reinstall the battery door.

CHARGE THE 3.7V 80mAh LIPO BATTERY

Do not use the charge feature while flying the model!

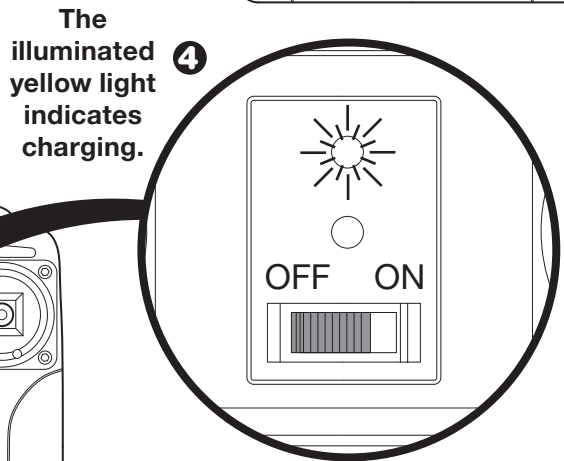
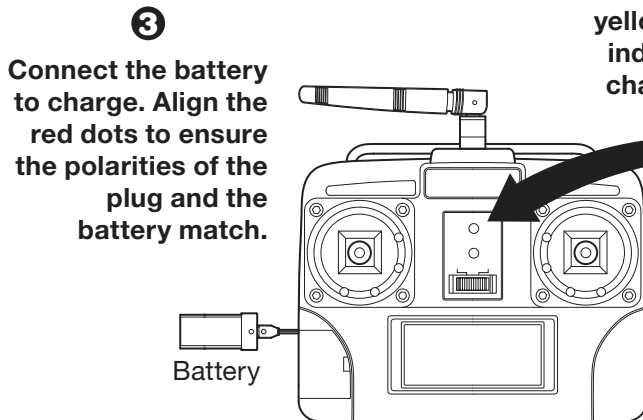
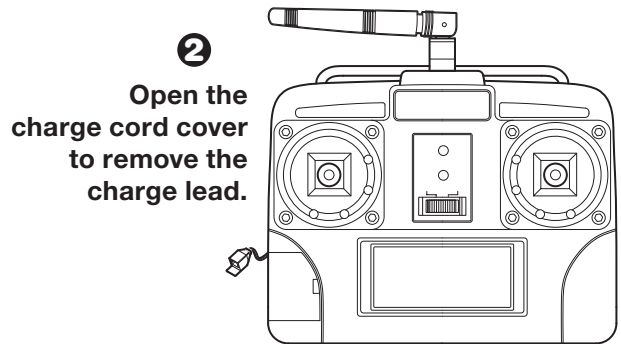
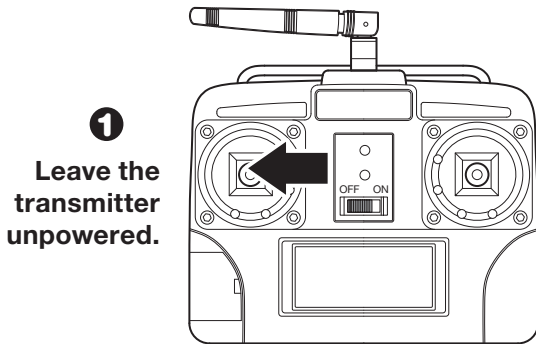

Battery

The yellow light will go out when charging is complete.

NOTE: The battery will not begin charging if more than 75% of the charge remains in the battery.

POWER THE TRANSMITTER

Leave the left stick (throttle control) in the minimum position during setup.

Power switch "ON".

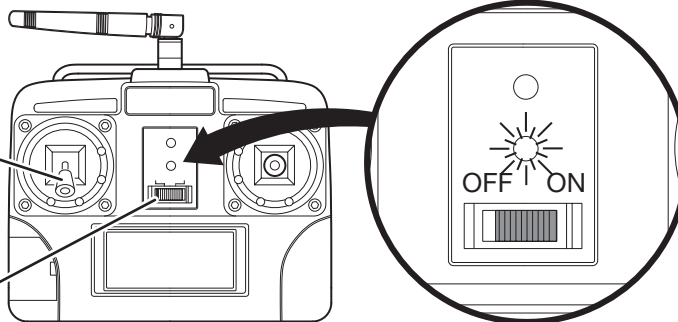

Illuminated red light indicates the transmitter is powered and transmitting.

INSTALLATION AND REMOVAL OF THE LIPO BATTERY



CAUTION: Keep hands clear of propeller during battery installation and removal.

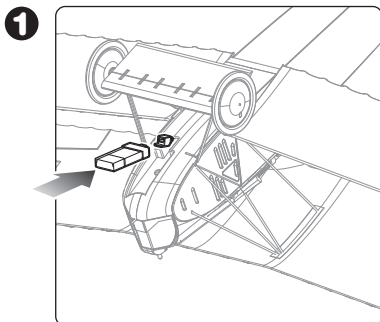

1 Use two fingers to secure connector during battery installation and removal.

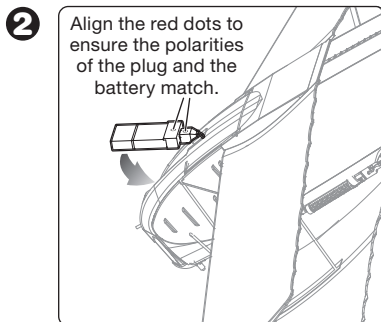

2 Align the red dots to ensure the polarities of the plug and the battery match.

Connect the LiPo to the lead.

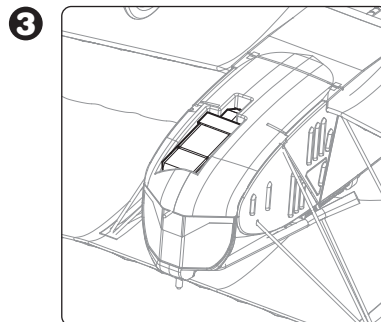

3 The battery is held in place magnetically.

Disconnect and remove the battery after use by holding the battery lead with two fingers and removing the battery from the lead with the other hand. Do not yank or jerk the battery from the aircraft. This could dislodge the 3-in-1 control unit from the model. **Note:** The battery features a small metal dot that secures the battery to the magnet in the battery compartment. Without the dot the battery will not attach.

CHECK THE CONTROL SURFACE DIRECTION

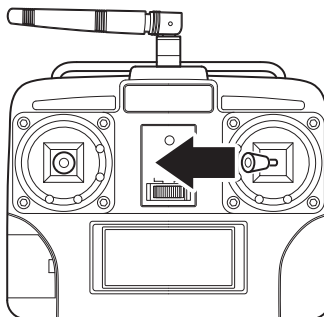
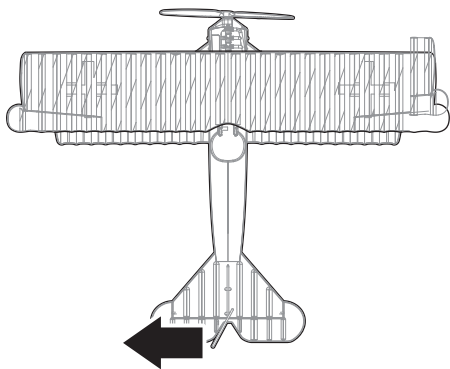

Right stick moves left, rudder moves left, causing the aircraft to bank to the left.

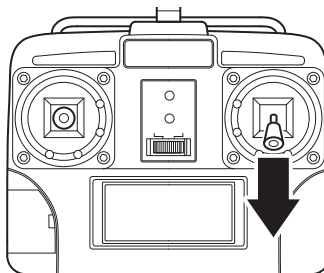
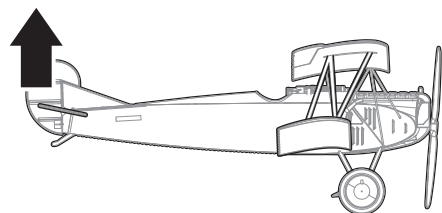

Right stick moves down, elevator moves up causing the aircraft's nose to pitch up, gaining altitude.

CENTER THE CONTROL SURFACE DIRECTION

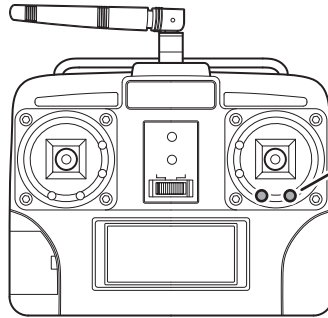
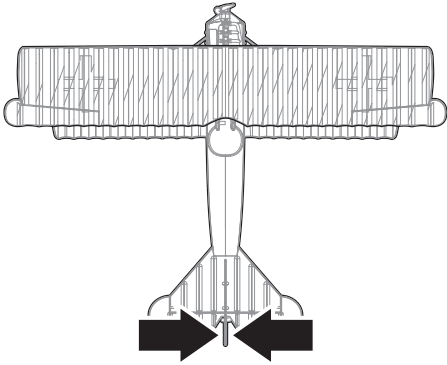

Before flight, center rudder control surface with rudder trim adjustment.

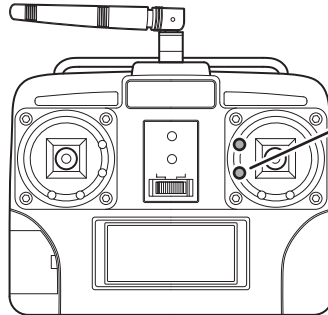
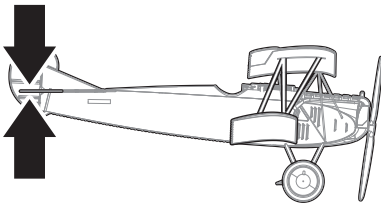

Before flight, center elevator control surface with elevator trim adjustment.

CHOOSE A FLYING SITE

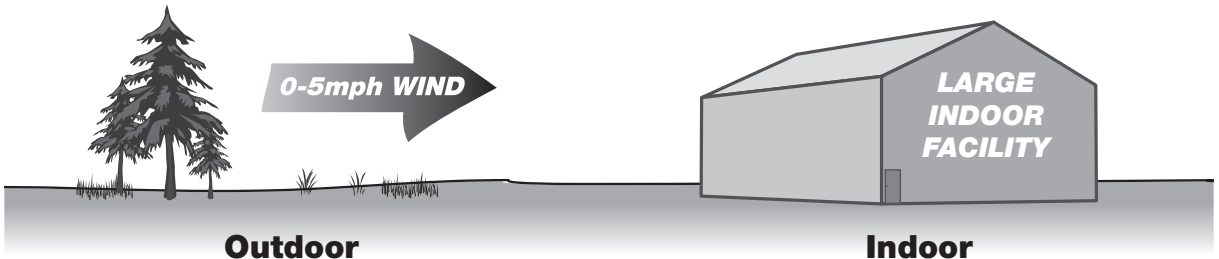

RANGE CHECK

With the transmitter powered and the battery plugged into the plane, walk 50' [15m] from the aircraft and check the control functions for proper operation.

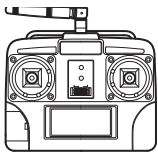

50' [15m]

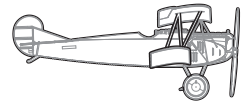

NOTE: If the control surfaces move but the throttle does not work, unplug the LiPo from the plane and turn off the transmitter. Be sure the throttle stick is at the lowest position when turning the transmitter back on.

FLYING THE FOKKER

If anytime during operation the controls or propeller become jammed or unresponsive, lower the power to the propeller and land. Disconnect, then reconnect the battery on the plane to attempt to regain control.

Take off into the wind. If hand launching, “gently” throw the airplane, at half throttle, so it is straight and level (not nose up). As it gains speed, add in a small amount of elevator.

Once in the air, gain altitude to allow yourself sufficient reaction time to make a correction during flight. Once you’re comfortable, adjust the rudder and elevator trims one increment at a time so that the plane flies straight and level with the right control stick centered.

Concentrate on brief control stick inputs of rudder so that the plane turns with minimum aircraft roll. A slight amount of up elevator may be necessary to maintain altitude going into a turn and the elevator will need to be returned to neutral when coming out of a turn to avoid gaining altitude.

It’s recommended that you attempt to land before the motor cuts out due to low voltage. Attempt to always land into the wind by pitching the elevator up, slowing the descent and reducing the glide slope. Gradually reduce the throttle and just before touchdown apply some up elevator to land safely on the landing gear and tail skid. Unpower the model, then switch off the transmitter. Allow the motor to cool between flights.

Note: With conservative throttle control, 7+ minutes of flight time can be expected.

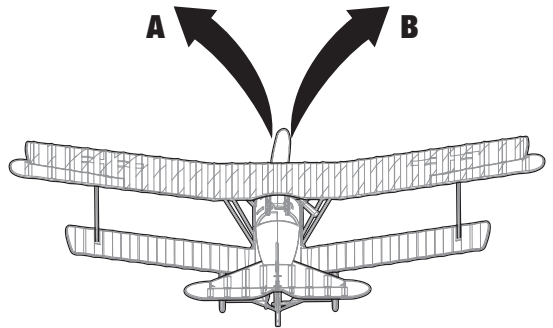
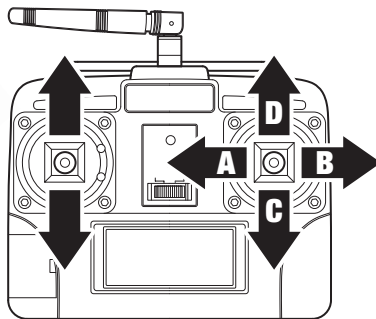
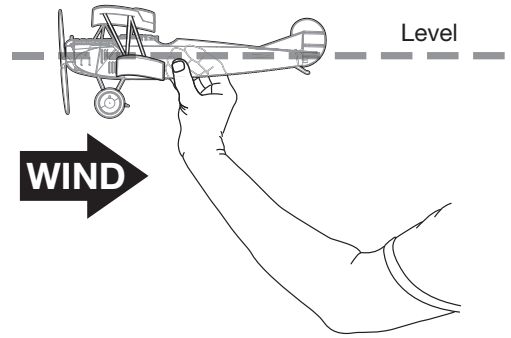

Use these to trim the plane for straight and level flight, when the right stick is centered.

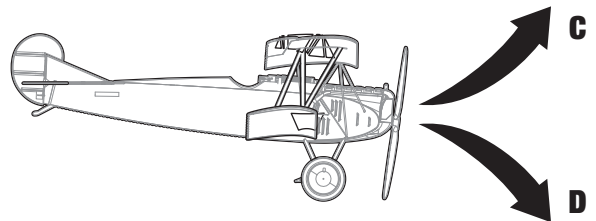
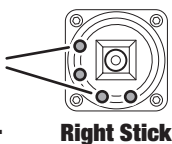

BINDING

The airplane comes bound to the transmitter. Should you need to re-bind, follow these steps.

1. Turn on both transmitter and aircraft.
2. Press both throttle trim buttons simultaneously.
3. The transmitter will beep until binding is completed automatically.
4. Rudder and elevator will move briefly.
5. Beeping will stop, binding complete.

Arming

When the transmitter and airplane are powered on, the aircraft binds automatically and the tail surfaces move briefly. After that, all functions are active and the propeller will spin when the throttle stick is moved.

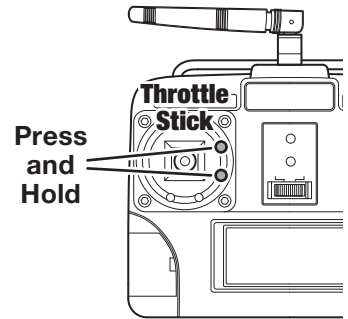

SERVO REVERSING

Complete all steps with the transmitter and aircraft powered on.

The transmitter features servo reversing on the rudder and elevator channels. The servo direction was set correctly at the factory however, in case any of the controls are operating in the wrong direction or you use the electronics in other models later, please follow these steps to change the servo directions as needed. Complete all steps with the transmitter and aircraft powered on.

Rudder Channel Servo Reversing

Press and hold the right rudder trim button, then press the left rudder trim button. Release both buttons and the servo direction will be reversed. Repeat to change back.

Elevator Channel Servo Reversing

Press and hold the right rudder trim button, then press the down elevator (top) trim button. Release both buttons and the servo direction will be reversed. Repeat to change back.

ADJUSTMENT OF LINKAGES

To alter the center position, or increase/decrease the control throws, follow these steps. Be sure to unpower the model before attempting to mechanically adjust the linkages.

Alter the Center Position

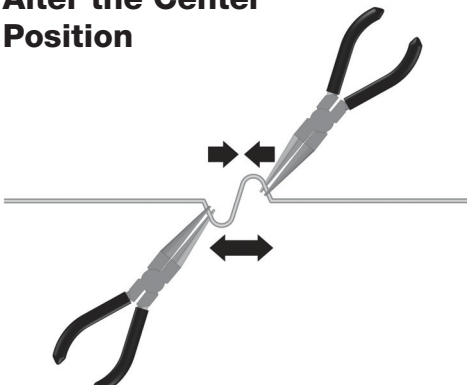

Increase/Decrease Throws

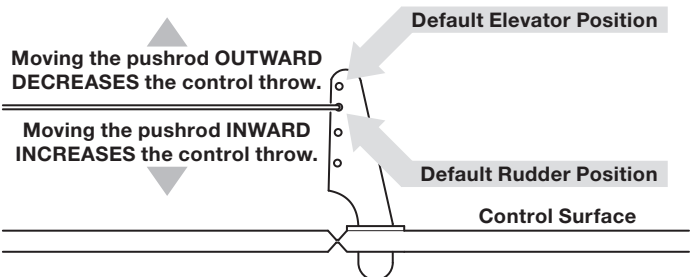

Use caution when removing and reinstalling the pushrod in the control horn to avoid accidentally disconnecting the linkage from the 3-in-1 control unit.

PROPELLER REPLACEMENT

To remove a damaged propeller, unpower the model, then hold the motor shaft with needle nose pliers and unscrew the damaged propeller off the shaft in the counter-clockwise direction. Install your replacement propeller in the clockwise direction.

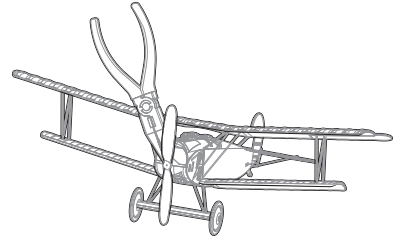

TRANSMITTER FACTORY RESET

To reset the transmitter to the factory default trim button settings and servo reverse settings, follow the procedure below:

1. Power on the transmitter.
2. Press and hold the right trim button below the throttle stick while simultaneously pressing the up trim button to the right of the throttle stick.
3. The transmitter will emit a long tone indicating that the factory reset was successful.

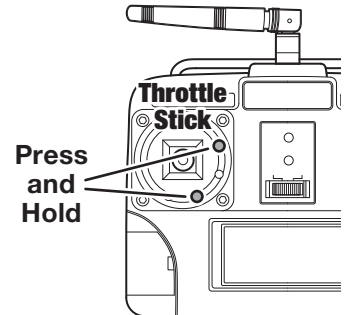

REPAIRS

Repairs can be made to the model by using the following items:

- Thick Foam Safe CA (for parts adhesion), PAAR2131
- Foam safe CA accelerator, GPMP6035
- Two sets of needle nose pliers or hemostats, EXLR5580
- Hobby Knife (#11 blade), EXLR9018
- Clear tape

REPLACEMENT PARTS

To order replacement parts for the D.VII model, use the order numbers in the list below. Replacement parts are available only as listed. Replacement parts are not available from Product Support, but can be purchased from hobby shops or mail order/Internet order firms. If you need assistance locating a dealer to purchase parts from, contact:

Product Support

E-mail: productsupport@horizonhobby.com

Stock No. Description

FLZU1001 Fuselage Set w/Dummy Engine
FLZU1002 Wing Set Top and Bottom
FLZU1003 Tail Set Stab and Rudder
FLZU1004 Landing Gear Set w/Wheels
FLZU1005 Pushrod Set Rudder & Elevator
FLZU1006 Wing Strut Set
FLZU1007 Decal Set

Stock No. Description

FLZU1008 Propeller 4.7 x 2.75
FLZU1009 Gear Box w/Shaft and Gear
FLZU1010 Prop Shaft w/Spur and Pin Gear
FLZU1011 Brushed Motor
FLZU1012 3-in-1 2.4G Micro Receiver
FLZU1013 4-Channel 2.4G Transmitter
FLZU1014 Battery 80 mAh 1S LiPo

LIMITED WARRANTY

What this Warranty Covers – Horizon Hobby, LLC, (Horizon) warrants to the original purchaser that the product purchased (the “Product”) will be free from defects in materials and workmanship at the date of purchase.

What is Not Covered – This warranty is not transferable and does not cover (i) cosmetic damage, (ii) damage due to acts of God, accident, misuse, abuse, negligence, commercial use, or due to improper use, installation, operation or maintenance, (iii) modification of or to any part of the Product, (iv) attempted service by anyone other than a Horizon Hobby authorized service center, (v) Product not purchased from an authorized Horizon dealer, or (vi) Product not compliant with applicable technical regulations, or (vii) use that violates any applicable laws, rules, or regulations OTHER THAN THE EXPRESS WARRANTY ABOVE, HORIZON MAKES NO OTHER WARRANTY OR REPRESENTATION, AND HEREBY DISCLAIMS ANY AND ALL IMPLIED WARRANTIES, INCLUDING, WITHOUT LIMITATION, THE IMPLIED WARRANTIES OF NON-INFRINGEMENT, MERCHANTABILITY AND FITNESS FOR A PARTICULAR PURPOSE. THE PURCHASER ACKNOWLEDGES THAT THEY ALONE HAVE DETERMINED THAT THE PRODUCT WILL SUITABLY MEET THE REQUIREMENTS OF THE PURCHASER’S INTENDED USE.

Purchaser’s Remedy – Horizon’s sole obligation and purchaser’s sole and exclusive remedy shall be that Horizon will, at its option, either (i) service, or (ii) replace, any Product determined by Horizon to be defective. Horizon reserves the right to inspect any and all Product(s) involved in a warranty claim. Service or replacement decisions are at the sole discretion of Horizon. Proof of purchase is required for all warranty claims. SERVICE OR REPLACEMENT AS PROVIDED UNDER THIS WARRANTY IS THE PURCHASER’S SOLE AND EXCLUSIVE REMEDY.

Limitation of Liability – HORIZON SHALL NOT BE LIABLE FOR SPECIAL, INDIRECT, INCIDENTAL OR CONSEQUENTIAL DAMAGES, LOSS OF PROFITS OR PRODUCTION OR COMMERCIAL LOSS IN ANY WAY, REGARDLESS OF WHETHER SUCH CLAIM IS BASED IN CONTRACT, WARRANTY, TORT,

NEGLIGENCE, STRICT LIABILITY OR ANY OTHER THEORY OF LIABILITY, EVEN IF HORIZON HAS BEEN ADVISED OF THE POSSIBILITY OF SUCH DAMAGES. Further, in no event shall the liability of Horizon exceed the individual price of the Product on which liability is asserted. As Horizon has no control over use, setup, final assembly, modification or misuse, no liability shall be assumed nor accepted for any resulting damage or injury. By the act of use, setup or assembly, the user accepts all resulting liability. If you as the purchaser or user are not prepared to accept the liability associated with the use of the Product, purchaser is advised to return the Product immediately in new and unused condition to the place of purchase.

Law – These terms are governed by Illinois law (without regard to conflict of law principals). This warranty gives you specific legal rights, and you may also have other rights which vary from state to state. Horizon reserves the right to change or modify this warranty at any time without notice.

WARRANTY SERVICES

Questions, Assistance, and Services – Your local hobby store and/or place of purchase cannot provide warranty support or service. Once assembly, setup or use of the Product has been started, you must contact your local distributor or Horizon directly. This will enable Horizon to better answer your questions and service you in the event that you may need any assistance. For questions or assistance, please visit our website at www.horizonhobby.com, submit a Product Support Inquiry, or call the toll free telephone number referenced in the Warranty and Service Contact Information section to speak with a Product Support representative.

Inspection or Services – If this Product needs to be inspected or serviced and is compliant in the country you live and use the Product in, please use the Horizon Online Service Request submission process found on our website or call Horizon to obtain a Return Merchandise Authorization (RMA) number. Pack the Product securely using a shipping carton. Please note that original boxes may be included, but are not designed to withstand the rigors of shipping without additional protection. Ship via a carrier that provides tracking and insurance for lost or damaged parcels, as Horizon is not responsible for merchandise until it arrives and is accepted at our facility. An Online Service Request is available at http://www.horizonhobby.com/content/_service-center_render-service-center. If you do not have internet access, please contact Horizon Product Support to obtain a RMA number along with instructions for submitting your product for service. When calling Horizon, you will be asked to provide your complete name, street address, email address and phone number where you can be reached during business hours. When sending product into Horizon, please include your RMA number, a list of the included items, and a brief summary of the problem. A copy of your original sales receipt must be included for warranty consideration. Be sure your name, address, and RMA number are clearly written on the outside of the shipping carton.

NOTICE: Do not ship LiPo batteries to Horizon. If you have any issue with a LiPo battery, please contact the appropriate Horizon Product Support office.

Warranty Requirements – For Warranty consideration, you must include your original sales receipt verifying the proof-of-purchase date. Provided warranty conditions have been met, your Product will be serviced or replaced free of charge. Service or replacement decisions are at the sole discretion of Horizon.

Non-Warranty Service – Should your service not be covered by warranty, service will be completed and payment will be required without notification or estimate of the expense unless the expense exceeds 50% of the retail purchase cost. By submitting the item for service you are agreeing to payment of the service without notification. Service estimates are available upon request. You must include this request with your item submitted for service. Non-warranty service estimates will be billed a minimum of ½ hour of labor. In addition you will be billed for return freight. Horizon accepts money orders and cashier's checks, as well as Visa, MasterCard, American Express, and Discover cards. By submitting any item to Horizon for service, you are agreeing to Horizon's Terms and Conditions found on our website http://www.horizonhobby.com/content/service-center_render-service-center.

ATTENTION: Horizon service is limited to Product compliant in the country of use and ownership. If received, a non-compliant Product will not be serviced. Further, the sender will be responsible for arranging return shipment of the un-serviced Product, through a carrier of the sender's choice and at the sender's expense. Horizon will hold non-compliant Product for a period of 60 days from notification, after which it will be discarded.

10/2015

CONTACT INFORMATION

Country of Purchase: United States of America

REPAIRS & REPAIR REQUESTS

Horizon Service Center
1608 Interstate Dr
Champaign, IL 61822
USA

[servicecenter.horizonhobby.com/
RequestForm/](http://servicecenter.horizonhobby.com/RequestForm/)

PRODUCT TECHNICAL ASSISTANCE

Horizon Product Support
1608 Interstate Dr
Champaign, IL 61822
USA

productsupport@horizonhobby.com
877-504-0233

SALES

Horizon Hobby, LLC
1608 Interstate Dr
Champaign, IL 61822
USA

websales@horizonhobby.com
800-338-4639



© 2018 Horizon Hobby, LLC.

Flyzone, and the Flyzone logo, and How high will you soar, are trademarks or registered trademarks of Horizon Hobby, LLC. All other trademarks, service marks and logos are property of their respective owners.

58901 FLZU1000