

**APPENDIX 1: Photographs of test setup**

**Appendix 1-1: Photograph of EUT and antenna position**

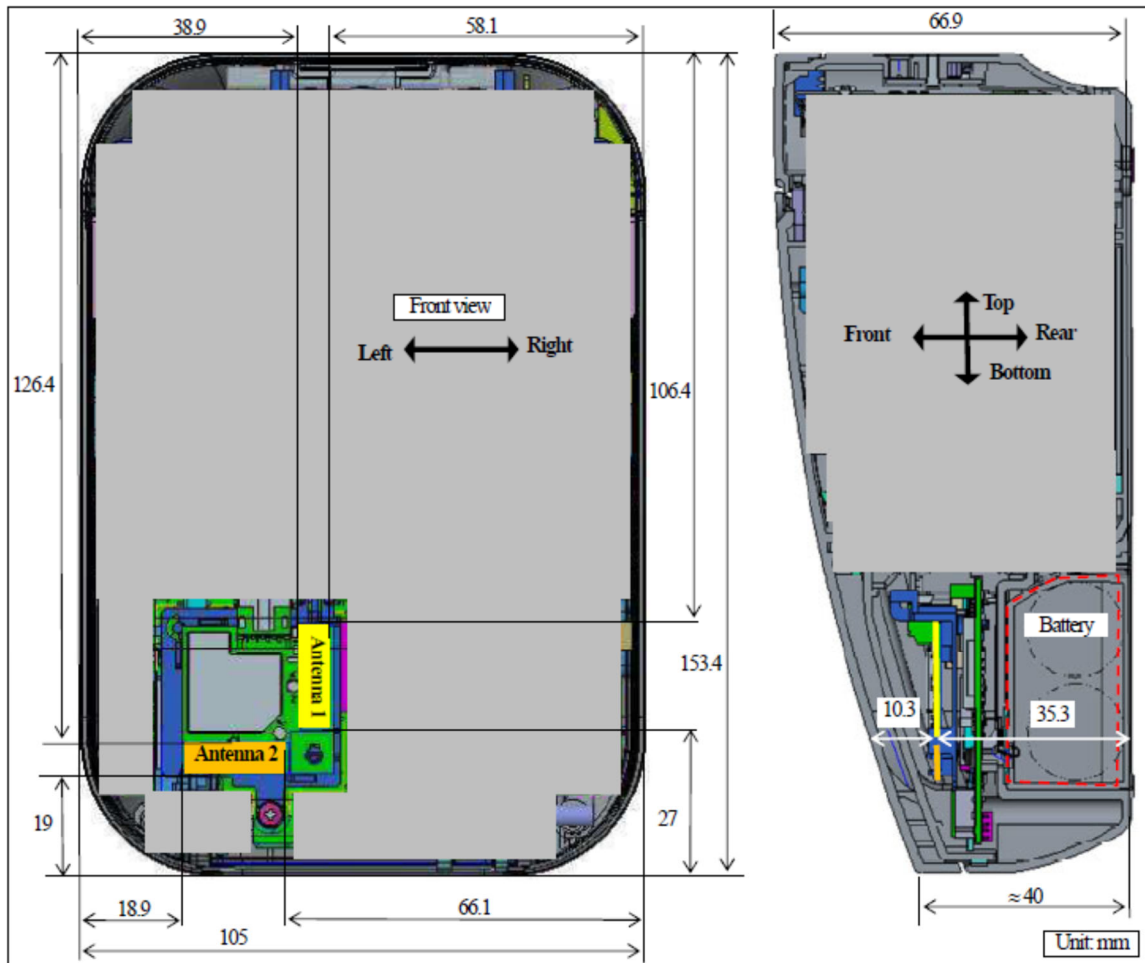

\*. Size of EUT: 105 mm (W) × 153.4 mm (D) × 66.9 mm (H)

**Appendix 1-2: EUT and support equipment**

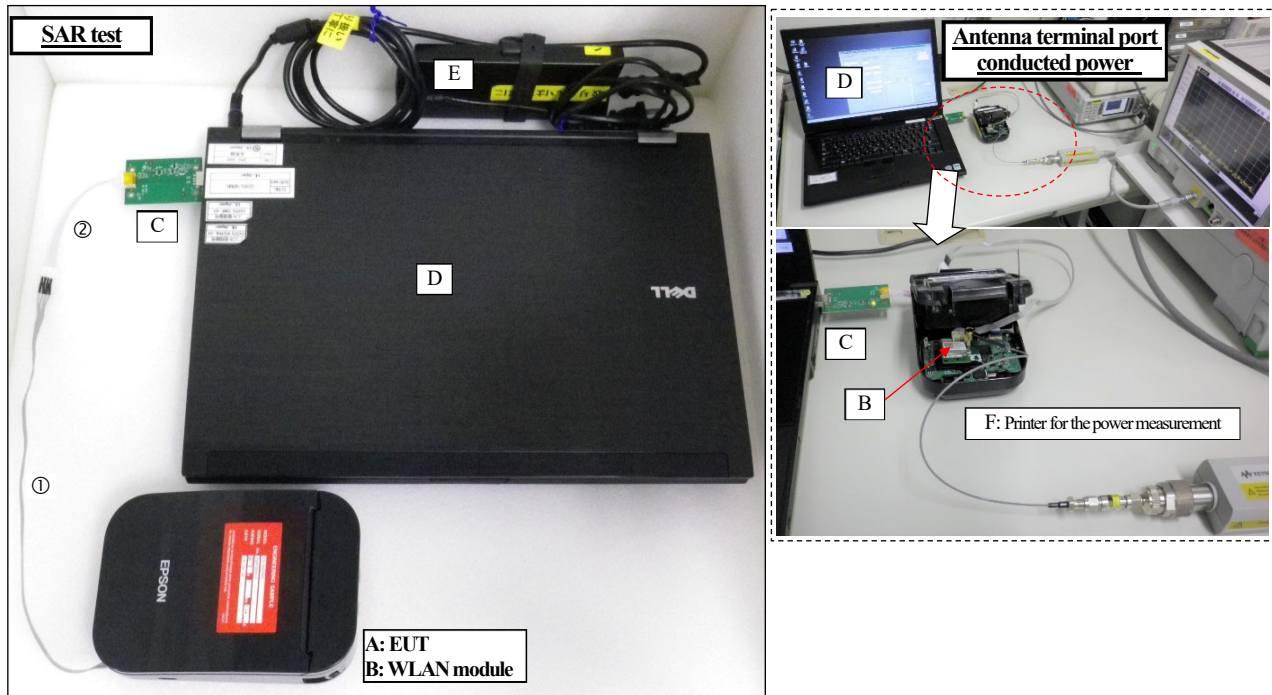

**Description of EUT and Support Equipment**

No.	Item	Model number	Serial number	Manufacturer	Remark
A	Printer	M382C	EQAF000016	Seiko Epson Corporation	EUT.
B	WLAN Module	J26H005	106FD9675097	Foxconn	*. Installed into EUT.
C	USB IF PCB	-	-	Foxconn	Support equipment.
D	Laptop PC (ctrl#:SPC-S03)	Latitude E6500	30326706285	DELL	Support equipment. (Host PC)
E	AC Adaptor (for item D, Laptop PC)	FA90PE0-00	-	DELL	Support equipment. DC cable: 1.7m, AC cable: 0.9m
F	Printer	M381A	EWAF000024	Seiko Epson Corporation	Support equipment.

**List of cables used**

No.	Name	Length (m)	Shield	No.	Name	Length (m)	Shield
①	Ribbon flat cable (1)	0.4	Unshielded	②	Ribbon flat cable (2)	0.1	Unshielded

**Appendix 1-3: Photograph of test setup**

Position	Setup photographs		
<b>Front</b> (Body-touch, D: 0mm) (Photo.P1)	(Front view/Flat-phantom) 	(Front-left view/Flat-phantom) 	(Front-right view/Flat-phantom) 
	(Left view/Flat-phantom) 	(Right view/Flat-phantom) 	(Overall view) 
	(Front view/Flat-phantom) 	(Bottom view/Flat-phantom) 	(Overall view) 
	(Left view/Flat-phantom) 	(Right view/Flat-phantom) 	(no photograph in here)
	(Front view/Flat-phantom) 	(Bottom view/Flat-phantom) 	(Overall view) 
	(Left view/Flat-phantom) 	(Right view/Flat-phantom) 	(no photograph in here)
<b>Left</b> (Body-touch, D: 0mm) (Photo.P3)	(Left view/Flat-phantom) 	(Right view/Flat-phantom) 	(Overall view) 
	(Front view/Flat-phantom) 	(Bottom view/Flat-phantom) 	(no photograph in here)

**Appendix 1-3: Photograph of test setup (cont'd)**

Position	Setup photographs		
<b>Right</b> (Body-touch, D: 0mm (Photo.P4)	(Front view/Flat-phantom) 	(Left view/Flat-phantom) 	(Right view/Flat-phantom) 
<b>Rear</b> (Body-touch, D: 0mm (Photo.P5)	(Front view/Flat-phantom) 	(Left view/Flat-phantom) 	(Right view/Flat-phantom) 
<b>Top</b> (Body-touch, D: 0mm (Photo.P6)	(Front view/Flat-phantom) 	(Left view/Flat-phantom) 	(Right view/Flat-phantom) 
<b>Front</b> *. Repeat (Body-touch, D: 0mm (Photo.P7)	(Front view/Flat-phantom) 	(Front-left view/Flat-phantom) 	(Front-right view/Flat-phantom) 
	(Left view/Flat-phantom) 	(Right view/Flat-phantom) 	(Overall view) 