

WHP-i230



Quick Start

1. Charge Headphone 3.5 hours.
2. Connect Transmitter to i-Pod.
3. Turn on Headphone and i-Pod.
4. Wearing the Headphones, hold down the LINK buttons on both the Headphone and the Transmitter until a beep is heard indicating the device are link.
5. Enjoy your wireless experience

WHP-i230: Wireless Music Anywhere

SoundOn's WHP-i230 is the world's first 2.1 wireless headphone with a portable i-Pod transmitter allowing you to go virtually anywhere with your music, but without the wires. Point-one technology takes the traditional headphone with two speaker-drives and enhances the performance with the addition of a built-in sub woofer. Point-one technology allows the listener to invite all the low-emission bass sounds life co-exists with.

All of SoundOn's wireless headphones use Adaptive Frequency Hopping technology ensuring the headphone is always searching for, finding, and moving to the clearest channel available. The result is the clearest wireless sound available, which Bluetooth's "blind hopping" and other wireless technologies cannot achieve.

Unique Features

- Based on advanced WiStereo™ digital wireless technology for reliable transmission of music in the 2.4 GHz band.
- Effective within 30 feet range from source.
- Patented dual-speakers in each of the ear-cups delivering a full range of sounds as well as a soft, deep bass.
- The transmitter can be powered by the i-Pod adapter.
- Extended battery life lasts up to 12 hours when fully charged.
- Ultra comfortable headband design for long wear hours.

Parts Introduction

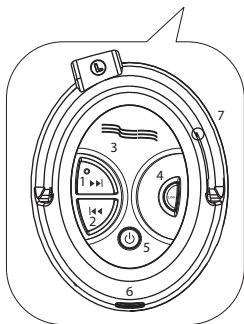
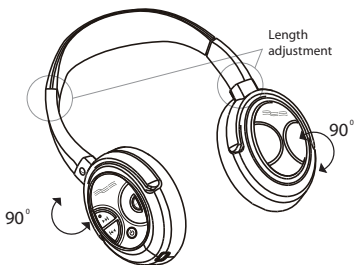

- ① Next track ▶▶
- ② Previous track ◀◀
- ③ LED Indicator
- ④ LINK
- ⑤ Power On/Off
- ⑥ Charging Port
- ⑦ Reset

- ① **Next track ►►**
Skip to next song.
- ② **Previous track ◀◀**
Skip to previous song.
- ③ **LED Indicator**
A red indicator represents charging functions.
A blue indicator represents signal connections.
- ④ **LINK**
Press “LINK” button to connect the wireless headphone and the iPod transmitter.
- ⑤ **Power On/Off**
Press this button to control power on/off.
- ⑥ **Charging Port**
Connect to the AC power adapter for charging.
- ⑦ **Reset**
If headphone is functioning improperly, poke the reset hole by a paper clip.

Getting Started

Charging the Headphone

Charging

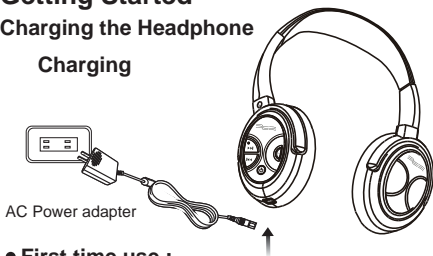

- **First time use :**

Charge 3.5 hours before using headphone for the first time.

Plug in to charge

Unplug when finished

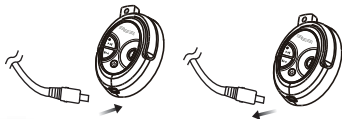

The headphone is charging.

- Steady red light is turned off when the headphone is fully charged.
- To ensure this headphone to work properly, please avoid recharging while using.
- AC Power Adapter is used to both charge the headphone and the transmitter(if batteries are not powering the transmitter).

Connecting the Transmitter

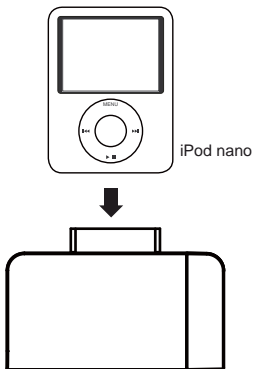

Turning the Headphone On/Off



- **Power on:** Press the power button to turn on the headphone.
- **Power off:** Press and hold the power button for 2 sec. to turn off the headphone.

Link the headphone to the Transmitter

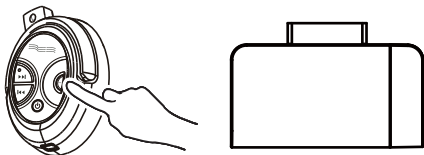

Simultaneously press the LINK buttons of both the headphone and the transmitter to connect the signal transmission.

User Guide Symbols

Steady red light



- The headphone is charging
-

Steady blue light



- Device are link
-

Flashing blue light



- Device are waiting for link
- Device are not link

Product Accessories



Wireless Headphone * 1pc

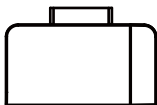

iPod Transmitter * 1pc



AC Power Adapter * 1pc

Trouble Shooting:

No sound emitting from the Headphone

1. Make sure the headphone is charged, and the transmitter is powered . Make sure the transmitter has connected the i-Pod steadily.
2. Check if the music is being played from your i-Pod.
3. Simultaneously press the LINK keys, both on the transmitter as well as on the headphone, for 2-3 seconds until sound returns.
4. In case the music player/source has a low volume output, try Press the volume up key on the iPod.

Sound break-up

First move around and get closer to the transmitter. The constant sound break-up may have occurred because of the range and radio-wave transmission obstacles. If the i-Pod's batteries are running low , it probably can cause sound break-up.

No connection signal visible

Make sure the headphone is charged and the transmitter is properly connected to the i-Pod. Within the range of signal coverage, power on the headset again.

The headphone automatically shuts off

Check to see if the battery life is too low or the indicator light is off.

Headphone Malfunction

If Headphones are experiencing problems try resetting the Headphones (see P. 2 “Reset Button”)

Specification

Model	WHP-i230
Wireless Technology	WiStereo™ for advanced 2-way digital transmission in the 2.4 GHz frequency band
Headphone Listen Time	Up to 12 hours (per charge)
Standby Time	Up to 3 months
Charge Time (full charge)	Up to 3.5 hours
Distance of Use	30 feet
Headphone Weight	0.47 ounces
Transmitter Weight	1.6 ounces
Charging Method	AC Power Adapter
Headphone Battery Type	Lithium Polymer
Frequency Response	20Hz ~30,000Hz (perfect for all music, game, and voice)
Audio Quality	Uncompressed audio for music (CD-quality) and voice (extra clarity)
Distortion (T.H.D.)	≤0.08% (professional grade audio performance)
Speaker Drivers	2 on each side for full-range audio and sub-woofer enhancement with SafeBass technology 30mm Neodymium for left/right channels® 40mm Neodymium for subwoofer

Important User Information:

1.Handling the headphone

Do not bend, drop, crush, puncture, incinerate, or open the headphone.

2.Repairing the headphone

Never attempt to repair the headphone yourself. The headset does not contain any user serviceable parts. For service information, read the “Help” section from the warranty card. The headphone should be replaced only by authorized service providers.

3.Avoiding Hearing Damage, Hearing Experts Suggest

Permanent hearing loss may occur if the headphone is used at too high a volume. Set the volume to a safe level. Warning: Over time it is possible to become accustomed to high volumes that may be damaging to your hearing. If you experience a ringing in your ears or your own voice and other sounds appear muffled, stop using the headphone and consult a hearing professional.

Safety Approvals and Certifications

FCC Statement

Both the headphone and the transmitter are compliant with part 15 of the FCC rules. Operation is subject to the following two conditions: (1) These devices may not cause harmful interference, and (2) These devices must accept any interference received, including interference that may cause undesired operation.

CE

This product is CE marked according to the provisions of the R&TTE Directive. (99/5/EC)

FEDERAL COMMUNICATIONS COMMISSION INTERFERENCE STATEMENT

This equipment has been tested and found to comply with the limits for a Class B digital device, pursuant to Part 15 of the FCC Rules. These limits are designed to provide reasonable protection against harmful interference in a residential installation. This equipment generates, uses and can radiate radio frequency energy and, if not installed and used in accordance with the instructions, may cause harmful interference to radio communications. However, there is no guarantee that interference will not occur in a particular installation. If this equipment does cause harmful interference to radio or television reception, which can be determined by turning the equipment off and on, the user is encouraged to try to correct the interference by one or more of the following measures:

- Reorient or relocate the receiving antenna.
- Increase the separation between the equipment and receiver.
- Connect the equipment into an outlet on a circuit different from that to which the receiver is connected.
- Consult the dealer or an experienced radio/TV technician for help.

CAUTION:

Any changes or modifications not expressly approved by the party responsible for compliance could void the user's authority to operate the equipment.

Headphones Made In China