

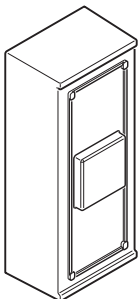

USE AND CARE GUIDE

WIRELESS PUSH BUTTON



Illustrations may vary from actual unit.

THANK YOU

We appreciate the trust and confidence you have placed in Hampton Bay through the purchase of this wireless push button. We strive to continually create quality products designed to enhance your home. Visit us online to see our full line of products available for your home improvement needs. Thank you for choosing Hampton Bay!

Warranty

3-YEAR LIMITED WARRANTY

WHAT IS COVERED

This product is guaranteed to be free of factory defective parts and workmanship for a period of 3 years from date of purchase. Purchase receipt is required for all warranty claims.

WHAT IS NOT COVERED

This warranty does not include expendable items (such as light bulbs, batteries, etc.), repair service, adjustment and calibration due to misuse, abuse or negligence. Unauthorized service or modification of the product or of any furnished component will void this warranty in its entirety. This warranty does not include reimbursement for inconvenience, installation, setup time, loss of use, unauthorized service, or return shipping charges. This warranty is not extended to other equipment and components that a customer uses in conjunction with this product.

Contact the Customer Service Team at 1-844-760-3644 or visit www.hamptonbay.com.



Questions, problems, missing parts?
Before returning to the store, call Hampton Bay Customer Service
8 a.m. - 5 p.m., CST, Monday - Friday

1-844-760-3644

HAMPTONBAY.COM

Safety Information

1. Please read and understand this entire manual before attempting to assemble, install, or operate this push button.

WARNING: To prevent possible SERIOUS INJURY or DEATH never allow small children near batteries. If battery is swallowed, immediately notify a doctor.

NOTE: The range of the wireless doorbell can vary with location, temperature, and battery condition.

This device complies with Part 15 of the FCC Rules and RSS-210 of Industry Canada. Operation is subject to the following two conditions: (1) this device may not cause harmful interference, and (2) this device must accept any interference received, including interference that may cause undesired operation.

The user is cautioned that changes or modifications not expressly approved by the party responsible for regulatory compliance could void the user's authority to operate the equipment.

Care and Cleaning

- Use a dry cloth to clean the push button.
- Do not use cleaners or polishes.
- Do not use any fluids on the push button.

Pre-Installation

TOOLS REQUIRED

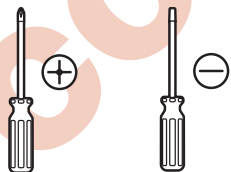

Phillips screwdriver

Small flathead screwdriver

PACKAGE CONTENTS

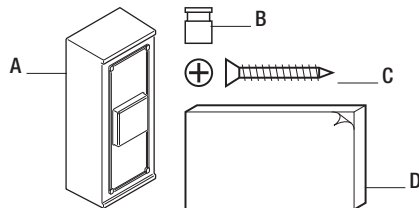

Part	Description	Quantity
A	Push button	1
B	Jumper	1
C	Screw	2
D	Double-sided tape	1
	Battery - pre-installed (not shown)	1

Installation

1 Removing the battery tab

- Remove the back of the push button by pushing in the tab on the bottom with a small screwdriver (not included).
- Remove the orange battery tab from the push button.

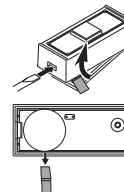

2 Syncing the push button and doorbell

- Press and hold the "SYNC" button on the doorbell until the doorbell sounds a "Beep-Beep".
- Press the push button within 30 seconds. The doorbell will sound a "Beep-Beep" tone to indicate the push button is synced.
- Press the push button to confirm sync. If the doorbell sounds, sync is complete.

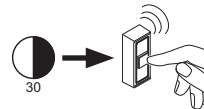
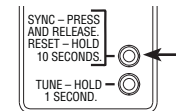

3 Testing the push button and doorbell

- Temporarily position the push button where you want it mounted.
- Press the push button to verify the doorbell and push button work properly. If the doorbell does not sound, see Troubleshooting.

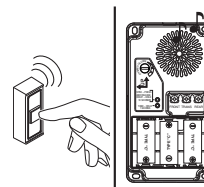

NOTE: Do not permanently mount the push button until the push button and doorbell are working properly.

Specifications

Power requirements Type 2032 3V battery

Installation

4 Mounting the push button

Use either screws or double-sided tape to mount the push button.

- To mount with screws, remove the back of the push button by pushing in the tab on the bottom with a small screwdriver. Place the push button back on the door jamb and mark the two screw holes. Attach with screws and snap on the front of the push button.
- When attaching the push button with double-sided tape, remove paper from both sides of the double-sided tape and apply to a clean surface.

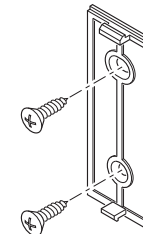

5 Selecting a tune

Wireless doorbells have different selectable tunes. The wireless push button can be set to play one of those tunes by adding or removing the jumper inside the push button. See the table below for tune selection.

Push Button Jumper	Doorbell Sound
Push Button Jumper ON	Rear door
Push Button Jumper OFF (factory default)	Front door

NOTE: Refer to the doorbell manual for available tunes.

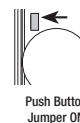

Troubleshooting

Problem	Solution
The doorbell does not sound.	Make sure batteries are installed according to the diagram inside the push button and doorbell (if applicable).
	Check the charge of the push button and doorbell batteries (if applicable) and replace if necessary.
	Make sure the plug-in doorbell has power (if applicable).
	Push button and doorbell are not synced. Follow step 2 under installation to sync.
The batteries seem okay, but the doorbell does not work after installation.	Metal reduces transmission range. Use 1/4 in. to 1/2 in. (6 to 13 mm) wood shims to move the doorbell or push button away from the metal surface.
	Concrete may reduce range. Move the doorbell away from the concrete surface.
	Locate the doorbell closer to the push button.