

- 4 **Touching Longer:** Touch the panel for a longer time to use as right mouse button.



#### Using the Touch Keyboard

- 1 Right-click on the taskbar, select [Taskbar Settings], and then set [Touch Keyboard] to [On].

- 2 Press the icon [  ] on the bottom right of the taskbar to display the [Keyboard] screen.



## Using Stylus Pen

If you use the **Stylus Pen** for the 16T90R models, you can do fine touch operations that are difficult with fingers.

### Parts Names



- 1 **Pen Tip**
  - Operates as the mouse cursor.
- 2 **Left Button**
  - Use to select or execute programs.
- 3 **Right Button**
  - Functions basically similar to the right mouse button.
- 4 **Pen Cap**

**TIP**

The **Stylus Pen** buttons may serve different functions in different programs.

### Basic Usage

When purchasing the product, the 1.5 V **AAAA** battery is provided inserted in the product. Detach the **Pen Cap** and remove the battery anti-discharge insulator before use.

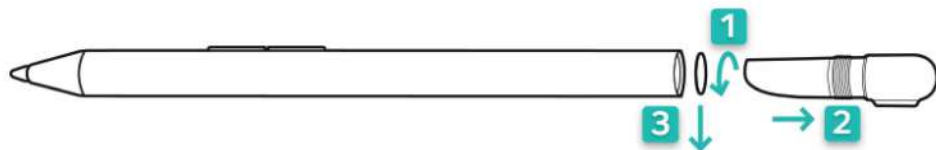

- **Touching Once:** Tap the screen once with the **Stylus Pen's** tip to bring the same effect as clicking the left mouse button.

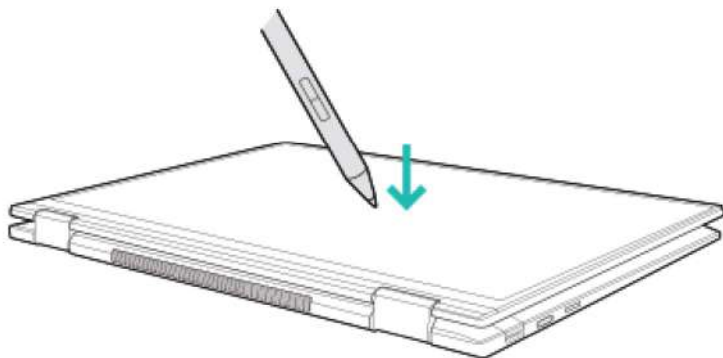

- **Touching Twice:** Tap the screen twice with the **Stylus Pen's** tip to bring the same effect as double-clicking the left mouse button.

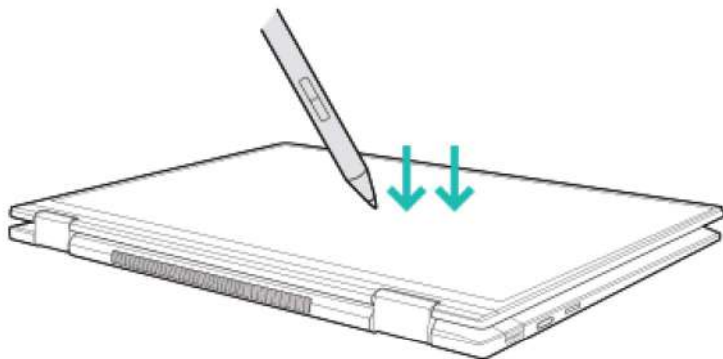

- **Drag:** Move the **Stylus Pen** with its tip pressed on the screen to bring the same effect as dragging the mouse.

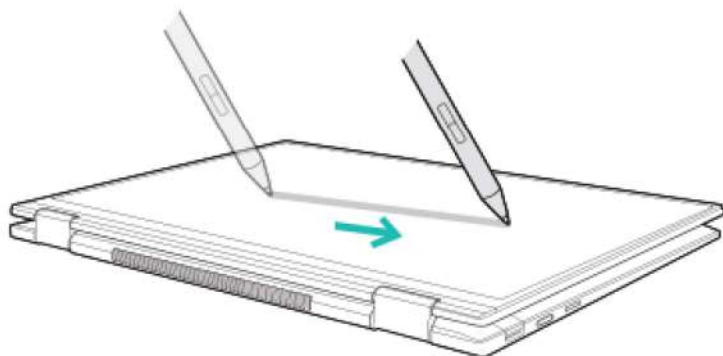
**TIP**

Do not apply excessive force on the **Stylus Pen**. Doing so may cause the **pen tip** or the pen to fail.

The **Stylus Pen** automatically enters the sleep mode to reduce battery consumption if the pen is not used for more than 10 minutes or if the **pen tip** remains pressed for more than 4 minutes.

To exit the sleep mode, simply touch the screen with the **Stylus Pen's** tip or click the left or right button on the pen.

**Setting Stylus Pen**

You can set the button function and sensitivity of the **Stylus Pen** in the **[LG Pen Settings]** app.

- 1 Select the Start button [  ] > [All apps] > **[LG Pen Settings]**.

## 2 Change the button function and sensitivity to use the **Stylus Pen**.

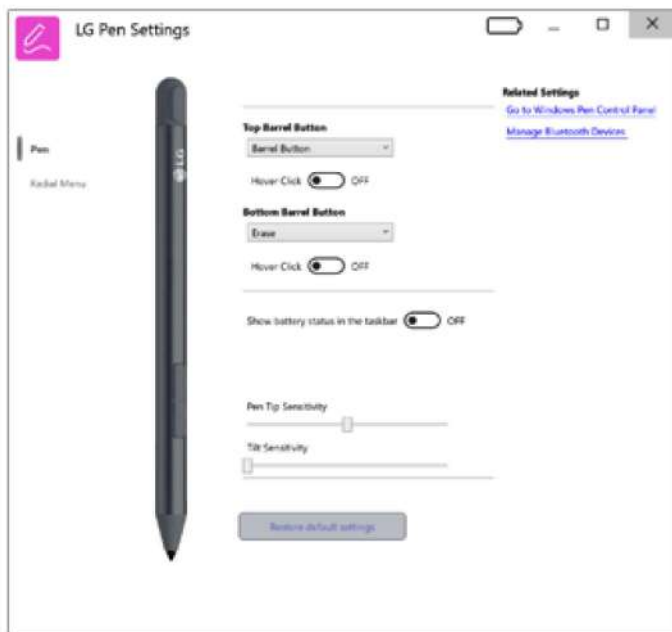

### Replacing the Battery



#### WARNING

If the battery is replaced to the incorrect type, there is a danger of fire or explosion.



#### CAUTION

If you use a non-standard battery or a rechargeable battery, the pen may not work.

Keep the battery removed if you are not using the pen for a long time. Otherwise, the battery may leak, causing the product to fail.

Do not use excessive force to insert the battery or to remove or fit the pen cap. Doing so may damage the product.

Storing or carrying the pen with the **tip** pressed consumes the battery.

Be careful not to cause an excessive impact on the product or drop it. The product may fail.

**TIP**

If the battery power is low, the pen operation may be interrupted, or the pen may not be recognized.

If you have not replaced the battery for a long time, replace the battery.

**AAAA** batteries are available from online shopping malls.

- 1 To separate the pen cap, position the pen horizontally, hold the **pen cap** with your right hand, and turn it downward.

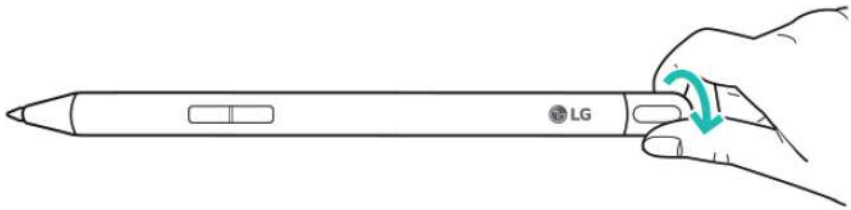

- 2 Remove the used battery.



- 3 Insert the battery in the correct +/- direction, and turn the **pen cap** upward to mount it.

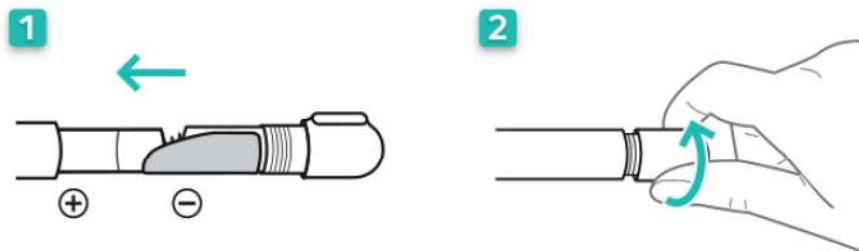

#### CAUTION

When removing or fitting the pen cap, take care not to introduce foreign substances into the spiral groove of the cap.

Be careful not to fit the pen cap with the pen and the pen cap misaligned. The product may fail.

When inserting the battery, make sure that the label attached to the pen cap does not hide the battery or spring.



#### Replacing the **Pen Tip**

When the nib of the **pen tip** wears out, replace the pen tip in the following method.

#### **TIP**

The **pen tip** is a consumable, and if necessary, it should be purchased separately for replacement.

A tweezer is provided when purchasing the **pen tip**.

To purchase a **pen tip**, contact the LG Electronics Service Center.



- 1 Hold the **pen tip** with **tweezers** and pull it outward to remove it from the **Stylus Pen**.

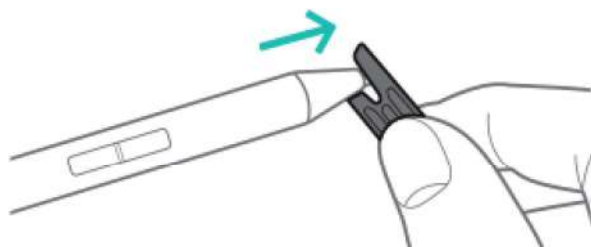

- 2 Insert the replacement **pen tip** into the **Stylus Pen**.

**CAUTION**

Do not insert the replacement **pen tip** with excessive force or in the opposite direction. The product may fail.

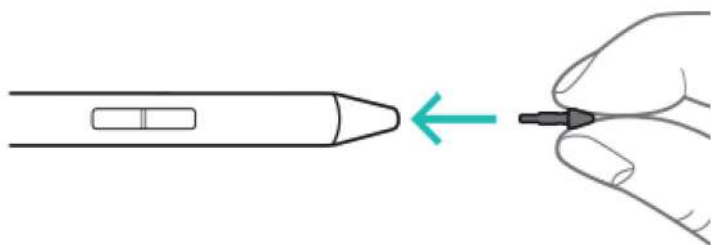

## Connecting to External Display

Connect the external display device through the USB-C™ port of the PC to output a PC screen to an external display.

**In some models, the Dolby Audio function may not work when connecting to an external display.**

 **TIP**

- Connect to the PC while the power of the external display device is turned off.
- If the external display screen does not appear after connecting to the PC, check Input Mode of the external display device.
- By connecting a display that supports USB-C™ Alternate Mode, you can use the USB-C™ port to output a screen to an external display. Alternate Mode is a mode that uses display outputs such as DP (Display Port) and HDMI through the USB-C™ port.
- The USB-C™ port supports the interface with the DP (Display Port) specifications.



**CAUTION**

- Use the cable/adaptor that fits the USB-C™ specifications and supports **Alternate Mode**.
- The USB-C™ cable/adaptor for non-LG products may not be connected or cause a problem.

- 1 Connect the PC and external display with a cable that fits the external display device.

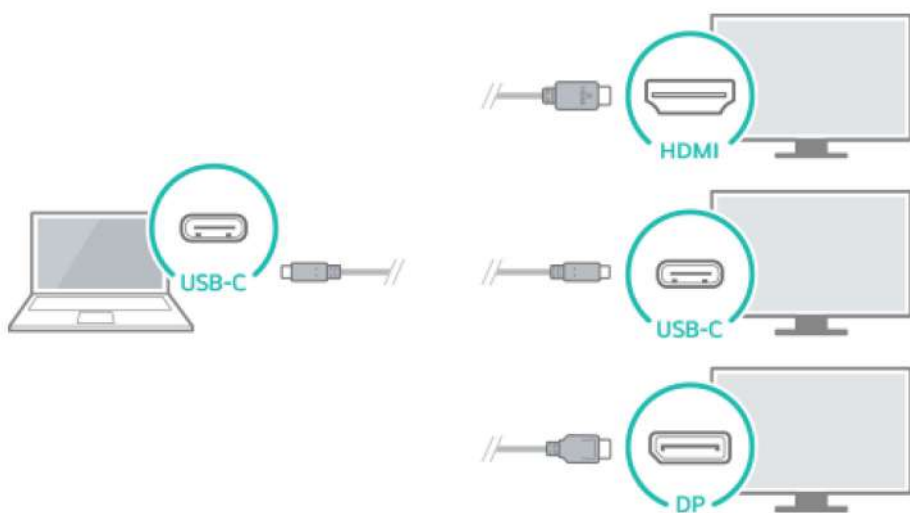

- 2 Turn on the power of the external display device.

- 3 Press the [Fn] + [F7] (or [  ] + [P]) keys on the keyboard to change Display Mode.

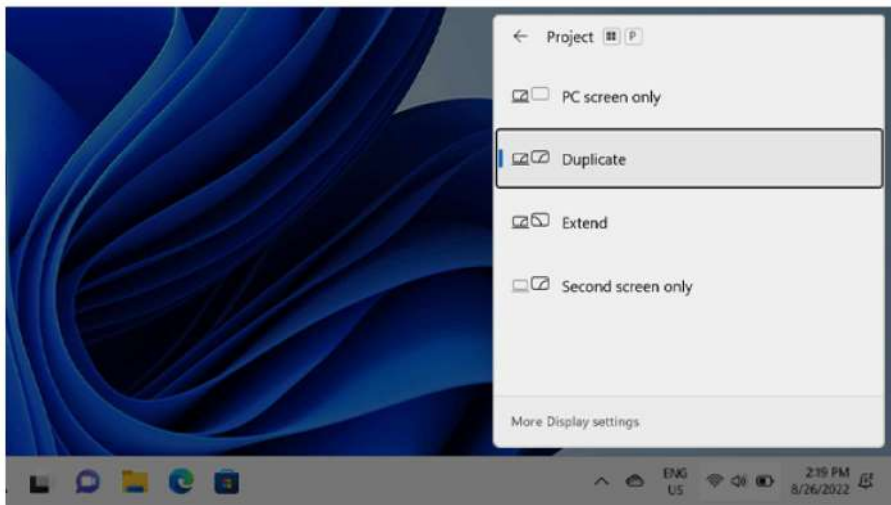

#### CAUTION

If you do not set Speaker as the default value after separating the external display connection cable, the system may not produce any sound. (If a program was running already, you must exit and restart the program to produce sound.)

## Connecting to Wireless Display

The wireless display feature connects the PC screen and sound to a display (TV, projector, etc.).

### OPTION

- To use the wireless display feature, the display device must support this feature.
- To connect to the display device that does not support wireless display, you must separately purchase a wireless display connection device.
- Once the wireless display connection is established, no additional procedures and searching are necessary the next time you try to connect.

### Connecting to Wireless Display

- 1 Select the Start button [  ] > [Settings].

### TIP

Press the [  ] key or [Ctrl] + [Esc] on the keyboard to display the Start screen.

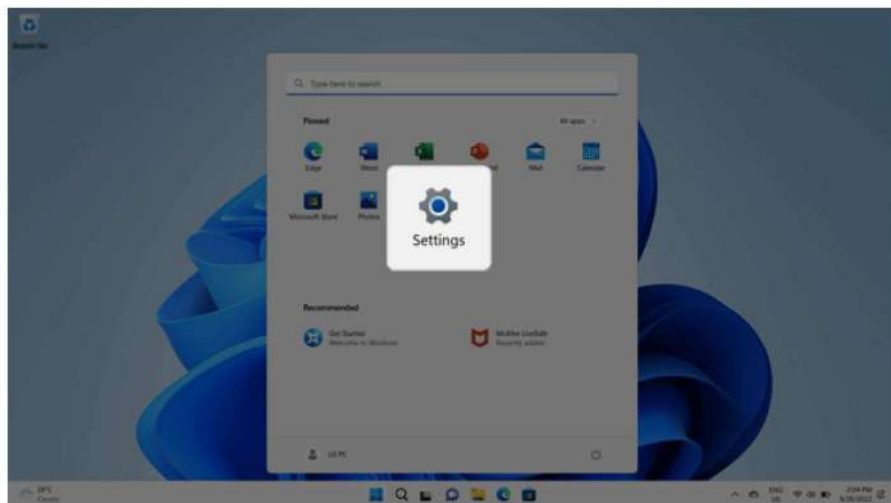

- 2 Select [Connect] under the [System] > [Display] > [Multiple displays] > [Connect to a wireless display] menu.

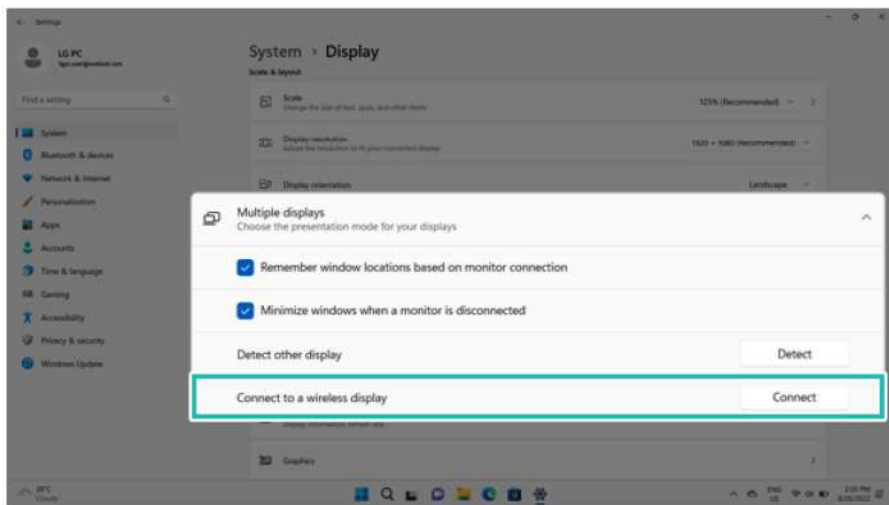

- 3 If the device search screen appears, it will search for nearby wireless display devices.

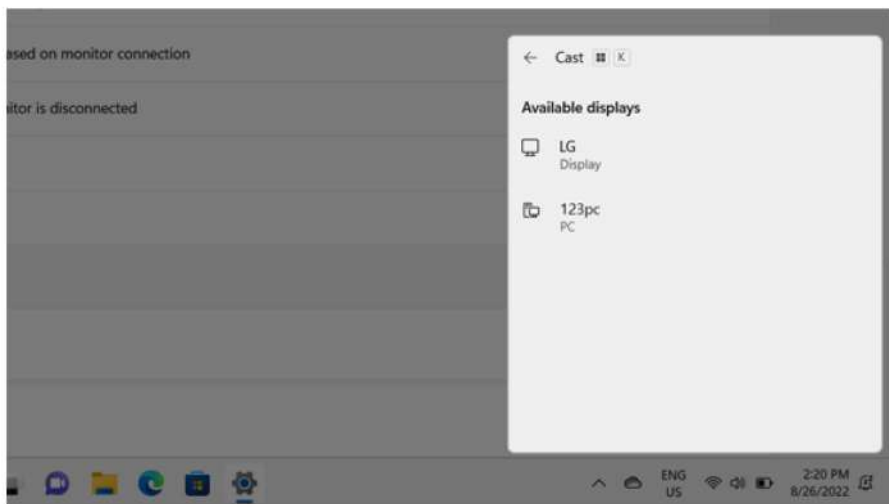

- 4 Select an available device and connect the device.

- 5 Once the wireless display device is connected, it outputs the PC screen and its sound.

## Connecting an External USB-C™ (Thunderbolt™) Device

The USB-C™ port mounted on this product supports USB 4.0 Gen 3x2 standards.

You can use the USB-C™ port to connect the USB device.

**TIP**

The name of the USB version has been changed from USB 3.1(or USB 3.1 Gen 2) to USB 3.2 Gen 2x1.

### Connecting a USB Device

If a USB device is connected to a USB-C™ port, the port works as an ordinary USB port.

**TIP**

To use a conventional USB device, a separate conversion adapter should be used.  
(Conversion adapters may be purchased separately.)

### Connecting a Thunderbolt™ Device

You can connect to the USB-C™ port an external display or a high-performance data device that support the Thunderbolt™ specifications.

Depending on the specifications of the device connected to the USB-C™ port, it acts as a USB or Thunderbolt™ device.

**TIP**

The Thunderbolt™ cable is not provided with the product. Make sure that you use a certified cable.

Some functions may not be available depending on the product. For more information, refer to the user manual provided with the device to be connected.

### Connecting two notebook PCs that support Thunderbolt™

Use Thunderbolt™ to connect two PCs easily and quickly and send and receive data between them.



- 1 Select the Start button [  ] > [All apps] > [Windows Tools].

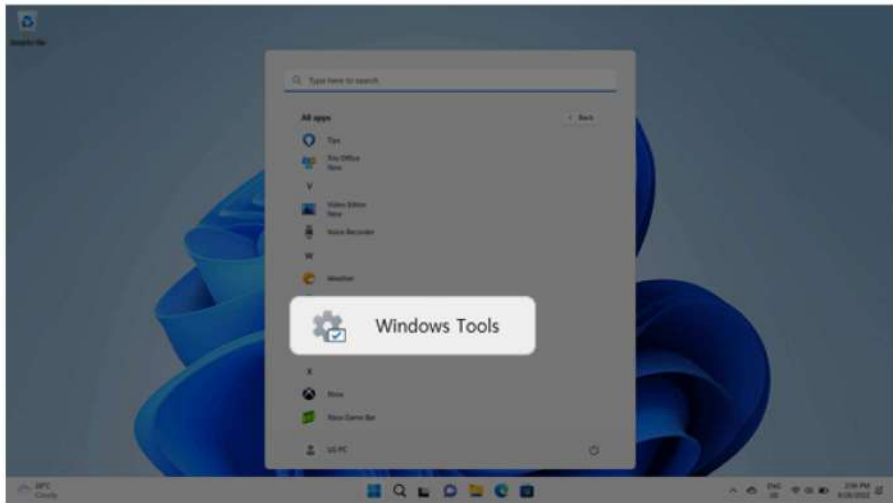

- 2 Select [Control Panel] > [Network and Sharing Center] > [Change advanced sharing settings].
- 3 Enable [Change sharing options for different network profiles] and save the changes.

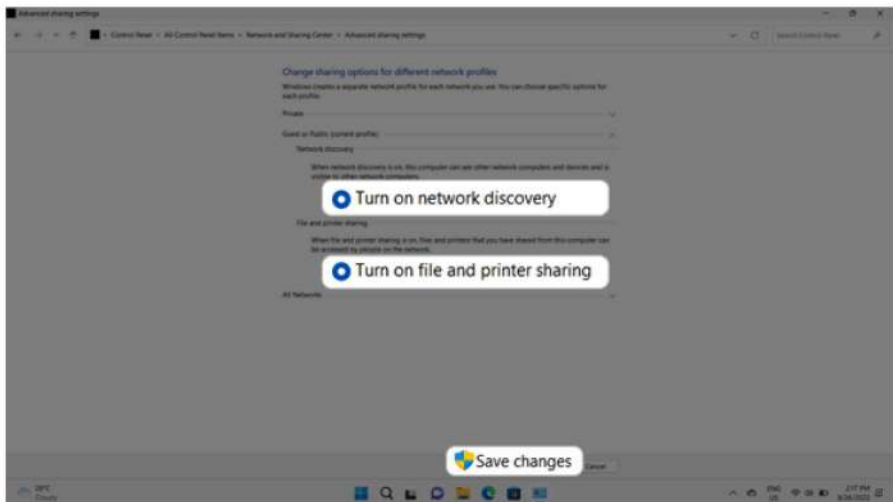

- 4 Use the Thunderbolt™ cable to connect two notebook PCs.

- 5 A while later, an icon of the connected computer appears on the desktops of the two notebook PCs.

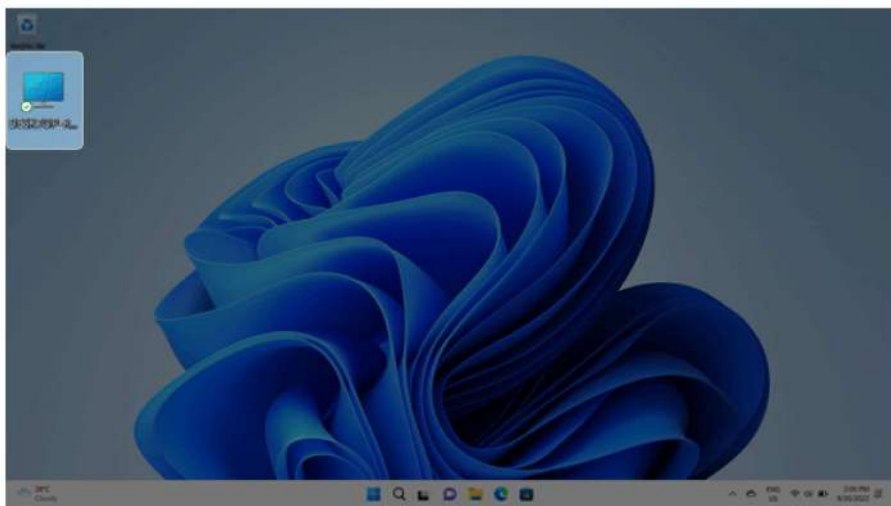

- 6 Double-click the connected computer icon to open the authentication screen.
- 7 Input the user name and password to connect to the other PC.

**Tip**

If there is no shared folder in the connected PC, nothing may appear on the screen.

## Using USB-C™ (Thunderbolt™) Charging Function

You can connect the USB-C™ device to charge a notebook PC battery or an external device, and the operation mode is automatically selected depending the charge settings of the connected device.

- To charge a notebook PC battery, the external device (USB PD Charger, notebook PC, etc.) should support USB Power Delivery 10 W (5 V / 2 A) or higher profile.
  - The external devices that use the USB-C™ port support 10 W (5 V / 2 A) and 15 W (5 V / 3 A).
  - A USB device compatible with USB PD (Power Delivery) supports charging at 15 W (5 V / 3 A), whereas a regular USB device supports charging at 10 W (5 V / 2 A).
  - USB PD batteries cannot be charged using the USB-C™ port of the notebook PC.
  - Always-On Charging is supported only with USB-C™ ports, but not with the regular USB ports.
  - If you connect an adapter with a lower output than the rated adapter, it may take more time to charge the notebook PC.
- 1 When the connected device is set to Automatic (charging the notebook PC or a connected device. Charging the notebook PC by using the mobile phone is not supported.)



- 2 When the connected device is set to Source (the notebook PC is charged.)



- 3 When the connected device is set to Sink (the connected device is charged.)

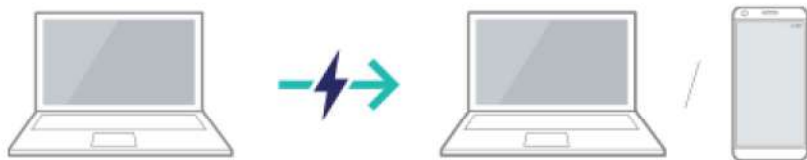

**TIP**

The charging status of the external device being charged is not displayed on the notebook PC. If you connected a smartphone, you should select "Charge mobile phone" on the smartphone screen to charge the phone battery.



**CAUTION**

If the power consumption of the notebook PC is larger than the power supply from the external device, the battery may be consumed gradually.

## Bluetooth

Bluetooth allows the user to access wirelessly various devices such as camera, cell phone, headset, printer, and GPS receiver that support Bluetooth . It can also establish a network and exchange data with other Bluetooth -enabled PC or smartphone.

### OPTION

The Bluetooth device is optional, and it may not be available in some models.

The figures herein may differ by language selection and are subject to change without prior notice.

For details on connecting a Bluetooth device, refer to the user manual provided with the Bluetooth device.

- 1 Select the Start button [  ] > [Settings].

### TIP

Press the [  ] key or [Ctrl] + [Esc] on the keyboard to display the Start screen.

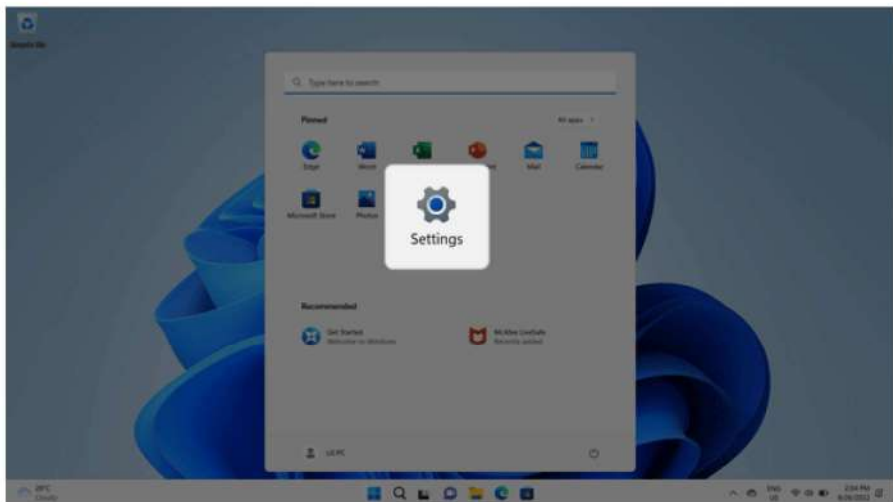

- 2 Select [Bluetooth & devices] > [Add device].

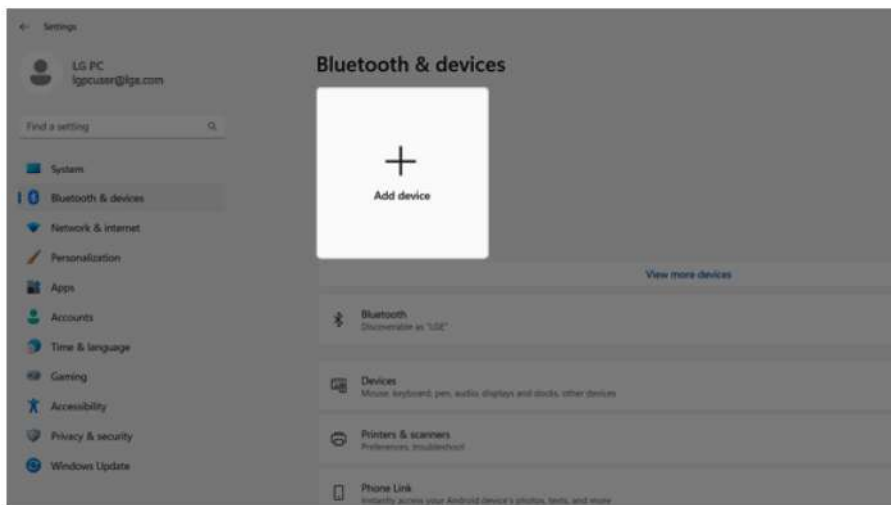

- 3 Select the **Bluetooth** to search for Bluetooth devices automatically.



- 4 After selecting the device you want to connect, complete the Bluetooth connection as guided.

## Wired LAN

LAN is the network environment that users can connect to by using a cable to connect to their internet providers or the company's network.

### Using Wired LAN

LAN is installed with an automatic IP (DHCP) as default value.

Please refer to the following instructions for details on setting up an automatic IP (DHCP) or manual IP.

- 1 Connect the LAN adapter to the USB-C™ port on the PC.

**TIP**

The recommended network cable for the optimal network environment is CAT5 or higher.  
The network (LAN) cable may be connected when the LAN adapter is used.  
The LAN adapter may be separately purchased at LG Service Center.





- 2 Connect the wired LAN cable to the LAN port.



- 3 Select the Start button [  ] > [Settings].

**Tip** TIP

Press the [  ] key or [Ctrl] + [Esc] on the keyboard to display the Start screen.

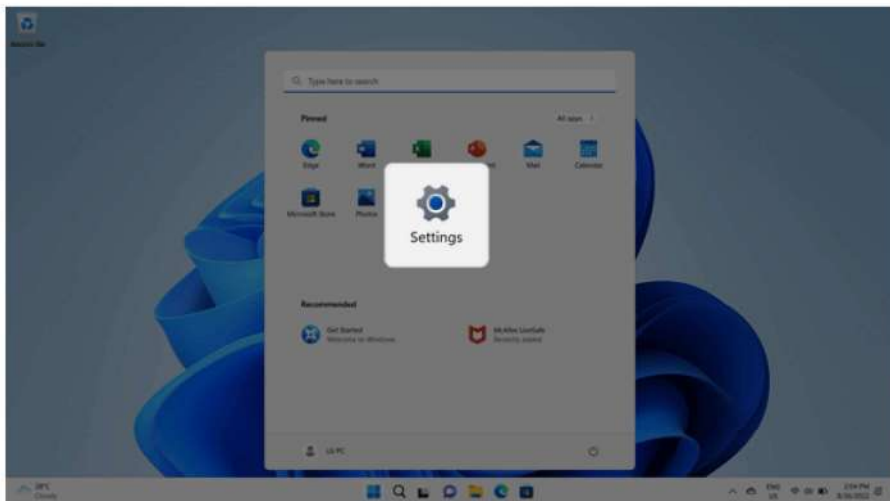

- 4 Select [Edit] in [Network & Internet] > [Ethernet] > [IP assignment].

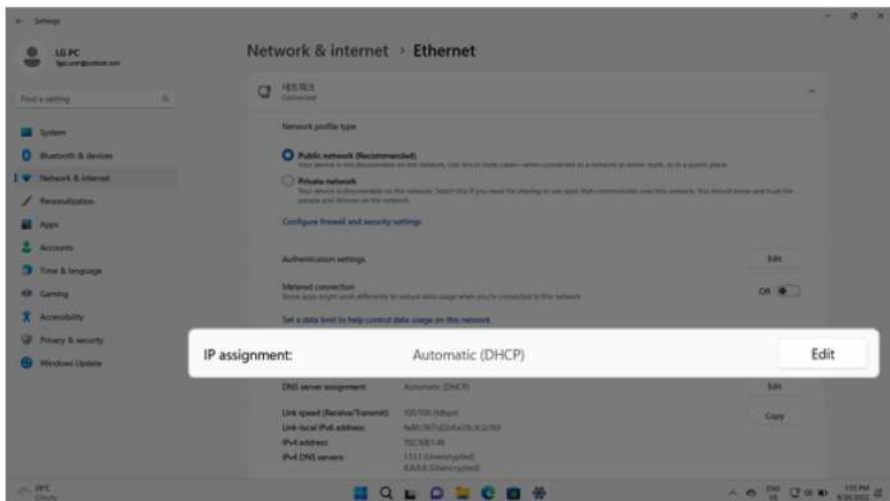

- 5 To use an automatic IP (DHCP), select [Automatic]. If you wish to use a static IP, set [Manual] > [IPv4] to [On] and enter the necessary item.

**Contact the network service provider or administrator to use a static IP.**

**Edit IP settings**

Manual

**IPv4**

On

IP address

Subnet mask

Gateway

Preferred DNS

Preferred DNS encryption

Unencrypted only

Alternate DNS

Save Cancel

- 6 Select [Save] to complete the network setup.
- 7 Click the Web Browser icon to check whether the internet is operating normally.

## Wireless LAN

The wireless network (Wireless LAN) is the network environment that connects a PC with the internet provider or company network through an Access Point (wireless or regular router).



### OPTION

Wireless LAN is optional. Hence, it may not be installed in some models.

### Turning On/Off Airplane Mode

Prior to using the wireless LAN, press [Fn] + [F6] to turn off **Airplane Mode**.

Pressing [Fn] + [F6] keys will turn on or off the **Airplane Mode**. If you are not going to use the product for a while, keep the **Airplane Mode** turned on to reduce the battery power consumption.

### Using the Wireless LAN

If an Access Point (wired or wireless router) is in the vicinity of the PC, the wireless LAN can easily be accessed.

**When searching for a wireless LAN, multiple Access Points may be discovered depending on the location of use.**

**In case no accessible wireless LAN is near the PC, no Access Point might be found.**

**A password-protected Access Point cannot be accessed without the correct password.**

- 1 Select **[Quick Settings]** on the right side of the taskbar.



### TIP

The displayed icons may differ from the figures herein.

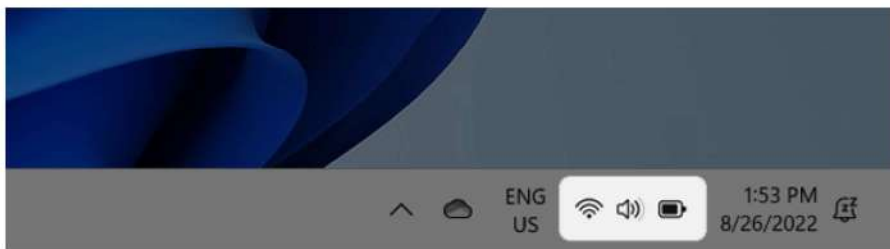

- 2 Select **Manage Wi-Fi Connections** [ > ] to search for near Access Point.

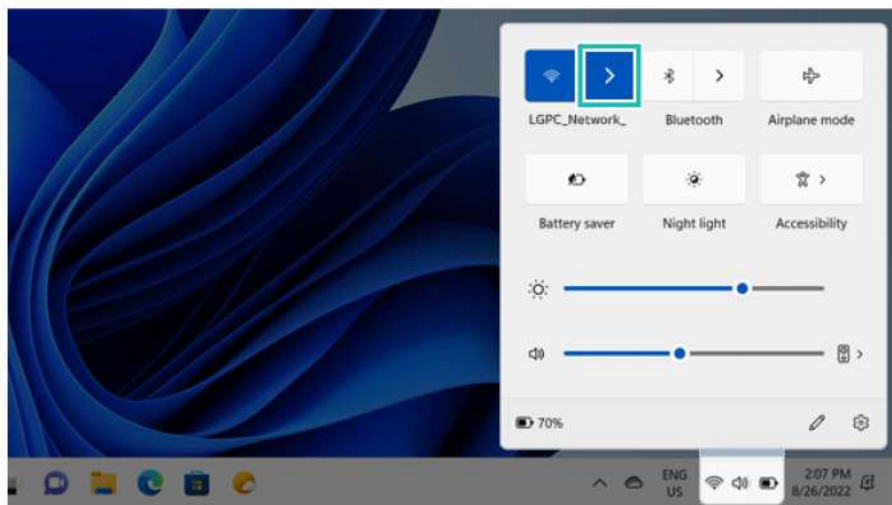

**TIP**

When **Wi-Fi** is turned off, set [Wi-Fi] to On.

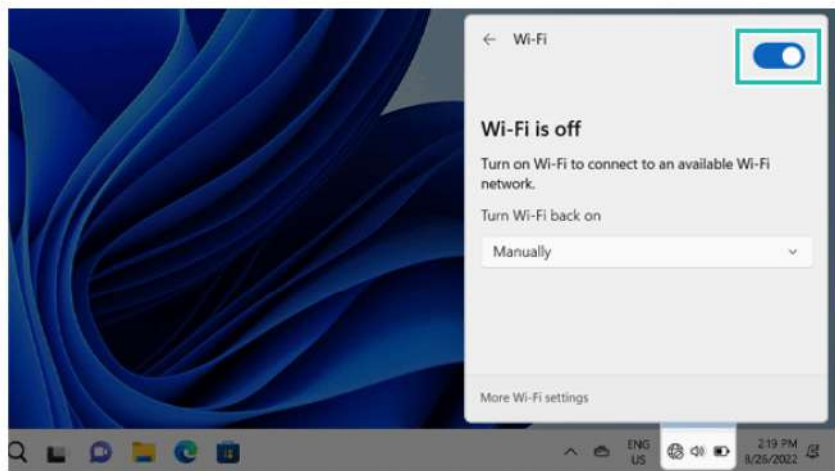

- 3 Select the Access Point you want to connect to and press [Connect].

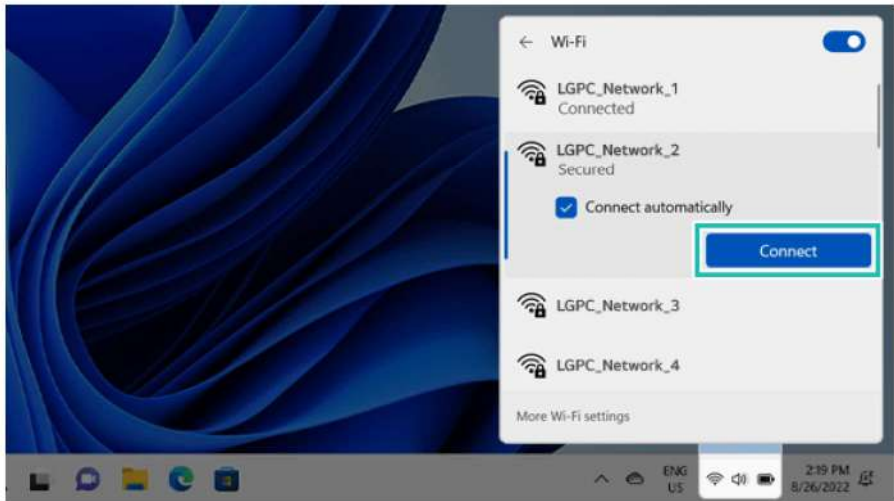

- 4 If a connection is established, [Connected] appears below the Access Point name.
- 5 Click the Web Browser icon to check whether the internet is operating normally.

## Using a Wired/Wireless Router

A wireless/regular router connects several PCs and mobile devices to one internet line and enables the use of internet and the network.

**A wireless/regular router has to be bought separately. Refer to the manual provided by the manufacturer for instructions.**

### Connecting a Wireless or Regular Router

If one internet line is used with a wired/wireless router and several devices are connected, this may result in a slower connection.

In case of a wireless LAN, it is recommended to change the network name and security settings for a more secure connection.

**Network speed can differ according to operation environment and specifications.**

- 1 Connect the internet cable of the modem that was provided by your internet provider to the router's WAN port.
- 2 Connect all devices (PC, IPTV, internet phone, etc.) with a LAN cable to LAN ports 1 to 4 of the router.

**The number of LAN ports can vary for each router model.**

- 3 Please refer to the manual provided by the router manufacturer for setup of the network and internet.

## microSD Slot

### Checking Available Memory Card

This model supports microSD memory cards.

- Directly applicable memory cards



microSD

### Mounting and Using Memory Card

This product has one **microSD** slot.

Check the insertion direction of the memory card and push the **microSD** memory in until it is fully seated.





**TIP**

- When the memory card is formatted, the data stored in the memory card will be deleted. Check whether there are important data before formatting the memory stick.
- To format a memory card, right-click the memory card drive and select Format. When the Format window appears, press Start to continue.
- If the write protection tab of memory card is locked, the user cannot format the memory stick nor write or delete the data.
- **microSD** memory cards can be used only as storage devices and do not support the copyright protection feature.

**Removing Memory Card**

Push the card with your finger to make the card spring out of the slot. Remove the memory card.

**TIP****Safely remove the microSD card**

The figures herein may differ by language selection and are subject to change without prior notice.

- When a pop-up window appears by selecting the [  ] icon on the right side of the taskbar, select Eject to safely remove the hardware.

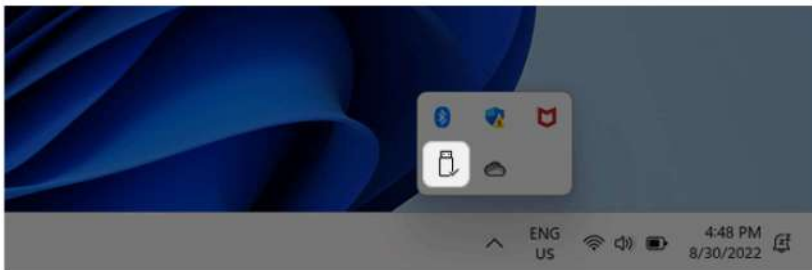

## Using Software

### LG Smart Assistant

**LG Smart Assistant** allows you to easily change the settings of your PC according to your needs.

**TIP**

**LG Smart Assistant** can be re-installed through **LG Update & Recovery** (or **LG Update**).

Menus and supported functions may differ depending on the model.

Please update the program to the latest version through **LG Update & Recovery** (or **LG Update**).

The figures herein are subject to change without prior notice.

#### Running LG Smart Assistant

Select the Start button [  ] > [All apps] and run [LG Smart Assistant].

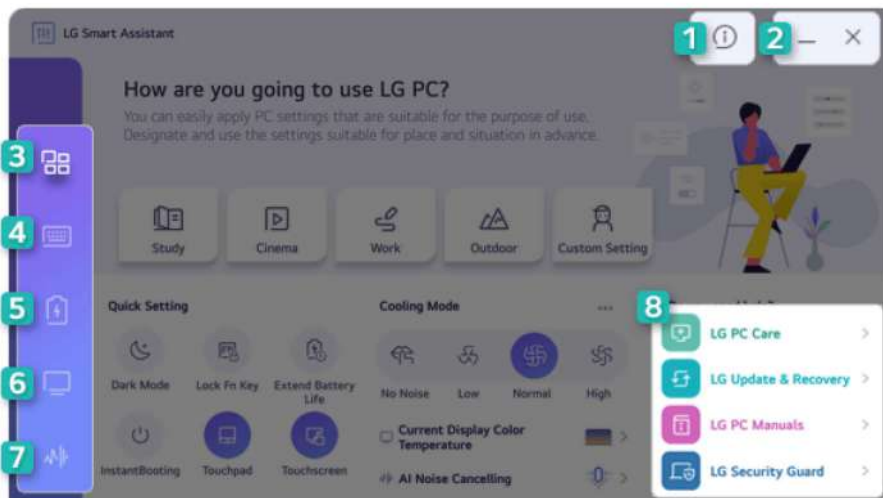

- 1 **Information Button:** Runs Help or displays information about the software.
- 2 **Minimize/Exit Button:** Minimizes the size of the window or closes the program window.
- 3 **Dashboard:** Allows you to specify PC settings suitable for the purpose of use and apply them at once, or to set key PC functions easily.

- 4 **Keyboard Setting:** Allows you to set the functions related to the keyboard such as keyboard lighting and shortcuts.
- 5 **Power Setting:** Allows you to check the battery status and extend the battery life, set the power and sleep settings, and set the USB-C™ port charging function.
- 6 **Display Setting:** Allows you to set the functions related to the display such as display color temperature and Reader Mode.
- 7 **AI Noise Cancelling:** Allows you to set the noise cancelling function for the microphone input and the speaker output.
- 8 **Go to LG Software:** Allows you to run LG PC Care, LG Update & Recovery (or LG Update), LG PC Manuals, and LG Security Guard directly.

## Dashboard

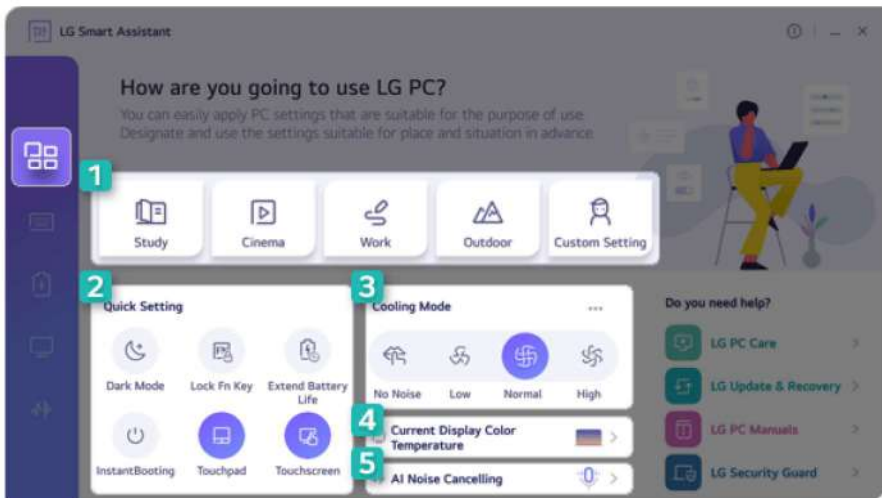

- 1 **User Mode:** Allows you to set the user mode according to the PC environment.
- 2 **Quick Setting:** Allows you to set the PC settings easily.
  - **Dark Mode:** Allows you dim the colors displayed on Windows and the app.
  - **Lock Fn Key:** Allows you to set the hot keys (F1 - F12) to operate even without pressing Fn.
  - **Extend Battery Life:** Allows you to lower the max. battery charge level to 80% to extend the battery lifespan.
  - **Instant Booting:** Allows you to set the system to turn on automatically when you open the cover of the notebook PC.
  - **Touchpad:** Allows you to turn off or on the touchpad.
  - **Touch Screen:** Allows you to turn off or on the touch screen.

- 3 **Cooling Mode:** Allows you to set the fan mode of the PC according to the PC environment.
- **No Noise Mode:** Limits the PC performance so that the PC does not generate fan noise. (The PC surface temperature may rise when the function is used for a long time. It automatically changes to the **Normal Mode** upon reboot.)
  - **Low Mode:** Minimizes fan speed so that you can use the PC in a quiet environment. (This may degrade your PC performance. It automatically changes to the **Normal Mode** upon reboot.)
  - **Normal Mode:** Optimizes PC performance, heat and noise.
  - **High Mode:** Sets to the tasks that require high performance. (This may result in increased PC surface temperature and noise, and shorter battery life. It automatically changes to the **Normal Mode** upon reboot.)

**CAUTION**

When using for a long term, use **Normal Mode**.

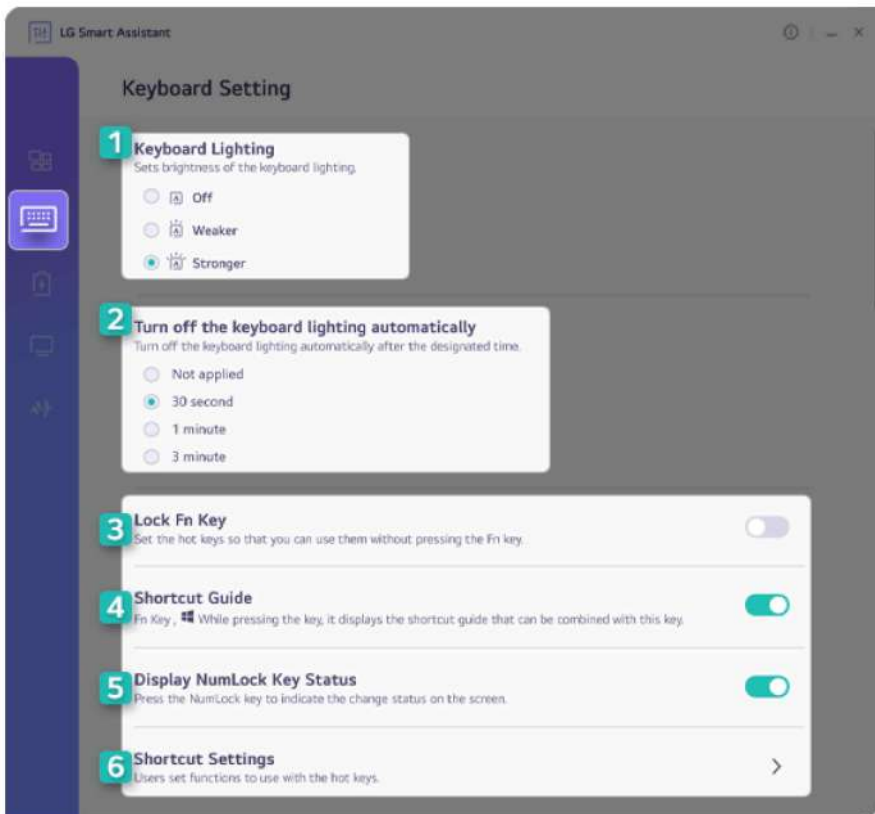

- 4 **Current Display Color Temperature:** Go to the [Display Setting] menu.
- 5 **AI Noise Cancelling:** Go to the [AI Noise Cancelling] menu.

## Keyboard Setting



- 1 Keyboard Lighting:** Allows you to set the keyboard lighting and brightness.
- 2 Turn off the keyboard lighting automatically:** Allows you to set the keyboard light to turn off automatically after a specified amount of time.
- 3 Lock Fn Key:** Allows you to set the hot keys (F1 - F12) to operate even without pressing Fn.
- 4 Shortcut Guide:** While pressing the Fn key or  key, you can set to display the shortcut guide that can be combined with this key.
- 5 Display NumLock Key Status:** Allows you to set the screen to display the status change when you press the NumLock key.

**6 Shortcut Settings:** You can register the app or Internet address to set to use as a shortcut, or check the designated shortcut.

- On the Shortcut Settings List, select the navigation icon [  ] or the internet icon [  ] to register the desired app or Internet address to a shortcut.

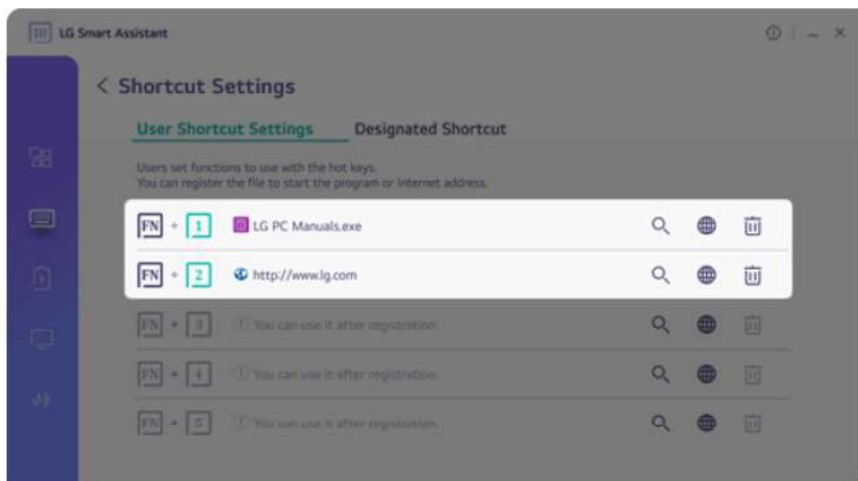

**TIP**

- Some abnormal program files (exes) and Internet addresses (links) may not be linked.
- Shortcuts can be set from 1 to 5, and the designated shortcuts cannot be changed.

- After selecting the app-running file, right-click the mouse and use the [Show more options] > [Set functions to use with user Hot keys] menu to register the app quickly.

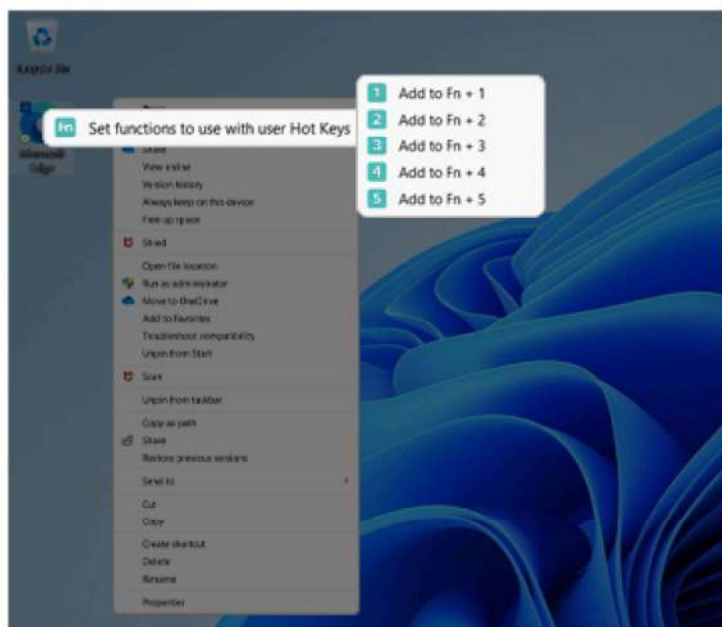

## Power Setting

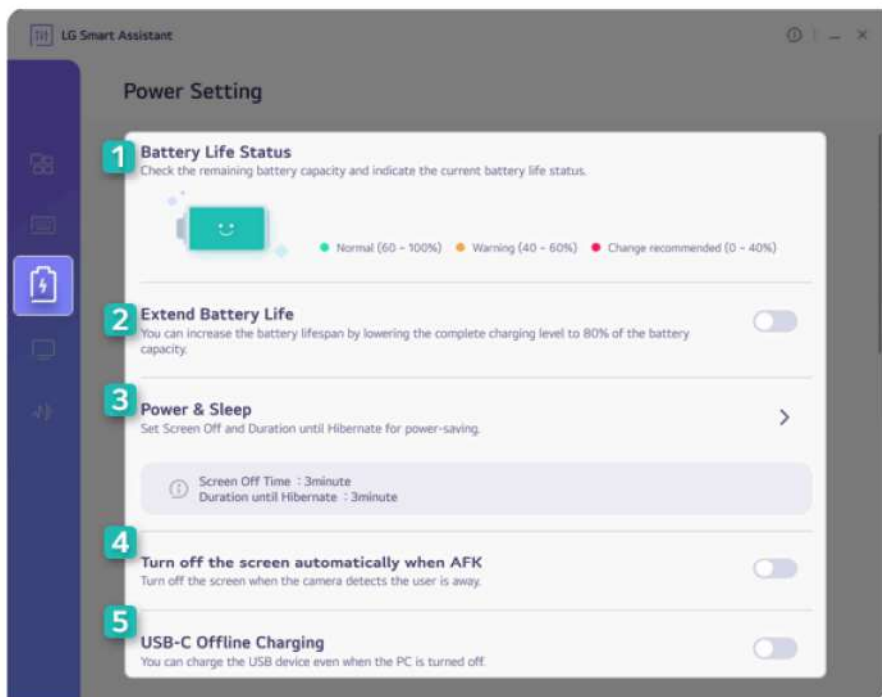

- 1 **Battery Life Status:** Displays the battery status so that you can replace the battery timely.
- 2 **Extend Battery Life:** Allows you to lower the max. battery charge level to 80% to extend the battery lifespan.
- 3 **Power & Sleep:** Displays the screen off time and the sleep mode entry time. You can go to Windows settings and set the time.
- 4 **Turn off the screen automatically when AFK:** Allows you to set the screen to automatically turn off when you are away from the keyboard for a certain amount of time.
- 5 **USB-C™ Offline Charging:** Allows you to set the PC to charge external devices via the USB-C™ port even when the PC is turned off.



## Display Setting

LG Smart Assistant

## Display Setting

- ### 1 Color Temperature Settings

Adjust to an eye-friendly and warm color, or an even more clear and cold color.



Cold Warm



#### Color Temperature Auto Adjustment

Set to the color temperature optimized for this display automatically.
- ### 2 Reader Mode

Set to the screen color that reduces eye fatigue.
- ### 3 Professional Mode

By applying the ICC profile, it provides a more expanded color range.
- ### 4 Connecting to Simple Display

Through the menu drawn on the screen while connecting the external display, you can easily switch to the extension mode or other modes.

#### Setting with Mouse Pointer

If you place the mouse pointer in the middle of each edge, the menu that can extend or copy the external display is displayed.
- ### 5 Applying Lively Theme

Provides a lively background exclusive to LG PC. Battery consumption may be fast and resource consumption may occur depending on PC specifications. If the Power Saving Mode is on, the operation stops.

#### Changing LG Theme

You can set various themes provided by LG PC easily and quickly.



#### Select operation in the charging status

  - Disable
  - Play once when starting Windows
  - Continuous Operation

#### Select operation in the battery status

  - Disable
  - Play once when starting Windows
  - Continuous Operation

- 1 **Color Temperature Settings:** Allows you to adjust the screen color temperature to cool (bluish screen color) or warm (reddish screen color) or use the automatic color temperature function.
- 2 **Reader Mode:** Allows you to set the Reader Mode to reduce eye fatigue when reading documents.

**CAUTION**

Using the **Reader Mode** and the **Night light** at the same time can cause color distortion. When you use the **Reader Mode**, turn off the **Night light**.

- You can turn [Night light] on or off in the Start button [  ] > [Settings] > [System] > [Display].

**TIP**

You can use hot keys to use the **Reader Mode** function more conveniently.

- Press the [Fn] + [F9] keys to switch the PC screen to **Reader Mode**. Press them again to turn off **Reader Mode**.

- 3 **Professional Mode:** Provides a more extended color gamut to the display and enhances the content color reproduction.

**TIP**

**Professional Mode** uses an ICC profile and works only in some programs.

- 4 **Connecting to Simple Display:** When connecting an external display, you can set to display the menu that can set the Display Mode on the PC screen.
- 5 **Applying Lively Theme:** You can set various themes provided by LG PC or select an operation method of Lively Theme according to the charging status.

## AI Noise Cancelling

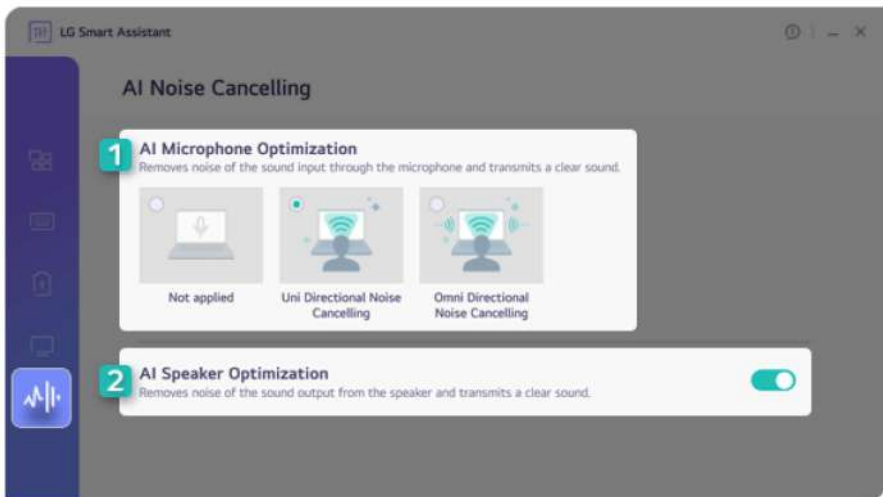

- 1 **AI Microphone Optimization:** Cancels out the noise input to the microphone to deliver clear sound.
- 2 **AI Speaker Optimization:** Cancels the noise output from the speakers to deliver clear sound.

## LG Update & Recovery

**LG Update & Recovery** performs updates to keep the system in an optimal state, and backs up and recovers data in case a problem occurs so that you can safely use your PC.

### TIP

For some models without the **Recovery** function, only the **LG Update** function is provided.

Menus and supported functions may differ depending on the model.

It may not work properly depending on user environment (security tools, etc.) and the network status.

You can use **LG Update & Recovery** (or **LG Update**) to install the deleted drivers or the latest drivers easily and quickly.

Use **LG Update & Recovery** (or **LG Update**) to keep your system current and optimized.

The figures herein are subject to change without prior notice.

### Running LG Update & Recovery (or LG Update)

Select the Start button [  ] > [All apps] and run [LG Update & Recovery] or [LG Update].

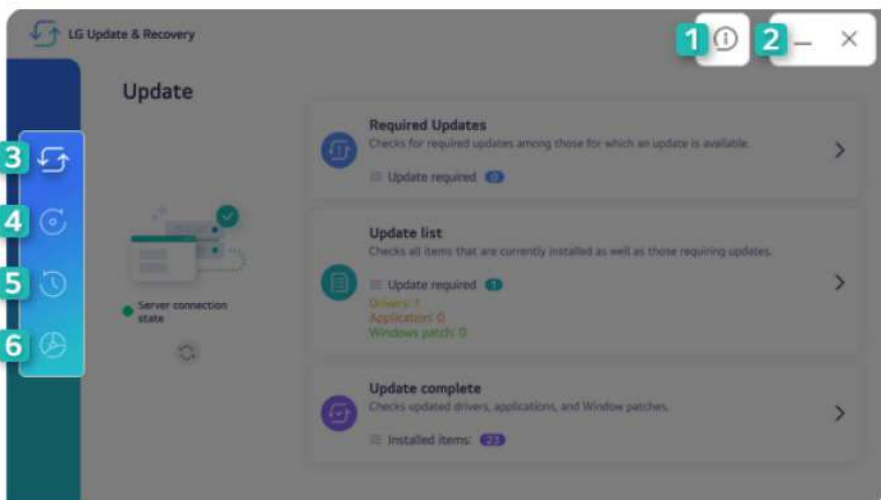

- 1 **Information Button:** Runs Help or displays information about the software.
- 2 **Minimize/Exit Button:** Minimizes the size of the window, or exits the software.

- 3 **Update:** Allows you to install various PC drivers, applications and Windows patches easily and quickly.
- 4 **Backup:** Allows you to back up Windows, disk environment, and data safely.
- 5 **Recovery:** Allows you to recover backup data or reset your PC.
- 6 **Tools:** Partitions the disk installed with Windows or the data disks.

**TIP**

For details on backup and recovery, see [Recovering the System].

**LG Update** does not support [Backup], [Recovery], and [Tools] menus.

## Update

If an item that needs updating is displayed, you can select it and update it.

- 1 Select [Required Updates] or [Update list] from the [Update] menu.

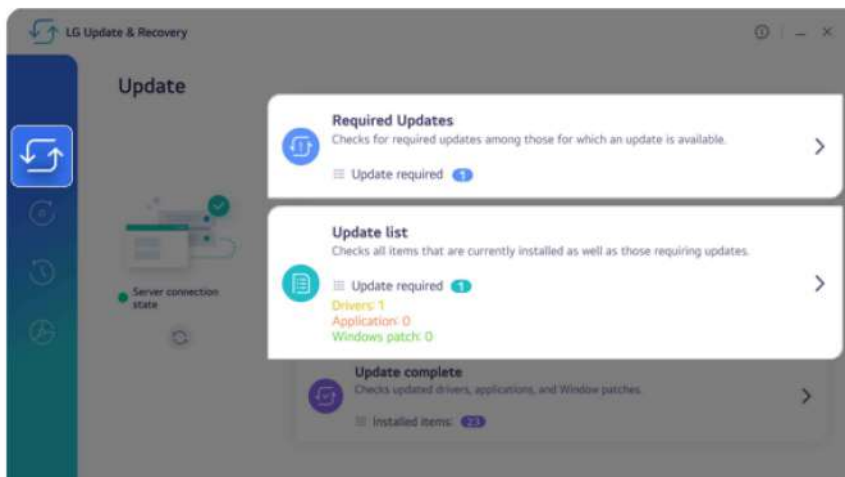

- 2 After selecting the items to update, select [Installation].

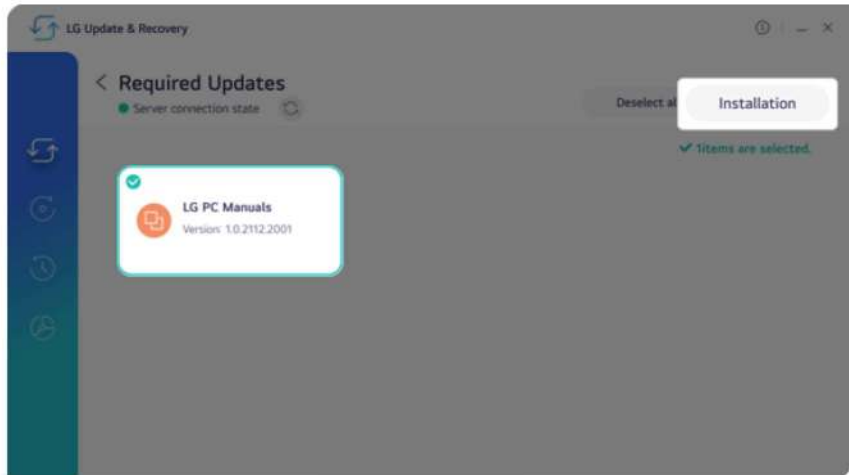

### Disk Partitioning

Partitions the disk installed with Windows or the data disks.

#### TIP

**LG Update** does not support the disk partitioning function.

The data disk partitioning function is only available on models with two or more storage devices.



#### CAUTION

You are encouraged to back up your personal files to avoid data loss when partitioning.

- 1 Select [Partitioning the Windows disk] or [Partitioning the data disk] from the [Tools] menu.

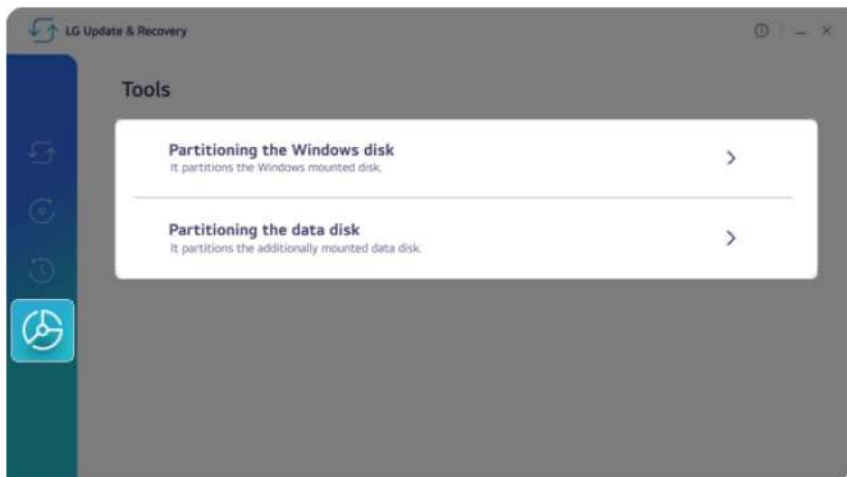

- 2 If you select the desired disk partition, the [Partitionable minimum volume] menu appears.

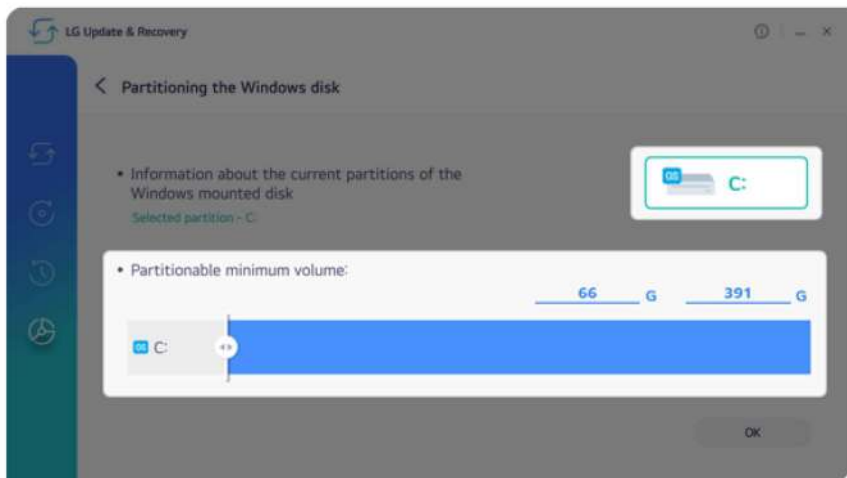

- 3 Set the capacity of the disk to be partitioned and select [OK].

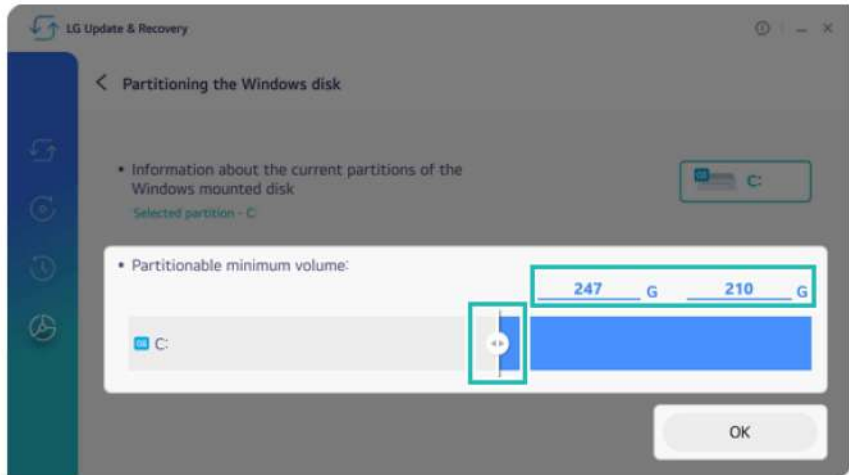

- 4 The disk will be partitioned.



## LG Glance by Mirametrix®

LG Glance by Mirametrix® uses AI-based attention detection technology to improve PC productivity and enhance security.

**TIP**

LG Glance by Mirametrix® can be re-installed by searching LG Glance by Mirametrix® in **Microsoft Store**.

LG Glance by Mirametrix® basically operates with the power connected, and connecting an external monitor makes it possible to utilize various functions more efficiently.

The figures herein are subject to change without prior notice.

### Running LG Glance by Mirametrix®

- 1 Select the Start button [  ] > [All apps] and run [LG Glance by Mirametrix®].
- 2 The tutorial (help on how-to-use) for LG Glance by Mirametrix® appears.

### Exploring LG Glance by Mirametrix®

Select the [  ] (Show hidden icons) icon on the right side of the taskbar, and then select the [

 ] icon to run LG Glance by Mirametrix®.

**TIP**

To always display the LG Glance by Mirametrix® icon [  ] on the taskbar, right-click on the taskbar, select [Taskbar settings] > [Other system tray icons], and set [Glance.exe] to [On].

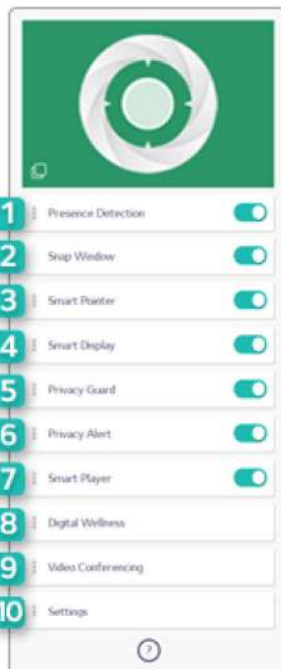
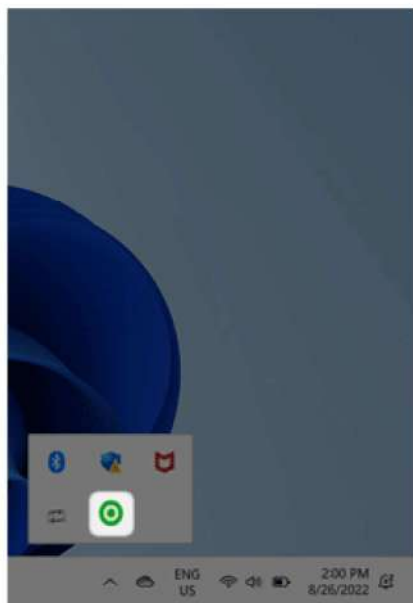

- 1 **Presence Detection:** If the user does not look at the screen or leaves the screen for a certain period of time, the screen is locked or darkened.
- 2 **Snap Window:** (When an external monitor is connected) Click and hold the title bar of the desired window, move your head to the external monitor or the notebook PC screen to move the window to the screen you are looking at.
- 3 **Smart Pointer:** (When an external monitor is connected) Move your head to the external monitor or the notebook PC screen to move the mouse pointer to the screen you are looking at.
- 4 **Smart Display:** Dims the screen of an external monitor or the notebook PC screen that the user is not looking at.
- 5 **Privacy Guard:** Blurs the notebook PC screen if someone is looking at your screen from behind.
- 6 **Privacy Alert:** Alerts you with an icon if someone is looking at your screen from behind.
- 7 **Smart Player:** Pauses the audio or video playback of a specific app when the user is away and automatically resumes playback when the user returns.
- 8 **Digital Wellness:** Tells you to look at an object far away for 20 seconds every 20 minutes to protect your eyesight. If you crouch too close to the screen, it tells you to correct your posture.
- 9 **Video Conferencing:** (During video conferencing) Displays a video of the presenter on the Desktop or automatically mutes the microphone when the user moves away from the screen. **Virtual Camera** hides the background of the camera or automatically adjusts the frame of the camera

according to the user's movement and compensates the face or the lighting to make your face look more beautiful.

- 10 Settings:** Provides the settings menu and tutorial (help on how to use) of LG Glance by Mirametrix®.

**Tip TIP**

For [Snap Window] and [Smart Pointer], an external monitor should be connected through Expansion, and they cannot be used if the monitor placement in [Display settings] is different from the actual monitor placement.

Right-click the mouse on Desktop > In [Display settings], change monitor placement according to the environment in use.

- For more information on how to connect the external monitor, refer to the details of [Connecting to External Display] in [Using the PC].

## LG Security Guard

**LG Security Guard**, when a user is away from the seat while using the PC, decreases danger of theft and loss of the laptop.

**TIP**

**LG Security Guard** can be re-installed through **LG Update & Recovery** (or **LG Update**).

The Monitoring Mode of **LG Security Guard** operates only when the power is connected.

The figures herein are subject to change without prior notice.

### Running LG Security Guard

- 1 Select the Start button [  ] > [All apps] and run [LG Security Guard].
- 2 Log into the Windows Hello account as guided.

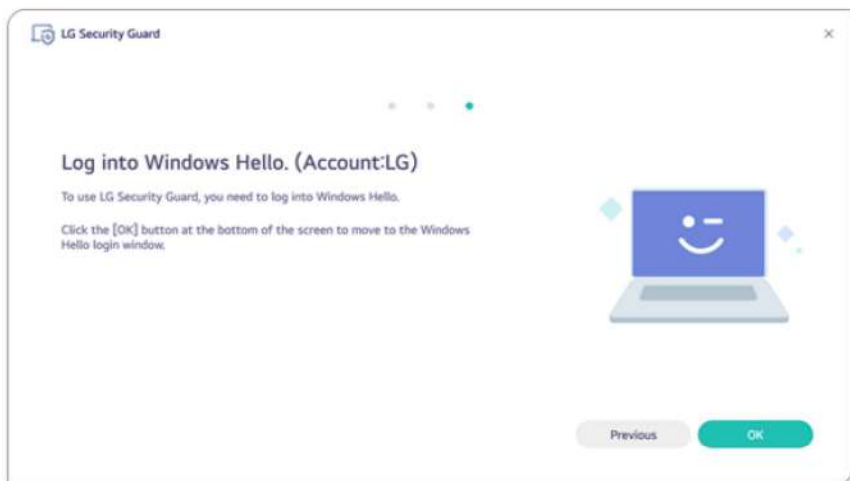

## Touring LG Security Guard

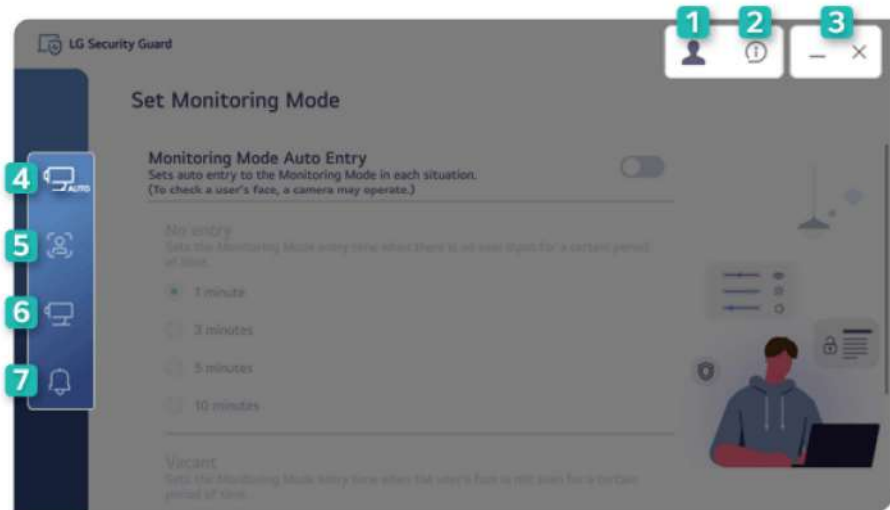

- 1 **User Account Button:** Displays information of the account currently logged in, and the account settings can be changed.
- 2 **Information Button:** Displays software information.
- 3 **Minimize/Exit Button:** Minimizes the size of the window or closes the program window.
- 4 **Set Monitoring Mode:** Allows you to set functions such as Monitoring Mode auto entry, time, and vacant.
- 5 **Detection Target Settings:** Allows you to set functions such as input device and face detection.
- 6 **Set Monitor Screen:** Allows you to set functions such as full screen and Monitoring Mode phrase.
- 7 **Warning Alarm Settings:** Allows you to set functions such as warning alarm phrase, e-mail notification, and lock booting password.

**TIP**

If there are no set values for e-mail notification and lock booting password functions, they are not activated.

## Sync On Mobile

**Sync On Mobile**, by connecting the PC with the mobile device, can send photos and videos easily.

**TIP**

**Sync On Mobile** can be re-installed through **LG Update & Recovery** (or **LG Update**).

It is recommended to disconnect from the app after using on a public PC.

The app may not work properly on some mobile devices and upgrading the operating system of a mobile device may prevent some features from working properly.

The figures herein are subject to change without prior notice.

### Connect **Sync On Mobile**

- 1 Select the Start button [  ] > [All apps] and run [**Sync On Mobile**].
- 2 Use the camera app of the mobile device to scan the [Downloading Sync On Mobile app] QR code, and install the app on the mobile device.

**TIP**

You can search **Sync On Mobile** on **Google Play** or **App Store** and install the mobile device app.

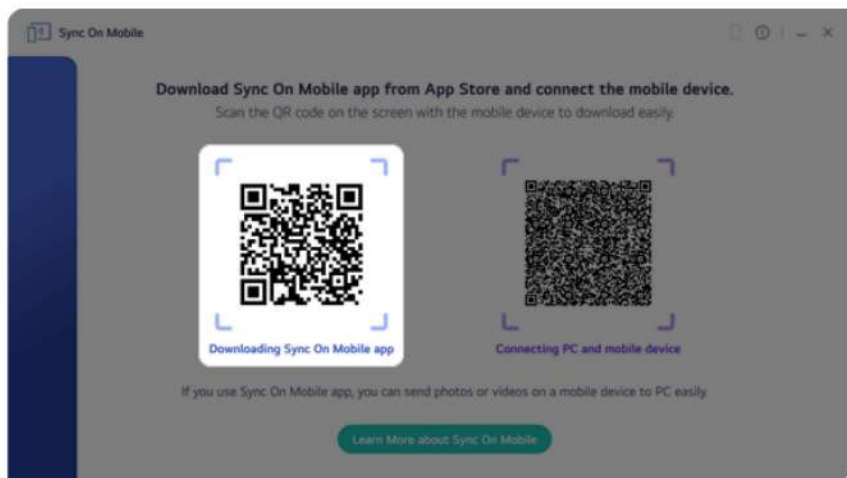

- 3 Connect the PC and mobile device to the same Wi-Fi.

- 4 Select [Connecting PC and Mobile device] on the **Sync On Mobile** app of the mobile device and scan the [Connecting PC and Mobile device] QR code of the PC to connect the PC and mobile device.

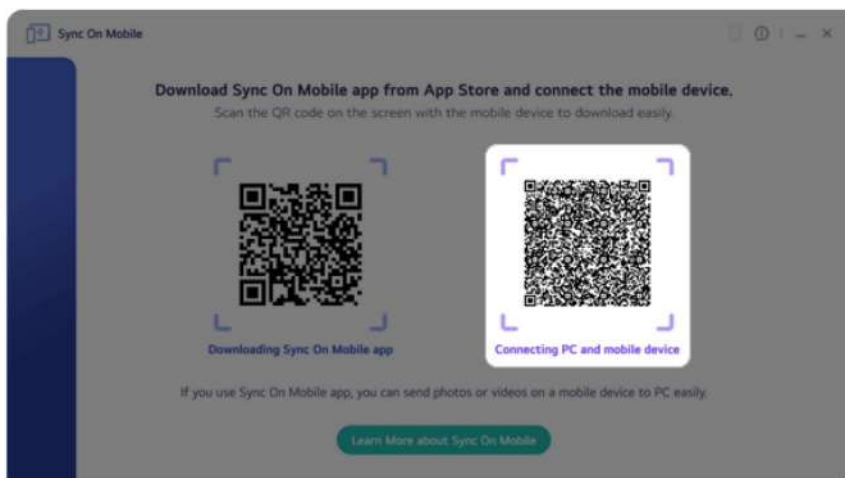

### Touring Sync On Mobile

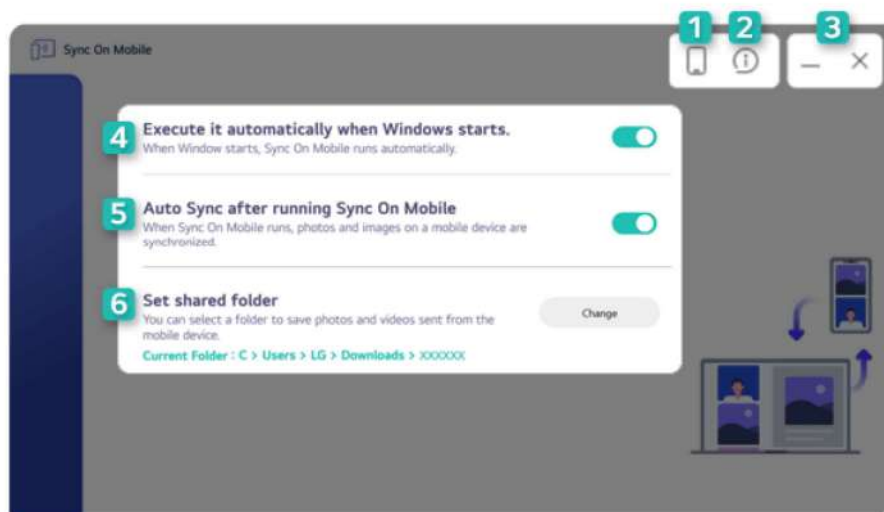

- 1 **Mobile Device Information Button:** Displays information of the mobile device currently connected, and you can deactivate the mobile device connection.
- 2 **Information Button:** Runs Help or displays information about the software.
- 3 **Minimize/Exit Button:** Minimizes the size of the window or closes the program window.
- 4 **Execute it automatically when Windows starts:** When running Windows, you can run the **Sync On Mobile** app automatically.
- 5 **Auto Sync after running Sync On Mobile:** When running the app, you can set to auto sync photos and videos of the connected mobile device.
- 6 **Set shared folder:** You can set a folder to save photos and videos sent from the mobile device.



## PCmover Professional

**PCmover Professional** transfers applications, files (pictures, music, videos, and documents) and settings from your old PC to your new PC.

**Tip** TIP

**PCmover Professional** can be re-installed through **LG Update & Recovery** (or **LG Update**).

The old and new PCs must be connected under the same network.

For details on how to use **PCmover Professional**, see the [User Guide] of **PCmover Professional**.

The figures herein are subject to change without prior notice.

### Running PCmover Professional

Select the Start button [  ] > [All apps] > [**Laplink PCmover Professional**] and run [**PCmover Professional**].

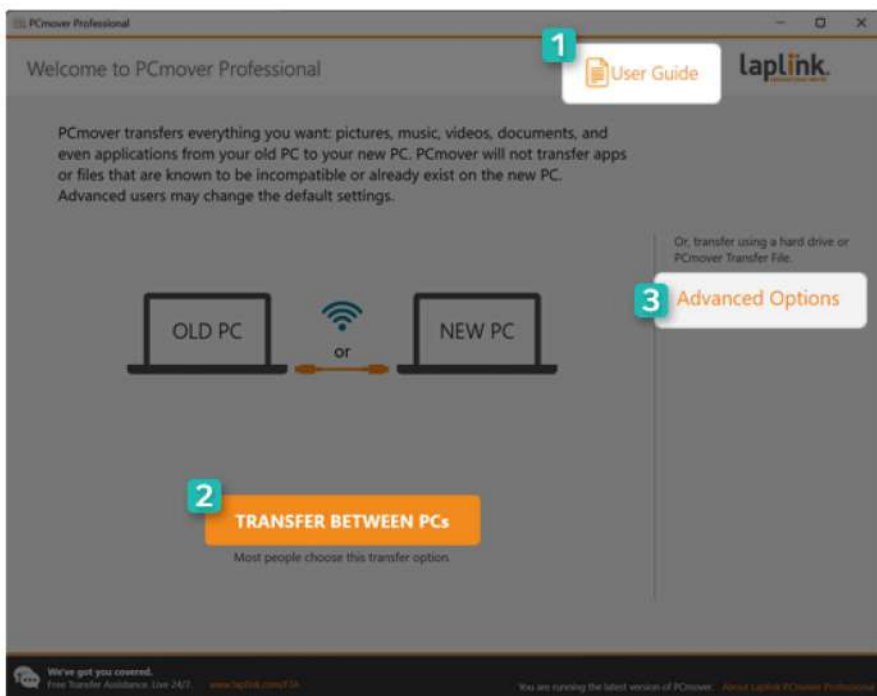

- 1 **User Guide:** You can find out more about how to use **PCmover Professional**.
- 2 **TRANSFER BETWEEN PCs:** Starts the process of transferring data (apps, files, settings, etc.) between the old PC and the new PC.
- 3 **Advanced Options:** Allows you to create a transfer file on an external media (USB disk, etc.) and transfer it to a new PC, or to transfer it to a new PC using a disk image backed up from the old PC. Also, you can transfer apps, files and settings between user accounts of the same PC.

## Dolby Access

**Dolby Access** helps use **Dolby Atmos** effects that provide accurate and ample sounds according to the situation.

**Tip** **TIP**

**Dolby Access** can be re-installed by searching **Dolby Access** in **Microsoft Store**.

**Dolby Access** may not be available depending on the model.

The figures herein are subject to change without prior notice.

### Running **Dolby Access**

Select the Start button [  ] > [All apps] and run [ **Dolby Access** ].

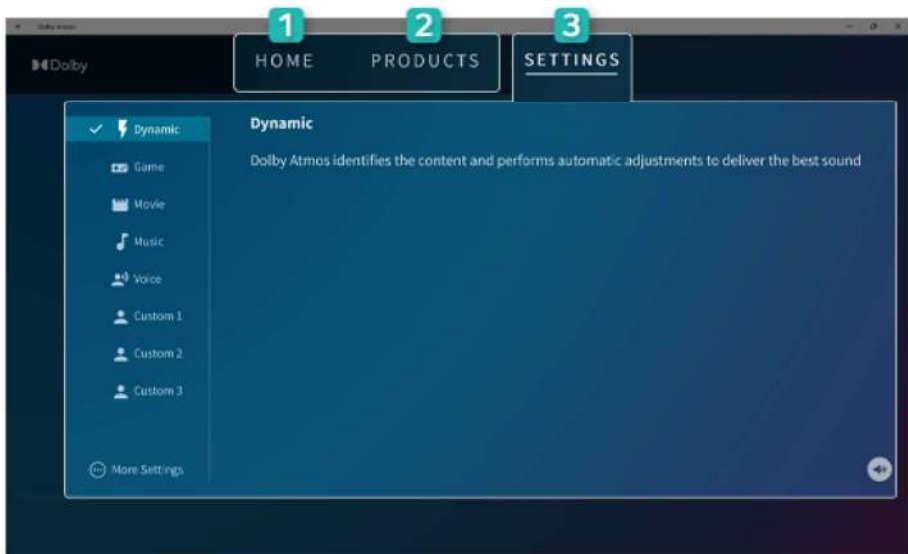

- 1 Home:** Allows you to experience contents for **Dolby Atmos**.
- 2 Product:** Allows you to set the product that can activate **Dolby Atmos** effects. (It is set to the built-in speaker by default, and when connecting the headphone, it changes to the headphone.)

**3 Settings:** Allows you to select various sound effects according to the situation.

- **Dynamic:** Provides optimized sounds for contents in operation.
- **Game:** Provides optimized sounds for running a game.
- **Movie:** Provides optimized sounds for movie playback.
- **Music:** Provides optimized sounds for music playback.
- **Voice:** Provides optimized sounds for voice playback.
- **Custom 1, 2, 3:** Provides optimized sounds according to user settings.
- **More Settings:** Allows you set other settings such as deactivating **Dolby Atmos** effects.

**TIP**

#### **Remove Audio Driver or Dolby Atmos**

Remove **[Dolby Access]** and **[Dolby Atmos Driver]** first, and then remove **[Realtek(R) Audio Driver]** and restart the system.

#### **Re-install Audio Driver or Dolby Atmos**

While **[Dolby Access]**, **[Dolby Atmos Driver]**, and **[Realtek(R) Audio Driver]** are all removed, install **[Realtek(R) Audio Driver]** first. Restart the system and install **[Dolby Atmos Driver]** and **[Dolby Access]**, respectively.

**If you do not remove or install them in the order specified, an error may occur.**

## Intel® Unison™

Intel® Unison™, by connecting the PC and smartphone, allows you to use calls or text messages on the PC or share files.

**TIP**

Intel® Unison™ can be reinstalled by searching Intel® Unison™ in **Microsoft Store**.

It is recommended to disconnect from the app after using on a public PC.

The app may not work properly on some smartphone models and upgrading the operating system of a smartphone may prevent some features from working properly.

The figures herein are subject to change without prior notice.

### Connect Intel® Unison™

- 1 Select the Start button [  ] > [All apps] and run [Intel® Unison™].
- 2 Select [Accept & continue].
- 3 Select [Get the phone app here] and scan the [Download the Intel® Unison™ phone App] QR code to install the app on the smartphone.

**TIP**

You can search Intel® Unison™ on **Google Play** or **App Store** and install the smartphone app.



- 4 Select [Use text code instead] on the Intel® Unison™ app on the smartphone, and scan the [Pair your phone and PC] QR code to connect the PC and smartphone.



### Touring Intel® Unison™

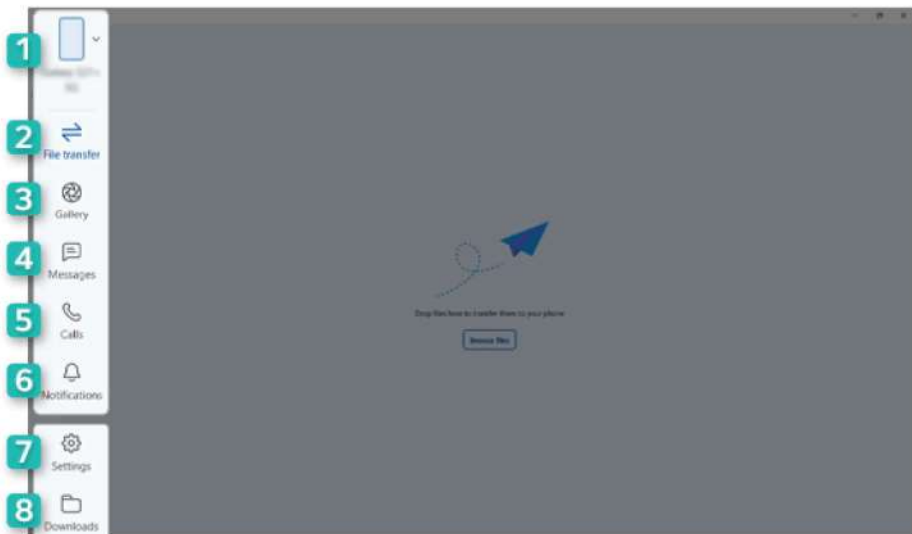

- 1 **Device:** You can check the battery level of your smartphone or set the Do Not Disturb mode, or disconnect the device.
- 2 **File transfer:** You can easily send files from the PC to your smartphone.
- 3 **Gallery:** You can check photos and videos saved on your smartphone, or share the photos and videos between the PC and smartphone.
- 4 **Messages:** Allows you to send and receive text messages.
- 5 **Calls:** Allows you to browse the contacts stored in your smartphone and send text or make a phone call to the contacts.
- 6 **Notifications:** Allows you to check smartphone notifications.
- 7 **Settings:** Allows you to change the settings related to common, notifications, messages, and calls, and can check the app information. (iPhone does not support message-related settings.)
- 8 **Downloads:** Allows you to check the file sent from the smartphone to the PC.

# Recovering the System

## Backing up/Recovering My Windows

You can back up and recover the disk partition where Windows is installed.

**This content only applies to the models provided with LG Update & Recovery.**



### CAUTION

Partitions other than the disk partition where Windows is installed are not backed up.  
For backup or recovery, the AC adapter must be connected to the PC.



### TIP

You can perform backup only on an external disk (USB memory, HDD, etc.).

### My Windows Backup

- 1 Connect the external disk where the backup file will be saved to the PC.
- 2 Select the Start button [  ] > [All apps] and run [LG Update & Recovery].
- 3 Select [Backup] > [My Windows Backup] > [OK] to reboot the PC.



- 4 When the [LG Recovery] screen appears, check the language you want to use and select [Next].

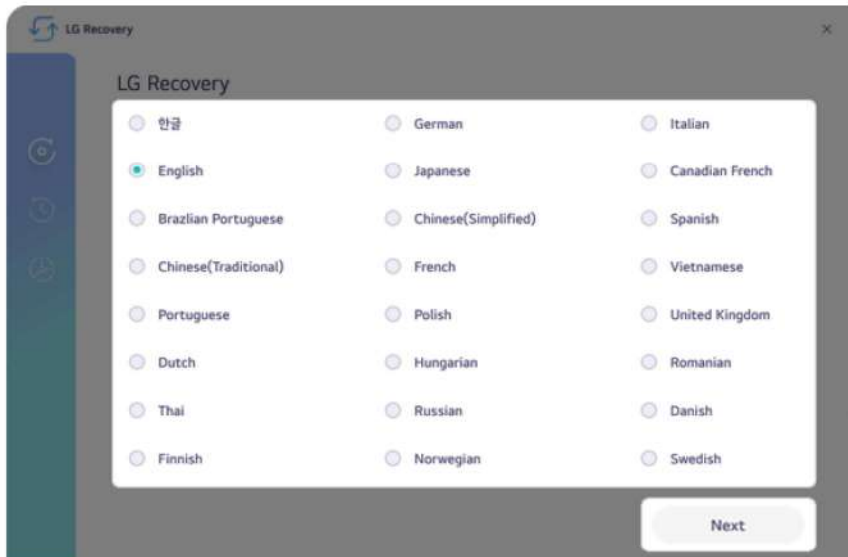

- 5 Select [Backup] > [My Windows Backup].
- 6 Select the external disk and click [OK].

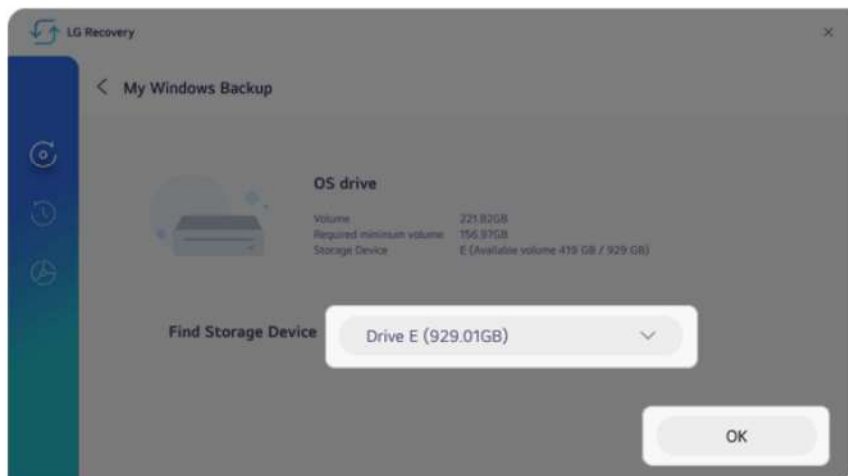

- 7 When the backup is complete, click [OK].
- 8 Select the Exit button [ X ] to reboot the PC.

### My Windows Recovery



#### CAUTION

All user data on the partition where Windows is installed will be deleted, so you must backup all important data in advance.

- 1 Connect the external disk where the backup file is saved to the PC.
- 2 Select the Start button [  ] > [All apps] and run [LG Update & Recovery].
- 3 Select [Recovery] > [My Windows Recovery] > [OK] to reboot the PC.
- 4 When the [LG Recovery] screen appears, check the language you want to use and select [Next].

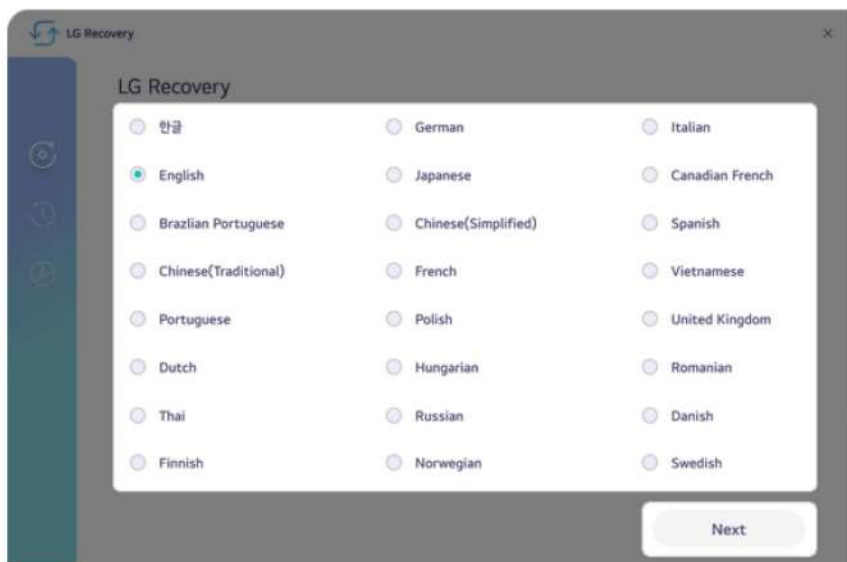

- 5 Select [Recovery] > [My Windows Recovery].

- 6 Select the backup file on the external disk and click [OK].

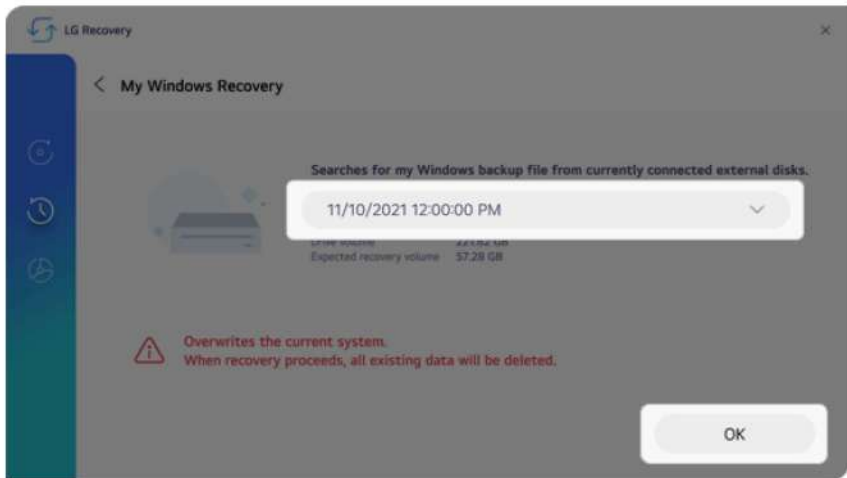

- 7 When the recovery is complete, click [OK].
- 8 Select the Exit button [X] to reboot the PC.

## Backing up/Recovering Disk

You can back up and recover the entire disk (all partitions) where Windows is installed.

**This content only applies to the models provided with LG Update & Recovery.**



### CAUTION

For backup or recovery, the AC adapter must be connected to the PC.



### TIP

You can perform backup only on an external disk (USB memory, HDD, etc.).

### Disk Backup

- 1 Connect the external disk where the backup file will be saved to the PC.
- 2 Select the Start button [  ] > [All apps] and run [LG Update & Recovery].
- 3 Select [Backup] > [Disk Backup] > [OK] to reboot the PC.
- 4 When the [LG Recovery] screen appears, check the language you want to use and select [Next].

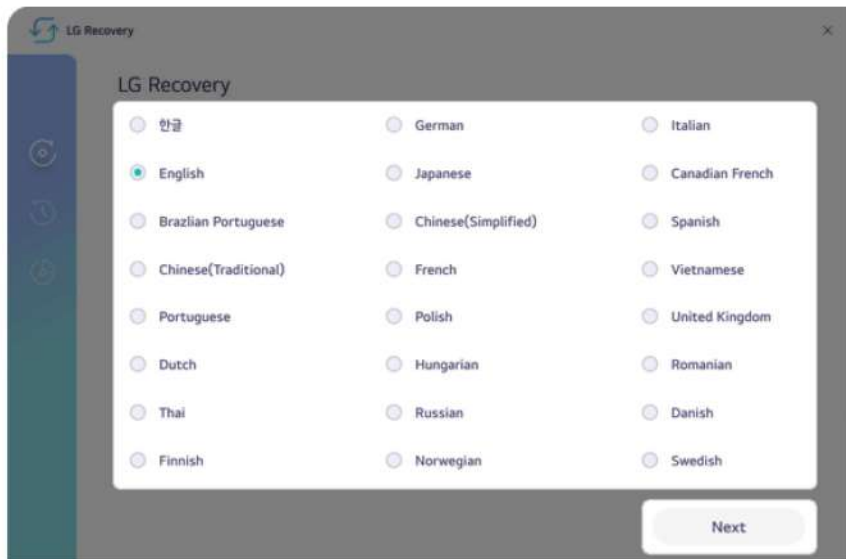

- 5 Select [Backup] > [Disk Backup].
- 6 Select the external disk and click [OK].

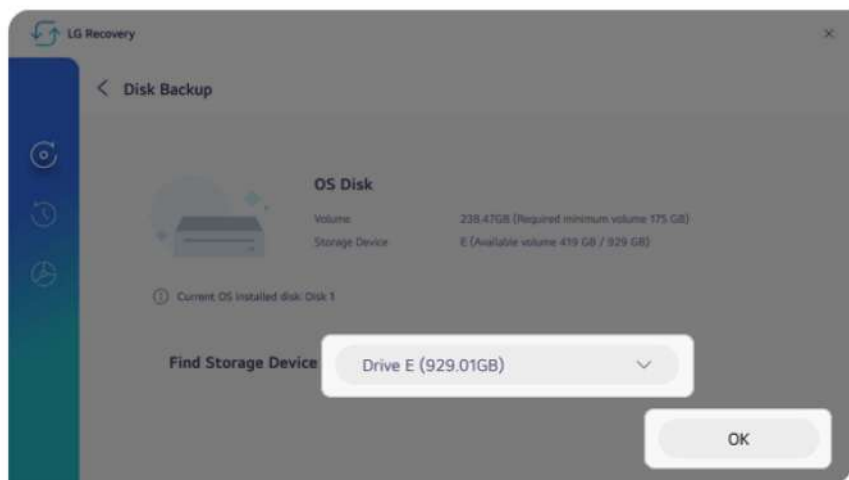

- 7 When the backup is complete, click [OK].
- 8 Select the Exit button [X] to reboot the PC.

### Disk Recovery



#### CAUTION

All user data on the disk to be recovered will be deleted, so you must back up all important data in advance.

Recovering a disk other than the one where Windows is installed will result in the deletion of user data on all disks.

- 1 Connect the external disk where the backup file is saved to the PC.
- 2 Select the Start button [Windows logo] > [All apps] and run [LG Update & Recovery].
- 3 Select [Recovery] > [Disk Recovery] > [OK] to reboot the PC.

- 4 When the [LG Recovery] screen appears, check the language you want to use and select [Next].

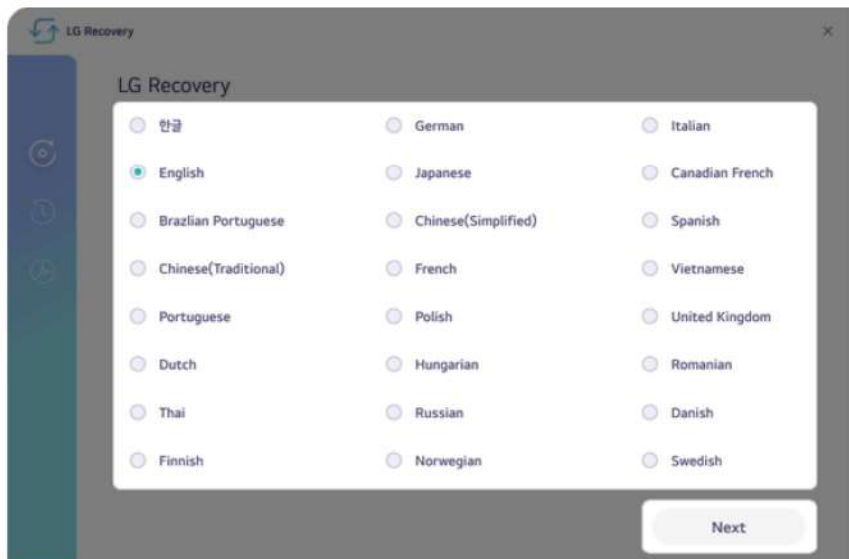

- 5 Select [Recovery] > [Disk Recovery].

- 6 Select the backup file on the external disk and the disk to recover, and click [OK].

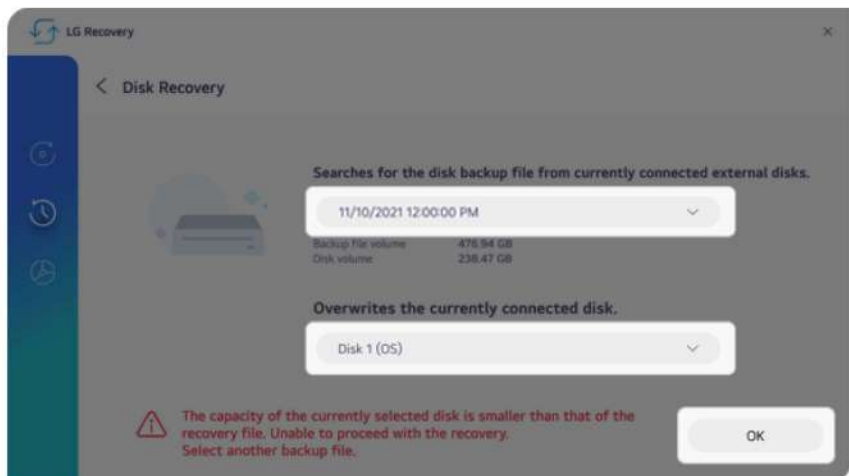

- 7 When the recovery is complete, click [OK].
- 8 Select the Exit button [  ] to reboot the PC.

## Backing up/Recovering Data

You can back up and recover the data in the Downloads, Videos, Documents, Desktop, Photos and Music folders in Windows.

**This content only applies to the models provided with LG Update & Recovery.**



### CAUTION

Any data other than those in these folders are not backed up/recovered.

All user data on the disk to be recovered may be deleted, so you must back up all important data in advance.

For backup or recovery, the AC adapter must be connected to the PC.



### TIP

You can perform backup only on an external disk (USB memory, HDD, etc.).

### Data Backup

- 1 Connect the external disk where the backup file will be saved to the PC.
- 2 Select the Start button [  ] > [All apps] and run [LG Update & Recovery].
- 3 Select [Backup] > [Data Backup].
- 4 Select the external disk and click [OK].

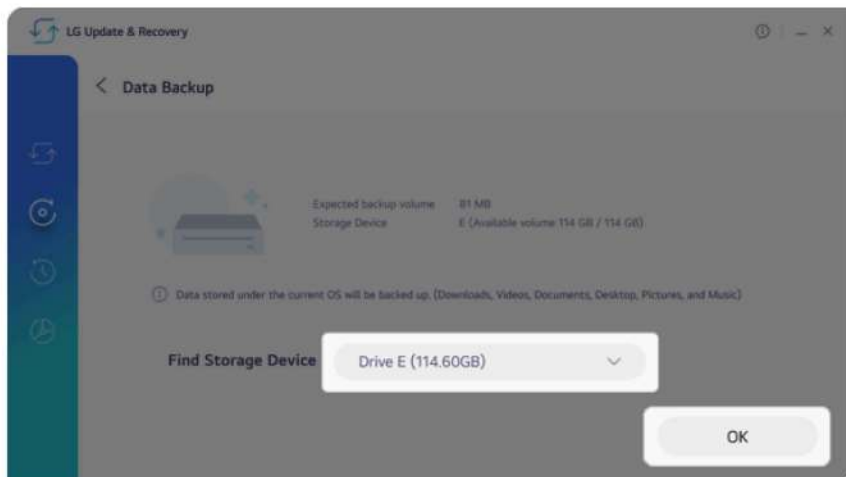



- 5 When the backup is complete, click [OK].

### Data Recovery

- 1 Connect the external disk where the backup file is saved to the PC.
- 2 Select the Start button [  ] > [All apps] and run [LG Update & Recovery].
- 3 Select [Recovery] > [User Data Recovery].
- 4 Select the backup file on the external disk and click [OK].

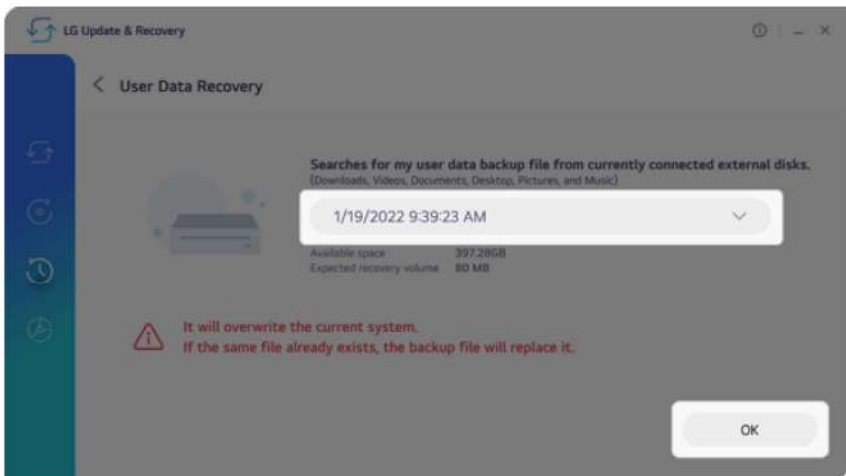

- 5 When the recovery is complete, click [OK].

## Factory Reset

This function resets your PC to the factory default state at the time of purchase.

**This content only applies to the models provided with LG Update & Recovery.**



### CAUTION

All data is lost during the initialization so you must backup all critical data in advance.  
For factory reset, the AC adapter must be connected to the PC.

- 1 Select the Start button [  ] > [All apps] and run [LG Update & Recovery].
- 2 Select [Recovery] > [Factory Reset] > [OK] to reboot the PC.
- 3 When the [LG Recovery] screen appears, check the language you want to use and select [Next].

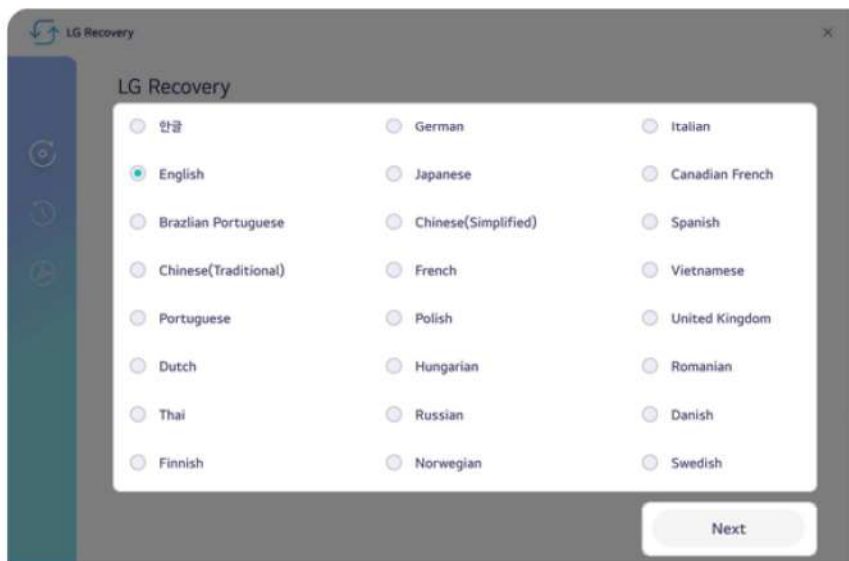

- 4 Select [Recovery] > [Factory Reset] > [Next] to execute the factory reset.

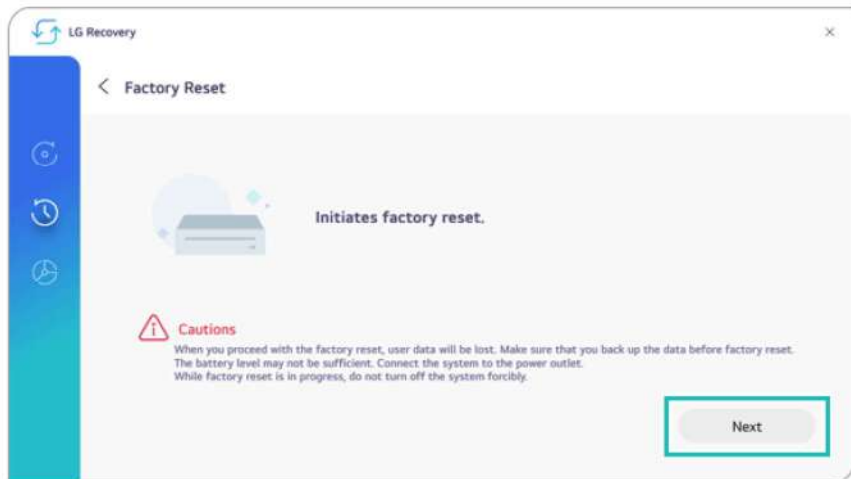

- 5 When the factory reset is complete, click [OK] to reboot the PC.

## Creating Recovery Disk

Once you create a recovery disk, you can use **LG Recovery** to recover the system even when the system fails to boot due to a problem.

**This content only applies to the models provided with LG Update & Recovery.**



### CAUTION

Creating a recovery disk will delete all data on the external disk, so please back up important data in advance.



### TIP

You can create the recovery disk only on an external disk (USB memory, HDD, etc.).

- 1 Select the Start button [  ] > [All apps] and run [LG Update & Recovery].
- 2 Select [Recovery] > [Create Recovery Disk].
- 3 Select the external disk and click [OK].

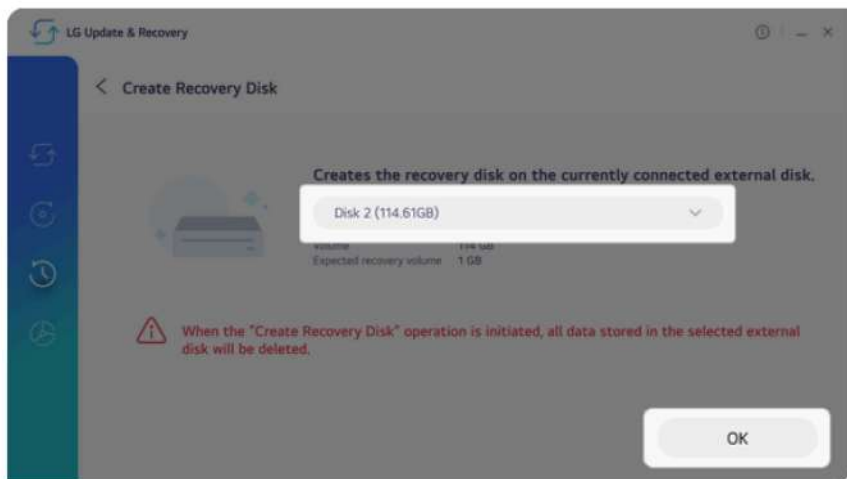

- 4 Once the recovery disk has been created, click [OK].

## Recovering from a Boot Failure

If the system cannot boot due to a serious error with the system, you can recover the system using the method shown below.

**This content only applies to the models provided with LG Update & Recovery.**



### CAUTION

All data is lost during the initialization so you must backup all critical data in advance.

For recovery, the AC adapter must be connected.

If you have deleted the recovery data in the protected area of the hard disk, the recovery function may not work.



### TIP

You can create the recovery disk only on an external disk (USB memory, HDD, etc.).

- 1 Turn on the PC and press [F11] multiple times.
- 2 When the **[LG Recovery]** screen appears, check the language you want to use and select [Next].

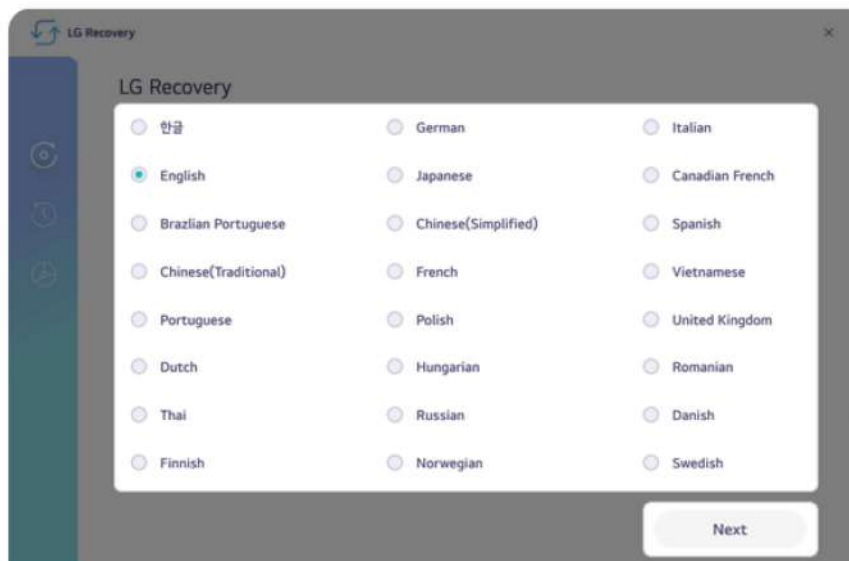

- In [Recovery], select the desired recovery method to recover the system.

**Tip**

[My Windows Recovery] or [Disk Recovery] can be performed only when you have the backup data. If you have no backup data, you can recover it through [Factory Reset].

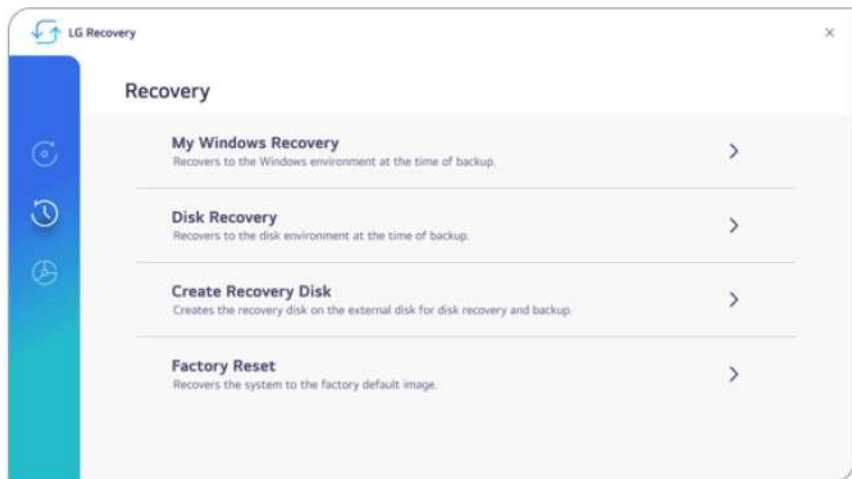

### Using Recovery Disk

If you can't execute **LG Recovery**, you can recover your system with a recovery disk.

- Connect the recovery disk to your PC.
- Turn on the PC and press [F10] multiple times.
- When the screen for selecting the boot device appears, select the connected recovery disk and press [Enter].

- 4 When the [LG Recovery] screen appears, check the language you want to use and select [Next].

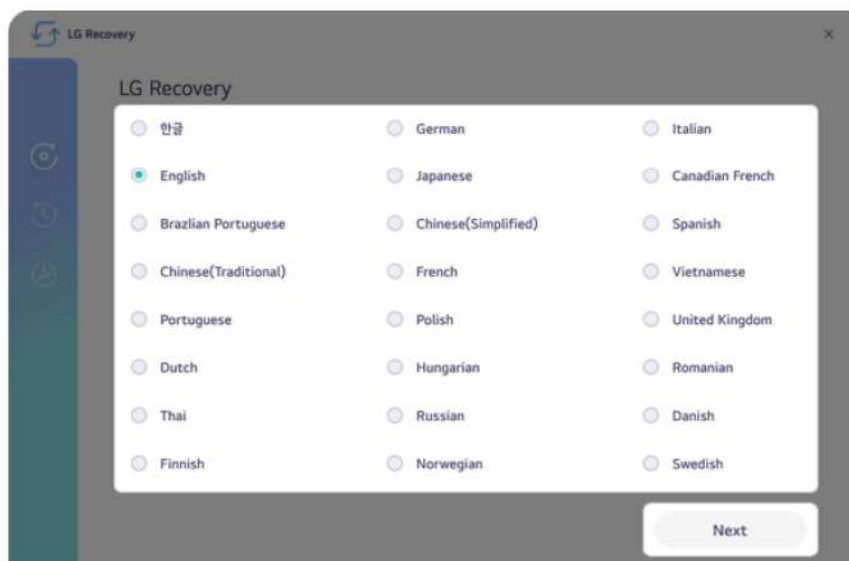

- 5 In [Recovery], select the desired recovery method to recover the system.

**Tip**

[My Windows Recovery] or [Disk Recovery] can be performed only when you have the backup data. If you have no backup data, you can recover it through [Factory Reset].

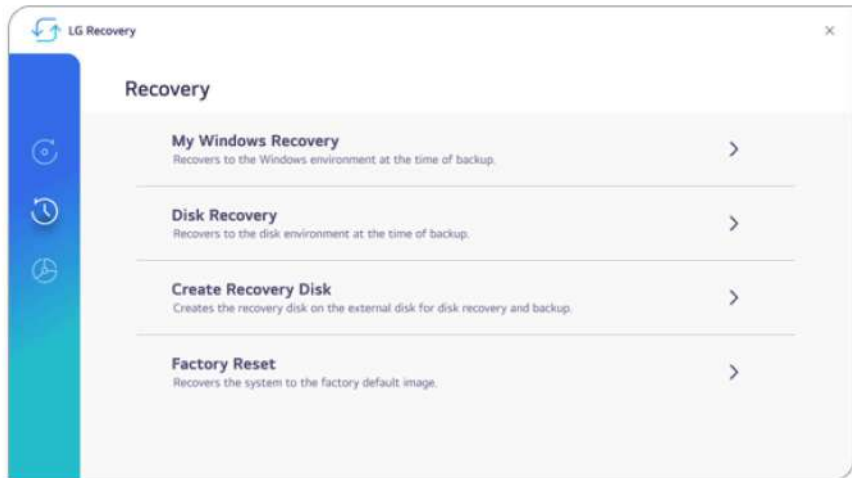



# Setup and Upgrade

## Installing the Driver

The figures herein may differ by language selection and are subject to change without prior notice.

Using **LG Update & Recovery** (or **LG Update**) to Install the Drivers

- 1 Select the Start button [  ] > [All apps] and run [ **LG Update & Recovery** ] or [ **LG Update** ].
- 2 Select [ **Required Updates** ] or [ **Update List** ] to install the driver.

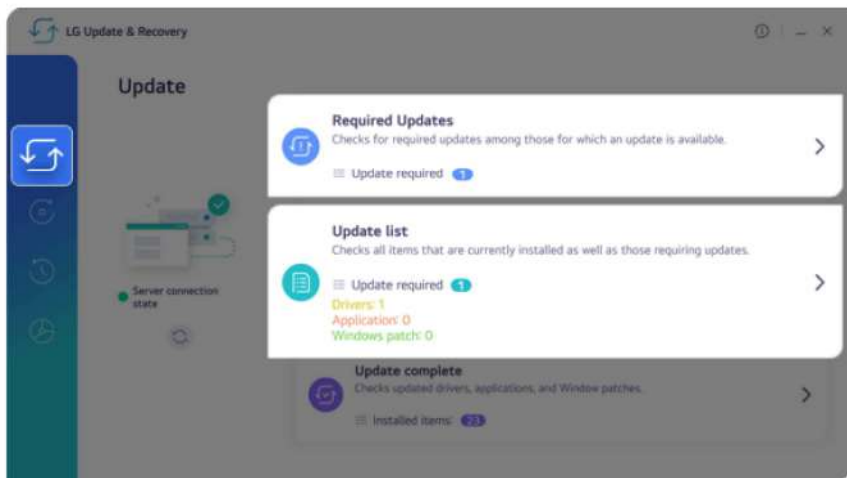

### Tip TIP

You can use **LG Update & Recovery** (or **LG Update**) to install the deleted drivers or the latest drivers easily and quickly.

Use **LG Update & Recovery** (or **LG Update**) to keep your system current and optimized.

Downloading **LG Update & Recovery** (or **LG Update**)

You can download and install **LG Update & Recovery** (or **LG Update**) from LG Electronics' website ([www.lg.com](http://www.lg.com)).

## Starting System Setup

System setup means storing the hardware configuration information of the PC in the flash memory. Through system setup, the PC retrieves various information including current date and time, memory capacity, and storage device (HDD, SSD, eMMC) capacity and type.

You setup the system when you set passwords, change the boot order, and add new peripheral devices to the machine.

**Items displayed on the Setup screen may differ by model type and specification.**

 **TIP**

To use the system setup (F2), booting device selection (F10), or recovery (F11), you need to restart the system (click [Restart] in the system power menu) and then immediately press the corresponding function key due to the fast booting speed.

 **CAUTION**

- Do not change the system setup unless necessary. Incorrect system setup may cause errors during system operation. Use caution when changing the system setup.
- For performance improvement, the system setup menu configuration and the initial setup status may be changed and may become different from images included in the user manual.

- 1 Reboot the system and press [F2] multiple times.



- 2 In a few moments, the system setup screen appears.



### Keys Used in System Setup

Keys	Function
Enter	Selects the current item.
Esc	To deselect the current item or to move to the previous screen.
▲, ▼, ◀, ▶ (Arrow keys)	Moves the cursor up, down, left, and right.
F5, F6	Increases or decreases the item value.
F10	Saves the new settings or exits the system setup.

## Setting the Boot Password

This process is to set a password so that other people cannot use the computer or change the settings.

The user can set a password while booting the system or setting up the system.

**The model in the example can differ from actual models and is subject to change for performance improvements, without prior notice.**



### CAUTION

Without the registered password, access to the system will be denied. Write down and keep the password in a safe place.

### Set Supervisor Password

The password prevents unauthorized people from accessing the PC. By default, no password is set for the machine. If an unauthorized person changes the password in the System Setup, you will be unable to access the system.



### TIP

With **[Set Supervisor Password]**, you are authorized to set all items in the System Setup and to set **[Power on Password]**. In case other people also use the computer, it is recommended to set the **[Set User Password]**.

- 1 Reboot the system and press [F2] multiple times.



- 2 When the System Setup screen appears, go to **[Security]** > **[Set Supervisor Password]** using the arrow keys and press the [Enter] key.



- 3 When the Password Setting screen appears, enter a password and press the [Enter] key. The password should not exceed 20 characters and should consist of English letters (A - Z), numbers (0 - 9), and special characters or a combination of them.



- 4 Enter the password once more and press the [Enter] key.



- 5 To save the changes in system setup, press [F10]. When a pop-up window appears, select **[Yes]** and press the [Enter] key.



- 6 The PC will restart.

### Set User Password

The password set in **[Set User Password]** is of a lower level than the one set in **[Set Supervisor Password]**, so you can set a user password only after setting a password in **[Set Supervisor Password]**.

**Tip** TIP

**[Set User Password]** allows limited access to the items in the System Setup screen compared to the **[Set Supervisor Password]** items.

- Execute the System Setup screen, go to **[Security]** > **[Set User Password]** using the arrow keys and press the **[Enter]** key.



- When the Password Setting screen appears, enter a password and press the **[Enter]** key. The password should not exceed 20 characters and should consist of English letters (A - Z), numbers (0 - 9), and special characters or a combination of them.



- Enter the password once more and press the **[Enter]** key.



- To save the changes in system setup, press [F10]. When a pop-up window appears, select **[Yes]** and press the [Enter] key.



- The PC will restart.

### Power on Password

**[Power on Password]** protects your system by requiring during booting to enter the password set in **[Set Supervisor Password]** or **[Set User Password]**.

To set **[Power on Password]**, you first need to set **[Set Supervisor Password]** or set both **[Set Supervisor Password]** and **[Set User Password]**.

- Execute the System Setup screen, go to **[Security]** > **[Power on Password]** using the arrow keys and press the [Enter] key.



- Select **[Enabled]** and press the [Enter] key to complete the **[Power on Password]** setting.



## Set PCIE SSD Password

[Set PCIE SSD Password] is to set the password directly on the storage device separately from [Set Supervisor Password].

### Tip

- Some models with built-in **PCIE SSD** may not support the password setting function.
- For the models equipped with two storage devices, you can set a password for each device. If passwords are set for both devices, the password input window appears twice during the booting process. The order in which the password input windows appears is according to the [Boot Type Order] of the [Boot] menu.
- For the models equipped with two storage devices, the menu names are shown as PCIE SSD1, PCIE SSD2, etc.



### CAUTION

If you lose the password for a storage device, you cannot recover the storage device.

- Please note that replacement of a storage device due to the loss of the password of the storage device is excluded from the product warranty.

- 1 Execute the System Setup screen, go to [Security] > [Set PCIE SSD1 Password] using the arrow keys and press the [Enter] key.



- When the Password Setting screen appears, enter a password and press the [Enter] key. The password should not exceed 32 characters and should consist of English letters (A - Z), numbers (0 - 9), and special characters or a combination of them.



- Enter the password once more and press the [Enter] key.



- To save the changes in system setup, press [F10]. When a pop-up window appears, select **[Yes]** and press the [Enter] key.



- The PC will restart.

## Deleting/Changing the Boot Password

You can delete or change the password only after entering the current password.

**The model in the example can differ from actual models and is subject to change for performance improvements, without prior notice.**

### Changing the Boot Password

- 1 Execute the System Setup screen, enter the password, and press the [Enter] key.



- 2 Change the password in the same way as setting one.

### Deleting the Boot Password

- 1 Execute the System Setup screen, enter the password, and press the [Enter] key.

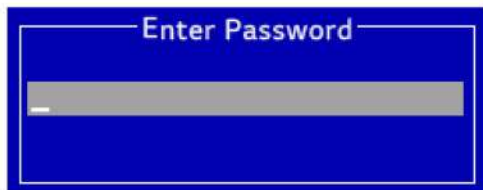

- 2 When the System Setup screen appears, go to **[Security]** > **[Set Supervisor Password]** using the arrow keys and press the **[Enter]** key.



- 3 Enter the current password in the **[Enter Current Password]** field.



- 4 Press the **[Enter]** key in the **[Create New Password]** field.



- 5 When a pop-up window appears, select **[Yes]** and press the **[Enter]** key.



- 6 To save the changes in system setup, press **[F10]**. When a pop-up window appears, select **[Yes]** and press the **[Enter]** key.



- 7 The PC will restart.

#### Deleting the Boot Password (Set PCIE SSD Password)

- 1 Execute the System Setup screen, enter the password, and press the **[Enter]** key.



- 2 When the System Setup screen appears, go to **[Security]** > **[Set PCIE SSD1 Password]** using the arrow keys and press the [Enter] key.

**Tip**

- For the models equipped with two storage devices, the menu names are shown as PCIE SSD1, PCIE SSD2, etc.



- 3 Enter the current password in the **[Enter Current Password]** field.



- 4 Press the [Enter] key in the **[Create New Password]** field.



- 5 When a pop-up window appears, select **[Yes]** and press the [Enter] key.



- 6 To save the changes in system setup, press [F10]. When a pop-up window appears, select **[Yes]** and press the [Enter] key.



- 7 The PC will restart.

## Initializing System Setup

If you have changed the system setup by mistake, you can restore the default settings.

**The model in the example can differ from actual models and is subject to change for performance improvements, without prior notice.**

- 1 Execute the System Setup screen, go to **[Exit]** > **[Load Setup Defaults]** using the arrow keys and press the **[Enter]** key.

**Tip** **TIP**

You can press the **[F9]** key to use the **[Load Setup Defaults]** item.

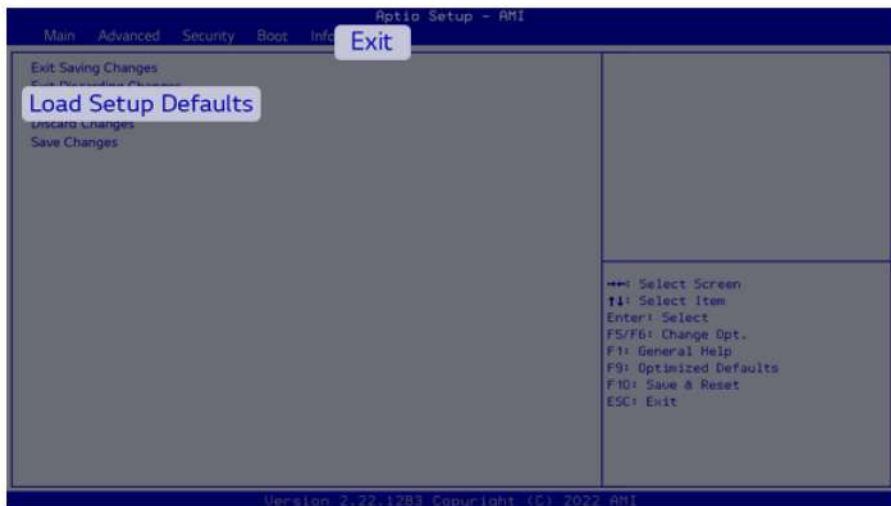

- 2 When a pop-up window appears, select **[Yes]** and press the **[Enter]** key. The settings will be reset to the factory default.

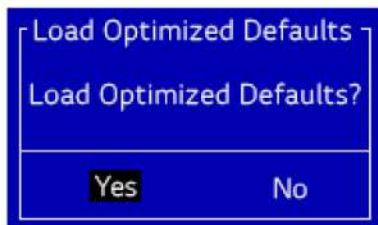



- To save the changes in system setup, press [F10]. When a pop-up window appears, select **[Yes]** and press the [Enter] key.



- The PC will restart.

## Changing the Boot Order

The user can change the boot order according to his or her needs, or select a boot device

**The model in the example can differ from actual models and is subject to change for performance improvements, without prior notice.**

**TIP**

To use the system setup (F2), booting device selection (F10), or recovery (F11), you need to restart the system (click **[Restart]** in the system power menu) and then immediately press the corresponding function key due to the fast booting speed.

### Changing the Boot Order

- 1 Reboot the system and press [F2] multiple times.



- 2 Go to the **[Boot]** menu using the arrow keys when the system setup screen appears.

- Go to **[Boot Type Order]** and press **[F5]** or **[F6]** to change the booting order.

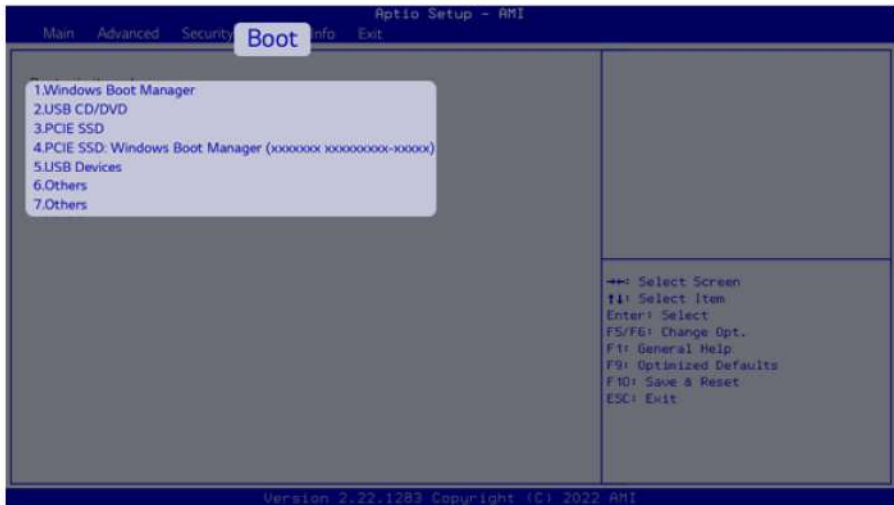

- To save the changes in system setup, press **[F10]**. When a pop-up window appears, select **[Yes]** and press the **[Enter]** key.

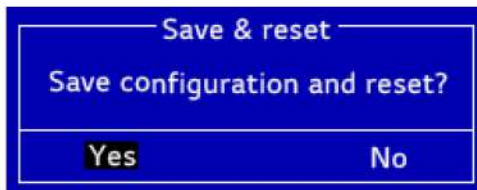

- The PC will restart.

## Selecting a Booting Device to Use

- 1 Reboot the system and press [F10] multiple times.



- 2 When the Select Boot Device screen appears, go to the desired device using the arrow keys and press the [Enter] key.

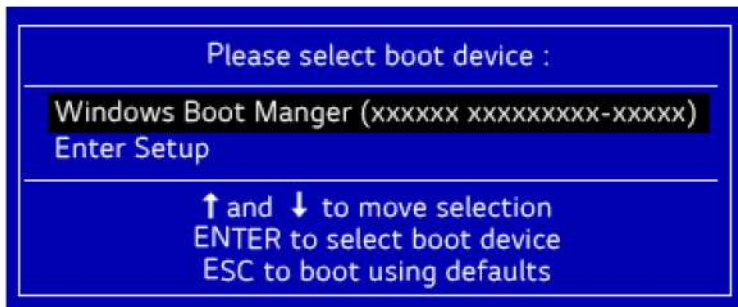

- 3 Boots using the selected device.

## Setting Auto Scaling

The Windows **Auto Scaling** feature for user's convenience may partially blur the screen or display some icons and texts larger.

Refer to the following information to change the DPI scaling to suit your needs.

- 1 Select the Start button [  ] > [Settings].

**Tip** TIP

Press the [  ] key or [Ctrl] + [Esc] on the keyboard to display the Start screen.

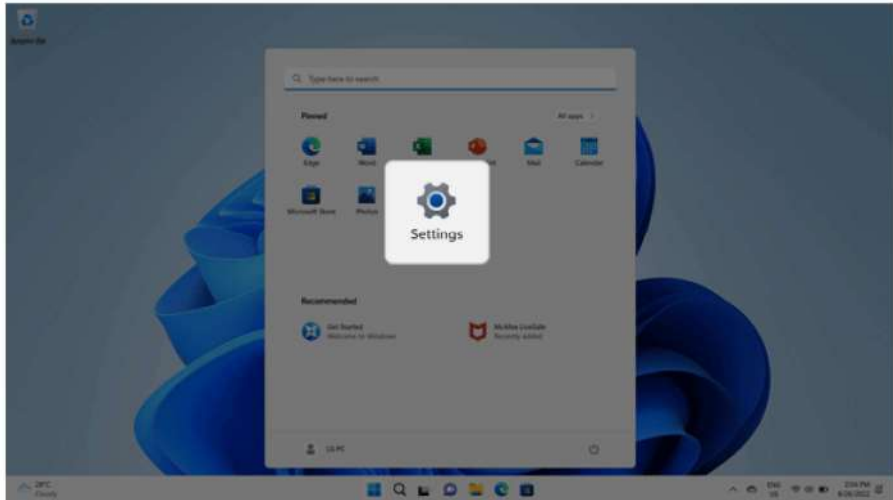

- 2 Select [System] > [Display].

### 3 Changing the [Scale] item value changes the auto scaling settings.

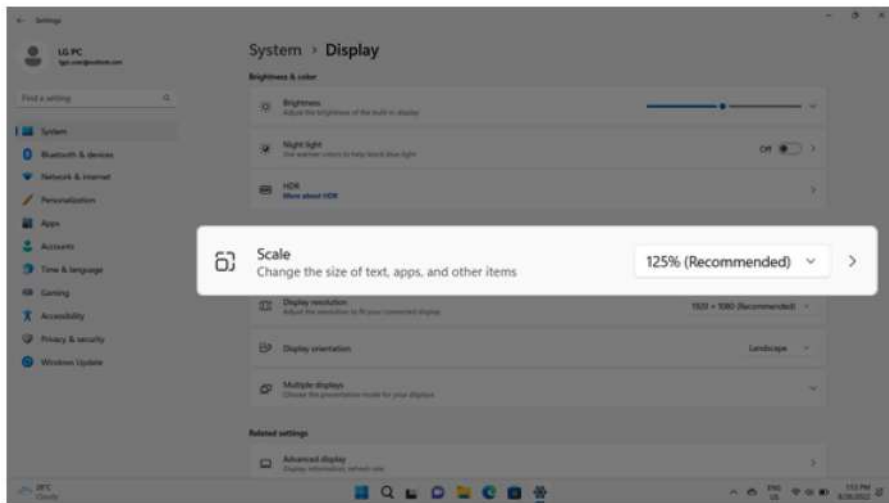
**Tip** TIP

After changing the Auto Scaling settings, some apps must be shut down and restarted for the scaling and layout to take effect.

## Using Instant Booting

**Instant Booting** allows the system to boot automatically when the notebook PC cover is opened, so that you can use the system without pressing the power button.

- 1 Select the Start button [  ] > [All apps] and run [LG Smart Assistant].
- 2 Turn on [Instant Booting].

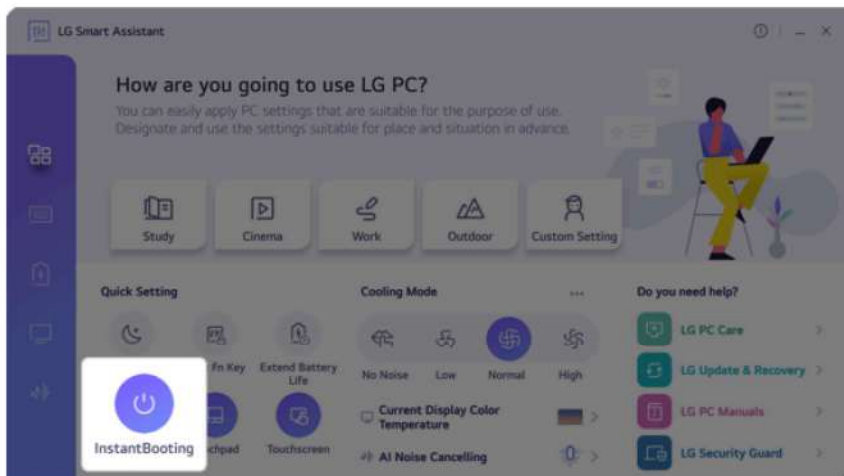

- 3 Shutdown the system and close the notebook PC cover.
- 4 When the cover is opened, the notebook PC turns on and the system starts to boot automatically.

## FAQ

### Using USB-C™ (Thunderbolt™) Charging Function

You can connect the USB-C™ device to charge a notebook PC battery or an external device, and the operation mode is automatically selected depending the charge settings of the connected device.

- To charge a notebook PC battery, the external device (USB PD Charger, notebook PC, etc.) should support USB Power Delivery 10 W (5 V / 2 A) or higher profile.
  - The external devices that use the USB-C™ port support 10 W (5 V / 2 A) and 15 W (5 V / 3 A).
  - A USB device compatible with USB PD (Power Delivery) supports charging at 15 W (5 V / 3 A), whereas a regular USB device supports charging at 10 W (5 V / 2 A).
  - USB PD batteries cannot be charged using the USB-C™ port of the notebook PC.
  - Always-On Charging is supported only with USB-C™ ports, but not with the regular USB ports.
  - If you connect an adapter with a lower output than the rated adapter, it may take more time to charge the notebook PC.
- 1 When the connected device is set to Automatic (charging the notebook PC or a connected device. Charging the notebook PC by using the mobile phone is not supported.)



- 2 When the connected device is set to Source (the notebook PC is charged.)





- 3 When the connected device is set to Sink (the connected device is charged.)



**TIP**

The charging status of the external device being charged is not displayed on the notebook PC. If you connected a smartphone, you should select "Charge mobile phone" on the smartphone screen to charge the phone battery.

**CAUTION**

If the power consumption of the notebook PC is larger than the power supply from the external device, the battery may be consumed gradually.

## LG Smart Assistant

**LG Smart Assistant** allows you to easily change the settings of your PC according to your needs.

**TIP**

**LG Smart Assistant** can be re-installed through **LG Update & Recovery** (or **LG Update**).

Menus and supported functions may differ depending on the model.

Please update the program to the latest version through **LG Update & Recovery** (or **LG Update**).

The figures herein are subject to change without prior notice.

### Running LG Smart Assistant

Select the Start button [  ] > [All apps] and run [LG Smart Assistant].

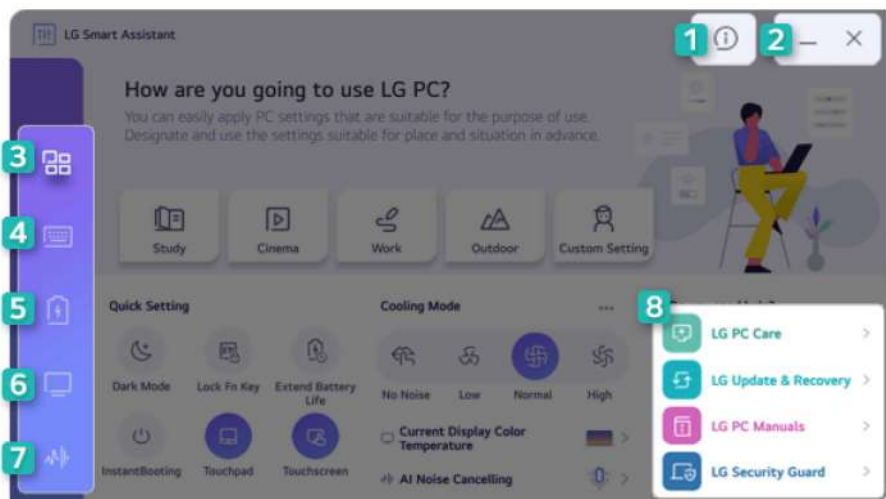

- 1 Information Button:** Runs Help or displays information about the software.
- 2 Minimize/Exit Button:** Minimizes the size of the window or closes the program window.
- 3 Dashboard:** Allows you to specify PC settings suitable for the purpose of use and apply them at once, or to set key PC functions easily.
- 4 Keyboard Setting:** Allows you to set the functions related to the keyboard such as keyboard lighting and shortcuts.

- 5 **Power Setting:** Allows you to check the battery status and extend the battery life, set the power and sleep settings, and set the USB-C™ port charging function.
- 6 **Display Setting:** Allows you to set the functions related to the display such as display color temperature and Reader Mode.
- 7 **AI Noise Cancelling:** Allows you to set the noise cancelling function for the microphone input and the speaker output.
- 8 **Go to LG Software:** Allows you to run LG PC Care, LG Update & Recovery (or LG Update), LG PC Manuals, and LG Security Guard directly.

## Dashboard

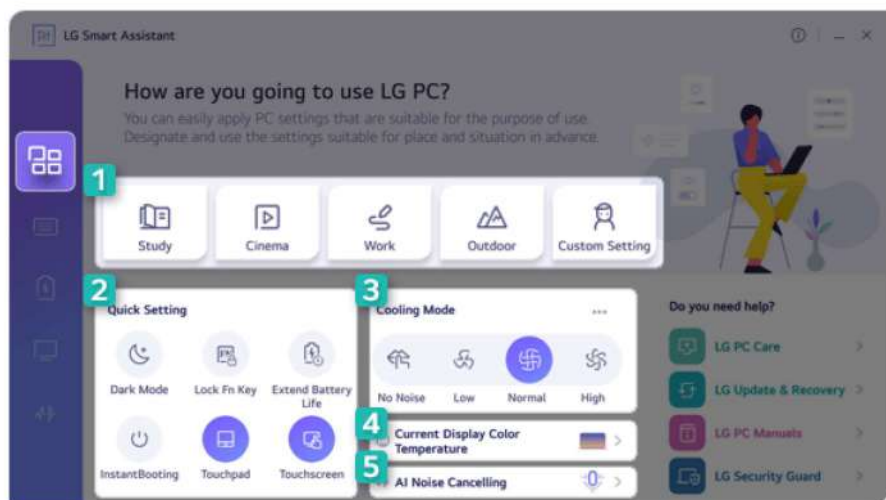

- 1 **User Mode:** Allows you to set the user mode according to the PC environment.
- 2 **Quick Setting:** Allows you to set the PC settings easily.
  - **Dark Mode:** Allows you dim the colors displayed on Windows and the app.
  - **Lock Fn Key:** Allows you to set the hot keys (F1 - F12) to operate even without pressing Fn.
  - **Extend Battery Life:** Allows you to lower the max. battery charge level to 80% to extend the battery lifespan.
  - **Instant Booting:** Allows you to set the system to turn on automatically when you open the cover of the notebook PC.
  - **Touchpad:** Allows you to turn off or on the touchpad.
  - **Touch Screen:** Allows you to turn off or on the touch screen.

- 3 **Cooling Mode:** Allows you to set the fan mode of the PC according to the PC environment.
- **No Noise Mode:** Limits the PC performance so that the PC does not generate fan noise. (The PC surface temperature may rise when the function is used for a long time. It automatically changes to the **Normal Mode** upon reboot.)
  - **Low Mode:** Minimizes fan speed so that you can use the PC in a quiet environment. (This may degrade your PC performance. It automatically changes to the **Normal Mode** upon reboot.)
  - **Normal Mode:** Optimizes PC performance, heat and noise.
  - **High Mode:** Sets to the tasks that require high performance. (This may result in increased PC surface temperature and noise, and shorter battery life. It automatically changes to the **Normal Mode** upon reboot.)

**CAUTION**

When using for a long term, use **Normal Mode**.

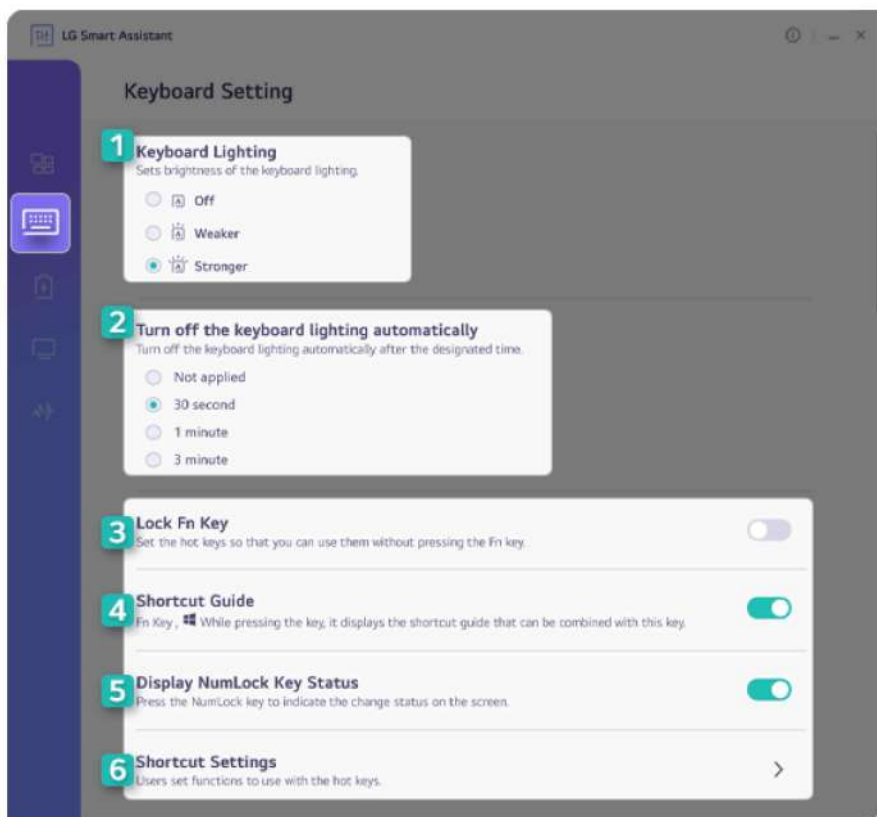

- 4 **Current Display Color Temperature:** Go to the [Display Setting] menu.
- 5 **AI Noise Cancelling:** Go to the [AI Noise Cancelling] menu.

## Keyboard Setting



- 1 Keyboard Lighting:** Allows you to set the keyboard lighting and brightness.
- 2 Turn off the keyboard lighting automatically:** Allows you to set the keyboard light to turn off automatically after a specified amount of time.
- 3 Lock Fn Key:** Allows you to set the hot keys (F1 - F12) to operate even without pressing Fn.
- 4 Shortcut Guide:** While pressing the Fn key or key, you can set to display the shortcut guide that can be combined with this key.
- 5 Display NumLock Key Status:** Allows you to set the screen to display the status change when you press the NumLock key.

**6 Shortcut Settings:** You can register the app or Internet address to set to use as a shortcut, or check the designated shortcut.

- On the Shortcut Settings List, select the navigation icon [  ] or the internet icon [  ] to register the desired app or Internet address to a shortcut.

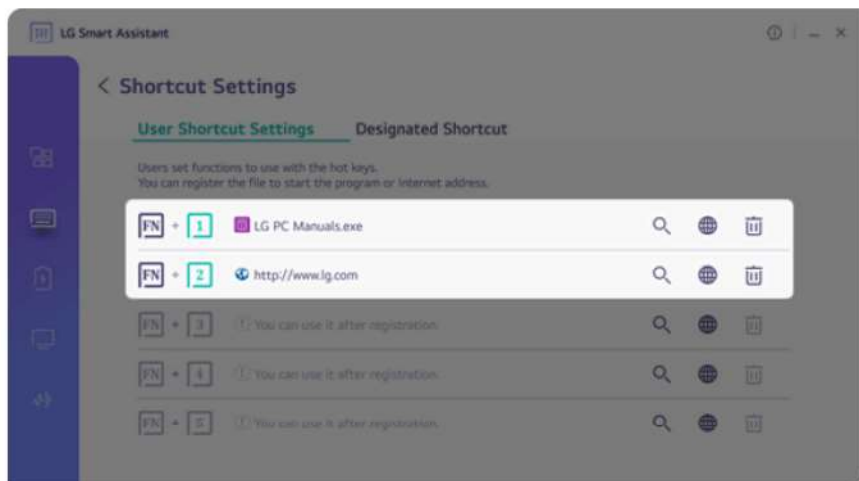

**TIP**

- Some abnormal program files (exes) and Internet addresses (links) may not be linked.
- Shortcuts can be set from 1 to 5, and the designated shortcuts cannot be changed.

- After selecting the app-running file, right-click the mouse and use the [Show more options] > [Set functions to use with user Hot Keys] menu to register the app quickly.

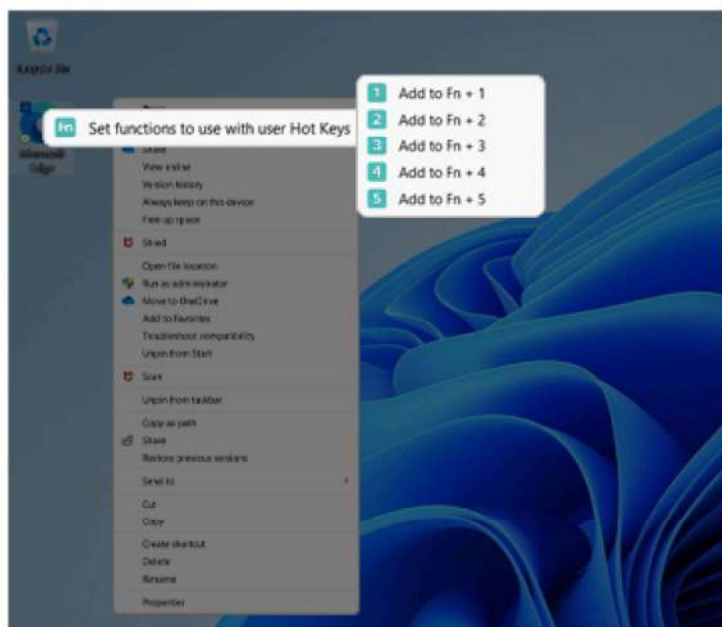

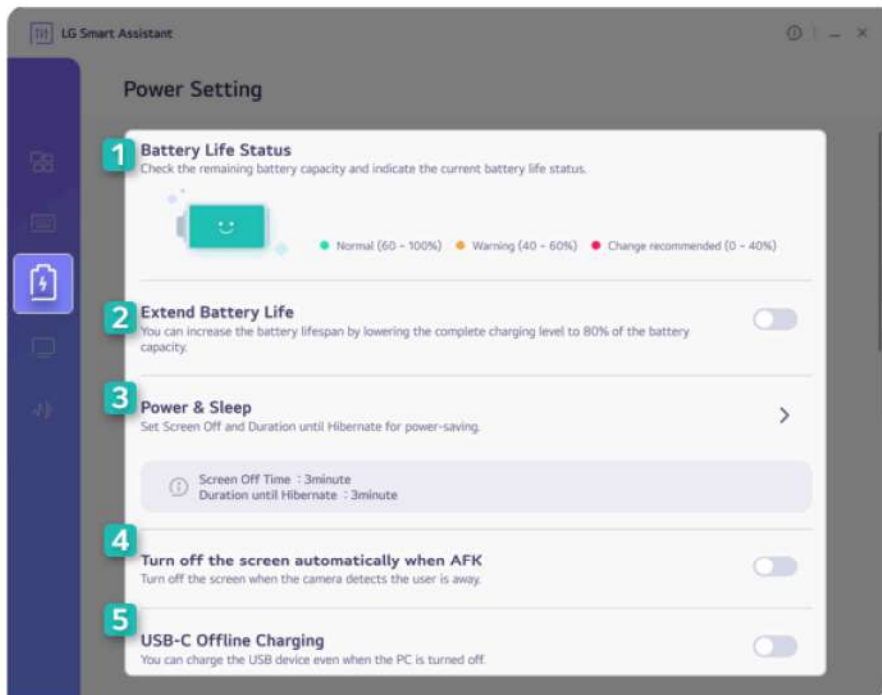

- 1 **Battery Life Status:** Displays the battery status so that you can replace the battery timely.
- 2 **Extend Battery Life:** Allows you to lower the max. battery charge level to 80% to extend the battery lifespan.
- 3 **Power & Sleep:** Displays the screen off time and the sleep mode entry time. You can go to Windows settings and set the time.
- 4 **Turn off the screen automatically when AFK:** Allows you to set the screen to automatically turn off when you are away from the keyboard for a certain amount of time.
- 5 **USB-C™ Offline Charging:** Allows you to set the PC to charge external devices via the USB-C™ port even when the PC is turned off.



## Display Setting

LG Smart Assistant

## Display Setting

- ### 1 Color Temperature Settings

Adjust to an eye-friendly and warm color, or an even more clear and cold color.



Cold Warm

#### Color Temperature Auto Adjustment

Set to the color temperature optimized for this display automatically.
- ### 2 Reader Mode

Set to the screen color that reduces eye fatigue.
- ### 3 Professional Mode

By applying the ICC profile, it provides a more expanded color range.
- ### 4 Connecting to Simple Display

Through the menu drawn on the screen while connecting the external display, you can easily switch to the extension mode or other modes.

#### Setting with Mouse Pointer

If you place the mouse pointer in the middle of each edge, the menu that can extend or copy the external display is displayed.
- ### 5 Applying Lively Theme

Provides a lively background exclusive to LG PC. Battery consumption may be fast and resource consumption may occur depending on PC specifications. If the Power Saving Mode is on, the operation stops.

#### Changing LG Theme

You can set various themes provided by LG PC easily and quickly. >



#### Select operation in the charging status

  - Disable
  - Play once when starting Windows
  - Continuous Operation

#### Select operation in the battery status

  - Disable
  - Play once when starting Windows
  - Continuous Operation

- 1 **Color Temperature Settings:** Allows you to adjust the screen color temperature to cool (bluish screen color) or warm (reddish screen color) or use the automatic color temperature function.
- 2 **Reader Mode:** Allows you to set the Reader Mode to reduce eye fatigue when reading documents.

**CAUTION**

Using the **Reader Mode** and the **Night light** at the same time can cause color distortion. When you use the **Reader Mode**, turn off the **Night light**.

- You can turn [Night light] on or off in the Start button [  ] > [Settings] > [System] > [Display].

**TIP**

You can use hot keys to use the **Reader Mode** function more conveniently.

- Press the [Fn] + [F9] keys to switch the PC screen to **Reader Mode**. Press them again to turn off **Reader Mode**.

- 3 **Professional Mode:** Provides a more extended color gamut to the display and enhances the content color reproduction.

**TIP**

**Professional Mode** uses an ICC profile and works only in some programs.

- 4 **Connecting to Simple Display:** When connecting an external display, you can set to display the menu that can set the Display Mode on the PC screen.
- 5 **Applying Lively Theme:** You can set various themes provided by LG PC or select an operation method of Lively Theme according to the charging status.

## AI Noise Cancelling

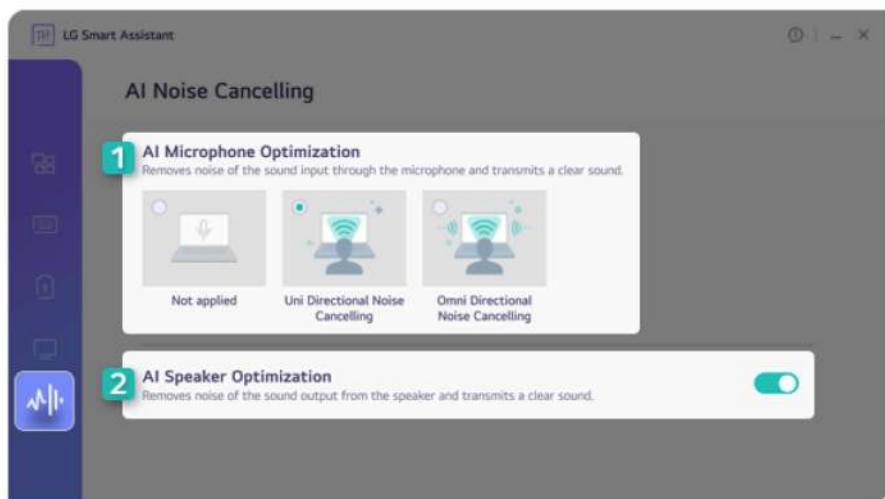

- 1 **AI Microphone Optimization:** Cancels out the noise input to the microphone to deliver clear sound.
- 2 **AI Speaker Optimization:** Cancels the noise output from the speakers to deliver clear sound.

## Backing up/Recovering My Windows

You can back up and recover the disk partition where Windows is installed.

**This content only applies to the models provided with LG Update & Recovery.**



### CAUTION

Partitions other than the disk partition where Windows is installed are not backed up.  
For backup or recovery, the AC adapter must be connected to the PC.



### TIP

You can perform backup only on an external disk (USB memory, HDD, etc.).

### My Windows Backup

- 1 Connect the external disk where the backup file will be saved to the PC.
- 2 Select the Start button [  ] > [All apps] and run **[LG Update & Recovery]**.
- 3 Select [Backup] > [My Windows Backup] > [OK] to reboot the PC.
- 4 When the **[LG Recovery]** screen appears, check the language you want to use and select [Next].

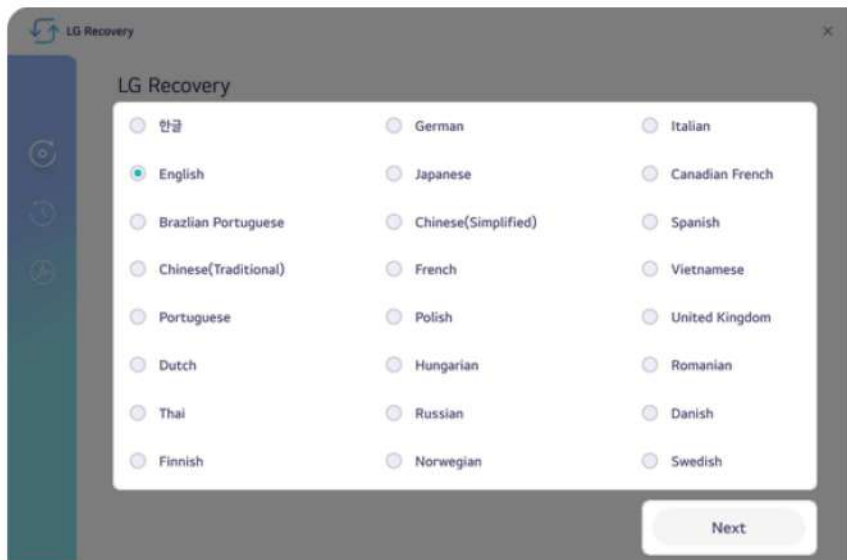

- 5 Select [Backup] > [My Windows Backup].
- 6 Select the external disk and click [OK].

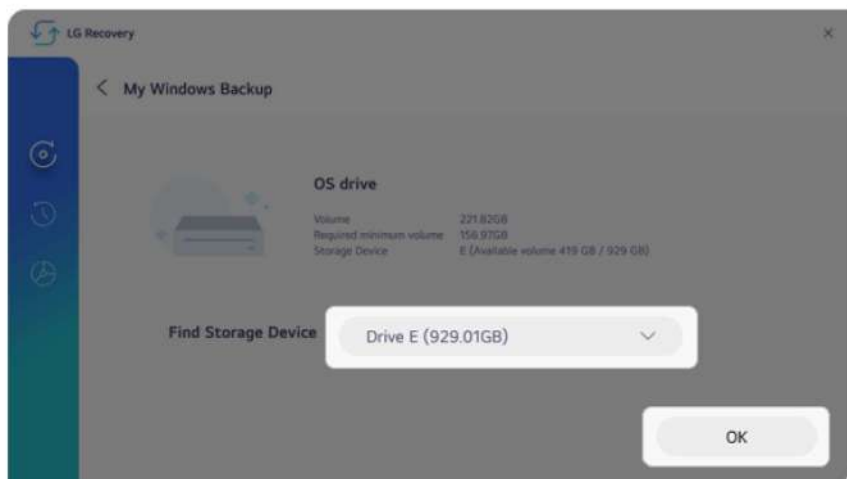

- 7 When the backup is complete, click [OK].
- 8 Select the Exit button [ X ] to reboot the PC.

### My Windows Recovery



#### CAUTION

All user data on the partition where Windows is installed will be deleted, so you must backup all important data in advance.

- 1 Connect the external disk where the backup file is saved to the PC.
- 2 Select the Start button [ Windows logo ] > [All apps] and run [LG Update & Recovery].
- 3 Select [Recovery] > [My Windows Recovery] > [OK] to reboot the PC.

- 4 When the [LG Recovery] screen appears, check the language you want to use and select [Next].

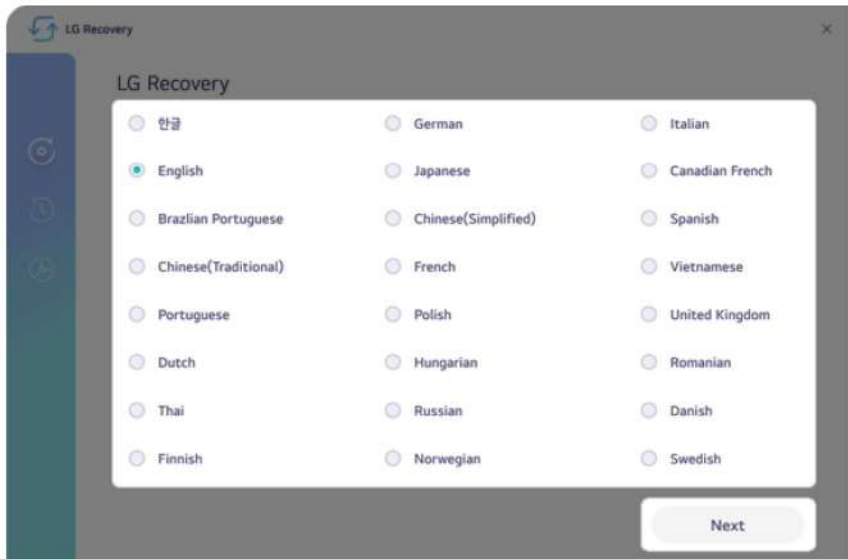

- 5 Select [Recovery] > [My Windows Recovery].
- 6 Select the backup file on the external disk and click [OK].

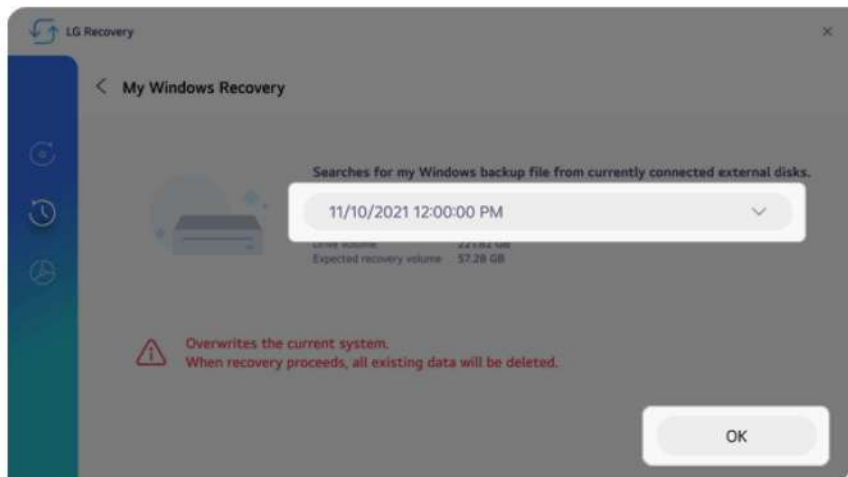

- 7 When the recovery is complete, click [OK].
- 8 Select the Exit button [  ] to reboot the PC.

## Setting the Boot Password

This process is to set a password so that other people cannot use the computer or change the settings.

The user can set a password while booting the system or setting up the system.

**The model in the example can differ from actual models and is subject to change for performance improvements, without prior notice.**



### CAUTION

Without the registered password, access to the system will be denied. Write down and keep the password in a safe place.

### Set Supervisor Password

The password prevents unauthorized people from accessing the PC. By default, no password is set for the machine. If an unauthorized person changes the password in the System Setup, you will be unable to access the system.



### TIP

With **[Set Supervisor Password]**, you are authorized to set all items in the System Setup and to set **[Power on Password]**. In case other people also use the computer, it is recommended to set the **[Set User Password]**.



- 1 Reboot the system and press [F2] multiple times.



- 2 When the System Setup screen appears, go to **[Security]** > **[Set Supervisor Password]** using the arrow keys and press the [Enter] key.

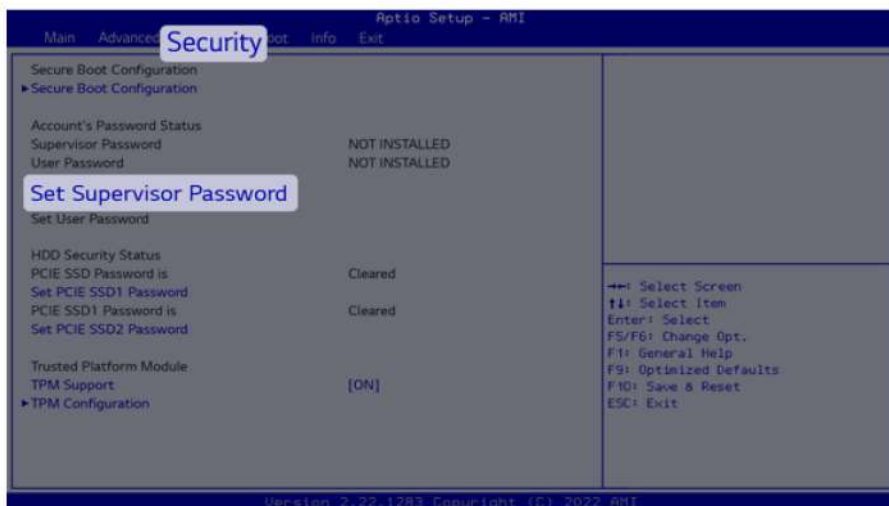

- 3 When the Password Setting screen appears, enter a password and press the [Enter] key. The password should not exceed 20 characters and should consist of English letters (A - Z), numbers (0 - 9), and special characters or a combination of them.



- 4 Enter the password once more and press the [Enter] key.



- 5 To save the changes in system setup, press [F10]. When a pop-up window appears, select [Yes] and press the [Enter] key.



- 6 The PC will restart.

### Set User Password

The password set in [Set User Password] is of a lower level than the one set in [Set Supervisor Password], so you can set a user password only after setting a password in [Set Supervisor Password].

**Tip** TIP

[Set User Password] allows limited access to the items in the System Setup screen compared to the [Set Supervisor Password] items.

- Execute the System Setup screen, go to **[Security]** > **[Set User Password]** using the arrow keys and press the **[Enter]** key.



- When the Password Setting screen appears, enter a password and press the **[Enter]** key. The password should not exceed 20 characters and should consist of English letters (A - Z), numbers (0 - 9), and special characters or a combination of them.



- Enter the password once more and press the **[Enter]** key.



- To save the changes in system setup, press [F10]. When a pop-up window appears, select **[Yes]** and press the [Enter] key.



- The PC will restart.

### Power on Password

**[Power on Password]** protects your system by requiring during booting to enter the password set in **[Set Supervisor Password]** or **[Set User Password]**.

To set **[Power on Password]**, you first need to set **[Set Supervisor Password]** or set both **[Set Supervisor Password]** and **[Set User Password]**.

- Execute the System Setup screen, go to **[Security]** > **[Power on Password]** using the arrow keys and press the [Enter] key.

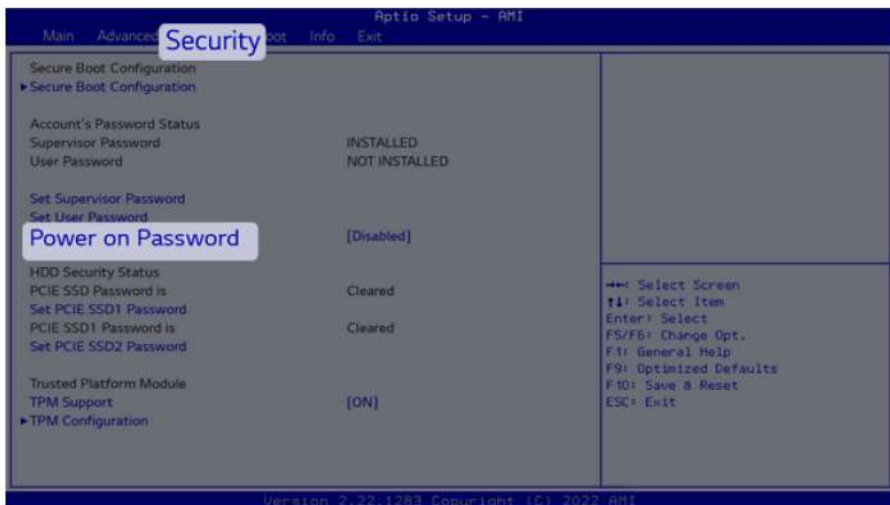

- Select **[Enabled]** and press the [Enter] key to complete the **[Power on Password]** setting.

## Set PCIE SSD Password

[Set PCIE SSD Password] is to set the password directly on the storage device separately from [Set Supervisor Password].

### Tip

- Some models with built-in **PCIE SSD** may not support the password setting function.
- For the models equipped with two storage devices, you can set a password for each device. If passwords are set for both devices, the password input window appears twice during the booting process. The order in which the password input windows appears is according to the [Boot Type Order] of the [Boot] menu.
- For the models equipped with two storage devices, the menu names are shown as PCIE SSD1, PCIE SSD2, etc.



### CAUTION

If you lose the password for a storage device, you cannot recover the storage device.

- Please note that replacement of a storage device due to the loss of the password of the storage device is excluded from the product warranty.

- 1 Execute the System Setup screen, go to [Security] > [Set PCIE SSD1 Password] using the arrow keys and press the [Enter] key.



- 2 When the Password Setting screen appears, enter a password and press the [Enter] key. The password should not exceed 32 characters and should consist of English letters (A - Z), numbers (0 - 9), and special characters or a combination of them.



- 3 Enter the password once more and press the [Enter] key.



- 4 To save the changes in system setup, press [F10]. When a pop-up window appears, select **[Yes]** and press the [Enter] key.



- 5 The PC will restart.

## Installing the Driver

The figures herein may differ by language selection and are subject to change without prior notice.

Using **LG Update & Recovery** (or **LG Update**) to Install the Drivers

- 1 Select the Start button [  ] > [All apps] and run [**LG Update & Recovery**] or [**LG Update**].
- 2 Select [**Required Updates**] or [**Update List**] to install the driver.

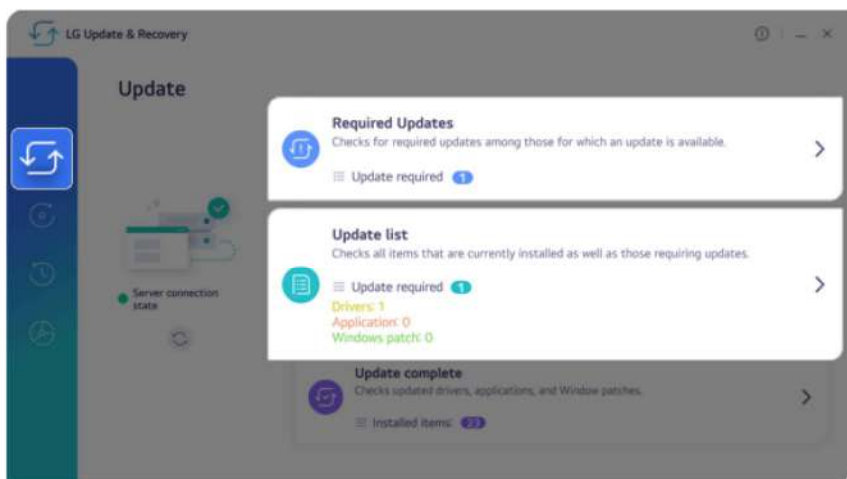

### Tip TIP

You can use **LG Update & Recovery** (or **LG Update**) to install the deleted drivers or the latest drivers easily and quickly.

Use **LG Update & Recovery** (or **LG Update**) to keep your system current and optimized.

Downloading **LG Update & Recovery** (or **LG Update**)

You can download and install **LG Update & Recovery** (or **LG Update**) from LG Electronics' website ([www.lg.com](http://www.lg.com)).

## Setting Auto Scaling

The Windows **Auto Scaling** feature for user's convenience may partially blur the screen or display some icons and texts larger.

Refer to the following information to change the DPI scaling to suit your needs.

- 1 Select the Start button [  ] > [Settings].

**TIP**

Press the [  ] key or [Ctrl] + [Esc] on the keyboard to display the Start screen.

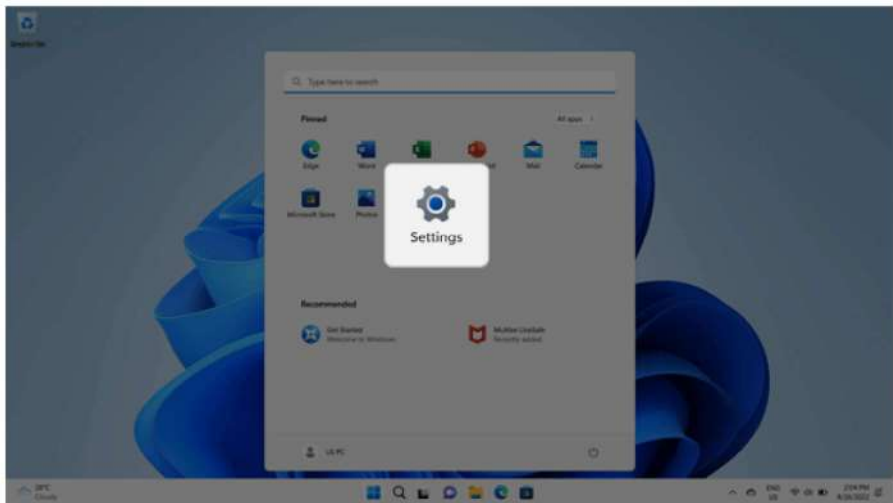

- 2 Select [System] > [Display].



- 3 Changing the **[Scale]** item value changes the auto scaling settings.

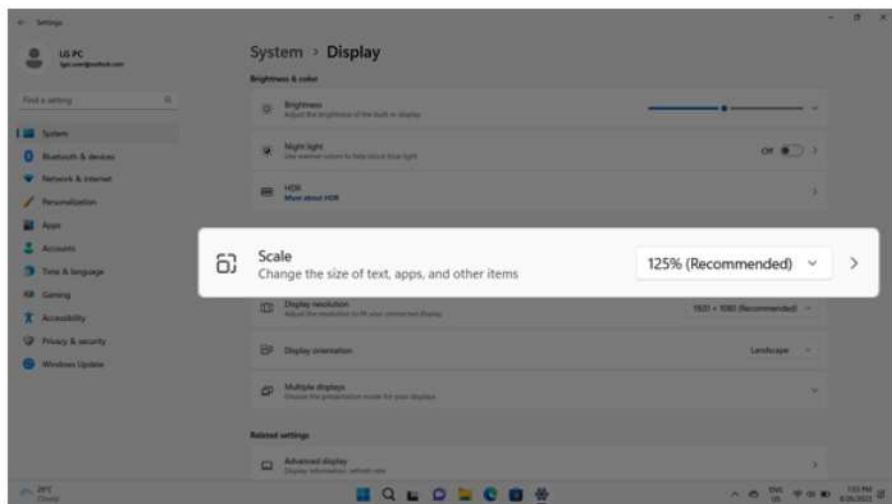

**TIP**

After changing the Auto Scaling settings, some apps must be shut down and restarted for the scaling and layout to take effect.

For 6XD (Indoor Client)

Prohibited for control of or communications with unmanned aircraft systems, including drones.