

NEED MORE HELP?

For the latest support info and online User Manuals visit jabra.com/motionoffice

TOLL FREE Customer Contact Details:

EUROPE	PHONE	EMAIL
Austria	+43720880558	support.at@jabra.com
Belgique/Belgium	+3228080766	support.be@jabra.com
Czech Republic	--	support.global@jabra.com
Denmark	+45 69918794	support.dk@jabra.com
Finland	+4535256540	--
France	+33 182880251	support.fr@jabra.com
Germany	+4930896778991	support.de@jabra.com
Italy	+39 0662207674	support.it@jabra.com
Luxembourg	+45 35256540	--
Netherlands	+31 208080962	support.nl@jabra.com
Norway	+4722577785	support.no@jabra.com
Poland	--	support.global@jabra.com
Portugal	+4535256540	--
Russia	--	support.ru@jabra.com
Spain	+34 911875539	support.es@jabra.com
Sweden	+46 852507012	support.se@jabra.com
Switzerland	+41 435002460	support.ch@jabra.com
Turkey	--	support.global@jabra.com
United Kingdom	+44 2033180070	support.uk@jabra.com
International	+4535256540	--

For more information, please visit
www.jabra.com

Jabra MOTION OFFICE

Jabra[®]
YOU'RE ON

GET STARTED

[JABRA.COM/MOTIONOFFICE](https://jabra.com/motionoffice)

A BRAND BY

GN Netcom

© 2014 GN Netcom A/S (North America: GN Netcom US, Inc.). All rights reserved. Jabra® is a registered trademark of GN Netcom A/S. All other trademarks included herein are the property of their respective owners. The Bluetooth® word mark and logos are owned by the Bluetooth SIG, Inc. and any use of such marks by GN Netcom A/S is under license. (Design and specifications subject to change without notice).

Made in China

MODEL: BTE6
WHB006



Bluetooth®

www.jabra.com

ENGLISH.....	2
ČESKY	8
DEUTSCH	14
DANSK/ SVENSKA.....	20
ESPAÑOL	26
FRANÇAIS	32
ITALIANO.....	38
NEDERLANDS.....	44
POLSKI	50
PORTUGUÊS	56
РУССКИЙ	62
TÜRKÇE.....	68

OVERVIEW

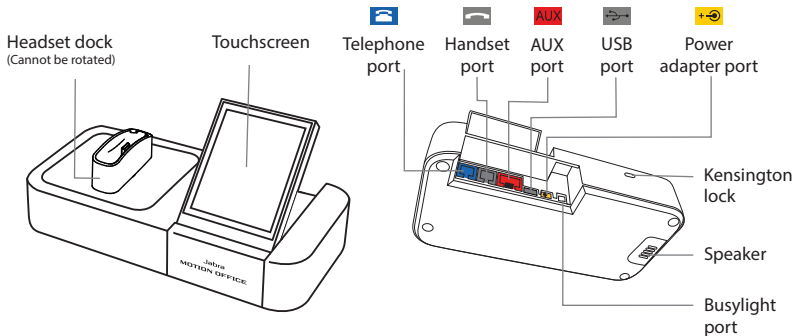
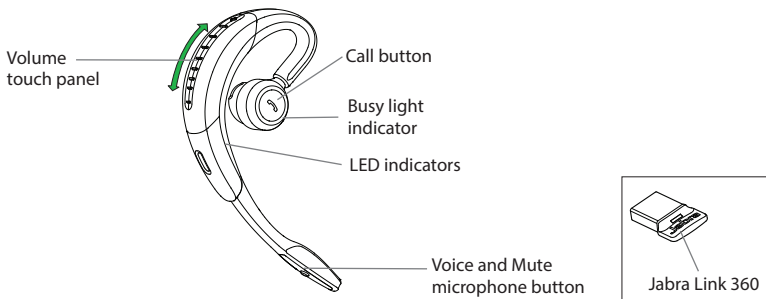

1 BASIC SETUP

ENGLISH

1

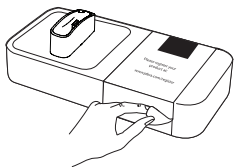

2



3

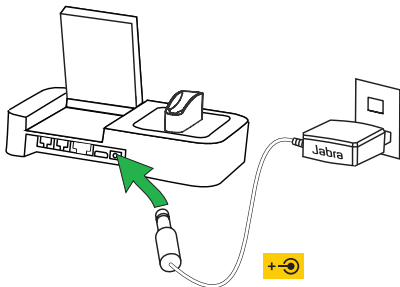

4



Important!

Download and install the latest Jabra software from jabra.com/pcsuite for full headset functionality.

2 CONNECT TO PHONE OR PC

JABRA MOTION OFFICE CONNECTION

The first time the base is connected to power, the setup wizard will automatically start. The setup wizard can also be accessed at any time via the touchscreen menu.

1. Tap the Settings menu on the touchscreen.
2. Tap Phone settings > Setup wizard.
3. Tap confirm to start the setup wizard.

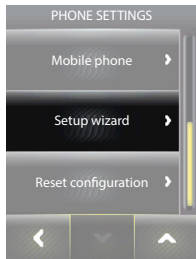

JABRA LINK 360 CONNECTION

The Jabra Link 360 enables a connection to a PC without the base, giving you wireless freedom when you travel.

To connect, simply plug the Jabra Link 360 into a USB port on your PC. The headset and the Jabra Link 360 are already pre-paired.



Important!

The Jabra Link 360 and the base should not be plugged in at the same time.



3 WEARING THE HEADSET

HEIGHT ADJUSTMENT

Get the perfect fit for your ear by adjusting the height of the speaker up or down.

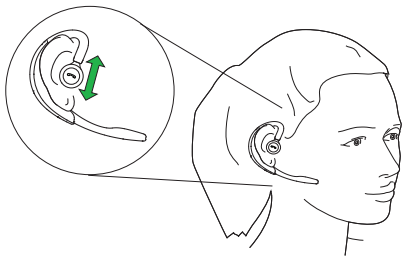

LEFT OR RIGHT EAR WEARING STYLE



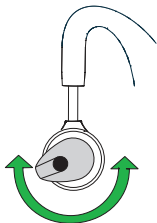
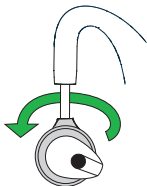
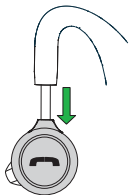

The headset can be worn on the left or right ear. To switch ear:

1. Pull the speaker all the way down.
2. Rotate the speaker 180°.
3. Twist the eargel around to fit your ear.

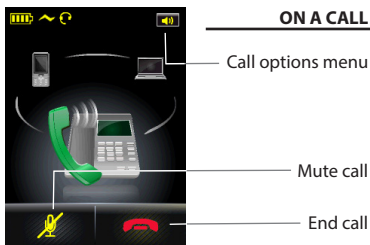
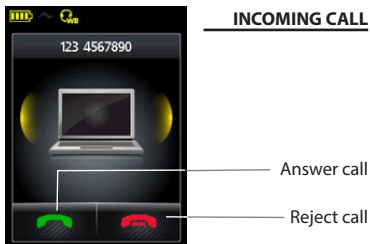
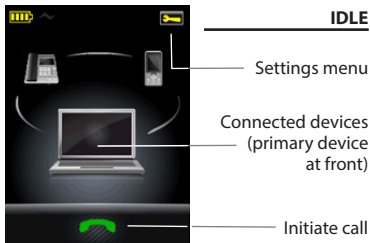
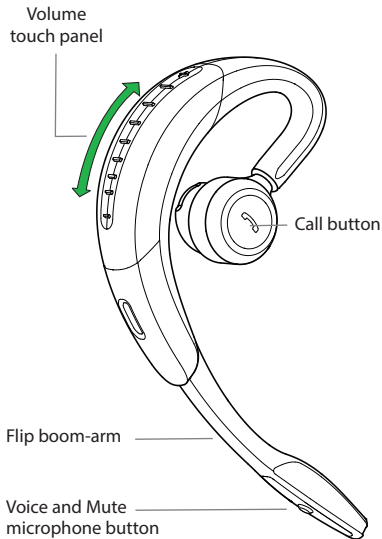

4 HOW TO USE

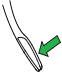

	FUNCTION	ACTION
	Headset On/off	Open/close the flip boom-arm
	Answer call	Tap the Call button on the headset, or tap the Answer call button on the touchscreen
	End call	Tap the Call button on the headset, or tap the End/reject call button on the touchscreen
	Talk time status	When not on a call, tap the Call button on the headset
	Speaker volume	Slide a finger up/down the Volume touch panel
	Switch primary device	Tap a connected device on the touchscreen to switch the primary device for calls
	Voice commands	Tap the Voice and Mute microphone button when not on a call, until you hear 'Say a command'. Say 'What can I say?' for a list of voice commands
	Mute microphone	Tap the Voice and Mute microphone button during a call

Important!

For more information about using the Jabra Motion Office, refer to jabra.com/motionoffice