

Jabra Wireless Charging Pad

User Manual

(General Edition)

User Manual

Thanks for choosing us!
This product is a TWS headphone /mobile phone wireless charger that allows you enjoy the fun of digital products easily.
Please kindly read the user manual before using the product and keep the manual properly for future reference



Specification

Standard version Qi
Input: DC 5V 2A (Max)
Output: 5W
Frequency: 112kHz-154.35kHz
Model: WPC02
E-Field: 17.5uA/m RMS
Maximum ambient temperature: 40°C
Altitude: 2000ft

Compatible for: All Qi version wireless charging devices
Charging distance: 2" - 8 mm
Conversion rate: >70%
Output: 5W

1. Connect to Laptop

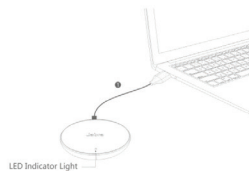

- ① Connect end A of the USB power cord to the USB port of the notebook;
- ② When the power is just turned on, the green light of the wireless charging indicator flashes three times, then the light is off and it is in the standby state;
- ③ When a fault occurs or a foreign object is detected, the red light flashes;
- ④ When the device is charging, the indicator light is steady green; when the device is full, the indicator light turns from the steady state to the off.

2. Connect to Desktop

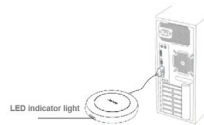

- ① Connect end A of the USB power cord to the USB interface of the desktop computer motherboard;
- ② When the power is just turned on, the green light of the wireless charging indicator flashes three times, then the light is off and it is in the standby state;
- ③ When a fault occurs or a foreign object is detected, the red light flashes;
- ④ When the device is charging, the indicator light is steady green; when the device is full, the indicator light turns from the steady state to the off.

3. Charging Mode



- ① Confirm that the wireless charger is correctly connected to the power supply and enters the standby state;
- ② Place the headphone box/mobile phone with wireless charging function in the center of the charger and on the Jabra logo position where is the best charging area;
- ③ When the indicator light is steady green, the headphone box/mobile phone enters the charging state;
- ④ When a fault occurs or a foreign object is detected, the red light flashes. If the headphone/mobile phone are not placed correctly and the red light flashes, please move the headphone box/mobile phone slightly until you find the best charging position;
- ⑤ When the device is full, the indicator light turns from the steady state to the off.

Notes:

1. Do not squeeze, crush or disassemble it.
2. Fire or water exposure will cause high risk of malfunction or circuit issue of the device.
3. Keep it away from hot, humid or corrosive environments to avoid the risk of circuit damage or electric leakage.
4. Keep the magnetic strips or chip card (ID card, bank cards, etc.) away from the WLC to avoid magnetic failure.
5. Keep the WLC at least 20cm in distance to avoid potential interference with the medical device such as implanted pacemakers, implantable cochlear, etc.
6. The WLC pad is not designed for toy purpose, pls keep the children away to avoid unnecessary accidents.

The pictures involved in the manual are all schematic diagrams, and the final product is subject to the actual product.

Contains: wireless charger pad and user manual.

*The power adapter is not included, please purchase it separately if needed (5V/2A)

Special Notice:

1. This device complies with Part 15 of the FCC Rules. Operation is subject to the following two conditions: (1) this device may not cause harmful interference, and (2) this device must accept any interference received, including interference that may cause undesired operation.

Changes or modifications not expressly approved by the party responsible for compliance could void the user's authority to operate the equipment. This equipment has been tested and found to comply with the limits for a Class B digital device, pursuant to Part 15 of the FCC Rules. These limits are designed to provide reasonable protection against harmful interference in a residential installation. This equipment generates, uses and can radiate radio frequency energy and, if not installed and used in accordance with the instructions, may cause harmful interference to radio communications. However, there is no guarantee that interference will not occur in a particular installation.

If this equipment does cause harmful interference to radio or television reception, which can be determined by turning the equipment off and on, the user is encouraged to try to correct the interference by one or more of the following measures:

- Reorient or relocate the receiving antenna.
- Increase the separation between the equipment and receiver.
- Connect the equipment into an outlet on a circuit different from that to which the receiver is connected.
- Consult the dealer or an experienced radio/TV technician for help.

2. This device complies with FCC RF radiation exposure limits set forth for an uncontrolled environment. This transmitter must not be collocated or operating in conjunction with any other antenna or transmitter. During the operation of device a distance of 15 cm surrounding the device and 20 cm above the top surface of the device must be respected.

3. This device contains licence-exempt transmitter(s)/receiver(s) that comply with Innovation, Science and Economic Development Canada's licence-exempt RSS(s). Operation is subject to the following two conditions:

- (1) This device may not cause interference.
- (2) This device must accept any interference, including interference that may cause undesired operation of the device.

L'émetteur/récepteur exempt de licence contenu dans le présent appareil est conforme aux CNR d'Innovation, Sciences et Développement économique Canada applicables aux appareils radio exempts de licence. L'exploitation est autorisée aux deux conditions suivantes :

- (1) L'appareil ne doit pas produire de brouillage;
- (2) L'appareil doit accepter tout brouillage radioélectrique subi, même si le brouillage est susceptible d'en compromettre le fonctionnement.

This equipment complies with Canada radiation exposure limits set forth for an uncontrolled environment.

4. During the operation of device a distance of 10 cm surrounding the device and 10 cm above the top surface of the device must be respected.

Cet équipement est conforme Canada limites d'exposition aux radiations dans un environnement non contrôlé.

au cours de l'opération de l'appareil sur une distance de 10 cm autour de l'appareil et de 10 cm au-dessus de la surface supérieure de l'appareil doit être respecté.