

NEED MORE HELP?

Why wait? Go to our support page and find all the answers you're looking for 24-hours a day. www.jabra.com/stealth

Contact details to Jabra Support:

NA Support

Email: support.na@jabra.com

Twitter: twitter.com/jabra_US

www.jabra.com/mobilesupport

(For the latest support info
and online user manuals)

1 (800) 327-2230 (U.S.)

1 (800) 489-4199 (Canada)

For more information, please visit
www.jabra.com

JABRA STEALTH

Jabra[®]
YOU'RE ON

GET STARTED IN UNDER

5
MINUTES

jabra.com/stealth

A BRAND BY

GN Netcom

© 2014 GN Netcom A/S (North America: GN Netcom US, Inc.). All rights reserved. Jabra® is a registered trademark of GN Netcom A/S. All other trademarks included herein are the property of their respective owners. The Bluetooth® word mark and logos are owned by the Bluetooth SIG, Inc. and any use of such marks by GN Netcom A/S is under license. (Design and specifications subject to change without notice).

MADE IN CHINA
MODEL: OTE18

FCC ID: BCE-OTE18
IC: 2386C-OTE18



Declaration of Conformity can be found on
www.jabra.com/CP/US/declarations-of-conformity

ENGLISH	1
FRANÇAIS	5
ESPAÑOL	9
PORTUGUÊS	13

1 HOW TO CONNECT

CONNECT TO MOBILE DEVICE

1. Turn the headset on (set the **On/off** switch to the On position).
2. Press and hold (3 secs) the **Answer/end** button until the Bluetooth indicator flashes blue and pairing mode is announced in the headset.
3. Follow the voice-guided pairing instructions to pair to your Bluetooth device.

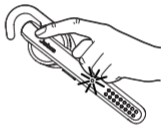

CONNECT TO MOBILE DEVICE (USING NFC)

1. Ensure that NFC is enabled on your mobile device.
2. Slowly slide the NFC zone of the headset against the NFC zone of the mobile device until a connection is confirmed.

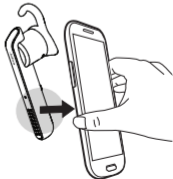

2 HOW TO WEAR

ENGLISH

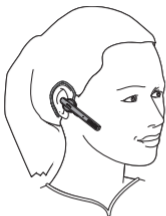

The headset can be worn on the left or right ear. There are 3 eargel styles, and 2 earhook styles.

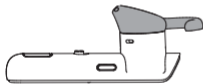

ATTACHING THE EARHOOK

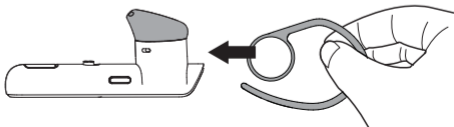



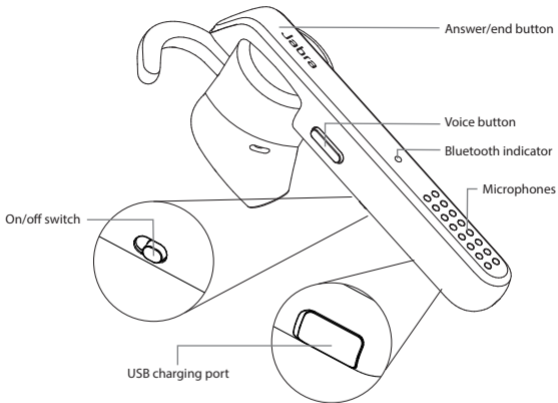

3 HOW TO USE



DID YOU KNOW?

The Jabra Assist app can help you locate your headset using GPS tracking. Download the Jabra Assist App for your Android™ or iOS device to enhance your Jabra experience.

	FUNCTION	ACTION
	On/off	Slide the On/off switch
	Answer/end call	Tap the Answer/end button
	Reject call	Press and hold (1 sec) the Answer/end button
	Redial last number	Double-tap the Answer/end button when not on a call
	Activate voice dialing (phone dependant)	Press and hold (1 sec) the Voice button
	Speaker volume	Use the volume controls on the connected mobile device

CHARGE THE HEADSET

Pull back the charging cover to expose the USB charging port. It takes approx. 2 hours to fully charge the battery.



1 COMMENT LE CONNECTER

CONNEXION À UN PÉRIPHÉRIQUE MOBILE

1. Allumez le casque (réglez le commutateur **Marche/Arrêt** à la position **Marche**).
2. Maintenez appuyée (3 secondes) la touche **Réponse/Fin** jusqu'à ce que l'indicateur Bluetooth clignote en bleu et que le mode d'appariement soit annoncé dans le casque.
3. Suivez les instructions vocales d'appariement pour appairer votre périphérique Bluetooth.

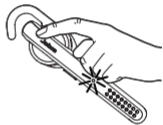

CONNEXION À UN PÉRIPHÉRIQUE MOBILE (AVEC NFC)

1. Assurez-vous que la fonction NFC est activée sur votre périphérique mobile.
2. Glissez lentement la zone NFC du casque directement contre la zone NFC du périphérique mobile jusqu'à la confirmation d'une connexion.

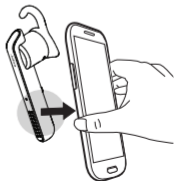

2 COMMENT LE PORTER

FRANÇAIS

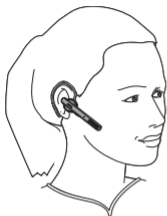

Le casque se porte sur l'oreille gauche ou droite. Il y a 3 types d'oreillette Eargel et 2 types de crochet auriculaire.

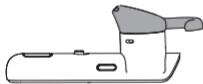

ATTACHER LE CROCHET AURICULAIRE

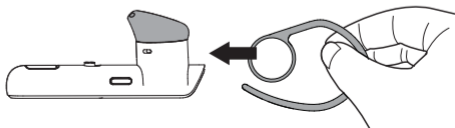



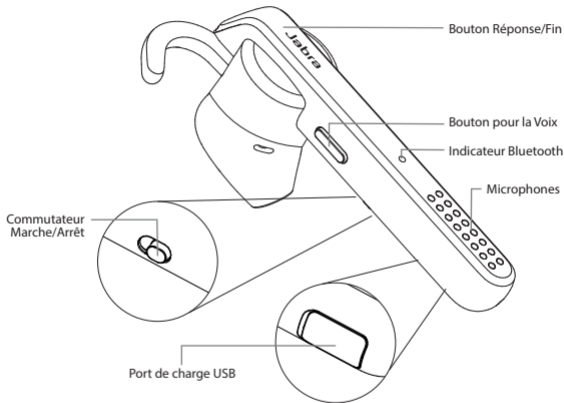

3 COMMENT L'UTILISER



LE SAVIEZ-VOUS?

Avec l'application Jabra Assist, vous pouvez localiser votre casque à l'aide du repérage du casque par GPS. Téléchargez l'application Jabra Assist pour votre Android™ ou un appareil iOS pour améliorer votre expérience Jabra.

	FONCTION	ACTION
	Marche/arrêt	Faites glisser le commutateur Marche/Arrêt
	Réponse/fin d'appel	Appuyez sur la touche Réponse/Fin
	Refuser un appel	Maintenez appuyée (1 seconde) la touche Réponse/Fin
	Recomposer le dernier numéro	Appuyez deux fois sur la touche Réponse/Fin quand vous n'êtes pas en cours d'appel
	Activer la Composition vocale (varie en fonction du téléphone)	Maintenez appuyée (1 seconde) la touche Voix
	Volume du haut- parleur	Utilisez le contrôle du volume sur l'appareil mobile connecté.

CHARGE DU CASQUE

Glissez le couvercle de charge pour que le port de charge USB soit visible. Une charge complète s'effectue en environ 2 heures.



1 CÓMO CONECTARLOS

CONEXIÓN A DISPOSITIVO MÓVIL

1. Encienda el auricular (ajuste el interruptor **Encender/Apagar** en la posición de Encender).
2. Presione y mantenga presionado (3 segundos) el botón **Responder/Finalizar** del auricular hasta que parpadee la luz azul de Bluetooth y se anuncie el modo de sincronización en el auricular.
3. Siga las instrucciones por voz para sincronizar su dispositivo Bluetooth.



CONEXIÓN A DISPOSITIVO MÓVIL (MEDIANTE NFC)

1. Cerciérese de que NFC esté activo en su dispositivo móvil.
2. Deslice lentamente la zona NFC del auricular sobre la zona NFC del dispositivo móvil hasta que se confirme una conexión.

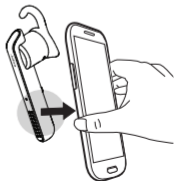

2 CÓMO USARLOS

ESPAÑOL

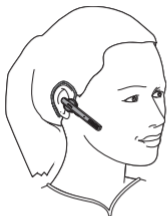

Puede usar el auricular en la oreja izquierda o en la derecha. Hay 3 estilos de eargel y 2 estilos de gancho para la oreja.

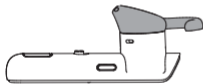

CÓMO COLOCAR EL GANCHO PARA LA OREJA

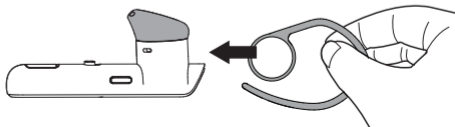



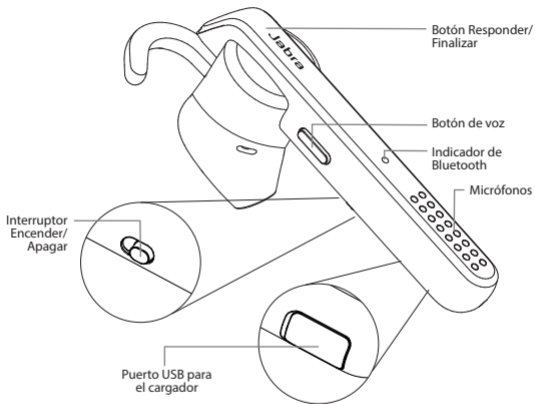

3 CÓMO UTILIZARLOS



¿SABÍA QUE...?

La aplicación Jabra Assist puede ayudarle a localizar el auricular mediante rastreo por GPS. Descargue la aplicación Jabra Assist para su dispositivo Android™ o iOS para mejorar su experiencia con Jabra.

	FUNCIÓN	ACCIÓN
	Encender/Apagar	Deslice el interruptor Encender/ Apagar .
	Responder/Finalizar llamada	Pulse el botón Responder/Finalizar .
	Rechazar llamada	Presione el botón Responder/ Finalizar y manténgalo presionado (1 segundo).
	Volver a marcar el último número	Pulse dos veces el botón Responder/ Finalizar cuando no esté en una llamada.
	Activar marcación por voz (depende del teléfono)	Mantenga presionado (1 segundo) el botón de Voz .
	Volumen del altavoz	Utilice los controles de volumen en el dispositivo móvil conectado.

CARGA DEL AURICULAR

Tire de la tapa de carga hacia atrás para dejar expuesto el puerto de carga USB. Lleva aproximadamente 2 horas cargar la batería por completo.



1 COMO SE CONECTAR

CONECTE-SE AO DISPOSITIVO MÓVEL

1. Ligue o headset (vire a chave **Ligar/Desligar** para a posição de ligado).
2. Pressione e segure (por 3 segundos) o botão **Atender/Terminar** até o indicador do Bluetooth piscar em azul e o modo de pareamento for anunciado no headset.
3. Siga as instruções de voz de pareamento para parear o seu dispositivo Bluetooth.

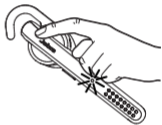

CONECTE-SE AO DISPOSITIVO MÓVEL (USANDO NFC)

1. Certifique-se de que o NFC esteja habilitado no seu dispositivo móvel.
2. Deslize lentamente a zona NFC do headset contra a zona NFC do dispositivo móvel até uma conexão ser confirmada.

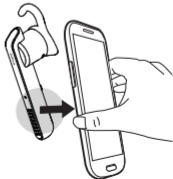

2 COMO USAR

PORTUGUÊS

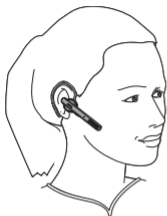

O headset pode ser usado na orelha esquerda ou direita. Há três estilos de gel de ouvido e 2 estilos de gancho de orelha.

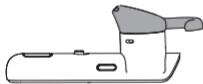

ANEXANDO O GANCHO DE ORELHA

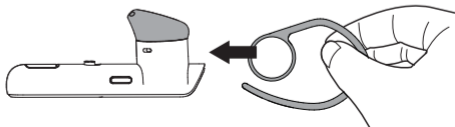



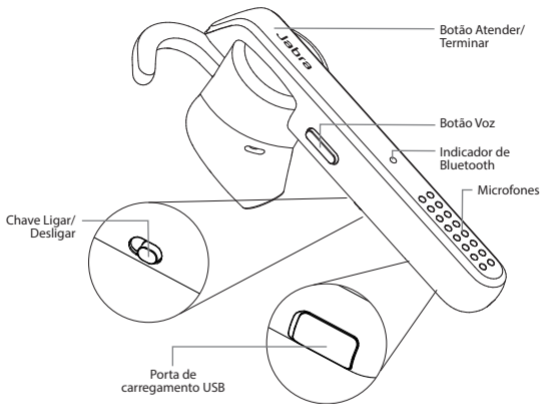

3 COMO USAR



VOCÊ SABIA?

O aplicativo Jabra Assist pode ajudá-lo a localizar o seu headset usando rastreamento por GPS. Baixe o aplicativo Jabra Assist para o seu dispositivo Android™ ou iOS para melhorar a sua experiência Jabra.

	FUNÇÃO	AÇÃO
	Ligar/Desligar	Deslize a chave Ligar/Desligar
	Atender/Terminar chamada	Toque no botão Atender/Terminar
	Rejeitar chamada	Pressione e segure (por 1 segundo) o botão Atender/Terminar
	Rediscar último número	Dê um toque duplo no botão Atender/Terminar quando não estiver em uma chamada
	Ativar discagem por voz (dependente do telefone)	Pressione e segure (por 1 segundo) o botão Voz
	Volume do alto-falante	Use os controles de volume no dispositivo móvel conectado

CARREGAR O HEADSET

Retire a tampa de carregamento para expor a porta de carregamento USB. Leva aproximadamente 2 horas para carregar completamente a bateria.

