

NEED MORE HELP?

Why wait? Go to our support page and find all the answers you're looking for 24-hours a day. www.jabra.com/roxwireless

Contact details to Jabra Support:

EUROPE	PHONE	EMAIL
Austria	+43 720880558	support.at@jabra.com
Belgium/Belgium	+32 28080766	support.be@jabra.com
Czech Republic	--	support.global@jabra.com
Denmark	+45 69918794	support.dk@jabra.com
Finland	+45 35256540	--
France	+33 182880251	support.fr@jabra.com
Germany	+49 30896778991	support.de@jabra.com
Italy	+39 0662207674	support.it@jabra.com
Luxembourg	+45 35256540	--
Netherlands	+31 208080962	support.nl@jabra.com
Norway	+47 22577785	support.no@jabra.com
Poland	--	support.global@jabra.com
Portugal	+45 35256540	--
Russia	--	support.ru@jabra.com
Spain	+34 911875539	support.es@jabra.com
Sweden	+46 852507012	support.se@jabra.com
Switzerland	+41 435002460	support.ch@jabra.com
Turkey	--	support.global@jabra.com
United Kingdom	+44 2033180070	support.uk@jabra.com
International	+45 35256540	--

For more information, please visit
www.jabra.com

81-03822 B

JABRA ROX WIRELESS

Jabra[®]
YOU'RE ON

GET STARTED IN UNDER

5 MINUTES

jabra.com/roxwireless

A BRAND BY



© 2013 GN Netcom A/S (North America: GN Netcom US, Inc.). All rights reserved. Jabra® is a registered trademark of GN Netcom A/S. All other trademarks included herein are the property of their respective owners. The Bluetooth® word mark and logos are owned by the Bluetooth SIG, Inc. and any use of such marks by GN Netcom A/S is under license. (Design and specifications subject to change without notice). Dolby and the double-D symbol are registered trademarks of Dolby laboratories. Confidential unpublished works. Copyright 2003-2010 Dolby Laboratories. All rights reserved.

MADE IN CHINA
MODEL: OTE16



ENGLISH	1
FRANÇAIS	X
DEUTSCH	X
NEDERLANDS.....	X
ITALIANO.....	X
ESPAÑOL	X
MAGYAR	X
ROMÂNĂ	X
SUOMI	X
DANSK/SVENSKA.....	X
РУССКИЙ	X
ČESKY	X
УКРАЇНСЬКА	X
POLSKI.....	X
PORTUGUÊS.....	X
TÜRKÇE	X
ΕΛΛΗΝΙΚΑ	X
X.....	العربية
X.....	فارسی

Declaration of Conformity can be found on
www.jabra.com/CP/US/declarations-of-conformity

1 HOW TO CONNECT

CONNECT WITH A BLUETOOTH® DEVICE

1. Press and hold (5 secs) the **Multi-function** button until the LED rapidly flashes blue.
2. Wear the headset, and follow the voice-guided pairing instructions to pair to your Bluetooth device.

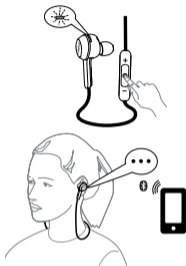

CONNECT WITH AN NFC DEVICE

1. Ensure that NFC is enabled on your mobile device.
2. Slowly slide the NFC zone of the headset (button side of the control box) directly against the NFC device until an NFC connection is confirmed.



2 HOW TO WEAR

ENGLISH

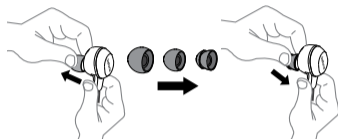

WEARING THE EAR SPRINGS

For the perfect active fit, attach the ear springs as illustrated.

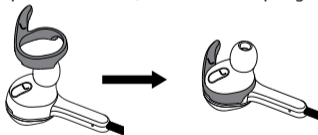

USING THE FITCLIP

Attach the fitclip to the cable, and adjust for optimal fit.

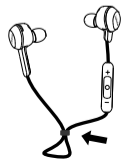

3 HOW TO USE

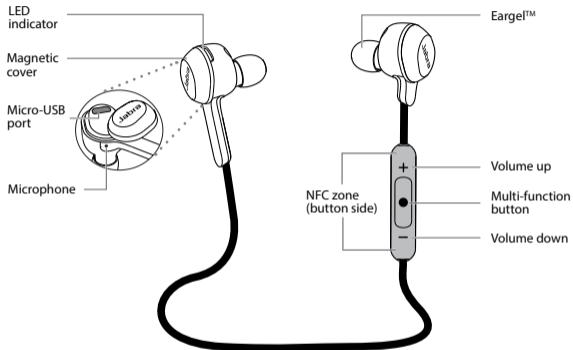

IMPORTANT

The earbuds are magnetic. Join or separate them to turn the Jabra Rox Wireless off/on, play/pause music or end/answer a call.

	FUNCTION	ACTION
	Turn on/off	Press and hold (1 sec) the Multi-function button until the LED flashes, or separate/join the magnetic earbuds
	Play/pause music	Tap the Multi-function button, or separate/join the magnetic earbuds
	Answer/end call	Tap the Multi-function button, or separate/join the magnetic earbuds
	Reject call	Double-tap the Multi-function button
	Redial last number	Double-tap the Multi-function button when not on a call
	Adjust speaker volume	Tap the Volume up or Volume down button
	Skip track	Press and hold (2 secs) the Volume up or Volume down button

CHARGING

Remove the magnetic cover on the right earbud to expose the USB port. Plug the supplied USB cable between headset and PC to begin charging.

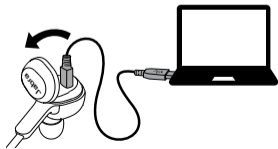

It takes approx. 2.5 hours to fully charge the battery.