

NEED MORE HELP?

For all support go to jabra.com/support

Jabra Evolve 75e



Quick start guide

How to connect

PC

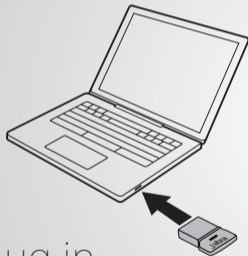

Plug in

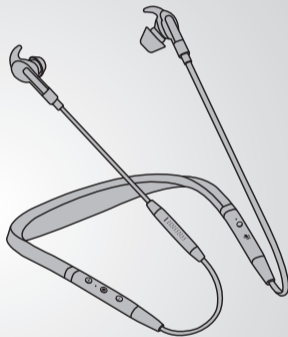

The headset and the USB dongle are pre-paired and ready for use. Press the Multi-function button to power on the headset.

Smartphone

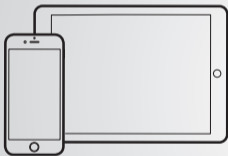

Press and hold

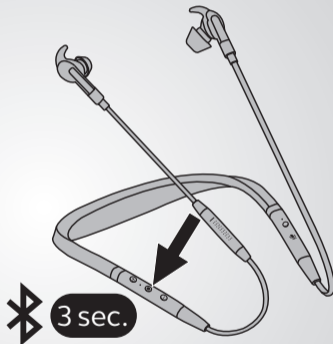

Hold the Multi-function button until the LED flashes blue, and then follow the voice-guided instructions in the headset.

How to wear

Select the correct EarGel and EarWing

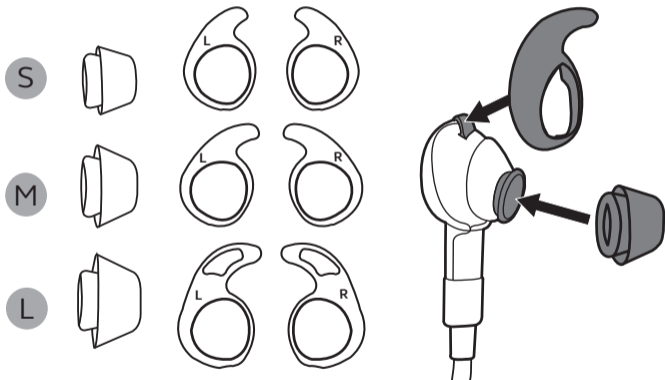

Ears come in all shapes and sizes. For optimal audio quality, mix and match the different EarGel and EarWing sizes to find the best fit for your ear.



Position the microphone close to your mouth.

How to use

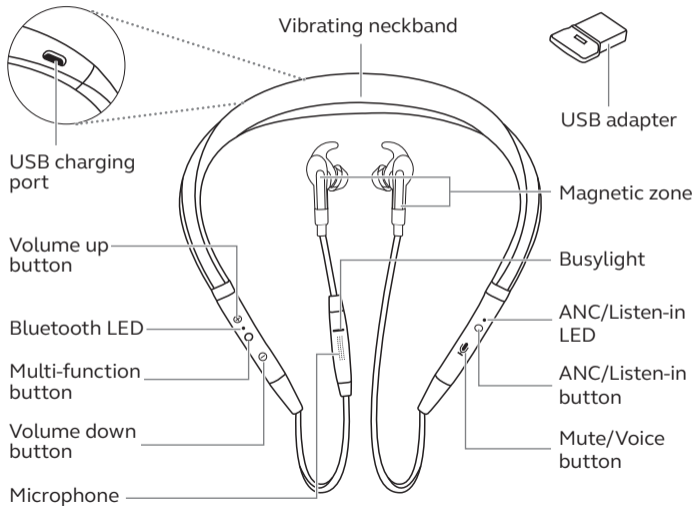

Active Noise Cancellation

Eliminate unwanted background noise by tapping the ANC button.

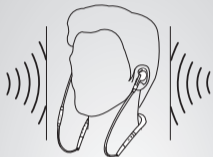

Listen-in

Listen-in to your surroundings without taking off your headset by pressing the Listen-in button (2 secs).



Charging

Plug the headset into a USB port on your PC or wall charger.

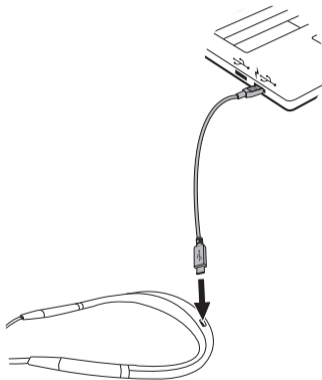

It takes approx. 2 hours to fully charge the headset.

Instructions de connexion

PC

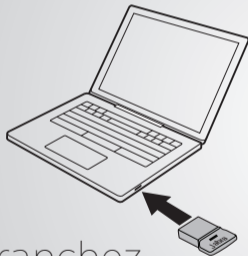

Branchez

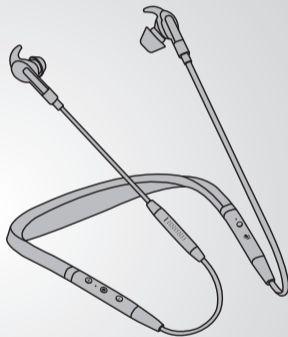

Le micro-casque et la clé USB sont pré-appairés et prêts à l'emploi. Appuyez sur le bouton Multifonction pour mettre le micro-casque sous tension.

Smartphone

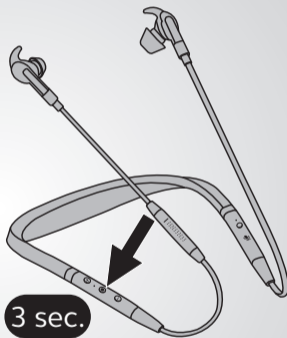
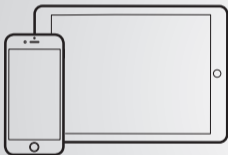

Maintenez appuyé



3 sec.

Maintenez le bouton Multifonction enfoncé jusqu'à ce que la LED clignote en bleu, puis suivez les instructions vocales dans le micro-casque.

Instructions de port

Sélectionnez l'EarGel et l'EarWing appropriés

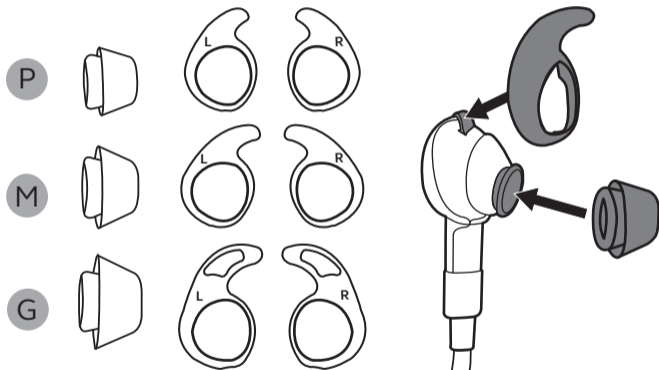

Les oreilles sont de toutes les formes et de toutes les tailles. Pour une qualité audio optimale, testez les différentes tailles d'EarGel et d'EarWing pour trouver le meilleur ajustement pour votre oreille.



Placez le micro près de votre bouche.

Instructions d'utilisation

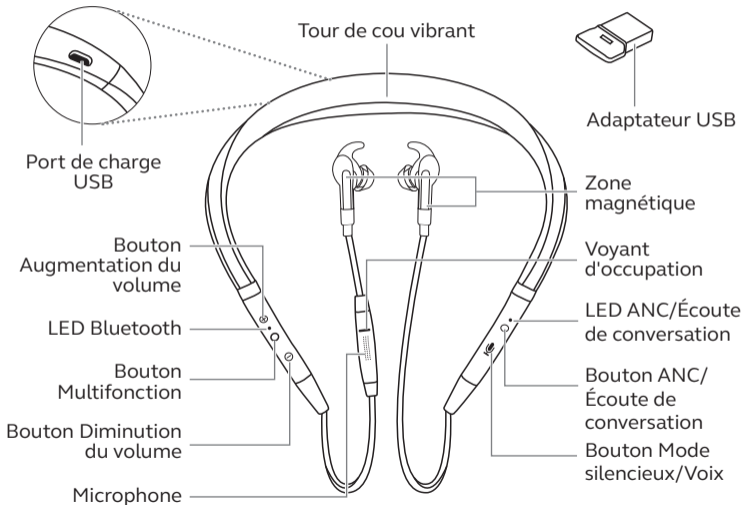

Réduction active du bruit

Éliminez le bruit de fond indésirable en appuyant sur le bouton ANC.

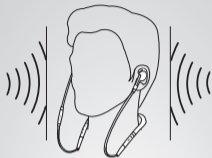

Écoute de conversation

Écoutez les sons qui vous entourent sans retirer votre micro-casque en appuyant sur le bouton Écoute de conversation (2 secondes).



Charge

Branchez le micro-casque à un port USB de votre PC ou chargeur mural.

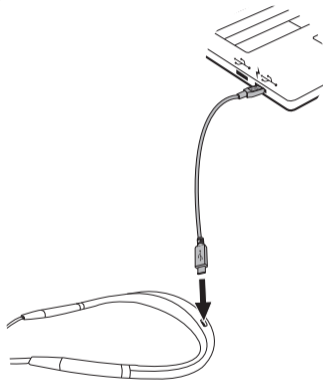

Comptez environ 2 heures pour une recharge complète.

“Este produto está homologado pela ANATEL, de acordo com os procedimentos regulamentados pela Resolução 242/2000, e atende aos requisitos técnicos aplicados”

Para maiores informações, consulte o site da ANATEL www.anatel.gov.br

Modelo: HSC100W / END040W



Agência Nacional de Telecomunicações

XXXXXX-XX-XXXXXX

04050-17-10520

Este equipamento não tem direito à proteção contra interferência prejudicial e não pode causar interferência em sistemas devidamente autorizados

© 2017 GN Audio A/S. All rights reserved. Jabra® is a trademark of GN Audio A/S. The Bluetooth® word mark and logos are registered trademarks owned by the Bluetooth SIG, Inc. and any use of such marks by GN Audio A/S is under license.

Made in China
MODEL: HSC100W/END040W
CMIIT ID: 2017DJXXXX
CMIIT ID: 2017DJ1027

FCC ID: BCE-HSC100W/BCE-END040W
IC: 2386C-HSC100W/2386C-END040W
GB/T 14471-2013 Complies



Declaration of Conformity can be found on
www.jabra.com/doc