

Jabra JX 10 with Bluetooth Hub



Jabra

English – Français – Español

Headset Setup and Charging

Adjusting headset for your comfort	4
Charging your headset	5
Turning your headset on	5

Bluetooth Hub Setup and Use (for Desk Phone)

Connecting Bluetooth Hub with desk phone and power supply	6
Making a test call on your desk phone to adjust settings	7
Making and ending a call via desk phone	9
Answering an incoming call to desk phone	11

Mobile Phone Setup and Use

Pairing headset to mobile phone	12
Making and ending a call from mobile phone	13
Using Voice Dial	14
Answering an incoming call to mobile phone	14

Quick Reference

Operating the Answer/End button	15
What the lights mean	16

In the box

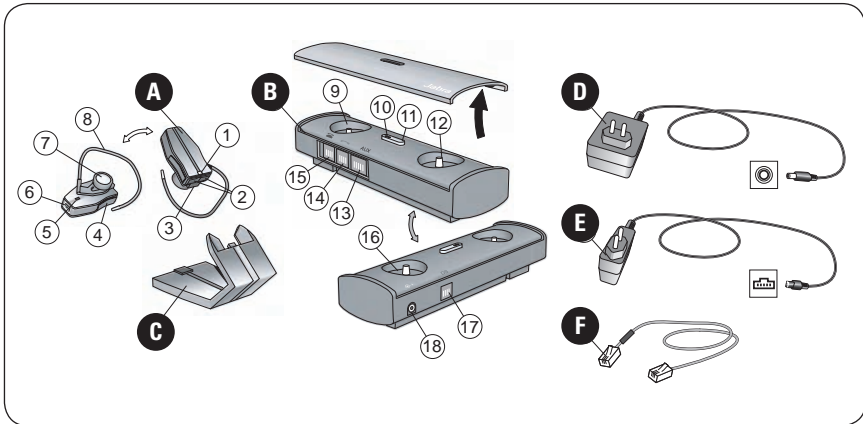
**A. Jabra JX 10 headset**

1. Light indicator (LED)
2. Volume controls
3. Charging socket
4. Answer/End button (also On/Off)
5. Pairing button
6. Microphone
7. Speaker
8. Earhook

B. Jabra Bluetooth Hub

9. Dial Tone Finder
10. Light indicator (LED)
11. Pairing button
12. Microphone volume control
13. AUX socket
14. Handset socket
15. Desk phone socket
16. Reset button
17. Desk stand socket (not for use with Jabra JX 10 headset)
18. Power supply socket

C. Desk stand**D.** Bluetooth Hub power supply**E.** Headset power supply**F.** Desk phone-Bluetooth Hub connection cord

Before you begin setup, be sure all parts have been above 32°F/0°C for at least 30 minutes.

Headset Setup and Charging

Adjusting headset for your comfort

1

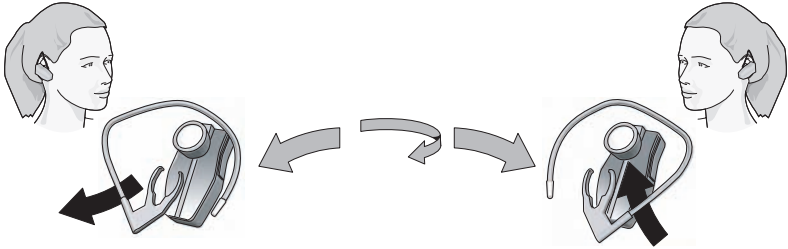

Headset is preset for use on right ear. Switch if necessary.

2

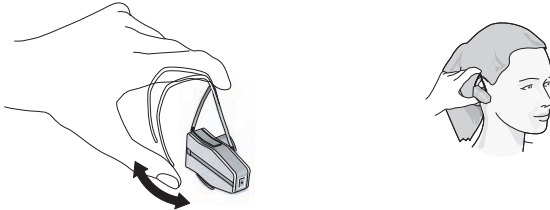

Bend to fit.

3

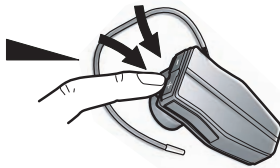

Adjust speaker volume (how others sound to you) on headset.

Charging your headset

4

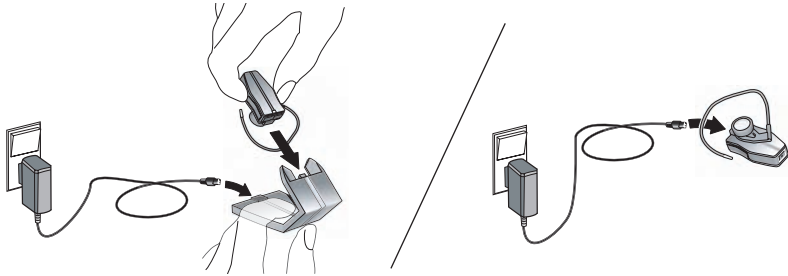

Charge via desk stand or Charge directly (handy for travel).

⚠ Important: Make sure your headset is inactive while charging.

5



Red = charging. Green = fully charged (approximately 2 hrs.).

Turning your headset on

6

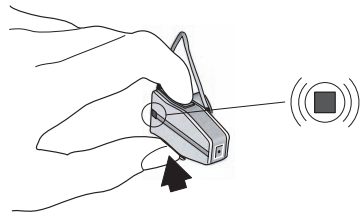

Press headset Answer/End button for 1 sec. Blue flash.

Bluetooth Hub Setup and Use (for Desk Phone)

Connecting Bluetooth Hub with desk phone and power supply

If your desk phone has a headset port, see instructions in inset.

For desk phones without headset port: if your desk phone has an electronic hookswitch lifter, or you are using a GN 1000 (remote handset lifter), please refer to the User Manual on the supplied CD-ROM for instructions.

1



Disconnect handset from desk phone.

2

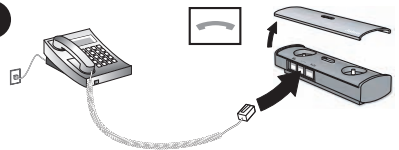

Connect handset to Bluetooth Hub.

3

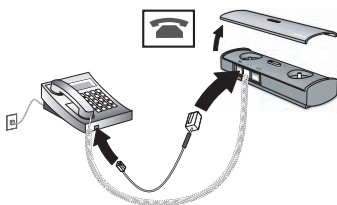

Connect desk phone with Bluetooth Hub using supplied connection cord (F).

4

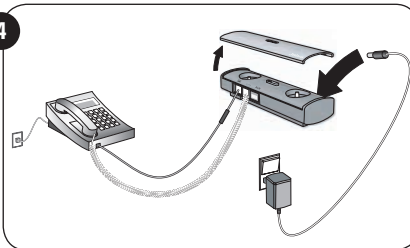

Connect power supply to Bluetooth Hub.



For desk phones with headset port

1

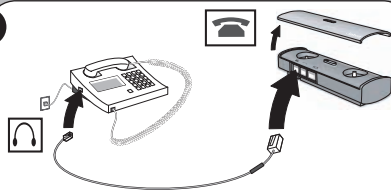

Connect desk phone with Bluetooth Hub using supplied connection cord (F).

2

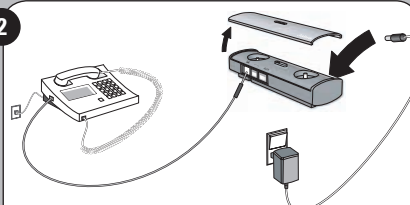

Connect power supply to Bluetooth Hub.

Making a test call on your desk phone to adjust settings

If your desk phone has an electronic hookswitch lifter, or you are using a GN 1000 (remote handset lifter), please refer to the User Manual on the supplied CD-ROM for instructions.

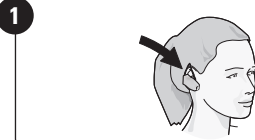

Place headset on ear.

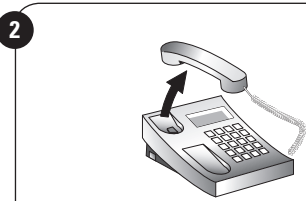

Lift desk phone handset.



For desk phones with headset port

2



Press the appropriate desk phone button to establish a clear dial tone.

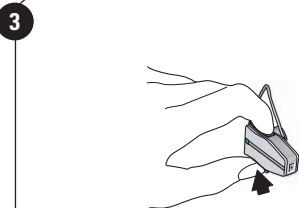

Tap headset Answer/End button.

4



Listen for dial tone in headset.

English

5



If necessary, find a clear dial tone via settings A-G on Bluetooth Hub Dial Tone Finder is preset to setting A (most commonly used).

6

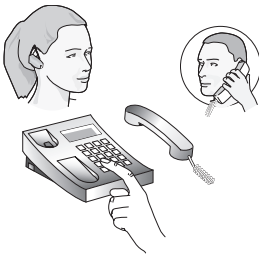

Dial a friend to test settings.

7

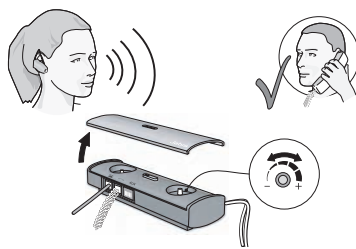

Adjust microphone volume (how your voice sounds to others) via Bluetooth Hub.

8

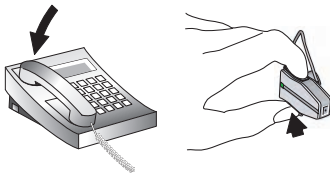

To end call, replace desk phone handset AND tap headset Answer/End button.

8



For desk phones with headset port

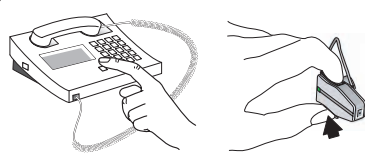

Press the appropriate button on desk phone AND tap headset Answer/End button.

Making and ending a call via desk phone

If your desk phone has an electronic hookswitch lifter, or you are using a GN 1000 (remote handset lifter), please refer to the User Manual on the CD-ROM for instructions.

1

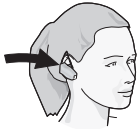

Place headset on ear.

2



Tap headset Answer/End button.

3



Lift desk phone handset.



For desk phones with headset port

3



Press the appropriate desk phone button to establish a clear dial tone.

4



Dial number.

4



Dial number.

English

5



Begin talking.

6

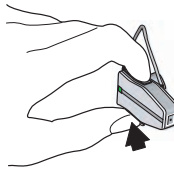

To end call, replace desk phone handset AND tap headset Answer/End button.



For desk phones with headset port

6

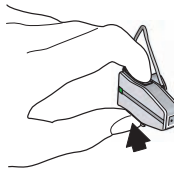

For desk phones with headset port, press the appropriate button on desk phone AND tap headset Answer/End button.

Answering an incoming call to desk phone

If your desk phone has an electronic hookswitch lifter, or you are using a GN 1000 (remote handset lifter), please refer to the User Manual on the CD-ROM for instructions.

1

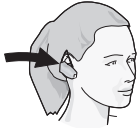

Place headset on ear.

2



Tap headset Answer/End button.

3



Lift desk phone handset.



For desk phones with headset port

3



Press the appropriate desk phone button to establish a clear dial tone.

4



Begin talking.

Mobile Phone Setup and Use

Pairing headset to mobile phone (establishes Bluetooth connection)

1



See your mobile phone User Guide for Bluetooth pairing instructions.

2

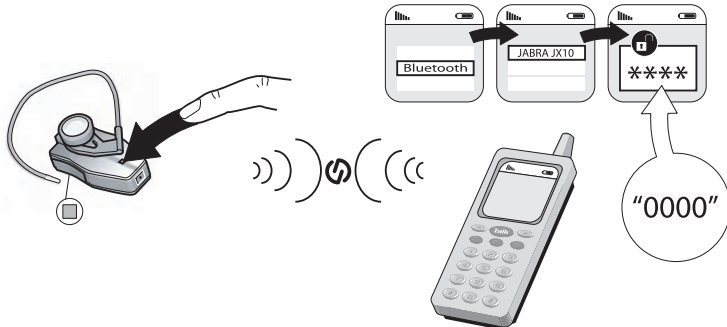

Press headset pairing button for 1 sec.
Blue light indicates open for pairing (5 minutes).

Mobile Phone Use**Making and ending a call from mobile phone****1**

Place headset on ear. Dial number on mobile phone and tap Talk/Yes or similar.

2

Begin talking. To end call, press End/No or similar on mobile phone OR tap headset Answer/End button.

English

Using Voice Dial (if your mobile phone supports this feature)

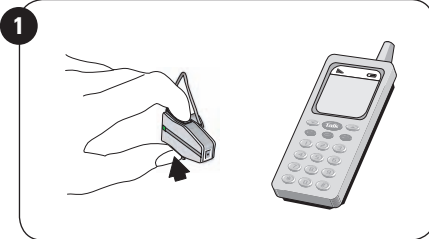

Press headset Answer/End button for 1 sec.

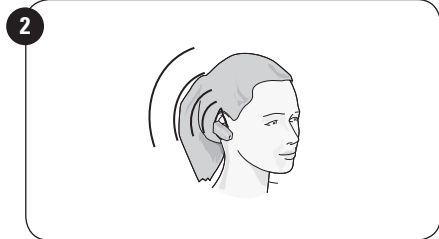

Hear voice dial signal. (Mobile phone dependent)

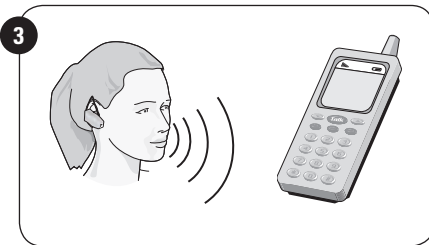

Give voice dial command.

Answering an incoming call to mobile phone



Tap headset Answer/End button.

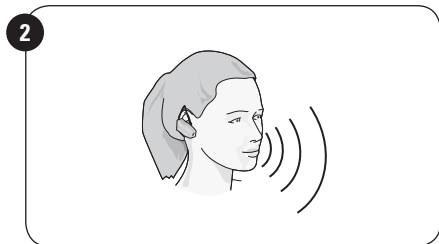

Begin talking.

Quick Reference

Operating the Answer/End button

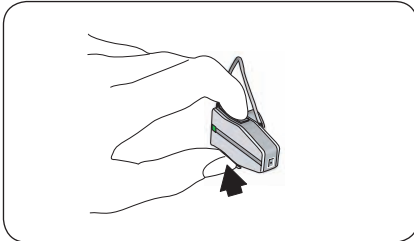

How to...	Headset Answer/End button action
Turn power on	Press for 1 sec
Turn power off	Press and hold for 5 sec
Make call via desk phone	Tap
Make call via mobile phone Voice Dial (if mobile phone has feature)	Press for 1 sec
Redial last outgoing number (from mobile phone)	Double tap
Answer all calls	Tap
End all calls	Tap
Reject a call (to your mobile phone)	Press for 1 sec
Put a call on hold	Press for 1 sec
Switch between two active calls	Press for 1 sec
End active call when another is on hold	Tap

English

Quick Reference

What the lights mean

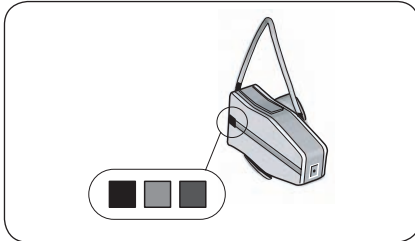

■ Red ■ Blue ■ Green

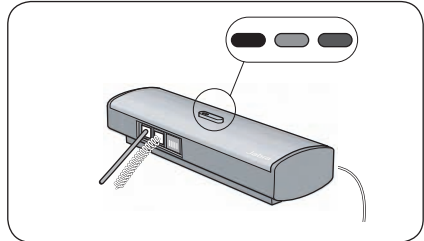

● Red ● Blue ● Green

Headset	
Green steady	Charge complete
Blue slow flash	Headset on
Blue fast flash	Call in progress
Blue steady	Headset in pairing mode
Red flash	Low battery
Red steady	Charge in progress

Bluetooth Hub	
Green steady	Bluetooth Hub on
Blue steady	Pairing in progress
Blue flash 10 times	Pairing successful
Red flash	Bluetooth Hub needs to be reset
Red steady	Reset in progress

Your Jabra JX 10 with Bluetooth Hub has a number of additional features including last number redial and call waiting. Please refer to the CD-ROM for complete User Manual (PDF) and animated installation (Flash).

Range:	Up to 10 meters/33 feet
Talk time:	Up to 6 hours
Standby time:	Up to 200 hours
Charge time:	Up to 2 hours