

© 2006 Jabra, GN Mobile A/S (GN Netcom A/S). All rights reserved. Jabra® is a registered trademark of GN Mobile A/S (GN Netcom A/S). All other trademarks included herein are the property of their respective owners. The Bluetooth® word mark and logos are owned by the Bluetooth SIG, Inc. and any use of such marks by GN Mobile A/S (GN Netcom A/S) is under license.
(Design and specifications subject to change without notice)



Jabra A 125s

www.jabra.com

Made in China

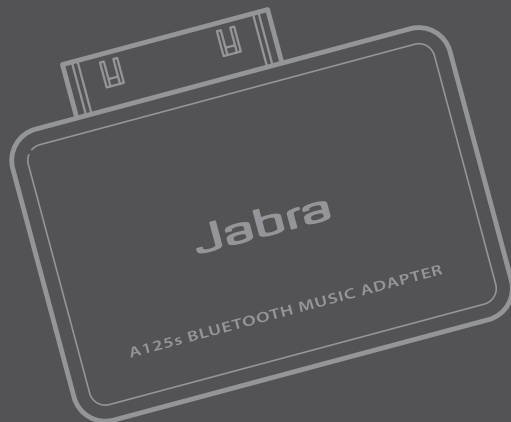

RELEASE YOUR JABRA

Jabra

Bluetooth music adapter

User manual

Jabra

Customer Contact Details:

Phone Number: 0800 0327026

Email Address: support.uk@jabra.com

PART NUMBER

Jabra

A125s

RELEASE YOUR JABRA

1. Thank you	3
2. About your Jabra A125s	3
3. What your Jabra A125s can do	3
4. Getting started	4
5. Charging your Jabra A125s	4
6. Turning on your Jabra A125s	4
7. Pairing with a headset or other device	4
8. Using the Jabra A125s	5
9. What the lights mean	6
10. Troubleshooting & FAQ	6
11. Need more help?	6
12. Certification and safety approvals	6
13. Taking care of your music adapter	7
14. Warranty	8
15. Glossary	8

1. Thank you

Thank you for purchasing the Jabra A125s Bluetooth® Music Adapter designed for most iPods. We hope you enjoy it! You will discover a new way of enjoying your music – wirelessly!

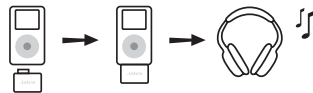

This instruction manual will get you started and ready to make the most of your adapter.

When the Jabra A125s is connected to the iPod, handle your iPod and Jabra A125s with care.

2. About your Jabra A125s

1. Light indicator (LED) and multi-function button
2. Charging socket
3. Dock connector for iPod

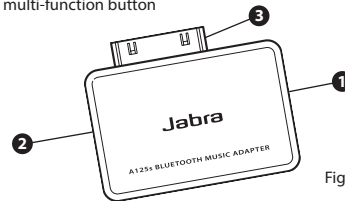

Fig 1

3. What your Jabra A125s can do

Your Jabra A125s is designed to work with any Jabra Bluetooth stereo headset such as the Jabra BT620s. The adapter connects with most iPods, iPod Minis and Nanos via iPod dock connector.



Specifications:

- Up to 10 hours of music - standby time up to 250 hours
- Rechargeable battery with charging option from PC via USB cable, AC power supply (not included in the pack), or car charger (not included)
- Weight 22 grams (¾ oz)
- Operating range up to 10 metres (33 feet)
- Advanced Audio (A2DP), Remote Control (AVRCP) (see glossary page 9)
- Bluetooth specification 1.2 (see glossary page 9)

Jabra A125s Bluetooth music adapter

What's in the pack?

- Jabra A125s Bluetooth music adapter
- USB charger for charging from any PC or laptop
- User manual

4. Getting started

The Jabra A125s is easy to operate. The multi-function button performs different functions depending on how long you press them:

Instruction:	Duration of press:
Tap	Press briefly and let go
Press	Approx: 1 second
Press and hold	Approx: 5 seconds

5. Charging your Jabra A125s

Make sure that your Jabra A125s is fully charged for up to 6 hours before you start using it. Only use the chargers provided in the box or Jabra approved chargers such as the Jabra BT 620s AC charger – do not use chargers from any other devices as this might damage your Jabra A125s.

Connect the USB charger to your Jabra A125s charging socket (see fig 1)

When the LED is solid red, your music adapter is charging. When the light turns to green, the adapter is fully charged.

6. Turning on your Jabra A125s

- **Press the multi-function button** to turn on your Jabra A125s – when the adapter is on the LED will flash
- **Press and hold** the button to turn the device off.

7. Pairing with a headset or other device

Before you use your Jabra A125s you must pair it with a Bluetooth headset or headphone

- Make sure the headset and Jabra A125s are turned off

1. Put the headset into pairing mode:

Refer to your headset's manual for pairing mode instructions, if you are pairing with the Jabra BT620s:

- **Press and hold** the answer/end button until the LED is solid blue.
- 2. **Put your Jabra A125s in pairing mode**
- **Press and hold** the multi-function button until the LED light is solid blue
- 3. **Connect your Jabra A125s to your iPod via the dock connector**

4. Your Jabra A125s will find and connect to the headset

- Within 1 minute the headset LED will start to flash and the adapter will start to flash slowly. Press play on your audio device. Sound will start to play in the headset. If the headset LED is still solid blue after 1 minute repeat sections 2 and 3.

NOTE: If you have a Jabra Bluetooth headset such as the Jabra BT620s, you can connect your mobile phone and your iPod simultaneously.

To pair two devices, first pair and connect your headset with your mobile phone (follow the instructions from your headset) and then pair your headset with the Jabra A125s as instructed above.

8. Using the Jabra A125s

Start playing music

- Make sure that your headset is turned on before turning on the music adapter. The music adapter will then connect automatically to your headset.
- Tap the button on the music adapter or use your headset play/pause button* to play or pause the music

Other music features supported by your Jabra A125s*

Playing music from your Bluetooth stereo headset such as the Jabra BT620s

- The prominent center button on the right side of the device is the play button. On the top there are the skip forward ► and skip back ◀ buttons.

To start play*

- **Tap** the play button once.

To pause*

- **Tap** the play button – tap again to resume playing.

Answer a call when playing music*

- **Tap** the answer/end button to pause the music and the call will be connected. The music will resume after the call has ended (depending on the device supporting this feature).

Skip one track forward*

- **Tap** the skip forward button - continue tapping to skip several tracks forward.

Skip one track back*

- **Tap** the skip back button - continue tapping to skip several tracks backward.

Fast forward*

- **Press and hold** the skip forward button.

Fast rewind*

- **Press and hold** the skip back button.

* Device dependent - These features will work when the headset you are connected to supports Bluetooth remote control (AVRCP) profile. Many headsets like the Jabra BT620s support this feature.

Connect to the headset manually

- **Tap** the button on the music adapter. (Make sure that the headset is switched on)

9. What the lights mean

What you see	Status
Solid red	Charging
Flashing red	Low battery
Solid green	Fully charged
Solid blue	Pairing mode
Soft flashing blue (every 3 sec)	Streaming connection is established
Flashing rapidly blue	Searching for devices

10. Troubleshooting and FAQ

Please see the headset's manual for further information regarding the headset.

I hear crackling noises

Bluetooth is a radio technology which means it is sensitive to objects between the headset and the device it is connected to. You should be able to have 10 metres (33 feet) of distance between the headset and the connected device when there are no major objects in the way (Walls etc.)

I cannot hear anything in the headset

Increase the volume in the headset and on the music player. Ensure that the headset is paired to a device that is playing. Make sure that music is playing on the audio device.

I have pairing problems

Ensure that both devices are fully charged and repeat all mentioned steps under pairing.

11. Need more help?

Jabra offers customer support online at www.jabra.com or you can see the inside cover for the support details for your country.

12. Certification and safety approvals

FCC

This device complies with part 15 of the FCC Rules. Operation is subject to the following two conditions: (1) This device may not cause harmful interference, and (2) this device must accept any interference received, including interference that may cause undesired operation. Users are not permitted to make changes or modify the device in any way. Changes or modifications not expressly approved by Jabra will void the user's authority to operate the equipment. This equipment has been tested and found to comply with the limits for a Class B digital device, pursuant to part 15 of the FCC Rules. These limits are designed to provide reasonable protection against harmful interference in a residential installation. This equipment generates,

uses and can radiate radio frequency energy and, if not installed and used in accordance with the instructions, may cause harmful interference to radio communications. However, there is no guarantee that interference will not occur in a particular installation. If this equipment does cause harmful interference to radio or television reception, which can be determined by turning the equipment off and on, the user is encouraged to try to correct the interference by one or more of the following measures:

- Reorient or relocate the receiving antenna.
- Increase the separation between the equipment and receiver.
- Connect the equipment into an outlet on a circuit different from that to which the receiver is connected.
- Consult the dealer or an experienced radio/TV technician for help.

The user must place the base 8" (20cm) or more from any personnel in order to comply with FCC RF exposure requirements.

CE

This product is CE marked according to the provisions of the R & TTE Directive (99/5/EC).

Hereby, GN Netcom, declares that this product is in compliance with the essential requirements and other relevant provisions of Directive 1999/5/EC. For further information please consult <http://www.jabra.com>

Within the EU this device is intended to be used in Austria, Belgium, Cyprus, Czech Republic, Denmark, Estonia, Finland, France, Germany, Greece, Hungary, Ireland, Italy, Latvia, Lithuania, Luxembourg, Malta, Poland, Portugal, Slovakia, Slovenia, Spain, Sweden, The Netherlands, United Kingdom, and within EFTA in Iceland, Norway and Switzerland

Bluetooth

The Bluetooth® word mark and logos are owned by the Bluetooth SIG, Inc. and any use of such marks by GN Netcom is under license. Other trademarks and trade names are those of their respective owners.

13. Taking care of your music adapter

- Always store the Jabra A125s with the power off and safely protected.
- Avoid storage at extreme temperatures (above 45°C/113°F – including direct sunlight – or below -10°C/14°F). This can shorten battery life and may affect operation. High temperatures may also degrade performance.
- Do not expose the Jabra A125s to rain or other liquids.

14. Warranty

Jabra (GN Netcom) warrants this product against all defects in material and workmanship for a period of two years from the date of original purchase. The conditions of this warranty and our responsibilities under this warranty are as follows:

- The warranty is limited to the original purchaser
- A copy of your receipt or other proof of purchase is required.
- The warranty is void if the serial number, date code label or product label is removed, or if the product has been subject to physical abuse, improper installation, modification, or repair by unauthorized third parties
- The responsibility of Jabra (GN Netcom) products shall be limited to the repair or replacement of the product at its sole discretion
- Any implied warranty on Jabra (GN Netcom) products is limited to two years from the date of purchase on all parts, including any cords and connectors
- Specifically exempt from any warranty are limited-life consumable components subject to normal wear and tear, such as microphone windscreens, ear cushions, decorative finishes, batteries, and other accessories
- Jabra (GN Netcom) is not liable for any incidental or consequential damages arising from the use or misuse of any Jabra (GN Netcom) product
- This warranty gives you specific rights and you may have other rights which vary from area to area
- Unless otherwise instructed in the User Manual, the user may not, under any circumstances, attempt to perform service, adjustments or repairs on this unit, whether in or out of warranty. It must be returned to the purchase point, factory or authorized service agency for all such work
- Jabra (GN Netcom) will not assume any responsibility for any loss or damage incurred in shipping. Any repair work on Jabra (GN Netcom) products by unauthorized third parties voids any warranty

WARNING: Improper connection, modifications, alterations, unauthorized repairs, dropping, hitting and other misuse or abuse of the product could damage the product and your iPod. Jabra shall have no liability for such damage.

15. Glossary

Bluetooth is a radio technology that connects devices, such as mobile phones and headsets, without wires or cords over a short distance (approx. 10 metres). Get more information at www.bluetooth.com

Bluetooth profiles are the different ways that Bluetooth devices communicate with other devices. Bluetooth phones support either the headset profile, the hands-free profile or both. In order to support a certain profile, a phone manufacturer must implement certain mandatory features within the phone's software.

Pairing creates a unique and encrypted link between two Bluetooth devices and lets them communicate with each other. Bluetooth devices will not work if the devices have not been paired.

Standby mode is when the Jabra A125s is on but not connected to a headset.

A2DP (Advanced Audio Distribution Profile) is a Bluetooth Profile that enables stereo sound. Both the adapter and the device it connects to must support A2DP in order to hear A2DP sound in the headset.

AVRCP (Audio Video Remote Control Profile) is a Bluetooth profile that enables remote control of the device that the headset is connected to. Both the headset and the device it connects to must support AVRCP in order for AVRCP to work.



Dispose of the product according to local standards and regulations. www.jabra.com/weee

Jabra A125s Bluetooth music adapter