



Using the Watch

Bluetooth Connection with a Smartphone

1. Hold down S2 for about 2 seconds to display the setting menu.
2. Please select "PAIRING".
3. Press S5 and then select "SMARTPHONE".
4. Press S5 and then select "CONNECT".
5. Press S5 to establish a Bluetooth connection.

Time adjustment

1. Hold down S2 for about 2 seconds to display the setting menu.
2. Please select "TIME ADJUST".
3. Press S5 and then select "AUTO".
4. Press S5 and then select "BLUETOOTH" or "TIME(GPS)".
 - "BLUETOOTH" : Adjust time with smartphone.
 - "TIME(GPS)" : Adjust time with GPS.
5. Press S5 to adjust the time in the specified way.



Hold down S2 for about 2 seconds

Select "PAIRING"

Setting menu

MENU(1/4)
 ▶ HOME TIME
 ▶ TIME ADJUS
 WORLD TIME
 ALARM

P10:58
 BARO

You can select the setting menu with S2 or S3.

Bluetooth Connection with a Smartphone

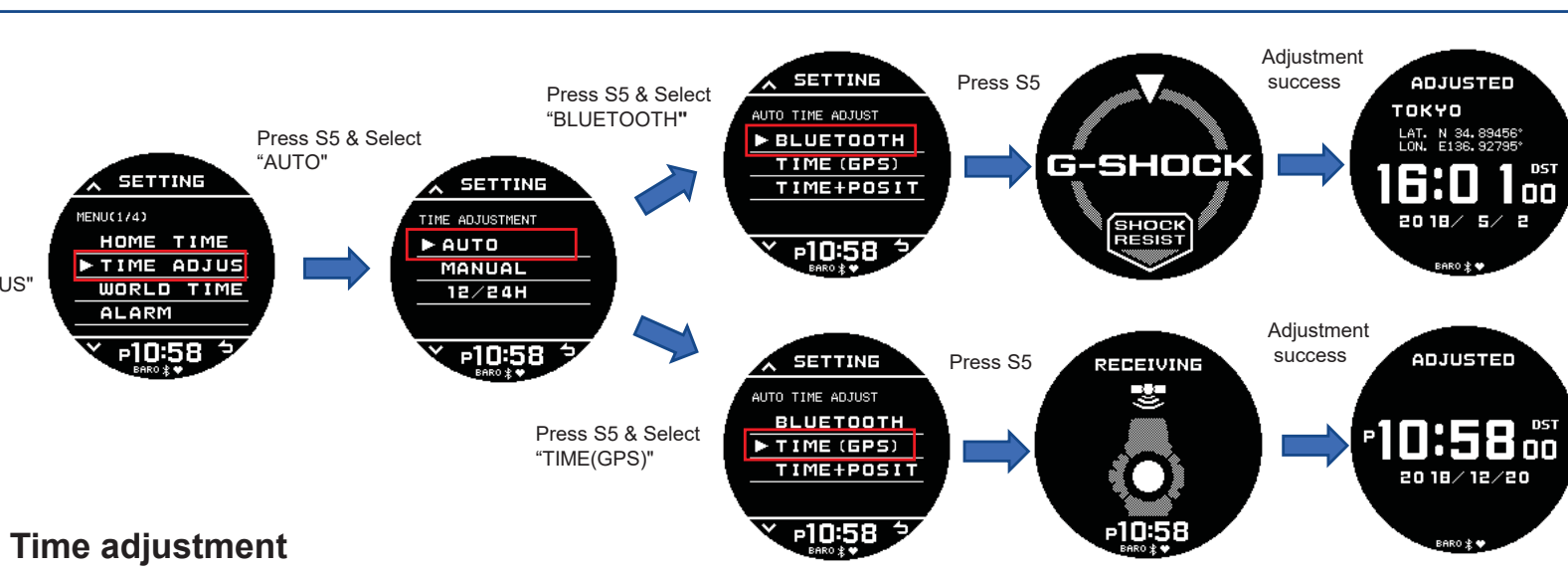
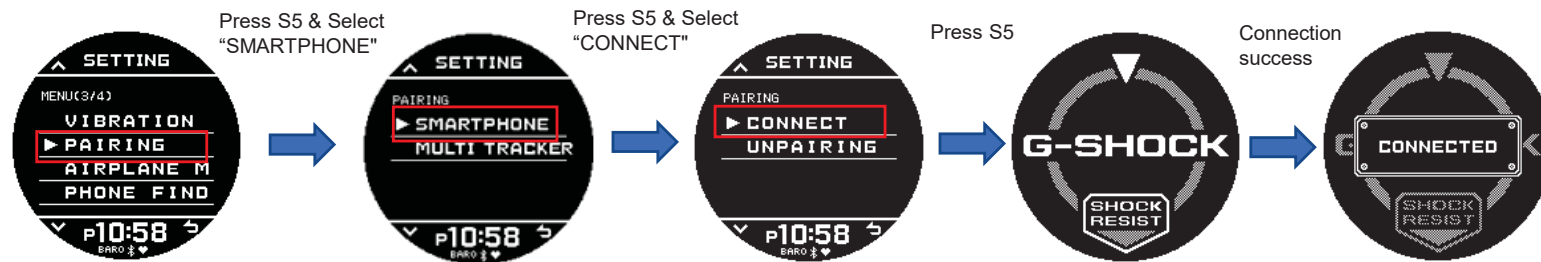

GSR-H1000_CW3491 Display of certificate number

1. Hold down S2 for about 2 seconds will changes to setting mode and "SETTING" is displayed.
2. You can select the setting menu with S2 or S3. Please select "REGULATORY".
3. Press S5, the certificate number will be displayed.
The screen changes with S2 or S3.

※Press S1 to return to the previous screen.

