

REMOVE CAMERA FROM WATERPROOF CASE
 1. To open the backdoor of the case, hold the camera so that you are looking at the screen and press the backdoor latch towards the right while pulling the latch towards you. Remove the camera from the case.

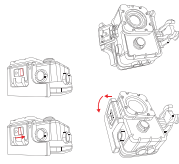

MOUNT BATTERY
 2. Slide the battery into the battery compartment on the bottom of the camera. Remove the cover by sliding the tab to release and pull from the camera. Use the battery provided in the package or the battery you purchased separately. Make sure the pins in the camera match the pins in the battery. Replace the cover.



CHARGE THE BATTERY
 3. Make sure to completely charge the battery before initial use. To charge the battery, use the USB cord provided in the package and plug into a power source while connected to the camera with the battery installed. The red LED light will illuminate while charging, and the battery symbol on the screen will show a full charge. Charging time for approximately 70 minutes on a fully charged battery.

BUCKLE MOUNTING SYSTEM
 6. Most of the ROX included accessories utilize the buckle mounting system. (An elastic adhesive mount is a skin surface at room temperature.)

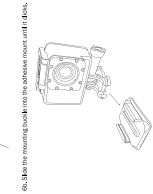

FIN-STYLE MOUNTING SYSTEM
 7. The ROX camera also utilizes the fin-style mounting system. Just unscrew the mounting screw from the back of the camera, insert the fin into the hole on the back of the camera, and push the camera into place. Then use the mounting screw to secure the camera to the surface.

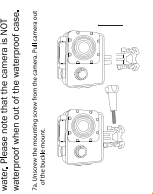

FIN-STYLE MOUNTING SYSTEM
 7. The ROX camera also utilizes the fin-style mounting system. Just unscrew the mounting screw from the back of the camera, insert the fin into the hole on the back of the camera, and push the camera into place. Then use the mounting screw to secure the camera to the surface.

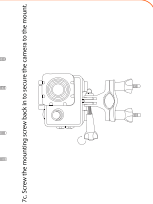

RECORD
 8. Toggle between video, photo, and playback modes by pressing the Power/Mode button on the top of the camera. Press the button marked "OK" on the top of the camera. Press the button again to stop the recording.

WASPCAM ROX APP
 9. The WASPCam ROX App lets you view and store video without the need to connect to a computer. Download the WASPCam ROX App from the App Store or Google Play Store. Turn Wi-Fi on the camera by holding the up button on the side of the camera. Connect the camera to your smartphone and connect to the camera with the Wi-Fi SSID and Password shown on the camera screen.

FCC STATEMENT
 Changes or modifications not expressly approved by the user's authority to operate the equipment. This equipment has been tested and found to comply with the requirements of Part 15 of the FCC Rules. These limits are designed to provide reasonable protection against harmful interference that may be caused by this equipment. This equipment generates uses and can radiate radio frequency energy and may cause harmful interference to radio communications. However, there is no guarantee that interference will not occur in a particular installation. If the equipment does cause harmful interference to radio or television reception, which can be determined by turning the equipment off and on, the user is encouraged to try to correct the interference by one or more of the following measures:
 -- Reorient or relocate the receiving antenna.
 -- Increase the separation between the equipment and the receiver.
 -- Connect the equipment into an outlet on a circuit different from that to which the receiver is connected.
 -- Consult the dealer or an experienced radio/TV technician for help.

FCC STATEMENT
 (1) This device may not cause harmful interference, and (2) this device must accept any interference that is received. This interference may cause undesired operation.
 The IC Statement of this device complies with Industry Canada's license-exempt RSS. Operation is subject to the following conditions:
 (1) This device must not cause interference; and
 (2) this device must accept any interference, including that which may cause undesired operation of the device.
 Le présent appareil est conforme aux CNR d'Industrie Canada applicables aux appareils radio exempts de licence. L'exploitation est autorisée aux deux conditions suivantes: (1) l'appareil ne doit pas produire d'interférence nuisible; (2) l'appareil doit accepter toute interférence radioélectrique qu'il pourrait subir, y compris toute interférence nuisible susceptible d'être causée par un autre appareil.

FCC STATEMENT
 Changes or modifications not expressly approved by the user's authority to operate the equipment. This equipment has been tested and found to comply with the requirements of Part 15 of the FCC Rules. These limits are designed to provide reasonable protection against harmful interference that may be caused by this equipment. This equipment generates uses and can radiate radio frequency energy and may cause harmful interference to radio communications. However, there is no guarantee that interference will not occur in a particular installation. If the equipment does cause harmful interference to radio or television reception, which can be determined by turning the equipment off and on, the user is encouraged to try to correct the interference by one or more of the following measures:
 -- Reorient or relocate the receiving antenna.
 -- Increase the separation between the equipment and the receiver.
 -- Connect the equipment into an outlet on a circuit different from that to which the receiver is connected.
 -- Consult the dealer or an experienced radio/TV technician for help.

FCC STATEMENT
 Changes or modifications not expressly approved by the user's authority to operate the equipment. This equipment has been tested and found to comply with the requirements of Part 15 of the FCC Rules. These limits are designed to provide reasonable protection against harmful interference that may be caused by this equipment. This equipment generates uses and can radiate radio frequency energy and may cause harmful interference to radio communications. However, there is no guarantee that interference will not occur in a particular installation. If the equipment does cause harmful interference to radio or television reception, which can be determined by turning the equipment off and on, the user is encouraged to try to correct the interference by one or more of the following measures:
 -- Reorient or relocate the receiving antenna.
 -- Increase the separation between the equipment and the receiver.
 -- Connect the equipment into an outlet on a circuit different from that to which the receiver is connected.
 -- Consult the dealer or an experienced radio/TV technician for help.