



Cobra® 29 LTD BT

The CB Story

Cobra Electronics Corporation
6500 West Cortland Street
Chicago, IL 60707 USA

If You Think You Need Service

For technical assistance, please call our Automated Help Desk which can assist you by answering the most frequently asked questions about Cobra products.

773-889-3087

24 hours a day, 7 days a week.

A Consumer Service Representative can be reached at 773-889-3087
8:00 am - 6:00 pm, Monday through Friday, Central Time.

Technical assistance is also available on-line in the Frequently Asked Questions (FAQ) section at www.cobra.com or by e-mail to productinfo@cobra.com

If you think you need service call 773-889-3087

"If your product should require factory service please call Cobra first before sending your unit in. This will ensure the fastest turn-around time on your repair."

You may be asked to send your unit to the Cobra factory. It will be necessary to furnish the following in order to have the product serviced and returned.

1. For Warranty Repair include some form of proof-of-purchase, such as a mechanical reproduction or carbon or a sales receipt. If you send the original receipt it cannot be returned.
2. Send the entire product.
3. Enclose a description of what is happening with the unit. Include a typed or clearly print name and address of where the unit is to be returned.
4. Pack unit securely to prevent damage in transit. If possible, use the original packing material.
5. Ship prepaid and insured by way of a traceable carrier such as United Parcel Service (UPS) or First Class Mail: to avoid loss in transit to: Cobra Factory Service, Cobra Electronics Corporation, 6500 West Cortland Street, Chicago, IL 60707 USA.
6. If the unit is in warranty, upon receipt of your unit it will either be repaired or exchanged depending on the model. Please allow approximately 3 to 4 weeks before contacting us for status. If the unit is out of warranty a letter will automatically be sent informing you of the repair charge or replacement charge. If you have any questions, please call 773-889-3087 for assistance.

Cobra®, Dynamike®, Nothing Comes Close to a Cobra® and the snake design are registered trademarks of Cobra Electronics Corporation, USA.

Cobra Electronics Corporation™ is a trademark of Cobra Electronics Corporation, USA.

The Bluetooth® word mark and logo are registered trademarks owned by Bluetooth SIG, Inc.

Operating Instructions for your Cobra 29 LTD BT



Patent Pending

© 2008 Cobra Electronics Corporation
Version B
Printed in China

Part No. 480-455-P

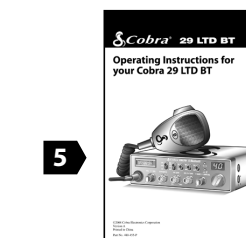
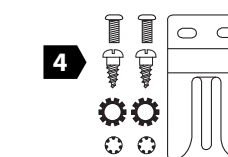
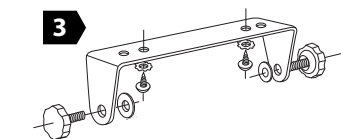
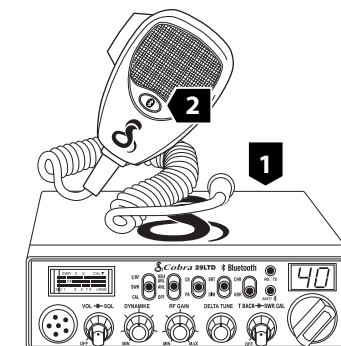

The Citizens Band lies between the shortwave broadcast and 10-meter Amateur radio bands, and was established by law in 1949. The Class D two-way communications service was opened in 1959. (CB also includes a Class A citizens band and Class C remote control frequencies.)

FCC Regulations

FCC regulations permit only "transmissions" (one party to another) rather than "broadcasts" (to a wide audience). Thus, advertising is not allowed on CB Channels because that is "broadcasting."

FCC Warnings

All transmitter adjustments other than those supplied by the manufacturer as front panel operating controls, must be made by, or under the supervision of, the holder of an FCC-issued general Radio-Telephone Operator's License.

Replacement or substitution of transistors, regular diodes or other parts of a unique nature, with parts other than those recommended by Cobra, may cause violation of the technical regulations of Part 95 of the FCC Rules, or violation of Type Acceptance requirements of Part 2 of the Rules.

You should read and understand Part 95 (included with this unit) of the FCC Rules and Regulations, before operating your Cobra radio, even though the FCC no longer requires you to obtain an operator's license.

What's Included with Your 29 LTD BT

- | | |
|--------------------------------------|------------------------------|
| 1. CB transceiver | 5. Operating manual |
| 2. Microphone with Bluetooth® Button | 6. DC power cord (not shown) |
| 3. Transceiver bracket | 7. FCC rules (not shown) |
| 4. Microphone bracket | |

Controls and Indicators

1. 6-Pin Microphone Connector
2. Power On/Off/Volume/ Squelch Control
3. Dynamike®
4. RF Gain
5. Delta-Tune
6. SWR CAL / Talk Back
7. Channel Selector
8. LED Channel Display
9. ANT Indicator and Bluetooth® LED Indicator
10. RX (Receive)/ TX (Transmit) LED Indicator
11. Channel 9/ Normal Switch
12. Dimmer Switch
13. CB/PA Switch
14. NB/ANL ANL Off Switch
15. S/RF SWR CAL Switch
16. Signal Strength Meter
17. Microphone
18. Bluetooth Button

Back Side

19. External Bluetooth Microphone Jack
20. Public Address Speaker Jack
21. External Speaker Jack
22. Power Jack
23. Antenna Connector

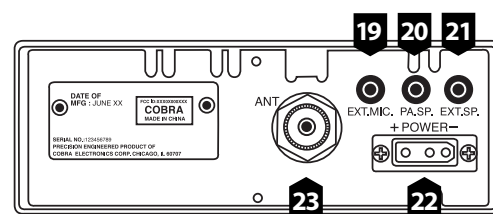
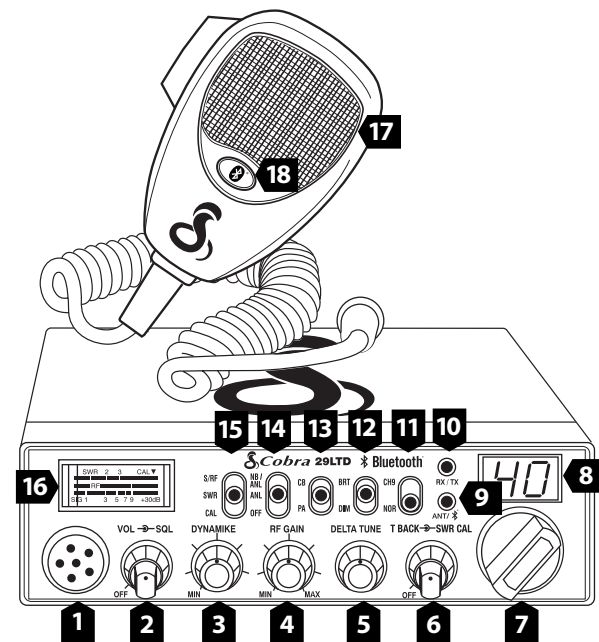

Our Thanks to You

Thank you for purchasing the Cobra 29 LTD BT CB Radio. Properly used, this Cobra product will give you many years of reliable service.

Customer Support

Should you encounter any problems with the product or not understand its many features, please refer to this owner's manual. If, after referring to the manual, you still need help, call Cobra Customer Service at 773-889-3087.



NOTE

This device complies with part 15 of the FCC Rules. Operation is subject to the following two (2) conditions:
1. This device may not cause harmful interference, and
2. This device must accept any interference received, including interference that may cause undesired operation.

Cobra Customer Service

Live operators are available
M-F 8:00 am - 6:00 pm Central
Time at: 773-889-3087

Automated Technical Assistance
available 24 hours a day, seven
days a week. E-mail questions
to: productinfo@cobra.com

Cobra on the World Wide Web:
Frequently Asked Questions
(FAQ) can be found on-line at:
www.cobra.com

Accessory Order Info

Ordering From U.S.A.

Call 773-889-3087 for pricing or visit www.cobra.com.

For Credit Card Orders

Call 773-889-3087 [Press one from the main menu] 8:00 a.m. to 6:00 p.m. Central Time, Monday through Friday.

Make Check or Money Order Payable To

Cobra Electronics, Attn: Accessories Dept.,
6500 West Cortland Street, Chicago, IL 60707 U.S.A.

To Order Online

Please visit our website: www.cobra.com

Item #	Description
426-002-N-001	Replacement DC Power Cord
251-353-9-001	Replacement Mounting Bracket
634-081-9-001	Replacement Thumb Screws
741-080-9-001	Replacement Microphone Bracket
HG A1000	21" Base Loaded, Magnetic Mount Antenna
HG A1500	38" Base Loaded Magnetic Mount Antenna
MNA MIC	External Bluetooth Microphone