

NOTES: (UNLESS OTHERWISE SPECIFIED)

1. BLACK GRAPHICS AND TYPE ON 2 MIL MYLAR WITH PRESSURE SENSITIVE PERMANENT ADHESIVE FOR USE ON ABS PLASTIC, 1 MIL CLEAR MYLAR OVERLAY.
2. COLOR PER ANSI Z535.1.

REVISIONS				
GCO	REV	DESCRIPTION	DATE	APPROVAL
00877	-	ORIGINAL ISSUE		

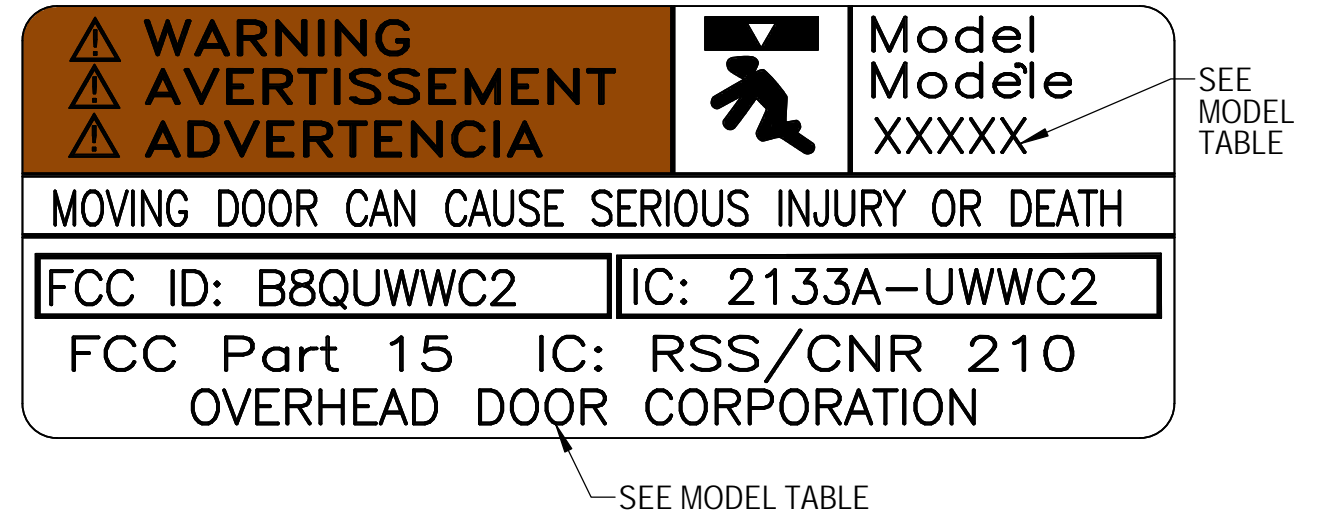
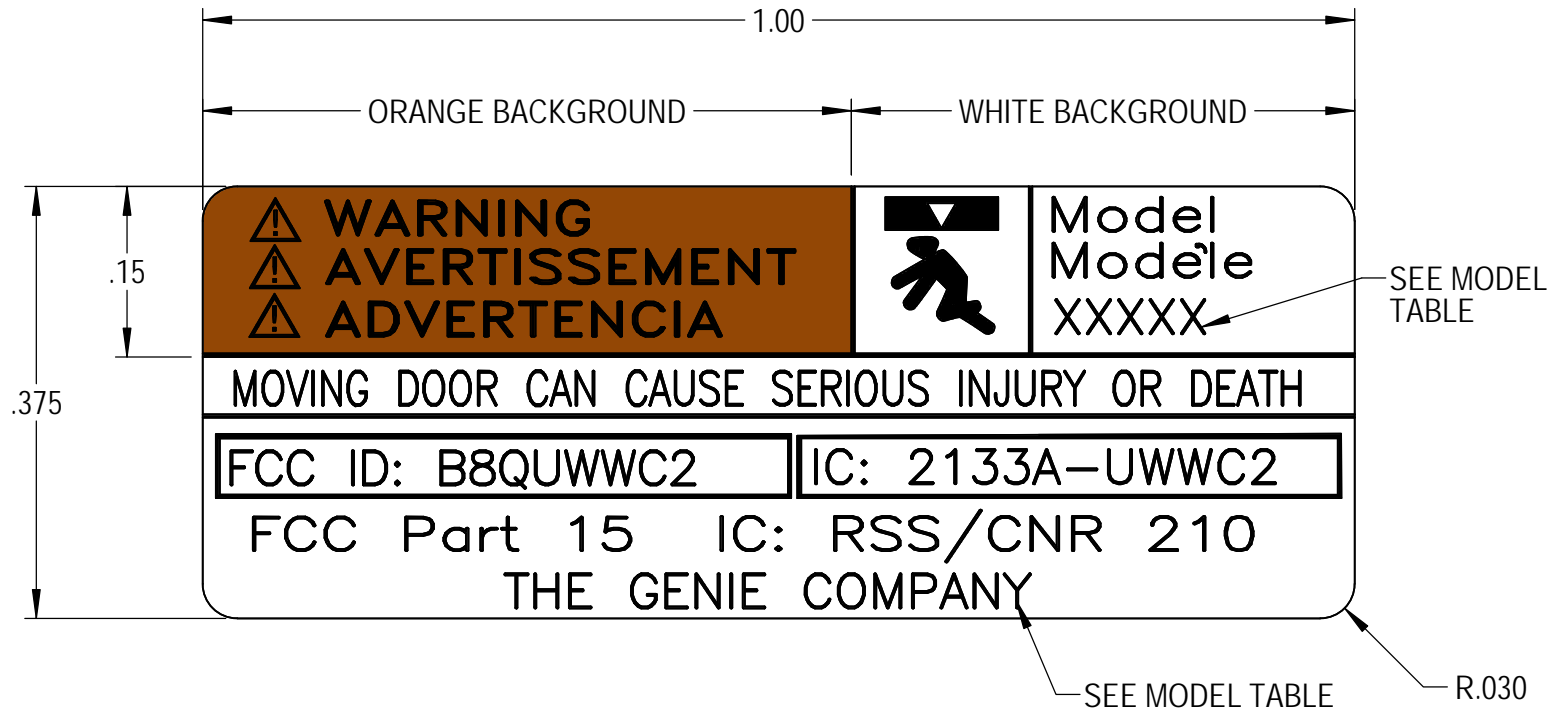

MODEL TABLE		
PART NUMBER	MODEL NUMBER	COMPANY NAME
41805A	GUWWC2	THE GENIE COMPANY
41805B	OUWWC2	OVERHEAD DOOR CORPORATION

PRELIMINARY

PLOTTED: 7/14/21

<p>THE DRAWINGS AND ALL OTHER INFORMATION CONTAINED HEREIN ARE THE CONFIDENTIAL PROPRIETARY PROPERTY OF OVERHEAD DOOR CORPORATION, INCLUDING ITS AFFILIATED SUBSIDIARIES AND AFFILIATES. THIS DRAWING INFORMATION, IN WHOLE OR IN PART, MAY NOT BE COPIED IN ANY MANNER OR DISCLOSED TO ANYONE WITHOUT PRIOR WRITTEN CONSENT OF OVERHEAD DOOR CORPORATION. DISCLOSURE OF ANY DRAWING OR INFORMATION IS INTENDED NOT TO AND SHALL NOT OPERATE AS A LICENSE OR AUTHORIZATION TO USE IT FOR ANY PURPOSE WITHOUT SPECIFIC WRITTEN CONSENT OF OVERHEAD DOOR CORPORATION.</p>	<p>UNLESS OTHERWISE SPECIFIED</p> <p>INTERPRET DIMS &amp; TOLS PER ASME Y14.5M</p> <p><b>ALL DIMS ARE IN INCHES</b></p> <p>DO NOT SCALE</p> <p>DIMS AND SPECIFICATIONS CIRCLED WITH SYMBOL 'C' ARE CRITICAL TO QUALITY DESIGN FEATURES &amp; MUST MEET APPLICABLE IN-PROCESS INSPECTION STANDARDS.</p>		<p>APPROVALS DATE</p> <p>DRAWN WDR 7/14/21</p> <p>CHECKED</p> <p>APPROVED</p> <p>MATERIAL</p> <p>FINISH</p>	<p><b>GENIE</b> A SUBSIDIARY OF OVERHEAD DOOR CORPORATION MT. HOPE, OHIO</p> <p>DESCRIPTION</p> <p><b>LABEL, FCC, UNIV WIRELESS WALL CONSOLE</b></p> <p>SIZE DWG NO.</p> <p><b>B 41805</b></p> <p>SCALE 6:1 SHEET 1 OF 1</p>
	<p>TOLERANCES:</p> <p>.X = ±.1</p> <p>.XX = ±.01</p> <p>.XXX = ±.005</p> <p>ANGULAR = ±1°</p>		<p>ALL GEOMETRY GOVERNED BY 3D CAD DATABASE: 41805</p>	
	<p>HOLES:</p> <p>&lt; Ø.251 = ±.003</p> <p>Ø.251-Ø.500 = ±.003</p> <p>&gt; Ø.500 = ±.003</p>			

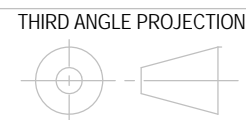

**NOTES: (UNLESS OTHERWISE SPECIFIED)**

ANY ONE FAILURE OF TESTS INDICATED BELOW IS A FAILURE OF THE ENTIRE UNIT.

1. TRANSMITTER MUST OPERATE ON EACH OF THE FOLLOWING FREQUENCIES (IN MHz) :303,310,315,318,372.5,390 AND 433.92
2. EACH BUTTON MUST OPERATE ON ANY OF THE FREQUENCIES LISTED IN NOTE 1.
3. MUST MEET 500 FEET OPEN FIELD RANGE SPECIFICATIONS AT ALL FREQUENCIES LISTED IN NOTE 1.
4. VERIFY FIT IS VISUALLY ACCEPTABLE AND MEETS APPLICABLE GENIE PRINTS.
5. COSMETICS/VISUAL APPEARANCE:
  - A. COLOR TO MATCH PANTONES SPECIFIED ON PRINT
  - B. NO MARKS, SCRATCHES OR IMPERFECTION OF ANY KIND AS JUDGED FROM A DISTANCE OF 18" UNDER FLUORESCENT LIGHTING.
6. LABEL PLACEMENT:
  - A. CHECK FCC LABEL PER DRAWING.
  - B. FCC LABEL SHALL BE STRAIGHT AND CONSISTENT ON ALL UNITS.
7. LOGO:
  - A. LOGO SHALL BE STRAIGHT AND CONSISTENT ON ALL UNITS.
  - B. LOGO SHALL BE READABLE.
8. VERIFY UNIT IS BUILT TO PURCHASED REVISION.
9. EACH UNIT MUST PASS FUNCTIONAL TESTS.
10. EACH UNIT MUST NOT BREAK WHILE CHANGING BATTERY AND EASILY BE REASSEMBLED.
11. PROGRAMMING INSTRUCTIONS ARE PROVIDED IN THE INSTRUCTION SHEET.

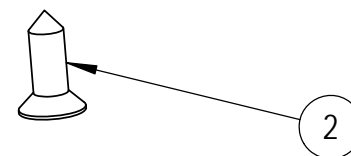
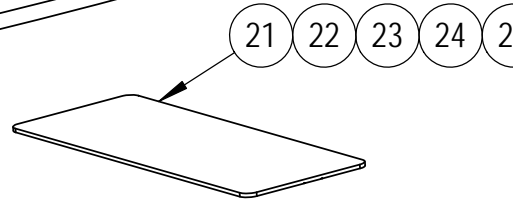
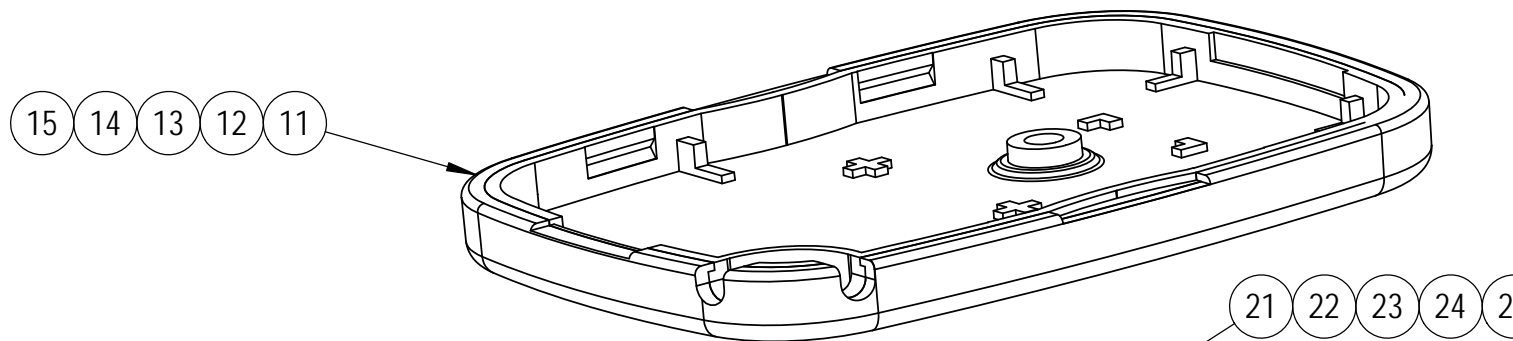
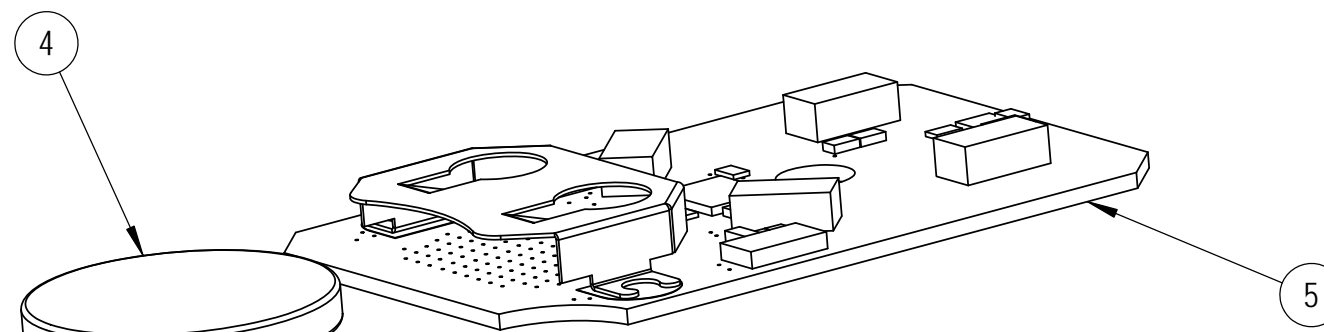
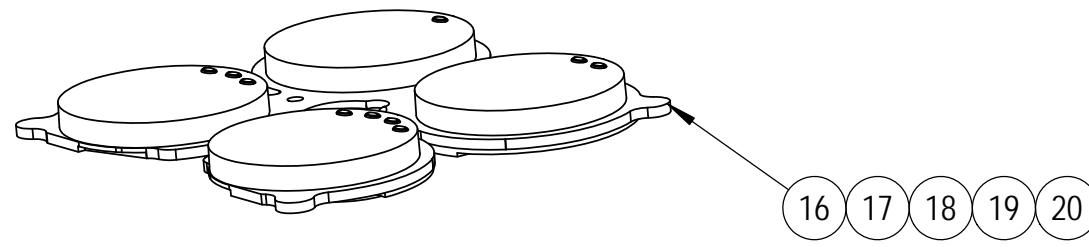
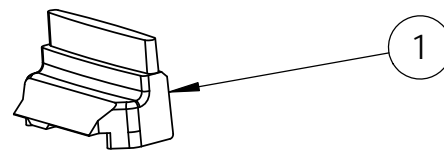
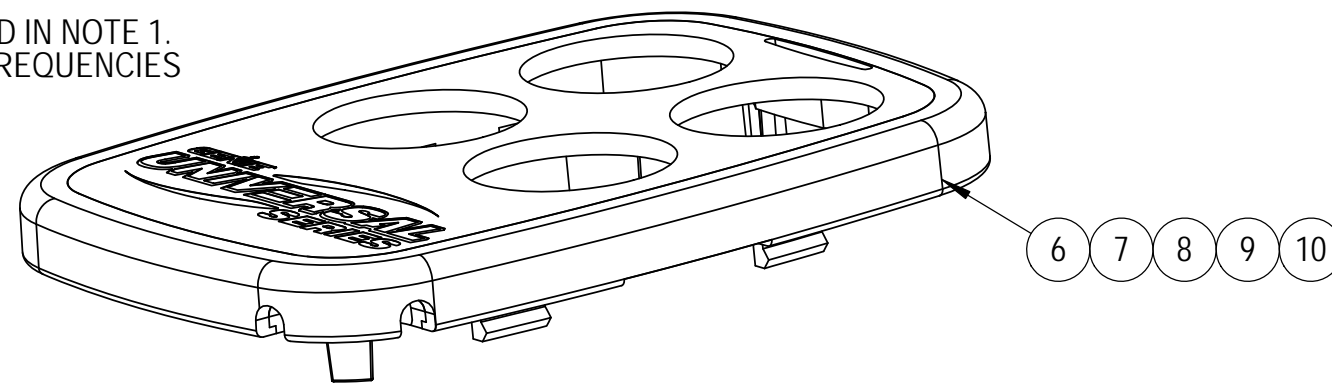

39877R: GENIE MODEL GU4T  
 39877T: GENIE MODEL GU4TR  
 39877U: GENIE MODEL GU4TB  
 39877V: GENIE MODEL GU4TG

39877S: OHD MODEL OU4T

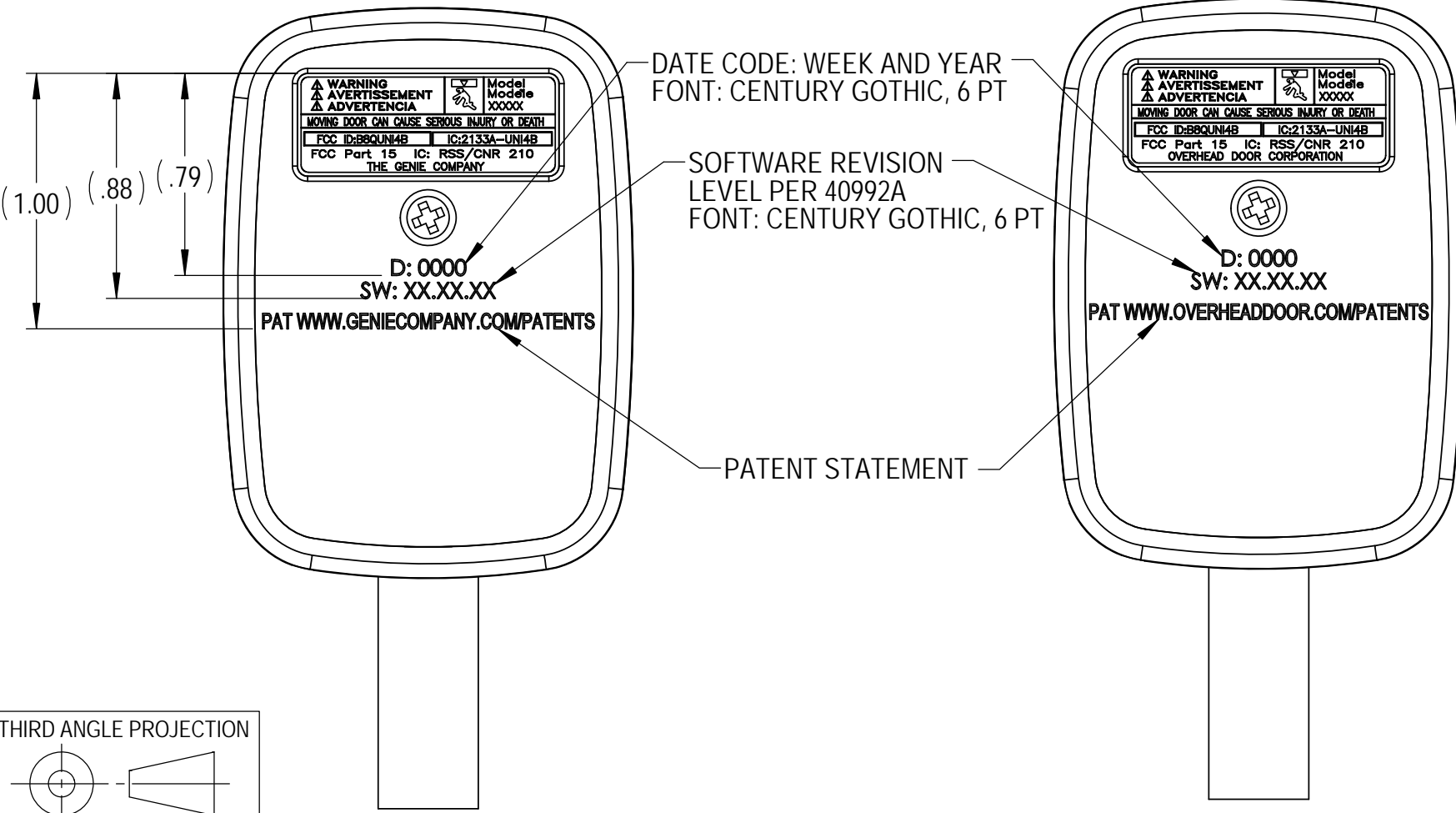

REVISIONS				
ER	REV	DESCRIPTION	DATE	APPROVAL
504070	-	ORIGINAL ISSUE (WAS PRELIM REV 14)		
504282	A	ADDED PATENT STATEMENTS	7/12/19	J.W.

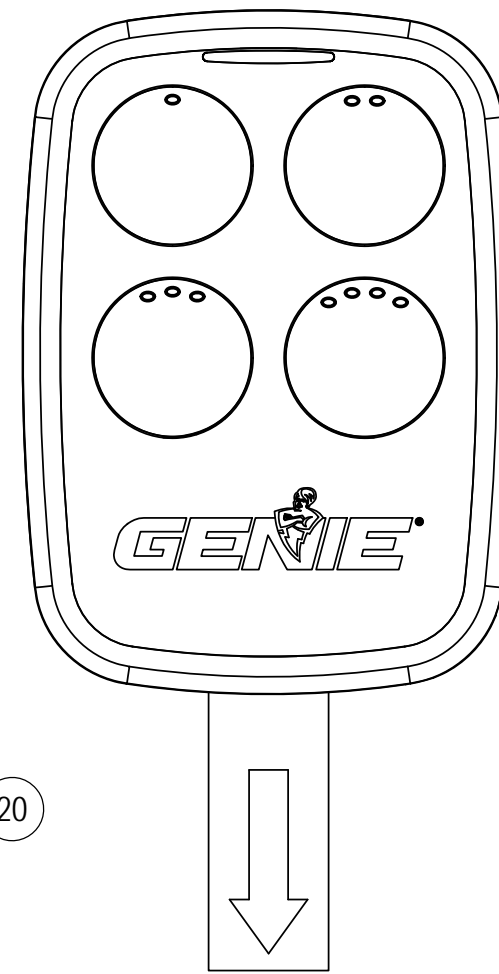

39877R

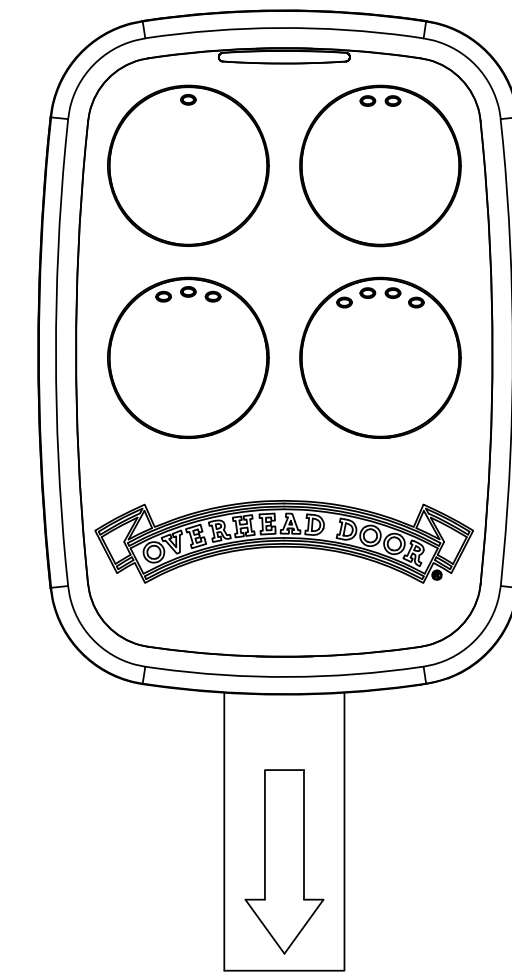

39877S

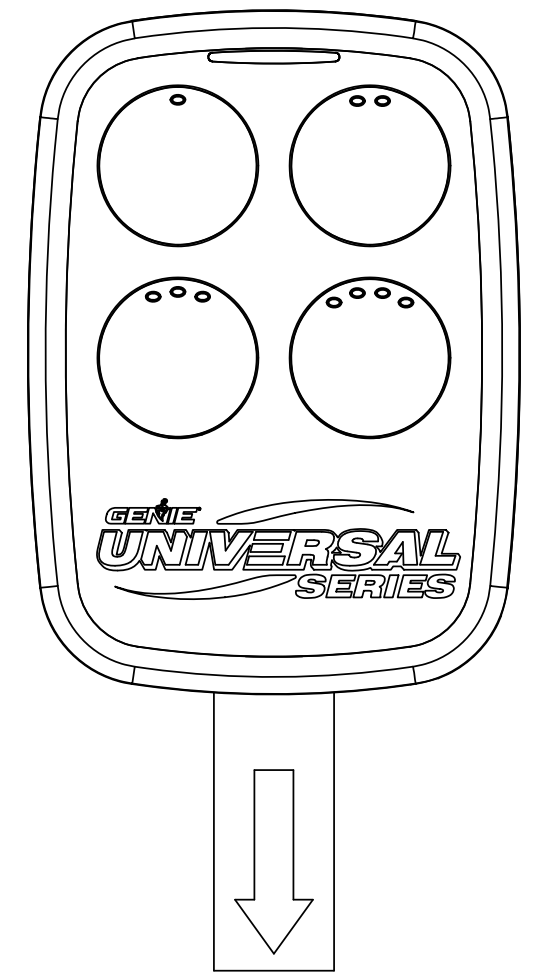

39877T  
 39877U  
 39877V

-V/QTY.	-U/QTY.	-T/QTY.	-S/QTY.	-R/QTY.	ITEM NO.	PART NO.	DESCRIPTION
					25	39883E	LABEL,FCC/IC, UNIV XMTR,GENIE GU4TG
	1				24	39883D	LABEL,FCC/IC, UNIV XMTR,GENIE GU4TB
		1			23	39883C	LABEL,FCC/IC, UNIV XMTR,GENIE GU4TR
			1		22	39883B	LABEL,FCC/IC, UNIV XMTR,OHD OU4T
				1	21	39883A	LABEL,FCC/IC, UNIV XMTR,GENIE GU4T
1					20	39874E	BUTTON TREE,XMTR,BLK/GRY
	1				19	39874D	BUTTON TREE,XMTR,BLK/BLUE
		1			18	39874C	BUTTON TREE,XMTR,BLK/RED
			1		17	39874B	BUTTON TREE,XMTR,WHT/RED
				1	16	39874A	BUTTON TREE,XMTR,WHT/GRY
1					15	39873E	HOUSING,XMTR,BOTTOM,BLK/GRY
	1				14	39873D	HOUSING,XMTR,BOTTOM,BLK/BLUE
		1			13	39873C	HOUSING,XMTR,BOTTOM,BLK/RED
			1		12	39873B	HOUSING,XMTR,BOTTOM,WHT/RED
				1	11	39873A	HOUSING,XMTR,BOTTOM,WHT/GRY
1					10	39872E	HOUSING,XMTR,TOP,GENIE UNIV, BLK/GRY
	1				9	39872D	HOUSING,XMTR,TOP,GENIE UNIV, BLK/BLUE
		1			8	39872C	HOUSING,XMTR,TOP,GENIE UNIV, BLK/RED
			1		7	39872B	HOUSING,XMTR,TOP,OHD,WHT/RED
				1	6	39872A	HOUSING,XMTR,TOP,GENIE,WHT/GRY
1	1	1	1	1	5	39899R	PCBA,UNIVERSAL XMTR
1	1	1	1	1	4	34472A	BATTERY, 3V, COIN CELL
1	1	1	1	1	3	39260A	PULL TAB, UNIVERSAL
1	1	1	1	1	2	39882A	SCREW, M2.2-0.8 x 6.5 LONG, FH, SELF-TAPPING
1	1	1	1	1	1	39875A	LIGHT PIPE, UNIVERSAL TRANSMITTER

PLOTTED: 5/1/19

THE DRAWINGS AND ALL OTHER INFORMATION CONTAINED HEREIN ARE THE CONFIDENTIAL PROPRIETARY PROPERTY OF OVERHEAD DOOR CORPORATION, INCLUDING ITS AFFILIATED SUBSIDIARIES AND AFFILIATES. THIS DRAWING INFORMATION, IN WHOLE OR IN PART, MAY NOT BE COPIED IN ANY MANNER OR DISCLOSED TO ANYONE WITHOUT PRIOR WRITTEN CONSENT OF OVERHEAD DOOR CORPORATION. DISCLOSURE OF ANY DRAWING OR INFORMATION IS INTENDED NOT TO AND SHALL NOT OPERATE AS A LICENSE OR AUTHORIZATION TO USE IT FOR ANY PURPOSE WITHOUT SPECIFIC WRITTEN CONSENT OF OVERHEAD DOOR CORPORATION.

UNLESS OTHERWISE SPECIFIED  
 INTERPRET DIMS & TOLS PER ASME Y14.5M  
**ALL DIMS ARE IN MM**  
 DO NOT SCALE  
 DIMS AND SPECIFICATIONS CIRCLED WITH SYMBOL 'C' ARE CRITICAL TO QUALITY DESIGN FEATURES & MUST MEET APPLICABLE IN-PROCESS INSPECTION STANDARDS.

**TOLERANCES:**  
 .X = ±.20  
 .XX = ±.12  
 .XXX = ±.12  
 ANGULAR = ±1°

**HOLES:**  
 < Ø6.0 = ±.07  
 Ø6.0-Ø12.0 = ±.07  
 > Ø12.0 = ±.07

ALL GEOMETRY GOVERNED BY 3D CAD DATABASE:  
 39877

**BILL OF MATERIAL**

APPROVALS	DATE
DRAWN DANP	2/23/2018
CHECKED DRU	3/27/19
APPROVED DANP	3/28/19

DESCRIPTION  
**XMTR ASSEMBLY, UNIVERSAL REMOTE**

SIZE DWG NO.  
**C 39877**

SCALE 2:1 SHEET 1 OF 1

A SUBSIDIARY OF OVERHEAD DOOR CORPORATION  
 MT. HOPE, OHIO