

NOTES: (UNLESS OTHERWISE SPECIFIED)

- ANY ONE FAILURE OF TESTS INDICATED BELOW IS A FAILURE OF THE ENTIRE UNIT.
- EACH BUTTON MUST PROPERLY FUNCTION AND COMMUNICATE WITH OPERATOR. ALL SEND COMMANDS MUST COMMUNICATE WITH 315MHz AND 390MHz FREQUENCIES.
  - MUST MEET 500 FEET OPEN FIELD RANGE SPECIFICATIONS AT BOTH 315MHz AND 390MHz FREQUENCIES.
  - VERIFY FIT IS VISUALLY ACCEPTABLE AND MEETS APPLICABLE GENIE COMPANY PRINTS.
  - COSMETICS/VISUAL APPEARANCE:
    - COLOR TO MATCH PANTONES SPECIFIED ON PRINT.
    - NO MARKS, SCRATCHES OR IMPERFECTION OF ANY KIND AS JUDGED FROM A DISTANCE OF 18" UNDER FLUORESCENT LIGHTING.
  - LABEL PLACEMENT:
    - CHECK FCC LABEL PER DRAWING.
    - FCC LABEL SHALL BE STRAIGHT AND CONSISTENT ON ALL UNITS.
    - INSTRUCTION LABEL SHALL BE STRAIGHT AND PLACED WITHOUT WRINKLES OR CREASES.
    - BAR CODE LABEL (1.25" x .5") TO BE ATTACHED TO BACK CASE AS SHOWN. LABEL SHALL BE STRAIGHT AND CONSISTENT ON ALL UNITS.
    - THE DATA ON THE BAR CODE LABEL WILL HAVE EIGHT CHARACTERS. THE FIRST SEVEN REPRESENTS THE SERIAL NUMBER AND THE LAST NUMBER REPRESENTS THE TRANSMITTER BUTTON FUNCTION CODE. THE BAR CODE TYPE WILL BE CODE 128.
  - LOGO:
    - LOGO SHALL BE STRAIGHT AND CONSISTENT ON ALL UNITS.
    - LOGO SHALL BE READABLE.
  - VERIFY UNIT IS BUILT TO PURCHASED REVISION.
  - EACH UNIT MUST PASS FUNCTIONAL TEST.
  - EACH UNIT MUST NOT BREAK WHILE CHANGING BATTERY AND EASILY BE REASSEMBLED.
  - TAPE SCREWS, ITEM #9, IN THIS AREA OF THE COVER.

REVISIONS				
ER	REV	DESCRIPTION	DATE	APPROVAL
502855	D	SOFTWARE REVISION 1.0.9 WAS 1.0.6	3/23/15	J.W.
502875	E	REPLACED P/N 37210A WITH 39260A	4/17/15	J.W.
503493	F	SOFTWARE REVISION 1.0.10 WAS 1.0.9	2/20/17	J.W.

PRELIMINARY 01\_G  
 REPLACED P/N 38363-R WITH 40877S.  
 REPLACED P/N 38182A WITH 38182B.  
 SOFTWARE REVISION 2.1.5 WAS 1.0.10  
 05/05/2022

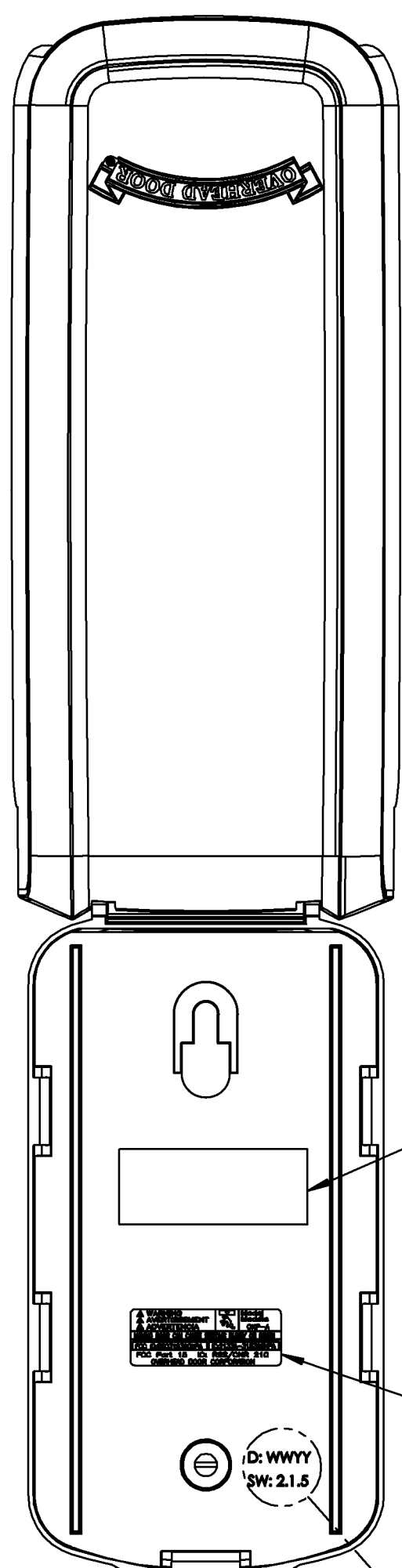
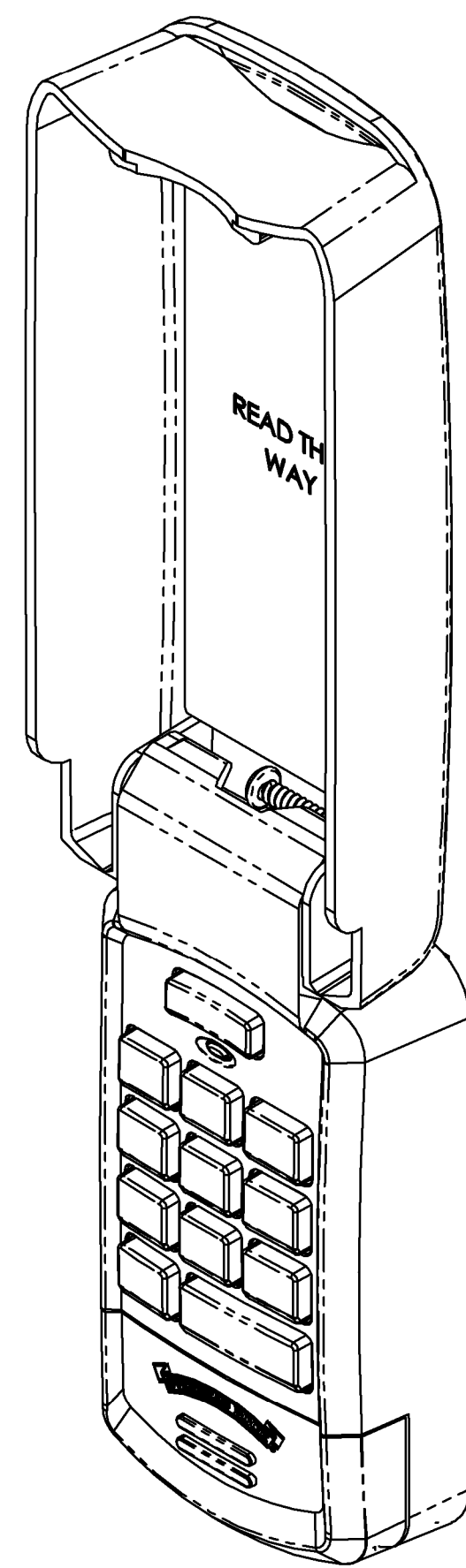
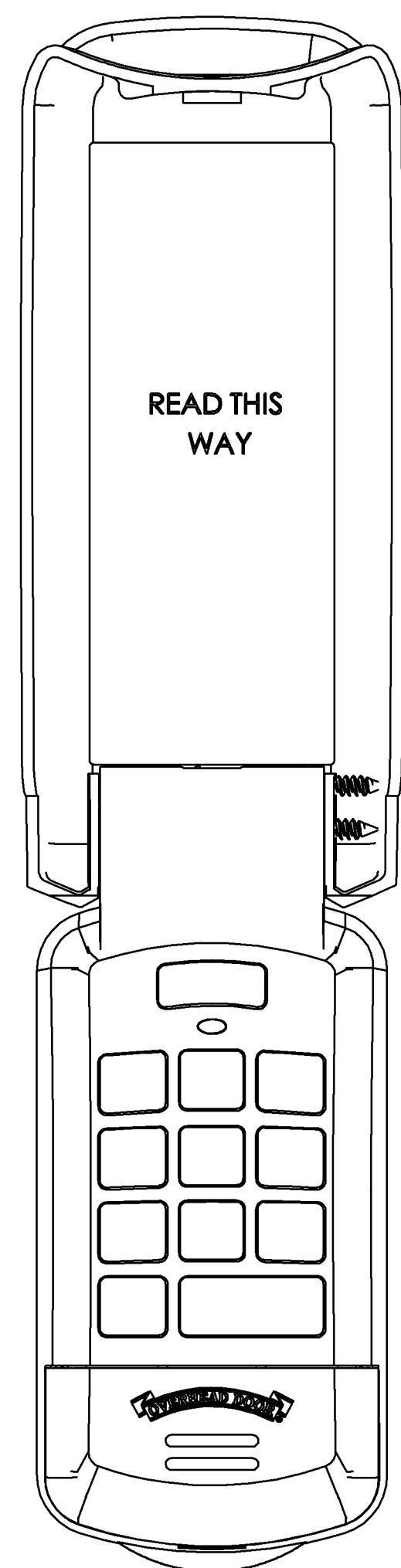

BAR CODE LABEL

DATE CODE & SOFTWARE REVISION (ADDED DURING ASSEMBLY)

D: WWYY  
 SW: 2.1.5

DETAIL A  
 SCALE 4 : 1

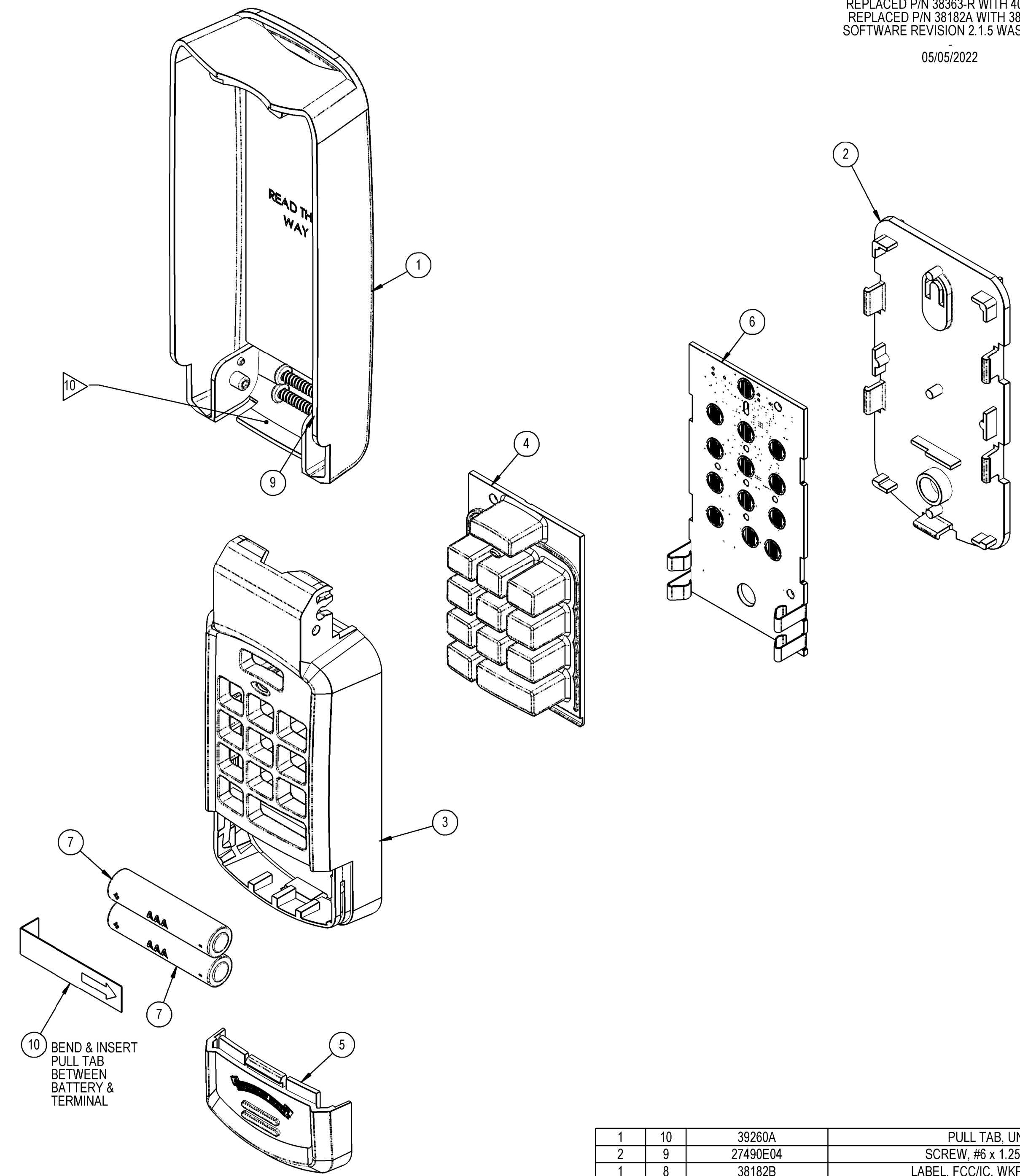

-R QTY	ITEM NO.	PART NO.	DESCRIPTION
1	10	39260A	PULL TAB, UNIVERSAL
2	9	27490E04	SCREW, #6 x 1.25 PAN HD PHIL
1	8	38182B	LABEL, FCC/IC, WKPAD OKP-A, OHD
2	7	36863A	BATTERY, 1.5V, AAA
1	6	40877S	BD ASSY, WKPAD
1	5	36849B	COVER, BATTERY, WKPAD, OHD
1	4	36853A	KEYPAD, SILICONE
1	3	36852A	CASE, TOP, WKPAD
1	2	36851A	CASE, BACK, WKPAD
1	1	38365-R	COVER ASSY, WKPAD, OHD, WHITE

BILL OF MATERIAL

PLOTTED: 1/30/17

THE DRAWINGS AND ALL OTHER INFORMATION CONTAINED HEREIN ARE THE CONFIDENTIAL, PROPRIETARY PROPERTY OF OVERHEAD DOOR CORPORATION, INCLUDING ITS AFFILIATED SUBSIDIARIES AND AFFILIATES. THIS DRAWING INFORMATION, IN WHOLE OR IN PART, MAY NOT BE COPIED IN ANY MANNER OR DISCLOSED TO ANYONE WITHOUT PRIOR WRITTEN CONSENT OF OVERHEAD DOOR CORPORATION. DISCLOSURE OF ANY DRAWING OR INFORMATION IS INTENDED NOT TO AND SHALL NOT OPERATE AS A LICENSE OR AUTHORIZATION TO USE IT FOR ANY PURPOSE WITHOUT SPECIFIC WRITTEN CONSENT OF OVERHEAD DOOR CORPORATION.

UNLESS OTHERWISE SPECIFIED  
 INTERPRET DIMS & TOLS PER ASME Y14.5M  
 ALL DIMS ARE IN INCHES  
 DO NOT SCALE

TOLERANCES:  
 X = ±.1  
 XX = ±.01  
 XXX = ±.005  
 ANGULAR = ±1°

HOLES:  
 < Ø.251 = ±.003  
 Ø.251-Ø.500 = ±.003  
 > Ø.500 = ±.003

APPROVALS	DATE
DRAWN KMG	10/2/12
CHECKED DRU	10/3/12
APPROVED J.W.	10/3/12
MATERIAL	
FINISH	

A SUBSIDIARY OF OVERHEAD DOOR CORPORATION ALLIANCE, OHIO	
DESCRIPTION	
WKPAD ASSY, OHD	
SIZE	DWG NO.
D	38362
SCALE 1:1	SHEET 1 OF 1

