

THIS DOCUMENT AND THE DATA DISCLOSED HEREIN OR HEREBY IS PROPERTY OF ACR ELECTRONICS, INC. IT IS UNLAWFUL TO REPRODUCE, COPIE, OR TRANSMIT IN ANY MANNER OR TO DISCLOSE IN ANY MANNER TO ANYONE WITHOUT THE PERMISSION OF ACR ELECTRONICS, INC.

NOTES:

1. ATTACH ANTENNA ASSY. (ITEM 2) TO TOP CASE ASSY. (ITEM 1 OR 12).
2. INSERT PCB ASSY. (ITEM 4) INTO TOP CASE ASSY. (ITEM 1 OR 12) AND ATTACH WITH ITEMS 5 & 6.
3. CONNECT PCB ASSY. TRANSMITTER (ITEM 7) & PCB ASSY. HOMER BOARD (ITEM 8) TO PCB ASSY. I/O BOARD (ITEM 4) AS SHOWN.
4. PEEL OFF PAPER FROM PAD (ITEM 9) AND ATTACH TO BOTTOM INSIDE OF CLAMP (ITEM 10).
5. INSERT CLAMP (ITEM 10) INTO TOP CASE ASSY. DURING INSERTION, MAKE SURE HOMER & TRANSMITTER PCB ASSEMBLIES ALIGN WITH AND SLIDE THROUGH GROOVES INSIDE CLAMP. ONCE FULLY INSERTED, ATTACH CLAMP USING ITEM 11.
6. PULL WIRES 1 & 2 AROUND CLAMP AND SOLDER TO TERMINALS AS SHOWN.

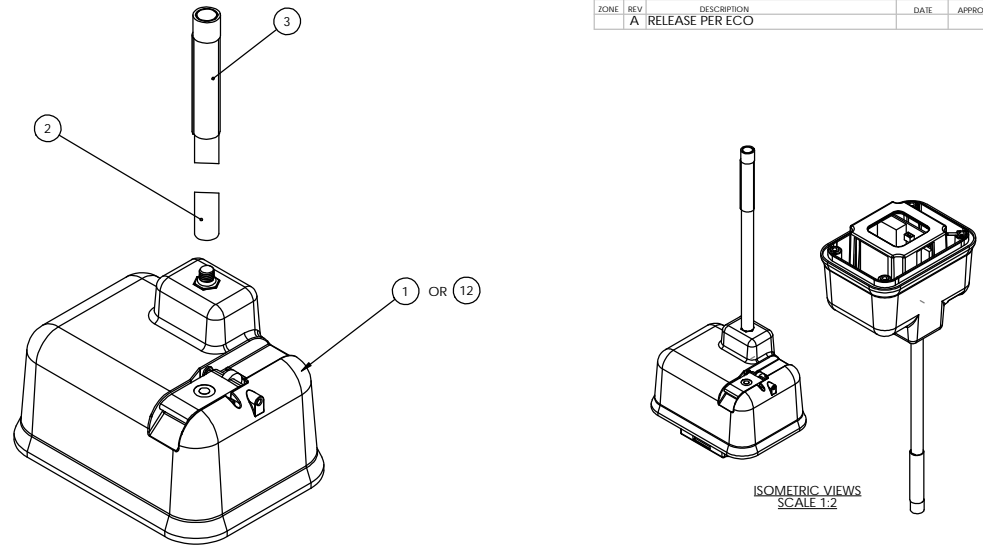

ISOMETRIC VIEWS
SCALE 1:2

D

D

C

C

B

B

A

A

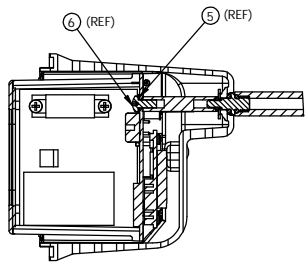
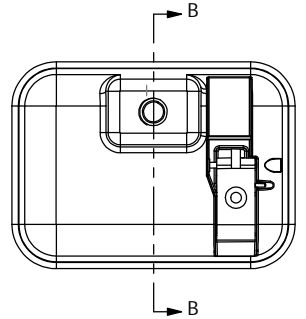

SECTION B-B
SCALE 1:1

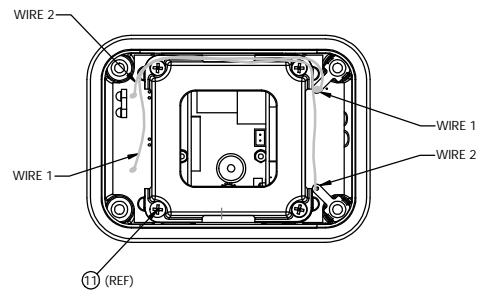

DASH INFORMATION	
DASH No.	DESCRIPTION
1	RLB-35, CAT. I
2	RLB-35, CAT. II

QTY	DASH 1	DASH 2	ITEM NO	PART OR IDENTIFYING NO.	NOMENCLATURE OR DESCRIPTION	MATERIAL & SPECIFICATION
1	-	12	A3-06-2202-2	TOP CAP ASSY., GLOBALFIX 406/RLB-35, CAT. II		
1	1	11	MS24625-18	SCREW, SELF-TAPPING, PH.		
1	1	10	A1-18-1725	CLAMP		
1	1	9	A1-25-0108	PAD, PRESSURE WITH ADHESIVE		
1	1	8	A3-07-0265-1	PCB ASSY., H.P., HOMER BOARD		
4	4	7	A3-07-0240-1	PCB ASSY., H.P., 406 MHZ TRANSMITTER		
1	1	6	MS51957-27	SCREW, PH. 6-32, 5/16 LG		
1	1	5	MS3335-58	WASHER, EXTERNAL TOOTH, #6		
1	1	4	A3-07-0264-1	PCB ASSY., H.P., I/O BOARD		
1	1	3	A2-05-0067-0182	REFLECTIVE SHEETINGS, 2" WIDE	1.625 CUT LENGTH	
1	1	2	A3-06-1791-1	ANTENNA ASSEMBLY		
-	1	1	A3-06-2202-1	TOP CAP ASSY., GLOBALFIX 406/RLB-35, CAT. I		
DASH 2	DASH 1	QTY	ITEM NO	PART OR IDENTIFYING NO.	NOMENCLATURE OR DESCRIPTION	MATERIAL & SPECIFICATION

LIST OF MATERIALS OR PARTS LIST

UNLESS OTHERWISE SPECIFIED: ALL ANGLES ARE 90° DIMENSIONS ARE IN INCHES TOLERANCES ON	FRAC TIONS ±.154	DECIMALS X ± .030 XX ± .010 XXX ± .005	ANGLES ± 10°
--	---------------------	---	-----------------

ACR ELECTRONICS, INC
5757 BAVENSWOOD RD. FT. LAUDERDALE, FL 33312

**ELECT. SUB-ASSEMBLY,
GLOBALFIX 406/RLB-35**

REV	DATE	DESCRIPTION	BY
D	18560	A3-06-2201-	

SCALE: 1:2