

803669

This drawing, written description, or specification represents a proprietary product of TELEX, Lincoln, NE, and shall not be released, disclosed, nor duplicated without the written permission of TELEX.

REVISIONS				
CHG NO	LTR	DESCRIPTION	DATE	APPD
-----	A	RELEASE	5/8/03	TCN

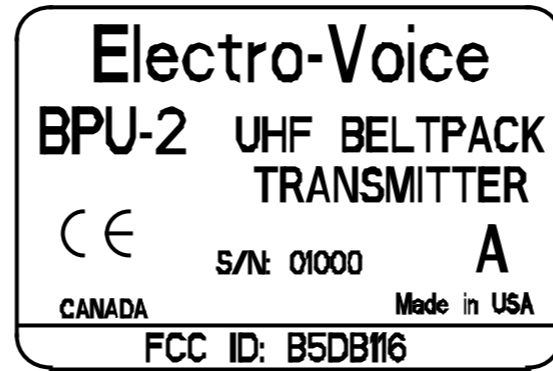
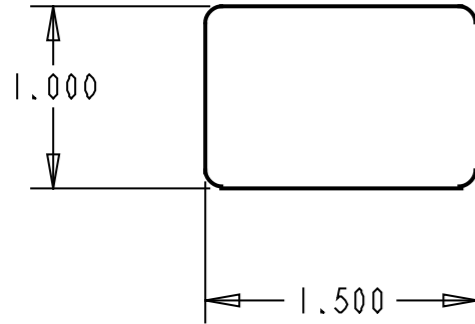

803669-21

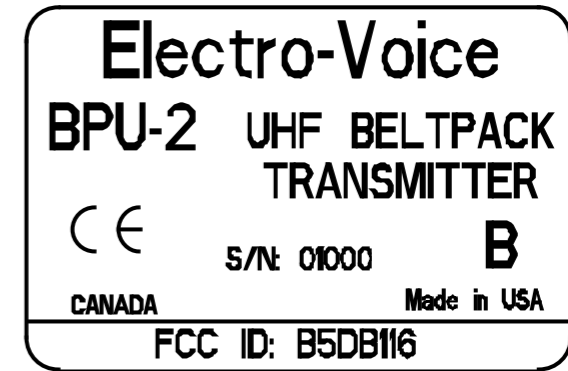

803669-22

4. LINCOLN DESIGN ENGINEERING TO APPROVE LABEL LAYOUT.

3. CHARACTER DESIGNATORS: A OR B (FREQUENCY BAND), H (HI POWER), R (REF SWITCH MODIFICATION).

2. S/N TO START AT 1000 FOR EACH FREQUENCY BAND AND OR PART NO..

1. LETTERING IS SUBJECT TO CHANGE

NOTES:

QTY	DESCRIPTION	ITEM	PART NO.	SPECIFICATION
	UNSPECIFIED LIMITS OF TOLERANCE	DATE	8 MAY, 03	Telex [®] TELEX COMMUNICATIONS INC. Lincoln Nebraska U.S.A.
	DECIMAL: FRACTION:	DR BY	T.C.N.	
	.X ±.030 IN. MACHINED	CHK BY	TCN 5/8/03	
	.XX ±.010 FINISH: 64 ✓	APPD		
	.XXX ±.005 IN.	PROD		TITLE
	ANGLES ±1°, BENDS ±2°	MATERIAL:		SERIAL LABEL
	STRAIGHTNESS AND / OR FLATNESS .005 IN./1 IN.	1" x 1.5" WHITE LABEL STOCK #L-466		WT-500/BPU-2
	UNMARKED ANGLES, BENDS AND INTERSECTIONS 90°			SIZE
	THREADS - EXT. CLASS 2A INT. CLASS 2B			B
	WT-500/BPU-2			CODE IDENT
	NEXT ASSY USED ON			57010
	APPLICATIONS			DWG. NO.
				803669
				SCALE: NONE
				SHEET: 1 of 1