



## PP1000se v3

### *Installation Guide*



## PP1000se Installation Guide

© 2014 VeriFone, Inc.

All rights reserved. No part of the contents of this document may be reproduced or transmitted in any form without the written permission of VeriFone, Inc.

The information contained in this document is subject to change without notice. Although VeriFone has attempted to ensure the accuracy of the contents of this document, this document may include errors or omissions. The examples and sample programs are for illustration only and may not be suited for your purpose. You should verify the applicability of any example or sample program before placing the software into productive use. This document, including without limitation the examples and software programs, is supplied "As-Is."

VeriFone, the VeriFone logo, NURIT, Omni, VeriCentre, Verix, and ZonTalk are registered trademarks of VeriFone. Other brand names or trademarks associated with VeriFone's products and services are trademarks of VeriFone, Inc.

All other brand names and trademarks appearing in this manual are the property of their respective holders.

Comments? Please e-mail all comments on this document to your local VeriFone Support Team.

VeriFone, Inc.  
2099 Gateway Place, Suite 600  
San Jose, CA, 95110 USA  
1-800-VERIFONE  
[www.verifone.com](http://www.verifone.com)

VeriFone Part Number DOC180-083-EN-A, Revision A.6



**CONTENTS**

**PREFACE** . . . . . 5

Audience . . . . . 5

Organization . . . . . 5

Related Documentation . . . . . 5

Guide Conventions . . . . . 6

    Acronym Definitions . . . . . 6

**CHAPTER 1**  
**Overview** PP1000SE . . . . . 7

    Front Functions . . . . . 7

    Back Functions . . . . . 8

    Features and Benefits . . . . . 9

**CHAPTER 2**  
**Setup** Selecting Location . . . . . 11

    Environmental Factors . . . . . 11

    Electrical Considerations . . . . . 12

    PIN Protection Measures . . . . . 12

        Ensuring User Privacy . . . . . 13

    Unpacking Shipping Carton . . . . . 13

    Attaching Controller Cable . . . . . 14

        Connecting via USB . . . . . 16

        Connecting via RS232 Cable . . . . . 17

        Connecting via Serial Cable with DC Input . . . . . 18

    Installing or Replacing SAM Card (CTLS Version Only) . . . . . 19

    Installing a Privacy Shield (Optional) . . . . . 21

**CHAPTER 3**  
**Specifications** Unit Power Requirements . . . . . 23

    Temperature . . . . . 23

    Humidity . . . . . 23

    External Dimensions . . . . . 23

    Weight . . . . . 23

**CHAPTER 4**  
**Troubleshooting Guidelines** Display Panel Does Not Work . . . . . 25

    Keypad Does Not Respond . . . . . 25

**CHAPTER 5**  
**Service and Support** Maintenance and Cleaning . . . . . 27

    Service Returns . . . . . 27

    Accessories and Documentation . . . . . 29

        Cables . . . . . 29

        Power Supply . . . . . 29

        Cleaning Kit . . . . . 29

        Documentation . . . . . 29





This guide is the primary source of information for setting up and installing a PP1000se device.

**Audience**

This guide provides simple descriptions of the PP1000se features, as well as basic information for installing and configuring PP1000se.

**Organization**

This guide is organized as follows:

**Chapter 1, Overview.** Provides an overview of a PP1000se device.

**Chapter 2, Setup.** Explains how to set up and install PP1000se, as well as to establish connections with other devices.

**Chapter 3, Specifications.** Discusses the power requirements and dimensions of PP1000se.

**Chapter 4, Troubleshooting Guidelines.** Provides troubleshooting guidelines, should you encounter a problem in installation and configuration.

**Chapter 5, Service and Support.** Provides information on contacting your VeriFone service provider, ordering accessories or documentation from VeriFone, and maintaining the PP1000se unit.

**Related Documentation**

To learn more about the PP1000se device, please refer to the following documents and their associated VeriFone Part Numbers (VPN):



<i>PP1000se Certifications and Regulations</i>	VPN DOC180-081-EN
<i>PP1000se Quick Installation Guide</i>	VPN DOC180-082-EN

## Guide Conventions

Please refer to the following document conventions for quickly identifying special formatting.

Table 1 describes these conventions and provides examples of their use.

**Table 1 Document Conventions**

Convention	Meaning	Example
Blue	Text in blue indicates terms that are cross-references.	See <a href="#">Guide Conventions</a> .
<i>Italics</i>	Italic typeface indicates book titles or emphasis.	You <i>must</i> not use this unit underwater.
<b>NOTE</b> 	The pencil icon is used to highlight important information.	RS-232-type devices do not work on the PP1000se communication port.
<b>CAUTION</b> 	The caution symbol indicates hardware or software failure, or loss of data.	The unit is not waterproof or dustproof, and is intended for indoor use only.
<b>WARNING</b> 	The lightning symbol is used as a warning when bodily injury might occur.	Due to risk of shock do not use the unit near water.

## Acronym Definitions

Please refer to Table 2 for the acronyms used in this manual.

**Table 2 Acronym Definitions**

Acronym	Definitions
LCD	Liquid Crystal Display
PED	PIN Entry Device
PIN	Personal Identification Number
POS	Point-of-Sale
RJ-11	Registered Jack 11
RJ-45	Registered Jack 45
SAM	Secure Access Module
USB	Universal Serial Bus
VPN	VeriFone Part Number

## Overview

This chapter provides the description and enumeration of features for the PP1000se.

### PP1000se

The PP1000se is a CTLS and peripheral data entry device that accepts and encrypts Personal Identification Numbers (PINs). Typically, a PIN is a four- to twelve-digit code, known only by the customer and the issuer. PIN code requests help verify the authorized customer during transactions. The PIN also serves as the electronic signature for the credit or debit transaction.

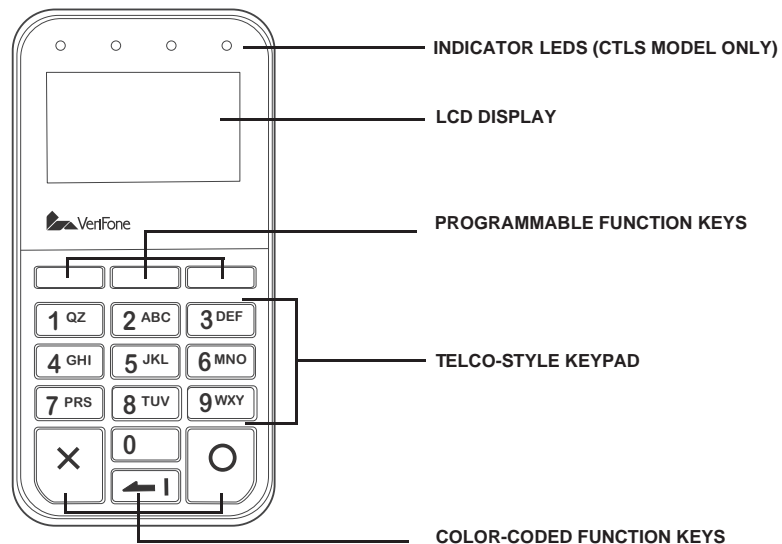

**Figure 1 PP1000se Front Features**

### Front Functions

The PP1000se includes the following features:

- Customer-view **indicator LEDs** (CTLS models only).
- An **LCD display**
- Three types of keys:
  - A 10-key, **telco-style keypad**
  - Three unlabeled, **programmable function keys** above the keypad

- Three **color-coded function keys** below the keypad (icons at right, left-to-right: CANCEL, BACKSPACE, ENTER)

## NOTE



VeriFone ships variants of the PP1000se unit for different markets. Your unit may have a different configuration. However, the basic processes described in this guide remain the same, regardless of the configuration.

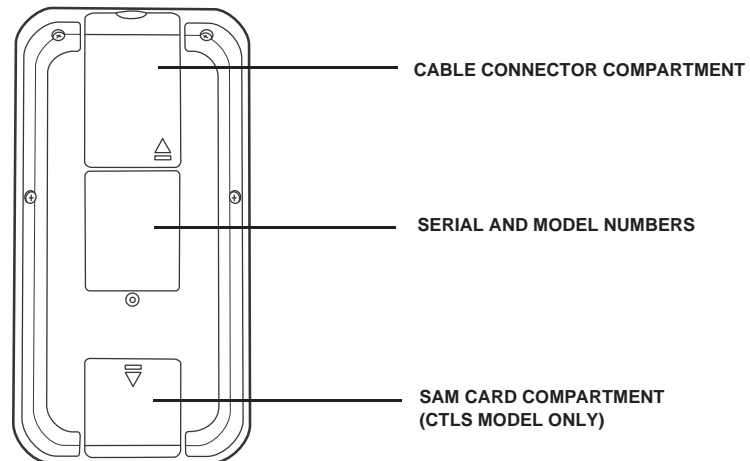

**Figure 2** PP1000se Rear View

**Back Functions** The rear of the PP1000se device shows the following:

- **Cable connector compartment.**
- **Serial and model number** sticker.
- In CTLS models, a **SAM** (security access module) **compartment** is built into the back side of the unit. The PP1000se CTLS unit contains a micromodule-sized SAM (MSAM) card holder to support stored-value card programs or other merchant card requirements.



## Features and Benefits

### Exceptional Ease of Use and Ergonomics

- Bright LEDs display transaction process progress (for CTLS models only).
- Sleek and stylish shape occupies minimal counter space.
- Bold, ergonomic design fits comfortably in the palm of a hand.
- Large, hard-rubber keys provide improved tactile feedback, minimizing errors and maximizing ease-of-use for consumers of all ages.
- Intuitive telco-style interface and colored control keys simplify training and reduce support requests.
- Programmable function keys allows selection of functions within an application.
- Highly readable 128x32 graphic liquid crystal display (LCD), which supports multiple languages for global applications.
- Rugged and reliable design.
- Connects with most POS payment terminals.
- Supports payment transactions in a variety of payment environments.

### Critical Security Protection

- Offers a choice of Master/Session or DUKPT key-management methods to protect PIN-based transactions.
- Offers secure, reliable PIN input for expanding range of PIN-based transactions.
- PCI-compliant for secure solutions, meeting the PED standard.
- Meets ISO and ANSI standards for PIN encryption, key management, and MAC.
- Key injection simplified and secured with VeriFone's SecureKit key loading software.
- Rugged and reliable design absorbs hard knocks found at point-of-sale counters.
- Removable privacy shield offers option of supplemental physical security.
- Connects with most POS payment terminals, PCs, and ECRs.
- Backward-compatible with VeriFone's legacy PINpad 1000SE and NURIT 222 PED.
- USB Connectivity that gives another option to connect with payment terminals, personal computers, and electronic cash registers (ECRs).

---

## OVERVIEW

*Features and Benefits*



## Setup

This chapter describes the setup procedure for the PP1000se, in the following sections:

- Selecting Location
- PIN Protection Measures
- Unpacking Shipping Carton
- Attaching Controller Cable
- Installing or Replacing SAM Card (CTLS Version Only)
- Installing a Privacy Shield (Optional)

### Selecting Location

Use the following guidelines to select the best location for the PP1000se device.

#### To Select a Location

- Select a location convenient for both merchant and client.
- Select a location that is far from heavy metal objects.
- Select a flat support surface, such as a countertop or table.
- Select a location near a power outlet and the terminal or computer connected to the PP1000se unit.



For safety, do not string cables or cords across a walkway.

### Environmental Factors

- Do not use the unit where there is high heat, dust, humidity, moisture, or caustic chemicals or oils.
- Keep the unit away from direct sunlight and anything that radiates heat, such as a stove or a motor.
- Do not use the PP1000se outdoors.



The PP1000se is not waterproof or dustproof, and is intended for *indoor use only*. Any damage to the unit from exposure to rain or dust can void any warranty.

**Electrical Considerations**

- Avoid using this product during electrical storms.
- Avoid locations near electrical appliances or other devices that cause excessive voltage fluctuations or emit electrical noise (for example, air conditioners, electric motors, neon signs, high-frequency or magnetic security devices, or computer equipment).
- Do not use the PP1000se unit in water or in moist conditions.
- Disconnect the device from its POS terminal before cleaning.

**PIN Protection Measures**

Use the following techniques to provide effective screening of PIN-entry devices (PEDs) during the PIN entry process. You can use these methods in combination, although in some cases a single method might suffice.

- Position the terminal on the check-in stand in such a way as to block visual observation of the PIN-entry process. Examples include:
  - Visual shields designed into the check-in stand. The shields may be solely for shielding purposes, or may be part of the general check stand design.
  - Position the PED so that it is angled in such a way that PIN spying is difficult.
- Install the PED on an adjustable stand that allows consumers to swivel the terminal sideways and/or tilt it forwards/backwards to a position that makes visual observation of the PIN-entry process difficult.
- Position in-store security cameras so that the PIN-entry keypad is not visible.

The following table describes the two preferred mounting methods and the recommended measures to protect from PIN capture in four observation corridors:

**Table 3 Mounting Methods and Protection Measures**

Method	Cashier	Customer in Queue	Customers Elsewhere	On-site Cameras
Countertop without stand	Use signage behind the PED	Install so that customer is between PED and next in queue	No action needed	Do not install within view of cameras
Countertop with stand	No action needed	Install so that customer is between PED and next in queue	No action needed	Do not install within view of cameras

VeriFone also recommends instruction of the cardholder regarding safe PIN-entry. This can be done with a combination of:

- Signage on the PED
- Prompts on the display, possibly with a click-through screen
- Literature at the point of sale
- A logo for safe PIN-entry process.

**Ensuring User Privacy**

Use the following guidelines to protect the user’s privacy when he enters his personal identification number (PIN):

- The area of visibility should be no larger than a cone taken from the number 5 key at an angle of 45° and covering an area of 270° directly in front of the user.

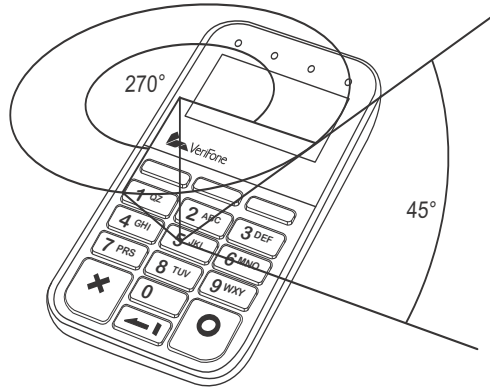

**Figure 3 Pin Entry Visibility Area**

- You can secure PIN entry by [Installing a Privacy Shield \(Optional\)](#).

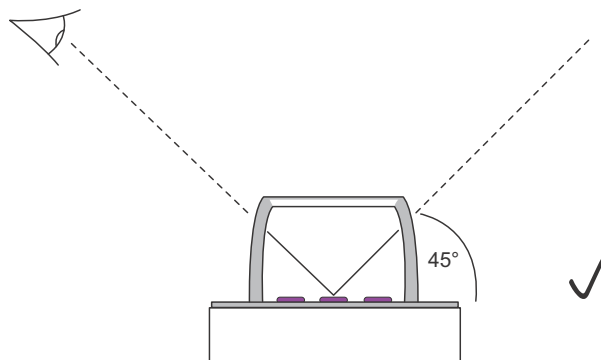

**Figure 4 PIN Entry Privacy Shield**

**Unpacking Shipping Carton**

Carefully inspect the shipping carton and its contents for possible tampering or damage.



The PP1000se device is a secure product and any tampering can cause it to cease to function or operate in an unsecured manner.

- 1 Remove the PP1000se unit from the shipping carton. The standard package contains the PIN pad only and does not include any other cables or accessories. Refer to [Accessories and Documentation](#) for more information about the PP1000se related accessories.
- 2 Remove any protective plastic wrap and place the unit on a table or countertop.
- 3 Remove the clear protective film from the display.

- 4 Replace all the packing materials, close the lid, and save the carton for repacking or moving the PP1000se device in the future.



Do not use a unit that has been tampered with or otherwise damaged. The PP1000se unit comes equipped with tamper-evident label. If a label or component appears damaged, immediately notify the shipping company and your VeriFone representative or service provider.

## Attaching Controller Cable

The PP1000se rear panel has a modular interface port for power and communication to the controlling device. You can use three types of controller cables to attach the PP1000se to various host devices:

- USB Cable (VPN CBL180-001-01-A)
- Serial Cable with DC Input Jack (VPN CBL180-007-01-A).



Turn off or unplug the terminal when connecting or disconnecting the PP1000se to avoid device memory corruption and data loss.

Refer to the controlling device instructions for any terminal-specific warnings.

- 1 Disconnect power from the PP1000se.
- 2 Position the unit face down on a soft, smooth surface to avoid damaging the keypad or display.
- 3 Press down on and slide the cover off the modular jack compartment. The cover will be attached to the PP1000se by a flat flexible cable. Turn over and hold the compartment cover to one side while performing [Step 4](#).

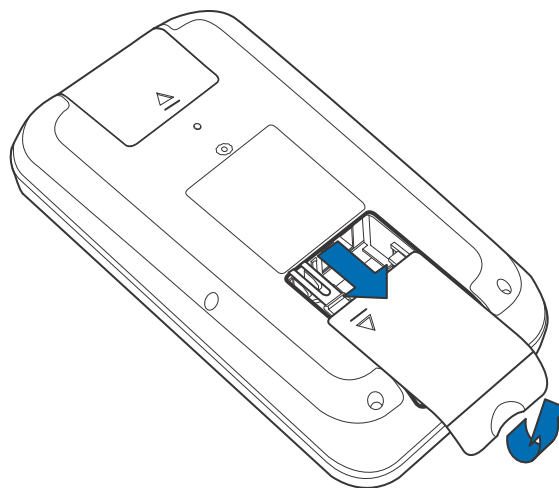

**Figure 5 Sliding Out Modular Jack Compartment Cover**

- 4 Connect the modular plug of the controller cable to the jack on the rear of the PP1000se.

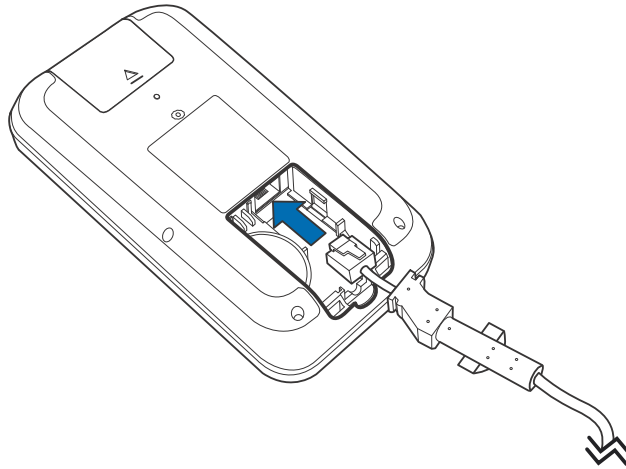

**Figure 6** Connecting Modular Jack

- 5 Press the molded cable into the slots to lock the cable in place.

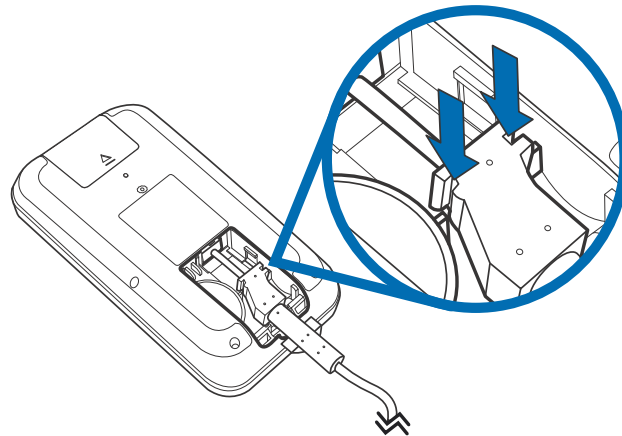

**Figure 7** Securing Controller Cable

- 6 Place the cover back on the modular jack compartment.

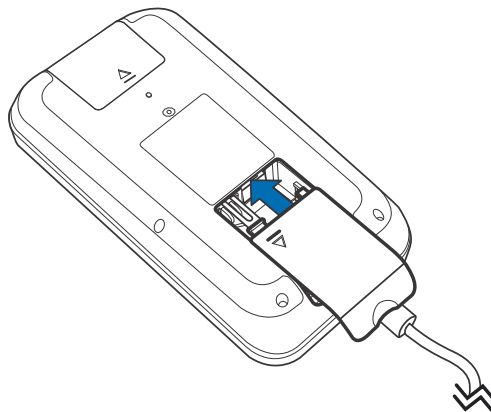

**Figure 8** Replacing Modular Jack Compartment Cover

## SETUP

### Attaching Controller Cable

- 7 Use the following guidelines in connecting the PP1000se using a specific connecting cable:
  - Connecting via USB
  - Connecting via Serial Cable with DC Input
- 8 After connecting the cables, restart the PP1000se and the controlling device.



#### NOTE

For cable removal, use the same steps described above in reverse. If exchanging cables, use a VeriFone-approved cable.

Refer to [Accessories and Documentation](#) for the individual part numbers of the PP1000se-related cables.

### Connecting via USB

You can connect the PP1000se to a Vx terminal using a coiled USB cable (VPN CBL180-001-01-A).



#### NOTE

When connecting the PP1000se to a computer via USB port, the computer may require additional installation of device drivers, which you can download from <http://support.verifone.com/verifone/support/home.do>.

- 1 Connect the cable to the PP1000se (see [Attaching Controller Cable](#)).
- 2 Connect the USB plug to the port in the host device (terminal or computer).

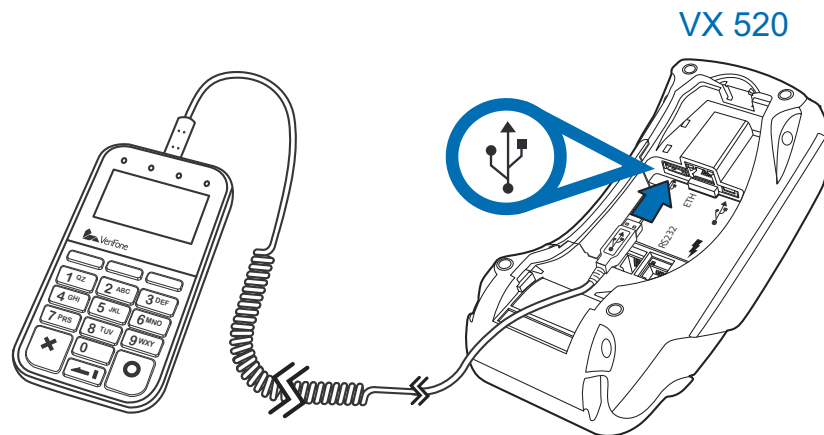

**Figure 9 Connecting PP1000se to Terminal Via USB**

- 3 Close the device covers then power up the PP1000se and the host device.
- 4 Wait until the host device recognizes the new hardware.



- 5 Browse to the INF file provided by VeriFone when specifying the driver location. When the installation completes, check the list of ports on the Device Manager to see the newly installed USB device.

---

**CAUTION**

Use only USB-certified cables if an extension cable is required when connecting to the device's USB port.

---

**NOTE**

You can find and download additional instructions and device drivers from the VeriFone Technical Support page:  
(<http://support.verifone.com/verifone/support/home.do>).

---

**Connecting via Serial Cable with DC Input**

Use the coiled serial cable (VPN CBL180-007-01-A) and power cable (VPN xxx-xxx-xxx) to connect the PP1000se to an electronic cash register (ECR) or a host computer.

- 1 Connect the cable to the PP1000se (see [Attaching Controller Cable](#)).
- 2 Attach the serial jack to the ECR or host computer and tighten the thumb screws.

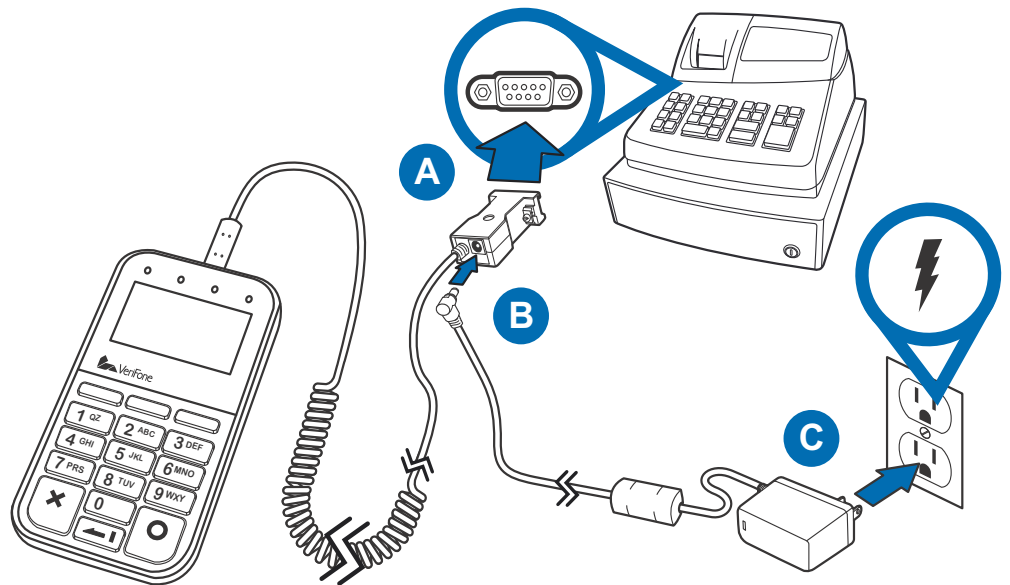

**Figure 11 Connecting PP1000se to an ECR via Powered Serial Cable**

- 3 Connect the power plug (VPN xxx-xxx-xxx) into the DC jack.
- 4 Connect the power cable to an external power supply.

- 5 Close the device covers then power up the PP1000se and the host device.



CAUTION

Use only USB-certified cables if an extension cable is required when connecting to the device's USB port.



NOTE

You can find and download additional instructions and device drivers from the VeriFone Technical Support page:  
(<http://support.verifone.com/verifone/support/home.do>).

## Installing or Replacing SAM Card (CTLS Version Only)

Use the following procedures to install a security access module (SAM) card or replace an old card. This step is necessary only for contactless models of the PP1000se.



CAUTION

Observe standard precautions in handling electrostatically sensitive devices. Electrostatic discharges can damage the equipment. VeriFone recommends using a grounded anti-static wrist strap.

### To change or install SAMs

- 1 Disconnect the device from its power supply, if you are using an external power source.
- 2 Disconnect the controller cable from the PP1000se.
- 3 Place the PP1000se facedown on a soft, clean surface to protect the screen from scratches.

## SETUP

### Installing or Replacing SAM Card (CTLS Version Only)

- 4 Press down on and slide the compartment door off the SAM card compartment.

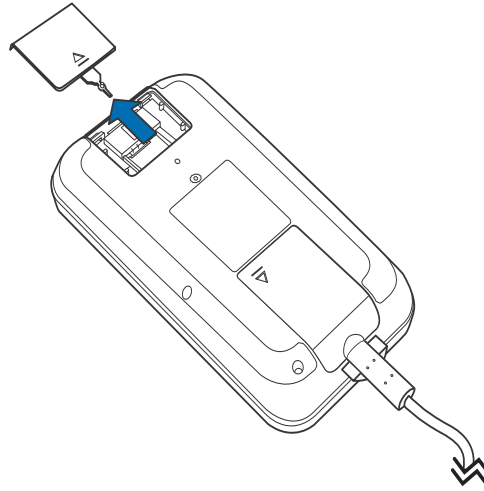

**Figure 12** Opening SAM Cover

#### NOTE



Before inserting the SAM card, position it as shown in [Figure 13](#), with the card's gold contacts facing away from you, toward the unit. The card holder slot in the PP1000se has a set of contacts. The SAM card has a notch on one corner to ensure that it fits into the connector base in only one way.

- 5 Install the SAM card by aligning the card and carefully sliding it into the slot until fully inserted.

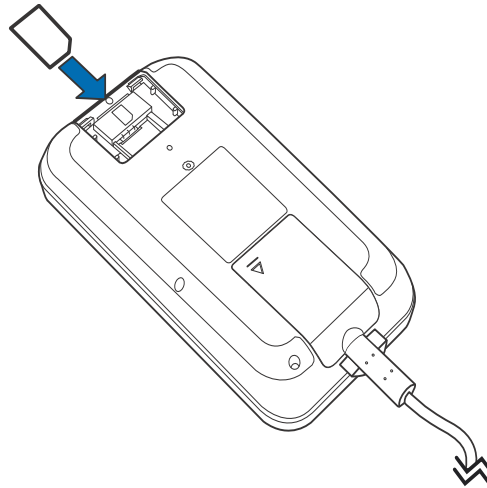

**Figure 13** Inserting SAM Card

- 6 Close the SAM compartment door until the locking pin slots into place.

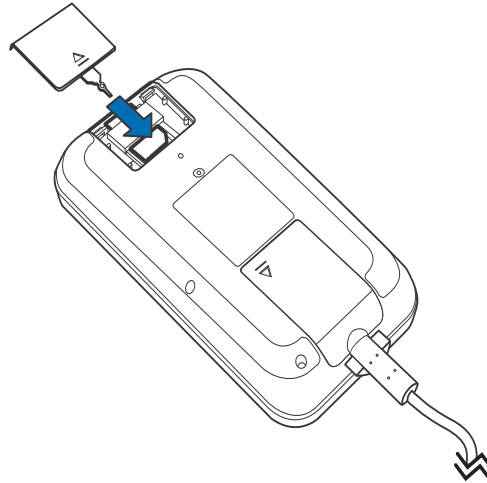

**Figure 14 Replacing SAM Cover**

- 7 Reconnect the controller cable to the device.
- 8 Reconnect the device to the power supply, if you are using an external power source.

## Installing a Privacy Shield (Optional)

The privacy shield protects the customers' PIN entry from being seen by the cashier or other customers. Use the following steps to install a privacy shield on your PP1000se.

- 1 Insert the privacy shield by slotting it on the recessed channels on the sides of the PP1000se.

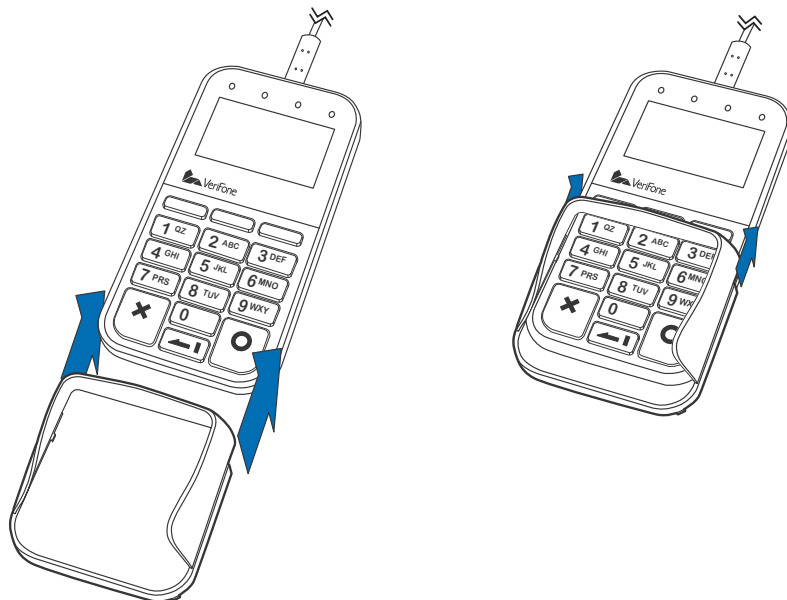
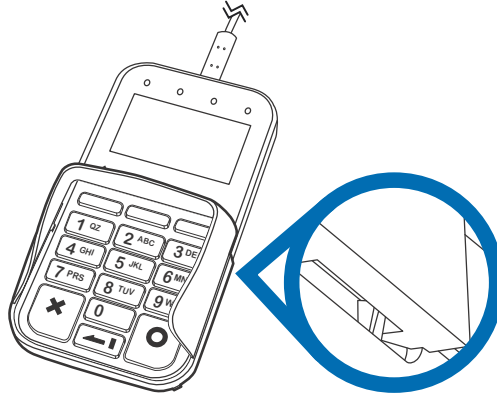

**Figure 15 Inserting Privacy Shield**

## SETUP

### Installing a Privacy Shield (Optional)

- 2 Insert fully until the privacy shield locks in place. There are locking tabs on both undersides of the privacy shield that latch onto slots in the recessed channels of the PP1000se.



**Figure 16** Locking the Privacy Shield

#### NOTE



Merchants who install the terminal without the privacy shield must ensure the cardholder's privacy when entering his PIN by positioning the terminal away from open view. Please refer to [PIN Protection Measures](#) for more information.



## Specifications

This chapter discusses power requirements, dimensions, and other specifications of the PP1000se device.

### Unit Power Requirements

**Input:** 5V - 12V DC  
**Maximum current:** 500 mA

### Temperature

**Operating temperature:** 0° to 40° C (32° to 104° F)

### Humidity

**Relative humidity:** 5% to 90% (non-condensing)

### External Dimensions

- **Length:** 133 mm (5.23 in)
- **Width:** 68 mm (2.67 in)
- **Depth:** 25 mm (0.98 in)

### Weight

- **Unit weight:** 270 g (9.52 oz)
- **Shipping weight:** 400 g (0.881 oz)

---

## SPECIFICATIONS

*Weight*





## Troubleshooting Guidelines

This chapter lists typical malfunctions that may occur while operating a PP1000se device and the appropriate corrective action. If the problem persists – even after performing the outlined guidelines, or if the problem is not described, contact your local VeriFone representative for assistance.

**NOTE**



The PP1000se device uses a tamper-evident case and contains no user-serviceable parts. Do not, under any circumstance, attempt to disassemble the unit. Perform only those adjustments or repairs specified in this guide. For all other services, contact your local VeriFone service provider. Service conducted by parties other than authorized VeriFone representatives may void any warranty.

### Display Panel Does Not Work

- 1 Check all the cable connections.
- 2 Check the controlling device's AC outlet to be sure the outlet is supplying sufficient power. Substitute the controlling device's power pack with another power pack.
- 3 The controlling device's application program might not be loaded correctly. Download the application program and try again.
- 4 If the problem persists, contact your local VeriFone representative.

### Keypad Does Not Respond

- 1 Check the display panel. If there are no characters, or the wrong characters are displayed, refer to [Display Panel Does Not Work](#).
- 2 If the problem persists, contact your local VeriFone representative.

---

**TROUBLESHOOTING GUIDELINES**

*Keypad Does Not Respond*

## Service and Support

### Maintenance and Cleaning

The PP1000se device has no user-serviceable parts. Unless otherwise instructed, do not, under any circumstances, attempt any service, adjustments, or repairs on the unit. Disconnect the device before cleaning.

To clean the unit, periodically use a clean cloth, slightly dampened with water and a drop or two of mild soap. For stubborn stains, use alcohol or an alcohol-based cleaner. For best results, use a VeriFone Cleaning Kit (refer to [Accessories and Documentation](#)).



**CAUTION**

Never use thinner, trichloroethylene, or ketone-based solvents – they can deteriorate plastic or rubber parts.

Because the PP1000se can be damaged by liquid, do not spray cleaners or other solutions directly onto the keypad or display. Always apply the cleaner to a cloth before cleaning the device.

### Service Returns

For PP1000se equipment failures that cannot be resolved by your help desk or service department, contact one of the following hotlines for product service and repair information:

- USA – VeriFone Service and Support Group, 1-800-834-9133, Monday - Friday, 8 A.M. - 7 P.M., EST
- International – Contact your VeriFone representative

Before returning PP1000se unit to VeriFone, you must obtain a Merchandise Return Authorization (MRA) number. The following procedure describes how to return one or more PP1000se for repair or replacement (U.S. customers only).

**NOTE**



International customers, please contact your local VeriFone representative for assistance with your service, return, or replacement.

- 1 Gather the following information from the printed labels (see [Figure 17](#)) on the bottom of *each* PP1000se device to be returned:
  - Product ID, including the model and part number. For example, “P003-280-02-XXn”
  - Serial number (S/N xxx-xxx-xxx)
- 2 Within the United States, call VeriFone toll-free at 1-800-834-9133.

- 3 Select the MRA option from the automated message. The MRA department is open Monday–Friday, 8 A.M.–7 P.M., EST.
- 4 Give the MRA representative the information gathered in [Step 1](#).  
If the list of serial numbers is long, you can fax the list, along with the information gathered in [Step 1](#), to the MRA department at 1-727-953-4172 (U.S.)
  - Please address the fax clearly to the attention of the “VeriFone MRA Dept.”
  - Include a telephone number where you can be reached, as well as your fax number.
  - You will be issued MRA number(s) and the fax will be returned to you.



One MRA number must be issued for each PP1000se unit you return to VeriFone, even if you are returning several of the same model.

- 5 Describe the problem(s).
- 6 Provide the shipping address where the repaired or replacement unit must be returned.
- 7 Keep a record of the following items:
  - Assigned MRA number(s).
  - The serial number assigned to the PP1000se device (located at the bottom of the unit (see [Figure 17](#)).
  - Shipping documentation, such as air bill numbers, used to trace the shipment.
  - Model(s) returned (model numbers are located on the bottom of the unit).

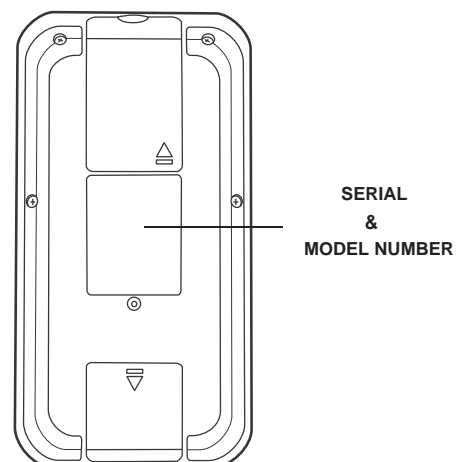

**Figure 17** Product Information Label

## **Accessories and Documentation**

VeriFone produces accessories and documentation for the PP1000se. When ordering, please refer to the part number in the left column.

- VeriFone Online Store at [www.store.verifone.com](http://www.store.verifone.com)
- USA – VeriFone Customer Development Center, 1-800-VeriFone (837-4366)  
Monday - Friday, 7 A.M. - 5 P.M., MST
- International – Contact your VeriFone representative

**Cables** Contact your local VeriFone distributor to determine which cable fits your needs.

CBL180-001-01-A	USB controller cable
CBL180-003-01-A	RS232 controller cable
CBL180-007-01-A	Serial controller cable with DC input jack

### **Power Supply**

xxxxx-xxx-xxx	Power pack for serial controller cable
CPS11212-1C-R	DC power supply (U.S.)
CPS11212-2D-R	DC power pack (Europe)
CPS11212-2E-R	DC power pack (China)
CPS11212-2F-R	DC power pack (UK)
CPS11212-2G-R	DC power pack (Australia)

### **Cleaning Kit**

02746-01	VeriFone Cleaning Kit
----------	-----------------------

### **Documentation**

DOC180-081-EN	PP1000se Certifications and Regulations
DOC180-082-EN	PP1000se Quick Installation Guide



VeriFone, Inc.  
2099 Gateway Place, Suite 600  
San Jose, CA, 95110 USA  
1-800-VERIFONE  
[www.verifone.com](http://www.verifone.com)

# PP1000se

## *Installation Guide*





2099 Gateway Place, Suite 600  
 San Jose, CA 95110 USA  
 Telephone: (800) VeriFone (837-4366)  
 World Wide Web: www.verifone.com

## PP1000SE Product Certifications and Regulations

### Electrical

The reference input power rating for the PP1000SE is 5-12 VDC, 500 mA max.

### Disconnecting Power

Disconnecting power during a transaction may cause transaction data files that are not yet stored in memory to be lost.

### Location – Electrical Considerations

Avoid locations near electrical appliances or other devices that cause excessive voltage fluctuations or emit electrical noise (for example, air conditioners, neon signs, high-frequency or magnetic security devices, or electric motors). CAUTION: Due to risk of electrical shock or unit damage, do not use the device near water, including a bathtub, wash bowl, kitchen sink or laundry tub, in a wet basement, or near a swimming pool. Also, avoid using this product during electrical storms.

### Equipment

#### Damage

Carefully inspect the shipping carton and its contents for any damage. If the unit or any product component appears damaged or to have been tampered with, immediately notify the shipping company and your VeriFone distributor or service provider. Do not use a unit that has been damaged or tampered with.

### Lithium Battery Caution

The Random Access Memory (RAM) contents in the device are protected by a lithium battery. Do not, *under any circumstances*, attempt to replace this battery. Failure to comply may invalidate the product warranty.

### Tamper Warning

This device has a tamper-evident case to indicate if an unauthorized party has opened the device. Opening the case will make the unit inoperable and void the product warranty.

### Repairs

Do not, *under any circumstances*, attempt any service, adjustments, or repairs on this equipment. Instead, contact your local VeriFone distributor or service provider for assistance. Failure to comply may invalidate the product warranty.

### Location – Environmental Considerations

Do not operate the device outdoors. It is not waterproof or dustproof, and is for indoor use only. Any damage to the unit from exposure to rain or dust may invalidate the product warranty. Do not use the unit where there is high heat, dust, humidity, moisture, or caustic chemicals or oils. Keep the unit away from direct sunlight and anything that radiates heat, such as a stove or a motor.

### Location – Ease of Use

Select a location for your device that contributes to its ease of use:

- A location convenient for both merchant and cardholder.
- A flat support surface, such as a countertop or table.

### Cleaners and Solvents

Never use thinner, trichloroethylene, or ketone-based solvents to clean the device — they may deteriorate plastic or rubber parts. Do not spray cleaners or other solutions directly onto the keypad or display. For best results, use a clean cloth dampened with water and mild soap. To remove stubborn stains, use alcohol or an alcohol-based cleaner.

### FCC Compliance

The following product has been tested and certified as compliant with the regulations and guidelines set forth in Part 15 of FCC Rules:

Manufacturer: VeriFone, Inc.

Brand, Model: PP1000SE

### Part 15 of FCC Rules

This device complies with the limits for a Class B digital device as specified in Part 15 of FCC Rules which provide reasonable protection against harmful interference in a residential area.

This device complies with Part 15 of the FCC Rules.

Operation is subject to the following two conditions:

- 1 This device may not cause harmful interference; and,
- 2 This device must accept any interference received, including interference that may cause undesired operation.

This equipment generates and uses radio frequency energy, and if not installed and used in accordance with the instructions, may cause harmful interference to radio communications. However, there is no guarantee that interference will not occur in a particular installation.

In the unlikely event that there is interference to radio or television reception (which can be determined by turning the equipment off and on), the user is encouraged to try to correct the interference by one or more of the following measures:

- Increase the separation between the equipment and receiver.
- Connect the equipment into an outlet on a circuit different from that to which the receiver is connected.
- Consult with the dealer or ask an experienced radio/TV technician for help.

Any changes or modifications to this equipment not expressly approved by VeriFone could void the user's authority to operate this equipment. The antenna(s) used for this transmitter must not be co-located or operating in conjunction with any other antenna or transmitter. Use of a shielded interface cable is required to comply with the Class B limits of Part 15 of FCC Rules.

### RF Exposure

This device was verified for RF exposure. To comply with Council Recommendation 1999/519/EC, IC RSS-102, and FCC RF exposure requirements, a minimum separation distance of 20 cm must be maintained between the user's body and the device, including the antenna. Any metallic components should be far from this device. Conditions that do not meet these requirements may not comply with Council Recommendation 1999/519/EC, IC RSS-102 and FCC RF exposure requirements and should be avoided.

To comply with the FCC RF exposure compliance requirements, make sure to use only the antenna that is included with the device.

This device and its antenna must not be in the same location or operating in the same area in conjunction with any other antenna or transmitter.

### Legal Terms and Conditions Regarding PCI SSC Approvals

PCI SSC's approval only applies to PEDs that are identical to the PED tested by a PCI Security Standards Council recognized laboratory. If any aspect of the PED is different from that which was tested by the laboratory - even if the PED conforms to the basic product description contained in the letter, then the PED model should not be considered approved, nor promoted as approved. For example, if a PED contains firmware, software, or physical construction that has the same name or model number as those tested by the laboratory, but in fact are not identical to those PED samples tested by the laboratory, then the PED should not be considered or promoted as approved.

No vendor or other third party may refer to a PED as "PCI Approved," nor otherwise state or imply that PCI SSC has, in whole or part, approved any aspect of a vendor or its PEDs, except to the extent and subject to the terms and restrictions expressly set forth in a written agreement with PCI SSC, or in an approval letter. All other references to PCI SSC's approval are strictly and actively prohibited by PCI SSC.

When granted, an approval is provided by PCI SSC to ensure certain security and operational characteristics important to the achievement of PCI SSC's goals, but the approval does not under any circumstances include any endorsement or warranty regarding the functionality, quality, or performance of any particular product or service. PCI SSC does not warrant any products or services provided by third parties. Approval does not, under any circumstances, include or imply any product warranties from PCI SSC, including, without limitation, any implied warranties of merchantability, fitness for purpose or noninfringement, all of which are expressly disclaimed by PCI SSC. All rights and remedies regarding products and services, which have received an approval, shall be provided by the party providing such products or services, and not by PCI SSC or the payment brand participants.

This equipment operates on a secondary basis. It is not entitled to protection from harmful interference, even for stations of the same type, and may not cause interference to systems operating on a primary basis.

### PP1000SE Certifications and Regulations

VeriFone Part Number: DOCXXX-XXX-EN-A Revision A.2



### Recycling: DO NOT DISCARD!

UNIT MUST BE RECYCLED OR DISPOSED OF PROPERLY  
 For proper disposal instructions go to <http://recycle.verifone.com/>

Please retain this sheet for future reference.

continued on rear cover

