

capello™



Wireless Speaker

Bluetooth Wireless

The easiest way to stream wirelessly and enjoy great audio for all your music, videos, games and apps

CB351 user guide



CAUTION
RISK OF ELECTRIC SHOCK
DO NOT OPEN



CAUTION: TO REDUCE THE RISK OF ELECTRIC SHOCK, DO NOT REMOVE COVER (OR BACK). NO USER-SERVICEABLE PARTS INSIDE. REFER SERVICING TO QUALIFIED SERVICE PERSONNEL.



DANGEROUS VOLTAGE: The lightning flash with arrowhead symbol, within an equilateral triangle is intended to alert the user to the presence of uninsulated dangerous voltage within the product's enclosure that may be of sufficient magnitude to constitute a risk of electric shock to persons.



ATTENTION: The exclamation point within an equilateral triangle is intended to alert the user to the presence of important operating and maintenance (servicing) instructions in the literature accompanying the appliance.

WARNING: Changes or modifications to this unit not expressly approved by the party responsible for compliance would void the user's authority to operate the equipment.

ATTENTION: POUR ÉVITER LES CHOC ÉLECTRIQUES, INTRODUIRE LA LAME LA PLUS LARGE DE LA FICHE DANS LA BORNE CORRESPONDANTE DE LA PRISES ET POUSSER JUSQU'AU FOND.

NOTE: This equipment has been tested and found to comply with the limits for a Class B digital device, pursuant to Part 15 of the FCC Rules. These limits are designed to provide reasonable protection against harmful interference in a residential installation. This equipment generates, uses and can radiate radio frequency energy and, if not installed and used in accordance with the instructions, may cause harmful interference to radio communications. However, there is no guarantee that interference will not occur in a particular installation. If this equipment does cause harmful interference to radio or television reception, which can be determined by turning the equipment off and on, the user is encouraged to try to correct the interference by one or more of the following measures:

- Reorient or relocate the receiving antenna.
- Increase the separation between the equipment and receiver.
- Connect the equipment into an outlet on a circuit different from that to which the receiver is connected.
- Consult the dealer or an experienced radio/TV technician for help.

Compliance information: This device complies with Part 15 of the FCC Rules. Operation is subject to the following two conditions: (1) this device may not cause harmful interference, and (2) this device must accept any interference received, including interference that may cause undesired operation.

WARNING: TO PREVENT FIRE OR SHOCK HAZARD, DO NOT EXPOSE THIS UNIT TO RAIN OR MOISTURE.

SURGE PROTECTORS: It is recommended to use a surge protector for AC connection. Lightning and power surges ARE NOT covered under warranty for this product.

SAFETY PRECAUTIONS

- a. Do not expose this unit or the AC/DC adapter to dripping or splashing water. Keep liquid-filled objects, such as vases, away from this unit and AC/DC adapter.
- b. Only use attachments / accessories specified by the manufacturer.
- c. Ensure that the AC/DC adapter is easily accessible.
- d. Please note the information printed underneath the unit.
- e. Do not impede the ventilation of this unit by covering the ventilation openings with items such as newspapers, table-cloths, curtains, etc.
- f. Keep open flames, such as lighted candles, away from this unit.
- g. Do not place this unit in closed bookcases, racks, or other spaces without proper ventilation.
- h. Unplug this unit during lightning storms or when unused for long periods of time.
- i. Use only the same or equivalent type batteries as there is a danger of explosion if the incorrect batteries are used or they are installed incorrectly.
- j. Batteries should not be exposed to excessive heat such as direct sunshine, fire, etc.
- k. Dispose of batteries properly according to environmental regulations.



inside the box

CB351 Wireless Speaker, AC power adapter, 3.5mm Line In Audio Cable and user guide.



power adapter option

To use CB351 with an existing power source, connect the supplied power adapter (DC 6V 2A) to the DC IN jack on the back of your CB351 (see “location of controls”) and plug the other end into a standard wall outlet (100~240V 50-60Hz).

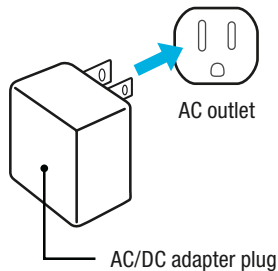

turning the unit on

Press the Power Button and the blue LED will illuminate, indicating that the CB351 is on.

note: During portable use, the LED will change to red and flash when the batteries are low and need to be replaced.



battery powered option

For portable use, you can install batteries to power your CB351. Playback time is approximately 8 hours at 75% volume and varies by type of music.

- 1 Open the Battery Door.
- 2 Insert four “AA” batteries into the battery compartment, being careful to observe proper polarity, as shown here.
- 3 Close the Battery Door.

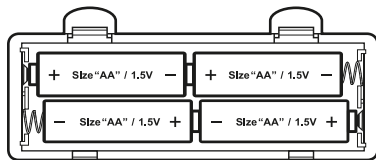

note: Alkaline batteries are recommended for the longest play time.

precautions when using batteries

- Use only the size and type of batteries specified “AA”
- Do not mix different types of batteries (e.g. Alkaline, Rechargeable and standard Carbon Zinc) or old batteries with new ones.
- Dead batteries must be removed to prevent battery leakage
- Dispose of batteries properly according to environmental regulations
- Batteries should not be exposed to excessive heat such as sunshine, fire, etc.
- Remove batteries if they lose power or if the CB351 is not going to be used for extended periods of time.

location of controls

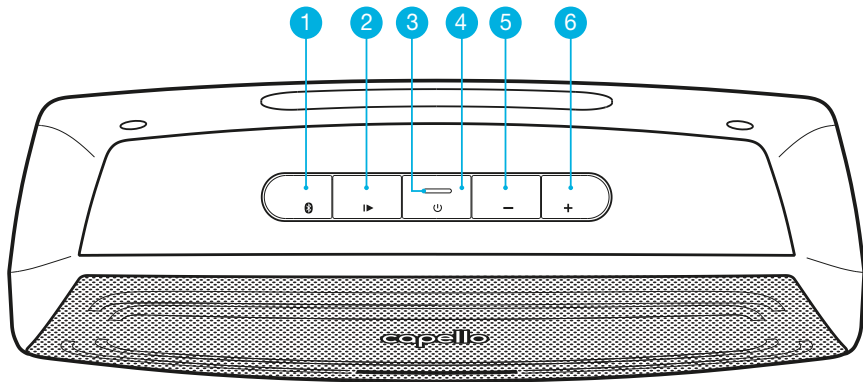

- 1 Bluetooth (Pair) Button
- 2 Play / Pause Button
- 3 LED Display Indicator

- 4 Power Button
- 5 Volume – Down Button
- 6 Volume + Up Button

- 7 USB Charging Port
- 8 External Jack Door
- 9 3.5mm Line In Jack
- 10 Pull Out Tray
- 11 DC Power In Jack
- 12 Battery Door

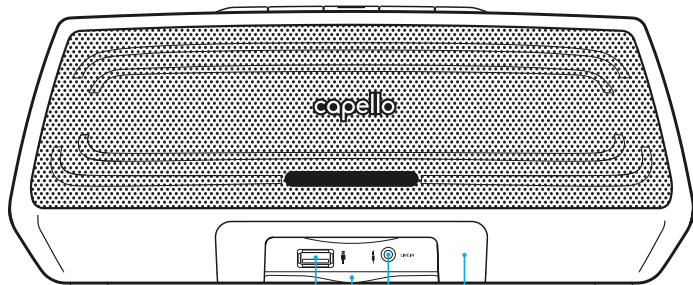

7 8 9 10

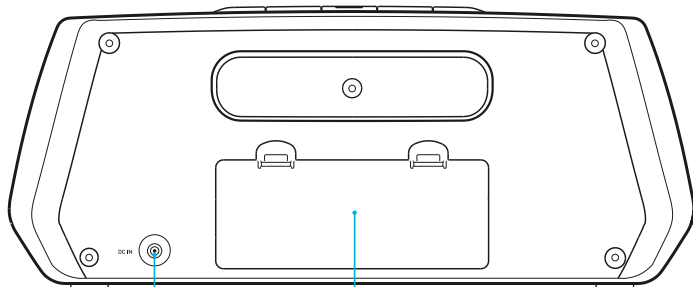

11 12

pull out tray

The CB351 includes a Pull Out Tray. This feature is designed to give you the option to rest your phone or device on the Pull Out Tray while charging or streaming audio to the unit.

To open and use the Pull Out Tray, simply place your fingers on the back edge of the tray as shown here, then gently slide it out until it stops.

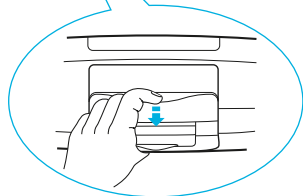
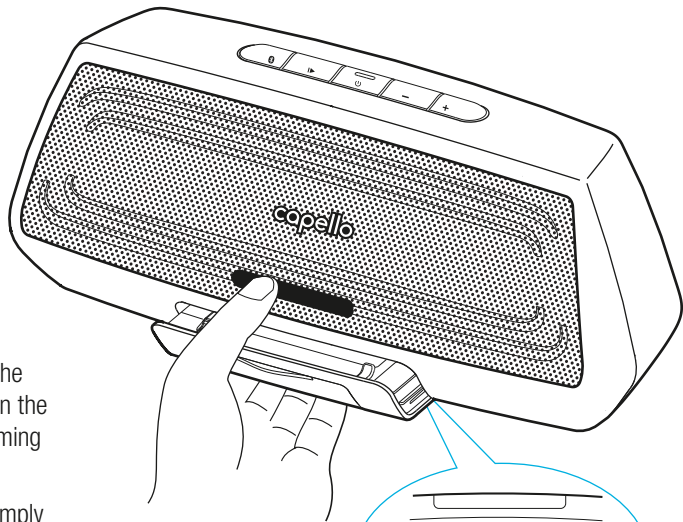

(bottom view)



streaming music and audio with Bluetooth wireless

You can stream audio wirelessly to your CB351 from up to 33' away using your iPhone, iPad, iPod, Android, laptop or other Bluetooth wireless technology enabled device.

- 1 Press the Power Button to turn on your CB351.
- 2 Then press the Pair Button. The blue LED on your CB351 will flash regularly.
- 3 Turn on your Bluetooth wireless device and then activate the feature with Bluetooth wireless.
- 4 Search for the Bluetooth wireless devices and select CB351. If asked for a password, enter '0000'.
- 5 The Blue LED on your CB351 will change from flashing to solid, indicating that your Bluetooth wireless device is connected to your CB351.

note: Press and hold the Pair Button for 3 seconds to disconnect the Bluetooth wireless connection. Your CB351 will return to pairing mode and the Blue LED will flash.



reconnecting your Bluetooth wireless devices

Once your Bluetooth wireless device has been paired with your CB351, it is simple to reconnect them when you want to stream music/audio again.

- 1 Make sure that your CB351 is powered on and within range.
- 2 Select 'CB351' from the list on your Bluetooth wireless device.
- 3 The Blue LED on your CB351 will change from flashing to solid, indicating that your Bluetooth wireless device is reconnected to your CB351.

note: For best audio performance, turn the volume on your Bluetooth source device all the way up.



line in connection

You can also play audio from other devices using the included 3.5mm Line In audio cable.

- 1 Press the Power Button to turn on your CB351
- 2 Insert one end of the 3.5mm audio cable into the Line In jack on the front of your CB351
- 3 Insert the other end of the 3.5mm audio cable into the Line Out or headphone jack of your external audio device (e.g. iPad, iPod shuffle, mobile phone, MP3 player or other digital media player, etc.)
- 4 Press the Play/Pause button on your external audio device to start playback. Press again to pause playback.

notes: For best audio performance and minimal distortion, avoid turning the volume on your audio source all the way up.

Your CB351 can only play audio from one source at a time. If your CB351 is connected to a Line In source, the Bluetooth wireless will not function. Simply unplug the 3.5mm Line In audio cable and press the Pair Button to switch to Bluetooth wireless (if necessary, select 'CB351' on your Bluetooth wireless device).

The Volume – Down or Volume + Up buttons do NOT function when playing music through Line In audio cable.



USB charging port

This unit includes a USB port placed on the front (see “location of controls”).

The USB port supplies 1A and will support powering and charging most devices including iPhones, iPads, iPods, smart phones, Android and most other USB devices. The USB port can only be used when CB351 is connected to an AC power source, it will not power or charge while operating from batteries in portable mode. (USB cable sold separately)



LED display indicators

LED	LED Status	Speaker Status
BLUE	Steady	Connected to Bluetooth wireless device
		Line In mode
	Flashing	Power On
		Bluetooth Pairing mode
		Volume button pressed when volume is at minimum
Volume button pressed when volume is at maximum		
RED	Flashing	Battery is low

capello™

For further assistance, please visit our website: ***hellocapello.com*** or contact customer service at ***support@capelloproducts.com*** or ***1-855-896-1795***.

Life Lab International Ltd

The Bluetooth® word mark and logos are registered trademarks owned by Bluetooth SIG, Inc. and any use of such marks by Life Lab International LTD. is under license. Other trademarks and trade names are those of their respective owners.