

iLuv®

User Manual



English



(Ver 1.0)

1. Pairing with AirPods



- 1 Open the AirPods case with your AirPods inside and hold it next to your AirFree™. Press & Hold the pair button on the back of the case until the White light flashes.



- 2 Press & Hold the power button until the White light flashes slowly.



- 3 The AirFree™ will automatically detect and pair the AirPods. When connection is successful, both products' Indicator Lights will change to Green.

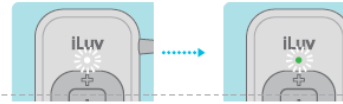

- 4 Plug AirFree™ into a compatible audio headphone jack to enjoy Hands-Free listening through your AirPods or Bluetooth-enabled audio device



- 5 Volume Control: Press & Hold (+) or (-) to increase or decrease volume

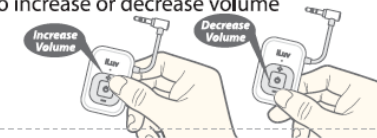

iLuv®

Manuel de l'utilisateur



Français



(Ver 1.0)

1. Jumeler avec les AirPods



- 1 Placez les AirPods dans leur boîtier de chargement dont vous laisserez le couvercle ouvert. Appuyez et maintenez le bouton de jumelage enfoncé à l'arrière du boîtier de l'AirPod jusqu'à ce que le voyant blanc clignote.



- 2 Appuyez sur le bouton d'alimentation et maintenez-le enfoncé jusqu'à ce que le voyant blanc clignote lentement.

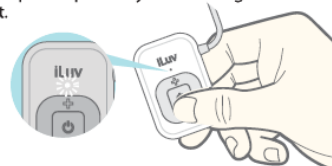

- 3 Le voyant blanc clignotant d'AirFree™ deviendra vert pendant 10 secondes une fois le jumelage réussi. Une fois jumelé, le voyant blanc clignotera toutes les 5 secondes.



- 4 Branchez AirFree™ dans la prise des écouteurs de votre choix et profitez de votre écoute avec vos AirPods.

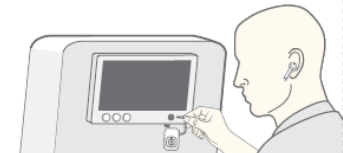

- 5 Contrôle du volume: maintenez les boutons « + » ou « - » enfoncés pour augmenter ou diminuer le volume.



2. Power Off

Press & Hold the power button until the Red light flashes twice.

* When it is powered on, AirFree™ will auto-connect to the last paired device, such as AirPods or bluetooth headphones.



3. Pairing AirFree™ with Bluetooth Headphones

Power on the AirFree™ and put your bluetooth headphones into pairing mode. The devices will connect automatically.

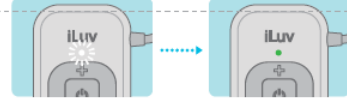

* The flashing White light on the AirFree™ will turn solid Green for 10 seconds when pairing is successful. Once paired, the White light flashes every 5 seconds.

4. Reconnecting AirPods or Bluetooth Headphones to your mobile device

Power off AirFree™, go to your bluetooth settings and select your Bluetooth Headphones.



5. Charging

1 Recharge your AirFree™ by connecting the Micro USB into the product charging port and the USB to a USB port or charger.

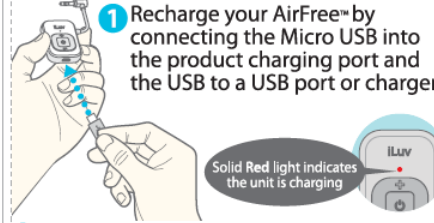

2 Indicator light will change to Green when it is fully charged.

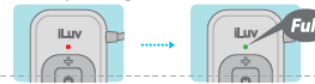

6. AirFree™ Light Indicator

- Pairing/Connectivity – Slow blinking White light
- Pairing Successful – Solid Green light will show for 10 seconds then will change to a blinking White light
- Paired – White light will flash every 5 seconds
- Disconnected – White light will flash slowly (product will power off 5 minutes later)
- Power off – Red light blinks twice and powers off
- Low battery (under 15%) – Solid Red light
- During charging – Solid Red light
- Fully charged – Solid Green light (light will turn off when product is disconnected from the charger)

7. What's Included



2. Mettre hors tension

Appuyez sur le bouton d'alimentation et maintenez-le enfoncé jusqu'à ce que le voyant rouge clignote deux fois.

* Lorsqu'il est allumé, AirFree™ se connecte automatiquement au dernier appareil jumelé, tel que les AirPods ou les écouteurs Bluetooth.



3. Jumeler AirFree™ avec des écouteurs Bluetooth

Allumez AirFree™ et mettez vos écouteurs Bluetooth en mode de jumelage. Les appareils se connecteront automatiquement.

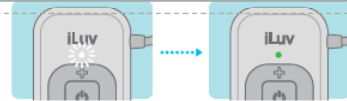

* Quand le jumelage est réussi, le voyant blanc clignotant sur AirFree™ devient vert pendant 10 secondes. Une fois jumelés, la lumière blanche clignotera toutes les 5 secondes.

4. Reconnecter des AirPods ou d'un casque Bluetooth à votre appareil mobile

Mettez AirFree™, hors tension, accédez à vos paramètres Bluetooth et sélectionnez votre casque Bluetooth.



5. Charger

1 Rechargez votre AirFree™ en utilisant le câble de charge fourni et tout port USB ou chargeur alimenté.



2 Le voyant se transformera en voyant vert fixe une fois la charge terminée.

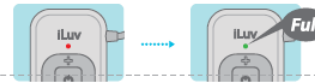

6. Indicateur lumineux AirFree™

- Mode d'appariement – Lumière blanche clignotant lentement
- Appariement réussi – Lumière verte fixe pendant 10 secondes se transformant en lumière blanche clignotante
- Jumelé – Lumière blanche clignotant toutes les 5 secondes
- Disconnected – White light will flash slowly (product will power off 5 minutes later)
- Débranché – Voyant blanc clignotant lentement (s'éteindra 5 minutes plus tard)
- Batterie faible (moins de 15%) – Lumière rouge fixe (à charger rapidement)
- Pendant la charge – Lumière rouge fixe (à charger rapidement)
- Complètement chargé – Voyant vert fixe jusqu'à ce que le chargeur soit débranché

7. Ce qui est inclus



FCC Statement:

This device complies with part 15 of the FCC Rules. Operation is subject to the following

two conditions: (1) This device may not cause harmful interference, and (2) this device

must accept any interference received, including interference that may cause undesired

operation.

This equipment has been tested and found to comply with the limits for a Class B digital

device, pursuant to part 15 of the FCC Rules. These limits are designed to provide reasonable protection against harmful interference in a residential installation. This equipment generates, uses and can radiate radio frequency energy and, if not installed and used in accordance with the instructions, may cause harmful interference to radio communications. However, there is no guarantee that interference will not occur in a particular installation. If this equipment does cause harmful interference to radio or television reception, which can be determined by turning the equipment off and on, the

user is encouraged to try to correct the interference by one or more of the following measures:

—Reorient or relocate the receiving antenna.

—Increase the separation between the equipment and receiver.

—Connect the equipment into an outlet on a circuit different from that to which the receiver is connected.

—Consult the dealer or an experienced radio/TV technician for help.

Caution: Any changes or modifications not expressly approved by the party responsible

for compliance could void the user's authority to operate the equipment.

This equipment complies with FCC radiation exposure limits set forth for an uncontrolled environment. This transmitter must not be co-located or operating in conjunction with any other antenna or transmitter.