

1 Charging

1 Charging the case

The indicator lights and flashes white while charging, and turns off when charging is complete.

- Be sure to use a USB conversion AC adapter (commercially available) with an output voltage of DC 5V, 1A or more, as it may cause a failure or abnormal heat generation.
- When charging, always use the included charging USB cable.

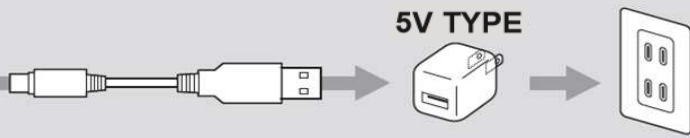

2 Charging the headsets

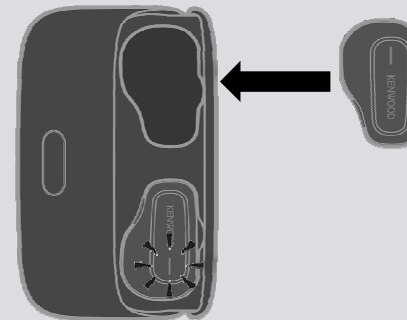

Insert earphones into charging case.

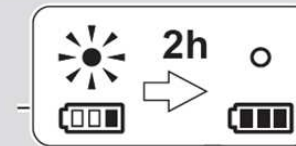

The indicator of the earphone lights red while charging. The indicator on the charging case lights up white. When charging is complete, the indicators on both the earphone and charging case will turn off.

2 Pairing

When you take out both earphones, the indicator lights up white and the

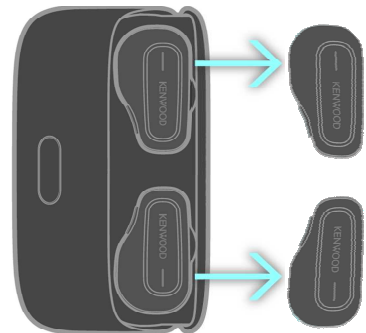

After a while, the indicator flashes red and white alternately and quickly.

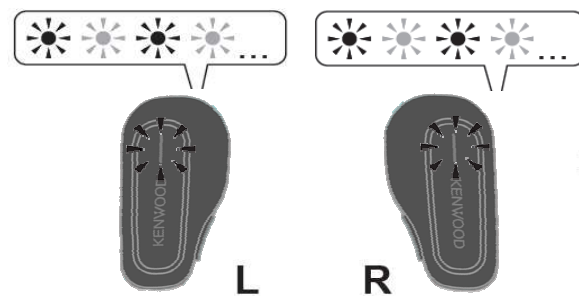

Select "KENWOOD WS-A1G" from the device list.

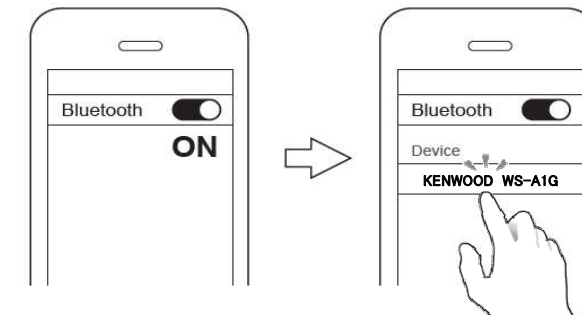

Flashes in white

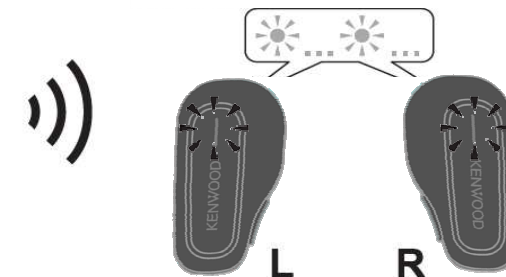

If the power does not turn on automatically (the indicator does not blink), press and hold the button on the earphone that is not turned on for about 3 seconds. The power turns on.

If the L indicator slowly flashes red, return both earphones to the charging case and remove them again.

If you cannot connect properly, put it back in the charging case, and repeat the procedure in "2. Pairing" from the beginning.

3 Operation

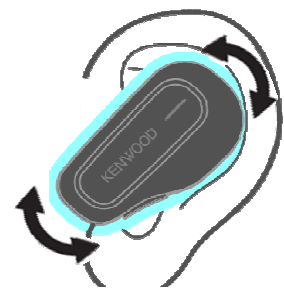

Adjust for a better fit

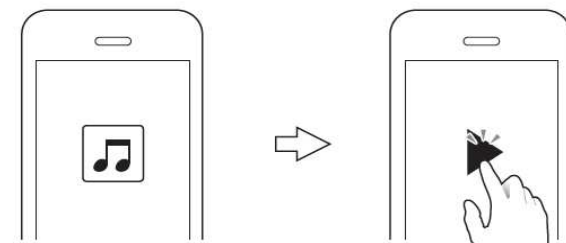

Start the music playback application on the partner device and

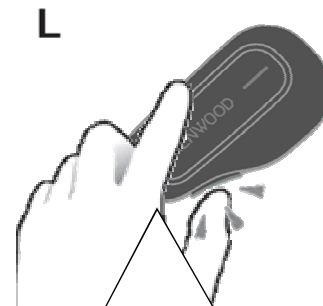

Button Operation
 ● AMBIENT — ● OFF — ● ANC

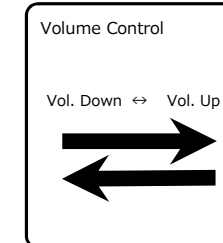
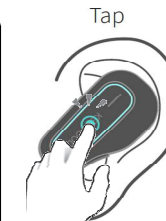
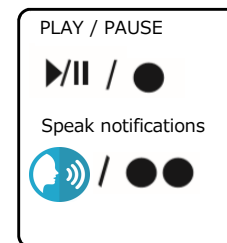

4 After use

After using, set firmly for charging.

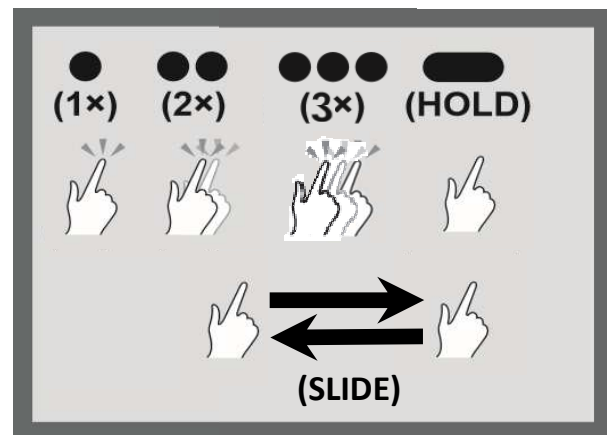

Button Operation
 ● Call
 ●● To reject a call

