

# Doors

## Using the Key

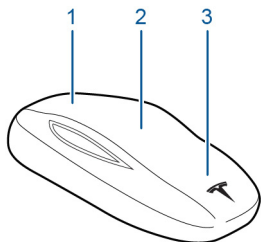

There are three buttons on the key, these are a softer area of the surface.

The buttons on the key transmit a coded radio signal to your Model S. It is not necessary to point the key at Model S, but you must be within operating range. The operating range will vary according to the condition of the key battery and other factors.

Use the buttons as follows:

### 1. Liftgate

- Press twice in quick succession to open the Liftgate.

*Note: If a powered Liftgate is installed, the Liftgate will raise.*

- Press once to stop a powered Liftgate.
- Press twice in quick succession to close a powered Liftgate.

### 2. Lock/Unlock

- Press once to lock all doors and the Liftgate. The hazard warning lights will flash once and a tone will sound to confirm.
- Press twice in quick succession to unlock the drivers door. The hazard warning lights will flash twice and two tones will sound to confirm.

*Note: If the multi-door unlock setting is enabled, all the doors and the Liftgate will unlock.*

- Press and hold to lower all the windows.

### 3. Frunk

- Press twice in quick succession to open the Frunk.

If you can not lock or unlock Model S using the key, you may need to change the key battery.

*Note: Interference from other radio equipment may affect key operation. If this happens, operate the key as close to Model S as possible. If you are still unable to unlock Model S with the key, you can unlock the doors and disarm the alarm by positioning the key against the passenger side front fender.*



**WARNING:** Remove all keys from Model S when it is left unattended. This will ensure Model S is left in a secure and safe condition. ▲

## Caring for the key



**CAUTION:** Protect the key from impact, water damage and high temperatures. Avoid contact with solvents, waxes and abrasive cleaners. Do not expose to direct sunlight.

## Replacing the key battery

When the key battery is low, a message will be displayed on the instrument cluster. Change the battery as soon as possible.

*Note: Life of a key battery is approximately one year depending on use.*

To change the key battery:

1. Place the key, button side down on a soft surface.

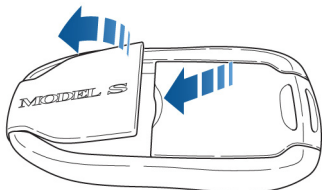

2. Using a small flat bladed tool, carefully release the rear cover from the key.
3. Remove the rear cover.

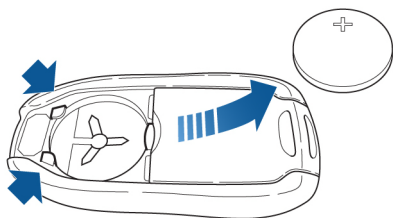

4. Push the battery towards the center of the key to release it from the front retaining clips and then remove the battery.
5. Fit the new battery (type CR2032) with the '+' side facing upwards. Finger marks will reduce battery life. Avoid touching the flat surfaces of the battery, and wipe the battery clean before fitting.
6. Align the front edges of the two key halves, then press them together until they snap into place.



Used batteries contain harmful substances. Seek advice on disposal from Tesla or your local authority.

## Obtaining additional or replacement keys

If you lose a key or require an additional one, contact Tesla. Model S can recognize three keys.

When ordering a new key for Model S, take all available keys with you so the system can be reprogrammed.

# Doors

## Passive Unlocking

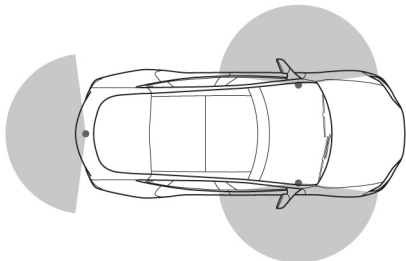

Your Model S may be equipped with sensors that can recognize the presence of a key outside the vehicle. The sensors are located at each end of the dash panel and behind the rear bumper, and have a range of approximately 3 ft (1 m).

If you are carrying a recognized key (e.g. in your pocket), touch a front door handle. The door handle will extend and you can open the door.

Similarly, press the switch located under the exterior handle to open the Liftgate.

*Note: The key may not be detected if you are carrying a cell phone, personal computer, wireless communication device, coins, metal wallet, CDs or DVDs.*

## Walk away locking

Select **P** (Park) and close all the doors. Check that you have the key when you exit Model S, and the doors and the Liftgate will automatically lock. The hazard warning lights will flash once and a tone will sound to confirm.

Enable or disable this feature using the touchscreen.

*Note: Touch the interior lock icon on the touchscreen with the driver's door open to enable the feature for a single lock cycle.*

If you leave the key inside Model S, the doors and Liftgate will remain unlocked.

## Opening the Doors

### Exterior handles

If you unlock Model S using the key, the door handles will automatically extend. If passive unlocking is installed, the door handles will extend when a front door handle is touched and a recognized key is detected.

If you do not open a door within five minutes, the handles will retract into the door.

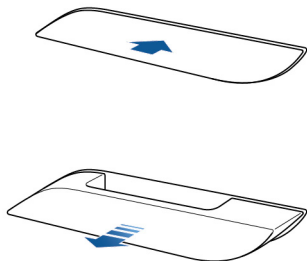

If Model S is still unlocked, touch a door handle and it will extend.

*Note: Lock Model S using the touchscreen to prevent the door handles extending.*

Lightly pull the door handle to release the door lock and partially open the door.

The door handles will automatically retract three seconds after the door is closed.

### Interior handles

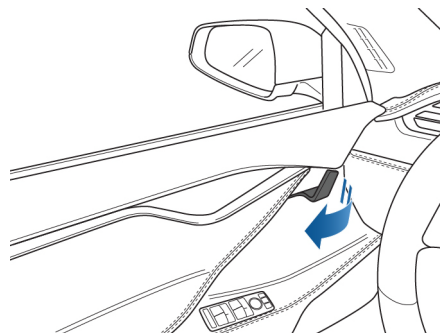

Pull the interior door handle towards you to open the door.

*Note: Engage the child safety locks to prevent the interior handles being used to open the rear doors.*

*Note: If you lock Model S using the key or with walk away locking, the alarm will sound if a front door is opened. The rear doors can not be opened using the interior handles.*

### Door open warning



When you open a door, the Frunk or the Liftgate, the door open warning light will illuminate.

With Model S in Drive mode, the left side of the instrument cluster will show a plan view of the vehicle with the aperture open and a warning message.

### After a collision

If you are in a collision and the air bags deploy, the door handles will automatically extend after 30 seconds and remain extended until Model S is locked using either the key or the touchscreen.

# Doors

## Interior Lock and Unlock Icon

You can lock and unlock Model S using the touchscreen, provided the key is inside the cabin.

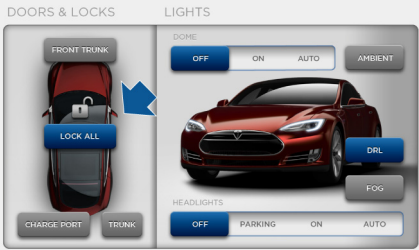

Touch the **CONTROLS** icon on the touchscreen to access the Model S controls screen. Touch the icon to change the lock status.



The change in lock status is indicated by a chime, and either the lock or unlock icon appearing on the instrument cluster.

*Note: If a door or the Liftgate are open and you touch the icon to lock the doors, the closed doors and Liftgate will be locked and the remaining doors will be locked immediately they are closed, providing a key is not detected inside the cabin.*

## Drive Away Locking

When your driving speed exceeds 5 mph (8 km/h), the doors and Liftgate will automatically lock.

Stop Model S and select **P** (Park), the doors and the Liftgate will unlock.

Use the touchscreen to enable or disable drive away locking.

## Child Safety Locks

Child safety locks are fitted to the rear doors and the Liftgate. Enable the safety locks to prevent the rear doors and the Liftgate from being opened using the interior handles.

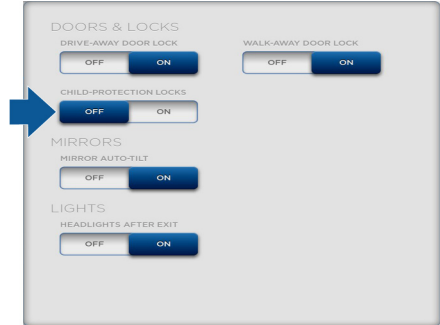

Use the touchscreen to enable or disable the child safety locks.

*Note: Engage child safety locks whenever children are being carried in the rear of Model S.*

## Emergency Door Opening Door opening backup process

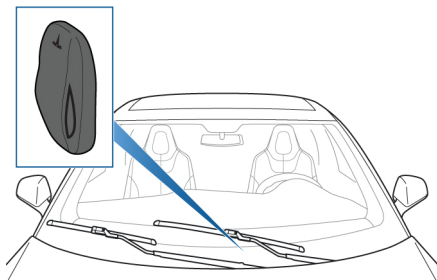

If you can not unlock Model S using the key, you can unlock the doors and disarm the alarm by positioning the key on the windshield as shown in the illustration.

Open the driver's door, a message in the instrument cluster will advise you to place the key in the backup start location. Place the key in the center console cup holder.

## Rear doors - interior release

If you experience an electrical failure, pull the mechanical release cable located below the outer rear seats to manually open the rear doors from inside Model S.

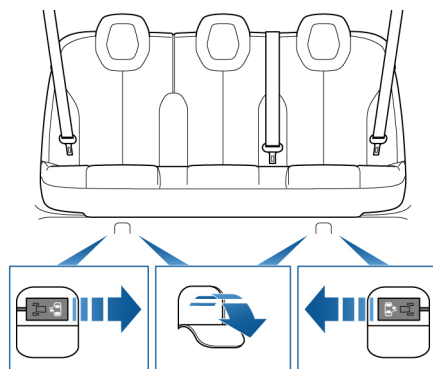

Fold back the panel in the carpet under the seat to access the release cable.

# Frunk

## Opening and Closing

### Opening

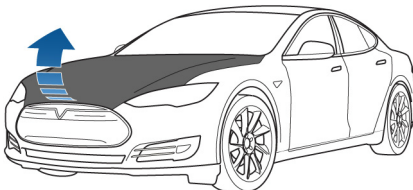
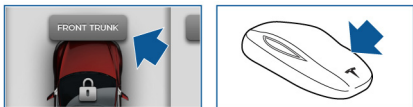

Open the Frunk as follows:

- Press the Frunk button on the key twice in quick succession.
- Touch the following icons on the touchscreen **Controls > Frunk**.



Open the Frunk. An indicator light illuminates on the instrument cluster.

With Model S in Drive mode, the left side of the instrument cluster will show a plan view of the vehicle with the Frunk open and a warning message.

*Note: You can not open the Frunk while Model S is moving. If you try to open it, a warning message will appear on the instrument cluster.*

### Closing

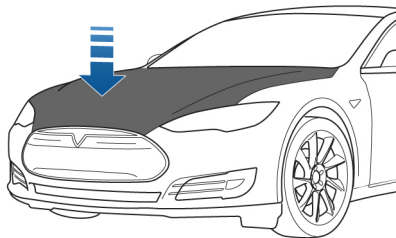

Lower the Frunk to the closed position and then push down on the center of the front edge to engage the primary and secondary catches. The catches click into position.

**⚠ WARNING:** Do not drive with the Frunk retained by the secondary catch alone. Lift the front edge of the Frunk to ensure that it is correctly retained. ▲

## Mechanical Release

If you experience an electrical failure, or you can not open the Frunk using the touchscreen or key, use the backup mechanical release lever located below the glove box.

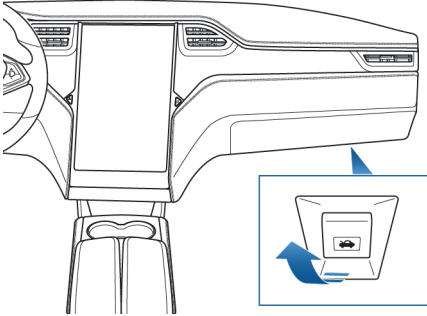

Pull the lever to release the primary catch on the Frunk.

*Note: If you use the release lever to open the Frunk when Model S is locked and the alarm is active, the alarm will sound.*

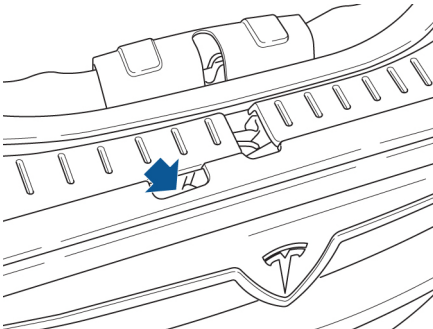

Push down on the secondary catch lever and lift the Frunk to open.

## Emergency Release Button

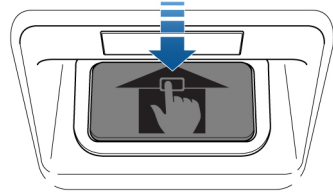

An emergency release button, inside the Frunk, provides a means of escape, should a person become locked inside the Frunk. Make occupants aware of the operation and location of the button.

*Note: The button is luminous and glows for hours after a brief exposure to ambient light.*

Press the button to open the Frunk and push up on the Frunk lid. The release button is active whenever Model S is stationary.



# Liftgate

## Manual Liftgate

### Opening and Closing

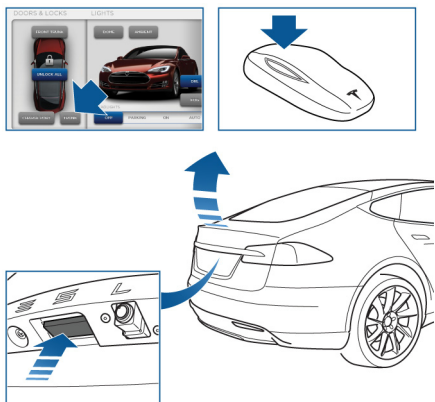

Open the Liftgate as follows:

- Press the Liftgate button on the key twice in quick succession.
- Touch the following icons on the touchscreen **Controls > Liftgate**.
- Unlock Model S and press the switch located under the exterior handle.



Open the Liftgate. An indicator light illuminates on the instrument cluster.

With Model S in Drive mode, the left side of the instrument cluster will show a plan view of the vehicle with the Liftgate open and a warning message.

*Note: You can not open the Liftgate when Model S is moving. If you try to open it, a warning message will appear on the instrument cluster.*

### Closing

Pull down on the Liftgate and then firmly push shut. Check that the Liftgate is fully closed.

## Powered Liftgate

The powered Liftgate option allows you to open and close the Liftgate with the touch of a button.

### Opening

Open the powered Liftgate as follows:

- Press the Liftgate button on the key, twice in quick succession.
- Touch the following icons on the touchscreen **Controls > Liftgate**.
- Unlock Model S and press the switch located under the exterior handle.

A chime will sound and the Liftgate will start to move.

Press the button on the key, touch the icon on the touchscreen, or press the switch on the exterior handle to stop the Liftgate.

### Liftgate opening height

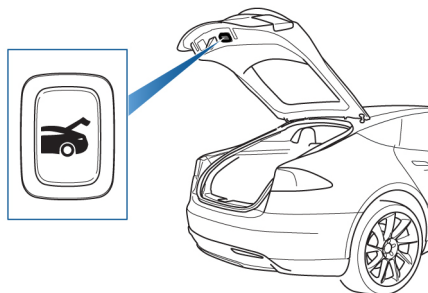

You can set the height to which the powered Liftgate opens to give easier access to the Liftgate closing button.

Set the Liftgate opening height as follows:

1. Lower the Liftgate to the desired height.
2. Press and hold the Liftgate closing button for two seconds. A chime will sound to confirm that the new height has been set.
3. Close and then open the Liftgate to confirm that the desired height is set.

## Closing

*Note: If you leave the Liftgate open for more than an hour, the power closing feature will be temporarily disabled. Manually close the Liftgate to restore powered operation.*

Close the powered Liftgate as follows:

- Press the Liftgate button on the key twice in quick succession.
- Touch the following icons on the touchscreen **Controls > Liftgate**.

A chime will sound and the Liftgate will start to close.

Press the button on the key, touch the icon on the touchscreen, or press the switch located under the exterior handle to stop the Liftgate.

If the Liftgate encounters an obstruction while closing, it will automatically stop and two chimes will sound. Remove the obstruction and try closing the Liftgate again. If the Liftgate cannot close for a second time, the chimes will sound and power closure will be temporarily disabled. Manually close the Liftgate to restore powered operation.

## Interior Release

*Note: The interior release switch is disabled if Model S is moving or you have engaged the child safety locks.*

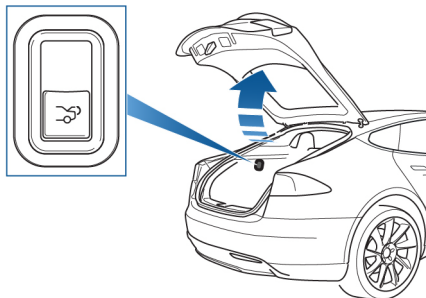

To open the Liftgate, pull down on the interior release switch and then push up on the Liftgate.

*Note: If the powered Liftgate option is installed, the Liftgate will open when the switch is pulled, or close when the switch is pushed.*

# Liftgate

---

## Emergency Release

If you experience an electrical failure, the liftgate can be opened from the inside using the mechanical release cable.

1. Pull the lower edge of the cover towards you to remove the cover.
2. Pull the cable to release the latch and push up on the liftgate to open.

## Key and Passive Unlocking System

### FCC certification

This device complies with Part 15 of the FCC rules. Operation is subject to the following two conditions:

1. this device may not cause harmful interference, and
2. this device must accept any interference received, including interference that may cause undesired operation.

Changes or modifications not expressly approved by Tesla Motors could void the user's authority to operate the equipment.

### IC certification

IC: 10176A-002

Model: 002

This device complies with Industry Canada licence-exempt RSS standard(s). Operation is subject to the following two conditions:

1. this device may not cause harmful interference, and
2. this device must accept any interference received, including interference that may cause undesired operation.

Le présent appareil est conforme aux CNR d'Industrie Canada applicables aux appareils radio exempts de licence. L'exploitation est autorisée aux deux conditions suivantes :

1. l'appareil ne doit pas produire de brouillage, et
2. l'utilisateur de l'appareil doit accepter tout brouillage radioélectrique subi, même si le brouillage est susceptible d'en compromettre le fonctionnement.

## Tire Pressure Monitoring System (TPMS)

The tire pressure monitoring system complies with Part 15 of the FCC rules and RSS-210 of Industry Canada. Operation is subject to the following two conditions:

1. this device may not cause harmful interference, and
2. this device must accept any interference received, including interference that may cause undesired operation.

Changes or modifications not expressly approved by Tesla Motors could void the user's authority to operate the equipment.

## Information to the user

This equipment has been tested and found to comply with the limits for a Class B digital device, pursuant to Part 15 of the FCC Rules. These limits are designed to provide reasonable protection against harmful interference in a residential installation. This equipment generates, uses and can radiate radio frequency energy and, if not installed and used in accordance with the instructions, may cause harmful interference to radio communications. However, there is no guarantee that interference will not occur in a particular installation. If this equipment does cause harmful interference to radio or television reception, which can be determined by turning the equipment off and on, the user is encouraged to try to correct the interference by one or more of the following measures:

- Reorient or relocate the receiving antenna.
- Increase the separation between the equipment and receiver.
- Connect the equipment into an outlet on a circuit different from that to which the receiver is connected.
- Consult the dealer or an experienced radio/TV technician for help