



JBL QUANTUM 910X WIRELESS FOR XBOX

QUICK START GUIDE



JBL QuantumENGINE

DOWNLOAD JBL QUANTUMENGINE TO GAIN FULL ACCESS TO FEATURES ON YOUR JBL QUANTUM HEADSETS - FROM HEADSET CALIBRATION TO ADJUSTING 3D AUDIO TO SUIT YOUR HEARING, FROM CREATING CUSTOMIZED RGB LIGHTING EFFECTS TO DETERMINING HOW THE BOOM MICROPHONE SIDE-TONE WORKS. JBLQUANTUM.COM/ENGINE

SOFTWARE REQUIREMENTS

PLATFORM: WINDOWS 10 (64 BIT ONLY) / WINDOWS 11
500MB OF FREE HARD DRIVE SPACE FOR INSTALLATION

*ALWAYS USE THE LATEST VERSION OF WINDOWS 10 (64 BIT) OR WINDOWS 11 FOR THE MOST OPTIMAL EXPERIENCE ON JBL QUANTUMENGINE

JBL QUANTUMSPHERE 360
AVAILABLE ON WINDOWS ONLY. SOFTWARE INSTALLATION REQUIRED.

JBL QUANTUMSPATIAL 360
AVAILABLE ON XBOX SERIES (X/S), XBOX ONE, PLAYSTATION™ (PS4/PS5) AND NINTENDO SWITCH

001 WHAT'S IN THE BOX



JBL QUANTUM 910X WIRELESS FOR XBOX



CALIBRATION MICROPHONE



USB CHARGING CABLE



3.5 MM AUDIO CABLE



USB-A TO USB-C CONVERTER



USB WIRELESS DONGLE



WINDSHIELD FOAM FOR BOOM MICROPHONE



QSG | WARRANTY CARD | SAFETY SHEET

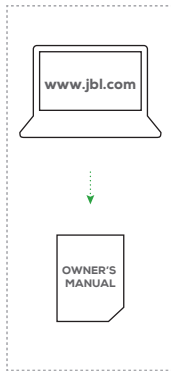

002 REQUIREMENTS



JBL QuantumENGINE SOFTWARE REQUIREMENTS

PLATFORM: WINDOWS 10 (64 BIT ONLY) / WINDOWS 11
500MB OF FREE HARD DRIVE SPACE FOR INSTALLATION

SYSTEM COMPATIBILITY

PC | XBOX™ | PLAYSTATION™ | NINTENDO SWITCH™ | MOBILE | MAC

CONNECTIVITY	PC	PS4/PS5	XBOX™	NINTENDO SWITCH™	MOBILE	MAC
3.5 mm Audio Cable	Stereo	Stereo	Stereo	Stereo	Stereo	Stereo
2.4GHz Wireless	JBL QuantumSPHERE 360™	JBL QuantumSPATIAL 360™	JBL QuantumSPATIAL 360™	JBL QuantumSPATIAL 360™	Not Compatible	JBL QuantumSPATIAL 360™
Bluetooth	Stereo	Not Compatible	Not Compatible	Stereo	Stereo	Stereo

003 OVERVIEW

- 01 ANC / TALKTHRU LED
- 02 ANC / TALKTHRU BUTTON
- 03 GAME AUDIO-CHAT BALANCE DIAL
- 04 VOLUME CONTROL
- 05 DETACHABLE WINDSHIELD FOAM
- 06* NOTIFICATION LED FOR MIC MUTE / UNMUTE
- 07* MICROPHONE MUTE / UNMUTE
- 08 CHARGING LED
- 09 3.5 MM AUDIO JACK
- 10 USB-C PORT
- 11 VOICE FOCUS BOOM MICROPHONE
- 12 SPATIAL SOUND / HEAD TRACKING CONTROL
- 13 POWER ON / OFF AND BLUETOOTH PAIRING SLIDER
- 14 POWER / 2.4GHz / BLUETOOTH LED
- 15* RGB LIGHTING ZONES
- 16 FLAT-FOLD EAR CUP
- 17 2.4GHz PAIRING BUTTON
- 18 VOLUME CONTROL
- 19 MIC MUTE BUTTON

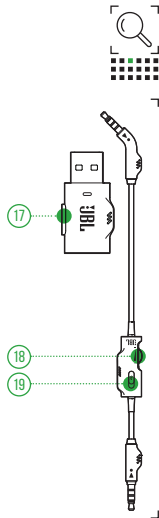
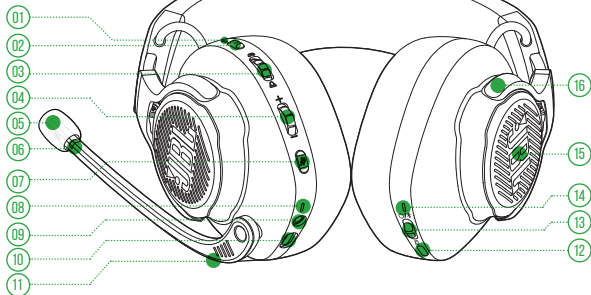

004 CALIBRATION MICROPHONE

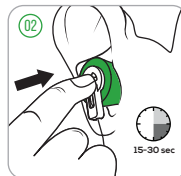
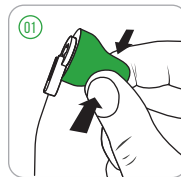
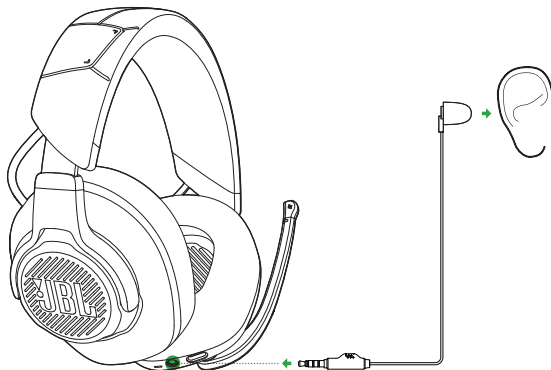

GO TO **JBL QuantumENGINE** FOR DETAILED SETUP INSTRUCTIONS.

005 POWER ON & CONNECT (XBOX)

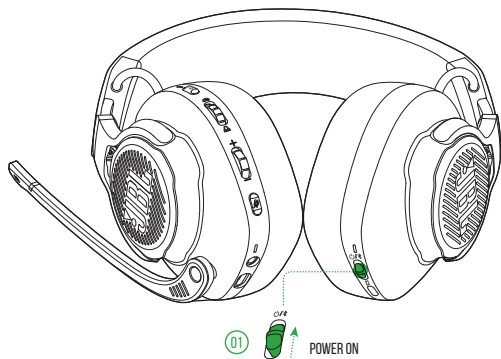

02 2.4GHz WIRELESS



MANUAL PAIRING

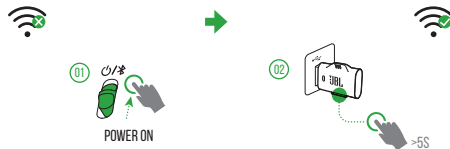

006 POWER ON & CONNECT (PC, MAC ETC.)

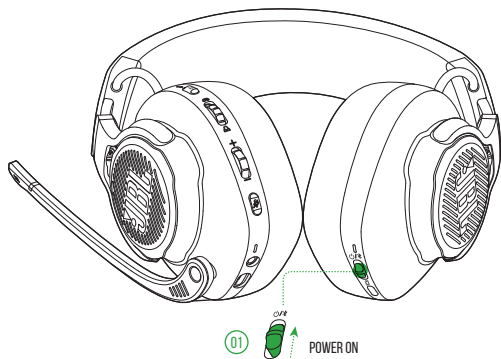

02 2.4GHz WIRELESS

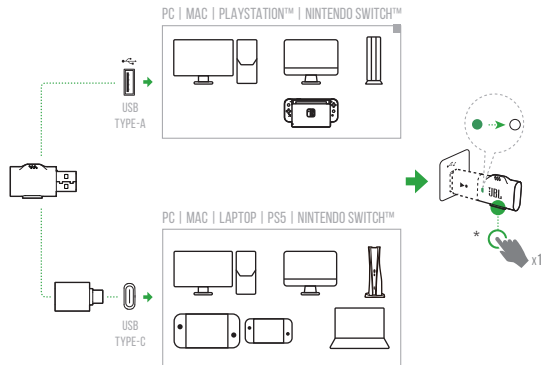

* ONLY REQUIRED FOR DEVICES (E.G., WINDOWS PC) WITHOUT AUTO SWITCH (GREEN TO WHITE AUTOMATICALLY)

007 BLUETOOTH

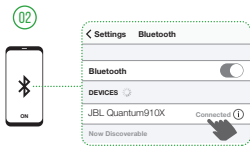
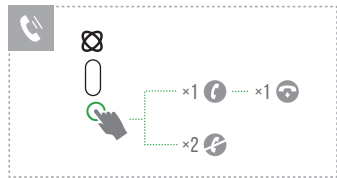
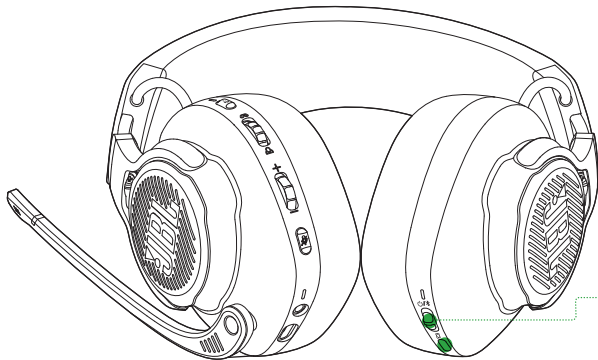

008 SETUP

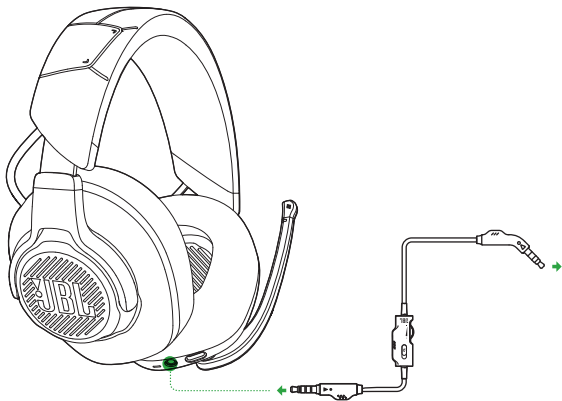

XBOX™ | PLAYSTATION™ | NINTENDO SWITCH™ | MOBILE | MAC

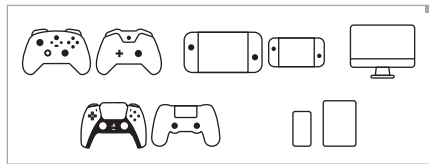

009 BUTTON COMMAND



ANC ON/OFF x1 | TALKTHRU ON/OFF >2s 

INCREASE GAME VOLUME 

INCREASE CHAT VOLUME 

INCREASE MASTER VOLUME 

DECREASE MASTER VOLUME 

MICROPHONE MUTE / UNMUTE x1 
JBL Quantum LIGHTING ON / OFF >5s 

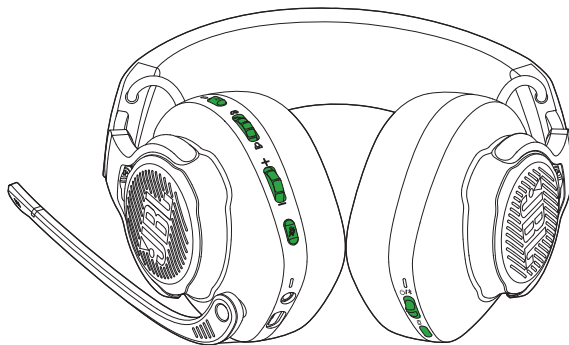

↑ x1 ON ↓ x1 OFF
↑ x1 BT RECONNECTING
↑ >2s BT PAIRING MODE



x1 OFF (DEFAULT) | SPATIAL SOUND | SPATIAL SOUND + HEAD TRACKING
>2s RE-CENTERING FOR HEAD TRACKING

010 FIRST TIME SETUP



- 10A CONNECT THE HEADSET TO YOUR PC VIA 2.4GHz USB WIRELESS CONNECTION.
- 10B GO TO "SOUND SETTINGS" -> "SOUND CONTROL PANEL".
- 10C* UNDER "PLAYBACK" HIGHLIGHT "JBL QUANTUM 910X WIRELESS FOR XBOX GAME" AND SELECT "SET DEFAULT" -> "DEFAULT DEVICE".
- 10D HIGHLIGHT "JBL QUANTUM 910X WIRELESS FOR XBOX CHAT" AND SELECT "SET DEFAULT" -> "DEFAULT COMMUNICATION DEVICE".
- 10E UNDER "RECORDING" HIGHLIGHT "JBL QUANTUM 910X WIRELESS FOR XBOX CHAT" AND SELECT "SET DEFAULT" -> "DEFAULT DEVICE".
- 10F IN YOUR CHAT APPLICATION SELECT "JBL QUANTUM 910X WIRELESS FOR XBOX CHAT" AS THE DEFAULT AUDIO DEVICE.
- 10G FOLLOW THE ONSCREEN INSTRUCTIONS TO PERSONALIZE YOUR SOUND SETTINGS.

* IF YOU HAVE NOT INSTALLED JBL QUANTUMENGINE, ENSURE TO COMPLETE THIS STEP BEFORE ENABLING JBL QUANTUMSPATIAL 360.



011 MICROPHONE

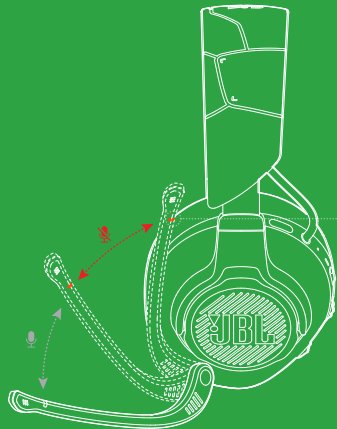

NOTIFICATION LED FOR MIC
MUTE / UNMUTE



012 CHARGING

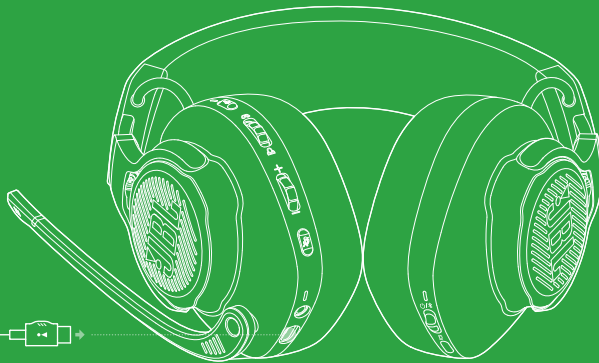

013 LED BEHAVIOURS

- ANC ON
- ANC OFF
- TALKTHRU ON

- MIC MUTE
- MIC UNMUTE

- LOW BATTERY
- CHARGING
- FULLY CHARGED

- 2.4GHz CONNECTING
- 2.4GHz CONNECTED

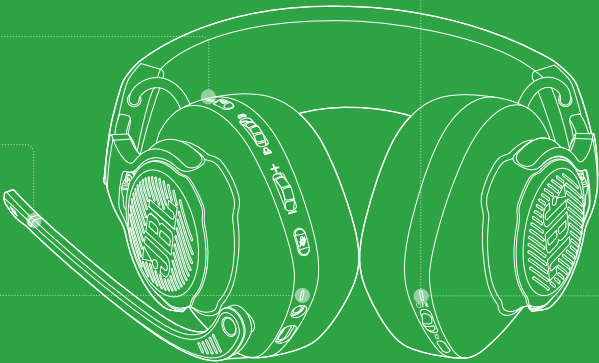

● 2.4GHz PAIRING	XBOX
● 2.4GHz CONNECTING	
● 2.4GHz CONNECTED	
● 2.4GHz PAIRING	PC, MAC ...
● 2.4GHz CONNECTING	
● 2.4GHz CONNECTED	

- BT PAIRING
- BT CONNECTING
- BT CONNECTED

- POWER ON
- POWER OFF



014 TECH SPEC



Model:	QUANTUM910X WIRELESS FOR XBOX QUANTUM910XWIRELESSTM	Bluetooth version:	BT Core: v5.2
Driver size:	50 mm Dynamic drivers	Battery type:	Li-ion battery (3.7 V / 1300 mAh)
Frequency response (Passive):	20 Hz - 40 kHz	Power supply:	5 V, 2 A
Frequency response (Active):	20 Hz - 20 kHz	Charging time:	3.5 hrs
Microphone frequency response:	100 Hz - 8 kHz	Music play time with BT+2.4GHz on and ANC+RGB lighting off:	Up to 34 hrs
Max input power:	30 mW	Talk time with BT+2.4GHz on and ANC+RGB lighting off:	Up to 35 hrs
Sensitivity:	113 dB SPL @1 kHz / 1 mW	Music play time with only 2.4GHz on and ANC+RGB lighting off:	Up to 37 hrs
Maximum SPL:	93 dB	Talk time with only 2.4GHz on and ANC+RGB lighting off:	Up to 37 hrs
Microphone sensitivity:	-38 dBV / Pa @1 kHz	Music play time with only BT on and ANC+RGB lighting off:	Up to 42 hrs
Impedance:	32 ohm	Talk time with only BT on and ANC+RGB lighting off:	Up to 46 hrs
2.4GHz Wireless transmitter power:	<11 dBm (headphone) <9dBm (dongle)	Microphone pickup pattern:	Unidirectional
2.4GHz Wireless modulation:	GFSK, $\pi/4$ -DQPSK	Weight:	420 g
2.4GHz Wireless carrier frequency:	2400 MHz - 2483.5 MHz		
Bluetooth transmitted power:	<12 dBm (EIRP)		
Bluetooth transmitted modulation:	GFSK, $\pi/4$ -DQPSK		
Bluetooth frequency:	2400 MHz - 2483.5 MHz		
Bluetooth profile version:	HFP: v1.8, A2DP: v1.3		

CONNECTIVITY	PC	PS4/PS5	XBOX™	NINTENDO SWITCH™	MOBILE	MAC
3.5 mm Audio Cable	Stereo	Stereo	Stereo	Stereo	Stereo	Stereo
2.4GHz Wireless	JBL QuantumSPHERE 360™	JBL QuantumSPATIAL 360™	JBL QuantumSPATIAL 360™	JBL QuantumSPATIAL 360™	Not Compatible	JBL QuantumSPATIAL 360™
Bluetooth	Stereo	Not Compatible	Not Compatible	Stereo	Stereo	Stereo

FR

CONNECTIVITÉ | PC | PS4/PS5 | XBOX™ | NINTENDO SWITCH™ | MOBILE | MAC
 Câble audio 3,5 mm | Stéréo
 Sans fil 2,4 GHz | Non compatible
 Bluetooth

EL

ΣΥΝΔΕΣΙΜΟΤΗΤΑ | PC | PS4/PS5 | XBOX™ | NINTENDO SWITCH™ | MOBILE | MAC
 Καλώδιο ήχου 3,5 mm | Stereo
 2,4 GHz Ασύρματο | Μη συμβατό
 Bluetooth

HU

KAPCSOLÓDÁS | PC | PS4/PS5 | XBOX™ | NINTENDO SWITCH™ | MOBILE | MAC
 3,5 mm-es audiókábel | Sztereo
 2,4 GHz Vezeték nélküli | Nem kompatibilis
 Bluetooth

NO

TILKOBLINGSMULIGHETER | PC | PS4/PS5 | XBOX™ | NINTENDO SWITCH™ | URZĄDZENIA MOBILNE | MAC
 3,5 mm lyd kabel | Stereo
 2,4 GHz trådløs | Ikke kompatibel
 Bluetooth

DA

TILSLUTNINGSMULIGHEDER | PC | PS4/PS5 | XBOX™ | NINTENDO SWITCH™ | MOBILE | MAC
 3,5 mm lyd kabel | Stereo
 2,4 GHz trådløs | Ikke kompatibel
 Bluetooth

ES

CONECTIVIDAD | PC | PS4/PS5 | XBOX™ | NINTENDO SWITCH™ | MOBILE | MAC
 Cable de audio de 3,5 mm | Estéreo
 Inalámbrica de 2,4 GHz | No es compatible
 Bluetooth

IT

CONNETTIVITÀ | PC | PS4/PS5 | XBOX™ | NINTENDO SWITCH™ | MOBILE | MAC
 Cavo Audio da 3,5 mm | Stereo
 Wireless 2.4 GHz | Non compatibile
 Bluetooth

PL

ŁĄCZNOŚĆ | PC | PS4/PS5 | XBOX™ | NINTENDO SWITCH™ | URZĄDZENIA MOBILNE | MAC
 Kabel audio 3,5 mm | Stereo
 Połączenie 2,4 GHz bezprzewodowe | Brak zgodności
 Bluetooth

DE

KONNEKTIVITÄT | PC | PS4/PS5 | XBOX™ | NINTENDO SWITCH™ | MOBILGERÄTE | MAC
 3,5-mm-Audiokabel | Stereo
 2,4-GHz-WLAN | Nicht kompatibel
 Bluetooth

FI

LITETTÄVYYS | PC | PS4/PS5 | XBOX™ | NINTENDO SWITCH™ | MOBILI | MAC
 3,5 mm audiokaapeli | Stereo
 2,4GHz langaton | Ei yhteensopiva
 Bluetooth

NL

AANSLUITINGSMOGEELIJKHEDEN | PC | PS4/PS5 | XBOX™ | NINTENDO SWITCH™ | MOBIEL | MAC
 3,5 mm audiokabel | Stereo
 2,4 GHz draadloos | Niet compatibel
 Bluetooth

PT-BR

CONECTIVIDADE | PC | PS4/PS5 | XBOX™ | NINTENDO SWITCH™ | CELULAR | MAC
 Cabo de áudio de 3,5 mm | Estéreo
 2,4 GHz Sem fio | Não compatível
 Bluetooth

CONNECTIVITY	PC	PS4/PS5	XBOX™	NINTENDO SWITCH™	MOBILE	MAC
3.5 mm Audio Cable	Stereo	Stereo	Stereo	Stereo	Stereo	Stereo
2.4GHz Wireless	JBL QuantumSPHERE 360™	JBL QuantumSPATIAL 360™	JBL QuantumSPATIAL 360™	JBL QuantumSPATIAL 360™	Not Compatible	JBL QuantumSPATIAL 360™
Bluetooth	Stereo	Not Compatible	Not Compatible	Stereo	Stereo	Stereo

SV

ANSLUTNING | PC | PS4/PS5 | XBOX™ | NINTENDO SWITCH™ | MOBIL | MAC
 3,5 mm ljudkabel | Stereo
 2,4 GHz Trådlös | Inkompatibel
 Bluetooth

ZH-CN

连接 | 个人电脑 | PS4/PS5 | XBOX™ | NINTENDO SWITCH™ | 手机 | MAC
 3.5 mm 音频线 | 立体声
 2.4 GHz 无线 | 不兼容
 蓝牙

JP

対応デバイス | PC | PS4/PS5 | XBOX™ | NINTENDO SWITCH™ | スマートホンなどモバイル端末 | MAC
 3.5mmオーディオケーブル | ステレオ
 2.4GHzワイヤレス | 対応していません
 Bluetooth

AR

التوصيل | أجهزة الكمبيوتر | PS4/PS5 | XBOX™ | NINTENDO SWITCH™ | الجوال | ماك
 كبل صوت بمقاس 3.5 مم | ستريو
 لاسلكي 2.4 جيجا هرتز | غير متوافق
 تقنية البلوتوث

TR

BAĞLANTI | BİLGİSAYAR | PS4/PS5 | XBOX™ | NINTENDO SWITCH™ | MOBİL | MAC
 3,5 mm Ses Kablosu | Stereo
 2,4 GHz Kablosuz | Uyumlu Değil
 Bluetooth

ZH-TW

連接 | PC | PS4/PS5 | XBOX™ | NINTENDO SWITCH™ | 手機 | MAC
 3.5 mm 音訊纜線 | 立體聲
 2.4 GHz 無線 | 不相容
 藍牙

KO

연결 | PC | PS4/PS5 | XBOX™ | NINTENDO SWITCH™ | 모바일 | MAC
 3.5mm 오디오 케이블 | 스테레오
 2.4GHz 무선 | 호환되지 않음
 Bluetooth

HE

קישוריות | PS4/PS5 | XBOX™ | NINTENDO SWITCH™ | נייד | MAC
 כבל שמע 3.5 מ"מ | סטראו
 אלחוטי 2.4GHz | לא תואם
 Bluetooth

RU

ПОДКЛЮЧЕНИЯ | ПК | PS4/PS5 | XBOX™ | NINTENDO SWITCH™ | МОБИЛЬНЫЕ | MAC
 Аудиокабель 3,5 мм | Стерео
 Беспроводное 2,4 ГГц | Несовместимо
 Bluetooth

ID

KONEKTIVITAS | PC | PS4/PS5 | XBOX™ | NINTENDO SWITCH™ | MOBILE | MAC
 Kabel Audio 3,5 mm | Stereo
 Nirkabel 2,4 GHz | Tidak Kompatibel
 Bluetooth

MM

ဆက်သွယ်မှု | PC | PS4/PS5 | XBOX™ | Nintendo Switch™ | ချိတ်ဆွဲခံနိုင် | MAC
 ၃.၅ မီလီမီတာ အသံကြိုး | စတီရီယို
 2.4GHz ကြိုးမဲ့ | တွဲဖက်အသုံးမပြုနိုင်
 Bluetooth

IC RF Exposure Information and Statement

The SAR limit of Canada (C) is 1.6 W/kg averaged over one gram of tissue. Device types: (IC: 6132A-JBLQ910WL) has also been tested against this SAR limit. According to this standard, the highest SAR value reported during product certification for head use is 0.14 W/Kg.

The device was tested for typical head operations where the product was kept 0 mm from the head. To maintain compliance with IC RF exposure requirements, use accessories that maintain a separation distance of 0mm between the user's head and the back of the headset. The use of belt clips, holsters and similar accessories shall not contain metal parts in its assembly. Use of accessories that do not meet these requirements may not comply with IC RF exposure requirements and should be avoided.

IC RF Exposure Information and Statement for USB Wireless Dongle

The SAR limit of Canada (C) is 1.6 W/kg averaged over one gram of tissue. Device types: (IC: 6132A-JBLQ910XWTM) has also been tested against this SAR limit. According to this standard, the highest SAR value reported during product certification for body use is 0.39 W/Kg.

Head operation

The device was subjected to a typical head manipulation test. In order to comply with RF exposure requirements, a minimum separation distance of 0 cm must be maintained between the user's ear and the product (including the antenna). Head exposure that do not meet these requirements may not meet RF exposure requirements and should be avoided. Use only the supplied or approved antenna.

IC: 6132A-JBLQ910WL

Body operation

The device was tested for typical bodily operations where the product was kept with 5 mm distance attaching away from the body. Non-compliance with the above restrictions may result in violation of IC RF exposure guidelines. Use only the supplied or approved antenna.

IC: 6132A-JBLQ910XWTM

Informations et énoncés sur l'exposition RF de l'IC.

La limite DAS du Canada (C) est de 1,6 W/kg, arrondie sur un gramme de tissu. Types d'appareils: (IC: 6132A-JBLQ910WL) a également été testé en relation avec cette limite DAS selon ce standard. La valeur DAS la plus élevée mesurée pendant la certification du produit pour une utilisation au niveau de la tête est de 0,14 W/Kg.

L'appareil a été testé dans des cas d'utilisation typiques en relation avec le corps, où le produit a été utilisé à 0 mm de la tête. Pour continuer à respecter les standards d'exposition RF de l'IC, utilisez des accessoires qui maintiennent une distance de séparation de 0 mm entre la tête de l'utilisateur et l'arrière du casque. L'utilisation de clips de ceinture, d'étui ou d'accessoires similaires ne doivent pas contenir de pièces métalliques. Les accessoires ne respectant pas ces exigences peuvent ne pas respecter les standards d'exposition RF de l'IC et doivent être évités.

Informations et déclaration d'exposition aux RF d'IC pour le dongle sans fil USB

La limite DAS du Canada (C) est de 1,6 W/kg en moyenne sur un gramme de tissu. Types d'appareils: (IC: 6132A-JBLQ910XWTM) a également été testé par rapport à cette limite SAR. Selon cette norme, la valeur SAR la plus élevée signalée lors de la certification du produit pour l'utilisation de la tête est de 0,39 W/Kg.

Utilisation au niveau de la tête

L'appareil est testé dans un cas d'utilisation typique autour de la tête. Pour respecter les standards d'exposition RF, une distance de séparation minimum de 0 cm doit être maintenue entre l'oreille et le produit (antenne comprise). L'exposition de la tête ne respectant pas ces exigences peut ne pas respecter les standards d'exposition RF et doit être évité. Utilisez uniquement l'antenne incluse ou une antenne certifiée.

IC: 6132A-JBLQ910WL

Opération du corps

L'appareil a été testé pour des opérations corporelles typiques où le produit était maintenu à une distance de 5 mm du corps. Le non-respect des restrictions ci-dessus peut entraîner une violation des directives d'exposition aux RF d'IC. Utilisez uniquement l'antenne fournie ou approuvée.

IC: 6132A-JBLQ910XWTM

해당 무선설비는 전파혼신 가능성이 있으므로 인명 안전과 관련된 서비스는 할 수 없음.



DO NOT ATTEMPT TO OPEN, SERVICE, OR DISASSEMBLE THE BATTERY | DO NOT SHORT CIRCUIT | MAY EXPLODE IF DISPOSED OF IN FIRE | RISK OF EXPLOSION IF BATTERY IS REPLACED BY AN INCORRECT TYPE | DISPOSE OR RECYCLE USED BATTERIES ACCORDING TO THE INSTRUCTIONS



The Bluetooth® word mark and logos are registered trademarks owned by Bluetooth SIG, Inc. and any use of such marks by HARMAN International Industries, Incorporated is under license. Other trademarks and trade names are those of their respective owners.



Este equipamento não tem direito à proteção contra interferência prejudicial e não pode causar interferência em sistemas devidamente autorizados.

Este produto está homologado pela ANATEL, de acordo com os procedimentos regulamentados pela Resolução 242/2000, e atende aos requisitos técnicos aplicados.

Para maiores informações, consulte o site da ANATEL – www.anatel.gov.br

Atenção: conforme lei brasileira nº 11.291, a exposição prolongada a ruídos superiores a 85dB pode causar danos ao sistema auditivo.

Пользовательские наушники

Изготовитель: Харман Интернешнл Индастриз Инкорпорейтед, США, 06901 Коннектикут, г.Стэмфорд, Атлантик Стрит 400, офис 1500

Сделано в Китае

Импортер: ООО "ХАРМАН РУС СиАйЭс", Россия, 127018, г.Москва, ул. Двинцев, д.12, к. 1

Гарантийный период: 1 год

Срок службы: 2 года

Информация о сервисных центрах: www.harman.com/ru

Техническая поддержка: 8 (800) 700 0467

Организация, уполномоченная на принятие претензий потребителей: ООО "ХАРМАН РУС СиАйЭс"

Товар сертифицирован

Дата изготовления устройства определяется по двум буквенным обозначениям из второй группы символов серийного номера изделия, следующих после разделительного знака «-». Кодировка соответствует порядку букв латинского алфавита, начиная с января 2010 года: 000000-МУ0000000, где «М» - месяц производства (А - январь, В - февраль, С - март и т.д.) и «У» - год производства (А - 2010, В - 2011, С - 2012 и т.д.).



HEADPHONE:
FCC ID: APJBLQ910WL
IC: 6132A-JBLQ910WL
HVIN: Q910XW

DONGLE:
FCC ID: APJBLQ910XWTM
IC: 6132A-JBLQ910XWTM
HVIN: Q910XWTM



Points de collecte sur www.quefairedemesdechets.fr

Product specifications and app screens are subject to change without notice.

HP_JBL_QUANTUM 910X_QSG_GLOBAL_SOP_V9