



JBL GO Essential

CMF + Artworks V05 - 15/JULY/2021

Artwork update history

26-FEB-2019 - Jongron Lo - V01 - New design
23-MAR-2021-Mina Chen - V02 - SKUs refinement
10-MAY-2021-Mina Chen - V03 - Compliance adjustment
08-JUN-2021-Mina Chen - V04 - Compliance adjustment
15-JULY-2021-Mina Chen - V05 - Compliance adjustment



JBL GO Essential / CMF OVERVIEW

Artworks - Unit: mm - 08-JUN-2021



Color range:

Global SKUs



JBL GO Essential / OVERVIEW

Artworks - Unit: mm - 15-JULY-2021

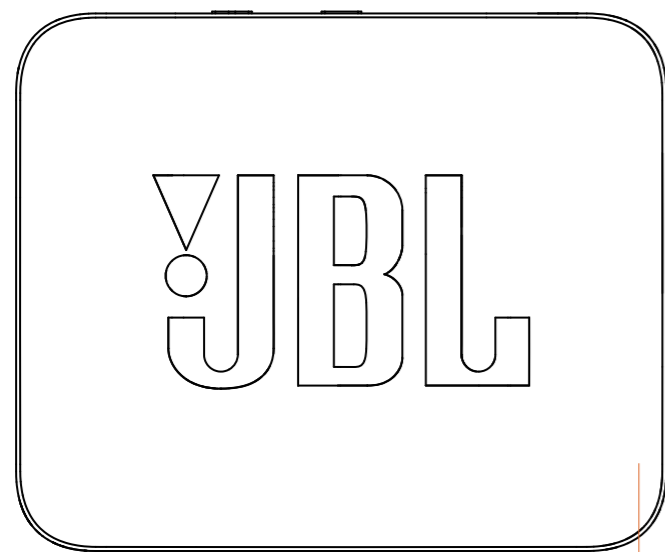

Housing

Plate:

Material: Plastic

Finishes: matte soft touch metallic rubber paint with porect coating

Color:

#1 - ESSENTIAL RED: PANTONE 709C

#2 - ESSENTIAL BLUE: PANTONE 646C

#3 - GUNMETAL: PANTONE 432C

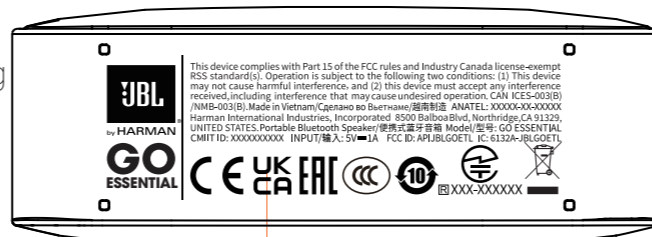
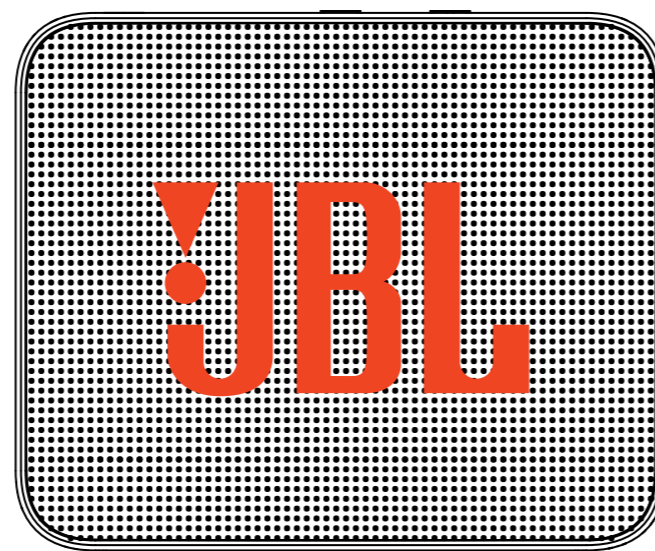
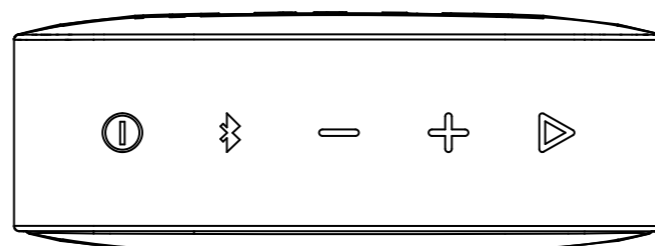

Product Information

Transparent

UV silkscreen printing

Color:

#1 - ESSENTIAL RED:PANTONE 710C

#2 - ESSENTIAL BLUE: PANTONE 647C

Connectors icon

In-mold
0.2mm debossed pattern

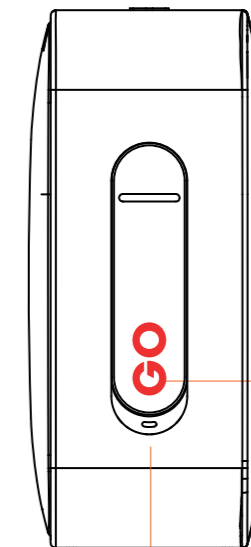
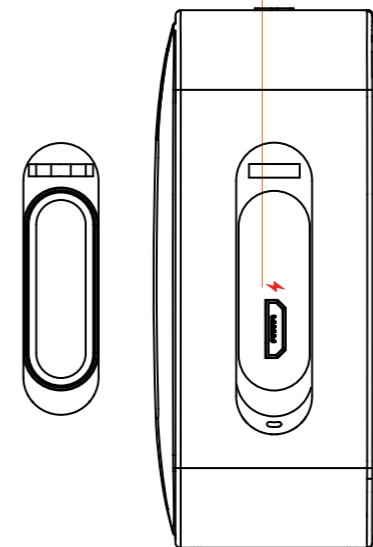

Connectors' cap logo

In-mold
Refer 3D document

Housing

Plate:

Material: Plastic

Finishes: matte soft touch metallic rubber paint with porect coating

Color:

#1 - ESSENTIAL RED: PANTONE 709C

#2 - ESSENTIAL BLUE: PANTONE 646C

#3 - GUNMETAL: PANTONE 432C



JBL GO Essential / OVERVIEW

Artworks - Unit: mm - 08-JUN-2021

Front grill

Plate:

Material: Plastic

Finishes: matte soft touch metallic rubber paint with porect coating

Color:

#1 - ESSENTIAL RED: PANTONE 709C

#2 - ESSENTIAL BLUE: PANTONE 646C

#3 - GUNMETAL: PANTONE 432C

JBL logo

Plate:

Material: Silicon

Finishes: matte

Color:

#1 - ESSENTIAL RED:

OPTION 1: PANTONE 705C

OPTION 2: PANTONE 699C

#2 - ESSENTIAL BLUE:

OPTION 1: PANTONE 656C

OPTION 2: PANTONE 2120C

#3 - GUN METAL: PANTONE 427C

