

QUICK START GUIDE

FREE WFH WIRELESS



WHAT'S IN THE BOX



OVERVIEW

- 01 VOLUME CONTROL
- 02 MICROPHONE MUTE / UNMUTE
- 03 CHARGING LED
- 04 USB-C PORT
- 05 2.5MM JACK FOR BOOM MICROPHONE
- 06 FLAT-FOLD EAR CUP
- 07 POWER / 2.4G LED
- 08 POWER ON / OFF SLIDER
- 09 2.4G PAIRING BUTTON
- 10 2.4G LED

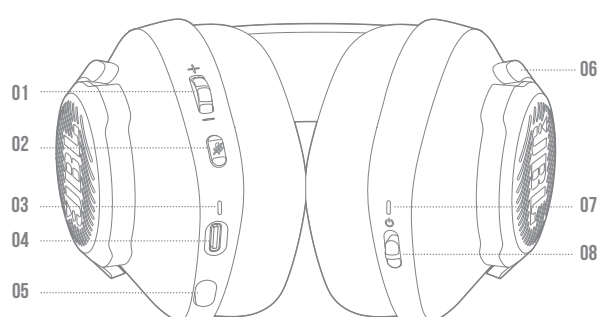

POWER ON & CONNECT

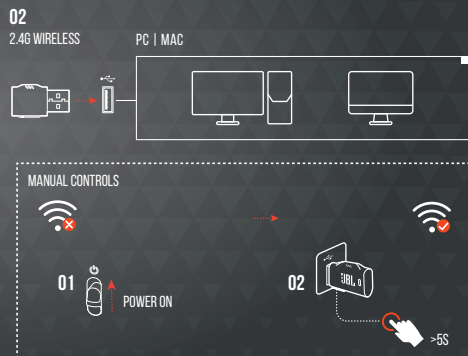

BUTTON COMMAND

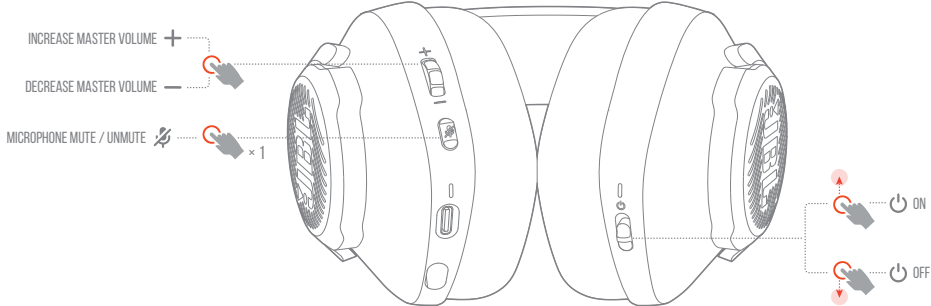

MICROPHONE



CHARGING

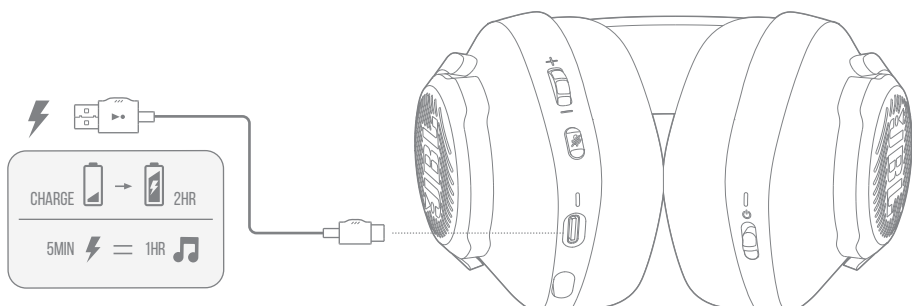

LED BEHAVIOURS



TECH SPEC

Driver size:	40 mm Dynamic Drivers
Frequency response:	20 Hz - 20 kHz
Microphone frequency response:	100 Hz - 10 kHz
Sensitivity:	115 dB SPL @1 kHz
Maximum SPL:	93 dB
Microphone sensitivity:	-42 dBV/Pa @1 kHz
Impedance:	32 ohm
2.4G Wireless transmitter power:	<10 dBm/MHz & <20 dBm
2.4G Wireless modulation:	GFSK
2.4G Wireless carrier frequency:	2402 MHz - 2480 MHz
Battery type:	Li-ion battery (3.7 V / 500 mAh)
Power supply:	5V ~ 1A
Charging time:	2 hrs
Music play time:	16 hrs
Microphone pickup pattern:	Omnidirectional
Weight:	252 g

