

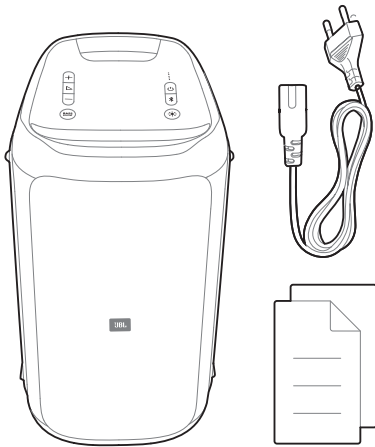

PARTYBOX 100

Quick Start Guide

1 What's in the box



2 Overview

2.1 Top Panel

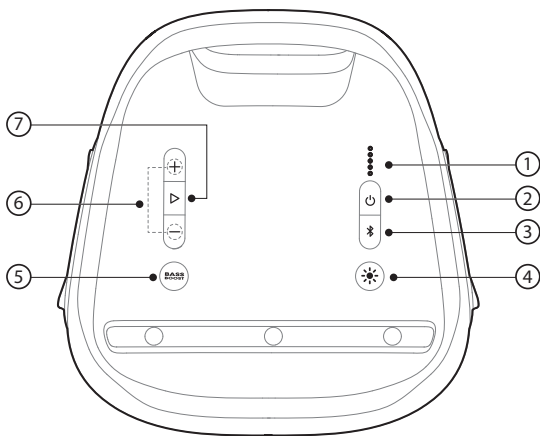

- 1) ●●●●●
 - Battery level indicator.
- 2) ⏻
 - Press to power on or off.
- 3) 📶
 - Press to enter Bluetooth pairing mode.
 - Press and hold for 20 seconds to forget all paired devices.

- 4) ☀️
 - Press to toggle between different light patterns.
 - Press and hold for 2 seconds to turn the light on or off.
- 5) **BASS BOOST**
 - Press repeatedly to switch between bass boost level 1 and level 2 or turn off.
- 6) +/-
 - Press to increase or decrease the volume level.
- 7) ▶️
 - Press to play or pause the music.

2.2 Back Panel

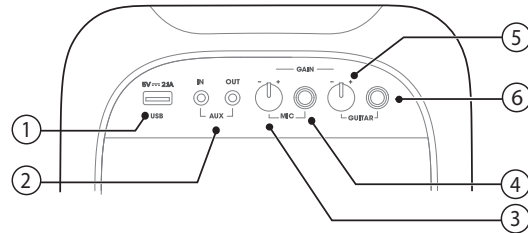

- 1) **USB**
 - Charge an external USB device.
 - Connect to a USB storage device
- 2) **AUX**
 - Connect to an external audio device through an audio cable.
- 3) **MIC**
 - Connect to a microphone (not provided).
- 4) **GUITAR**
 - Connect to a guitar (not provided).
- 5) **VOLUME (MIC)**
 - Rotate the knob to adjust the **MIC** volume.
- 6) **VOLUME (GUITAR)**
 - Rotate the knob to adjust the **GUITAR** volume.

3 Placement

Place your product vertically on a stable, flat surface near a live AC (mains) outlet.

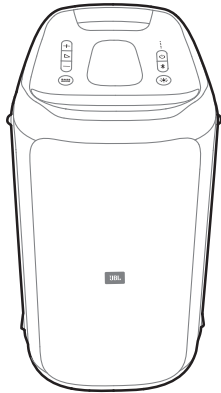

5 Power on

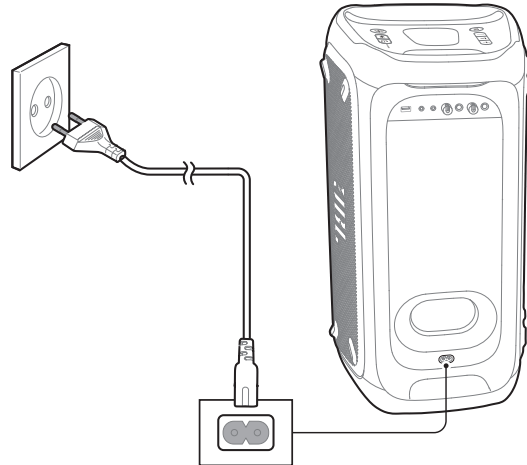

4 Carrying

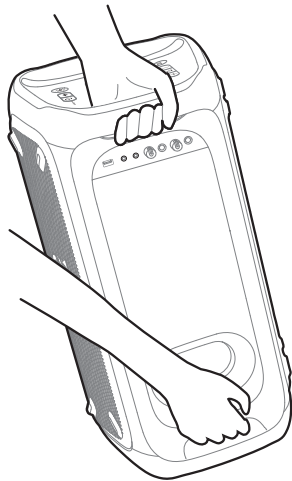

6 Charging USB Devices

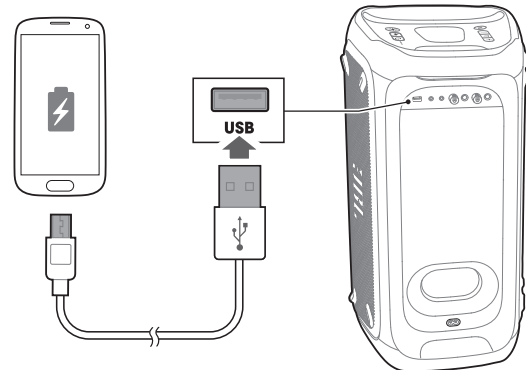

7 Connections

a. Bluetooth

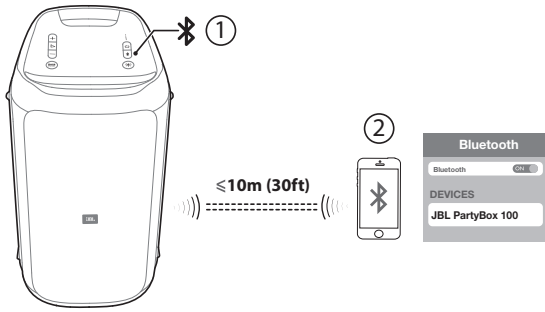

b. USB

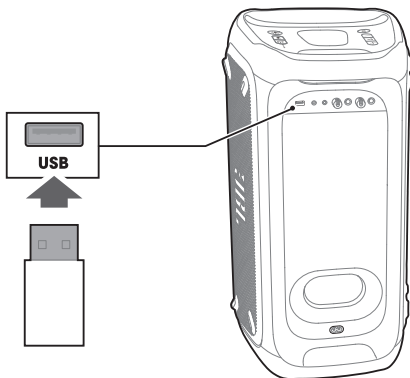

c. AUX

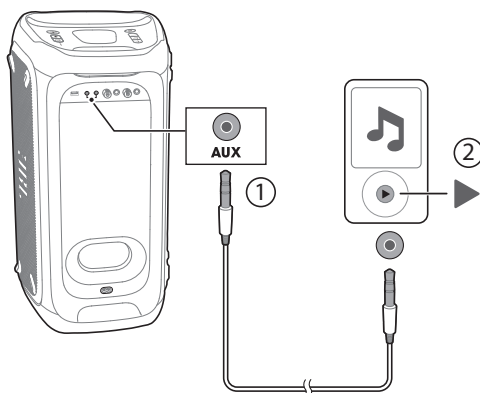

8 Mixing Sound with Microphone/Guitar (not provided)

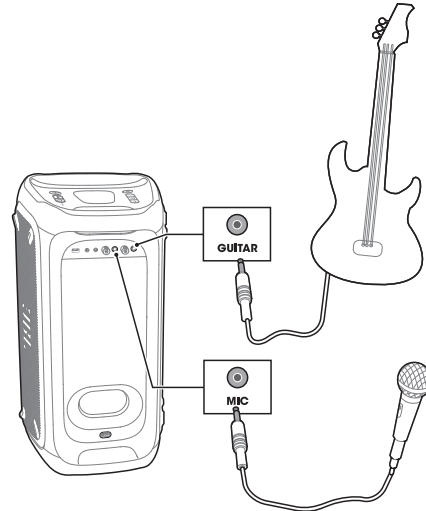

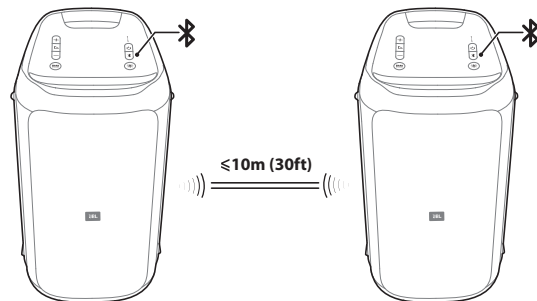

9 TWS (True Wireless Stereo) Mode

Press and hold  on both speakers for 5 seconds, TWS connection will be built up.



10 LED Behavior

	<input type="radio"/> White (Constant)	Power on
	<input checked="" type="radio"/> Amber (Constant)	Standby
	<input checked="" type="radio"/> Off	Power off
	<input checked="" type="radio"/> White (Regular flash)	Pairing
	<input type="radio"/> White (Constant)	Connected
	<input checked="" type="radio"/> Off	Not connected
BASS BOOST	<input type="radio"/> White (Constant)	On
	<input checked="" type="radio"/> Off	Off
	<input checked="" type="radio"/> Red (Regular flash)	Low battery
	<input checked="" type="radio"/> White (Regular flash)	Charging
	<input type="radio"/> White (Constant)	Charged

11 Specifications

- Product name: PartyBox 100
- AC power input: 100-240V ~ 50/60Hz
- Built-in battery: Li-ion 2500mAh, 14.4V"
- Power consumption: 60W
- Standby power consumption: <2W with BT connecting; <0.5W without BT connecting
- USB output: 5 V = 2.1 A Max
- Speaker drivers: 2x 5.25" woofer + 2x 2.25" tweeter
- Speaker impedance: 4 ohm
- Total output power: 160 W
- Signal-to-noise (S/N) ratio: 80 dBA
- Frequency response: 45 Hz - 18 KHz (+/-1dB)
- Bluetooth version: 4.2
- Bluetooth profile: A2DP V1.3, AVRCP V1.5
- Bluetooth transmitter frequency range: 2402-2480 MHz
- Bluetooth maximum transmitter power: 15 dBm (EIRP)
- Bluetooth transmitter modulation: GFSK, $\pi/4$ DQPSK, 8 DPSK
- Bluetooth range: Approx. 10 m (33 feet)
- USB format: FAT 16, FAT 32
- USB file format: .mp3, .wma, .wav
- Input sensitivity: AUX in: 370 mV rms (3.5mm connector)
- Digital input: Bluetooth/USB -9 dBFS.
- Dimension(W x H xD): 288 mm x 551 mm x 290 mm
- Net weight: 9.7kg
- Operation Temperature: 45°C Max



Note: The product is in compliance with the European Union energy legislation.

1) Bluetooth connection mode

The product is intended to be used for streaming music via Bluetooth connection. A consumer can stream Bluetooth audio to the speaker. When the product is connected through Bluetooth, the Bluetooth connection must remain active at all times to ensure proper operation.

The product will enter into sleep mode (networked standby), after 20 minutes without operation, the power consumption @ sleep is less than 2.0 Watts, after which it can be re-activated via Bluetooth connection.

2) Bluetooth disconnection mode

The product will enter into standby mode, after 20 minutes without operation, the power consumption @ standby is less than 0.5 Watts.

Торговая марка	:	JBL
Назначение товара	:	Активная акустическая система
Изготовитель	:	Харман Интернешнл Индастриз Инкорпорейтед, США, 06901 Коннектикут, г.Стэмфорд, Атлантик Стрит 400, офис 1500
Страна происхождения	:	Китай
Импортер в Россию	:	ООО "ХАРМАН РУС СиАйЭс", Россия, 127018, г.Москва, ул. Двинцев, д.12, к 1
Гарантийный период	:	1 год
Информация о сервисных центрах	:	www.harman.com/ru тел. +7-800-700-0467
Срок службы	:	5 лет

Товар сертифицирован



Дата производства

Дата изготовления устройства определяется по двум буквенным обозначениям из второй группы символов серийного номера изделия, следующих после разделительного знака «-». Кодировка соответствует порядку букв латинского алфавита, начиная с января 2010 года: 000000-MY0000000, где «M» - месяц производства (A - январь, B - февраль, C - март и т.д.) и «Y» - год производства (A - 2010, B - 2011, C - 2012 и т.д.).

Используйте устройство только по прямому назначению в соответствии с предоставленной инструкцией. Не пытайтесь самостоятельно вскрывать корпус товара и осуществлять ремонт. В случае обнаружения недостатков или дефектов, обращайтесь за гарантийным обслуживанием в соответствии с информацией из гарантийного талона. Особые условия хранения, реализации и (или) транспортировки не предусмотрены. Избегайте воздействия экстремальных температур, длительного воздействия влаги, сильных магнитных полей. Устройство предназначено для работы в жилых зонах. Срок годности не ограничен при соблюдении условий хранения.



Este equipamento não tem direito à proteção contra interferência prejudicial e não pode causar interferência em sistemas devidamente autorizados.

Este produto está homologado pela ANATEL, de acordo com os procedimentos regulamentados pela Resolução 242/2000, e atende aos requisitos técnicos aplicados.

Para maiores informações, consulte o site da ANATEL – www.anatel.gov.br



The Bluetooth® word mark and logos are registered trademarks owned by the Bluetooth SIG, Inc. and any use of such marks by HARMAN International Industries, Incorporated is under license. Other trademarks and trade names are those of their respective owners.

