



QUICK START GUIDE

BAR 5.1 SURROUND







EN Before using this product, read the safety sheet carefully.

KO 제품을 사용하기 전에 안전 관련 주의사항을 자세히 읽으십시오.

ZH-TW 在使用本產品前，請仔細閱讀安全說明書。

ID Sebelum menggunakan produk ini, bacalah lembar panduan keselamatan dengan cermat.



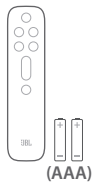
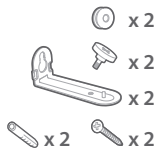
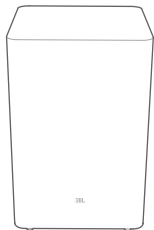

EN * Power cord quantity and plug type vary by regions.

KO * 전원 코드 수량 및 플러그 유형은 지역별로 다릅니다.

ZH-TW * 電源線數量和插頭類型因區域而異。

ID * Jumlah kabel daya dan jenis steker berbeda-beda tergantung wilayah.

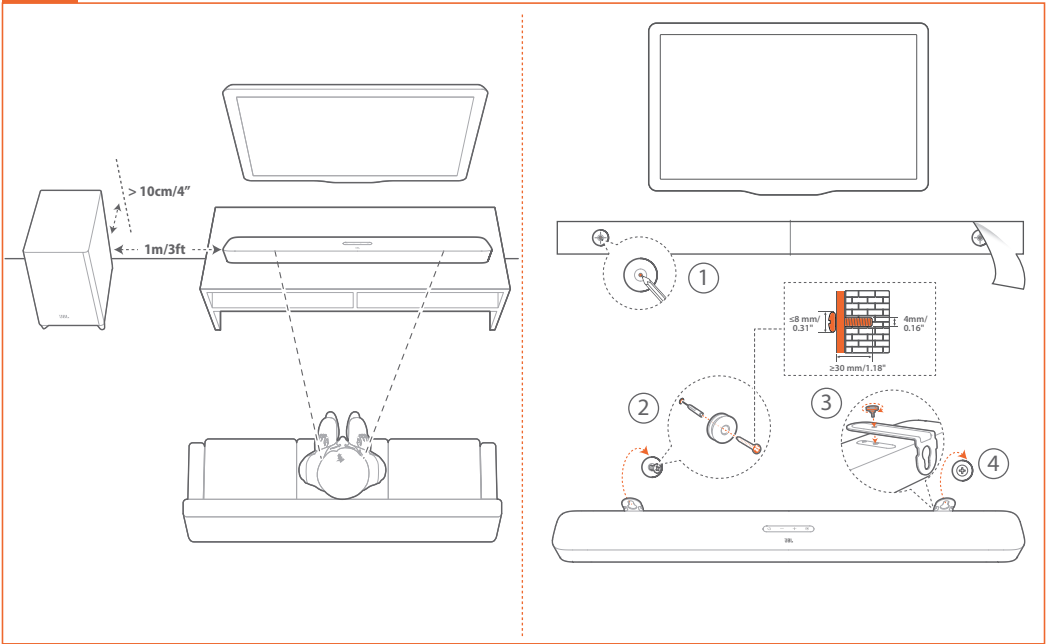

> 10cm/4"

1m/3ft

1

2

3

4

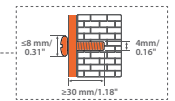



HDMI OUT (TV ARC)

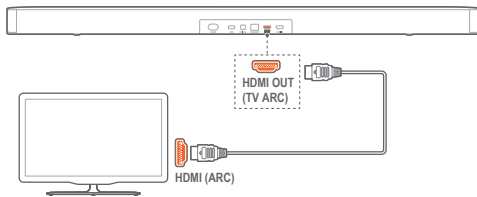

OPTICAL

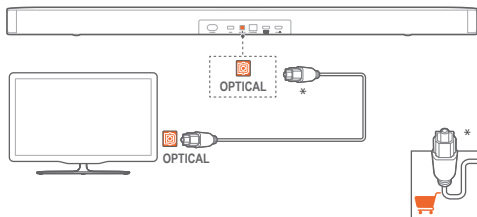

HDMI IN

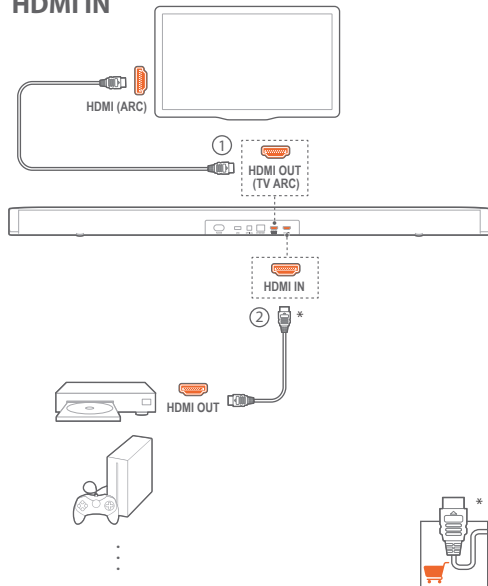

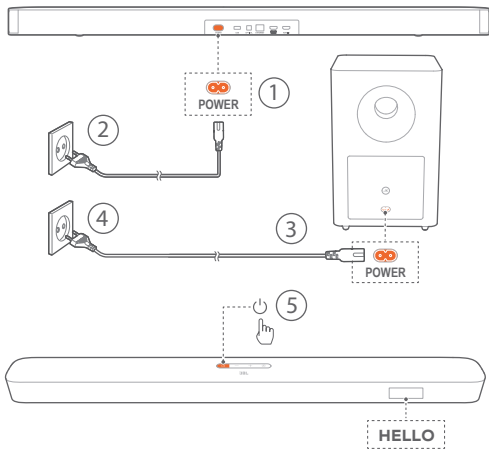

EN The subwoofer and the soundbar will be paired automatically when both are powered on.

KO 서브우퍼와 사운드바는 둘 다 전원이 켜져 있는 경우 자동 페어링됩니다.

ZH-TW 重低音喇叭和條形音箱在通電時會自動配對。

ID Subwoofer dan Soundbar akan berpasangan secara otomatis saat keduanya dihidupkan.

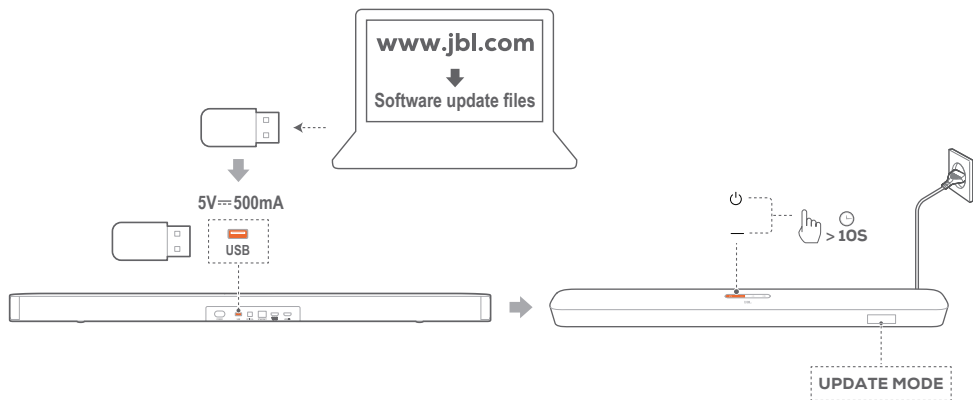

EN For software upgrade, USB playback is available in the US version only (Hard Disk Drive not supported).

KO 소프트웨어 업그레이드용, USB 재생은 미국 버전으로만 이용 가능합니다 (하드 디스크 드라이브 지원되지 않음).

ZH-TW 對於軟體升級, 僅美國版本提供 USB 播放 (不支援硬碟)。

ID Untuk pemutakhiran perangkat lunak, Pemutaran USB hanya tersedia di versi AS (Hard Disk Drive tidak didukung)

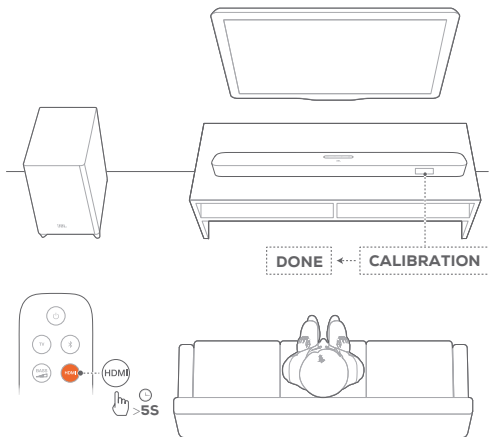

EN Automatic MultiBeam Calibration

With Automatic MultiBeam™ Calibration (AMC), your surround sound experience can be optimized for your favorite seating position.

KO Automatic MultiBeam Calibration

Automatic MultiBeam™ Calibration (AMC)으로 선호하는 좌석 위치에 최적화된 서라운드 사운드를 경험할 수 있습니다.

ZH-TW 自動多波束校準

利用自動多波束校準 (AMC), 可針對您喜愛的座椅位置最佳化您的環繞聲體驗。

ID Automatic MultiBeam Calibration

Dengan Automatic MultiBeam™ Calibration (AMC), suara keliling dapat dioptimalkan sesuai posisi duduk yang Anda sukai.

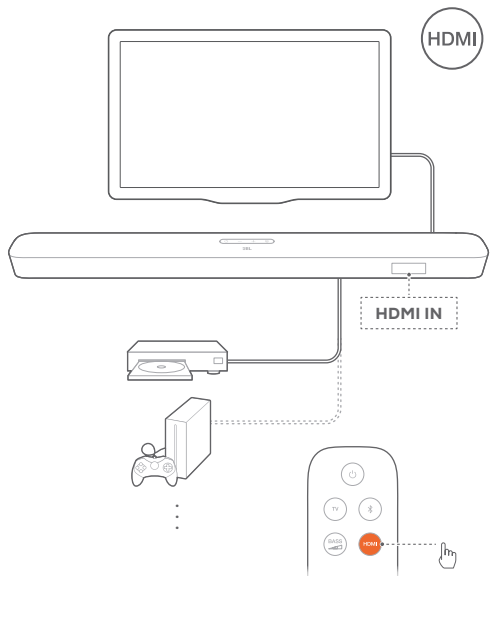
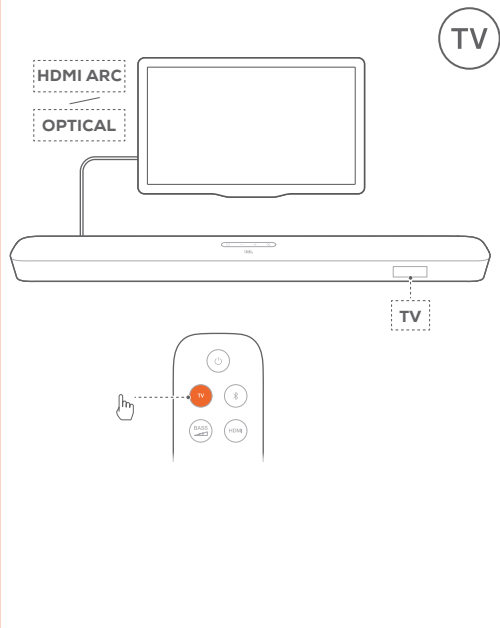



1

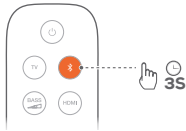

2

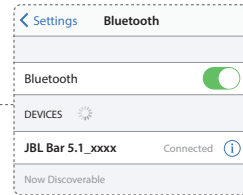

< 10 m / 33 ft



BT PAIRING

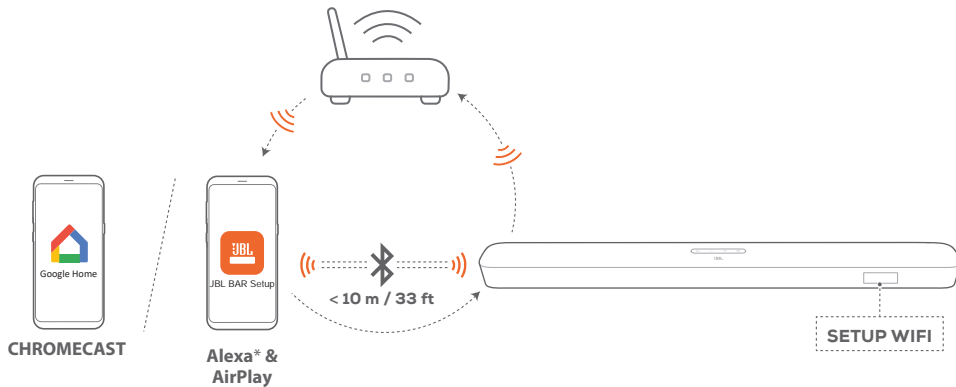

EN * Some features require subscriptions or services not available in all countries.

KO * 일부 기능은 구독이 필요하거나 일부 국가에서 사용 불가능한 서비스가 있습니다.

ZH-TW * 某些功能需要部份國家/地區不提供的訂閱或服務。

ID * Beberapa fitur memerlukan langganan atau layanan yang hanya tersedia di beberapa negara.



CHROMECAST

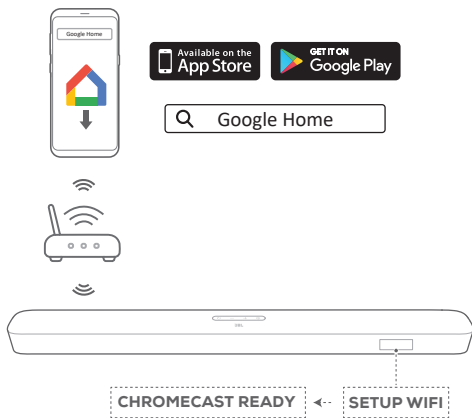

EN On an Android™ or iOS device, add the soundbar to your home Wi-Fi network through the Google Home app. Follow the app instructions to complete setup.

KO Android™ 또는 iOS 장치에서 Google Home 앱을 통해 사운드바를 홈 Wi-Fi 네트워크에 추가합니다. 앱의 지침에 따라 설정을 완료합니다.

ZH-TW 在 Android™ 或 iOS 裝置上，透過 Google Home 應用程式將條形音箱新增至家用 Wi-Fi 網路。遵循應用程式說明完成設定。

ID Pada perangkat Android™ atau iOS, tambahkan soundbar ke jaringan Wi-Fi rumah Anda melalui aplikasi Google Home. Ikuti petunjuk aplikasi untuk menyelesaikan pengaturan.



AirPlay

Available on the
App Store

JBL BAR Setup



SETUP WIFI

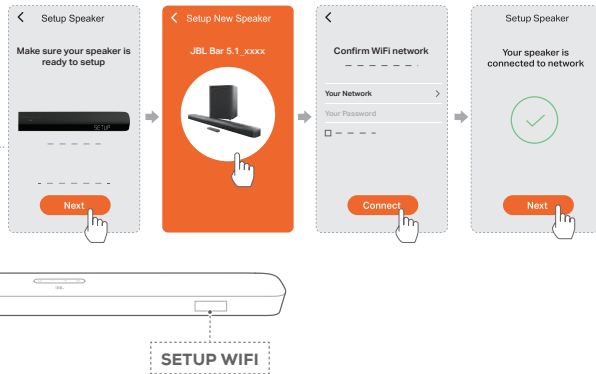

EN On an iOS device, add the soundbar to your home Wi-Fi network through the JBL BAR Setup app. Follow the app instructions to complete setup.

KO iOS 장치에서 JBL BAR Setup 앱을 통해 사운드바를 홈 Wi-Fi 네트워크에 추가합니다. 앱의 지침에 따라 설정을 완료합니다.

ZH-TW 在 iOS 裝置上，透過 JBL BAR Setup 應用程式將條形音箱新增至家用 Wi-Fi 網路。遵循應用程式說明完成設定。

ID Pada perangkat iOS, tambahkan soundbar ke jaringan Wi-Fi rumah Anda melalui aplikasi JBL BAR Setup. Ikuti petunjuk aplikasi untuk menyelesaikan pengaturan.



Alexa MRM: Multi-Room Music

1



JBL BAR Setup

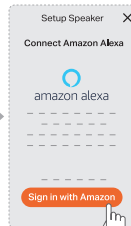
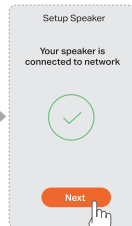
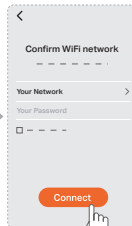



2



EN Alexa MRM: Multi-Room Music

1. On an Android or iOS device, add the soundbar to your home Wi-Fi network through the JBL BAR Setup app. Follow the app instructions to complete setup.
Sign in with your Amazon Alexa account. If you do not have, create a new one.
2. With the Alexa MRM multi-room music playback, you can stream music on your Android or iOS device to multiple Amazon Alexa speakers

KO Alexa MRM: Multi-Room Music (멀티룸 재생)

1. Android 또는 iOS 장치에서 JBL BAR Setup 앱을 통해 사운드바를 홈 Wi-Fi 네트워크에 추가합니다. 앱의 지침에 따라 설정을 완료합니다.
Amazon Alexa 계정으로 로그인합니다. 계정이 없는 경우 새로운 계정을 만드십시오.
2. Alexa MRM 멀티룸 재생 기능을 사용하면 Android 또는 iOS 장치에 있는 음악을 여러 개의 Amazon Alexa 스피커에서 스트리밍할 수 있습니다.

ZH-TW Alexa MRM: Multi-Room Music (多房間播放)

1. 在 Android 或 iOS 裝置上，透過 JBL BAR Setup 應用程式將條形音箱新增至家用 Wi-Fi 網路。遵循應用程式說明完成設定。
使用您的 Amazon Alexa 帳戶登入。若您沒有 Amazon Alexa 帳戶，就註冊一個。
2. 透過 Alexa MRM 多房間播放，您可以將 Android 或 iOS 裝置上的音樂串流傳輸到多個 Amazon Alexa 喇叭。

ID Alexa MRM: Multi-Room Music (Pemutaran Multi-room)

1. Pada perangkat Android atau iOS, tambahkan soundbar ke jaringan Wi-Fi rumah Anda melalui aplikasi JBL BAR Setup. Ikuti petunjuk aplikasi untuk menyelesaikan pengaturan.
Masuk menggunakan akun Amazon Alexa Anda. Buatlah akun jika Anda belum memilikinya.
2. Dengan Alexa MRM pemutaran multi-room, Anda dapat mengalirkan musik yang ada di perangkat Android atau iOS Anda ke beberapa speaker Amazon Alexa.

**EN****General specification:**

- Model: Bar 5.1 CNTR (Soundbar Unit), BAR 5.1 SUB (Subwoofer Unit)
- Power supply: 100 - 240V AC, ~ 50/60Hz
- Total speaker power output (Max. @THD 1%): 550W
- Soundbar output power (Max. @THD 1%): 5 x 50W
- Subwoofer output power (Max. @THD 1%): 300W
- Soundbar transducer: 5 x racetrack drivers + 2 x 1.25" side-firing tweeters
- Subwoofer transducer: 10"
- networked standby power: <2.0W
- Operating temperature: 0°C - 45°C

HDMI specification:

- HDMI Video input: 1
- HDMI Video output (With Audio return channel): 1
- HDMI HDCP version: 2.3

Audio specification:

- Frequency response: 34Hz - 20KHz
- Audio inputs: 1 Optical, Bluetooth, USB (USB playback is available in US version. For other versions, USB is for Service only.)

USB specification:

- USB port: Type A
- USB rating: 5V DC, 0.5A
- Supporting file format: mp3
- MP3 Codec: MPEG 1 Layer 2/3, MPEG 2 Layer 3, MPEG 2.5 Layer 3
- MP3 sampling rate: 16KHz - 48 KHz
- MP3 bitrate: 80kbps - 320kbps

Wireless specification:

- Bluetooth version: 4.2
- Bluetooth profile: A2DP V1.2, AVRCP V1.5
- Bluetooth frequency range: 2402MHz - 2480MHz
- Bluetooth Max. transmitting power: <11dBm (EIRP)
- Modulation Type: GFSK, $\pi/4$ DQPSK, 8DPSK
- Wi-Fi network : IEEE 802.11 a/b/g/n/ac (2.4GHz/5GHz)
- 2.4G Wi-Fi frequency range: 2412 - 2472MHz (2.4GHz ISM Band, USA 11 Channels, Europe and others 13 Channels)
- 2.4G Wi-Fi Max. transmitting power: <20dBm
- Modulation Type: DBPSK, DQPSK, CCK, QPSK, BPSK, 16QAM, 64QAM
- 5G Wi-Fi frequency range: 5.15 - 5.35GHz, 5.470-5.725GHz, 5.725 - 5.825GHz
- 5G Wi-Fi Max. transmitting power: <22dBm
- Modulation Type: QPSK, BPSK, 16QAM, 64QAM, 256QAM
- 5G Wireless frequency range: 5743MHz - 5832MHz
- 5G Max. transmitting power: <10dBm
- Modulation Type: FSK

Dimensions:

- Dimensions (W x H x D): 1018 x 58 x 100mm / 40.1" x 2.3" x 3.9" (Soundbar); 305 x 440 x 305mm / 12.0" x 17.3" x 12.0" (Subwoofer)
- Weight: 3.06Kg (Soundbar); 10.62Kg (Subwoofer)
- Packaging dimensions (W x H x D): 1105 x 382 x 488 mm / 43.5" x 15.0" x 19.2"
- Packaging weight (Gross weight): 16.8 Kg



KO

일반 사양:

- 모델: Bar 5.1 CNTR(사운드바 장치), BAR 5.1 SUB(서브우퍼 장치)
- 전원 공급 장치: 100~240V AC, 약 50/60Hz
- 총 스피커 전원 출력(최대치 @THD 1%): 550W
- 사운드바 전원 출력(최대치 @THD 1%): 5 x 50W
- 서브우퍼 전원 출력(최대치 @THD 1%): 300W
- 사운드바 변환기: 5 x 레이스트랙 드라이버 +2 x 1.25" 측면 방사 트위터
- 서브우퍼 변환기: 10"
- 대기 전력: <0.5W
- 네트워크 상태의 대기 전력: <2.0W
- 작동 온도: 0°C~45°C

HDMI 사양:

- HDMI 비디오 입력: 1
- HDMI 비디오 출력(Audio Return Channel 지원): 1
- HDMI HDCP 버전: 2.3

오디오 사양:

- 주파수 응답: 34Hz~20KHz
- 오디오 입력: 1 광케이블, Bluetooth, USB(USB 재생은 미국 버전으로만 이용 가능하며 다른 버전 사용 시 USB는 정비 전용)

USB 사양:

- USB 포트: A형
- USB規格: 5V DC, 0.5A
- 지원 파일 형식: mp3
- MP3 코덱: MPEG 1 Layer 2/3, MPEG 2 Layer 3, MPEG 2.5 Layer 3
- MP3 샘플링 속도: 16KHz~48KHz
- MP3 비트 전송률: 80kbps~320kbps

무선 사양:

- Bluetooth 버전: 4.2
- Bluetooth 프로파일: A2DP V1.2, AVRCP V1.5
- Bluetooth 주파수 범위: 2,402MHz~2,480MHz
- Bluetooth 최대 송신 출력: <11dBm(EIRP)
- 변조 형식: GFSK, $\pi/4$ DQPSK, 8DPSK
- Wi-Fi 네트워크: IEEE 802.11 a/b/g/n/ac(2.4GHz/5GHz)
- 2.4G Wi-Fi 주파수 범위: 2,412~2,472MHz(2.4GHz ISM 밴드, 미국 11개 채널, 유럽 및 기타 지역 13개 채널)
- 2.4G Wi-Fi 최대 송신 출력: <20dBm
- 변조 형식: DBPSK, DQPSK, CCK, QPSK, BPSK, 16QAM, 64QAM
- 5G Wi-Fi 주파수 범위: 5.15 - 5.35GHz, 5.470-5.725GHz, 5.725 - 5.825GHz
- 5G Wi-Fi 최대 송신 출력: <22dBm
- 변조 형식: QPSK, BPSK, 16QAM, 64QAM, 256QAM
- 5G 무선 주파수 범위: 5,743 MHz - 5,832 MHz
- 5G 최대 송신 출력: <10dBm
- 변조 형식: FSK

치수:

- 치수(너비 x 높이 x 깊이): 1,018 x 58 x 100mm / 40.1"x 2.3"x 3.9"(사운드바), 305 x 440 x 305mm / 12.0"x 17.3"x 12.0"(서브우퍼)
- 중량: 3.06kg(사운드바); 10.62kg(서브우퍼)
- 포장 치수(W x H x D): 1105 x 382 x 488mm / 43.5"x 15.0"x 19.2"
- 포장 중량(총 중량): 16.8kg

ZH-TW

一般規格：

- 型號：Bar 5.1 CNTR (條型音箱單元)、BAR 5.1 SUB (重低音喇叭單元)
- 電源：100 - 240V AC，~ 50/60Hz
- 總喇叭輸出功率 (Max. @THD 1%)：550W
- 條形音箱輸出功率 (Max. @THD 1%)：5 x 50W
- 重低音喇叭輸出功率 (Max. @THD 1%)：300W
- 條型音箱轉換器：5 x 賽道驅動器 + 2 x 1.25"側推式高音喇叭
- 重低音喇叭轉換器：10"
- 網路待命功率：<2.0W
- 工作溫度：0°C - 45°C

HDMI 規格：

- HDMI 視訊輸入：1
- HDMI 視訊輸出 (帶音訊回傳通道)：1
- HDMI HDCP 版本：2.3

音訊規格：

- 頻率回應：34Hz - 20KHz
- 音訊輸入：1 光纖、藍牙、USB (美國版本提供 USB 播放。對於其他版本，USB 僅適用於服務。)

USB 規格：

- USB 連接埠：A 型
- USB 額定值：5V DC，0.5A
- 支援檔案格式：mp3
- MP3 編解碼器：MPEG 1 Layer 2/3、MPEG 2 Layer 3、MPEG 2.5 Layer 3
- MP3 取樣率：16KHz - 48 KHz
- MP3 位元速率：80kbps - 320kbps

無線規格：

- 藍牙版本：4.2
- 藍牙設定檔：A2DP V1.2, AVRCP V1.5
- 藍牙頻率範圍：2,402MHz - 2,480MHz
- 藍牙最大發射機功率：<11dBm (EIRP)
- 調變類型：GFSK、 $\pi/4$ DQPSK、8DPSK
- Wi-Fi 網路：IEEE 802.11 a/b/g/n/ac (2.4GHz/5GHz)
- 2.4G Wi-Fi 頻率範圍：2,412 - 2,472MHz (2.4GHz ISM 頻帶、美國 11 個頻道、歐洲和其他 13 個頻道)
- 2.4G Wi-Fi 最大發射機功率：<20dBm
- 調變類型：DBPSK、DQPSK、CCK、QPSK、BPSK、16QAM、64QAM
- 5G Wi-Fi 頻率範圍：5.15 - 5.35GHz, 5.470-5.725GHz, 5.725 - 5.825GHz
- 5G Wi-Fi 最大發射機功率：<22dBm
- 調變類型：QPSK、BPSK、16QAM、64QAM、256QAM
- 5G 無線頻率範圍：5,743MHz - 5,832MHz
- 5G 最大發射機功率：<10dBm
- 調變類型：FSK

尺寸：

- 尺寸 (寬 x 高 x 深)：1018 x 58 x 100mm / 40.1" x 2.3" x 3.9" (條型音箱)；305 x 440 x 305mm / 12.0" x 17.3" x 12.0" (重低音喇叭)
- 重量：3.06kg (條型音箱)；10.62kg (重低音喇叭)
- 包裝尺寸 (寬 x 高 x 深)：1105 x 382 x 488mm / 43.5" x 15.0" x 19.2"
- 包裝重量 (毛重)：16.8kg



ID

Spesifikasi umum:

- Model: Bar 5.1 CNTR (Unit Soundbar), BAR 5.1 SUB (Unit Subwoofer)
- Catu daya: 100–240 V AC, ~50/60 Hz
- Daya output speaker total (Maks. @THD 1%): 550 W
- Daya output Soundbar (Maks. @THD 1%): 5 x 50 W
- Daya output Subwoofer (Maks. @THD 1%): 300 W
- Transduser Soundbar: 5 Racetrack driver + 2 tweeter samping (side-firing) 1,25"
- Transduser Subwoofer: 10"
- daya siaga dalam jaringan: < 2,0 W
- Suhu pengoperasian: 0°–45° C

Spesifikasi HDMI:

- Input Video HDMI: 1
- Output Video HDMI (dengan Audio Return Channel): 1
- Versi HDMI HDCP: 2.3

Spesifikasi audio:

- Respons frekuensi: 34 Hz–20 kHz
- Input audio: 1 Optik, Bluetooth, USB (pemutaran USB tersedia di versi AS. Pada versi lain, USB hanya untuk Layanan.)

Spesifikasi USB:

- Port (USB): Tipe A
- Rating USB: 5 V DC, 0,5 A
- Format file yang didukung: mp3
- Codec MP3: MPEG 1 Layer 2/3, MPEG 2 Layer 3, MPEG 2.5 Layer 3
- Laju sampel MP3: 16–48 kHz
- Bitrate MP3: 80–320 kbps

Spesifikasi nirkabel:

- Versi Bluetooth: 4.2
- Profil Bluetooth: A2DP V1.2, AVRCP V1.5
- Rentang frekuensi Bluetooth: 2402 MHz – 2480 MHz
- Daya pancar maks. Bluetooth: < 11 dBm (EIRP)
- Tipe Modulasi: GFSK, $\pi/4$ DQPSK, 8DPSK
- Jaringan Wi-Fi: IEEE 802.11 a/b/g/n/ac (2,4 GHz/5 GHz)
- Rentang frekuensi Wi-Fi 2,4G: 2412–2472 MHz (Pita ISM 2,4 GHz, AS 11 Saluran, Eropa dan lainnya 13 Saluran)
- Daya pancar Maks. Wi-Fi 2,4G: < 20dBm
- Tipe Modulasi: DBPSK, DQPSK, CCK, QPSK, BPSK, 16QAM, 64QAM
- Rentang frekuensi Wi-Fi 5G: 5,15 - 5,35GHz, 5,725 - 5,825GHz
- Daya pancar Maks Wi-Fi 5G: < 22dBm
- Tipe Modulasi: QPSK, BPSK, 16QAM, 64QAM, 256QAM
- Rentang frekuensi nirkabel 5G: 5743MHz - 5832MHz
- Daya pancar Maks 5G: < 10dBm
- Tipe Modulasi: FSK

Dimensi:

- Dimensi (P x T x L): 1018 x 58 x 100 mm / 40,1"x 2,3"x 3,9"(Soundbar); 305 x 440 x 305 mm / 12,0"x 17,3"x 12,0"(Subwoofer)
- Berat: 3,06 kg (Soundbar); 10,62 kg (Subwoofer)
- Dimensi kemasan (P x T x L): 1105 x 382 x 488 mm / 43,5" x 15,0" x 19,2"
- Berat kemasan (Berat kotor): 16,8 kg

EN

BAR 5.1 SURROUND is in compliance with European Commission Regulation (EC) No 1275/2008 and (EU) No 801/2013.

Power consumption

- Off Mode: N/A
- Network Standby: <2.0 W
- Time to standby: <20 minutes

* Standby: in the condition of all wireless connections of Soundbar are deactivated, if no provide any audio or video signal to the Soundbar unit, the Soundbar unit will automatically into standby mode in 10 minutes.

* Networked standby: in the condition of any wireless connection of Soundbar is activated, if no provide any audio or video signal to the Soundbar unit, the Subwoofer and Soundbar unit will automatically into networked standby mode in 10 minutes.

Any audio or video recover will bring device from standby to operation mode.

KO

BAR 5.1 서라운드 는 유럽연합 집행위원회 규정(EC) No 1275/2008 및 (EU) No 801/2013을 준수합니다.

소비 전력

- OFF(꺼짐) 모드: 해당 사항 없음
- 대기: <0.5W
- 네트워크 대기: <2.0 W
- 대기 전환 시간: <20분

* 대기: 사운드바의 모든 무선 연결이 비활성화된 상태에서 오디오 또는 비디오 신호가 사운드바 장치에 제공되지 않으면 사운드바 장치가 10분 뒤 대기 모드로 자동 전환됩니다.

* 네트워크 대기: 사운드바의 어느 무선 연결이든 활성화된 상태에서 오디오 또는 비디오 신호가 사운드바 장치에 제공되지 않으면 서브우퍼와 사운드바 장치가 10분 뒤 네트워크 대기 모드로 자동 전환됩니다.

오디오 또는 비디오가 복구되면 장치가 대기 모드에서 작동 모드로 전환됩니다.

ZH-TW

BAR 5.1 SURROUND 符合歐盟委員會法規 (EC) No 1275/2008 和 (EU) No 801/2013。

功耗

- 關閉模式: 不適用
- 網路待命: <2.0 W
- 進入待命狀態前所需的時間: <20 分鐘

* 待命: 在條形音箱的所有無線連線均被停用的情況下, 若不向條形音箱單元發出任何音訊或視訊訊號, 條形音箱單元將於 10 分鐘後自動進入待命模式。

* 網路待命: 在條形音箱的任何無線連線被啟用的情況下, 若不向條形音箱單元發出任何音訊或視訊訊號, 重低音喇叭和條形音箱單元將於 10 分鐘後自動進入網路待命模式。

再次發出任何音訊或視訊訊號都會使裝置從待命狀態進入工作模式。

ID

BAR 5.1 SURROUND mematuhi Peraturan Komisi Eropa (EC) No 1275/2008 dan (EU) No 801/2013.

Konsumsi daya

- Mode Off (Nonaktif): Tidak Ada
- Siaga Jaringan: < 2,0 W
- Waktu untuk siaga: < 20 menit

* Siaga: jika unit Soundbar tidak menerima sinyal audio atau video saat semua sambungan nirkabel ke Soundbar dinonaktifkan, unit Soundbar akan berpindah ke mode siaga secara otomatis dalam 10 menit.

* Siaga dalam jaringan: jika unit Soundbar tidak menerima sinyal audio atau video saat satu atau beberapa sambungan nirkabel ke Soundbar diaktifkan, unit Subwoofer dan Soundbar akan berpindah ke mode siaga secara otomatis dalam 10 menit.

Melanjutkan pemutaran audio atau video akan mengalihkan perangkat dari mode siaga ke mode operasional.

This product contains open source software licensed under GPL. For your convenience, the source code and relevant build instruction are also available at <http://www.jbl.com/opensource.html>. Please feel free to contact us at:

Harman Deutschland GmbH

ATT: Open Source, Gregor Krapf-Gunther, Parking 3

85748 Garching bei Munchen, Germany

or OpenSourceSupport@Harman.com if you have additional question regarding the open source software in the product.



The Bluetooth® word mark and logos are registered trademarks owned by Bluetooth SIG, Inc. and any use of such marks by HARMAN International Industries, Incorporated is under license. Other trademarks and trade names are those of their respective owners.



The terms HDMI, HDMI High-Definition Multimedia Interface, and the HDMI Logo are trademarks or registered trademarks of HDMI Licensing Administrator, Inc.



The Wi-Fi CERTIFIED™ Logo is a certification mark of the Wi-Fi Alliance®.



Manufactured under license from Dolby Laboratories. Dolby, Dolby Audio, Dolby Vision, and the double-D symbol are trademarks of Dolby Laboratories.



Google, Google Play, Google Home and Chromecast built-in are trademarks of Google LLC.



Apple, AirPlay, iPad, iPad Air, iPad Pro, and iPhone are trademarks of Apple Inc., registered in the U.S. and other countries.

Use of the Works with Apple badge means that an accessory has been designed to work specifically with the technology identified in the badge and has been certified by the developer to meet Apple performance standards.

To control this AirPlay 2-enabled speaker, iOS 13.4 or later is required.



Amazon, Echo, Alexa, and all related logos are trademarks of Amazon.com, Inc. or its affiliates.





72-HMSB51-OSGE1
SB_JBL_Bar5.1 & SUB_OSG_APAC_MRM_CR_V2