



QUICK START GUIDE

BAR 2.0 ALL-IN-ONE





- EN** Before using this product, read the safety sheet carefully.
- DA** Before using this product, read the safety sheet carefully.
- DE** Before using this product, read the safety sheet carefully.
- ES** Before using this product, read the safety sheet carefully.
- FI** Before using this product, read the safety sheet carefully.
- FR** Before using this product, read the safety sheet carefully.
- IT** Before using this product, read the safety sheet carefully.
- NL** Before using this product, read the safety sheet carefully.
- NO** Before using this product, read the safety sheet carefully.
- PL** Before using this product, read the safety sheet carefully.
- PT** Before using this product, read the safety sheet carefully.
- RU** Before using this product, read the safety sheet carefully.
- SV** Before using this product, read the safety sheet carefully.
- JP** Before using this product, read the safety sheet carefully.
- KO** Before using this product, read the safety sheet carefully.
- CN** Before using this product, read the safety sheet carefully.
- TW** Before using this product, read the safety sheet carefully.
- ID** Before using this product, read the safety sheet carefully.
- AR** Before using this product, read the safety sheet carefully.



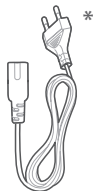

*

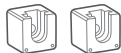

- EN** * Power cord quantity and plug type vary by regions.
- DA** * Power cord quantity and plug type vary by regions.
- DE** * Power cord quantity and plug type vary by regions.
- ES** * Power cord quantity and plug type vary by regions.
- FI** * Power cord quantity and plug type vary by regions.
- FR** * Power cord quantity and plug type vary by regions.
- IT** * Power cord quantity and plug type vary by regions.
- NL** * Power cord quantity and plug type vary by regions.
- NO** * Power cord quantity and plug type vary by regions.
- PL** * Power cord quantity and plug type vary by regions.
- PT** * Power cord quantity and plug type vary by regions.
- RU** * Power cord quantity and plug type vary by regions.
- SV** * Power cord quantity and plug type vary by regions.
- JP** * Power cord quantity and plug type vary by regions.
- KO** * Power cord quantity and plug type vary by regions.
- CN** * Power cord quantity and plug type vary by regions.
- TW** * Power cord quantity and plug type vary by regions.
- ID** * Power cord quantity and plug type vary by regions.
- AR** * Power cord quantity and plug type vary by regions.

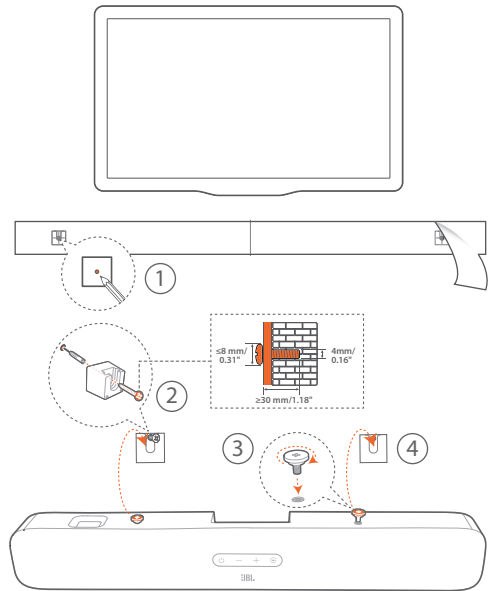
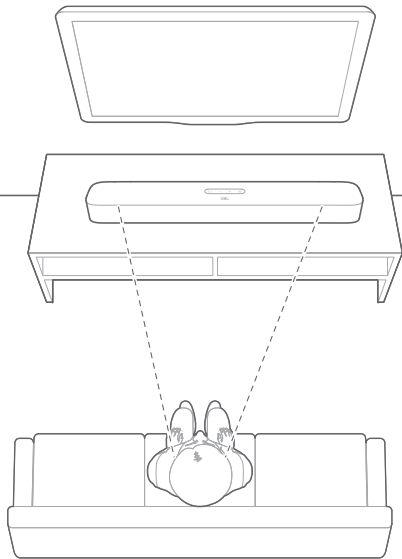



HDMI OUT

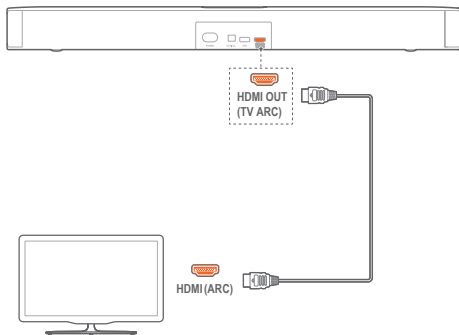

OPTICAL

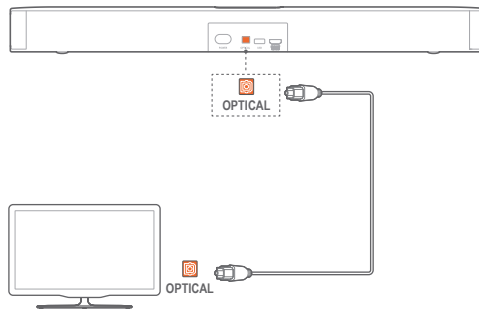



POWER ①



②

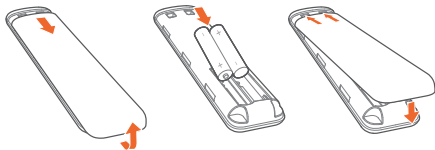

USB

5V $\overline{\text{---}}$ 500mA (For service only)

DA For service only

DE For service only

ES For service only

FI For service only

FR For service only

IT For service only

NL For service only

NO For service only

PL For service only

PT For service only

RU For service only

SV For service only

JP For service only

KO For service only

CN For service only

TW For service only

ID For service only

AR For service only



TV

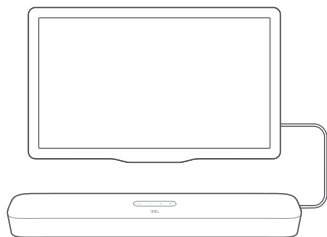

HDMI ARC / OPTICAL

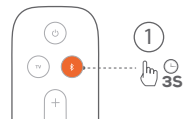
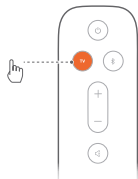

2

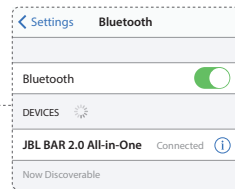

< 10 m / 33 ft



**EN**

- Model: Bar 2.0 CNTR
- Power supply: 100 - 240V, ~ 50/60Hz
- Total maximum power: 80W
- Soundbar maximum power: 2 x 40W
- Transducer: 4 x 2.25" racetrack drivers, 2 x 1.25" tweeter
- Max SPL: 103dB
- USB port rating: 5V \equiv 500mA, (For service only)
- Frequency response: 40Hz - 20KHz
- Operating temperature: 0°C - 45°C
- Bluetooth version: 4.2
- Bluetooth frequency range: 2402MHz-2480MHz
- Max transmitting power: 10dBm
- Bluetooth modulation: GFSK, $\pi/4$ DQPSK, 8DPSK
- Standby power: 0.5W
- Dimensions (W x H x D): 614 x 58 x 90 mm / 24.17" x 2.28" x 3.54"
- Weight: 1.61 kg

DA

- Model: Bar 2.0 CNTR
- Power supply: 100 - 240V, ~ 50/60Hz
- Total maximum power: 80W
- Soundbar maximum power: 2 x 40W
- Transducer: 4 x 2.25" racetrack drivers, 2 x 1.25" tweeter
- Max SPL: 103dB
- USB port rating: 5V \equiv 500mA, (For service only)
- Frequency response: 40Hz - 20KHz
- Operating temperature: 0°C - 45°C
- Bluetooth version: 4.2
- Bluetooth frequency range: 2402MHz-2480MHz
- Max transmitting power: 10dBm
- Bluetooth modulation: GFSK, $\pi/4$ DQPSK, 8DPSK
- Standby power: 0.5W
- Dimensions (W x H x D): 614 x 58 x 90 mm / 24.17" x 2.28" x 3.54"
- Weight: 1.61 kg

DE

- Model: Bar 2.0 CNTR
- Power supply: 100 - 240V, ~ 50/60Hz
- Total maximum power: 80W
- Soundbar maximum power: 2 x 40W
- Transducer: 4 x 2.25" racetrack drivers, 2 x 1.25" tweeter
- Max SPL: 103dB
- USB port rating: 5V \equiv 500mA, (For service only)
- Frequency response: 40Hz - 20KHz
- Operating temperature: 0°C - 45°C
- Bluetooth version: 4.2
- Bluetooth frequency range: 2402MHz-2480MHz
- Max transmitting power: 10dBm
- Bluetooth modulation: GFSK, $\pi/4$ DQPSK, 8DPSK
- Standby power: 0.5W
- Dimensions (W x H x D): 614 x 58 x 90 mm / 24.17" x 2.28" x 3.54"
- Weight: 1.61 kg

ES

- Model: Bar 2.0 CNTR
- Power supply: 100 - 240V, ~ 50/60Hz
- Total maximum power: 80W
- Soundbar maximum power: 2 x 40W
- Transducer: 4 x 2.25" racetrack drivers, 2 x 1.25" tweeter
- Max SPL: 103dB
- USB port rating: 5V \equiv 500mA, (For service only)
- Frequency response: 40Hz - 20KHz
- Operating temperature: 0°C - 45°C
- Bluetooth version: 4.2
- Bluetooth frequency range: 2402MHz-2480MHz
- Max transmitting power: 10dBm
- Bluetooth modulation: GFSK, $\pi/4$ DQPSK, 8DPSK
- Standby power: 0.5W
- Dimensions (W x H x D): 614 x 58 x 90 mm / 24.17" x 2.28" x 3.54"
- Weight: 1.61 kg

**FI**

- Model: Bar 2.0 CNTR
- Power supply: 100 - 240V, ~ 50/60Hz
- Total maximum power: 80W
- Soundbar maximum power: 2 x 40W
- Transducer: 4 x 2.25" racetrack drivers, 2 x 1.25" tweeter
- Max SPL: 103dB
- USB port rating: 5V \equiv 500mA, (For service only)
- Frequency response: 40Hz - 20KHz
- Operating temperature: 0°C - 45°C
- Bluetooth version: 4.2
- Bluetooth frequency range: 2402MHz-2480MHz
- Max transmitting power: 10dBm
- Bluetooth modulation: GFSK, $\pi/4$ DQPSK, 8DPSK
- Standby power: 0.5W
- Dimensions (W x H x D): 614 x 58 x 90 mm / 24.17" x 2.28" x 3.54"
- Weight: 1.61 kg

FR

- Model: Bar 2.0 CNTR
- Power supply: 100 - 240V, ~ 50/60Hz
- Total maximum power: 80W
- Soundbar maximum power: 2 x 40W
- Transducer: 4 x 2.25" racetrack drivers, 2 x 1.25" tweeter
- Max SPL: 103dB
- USB port rating: 5V \equiv 500mA, (For service only)
- Frequency response: 40Hz - 20KHz
- Operating temperature: 0°C - 45°C
- Bluetooth version: 4.2
- Bluetooth frequency range: 2402MHz-2480MHz
- Max transmitting power: 10dBm
- Bluetooth modulation: GFSK, $\pi/4$ DQPSK, 8DPSK
- Standby power: 0.5W
- Dimensions (W x H x D): 614 x 58 x 90 mm / 24.17" x 2.28" x 3.54"
- Weight: 1.61 kg

IT

- Model: Bar 2.0 CNTR
- Power supply: 100 - 240V, ~ 50/60Hz
- Total maximum power: 80W
- Soundbar maximum power: 2 x 40W
- Transducer: 4 x 2.25" racetrack drivers, 2 x 1.25" tweeter
- Max SPL: 103dB
- USB port rating: 5V \equiv 500mA, (For service only)
- Frequency response: 40Hz - 20KHz
- Operating temperature: 0°C - 45°C
- Bluetooth version: 4.2
- Bluetooth frequency range: 2402MHz-2480MHz
- Max transmitting power: 10dBm
- Bluetooth modulation: GFSK, $\pi/4$ DQPSK, 8DPSK
- Standby power: 0.5W
- Dimensions (W x H x D): 614 x 58 x 90 mm / 24.17" x 2.28" x 3.54"
- Weight: 1.61 kg

NL

- Model: Bar 2.0 CNTR
- Power supply: 100 - 240V, ~ 50/60Hz
- Total maximum power: 80W
- Soundbar maximum power: 2 x 40W
- Transducer: 4 x 2.25" racetrack drivers, 2 x 1.25" tweeter
- Max SPL: 103dB
- USB port rating: 5V \equiv 500mA, (For service only)
- Frequency response: 40Hz - 20KHz
- Operating temperature: 0°C - 45°C
- Bluetooth version: 4.2
- Bluetooth frequency range: 2402MHz-2480MHz
- Max transmitting power: 10dBm
- Bluetooth modulation: GFSK, $\pi/4$ DQPSK, 8DPSK
- Standby power: 0.5W
- Dimensions (W x H x D): 614 x 58 x 90 mm / 24.17" x 2.28" x 3.54"
- Weight: 1.61 kg

**NO**

- Model: Bar 2.0 CNTR
- Power supply: 100 - 240V, ~ 50/60Hz
- Total maximum power: 80W
- Soundbar maximum power: 2 x 40W
- Transducer: 4 x 2.25" racetrack drivers, 2 x 1.25" tweeter
- Max SPL: 103dB
- USB port rating: 5V \equiv 500mA, (For service only)
- Frequency response: 40Hz - 20KHz
- Operating temperature: 0°C - 45°C
- Bluetooth version: 4.2
- Bluetooth frequency range: 2402MHz-2480MHz
- Max transmitting power: 10dBm
- Bluetooth modulation: GFSK, $\pi/4$ DQPSK, 8DPSK
- Standby power: 0.5W
- Dimensions (W x H x D): 614 x 58 x 90 mm / 24.17" x 2.28" x 3.54"
- Weight: 1.61 kg

PL

- Model: Bar 2.0 CNTR
- Power supply: 100 - 240V, ~ 50/60Hz
- Total maximum power: 80W
- Soundbar maximum power: 2 x 40W
- Transducer: 4 x 2.25" racetrack drivers, 2 x 1.25" tweeter
- Max SPL: 103dB
- USB port rating: 5V \equiv 500mA, (For service only)
- Frequency response: 40Hz - 20KHz
- Operating temperature: 0°C - 45°C
- Bluetooth version: 4.2
- Bluetooth frequency range: 2402MHz-2480MHz
- Max transmitting power: 10dBm
- Bluetooth modulation: GFSK, $\pi/4$ DQPSK, 8DPSK
- Standby power: 0.5W
- Dimensions (W x H x D): 614 x 58 x 90 mm / 24.17" x 2.28" x 3.54"
- Weight: 1.61 kg

PT

- Model: Bar 2.0 CNTR
- Power supply: 100 - 240V, ~ 50/60Hz
- Total maximum power: 80W
- Soundbar maximum power: 2 x 40W
- Transducer: 4 x 2.25" racetrack drivers, 2 x 1.25" tweeter
- Max SPL: 103dB
- USB port rating: 5V \equiv 500mA, (For service only)
- Frequency response: 40Hz - 20KHz
- Operating temperature: 0°C - 45°C
- Bluetooth version: 4.2
- Bluetooth frequency range: 2402MHz-2480MHz
- Max transmitting power: 10dBm
- Bluetooth modulation: GFSK, $\pi/4$ DQPSK, 8DPSK
- Standby power: 0.5W
- Dimensions (W x H x D): 614 x 58 x 90 mm / 24.17" x 2.28" x 3.54"
- Weight: 1.61 kg

RU

- Model: Bar 2.0 CNTR
- Power supply: 100 - 240V, ~ 50/60Hz
- Total maximum power: 80W
- Soundbar maximum power: 2 x 40W
- Transducer: 4 x 2.25" racetrack drivers, 2 x 1.25" tweeter
- Max SPL: 103dB
- USB port rating: 5V \equiv 500mA, (For service only)
- Frequency response: 40Hz - 20KHz
- Operating temperature: 0°C - 45°C
- Bluetooth version: 4.2
- Bluetooth frequency range: 2402MHz-2480MHz
- Max transmitting power: 10dBm
- Bluetooth modulation: GFSK, $\pi/4$ DQPSK, 8DPSK
- Standby power: 0.5W
- Dimensions (W x H x D): 614 x 58 x 90 mm / 24.17" x 2.28" x 3.54"
- Weight: 1.61 kg



SV

- Model: Bar 2.0 CNTR
- Power supply: 100 - 240V, ~ 50/60Hz
- Total maximum power: 80W
- Soundbar maximum power: 2 x 40W
- Transducer: 4 x 2.25" racetrack drivers, 2 x 1.25" tweeter
- Max SPL: 103dB
- USB port rating: 5V \equiv 500mA, (For service only)
- Frequency response: 40Hz - 20KHz
- Operating temperature: 0°C - 45°C
- Bluetooth version: 4.2
- Bluetooth frequency range: 2402MHz-2480MHz
- Max transmitting power: 10dBm
- Bluetooth modulation: GFSK, $\pi/4$ DQPSK, 8DPSK
- Standby power: 0.5W
- Dimensions (W x H x D): 614 x 58 x 90 mm / 24.17" x 2.28" x 3.54"
- Weight: 1.61 kg

JP

- Model: Bar 2.0 CNTR
- Power supply: 100 - 240V, ~ 50/60Hz
- Total maximum power: 80W
- Soundbar maximum power: 2 x 40W
- Transducer: 4 x 2.25" racetrack drivers, 2 x 1.25" tweeter
- Max SPL: 103dB
- USB port rating: 5V \equiv 500mA, (For service only)
- Frequency response: 40Hz - 20KHz
- Operating temperature: 0°C - 45°C
- Bluetooth version: 4.2
- Bluetooth frequency range: 2402MHz-2480MHz
- Max transmitting power: 10dBm
- Bluetooth modulation: GFSK, $\pi/4$ DQPSK, 8DPSK
- Standby power: 0.5W
- Dimensions (W x H x D): 614 x 58 x 90 mm / 24.17" x 2.28" x 3.54"
- Weight: 1.61 kg

KO

- Model: Bar 2.0 CNTR
- Power supply: 100 - 240V, ~ 50/60Hz
- Total maximum power: 80W
- Soundbar maximum power: 2 x 40W
- Transducer: 4 x 2.25" racetrack drivers, 2 x 1.25" tweeter
- Max SPL: 103dB
- USB port rating: 5V \equiv 500mA, (For service only)
- Frequency response: 40Hz - 20KHz
- Operating temperature: 0°C - 45°C
- Bluetooth version: 4.2
- Bluetooth frequency range: 2402MHz-2480MHz
- Max transmitting power: 10dBm
- Bluetooth modulation: GFSK, $\pi/4$ DQPSK, 8DPSK
- Standby power: 0.5W
- Dimensions (W x H x D): 614 x 58 x 90 mm / 24.17" x 2.28" x 3.54"
- Weight: 1.61 kg

CN

- Model: Bar 2.0 CNTR
- Power supply: 100 - 240V, ~ 50/60Hz
- Total maximum power: 80W
- Soundbar maximum power: 2 x 40W
- Transducer: 4 x 2.25" racetrack drivers, 2 x 1.25" tweeter
- Max SPL: 103dB
- USB port rating: 5V \equiv 500mA, (For service only)
- Frequency response: 40Hz - 20KHz
- Operating temperature: 0°C - 45°C
- Bluetooth version: 4.2
- Bluetooth frequency range: 2402MHz-2480MHz
- Max transmitting power: 10dBm
- Bluetooth modulation: GFSK, $\pi/4$ DQPSK, 8DPSK
- Standby power: 0.5W
- Dimensions (W x H x D): 614 x 58 x 90 mm / 24.17" x 2.28" x 3.54"
- Weight: 1.61 kg



TW

- Model: Bar 2.0 CNTR
- Power supply: 100 - 240V, ~ 50/60Hz
- Total maximum power: 80W
- Soundbar maximum power: 2 x 40W
- Transducer: 4 x 2.25" racetrack drivers, 2 x 1.25" tweeter
- Max SPL: 103dB
- USB port rating: 5V \equiv 500mA, (For service only)
- Frequency response: 40Hz - 20KHz
- Operating temperature: 0°C - 45°C
- Bluetooth version: 4.2
- Bluetooth frequency range: 2402MHz-2480MHz
- Max transmitting power: 10dBm
- Bluetooth modulation: GFSK, $\pi/4$ DQPSK, 8DPSK
- Standby power: 0.5W
- Dimensions (W x H x D): 614 x 58 x 90 mm / 24.17" x 2.28" x 3.54"
- Weight: 1.61 kg

ID

- Model: Bar 2.0 CNTR
- Power supply: 100 - 240V, ~ 50/60Hz
- Total maximum power: 80W
- Soundbar maximum power: 2 x 40W
- Transducer: 4 x 2.25" racetrack drivers, 2 x 1.25" tweeter
- Max SPL: 103dB
- USB port rating: 5V \equiv 500mA, (For service only)
- Frequency response: 40Hz - 20KHz
- Operating temperature: 0°C - 45°C
- Bluetooth version: 4.2
- Bluetooth frequency range: 2402MHz-2480MHz
- Max transmitting power: 10dBm
- Bluetooth modulation: GFSK, $\pi/4$ DQPSK, 8DPSK
- Standby power: 0.5W
- Dimensions (W x H x D): 614 x 58 x 90 mm / 24.17" x 2.28" x 3.54"
- Weight: 1.61 kg

AR

- Model: Bar 2.0 CNTR
- Power supply: 100 - 240V, ~ 50/60Hz
- Total maximum power: 80W
- Soundbar maximum power: 2 x 40W
- Transducer: 4 x 2.25" racetrack drivers, 2 x 1.25" tweeter
- Max SPL: 103dB
- USB port rating: 5V \equiv 500mA, (For service only)
- Frequency response: 40Hz - 20KHz
- Operating temperature: 0°C - 45°C
- Bluetooth version: 4.2
- Bluetooth frequency range: 2402MHz-2480MHz
- Max transmitting power: 10dBm
- Bluetooth modulation: GFSK, $\pi/4$ DQPSK, 8DPSK
- Standby power: 0.5W
- Dimensions (W x H x D): 614 x 58 x 90 mm / 24.17" x 2.28" x 3.54"
- Weight: 1.61 kg

Торговая марка:	JBL
Назначение товара:	Активная акустическая система
Изготовитель:	Харман Интернешнл Индастриз Инкорпорейтед, США, 06901 Коннектикут, г.Стэмфорд, Атлантик Стрит 400, офис 1500
Страна происхождения:	Китай
Импортер в Россию:	ООО "ХАРМАН РУС СиАйЭс", Россия, 127018, г.Москва, ул.Двинцев, д.12, к 1
Гарантийный период:	1 год
Информация о сервисных центрах:	www.harman.com/ru тел. +7-800-700-0467
Срок службы:	5 лет

Товар сертифицирован

Дата производства:

EAC

Дата изготовления устройства определяется по двумбуквенным обозначениям из второй группы символов серийного номера изделия, следующих после разделительного знака «-». Кодировка соответствует порядкубукв латинского алфавита, начиная с января 2010 года: 000000-MY0000000, где «M» -месяц производства (A - январь, B - февраль, C - март и т.д.) и «Y» - год производства (A - 2010, B - 2011, C - 2012 и т.д.).

Используйте устройство только по прямому назначению в соответствии с предоставленной инструкцией. Не пытайтесь самостоятельно вскрывать корпус товара и осуществлять ремонт. В случае обнаружения недостатков или дефектов, обращайтесь за гарантийным обслуживанием в соответствии с информацией из гарантийного талона. Особые условия хранения, реализации и (или) транспортировки не предусмотрены. Избегайте воздействия экстремальных температур, долговременного воздействия влаги, сильных магнитных полей. Устройство предназначено для работы в жилых зонах. Срок годности не ограничен при соблюдении условий хранения



The Bluetooth® word mark and logos are registered trademarks owned by the Bluetooth SIG, Inc. and any use of such marks by HARMAN International Industries, Incorporated is under license. Other trademarks and trade names are those of their respective owners.



The terms HDMI, HDMI High-Definition Multimedia Interface, and the HDMI Logo are trademarks or registered trademarks of HDMI Licensing Administrator, Inc.



Manufactured under license from Dolby Laboratories. Dolby, Dolby Audio and the double-D symbol are trademarks of Dolby Laboratories.



Este equipamento não tem direito à proteção contra interferência prejudicial e não pode causar interferência em sistemas devidamente autorizados.

Este produto está homologado pela ANATEL, de acordo com os procedimentos regulamentados pela Resolução 242/2000, e atende aos requisitos técnicos aplicados.

Para maiores informações, consulte o site da ANATEL - www.anatel.gov.br

