

AMPSound by Jabees are the Hearing-Aid Like Sound Amplifiers and a Wireless Bluetooth Headphones all in one. They are unique in the way they combine the benefits of three different products in one beautifully designed stereo headphones.

- Personal Bluetooth Amplifiers to boost your hearing
- Bluetooth Stereo Headphones for music streaming
- Bluetooth Headset for phone calls

LET'S EXPLORE TOGETHER!



- 1 -

IN THE BOX

- 1) AMPSound Bluetooth Hearing Amplifier (1)
- 2) Power Pouch with Built-in 3000mAh Battery Capacity (1)
- 3) Single-Flange Earbuds (S.M.L.) (3)
- 4) Double-Flange Earbuds (S.M.L.) (3)
- 5) In-Ear Earbuds (S.M.L.) (3)
- 6) Micro-USB Charging Cable (1)
- 7) Screwdriver



- 2 -

PRODUCT OVERVIEW

- 1) On/Off Switch
- 2) MODE Button
- 3) MF Button (Multifunction Button)
- 4) LED Light
- 5) Microphone 1
- 6) Microphone 2

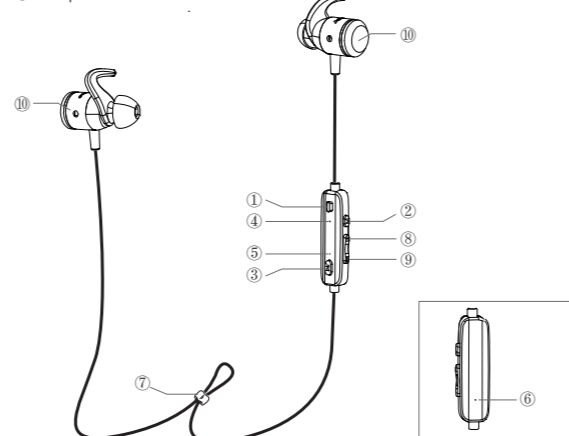

- 3 -

MF Button

- MF Button



Play/Pause Music

Answer/End the Call

Reject the Call

Transfer the Call

Redial Last Number

Press once

Press once

Long press for 2 seconds when incoming call

Long press for 2 seconds during the call state

Long press for 2 seconds

Volume Buttons

- Volume Buttons



Adjust the Volume

Enhance & Lower the Amplifier Sound

Next/Previous Song

Mute/Unmute

Press once V+/-

Press once V+/-

Long press V+/-

Press V+/-V- at the same time

Press V+/-V- at the same time

Press V+/-V- at the same time

Press V+/-V- at the same time

Press V+/-V- at the same time

Press V+/-V- at the same time

Press V+/-V- at the same time

Press V+/-V- at the same time

Press V+/-V- at the same time

Press V+/-V- at the same time

Press V+/-V- at the same time

Press V+/-V- at the same time

Press V+/-V- at the same time

Press V+/-V- at the same time

Press V+/-V- at the same time

Press V+/-V- at the same time

Press V+/-V- at the same time

Press V+/-V- at the same time

Press V+/-V- at the same time

Press V+/-V- at the same time

Press V+/-V- at the same time

Press V+/-V- at the same time

Press V+/-V- at the same time

Press V+/-V- at the same time

Press V+/-V- at the same time

Press V+/-V- at the same time

Press V+/-V- at the same time

Press V+/-V- at the same time

Press V+/-V- at the same time

Press V+/-V- at the same time

Press V+/-V- at the same time

Press V+/-V- at the same time

Press V+/-V- at the same time

Press V+/-V- at the same time

Press V+/-V- at the same time

Press V+/-V- at the same time

Press V+/-V- at the same time

Press V+/-V- at the same time

Press V+/-V- at the same time

Press V+/-V- at the same time

Press V+/-V- at the same time

Press V+/-V- at the same time

Press V+/-V- at the same time

Press V+/-V- at the same time

Press V+/-V- at the same time

Press V+/-V- at the same time

Press V+/-V- at the same time

Press V+/-V- at the same time

Press V+/-V- at the same time

Press V+/-V- at the same time

Press V+/-V- at the same time

Press V+/-V- at the same time

Press V+/-V- at the same time

Press V+/-V- at the same time

Press V+/-V- at the same time

Press V+/-V- at the same time

Press V+/-V- at the same time

Press V+/-V- at the same time

Press V+/-V- at the same time

Press V+/-V- at the same time

Press V+/-V- at the same time

Press V+/-V- at the same time

Press V+/-V- at the same time

Press V+/-V- at the same time

Press V+/-V- at the same time

Press V+/-V- at the same time

Press V+/-V- at the same time

Press V+/-V- at the same time

WEARING THE HEADPHONES

Wearing the headphones correctly will ensure the most comfortable and secure fit.

Step 1:

Zip tight seal between earbud and ear canal to deliver great sound and bass. Three sizes of earbuds, single-flange and double flange earbuds are included to help you achieve the best fit. We recommend trying all of them and selecting the ones with the best sound and comfort for your ears.

Step 2:

The soft silicone wings gently lock into the bowl of the wearer's ears.

Step 3:

Adjust the cable cinch to reduce cable slack for a more secure and comfortable fit.

Step 4:

Adjust the cable cinch to reduce cable slack for a more secure and comfortable fit.

Step 5:

Adjust the cable cinch to reduce cable slack for a more secure and comfortable fit.

Step 6:

Adjust the cable cinch to reduce cable slack for a more secure and comfortable fit.

Step 7:

Adjust the cable cinch to reduce cable slack for a more secure and comfortable fit.

Step 8:

Adjust the cable cinch to reduce cable slack for a more secure and comfortable fit.

Step 9:

Adjust the cable cinch to reduce cable slack for a more secure and comfortable fit.

Step 10:

Adjust the cable cinch to reduce cable slack for a more secure and comfortable fit.

Step 11:

Adjust the cable cinch to reduce cable slack for a more secure and comfortable fit.

Step 12:

Adjust the cable cinch to reduce cable slack for a more secure and comfortable fit.

Step 13:

Adjust the cable cinch to reduce cable slack for a more secure and comfortable fit.

Step 14:

Adjust the cable cinch to reduce cable slack for a more secure and comfortable fit.

Step 15:

Adjust the cable cinch to reduce cable slack for a more secure and comfortable fit.

Step 16:

Adjust the cable cinch to reduce cable slack for a more secure and comfortable fit.

Step 17:

Adjust the cable cinch to reduce cable slack for a more secure and comfortable fit.

Step 18:

Adjust the cable cinch to reduce cable slack for a more secure and comfortable fit.

Step 19:

Adjust the cable cinch to reduce cable slack for a more secure and comfortable fit.

Step 20:

Adjust the cable cinch to reduce cable slack for a more secure and comfortable fit.

Step 21:

Adjust the cable cinch to reduce cable slack for a more secure and comfortable fit.

Step 22:

Adjust the cable cinch to reduce cable slack for a more secure and comfortable fit.

Step 23:

Adjust the cable cinch to reduce cable slack for a more secure and comfortable fit.

Step 24:

Adjust the cable cinch to reduce cable slack for a more secure and comfortable fit.

Step 25:

Adjust the cable cinch to reduce cable slack for a more secure and comfortable fit.

Step 26:

Adjust the cable cinch to reduce cable slack for a more secure and comfortable fit.

Step 27:

Adjust the cable cinch to reduce cable slack for a more secure and comfortable fit.

Step 28:

Adjust the cable cinch to reduce cable slack for a more secure and comfortable fit.

Step 29:

Adjust the cable cinch to reduce cable slack for a more secure and comfortable fit.

Step 30:

Adjust the cable cinch to reduce cable slack for a more secure and comfortable fit.

Step 31:

Adjust the cable cinch to reduce cable slack for a more secure and comfortable fit.

Step 32:

Adjust the cable cinch to reduce cable slack for a more secure and comfortable fit.

Step 33:

Adjust the cable cinch to reduce cable slack for a more secure and comfortable fit.

Step 34:

Adjust the cable cinch to reduce cable slack for a more secure and comfortable fit.

Step 35:

Adjust the cable cinch to reduce cable slack for a more secure and comfortable fit.

Step 36:

Adjust the cable cinch to reduce cable slack for a more secure and comfortable fit.

Step 37:

Adjust the cable cinch to reduce cable slack for a more secure and comfortable fit.

Step 38:

Adjust the cable cinch to reduce cable slack for a more secure and comfortable fit.

Step 39:

Adjust the cable cinch to reduce cable slack for a more secure and comfortable fit.

Step 40:

Adjust the cable cinch to reduce cable slack for a more secure and comfortable fit.

CHARGING

The Power Pack of AMPSound is with built-in 3000mAh battery capacity. It can be used to charge the Battery Capsules, as well as the mobile phones.

- LED Indicator Lights to Show the Remaining Capacity

- 4) LED on: 100% 3) LED on: 75%
- 2) LED on: 50% 1) LED on: 25%

- 1) LED Indicator Lights
- 2) USB Output for Charging the Mobile Phone.
- 3) Input for Charging the Power Pack
- 4) LED Charging Status Indicator Lights
- 5) Internal Mesh Pocket

- 1) LED Indicator Lights
- 2) USB Output for Charging the Mobile Phone.
- 3) Input for Charging the Power Pack
- 4) LED Charging Status Indicator Lights
- 5) Internal Mesh Pocket

- 1) LED Indicator Lights
- 2) USB Output for Charging the Mobile Phone.
- 3) Input for Charging the Power Pack
- 4) LED Charging Status Indicator Lights
- 5) Internal Mesh Pocket

- 1) LED Indicator Lights
- 2) USB Output for Charging the Mobile Phone.
- 3) Input for Charging the Power Pack
- 4) LED Charging Status Indicator Lights
- 5) Internal Mesh Pocket

- 1) LED Indicator Lights
- 2) USB Output for Charging the Mobile Phone.
- 3) Input for Charging the Power Pack
- 4) LED Charging Status Indicator Lights
- 5) Internal Mesh Pocket

- 1) LED Indicator Lights
- 2) USB Output for Charging the Mobile Phone.
- 3) Input for Charging the Power Pack
- 4) LED Charging Status Indicator Lights
- 5) Internal Mesh Pocket

- 1) LED Indicator Lights
- 2) USB Output for Charging the Mobile Phone.
- 3) Input for Charging the Power Pack
- 4) LED Charging Status Indicator Lights
- 5) Internal Mesh Pocket

- 1) LED Indicator Lights
- 2) USB Output for Charging the Mobile Phone.
- 3) Input for Charging the Power Pack
- 4) LED Charging Status Indicator Lights
- 5) Internal Mesh Pocket

- 1) LED Indicator Lights
- 2) USB Output for Charging the Mobile Phone.
- 3) Input for Charging the Power Pack
- 4) LED Charging Status Indicator Lights
- 5) Internal Mesh Pocket

- 1) LED Indicator Lights
- 2) USB Output for Charging the Mobile Phone.
- 3) Input for Charging the Power Pack
- 4) LED Charging Status Indicator Lights
- 5) Internal Mesh Pocket

- 1) LED Indicator Lights
- 2) USB Output for Charging the Mobile Phone.
- 3) Input for Charging the Power Pack
- 4) LED Charging Status Indicator Lights
- 5) Internal Mesh Pocket

- 1) LED Indicator Lights
- 2) USB Output for Charging the Mobile Phone.
- 3) Input for Charging the Power Pack
- 4) LED Charging Status Indicator Lights
- 5) Internal Mesh Pocket

- 1) LED Indicator Lights
- 2) USB Output for Charging the Mobile Phone.
- 3) Input for Charging the Power Pack
- 4) LED Charging Status Indicator Lights
- 5) Internal Mesh Pocket

- 1) LED Indicator Lights
- 2) USB Output for Charging the Mobile Phone.
- 3) Input for Charging the Power Pack
- 4) LED Charging Status Indicator Lights
- 5) Internal Mesh Pocket

- 1) LED Indicator Lights
- 2) USB Output for Charging the Mobile Phone.
- 3) Input for Charging the Power Pack
- 4) LED Charging Status Indicator Lights
- 5) Internal Mesh Pocket

- 1) LED Indicator Lights
- 2) USB Output for Charging the Mobile Phone.
- 3) Input for Charging the Power Pack
- 4) LED Charging Status Indicator Lights
- 5) Internal Mesh Pocket

- 1) LED Indicator Lights
- 2) USB Output for Charging the Mobile Phone.
- 3) Input for Charging the Power Pack
- 4) LED Charging Status Indicator Lights
- 5) Internal Mesh Pocket

- 1) LED Indicator Lights
- 2) USB Output for Charging the Mobile Phone.
- 3) Input for Charging the Power Pack
- 4) LED Charging Status Indicator Lights
- 5) Internal Mesh Pocket

- 1) LED Indicator Lights
- 2) USB Output for Charging the Mobile Phone.
- 3) Input for Charging the Power Pack
- 4) LED Charging Status Indicator Lights
- 5) Internal Mesh Pocket

- 1) LED Indicator Lights
- 2) USB Output for Charging the Mobile Phone.
- 3) Input for Charging the Power Pack
- 4) LED Charging Status Indicator Lights
- 5) Internal Mesh Pocket

- 1) LED Indicator Lights
- 2) USB Output for Charging the Mobile Phone.
- 3) Input for Charging the Power Pack
- 4) LED Charging Status Indicator Lights
- 5) Internal Mesh Pocket

- 1) LED Indicator Lights
- 2) USB Output for Charging the Mobile Phone.
- 3) Input for Charging the Power Pack
- 4) LED Charging Status Indicator Lights
- 5) Internal Mesh Pocket

- 1) LED Indicator Lights
- 2) USB Output for Charging the Mobile Phone.
- 3) Input for Charging the Power Pack
- 4) LED Charging Status Indicator Lights
- 5) Internal Mesh Pocket

- 1) LED Indicator Lights
- 2) USB Output for Charging the Mobile Phone.
- 3) Input for Charging the Power Pack
- 4) LED Charging Status Indicator Lights
- 5) Internal Mesh Pocket

- 1) LED Indicator Lights
- 2) USB Output for Charging the Mobile Phone.
- 3) Input for Charging the Power Pack
- 4) LED Charging Status Indicator Lights
- 5) Internal Mesh Pocket

- 1) LED Indicator Lights
- 2) USB Output for Charging the Mobile Phone.
- 3) Input for Charging the Power Pack
- 4) LED Charging Status Indicator Lights
- 5) Internal Mesh Pocket

- 1) LED Indicator Lights
- 2) USB Output for Charging the Mobile Phone.
- 3) Input for Charging the Power Pack
- 4) LED Charging Status Indicator Lights
- 5) Internal Mesh Pocket

- 1) LED Indicator Lights
- 2) USB Output for Charging the Mobile Phone.
- 3) Input for Charging the Power Pack
- 4) LED Charging Status Indicator Lights
- 5) Internal Mesh Pocket

- 1) LED Indicator Lights
- 2) USB Output for Charging the Mobile Phone.
- 3) Input for Charging the Power Pack
- 4) LED Charging Status Indicator Lights
- 5) Internal Mesh Pocket

- 1) LED Indicator Lights
- 2) USB Output for Charging the Mobile Phone.
- 3) Input for Charging the Power Pack
- 4) LED Charging Status Indicator Lights
- 5) Internal Mesh Pocket

- 1) LED Indicator Lights
- 2) USB Output for Charging the Mobile Phone.
- 3) Input for Charging the Power Pack
- 4) LED Charging Status Indicator Lights
- 5) Internal Mesh Pocket

- 1) LED Indicator Lights
- 2) USB Output for Charging the Mobile Phone.
- 3) Input for Charging the Power Pack
- 4) LED Charging Status Indicator Lights
- 5) Internal Mesh Pocket

BLUETOOTH MUSIC & HANDSFREE MODE

AMPSound can be used as a conventional Bluetooth Stereo Headphones for Music Streaming and Phone Call after pairing and connecting with your device. (Please refer to "BLUETOOTH PAIRING & CONNECTION" section.)

- Wireless Music Streaming

AMPSound features the aptX technology for the CD-like quality music when you are listening to your favorite tune.

- Wireless Handsfree

AMPSound can be used to receive and make calls, and voice message on WhatsApp, Wechat, Skype and so on.

- Note: When there is incoming call, the Hearing Amplifier Mode will be automatically switched to the Bluetooth Handsfree mode. When the call ends, the headphones will be switched back to the Hearing Amplifier Mode.

- Note: When there is incoming call, the Hearing Amplifier Mode will be automatically switched to the Bluetooth Handsfree mode. When the call ends, the headphones will be switched back to the Hearing Amplifier Mode.

- Note: When there is incoming call, the Hearing Amplifier Mode will be automatically switched to the Bluetooth Handsfree mode. When the call ends, the headphones will be switched back to the Hearing Amplifier Mode.

- Note: When there is incoming call, the Hearing Amplifier Mode will be automatically switched to the Bluetooth Handsfree mode. When the call ends, the headphones will be switched back to the Hearing Amplifier Mode.

- Note: When there is incoming call, the Hearing Amplifier Mode will be automatically switched to the Bluetooth Handsfree mode. When the call ends, the headphones will be switched back to the Hearing Amplifier Mode.

- Note: When there is incoming call, the Hearing Amplifier Mode will be automatically switched to the Bluetooth Handsfree mode. When the call ends, the headphones will be switched back to the Hearing Amplifier Mode.